



Rogers

Assessment Property Record Card for Tax Year 2026

Data provided by LISA DELOZIER County Assessor

Date 04/17/2026
Time 03:10:21
Page 1

Assessment Data					Primary Image																																																																																																																				
Account 660003340 Parcel ID 22N17E-04-3-00000-000-0000 Cadastral ID 04-22-17-00900 Property Type REAL - Real Property Property Class RA VI Area 2 Tax Area 70 - FOYIL RURAL/FOYIL FIRE Name ID 292149 CLARK, NATHAN J & VALERIE D 13559 S ELM PL CLAREMORE OK 74017-0000 Parcel Location Situs 13801 S 4210 RD Subdivision Lot/Block / Parcel Size 169.28 - Acres Sec/Twn/Rng 4 / 22 / 17 / 3 Neighborhood 4070 - FOYIL SEQUOYAH AREA School District S007 - FOYIL SCHOOLS																																																																																																																									
Legal Description Lat/Long: 36.41154479 -95.50025739																																																																																																																									
Legal Description S 636' S2 NW SW & N2 SW SW & NW SE SW & E2 NW SE & SW SE & SW NW SE & S2 SE SW & SW SW SW & SE SW SW & NE SE SW					Building Permits <table border="1"> <thead> <tr> <th>Number</th> <th>Description</th> <th>Opened</th> <th>Closed</th> <th>Amount</th> </tr> </thead> <tbody> <tr> <td> </td> <td> </td> <td> </td> <td> </td> <td> </td> </tr> </tbody> </table>					Number	Description	Opened	Closed	Amount																																																																																																											
Number	Description	Opened	Closed	Amount																																																																																																																					
Exemptions <table border="1"> <thead> <tr> <th>Code</th> <th>Type</th> <th>Active</th> <th>Maximum</th> <th>Exemption</th> </tr> </thead> <tbody> <tr> <td>H</td> <td>Homestead</td> <td>No</td> <td>1,000</td> <td> </td> </tr> </tbody> </table>					Code	Type	Active	Maximum	Exemption	H	Homestead	No	1,000		Sale History <table border="1"> <thead> <tr> <th>Bk/Pg</th> <th>Grantor</th> <th>Date</th> <th>Price</th> <th>Code</th> </tr> </thead> <tbody> <tr> <td>/</td> <td>STONE, BALFORD MRS</td> <td>11/19/2024</td> <td>620,000</td> <td>WG</td> </tr> </tbody> </table>					Bk/Pg	Grantor	Date	Price	Code	/	STONE, BALFORD MRS	11/19/2024	620,000	WG																																																																																												
Code	Type	Active	Maximum	Exemption																																																																																																																					
H	Homestead	No	1,000																																																																																																																						
Bk/Pg	Grantor	Date	Price	Code																																																																																																																					
/	STONE, BALFORD MRS	11/19/2024	620,000	WG																																																																																																																					
Parcel Valuation <table border="1"> <thead> <tr> <th>Source</th> <th>REAL</th> <th>Fair Cash</th> <th>Capped</th> <th>Asmnt Level</th> <th>Assessed</th> <th>Levy Rate</th> <th>101.660</th> <th>Current Tax</th> </tr> </thead> <tbody> <tr> <td>Remove Cap</td> <td>2025</td> <td>Land Value 11,959</td> <td>11,959</td> <td>11%</td> <td>1,315</td> <td>Assessed</td> <td>17,905</td> <td>1,820.22</td> </tr> <tr> <td>Year Frozen</td> <td>2005</td> <td>Improvements 150,821</td> <td>150,821</td> <td> </td> <td>16,590</td> <td>Penalty</td> <td>0</td> <td> </td> </tr> <tr> <td>Uncapped Value</td> <td>0</td> <td>Mobile Home 0</td> <td>0</td> <td> </td> <td>0</td> <td>Exemption</td> <td>0</td> <td>0.00</td> </tr> <tr> <td>TIF Project ID</td> <td>0</td> <td>Total Value 162,780</td> <td>162,780</td> <td> </td> <td>17,905</td> <td>Total Taxable</td> <td>17,905</td> <td>1,820.00</td> </tr> </tbody> </table>										Source	REAL	Fair Cash	Capped	Asmnt Level	Assessed	Levy Rate	101.660	Current Tax	Remove Cap	2025	Land Value 11,959	11,959	11%	1,315	Assessed	17,905	1,820.22	Year Frozen	2005	Improvements 150,821	150,821		16,590	Penalty	0		Uncapped Value	0	Mobile Home 0	0		0	Exemption	0	0.00	TIF Project ID	0	Total Value 162,780	162,780		17,905	Total Taxable	17,905	1,820.00																																																																			
Source	REAL	Fair Cash	Capped	Asmnt Level	Assessed	Levy Rate	101.660	Current Tax																																																																																																																	
Remove Cap	2025	Land Value 11,959	11,959	11%	1,315	Assessed	17,905	1,820.22																																																																																																																	
Year Frozen	2005	Improvements 150,821	150,821		16,590	Penalty	0																																																																																																																		
Uncapped Value	0	Mobile Home 0	0		0	Exemption	0	0.00																																																																																																																	
TIF Project ID	0	Total Value 162,780	162,780		17,905	Total Taxable	17,905	1,820.00																																																																																																																	
Assessment History <table border="1"> <thead> <tr> <th>Tax Year</th> <th>Statement Number</th> <th>Billed Owner</th> <th>Tax Area</th> <th>Total Value</th> <th>Exemptions</th> <th>Taxable Value</th> <th>Billed Tax</th> </tr> </thead> <tbody> <tr><td>2025</td><td>2025-660003340</td><td>CLARK, NATHAN J &</td><td>70</td><td>203,131</td><td>0</td><td>22,344</td><td>2,271.00</td></tr> <tr><td>2024</td><td>2024-660003340</td><td>STONE, BALFORD MRS</td><td>70</td><td>139,650</td><td>1000</td><td>7,491</td><td>794.00</td></tr> <tr><td>2023</td><td>2023-660003340</td><td>STONE, BALFORD MRS</td><td>70</td><td>130,475</td><td>1000</td><td>7,490</td><td>795.00</td></tr> <tr><td>2022</td><td>2022-660003340</td><td>STONE, BALFORD MRS</td><td>70</td><td>126,222</td><td>1000</td><td>7,491</td><td>798.00</td></tr> <tr><td>2021</td><td>2021-660003340</td><td>STONE, BALFORD MRS</td><td>70</td><td>129,820</td><td>1000</td><td>7,490</td><td>778.00</td></tr> <tr><td>2020</td><td>2020-660003340</td><td>STONE, BALFORD MRS</td><td>70</td><td>130,888</td><td>1000</td><td>7,491</td><td>809.00</td></tr> <tr><td>2019</td><td>2019-660003340</td><td>STONE, BALFORD MRS</td><td>70</td><td>127,052</td><td>1000</td><td>7,490</td><td>812.00</td></tr> <tr><td>2018</td><td>2018-660003340</td><td>STONE, BALFORD MRS</td><td>70</td><td>132,701</td><td>1000</td><td>7,491</td><td>797.00</td></tr> <tr><td>2017</td><td>2017-660003340</td><td>STONE, BALFORD MRS</td><td>70</td><td>131,504</td><td>1000</td><td>7,491</td><td>800.00</td></tr> <tr><td>2016</td><td>2016-660003340</td><td>STONE, BALFORD MRS</td><td>70</td><td>127,975</td><td>1000</td><td>7,490</td><td>828.00</td></tr> <tr><td>2015</td><td>2015-660003340</td><td>STONE, BALFORD MRS</td><td>70</td><td>126,653</td><td>1000</td><td>7,491</td><td>820.00</td></tr> <tr><td>2014</td><td>2014-660003340</td><td>STONE, BALFORD MRS</td><td>70</td><td>129,210</td><td>1000</td><td>7,490</td><td>808.00</td></tr> <tr><td>2013</td><td>2013-660003340</td><td>STONE, BALFORD MRS</td><td>70</td><td>121,279</td><td>1000</td><td>7,491</td><td>790.00</td></tr> </tbody> </table>										Tax Year	Statement Number	Billed Owner	Tax Area	Total Value	Exemptions	Taxable Value	Billed Tax	2025	2025-660003340	CLARK, NATHAN J &	70	203,131	0	22,344	2,271.00	2024	2024-660003340	STONE, BALFORD MRS	70	139,650	1000	7,491	794.00	2023	2023-660003340	STONE, BALFORD MRS	70	130,475	1000	7,490	795.00	2022	2022-660003340	STONE, BALFORD MRS	70	126,222	1000	7,491	798.00	2021	2021-660003340	STONE, BALFORD MRS	70	129,820	1000	7,490	778.00	2020	2020-660003340	STONE, BALFORD MRS	70	130,888	1000	7,491	809.00	2019	2019-660003340	STONE, BALFORD MRS	70	127,052	1000	7,490	812.00	2018	2018-660003340	STONE, BALFORD MRS	70	132,701	1000	7,491	797.00	2017	2017-660003340	STONE, BALFORD MRS	70	131,504	1000	7,491	800.00	2016	2016-660003340	STONE, BALFORD MRS	70	127,975	1000	7,490	828.00	2015	2015-660003340	STONE, BALFORD MRS	70	126,653	1000	7,491	820.00	2014	2014-660003340	STONE, BALFORD MRS	70	129,210	1000	7,490	808.00	2013	2013-660003340	STONE, BALFORD MRS	70	121,279	1000	7,491	790.00
Tax Year	Statement Number	Billed Owner	Tax Area	Total Value	Exemptions	Taxable Value	Billed Tax																																																																																																																		
2025	2025-660003340	CLARK, NATHAN J &	70	203,131	0	22,344	2,271.00																																																																																																																		
2024	2024-660003340	STONE, BALFORD MRS	70	139,650	1000	7,491	794.00																																																																																																																		
2023	2023-660003340	STONE, BALFORD MRS	70	130,475	1000	7,490	795.00																																																																																																																		
2022	2022-660003340	STONE, BALFORD MRS	70	126,222	1000	7,491	798.00																																																																																																																		
2021	2021-660003340	STONE, BALFORD MRS	70	129,820	1000	7,490	778.00																																																																																																																		
2020	2020-660003340	STONE, BALFORD MRS	70	130,888	1000	7,491	809.00																																																																																																																		
2019	2019-660003340	STONE, BALFORD MRS	70	127,052	1000	7,490	812.00																																																																																																																		
2018	2018-660003340	STONE, BALFORD MRS	70	132,701	1000	7,491	797.00																																																																																																																		
2017	2017-660003340	STONE, BALFORD MRS	70	131,504	1000	7,491	800.00																																																																																																																		
2016	2016-660003340	STONE, BALFORD MRS	70	127,975	1000	7,490	828.00																																																																																																																		
2015	2015-660003340	STONE, BALFORD MRS	70	126,653	1000	7,491	820.00																																																																																																																		
2014	2014-660003340	STONE, BALFORD MRS	70	129,210	1000	7,490	808.00																																																																																																																		
2013	2013-660003340	STONE, BALFORD MRS	70	121,279	1000	7,491	790.00																																																																																																																		



Rogers

Assessment Property Record Card for Tax Year 2026

Data provided by LISA DELOZIER County Assessor

Date 04/17/2026
 Time 03:10:21
 Page 2

Lot Data - FOYIL SEQUOYAH AREA (UNITS BUILDABLE)	
Lot Size	
Lot Count	
Units Buildable	
Non-Ag Acres	0
Topography	
Street Access	
Utilities	
Amenities	LAND QUALITY
Method	Units-Buildable
Base Lot Value	
Factor Value	
Adjustments	
Lot Value	



\\tsclient\C\TOMS PC PICS\2016-11-15 11-15-2016\11-15-2016 00 11/15/2016

Residential Data	
Type	1 Single Family Residence
Condition	3 - Average
Quality	3 - Average
Architecture	TRAD TRADITIONAL
Style	100% One Story
Exterior Wall	100% Veneer, Stone
Base/Total Area	1,806 / 1,806
Style	100% One Story
HVAC	100% Warmed & Cooled Air
Roof Cover	1 Composition Shingle
Area on Slab	0
Fixture/RghIn	8 /
Bed/F/H Bath	2 / 2.0 /
Basement Area	
Garage Type	400 Attached Garage - Unfinished
Remodel	
Year/Eff Age	1974 / 39

GRM Approach

GRM Code	
Gross Rent	0.00
Indicated Value	

Multiple Regression

MRA Code	
Adjusted R	
Indicated Value	

Direct Comparables

Selection Model	1 Res
Adjustment Model	A2 AO Test
Comparables	
Indicated Value	

Cost Approach		Manual : 01/2025	
Base Cost	115.55	Total Misc Impr	+ 11,132
Roofing Adj	+ 4.80	Garage Cost	+ 13,584
Subfloor Adj	+ 0.00	Total RCN	= 276,400
Heat/Cool Adj	+ 12.64	Depreciation (46%)	- 127,144
Plumbing Adj	+ 6.37	Lump Sums	+ 0
Basement Adj	+ 0.00	RCNLD	= 149,256
Adj Base Cost	= 139.36	Lot Value	+ 149,256
Total Area	x 1,806	Indicated Value	= 149,256
Adjusted Cost	= 251,684	Value Per SqFt	82.64

Value Reconciliation

Selected Approach	Cost Approach		
Improvements	149,256		
Lot Value			
Indicated Value	149,256	82.64	Per SqFt
Agland Value	11,959		
Site Improvements	1,565		
Total Value	312,036	172.78	Total Value Per SqFt

Miscellaneous Improvements

Code	Description	Sketch ID	Size	Year	Units	Unit Cost	Depr	Value
FPR1	FIREPLACE - RESIDENTIAL 1 STORY	0		1	1	5,615.40		5,615
PRCH	Porch	8406		58	58	26.75		1,552
PATO	SLAB PORCH - OPEN	8407	18x8		144	11.07		1,594
PATO	SLAB PORCH - OPEN	8408	20x12		240	9.88		2,371



Rogers

Assessment Property Record Card for Tax Year 2026

Data provided by LISA DELOZIER County Assessor

Date 04/17/2026
 Time 03:10:21
 Page 3

Sketch Image

660003340

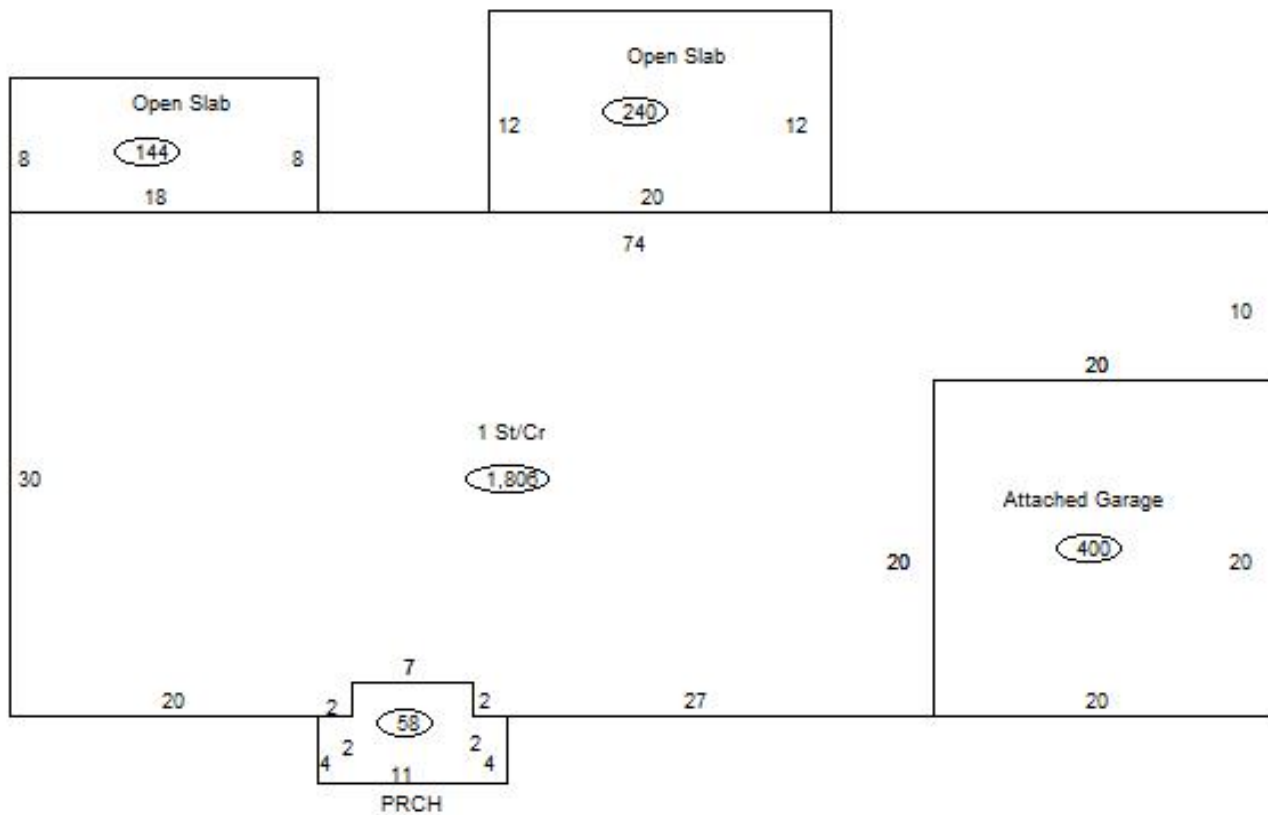

Sketch Vector Information

Sequence	Code	Type	Built Over	Scale	Section Label	Base Area	Multiplier	Total Area
1	R	1	Crawl	13	1 St/Cr	1,806	1.000	1,806
2	G	1		13	Attached Garage	400	1.000	400
3	M	PRCH		13	PRCH	58	1.000	58
4	M	PATO		13	Open Slab	144	1.000	144
5	M	PATO		13	Open Slab	240	1.000	240
Total Building Area						1,806		1,806



Rogers

Assessment Property Record Card for Tax Year 2026

Data provided by LISA DELOZIER County Assessor

Date 04/17/2026
Time 03:10:21
Page 4

660003340

Outbuildings/Site Improvements

Building Image	Code	Description	Dimensions	Floor	Roofing	Total Units
	LOAF	LOAFING SHED	30x20x8	Dirt	Galvanized Metal	600
	Qual 3	Cond 3	Year 2000	Eff Age 20		
Valuation Summary		Modifier Total	RCN	Depr (59% Phys/ % Func)		RCNLD
Base Cost (6.36 x 600)		3,816		3,816	2,251	1,565



Rogers

Assessment Property Record Card for Tax Year 2026

Data provided by LISA DELOZIER County Assessor

Date 04/17/2026
Time 03:10:21
Page 5

Agland Inventory

660003340

Soi	Description	Land Use	LPI	Adj Type	Adj Code	Acres	Use/Acre	Mkt/Acre	Use Value	Market Value
HC	HECTOR STONY SANDY LOAM	TMBR	20			92.936	36	36	3,346	3,346
HLC	HECTOR-LINKER FINE SANDY	TMBR	35			8.527	63	63	537	537
LKB	LINKER FINE SANDY LOAM 1-	NTV PST	63			33.432	151	151	5,055	5,055
LKC	LINKER FINE SANDY LOAM 3-	TMBR	51			15.569	92	92	1,429	1,429
VF	VERDIGRIS SOILS FREQUENTL	TMBR	47			18.817	85	85	1,592	1,592
TMBR Totals						169.280			11,959	11,959
Total Agland						169.280			11,959	11,959