



# Rogers

## Assessment Property Record Card for Tax Year 2026

Data provided by LISA DELOZIER County Assessor

Date 04/17/2026  
 Time 14:22:26  
 Page 1

Assessment Data					Primary Image																																																																																																																				
<b>Account</b> 660003396 <b>Parcel ID</b> 24N17E-04-4-00000-000-0000 <b>Cadastral ID</b> 04-24-17-02000 <b>Property Type</b> REAL - Real Property <b>Property Class</b> RR VI Area 2 <b>Tax Area</b> 14 - CHELSEA RURAL <b>Name ID</b> 274505 TAYLOR, INGER M  1904 S HWY 28 CHELSEA OK 74016-0000  <b>Parcel Location</b> <b>Situs</b> 01904 S HWY 28 <b>Subdivision</b> <b>Lot/Block</b> / <b>Parcel Size</b> 10 - Acres <b>Sec/Twn/Rng</b> 4 / 24 / 17 / 4 <b>Neighborhood</b> 4050 - CHELSEA FOYIL RURAL <b>School District</b> S003 - CHELSEA SCHOOLS																																																																																																																									
<b>Legal Description</b> Lat/Long: 36.58365232 -95.49074291																																																																																																																									
SE SE SE					<b>Building Permits</b> <table border="1"> <thead> <tr> <th>Number</th> <th>Description</th> <th>Opened</th> <th>Closed</th> <th>Amount</th> </tr> </thead> <tbody> <tr> <td colspan="5" style="height: 100px;"> </td> </tr> </tbody> </table>					Number	Description	Opened	Closed	Amount																																																																																																											
Number	Description	Opened	Closed	Amount																																																																																																																					
<b>Exemptions</b> <table border="1"> <thead> <tr> <th>Code</th> <th>Type</th> <th>Active</th> <th>Maximum</th> <th>Exemption</th> </tr> </thead> <tbody> <tr> <td>H</td> <td>Homestead</td> <td>Yes</td> <td>1,000</td> <td>1,000</td> </tr> </tbody> </table>					Code	Type	Active	Maximum	Exemption	H	Homestead	Yes	1,000	1,000	<b>Sale History</b> <table border="1"> <thead> <tr> <th>Bk/Pg</th> <th>Grantor</th> <th>Date</th> <th>Price</th> <th>Code</th> </tr> </thead> <tbody> <tr> <td>1233/354</td> <td>CRUSSELL, BILLY RAY</td> <td>06/16/2000</td> <td>63,000</td> <td>Yes</td> </tr> </tbody> </table>					Bk/Pg	Grantor	Date	Price	Code	1233/354	CRUSSELL, BILLY RAY	06/16/2000	63,000	Yes																																																																																												
Code	Type	Active	Maximum	Exemption																																																																																																																					
H	Homestead	Yes	1,000	1,000																																																																																																																					
Bk/Pg	Grantor	Date	Price	Code																																																																																																																					
1233/354	CRUSSELL, BILLY RAY	06/16/2000	63,000	Yes																																																																																																																					
<b>Parcel Valuation</b> <table border="1"> <thead> <tr> <th>Source</th> <th>REAL</th> <th>Fair Cash</th> <th>Capped</th> <th>Asmnt Level</th> <th>Assessed</th> <th>Levy Rate</th> <th>82.750</th> <th>Current Tax</th> </tr> </thead> <tbody> <tr> <td>Remove Cap</td> <td>2001</td> <td>Land Value 115,152</td> <td>71,799</td> <td>11%</td> <td>7,898</td> <td>Assessed</td> <td>11,297</td> <td>934.83</td> </tr> <tr> <td>Year Frozen</td> <td>0</td> <td>Improvements 49,957</td> <td>30,898</td> <td></td> <td>3,399</td> <td>Penalty</td> <td>0</td> <td></td> </tr> <tr> <td>Uncapped Value</td> <td>0</td> <td>Mobile Home 0</td> <td>0</td> <td></td> <td>0</td> <td>Exemption</td> <td>1,000</td> <td>-83.00</td> </tr> <tr> <td>TIF Project ID</td> <td>0</td> <td>Total Value 165,109</td> <td>102,697</td> <td></td> <td>11,297</td> <td>Total Taxable</td> <td>10,297</td> <td>852.00</td> </tr> </tbody> </table>										Source	REAL	Fair Cash	Capped	Asmnt Level	Assessed	Levy Rate	82.750	Current Tax	Remove Cap	2001	Land Value 115,152	71,799	11%	7,898	Assessed	11,297	934.83	Year Frozen	0	Improvements 49,957	30,898		3,399	Penalty	0		Uncapped Value	0	Mobile Home 0	0		0	Exemption	1,000	-83.00	TIF Project ID	0	Total Value 165,109	102,697		11,297	Total Taxable	10,297	852.00																																																																			
Source	REAL	Fair Cash	Capped	Asmnt Level	Assessed	Levy Rate	82.750	Current Tax																																																																																																																	
Remove Cap	2001	Land Value 115,152	71,799	11%	7,898	Assessed	11,297	934.83																																																																																																																	
Year Frozen	0	Improvements 49,957	30,898		3,399	Penalty	0																																																																																																																		
Uncapped Value	0	Mobile Home 0	0		0	Exemption	1,000	-83.00																																																																																																																	
TIF Project ID	0	Total Value 165,109	102,697		11,297	Total Taxable	10,297	852.00																																																																																																																	
<b>Assessment History</b> <table border="1"> <thead> <tr> <th>Tax Year</th> <th>Statement Number</th> <th>Billed Owner</th> <th>Tax Area</th> <th>Total Value</th> <th>Exemptions</th> <th>Taxable Value</th> <th>Billed Tax</th> </tr> </thead> <tbody> <tr><td>2025</td><td>2025-660003396</td><td>TAYLOR, INGER M</td><td>14</td><td>200,863</td><td>0</td><td>10,968</td><td>908.00</td></tr> <tr><td>2024</td><td>2024-660003396</td><td>TAYLOR, INGER M</td><td>14</td><td>200,235</td><td>0</td><td>10,445</td><td>882.00</td></tr> <tr><td>2023</td><td>2023-660003396</td><td>TAYLOR, INGER M</td><td>14</td><td>90,438</td><td>0</td><td>9,948</td><td>848.00</td></tr> <tr><td>2022</td><td>2022-660003396</td><td>TAYLOR, INGER M</td><td>14</td><td>93,986</td><td>0</td><td>10,339</td><td>875.00</td></tr> <tr><td>2021</td><td>2021-660003396</td><td>TAYLOR, INGER M</td><td>14</td><td>97,182</td><td>0</td><td>10,522</td><td>892.00</td></tr> <tr><td>2020</td><td>2020-660003396</td><td>TAYLOR, INGER M</td><td>14</td><td>91,092</td><td>0</td><td>10,021</td><td>850.00</td></tr> <tr><td>2019</td><td>2019-660003396</td><td>TAYLOR, INGER M</td><td>14</td><td>86,962</td><td>0</td><td>9,566</td><td>822.00</td></tr> <tr><td>2018</td><td>2018-660003396</td><td>TAYLOR, INGER M</td><td>14</td><td>96,525</td><td>0</td><td>10,618</td><td>907.00</td></tr> <tr><td>2017</td><td>2017-660003396</td><td>TAYLOR, INGER M</td><td>14</td><td>95,286</td><td>0</td><td>10,482</td><td>899.00</td></tr> <tr><td>2016</td><td>2016-660003396</td><td>TAYLOR, INGER M</td><td>14</td><td>72,530</td><td>0</td><td>7,979</td><td>695.00</td></tr> <tr><td>2015</td><td>2015-660003396</td><td>TAYLOR, INGER M</td><td>14</td><td>71,416</td><td>0</td><td>7,856</td><td>677.00</td></tr> <tr><td>2014</td><td>2014-660003396</td><td>TAYLOR, INGER M</td><td>14</td><td>68,919</td><td>0</td><td>7,581</td><td>675.00</td></tr> <tr><td>2013</td><td>2013-660003396</td><td>TAYLOR, INGER M</td><td>14</td><td>70,704</td><td>0</td><td>7,396</td><td>656.00</td></tr> </tbody> </table>										Tax Year	Statement Number	Billed Owner	Tax Area	Total Value	Exemptions	Taxable Value	Billed Tax	2025	2025-660003396	TAYLOR, INGER M	14	200,863	0	10,968	908.00	2024	2024-660003396	TAYLOR, INGER M	14	200,235	0	10,445	882.00	2023	2023-660003396	TAYLOR, INGER M	14	90,438	0	9,948	848.00	2022	2022-660003396	TAYLOR, INGER M	14	93,986	0	10,339	875.00	2021	2021-660003396	TAYLOR, INGER M	14	97,182	0	10,522	892.00	2020	2020-660003396	TAYLOR, INGER M	14	91,092	0	10,021	850.00	2019	2019-660003396	TAYLOR, INGER M	14	86,962	0	9,566	822.00	2018	2018-660003396	TAYLOR, INGER M	14	96,525	0	10,618	907.00	2017	2017-660003396	TAYLOR, INGER M	14	95,286	0	10,482	899.00	2016	2016-660003396	TAYLOR, INGER M	14	72,530	0	7,979	695.00	2015	2015-660003396	TAYLOR, INGER M	14	71,416	0	7,856	677.00	2014	2014-660003396	TAYLOR, INGER M	14	68,919	0	7,581	675.00	2013	2013-660003396	TAYLOR, INGER M	14	70,704	0	7,396	656.00
Tax Year	Statement Number	Billed Owner	Tax Area	Total Value	Exemptions	Taxable Value	Billed Tax																																																																																																																		
2025	2025-660003396	TAYLOR, INGER M	14	200,863	0	10,968	908.00																																																																																																																		
2024	2024-660003396	TAYLOR, INGER M	14	200,235	0	10,445	882.00																																																																																																																		
2023	2023-660003396	TAYLOR, INGER M	14	90,438	0	9,948	848.00																																																																																																																		
2022	2022-660003396	TAYLOR, INGER M	14	93,986	0	10,339	875.00																																																																																																																		
2021	2021-660003396	TAYLOR, INGER M	14	97,182	0	10,522	892.00																																																																																																																		
2020	2020-660003396	TAYLOR, INGER M	14	91,092	0	10,021	850.00																																																																																																																		
2019	2019-660003396	TAYLOR, INGER M	14	86,962	0	9,566	822.00																																																																																																																		
2018	2018-660003396	TAYLOR, INGER M	14	96,525	0	10,618	907.00																																																																																																																		
2017	2017-660003396	TAYLOR, INGER M	14	95,286	0	10,482	899.00																																																																																																																		
2016	2016-660003396	TAYLOR, INGER M	14	72,530	0	7,979	695.00																																																																																																																		
2015	2015-660003396	TAYLOR, INGER M	14	71,416	0	7,856	677.00																																																																																																																		
2014	2014-660003396	TAYLOR, INGER M	14	68,919	0	7,581	675.00																																																																																																																		
2013	2013-660003396	TAYLOR, INGER M	14	70,704	0	7,396	656.00																																																																																																																		



# Rogers

## Assessment Property Record Card for Tax Year 2026

Data provided by LISA DELOZIER County Assessor

Date 04/17/2026  
 Time 14:22:26  
 Page 2

Lot Data		Square-Foot - NBHD 4050 #1	
Lot Size			
Lot Count			
Units Buildable	10		
Non-Ag Acres	0		
Topography			
Street Access			
Utilities			
Amenities	LAND QUALITY		0
			0
Method	Square-Foot		
Base Lot Value	438,700.00 x .26 = 115,152		
Factor Value			
Adjustments	1.0000		
Lot Value	115,152		

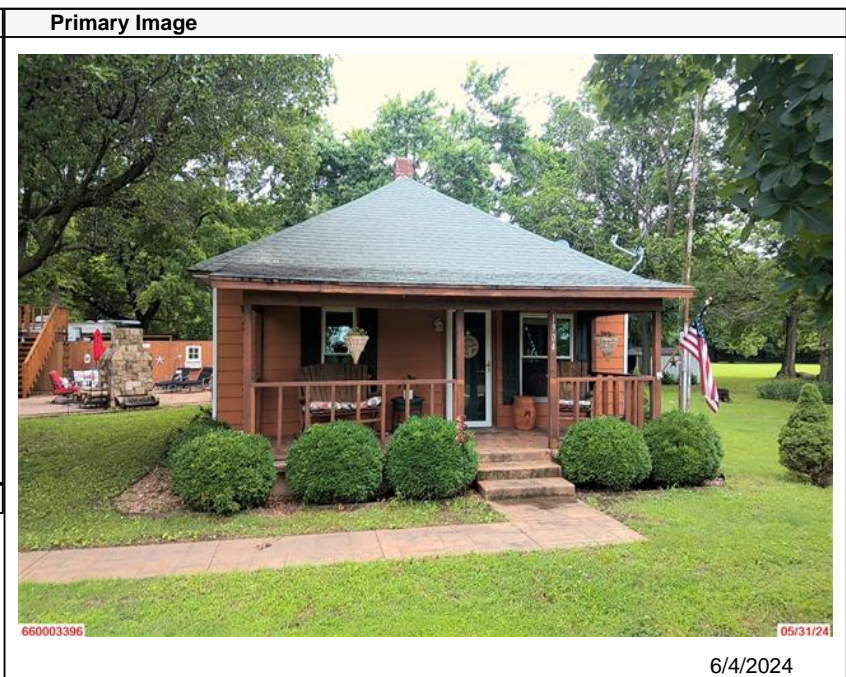

6/4/2024

Residential Data	
Type	1 Single Family Residence
Condition	3 - Average
Quality	2 - Fair
Architecture	
Style	100% One Story
Exterior Wall	100% Frame, Siding, Metal
Base/Total Area	936 / 936
Style	100% One Story
HVAC	100% Wall Furnace
Roof Cover	1 Composition Shingle
Area on Slab	0
Fixture/RghIn	4 /
Bed/F/H Bath	2 / 1.0 /
Basement Area	
Garage Type	
Remodel	RMA -
Year/Eff Age	1920 / 80

GRM Approach	
GRM Code	
Gross Rent	0.00
Indicated Value	

Multiple Regression			
MRA Code	1	Test	
Adjusted R	0.8445		
Indicated Value	54,308	58.02	Per SqFt

Direct Comparables	
Selection Model	1 Res
Adjustment Model	A2 AO Test
Comparables	
Indicated Value	

Cost Approach		Manual : 01/2025	
Base Cost	97.61	Total Misc Impr	+ 11,855
Roofing Adj	+ 4.39	Garage Cost	+
Subfloor Adj	+ 2.58	Total RCN	= 115,339
Heat/Cool Adj	+ 0.74	Depreciation ( 80%)	- 92,271
Plumbing Adj	+ 5.24	Lump Sums	+ 0
Basement Adj	+ 0.00	RCNLD	= 23,068
Adj Base Cost	= 110.56	Lot Value	+ 115,152
Total Area	x 936	Indicated Value	= 138,220
Adjusted Cost	= 103,484	Value Per SqFt	147.67

Value Reconciliation			
Selected Approach	Cost Approach		
Improvements	23,068		
Lot Value	115,152		
Indicated Value	138,220	147.67	Per SqFt
Agland Value			
Site Improvements	26,889		
Total Value	165,109	176.40	Total Value Per SqFt

Miscellaneous Improvements								
Code	Description	Sketch ID	Size	Year	Units	Unit Cost	Depr	Value
SHLT	STORM SHELTER	0		1	2012	1	0.00	
PRCH	SLAB PORCH - COVERED	8450	20x6			120	20.50	2,460
EPKS	ENCLOSED PORCH - KNEEWALL SCREEN	8451	220			220	22.32	4,910
FPR1	Fireplace - Residential 1 Story			1		1	4,485.02	4,485



# Rogers

## Assessment Property Record Card for Tax Year 2026

Data provided by LISA DELOZIER County Assessor

Date 04/17/2026

Time 14:22:26

Page 3

### Sketch Image

660003396

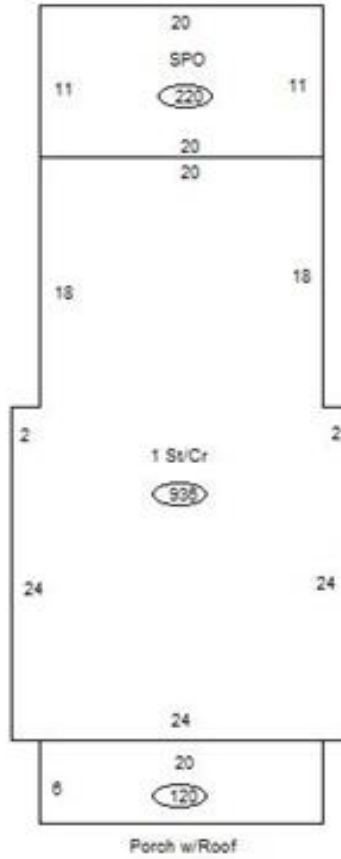

### Sketch Vector Information

Sequence	Code	Type	Built Over	Scale	Section Label	Base Area	Multiplier	Total Area
1	R	1	Crawl	13	1 St/Cr	936	1.000	936
2	M	PRCH		13	SLBC	120	1.000	120
3	M	EPKS		13	Screen Porch	220	1.000	220
<b>Total Building Area</b>						936		936



# Rogers

## Assessment Property Record Card for Tax Year 2026

Data provided by LISA DELOZIER County Assessor

Date 04/17/2026  
Time 14:22:26  
Page 4

660003396

### Outbuildings/Site Improvements

Building Image	Code	Description	Dimensions	Floor	Roofing	Total Units	
	PFS	PORTABLE FRAME STRUCTURE	20x32x0			640	
	Qual	2	Cond 3	Year 2016	Eff Age 8		
	<b>Valuation Summary</b>		<b>Modifier Total</b>		<b>RCN</b>	<b>Depr (33% Phys/ % Func)</b>	<b>RCNLD</b>
		Base Cost (28.20 x 640)	18,048		18,048	5,956	12,092
	PFS	PORTABLE FRAME STRUCTURE	16x22x0			352	
	Qual	1	Cond 3	Year 2016	Eff Age 8		
	<b>Valuation Summary</b>		<b>Modifier Total</b>		<b>RCN</b>	<b>Depr (33% Phys/ % Func)</b>	<b>RCNLD</b>
		Base Cost (25.00 x 352)	8,800		8,800	2,904	5,896
	SHDS	Shed - Small	0x0x0		Base	432	
	Qual	3	Cond 3	Year	Eff Age		
	<b>Valuation Summary</b>		<b>Modifier Total</b>		<b>RCN</b>	<b>Depr (60% Phys/ % Func)</b>	<b>RCNLD</b>
		Base Cost (19.87 x 432)	8,584		8,584	5,150	3,434
	CPDT	CARPORT - DETACHED	0x0x0			720	
	Qual	3	Cond 3	Year	Eff Age 1520		
	<b>Valuation Summary</b>		<b>Modifier Total</b>		<b>RCN</b>	<b>Depr (50% Phys/ % Func)</b>	<b>RCNLD</b>
		Base Cost (10.33 x 720)	7,438		7,438	3,719	3,719
	SHDS	Shed - Small	0x0x0		Base		
	Qual	3	Cond	Year	Eff Age		
	<b>Valuation Summary</b>		<b>Modifier Total</b>		<b>RCN</b>	<b>Depr (100% Phys/ % Func)</b>	<b>RCNLD</b>
		Base Cost (39.31 x )					
	SHDS	Shed - Small	0x0x0		Base		
	Qual	3	Cond	Year	Eff Age		
	<b>Valuation Summary</b>		<b>Modifier Total</b>		<b>RCN</b>	<b>Depr (100% Phys/ % Func)</b>	<b>RCNLD</b>
		Base Cost (39.31 x )					
	WODO	WOOD DECK - OPEN	6x14x0			84	
	Qual	2	Cond 3	Year	Eff Age 1520		
	<b>Valuation Summary</b>		<b>Modifier Total</b>		<b>RCN</b>	<b>Depr (80% Phys/ % Func)</b>	<b>RCNLD</b>
		Base Cost (24.89 x 84)	2,091		2,091	1,673	418



# Rogers



## Assessment Property Record Card for Tax Year 2026

Data provided by LISA DELOZIER County Assessor

Date 04/17/2026  
Time 14:22:26  
Page 5

660003396

### Outbuildings/Site Improvements

Building Image	Code	Description	Dimensions	Floor	Roofing	Total Units	
	WODC	WOOD DECK - COVERED	6x14x0			84	
	Qual 2	Cond 3	Year	Eff Age	1520		
	<b>Valuation Summary</b>		<b>Modifier Total</b>	<b>RCN</b>	<b>Depr (80% Phys/ % Func)</b>	<b>RCNLD</b>	
	Base Cost (39.61 x 84)		3,327		3,327	2,662	665
	WODC	WOOD DECK - COVERED	6x14x0			84	
	Qual 2	Cond 3	Year	Eff Age	1520		
	<b>Valuation Summary</b>		<b>Modifier Total</b>	<b>RCN</b>	<b>Depr (80% Phys/ % Func)</b>	<b>RCNLD</b>	
	Base Cost (39.61 x 84)		3,327		3,327	2,662	665