



Rogers

Assessment Property Record Card for Tax Year 2026

Data provided by LISA DELOZIER County Assessor

Date 04/17/2026
 Time 05:18:59
 Page 1

Assessment Data					Primary Image																																																																																																																				
Account 660003424 Parcel ID 24N18E-04-3-00000-000-0000 Cadastral ID 04-24-18-00300 Property Type REAL - Real Property Property Class RA VI Area 2 Tax Area 14 - CHELSEA RURAL Name ID 349467 MORGAN, GERALD & LAURI REVOCABLE TRUST 1851 S 4270 RD CHELSEA OK 74016-0000 Parcel Location Situs 01851 S 4270 RD Subdivision Lot/Block / Parcel Size 20.37 - Acres Sec/Twn/Rng 4 / 24 / 18 / 3 Neighborhood 4050 - CHELSEA FOYIL RURAL School District S003 - CHELSEA SCHOOLS																																																																																																																									
Legal Description Lat/Long: 36.58434056 -95.39911231																																																																																																																									
Legal Description TR IN SW SW, DESC; BEG NW/C SW E 413.62', S 22-20 E 492.80', S 32 01 E 244.09', S 16-19 E 489.71', S 32-38 W 160.23', S 73-21 W 182.15' TO S/L SW SW W ALG S/L 600' TO SW/C SW SW, N 1320' TO POB					Building Permits <table border="1"> <thead> <tr> <th>Number</th> <th>Description</th> <th>Opened</th> <th>Closed</th> <th>Amount</th> </tr> </thead> <tbody> <tr> <td> </td> <td> </td> <td> </td> <td> </td> <td> </td> </tr> </tbody> </table>					Number	Description	Opened	Closed	Amount																																																																																																											
Number	Description	Opened	Closed	Amount																																																																																																																					
Exemptions <table border="1"> <thead> <tr> <th>Code</th> <th>Type</th> <th>Active</th> <th>Maximum</th> <th>Exemption</th> </tr> </thead> <tbody> <tr> <td>H</td> <td>Homestead</td> <td>Yes</td> <td>1,000</td> <td>1,000</td> </tr> </tbody> </table>					Code	Type	Active	Maximum	Exemption	H	Homestead	Yes	1,000	1,000	Sale History <table border="1"> <thead> <tr> <th>Bk/Pg</th> <th>Grantor</th> <th>Date</th> <th>Price</th> <th>Code</th> </tr> </thead> <tbody> <tr> <td>/</td> <td>MORGAN, GERALD L &</td> <td>02/16/2026</td> <td> </td> <td>WB</td> </tr> </tbody> </table>					Bk/Pg	Grantor	Date	Price	Code	/	MORGAN, GERALD L &	02/16/2026		WB																																																																																												
Code	Type	Active	Maximum	Exemption																																																																																																																					
H	Homestead	Yes	1,000	1,000																																																																																																																					
Bk/Pg	Grantor	Date	Price	Code																																																																																																																					
/	MORGAN, GERALD L &	02/16/2026		WB																																																																																																																					
Parcel Valuation <table border="1"> <thead> <tr> <th>Source</th> <th>REAL</th> <th>Fair Cash</th> <th>Capped</th> <th>Asmnt Level</th> <th>Assessed</th> <th>Levy Rate</th> <th>82.750</th> <th>Current Tax</th> </tr> </thead> <tbody> <tr> <td>Remove Cap</td> <td>0</td> <td>Land Value 3,098</td> <td>3,098</td> <td>11%</td> <td>341</td> <td>Assessed</td> <td>7,902</td> <td>653.89</td> </tr> <tr> <td>Year Frozen</td> <td>0</td> <td>Improvements 86,691</td> <td>68,735</td> <td> </td> <td>7,561</td> <td>Penalty</td> <td>0</td> <td> </td> </tr> <tr> <td>Uncapped Value</td> <td>0</td> <td>Mobile Home 0</td> <td>0</td> <td> </td> <td>0</td> <td>Exemption</td> <td>1,000</td> <td>-83.00</td> </tr> <tr> <td>TIF Project ID</td> <td>0</td> <td>Total Value 89,789</td> <td>71,833</td> <td> </td> <td>7,902</td> <td>Total Taxable</td> <td>6,902</td> <td>571.00</td> </tr> </tbody> </table>										Source	REAL	Fair Cash	Capped	Asmnt Level	Assessed	Levy Rate	82.750	Current Tax	Remove Cap	0	Land Value 3,098	3,098	11%	341	Assessed	7,902	653.89	Year Frozen	0	Improvements 86,691	68,735		7,561	Penalty	0		Uncapped Value	0	Mobile Home 0	0		0	Exemption	1,000	-83.00	TIF Project ID	0	Total Value 89,789	71,833		7,902	Total Taxable	6,902	571.00																																																																			
Source	REAL	Fair Cash	Capped	Asmnt Level	Assessed	Levy Rate	82.750	Current Tax																																																																																																																	
Remove Cap	0	Land Value 3,098	3,098	11%	341	Assessed	7,902	653.89																																																																																																																	
Year Frozen	0	Improvements 86,691	68,735		7,561	Penalty	0																																																																																																																		
Uncapped Value	0	Mobile Home 0	0		0	Exemption	1,000	-83.00																																																																																																																	
TIF Project ID	0	Total Value 89,789	71,833		7,902	Total Taxable	6,902	571.00																																																																																																																	
Assessment History <table border="1"> <thead> <tr> <th>Tax Year</th> <th>Statement Number</th> <th>Billed Owner</th> <th>Tax Area</th> <th>Total Value</th> <th>Exemptions</th> <th>Taxable Value</th> <th>Billed Tax</th> </tr> </thead> <tbody> <tr><td>2025</td><td>2025-660003424</td><td>MORGAN, GERALD L &</td><td>14</td><td>88,140</td><td>1000</td><td>6,671</td><td>552.00</td></tr> <tr><td>2024</td><td>2024-660003424</td><td>MORGAN, GERALD L &</td><td>14</td><td>92,582</td><td>1000</td><td>6,449</td><td>544.00</td></tr> <tr><td>2023</td><td>2023-660003424</td><td>MORGAN, GERALD L &</td><td>14</td><td>79,693</td><td>1000</td><td>6,231</td><td>531.00</td></tr> <tr><td>2022</td><td>2022-660003424</td><td>MORGAN, GERALD L &</td><td>14</td><td>79,709</td><td>1000</td><td>6,021</td><td>509.00</td></tr> <tr><td>2021</td><td>2021-660003424</td><td>MORGAN, GERALD L &</td><td>14</td><td>76,076</td><td>1000</td><td>5,816</td><td>493.00</td></tr> <tr><td>2020</td><td>2020-660003424</td><td>MORGAN, GERALD L &</td><td>14</td><td>76,965</td><td>1000</td><td>5,618</td><td>476.00</td></tr> <tr><td>2019</td><td>2019-660003424</td><td>MORGAN, GERALD L &</td><td>14</td><td>74,028</td><td>1000</td><td>5,425</td><td>466.00</td></tr> <tr><td>2018</td><td>2018-660003424</td><td>MORGAN, GERALD L &</td><td>14</td><td>80,644</td><td>1000</td><td>5,238</td><td>447.00</td></tr> <tr><td>2017</td><td>2017-660003424</td><td>MORGAN, GERALD L &</td><td>14</td><td>79,608</td><td>1000</td><td>5,057</td><td>434.00</td></tr> <tr><td>2016</td><td>2016-660003424</td><td>MORGAN, GERALD L &</td><td>14</td><td>77,528</td><td>1000</td><td>4,880</td><td>425.00</td></tr> <tr><td>2015</td><td>2015-660003424</td><td>MORGAN, GERALD L &</td><td>14</td><td>75,723</td><td>1000</td><td>4,709</td><td>406.00</td></tr> <tr><td>2014</td><td>2014-660003424</td><td>MORGAN, GERALD L &</td><td>14</td><td>78,600</td><td>1000</td><td>4,543</td><td>405.00</td></tr> <tr><td>2013</td><td>2013-660003424</td><td>MORGAN, GERALD L &</td><td>14</td><td>75,203</td><td>1000</td><td>4,382</td><td>389.00</td></tr> </tbody> </table>										Tax Year	Statement Number	Billed Owner	Tax Area	Total Value	Exemptions	Taxable Value	Billed Tax	2025	2025-660003424	MORGAN, GERALD L &	14	88,140	1000	6,671	552.00	2024	2024-660003424	MORGAN, GERALD L &	14	92,582	1000	6,449	544.00	2023	2023-660003424	MORGAN, GERALD L &	14	79,693	1000	6,231	531.00	2022	2022-660003424	MORGAN, GERALD L &	14	79,709	1000	6,021	509.00	2021	2021-660003424	MORGAN, GERALD L &	14	76,076	1000	5,816	493.00	2020	2020-660003424	MORGAN, GERALD L &	14	76,965	1000	5,618	476.00	2019	2019-660003424	MORGAN, GERALD L &	14	74,028	1000	5,425	466.00	2018	2018-660003424	MORGAN, GERALD L &	14	80,644	1000	5,238	447.00	2017	2017-660003424	MORGAN, GERALD L &	14	79,608	1000	5,057	434.00	2016	2016-660003424	MORGAN, GERALD L &	14	77,528	1000	4,880	425.00	2015	2015-660003424	MORGAN, GERALD L &	14	75,723	1000	4,709	406.00	2014	2014-660003424	MORGAN, GERALD L &	14	78,600	1000	4,543	405.00	2013	2013-660003424	MORGAN, GERALD L &	14	75,203	1000	4,382	389.00
Tax Year	Statement Number	Billed Owner	Tax Area	Total Value	Exemptions	Taxable Value	Billed Tax																																																																																																																		
2025	2025-660003424	MORGAN, GERALD L &	14	88,140	1000	6,671	552.00																																																																																																																		
2024	2024-660003424	MORGAN, GERALD L &	14	92,582	1000	6,449	544.00																																																																																																																		
2023	2023-660003424	MORGAN, GERALD L &	14	79,693	1000	6,231	531.00																																																																																																																		
2022	2022-660003424	MORGAN, GERALD L &	14	79,709	1000	6,021	509.00																																																																																																																		
2021	2021-660003424	MORGAN, GERALD L &	14	76,076	1000	5,816	493.00																																																																																																																		
2020	2020-660003424	MORGAN, GERALD L &	14	76,965	1000	5,618	476.00																																																																																																																		
2019	2019-660003424	MORGAN, GERALD L &	14	74,028	1000	5,425	466.00																																																																																																																		
2018	2018-660003424	MORGAN, GERALD L &	14	80,644	1000	5,238	447.00																																																																																																																		
2017	2017-660003424	MORGAN, GERALD L &	14	79,608	1000	5,057	434.00																																																																																																																		
2016	2016-660003424	MORGAN, GERALD L &	14	77,528	1000	4,880	425.00																																																																																																																		
2015	2015-660003424	MORGAN, GERALD L &	14	75,723	1000	4,709	406.00																																																																																																																		
2014	2014-660003424	MORGAN, GERALD L &	14	78,600	1000	4,543	405.00																																																																																																																		
2013	2013-660003424	MORGAN, GERALD L &	14	75,203	1000	4,382	389.00																																																																																																																		



Rogers

Assessment Property Record Card for Tax Year 2026

Data provided by LISA DELOZIER County Assessor

Date 04/17/2026
 Time 05:18:59
 Page 2

Lot Data - CHELSEA FOYIL RURAL (UNITS BUILDABLE)	
Lot Size	
Lot Count	
Units Buildable	
Non-Ag Acres	0
Topography	
Street Access	
Utilities	
Amenities	LAND QUALITY
Method	Units-Buildable
Base Lot Value	
Factor Value	
Adjustments	
Lot Value	



\\tsclient\TLOGAN\LOGAN RESIDENTIAL VI\2024-1-4\IMG_0003 1/4/2024

Residential Data	
Type	1 Single Family Residence
Condition	3 - Average
Quality	2 - Fair
Architecture	
Style	100% One Story
Exterior Wall	100% Frame, Siding, Vinyl
Base/Total Area	1,560 / 1,560
Style	100% One Story
HVAC	100% Floor Furnace
Roof Cover	1 Composition Shingle
Area on Slab	0
Fixture/RghIn	7 /
Bed/F/H Bath	3 / 1.5 /
Basement Area	
Garage Type	480 Attached Garage - Unfinished
Remodel	
Year/Eff Age	1960 / 50

GRM Approach

GRM Code	
Gross Rent	0.00
Indicated Value	

Multiple Regression

MRA Code	
Adjusted R	
Indicated Value	

Direct Comparables

Selection Model	1 Res
Adjustment Model	A2 AO Test
Comparables	
Indicated Value	

Cost Approach Manual : 01/2025

Base Cost	84.90	Total Misc Impr	+	321
Roofing Adj	+ 3.86	Garage Cost	+	11,059
Subfloor Adj	+ 2.26	Total RCN	=	164,010
Heat/Cool Adj	+ 1.62	Depreciation (59%)	-	96,766
Plumbing Adj	+ 5.20	Lump Sums	+	0
Basement Adj	+ 0.00	RCNLD	=	67,244
Adj Base Cost	= 97.84	Lot Value	+	
Total Area	x 1,560	Indicated Value	=	67,244
Adjusted Cost	= 152,630	Value Per SqFt		43.11

Value Reconciliation

Selected Approach	Cost Approach		
Improvements	67,244		
Lot Value			
Indicated Value	67,244	43.11	Per SqFt
Agland Value	3,098		
Site Improvements	19,447		
Total Value	89,789	57.56	Total Value Per SqFt

Miscellaneous Improvements

Code	Description	Sketch ID	Size	Year	Units	Unit Cost	Depr	Value
PATO	SLAB PORCH - OPEN	8463	8x4		32	10.04		321



Rogers

Assessment Property Record Card for Tax Year 2026

Data provided by LISA DELOZIER County Assessor

Date 04/17/2026

Time 05:18:59

Page 3

Sketch Image

660003424

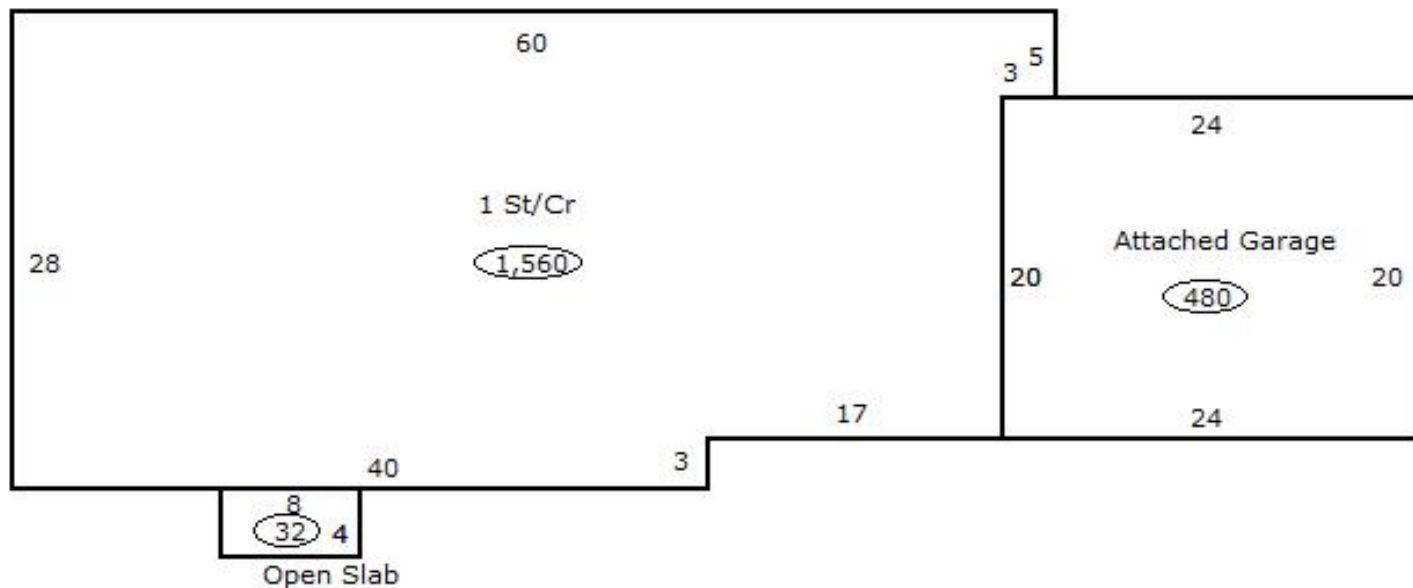

Sketch Vector Information

Sequence	Code	Type	Built Over	Scale	Section Label	Base Area	Multiplier	Total Area
1	R	1	Crawl	13	1 St/Cr	1,560	1.000	1,560
2	G	1		13	Attached Garage	480	1.000	480
3	M	PATO		13	Open Slab	32	1.000	32
Total Building Area						1,560		1,560



Rogers



Assessment Property Record Card for Tax Year 2026

Data provided by LISA DELOZIER County Assessor

Date 04/17/2026
 Time 05:19:00
 Page 4

660003424

Outbuildings/Site Improvements

Building Image	Code	Description	Dimensions	Floor	Roofing	Total Units	
	BARN	BARN	0x0x0			1,500	
	Qual	3	Cond 3	Year	Eff Age		
	Valuation Summary		Modifier Total	RCN	Depr (25% Phys/ % Func)	RCNLD	
		Base Cost (9.80 x 1,500)	14,700		14,700	3,675	11,025
	BARN	BARN	30x30x0			900	
	Qual	3	Cond 3	Year	Eff Age 1520		
	Valuation Summary		Modifier Total	RCN	Depr (25% Phys/ % Func)	RCNLD	
		Base Cost (12.32 x 900)	11,088		11,088	2,772	8,316
	LF	LOAFING SHED	10x10x0			100	
	Qual		Cond	Year	Eff Age		
				0			
			0				
			0				
Valuation Summary		Modifier Total	RCN	Depr (75% Phys/ % Func)	RCNLD		
		Base Cost (4.26 x 100)	426		426	320	106
	BARN	Barn-old barn	0x0x0				
	Qual		Cond	Year	Eff Age		
	Valuation Summary		Modifier Total	RCN	Depr (0% Phys/ % Func)	RCNLD	
		Base Cost (11.51 x)					



Rogers

Assessment Property Record Card for Tax Year 2026

Data provided by LISA DELOZIER County Assessor

Date 04/17/2026
Time 05:19:00
Page 5

Agland Inventory

660003424

Soi	Description	Land Use	LPI	Adj Type	Adj Code	Acres	Use/Acre	Mkt/Acre	Use Value	Market Value
HC	HECTOR STONY SANDY LOAM	TMBR	20		0	5.000	36	36	180	180
VD	VERDIGRIS SILT LOAM	TMBR	95		0	2.000	171	171	342	342
TMBR Totals						7.000			522	522
DBC	DENNIS-BATES COMPLEX 2-5%	IMP PST	60		0	10.000	168	168	1,680	1,680
VD	VERDIGRIS SILT LOAM	IMP PST	95		0	3.370	266	266	896	896
IMP PST Totals						13.370			2,576	2,576
Total Agland						20.370			3,098	3,098