



Rogers

Assessment Property Record Card for Tax Year 2026

Data provided by LISA DELOZIER County Assessor

Date 04/18/2026
 Time 05:56:20
 Page 1

Assessment Data					Primary Image																																																																																																																				
Account 660003481 Parcel ID 000000-00-0-50040-047-0014 Cadastral ID 05-19-17-02660 Property Type REAL - Real Property Property Class URP VI Area 3 Tax Area 19 - INOLA OT Name ID 349528 MARTIN, TERRY A 345 B ST NW INOLA OK 74036-0000 Parcel Location Situs 00345 B ST Subdivision GRANDVIEW Lot/Block 0014 / 0047 Parcel Size 1 - Lots Sec/Twn/Rng 5 / 19 / 17 / 5 Neighborhood 1205 - R-V03-SE INOLA School District S005 - INOLA SCHOOLS																																																																																																																									
Legal Description Lot/Long: 36.15436778 -95.51447749																																																																																																																									
Building Permits					<table border="1"> <thead> <tr> <th>Number</th> <th>Description</th> <th>Opened</th> <th>Closed</th> <th>Amount</th> </tr> </thead> <tbody> <tr> <td colspan="5"> </td> </tr> </tbody> </table>					Number	Description	Opened	Closed	Amount																																																																																																											
Number	Description	Opened	Closed	Amount																																																																																																																					
Exemptions					Sale History																																																																																																																				
<table border="1"> <thead> <tr> <th>Code</th> <th>Type</th> <th>Active</th> <th>Maximum</th> <th>Exemption</th> </tr> </thead> <tbody> <tr> <td colspan="5"> </td> </tr> </tbody> </table>					Code	Type	Active	Maximum	Exemption						<table border="1"> <thead> <tr> <th>Bk/Pg</th> <th>Grantor</th> <th>Date</th> <th>Price</th> <th>Code</th> </tr> </thead> <tbody> <tr> <td>/</td> <td>RANSOM, PETER H</td> <td>03/04/2026</td> <td>15,000</td> <td>YES</td> </tr> <tr> <td>2705/483</td> <td>RANSOM, PETER H &</td> <td>04/20/2018</td> <td>0</td> <td>WB</td> </tr> <tr> <td>2116/764</td> <td>MCCAW, ROSE ANN &</td> <td>07/26/2010</td> <td>0</td> <td>4</td> </tr> <tr> <td>1393/560</td> <td>VINSON, DENISA ROCHELLE</td> <td>07/24/2002</td> <td>50,000</td> <td>YES</td> </tr> <tr> <td>1119/379</td> <td>KOSKINEN, RICHARD L</td> <td>06/30/1998</td> <td>40,000</td> <td>No</td> </tr> <tr> <td>895/538</td> <td>FIREMAN'S FUND MORTGAGE-CORP</td> <td>09/29/1992</td> <td>28,000</td> <td>Yes</td> </tr> </tbody> </table>					Bk/Pg	Grantor	Date	Price	Code	/	RANSOM, PETER H	03/04/2026	15,000	YES	2705/483	RANSOM, PETER H &	04/20/2018	0	WB	2116/764	MCCAW, ROSE ANN &	07/26/2010	0	4	1393/560	VINSON, DENISA ROCHELLE	07/24/2002	50,000	YES	1119/379	KOSKINEN, RICHARD L	06/30/1998	40,000	No	895/538	FIREMAN'S FUND MORTGAGE-CORP	09/29/1992	28,000	Yes																																																																			
Code	Type	Active	Maximum	Exemption																																																																																																																					
Bk/Pg	Grantor	Date	Price	Code																																																																																																																					
/	RANSOM, PETER H	03/04/2026	15,000	YES																																																																																																																					
2705/483	RANSOM, PETER H &	04/20/2018	0	WB																																																																																																																					
2116/764	MCCAW, ROSE ANN &	07/26/2010	0	4																																																																																																																					
1393/560	VINSON, DENISA ROCHELLE	07/24/2002	50,000	YES																																																																																																																					
1119/379	KOSKINEN, RICHARD L	06/30/1998	40,000	No																																																																																																																					
895/538	FIREMAN'S FUND MORTGAGE-CORP	09/29/1992	28,000	Yes																																																																																																																					
Parcel Valuation																																																																																																																									
<table border="1"> <thead> <tr> <th>Source</th> <th>REAL</th> <th>Fair Cash</th> <th>Capped</th> <th>Asmnt Level</th> <th>Assessed</th> <th>Levy Rate</th> <th>80.060</th> <th>Current Tax</th> </tr> </thead> <tbody> <tr> <td>Remove Cap</td> <td>2027</td> <td>Land Value 24,677</td> <td>13,990</td> <td>11%</td> <td>1,539</td> <td>Assessed 5,745</td> <td></td> <td>459.94</td> </tr> <tr> <td>Year Frozen</td> <td>0</td> <td>Improvements 38,238</td> <td>38,238</td> <td></td> <td>4,206</td> <td>Penalty 0</td> <td></td> <td></td> </tr> <tr> <td>Uncapped Value</td> <td>0</td> <td>Mobile Home 0</td> <td>0</td> <td></td> <td>0</td> <td>Exemption 0</td> <td></td> <td>0.00</td> </tr> <tr> <td>TIF Project ID</td> <td>0</td> <td>Total Value 62,915</td> <td>52,228</td> <td></td> <td>5,745</td> <td>Total Taxable 5,745</td> <td></td> <td>460.00</td> </tr> </tbody> </table>		Source	REAL	Fair Cash	Capped	Asmnt Level	Assessed	Levy Rate	80.060	Current Tax	Remove Cap	2027	Land Value 24,677	13,990	11%	1,539	Assessed 5,745		459.94	Year Frozen	0	Improvements 38,238	38,238		4,206	Penalty 0			Uncapped Value	0	Mobile Home 0	0		0	Exemption 0		0.00	TIF Project ID	0	Total Value 62,915	52,228		5,745	Total Taxable 5,745		460.00																																																																											
Source	REAL	Fair Cash	Capped	Asmnt Level	Assessed	Levy Rate	80.060	Current Tax																																																																																																																	
Remove Cap	2027	Land Value 24,677	13,990	11%	1,539	Assessed 5,745		459.94																																																																																																																	
Year Frozen	0	Improvements 38,238	38,238		4,206	Penalty 0																																																																																																																			
Uncapped Value	0	Mobile Home 0	0		0	Exemption 0		0.00																																																																																																																	
TIF Project ID	0	Total Value 62,915	52,228		5,745	Total Taxable 5,745		460.00																																																																																																																	
Assessment History																																																																																																																									
<table border="1"> <thead> <tr> <th>Tax Year</th> <th>Statement Number</th> <th>Billed Owner</th> <th>Tax Area</th> <th>Total Value</th> <th>Exemptions</th> <th>Taxable Value</th> <th>Billed Tax</th> </tr> </thead> <tbody> <tr><td>2025</td><td>2025-660003481</td><td>RANSOM, PETER H</td><td>19</td><td>63,072</td><td>0</td><td>5,471</td><td>438.00</td></tr> <tr><td>2024</td><td>2024-660003481</td><td>RANSOM, PETER H</td><td>19</td><td>64,094</td><td>0</td><td>5,211</td><td>419.00</td></tr> <tr><td>2023</td><td>2023-660003481</td><td>RANSOM, PETER H</td><td>19</td><td>45,118</td><td>0</td><td>4,963</td><td>400.00</td></tr> <tr><td>2022</td><td>2022-660003481</td><td>RANSOM, PETER H</td><td>19</td><td>45,118</td><td>0</td><td>4,963</td><td>403.00</td></tr> <tr><td>2021</td><td>2021-660003481</td><td>RANSOM, PETER H</td><td>19</td><td>48,149</td><td>0</td><td>5,296</td><td>424.00</td></tr> <tr><td>2020</td><td>2020-660003481</td><td>RANSOM, PETER H</td><td>19</td><td>47,427</td><td>0</td><td>5,217</td><td>421.00</td></tr> <tr><td>2019</td><td>2019-660003481</td><td>RANSOM, PETER H</td><td>19</td><td>46,833</td><td>0</td><td>5,151</td><td>426.00</td></tr> <tr><td>2018</td><td>2018-660003481</td><td>RANSOM, PETER H</td><td>19</td><td>50,369</td><td>0</td><td>5,540</td><td>462.00</td></tr> <tr><td>2017</td><td>2017-660003481</td><td>RANSOM, ROSE ANN MCCAW &</td><td>19</td><td>49,988</td><td>0</td><td>5,498</td><td>463.00</td></tr> <tr><td>2016</td><td>2016-660003481</td><td>RANSOM, ROSE ANN MCCAW &</td><td>19</td><td>48,762</td><td>0</td><td>5,364</td><td>456.00</td></tr> <tr><td>2015</td><td>2015-660003481</td><td>RANSOM, ROSE ANN MCCAW &</td><td>19</td><td>47,907</td><td>0</td><td>5,270</td><td>457.00</td></tr> <tr><td>2014</td><td>2014-660003481</td><td>RANSOM, ROSE ANN MCCAW &</td><td>19</td><td>49,751</td><td>0</td><td>5,310</td><td>477.00</td></tr> <tr><td>2013</td><td>2013-660003481</td><td>RANSOM, ROSE ANN MCCAW &</td><td>19</td><td>47,689</td><td>0</td><td>5,058</td><td>426.00</td></tr> </tbody> </table>										Tax Year	Statement Number	Billed Owner	Tax Area	Total Value	Exemptions	Taxable Value	Billed Tax	2025	2025-660003481	RANSOM, PETER H	19	63,072	0	5,471	438.00	2024	2024-660003481	RANSOM, PETER H	19	64,094	0	5,211	419.00	2023	2023-660003481	RANSOM, PETER H	19	45,118	0	4,963	400.00	2022	2022-660003481	RANSOM, PETER H	19	45,118	0	4,963	403.00	2021	2021-660003481	RANSOM, PETER H	19	48,149	0	5,296	424.00	2020	2020-660003481	RANSOM, PETER H	19	47,427	0	5,217	421.00	2019	2019-660003481	RANSOM, PETER H	19	46,833	0	5,151	426.00	2018	2018-660003481	RANSOM, PETER H	19	50,369	0	5,540	462.00	2017	2017-660003481	RANSOM, ROSE ANN MCCAW &	19	49,988	0	5,498	463.00	2016	2016-660003481	RANSOM, ROSE ANN MCCAW &	19	48,762	0	5,364	456.00	2015	2015-660003481	RANSOM, ROSE ANN MCCAW &	19	47,907	0	5,270	457.00	2014	2014-660003481	RANSOM, ROSE ANN MCCAW &	19	49,751	0	5,310	477.00	2013	2013-660003481	RANSOM, ROSE ANN MCCAW &	19	47,689	0	5,058	426.00
Tax Year	Statement Number	Billed Owner	Tax Area	Total Value	Exemptions	Taxable Value	Billed Tax																																																																																																																		
2025	2025-660003481	RANSOM, PETER H	19	63,072	0	5,471	438.00																																																																																																																		
2024	2024-660003481	RANSOM, PETER H	19	64,094	0	5,211	419.00																																																																																																																		
2023	2023-660003481	RANSOM, PETER H	19	45,118	0	4,963	400.00																																																																																																																		
2022	2022-660003481	RANSOM, PETER H	19	45,118	0	4,963	403.00																																																																																																																		
2021	2021-660003481	RANSOM, PETER H	19	48,149	0	5,296	424.00																																																																																																																		
2020	2020-660003481	RANSOM, PETER H	19	47,427	0	5,217	421.00																																																																																																																		
2019	2019-660003481	RANSOM, PETER H	19	46,833	0	5,151	426.00																																																																																																																		
2018	2018-660003481	RANSOM, PETER H	19	50,369	0	5,540	462.00																																																																																																																		
2017	2017-660003481	RANSOM, ROSE ANN MCCAW &	19	49,988	0	5,498	463.00																																																																																																																		
2016	2016-660003481	RANSOM, ROSE ANN MCCAW &	19	48,762	0	5,364	456.00																																																																																																																		
2015	2015-660003481	RANSOM, ROSE ANN MCCAW &	19	47,907	0	5,270	457.00																																																																																																																		
2014	2014-660003481	RANSOM, ROSE ANN MCCAW &	19	49,751	0	5,310	477.00																																																																																																																		
2013	2013-660003481	RANSOM, ROSE ANN MCCAW &	19	47,689	0	5,058	426.00																																																																																																																		



Rogers

Assessment Property Record Card for Tax Year 2026

Data provided by LISA DELOZIER County Assessor

Date 04/18/2026
 Time 05:56:21
 Page 2

Lot Data		Square-Foot - NBHD 1205 #1		Primary Image				
Lot Size								
Lot Count								
Units Buildable	10500							
Non-Ag Acres	0.2411							
Topography								
Street Access								
Utilities								
Amenities	LAND QUALITY	0						
		0						
Method	Square-Foot							
Base Lot Value	10,501.00 x 2.35 = 24,677							
Factor Value								
Adjustments	1.0000							
Lot Value	24,677							
Residential Data				660003481_001.JPG 12/6/2025				
Type	1 Single Family Residence			GRM Approach				
Condition	2 - Fair			GRM Code				
Quality	2 - Fair			Gross Rent 0.00				
Architecture	TRAD TRADITIONAL			Indicated Value				
Style	100% One Story			Multiple Regression				
Exterior Wall	10% Veneer, Stone 90% Frame, Siding, Wood			MRA Code 1 Test				
Base/Total Area	1,040 / 1,040			Adusted R 0.8445				
Style	100% One Story			Indicated Value 64,532 62.05 Per SqFt				
HVAC	100% Forced Air Furnace			Direct Comparables				
Roof Cover	1 Composition Shingle			Selection Model A Adam Test				
Area on Slab	0			Adjustment Model 1 2022 Residential				
Fixture/RghIn	6 /			Comparables 8				
Bed/F/H Bath	3 / 1.0 /			Indicated Value 89,930 Per SqFt				
Basement Area				Value Reconciliation				
Garage Type				Selected Approach Cost Approach				
Remodel				Improvements 38,238				
Year/Eff Age	1965 / 61			Lot Value 24,677				
Cost Approach		Manual : 01/2025		Indicated Value 62,915 60.50 Per SqFt				
Base Cost	94.78	Total Misc Impr	+ 1,642	Agland Value				
Roofing Adj	+ 4.19	Garage Cost	+ 0	Site Improvements				
Subfloor Adj	+ 2.43	Total RCN	= 119,495	Total Value 62,915 60.50 Total Value Per SqFt				
Heat/Cool Adj	+ 5.00	Depreciation (68%)	- 81,257					
Plumbing Adj	+ 6.92	Lump Sums	+ 0					
Basement Adj	+ 0.00	RCNLD	= 38,238					
Adj Base Cost	= 113.32	Lot Value	+ 24,677					
Total Area	x 1,040	Indicated Value	= 62,915					
Adjusted Cost	= 117,853	Value Per SqFt	60.50					
Miscellaneous Improvements								
Code	Description	Sketch ID	Size	Year	Units	Unit Cost	Depr	Value
PRCH	SLAB PORCH - COVERED	8522	13x6		78	21.05		1,642



Rogers

Assessment Property Record Card for Tax Year 2026

Data provided by LISA DELOZIER County Assessor

Date 04/18/2026

Time 05:56:21

Page 3

Sketch Image

660003481

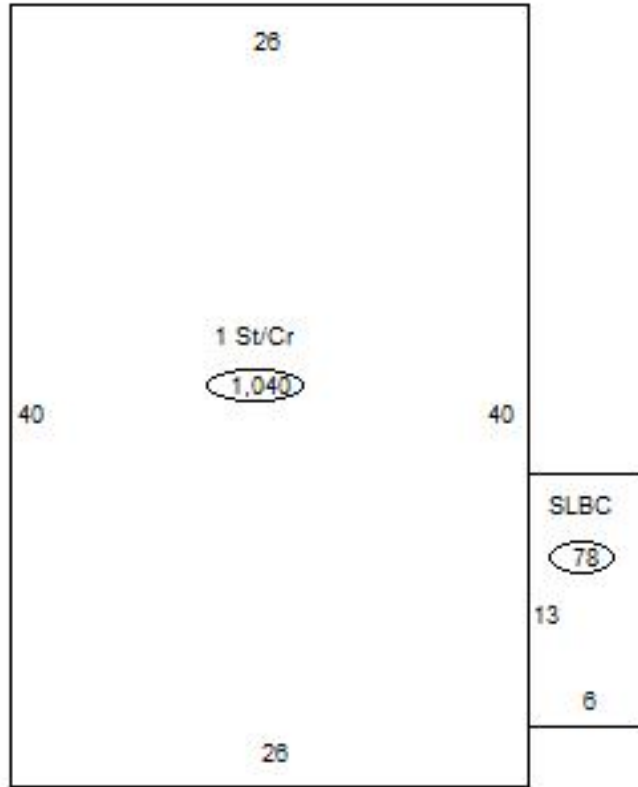

Sketch Vector Information

Sequence	Code	Type	Built Over	Scale	Section Label	Base Area	Multiplier	Total Area
1	R	1	Crawl	13	1 St/Cr	1,040	1.000	1,040
2	M	PRCH		13	SLBC	78	1.000	78
Total Building Area						1,040		1,040