



Rogers

Assessment Property Record Card for Tax Year 2026

Data provided by LISA DELOZIER County Assessor

Date 04/18/2026
 Time 05:05:32
 Page 1

Assessment Data					Primary Image																																																																																																																				
Account 660003508 Parcel ID 000000-00-0-50040-054-0004 Cadastral ID 05-19-17-02930 Property Type REAL - Real Property Property Class URP VI Area 3 Tax Area 19 - INOLA OT Name ID 147924 JUSTICE, LINDA L & HANNAH RUTH JUSTICE BOX 554 INOLA OK 74036-0000 Parcel Location Situs 00130 A ST SE Subdivision GRANDVIEW Lot/Block 0004 / 0054 Parcel Size 2 - Lots Sec/Twn/Rng 5 / 19 / 17 / 5 Neighborhood 1205 - R-V03-SE INOLA School District S005 - INOLA SCHOOLS					<p>660003508 12/04/25</p> <p>660003508_001.JPG 12/6/2025</p>																																																																																																																				
Legal Description Lat/Long: 36.15237306 -95.51233549																																																																																																																									
Building Permits <table border="1"> <thead> <tr> <th>Number</th> <th>Description</th> <th>Opened</th> <th>Closed</th> <th>Amount</th> </tr> </thead> <tbody> <tr> <td colspan="5" style="height: 100px;"> </td> </tr> </tbody> </table>					Number	Description	Opened	Closed	Amount																																																																																																																
Number	Description	Opened	Closed	Amount																																																																																																																					
Exemptions <table border="1"> <thead> <tr> <th>Code</th> <th>Type</th> <th>Active</th> <th>Maximum</th> <th>Exemption</th> </tr> </thead> <tbody> <tr> <td>H</td> <td>Homestead</td> <td>Yes</td> <td>1,000</td> <td>1,000</td> </tr> <tr> <td>PD</td> <td>Add-Homestead</td> <td>Yes</td> <td>1,000</td> <td>1,000</td> </tr> </tbody> </table>					Code	Type	Active	Maximum	Exemption	H	Homestead	Yes	1,000	1,000	PD	Add-Homestead	Yes	1,000	1,000	Sale History <table border="1"> <thead> <tr> <th>Bk/Pg</th> <th>Grantor</th> <th>Date</th> <th>Price</th> <th>Code</th> </tr> </thead> <tbody> <tr> <td colspan="5" style="height: 100px;"> </td> </tr> </tbody> </table>					Bk/Pg	Grantor	Date	Price	Code																																																																																												
Code	Type	Active	Maximum	Exemption																																																																																																																					
H	Homestead	Yes	1,000	1,000																																																																																																																					
PD	Add-Homestead	Yes	1,000	1,000																																																																																																																					
Bk/Pg	Grantor	Date	Price	Code																																																																																																																					
Parcel Valuation <table border="1"> <thead> <tr> <th>Source</th> <th>REAL</th> <th>Fair Cash</th> <th>Capped</th> <th>Asmnt Level</th> <th>Assessed</th> <th>Levy Rate</th> <th>80.060</th> <th>Current Tax</th> </tr> </thead> <tbody> <tr> <td>Remove Cap</td> <td>0</td> <td>Land Value 32,905</td> <td>20,365</td> <td>11%</td> <td>2,240</td> <td>Assessed</td> <td>6,889</td> <td>551.53</td> </tr> <tr> <td>Year Frozen</td> <td>2018</td> <td>Improvements 68,282</td> <td>42,260</td> <td></td> <td>4,649</td> <td>Penalty</td> <td>0</td> <td></td> </tr> <tr> <td>Uncapped Value</td> <td>0</td> <td>Mobile Home 0</td> <td>0</td> <td></td> <td>0</td> <td>Exemption</td> <td>2,000</td> <td>-161.00</td> </tr> <tr> <td>TIF Project ID</td> <td>0</td> <td>Total Value 101,187</td> <td>62,625</td> <td></td> <td>6,889</td> <td>Total Taxable</td> <td>4,889</td> <td>391.00</td> </tr> </tbody> </table>										Source	REAL	Fair Cash	Capped	Asmnt Level	Assessed	Levy Rate	80.060	Current Tax	Remove Cap	0	Land Value 32,905	20,365	11%	2,240	Assessed	6,889	551.53	Year Frozen	2018	Improvements 68,282	42,260		4,649	Penalty	0		Uncapped Value	0	Mobile Home 0	0		0	Exemption	2,000	-161.00	TIF Project ID	0	Total Value 101,187	62,625		6,889	Total Taxable	4,889	391.00																																																																			
Source	REAL	Fair Cash	Capped	Asmnt Level	Assessed	Levy Rate	80.060	Current Tax																																																																																																																	
Remove Cap	0	Land Value 32,905	20,365	11%	2,240	Assessed	6,889	551.53																																																																																																																	
Year Frozen	2018	Improvements 68,282	42,260		4,649	Penalty	0																																																																																																																		
Uncapped Value	0	Mobile Home 0	0		0	Exemption	2,000	-161.00																																																																																																																	
TIF Project ID	0	Total Value 101,187	62,625		6,889	Total Taxable	4,889	391.00																																																																																																																	
Assessment History <table border="1"> <thead> <tr> <th>Tax Year</th> <th>Statement Number</th> <th>Billed Owner</th> <th>Tax Area</th> <th>Total Value</th> <th>Exemptions</th> <th>Taxable Value</th> <th>Billed Tax</th> </tr> </thead> <tbody> <tr><td>2025</td><td>2025-660003508</td><td>JUSTICE, LINDA L &</td><td>19</td><td>91,093</td><td>2000</td><td>4,888</td><td>391.00</td></tr> <tr><td>2024</td><td>2024-660003508</td><td>JUSTICE, LINDA L &</td><td>19</td><td>92,448</td><td>2000</td><td>4,889</td><td>393.00</td></tr> <tr><td>2023</td><td>2023-660003508</td><td>JUSTICE, LINDA L</td><td>19</td><td>62,625</td><td>2000</td><td>4,889</td><td>394.00</td></tr> <tr><td>2022</td><td>2022-660003508</td><td>JUSTICE, LINDA L</td><td>19</td><td>63,672</td><td>2000</td><td>4,971</td><td>403.00</td></tr> <tr><td>2021</td><td>2021-660003508</td><td>JUSTICE, LINDA L</td><td>19</td><td>67,723</td><td>2000</td><td>4,972</td><td>398.00</td></tr> <tr><td>2020</td><td>2020-660003508</td><td>JUSTICE, LINDA L</td><td>19</td><td>66,658</td><td>2000</td><td>4,971</td><td>402.00</td></tr> <tr><td>2019</td><td>2019-660003508</td><td>JUSTICE, LINDA L</td><td>19</td><td>65,062</td><td>2000</td><td>4,971</td><td>411.00</td></tr> <tr><td>2018</td><td>2018-660003508</td><td>JUSTICE, LINDA L</td><td>19</td><td>68,936</td><td>2000</td><td>4,971</td><td>415.00</td></tr> <tr><td>2017</td><td>2017-660003508</td><td>JUSTICE, LINDA L</td><td>19</td><td>68,389</td><td>1000</td><td>5,768</td><td>485.00</td></tr> <tr><td>2016</td><td>2016-660003508</td><td>JUSTICE, LINDA L</td><td>19</td><td>66,592</td><td>1000</td><td>5,571</td><td>474.00</td></tr> <tr><td>2015</td><td>2015-660003508</td><td>JUSTICE, LINDA L</td><td>19</td><td>65,287</td><td>1000</td><td>5,380</td><td>467.00</td></tr> <tr><td>2014</td><td>2014-660003508</td><td>JUSTICE, LINDA L</td><td>19</td><td>64,901</td><td>1000</td><td>5,194</td><td>466.00</td></tr> <tr><td>2013</td><td>2013-660003508</td><td>JUSTICE, LINDA L</td><td>19</td><td>61,862</td><td>1000</td><td>5,014</td><td>422.00</td></tr> </tbody> </table>										Tax Year	Statement Number	Billed Owner	Tax Area	Total Value	Exemptions	Taxable Value	Billed Tax	2025	2025-660003508	JUSTICE, LINDA L &	19	91,093	2000	4,888	391.00	2024	2024-660003508	JUSTICE, LINDA L &	19	92,448	2000	4,889	393.00	2023	2023-660003508	JUSTICE, LINDA L	19	62,625	2000	4,889	394.00	2022	2022-660003508	JUSTICE, LINDA L	19	63,672	2000	4,971	403.00	2021	2021-660003508	JUSTICE, LINDA L	19	67,723	2000	4,972	398.00	2020	2020-660003508	JUSTICE, LINDA L	19	66,658	2000	4,971	402.00	2019	2019-660003508	JUSTICE, LINDA L	19	65,062	2000	4,971	411.00	2018	2018-660003508	JUSTICE, LINDA L	19	68,936	2000	4,971	415.00	2017	2017-660003508	JUSTICE, LINDA L	19	68,389	1000	5,768	485.00	2016	2016-660003508	JUSTICE, LINDA L	19	66,592	1000	5,571	474.00	2015	2015-660003508	JUSTICE, LINDA L	19	65,287	1000	5,380	467.00	2014	2014-660003508	JUSTICE, LINDA L	19	64,901	1000	5,194	466.00	2013	2013-660003508	JUSTICE, LINDA L	19	61,862	1000	5,014	422.00
Tax Year	Statement Number	Billed Owner	Tax Area	Total Value	Exemptions	Taxable Value	Billed Tax																																																																																																																		
2025	2025-660003508	JUSTICE, LINDA L &	19	91,093	2000	4,888	391.00																																																																																																																		
2024	2024-660003508	JUSTICE, LINDA L &	19	92,448	2000	4,889	393.00																																																																																																																		
2023	2023-660003508	JUSTICE, LINDA L	19	62,625	2000	4,889	394.00																																																																																																																		
2022	2022-660003508	JUSTICE, LINDA L	19	63,672	2000	4,971	403.00																																																																																																																		
2021	2021-660003508	JUSTICE, LINDA L	19	67,723	2000	4,972	398.00																																																																																																																		
2020	2020-660003508	JUSTICE, LINDA L	19	66,658	2000	4,971	402.00																																																																																																																		
2019	2019-660003508	JUSTICE, LINDA L	19	65,062	2000	4,971	411.00																																																																																																																		
2018	2018-660003508	JUSTICE, LINDA L	19	68,936	2000	4,971	415.00																																																																																																																		
2017	2017-660003508	JUSTICE, LINDA L	19	68,389	1000	5,768	485.00																																																																																																																		
2016	2016-660003508	JUSTICE, LINDA L	19	66,592	1000	5,571	474.00																																																																																																																		
2015	2015-660003508	JUSTICE, LINDA L	19	65,287	1000	5,380	467.00																																																																																																																		
2014	2014-660003508	JUSTICE, LINDA L	19	64,901	1000	5,194	466.00																																																																																																																		
2013	2013-660003508	JUSTICE, LINDA L	19	61,862	1000	5,014	422.00																																																																																																																		



Rogers

Assessment Property Record Card for Tax Year 2026

Data provided by LISA DELOZIER County Assessor

Date 04/18/2026
Time 05:05:32
Page 2

Lot Data		Square-Foot - NBHD 1205 #1		Primary Image				
Lot Size								
Lot Count								
Units Buildable	14000							
Non-Ag Acres	0.3214							
Topography								
Street Access								
Utilities								
Amenities	LAND QUALITY					0	0	
Method	Square-Foot							
Base Lot Value	14,002.00 x 2.35 = 32,905							
Factor Value								
Adjustments	1.0000							
Lot Value	32,905							
Residential Data				660003508_001.JPG 12/6/2025				
Type	1 Single Family Residence			GRM Approach				
Condition	3 - Average			GRM Code				
Quality	2 - Fair			Gross Rent 0.00				
Architecture	TRAD TRADITIONAL			Indicated Value				
Style	100% One Story			Multiple Regression				
Exterior Wall	100% Frame, Siding, Vinyl			MRA Code 1 Test				
Base/Total Area	1,108 / 1,108			Adusted R 0.8445				
Style	100% One Story			Indicated Value 101,055 91.20 Per SqFt				
HVAC	100% Warmed & Cooled Air			Direct Comparables				
Roof Cover	1 Composition Shingle			Selection Model A Adam Test				
Area on Slab	0			Adjustment Model 1 2022 Residential				
Fixture/RghIn	7 /			Comparables 8				
Bed/F/H Bath	2 / 1.0 /			Indicated Value 104,980 Per SqFt				
Basement Area				Value Reconciliation				
Garage Type	320 Attached Garage - Finished 1 Stalls			Selected Approach Cost Approach				
Remodel				Improvements 67,048				
Year/Eff Age	1969 / 43			Lot Value 32,905				
Cost Approach		Manual : 01/2025		Indicated Value 99,953 90.21 Per SqFt				
Base Cost	92.17	Total Misc Impr	+ 2,919	Agland Value				
Roofing Adj	+ 4.17	Garage Cost	+ 10,621	Site Improvements 1,234				
Subfloor Adj	+ 2.42	Total RCN	= 142,655	Total Value 101,187 91.32 Total Value Per SqFt				
Heat/Cool Adj	+ 10.30	Depreciation (53%)	- 75,607					
Plumbing Adj	+ 7.47	Lump Sums	+ 0					
Basement Adj	+ 0.00	RCNLD	= 67,048					
Adj Base Cost	= 116.53	Lot Value	+ 32,905					
Total Area	x 1,108	Indicated Value	= 99,953					
Adjusted Cost	= 129,115	Value Per SqFt	90.21					
Miscellaneous Improvements								
Code	Description	Sketch ID	Size	Year	Units	Unit Cost	Depr	Value
PRCH	SLAB PORCH - COVERED	8593	14x10		140	20.85		2,919



Rogers

Assessment Property Record Card for Tax Year 2026

Data provided by LISA DELOZIER County Assessor

Date 04/18/2026

Time 05:05:32

Page 3

Sketch Image

660003508

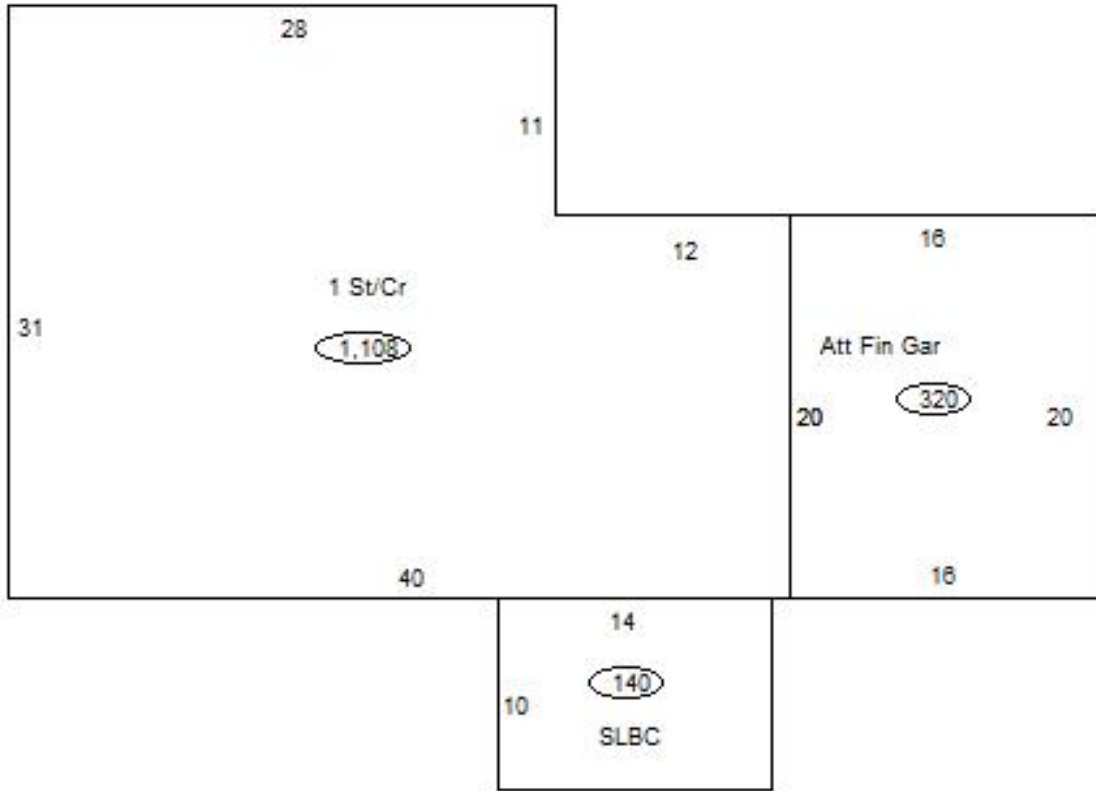

Sketch Vector Information

Sequence	Code	Type	Built Over	Scale	Section Label	Base Area	Multiplier	Total Area
1	R	1	Crawl	13	1 St/Cr	1,108	1.000	1,108
2	G	5		13	Att Fin Gar	320	1.000	320
3	M	PRCH		13	SLBC	140	1.000	140
Total Building Area						1,108		1,108



Rogers

Assessment Property Record Card for Tax Year 2026

Data provided by LISA DELOZIER County Assessor

Date 04/18/2026
Time 05:05:32
Page 4

660003508

Outbuildings/Site Improvements

Building Image	Code	Description	Dimensions	Floor	Roofing	Total Units
	SHDS	Shed - Small	10x10x8	Plank	Formed Metal	100
	Qual	2	Cond 3	Year	2010	Eff Age
Valuation Summary		Modifier Total		RCN	Depr (46% Phys/ % Func)	RCNLD
Base Cost (22.85 x 100)		2,285		2,285	1,051	1,234