



Rogers

Assessment Property Record Card for Tax Year 2026

Data provided by LISA DELOZIER County Assessor

Date 04/17/2026
 Time 06:18:56
 Page 1

Assessment Data					Primary Image																																																																																																																				
Account 660003572 Parcel ID 000000-00-0-50040-065-0003 Cadastral ID 05-19-17-03560 Property Type REAL - Real Property Property Class URP VI Area 3 Tax Area 19 - INOLA OT Name ID 340041 WOMACK, JEREMIAH & DUSTY QUALLS 404 W COMMERCIAL ST INOLA OK 74036-0000 Parcel Location Situs 00404 W COMMERCIAL ST Subdivision GRANDVIEW Lot/Block 0003 / 0065 Parcel Size 3 - Lots Sec/Twn/Rng 5 / 19 / 17 / 5 Neighborhood 1205 - R-V03-SE INOLA School District S005 - INOLA SCHOOLS					<p>660003572 11/14/25</p> <p>660003572_001.JPG 12/6/2025</p>																																																																																																																				
Legal Description Lat/Long: 36.14872167 -95.51408305																																																																																																																									
Legal Description LOTS 1- 2 & 3 BLOCK 65 GRANDVIEW					Building Permits <table border="1"> <thead> <tr> <th>Number</th> <th>Description</th> <th>Opened</th> <th>Closed</th> <th>Amount</th> </tr> </thead> <tbody> <tr><td> </td><td> </td><td> </td><td> </td><td> </td></tr> <tr><td> </td><td> </td><td> </td><td> </td><td> </td></tr> <tr><td> </td><td> </td><td> </td><td> </td><td> </td></tr> </tbody> </table>					Number	Description	Opened	Closed	Amount																																																																																																											
Number	Description	Opened	Closed	Amount																																																																																																																					
Exemptions <table border="1"> <thead> <tr> <th>Code</th> <th>Type</th> <th>Active</th> <th>Maximum</th> <th>Exemption</th> </tr> </thead> <tbody> <tr> <td>H</td> <td>Homestead</td> <td>Yes</td> <td>1,000</td> <td>1,000</td> </tr> </tbody> </table>					Code	Type	Active	Maximum	Exemption	H	Homestead	Yes	1,000	1,000	Sale History <table border="1"> <thead> <tr> <th>Bk/Pg</th> <th>Grantor</th> <th>Date</th> <th>Price</th> <th>Code</th> </tr> </thead> <tbody> <tr> <td>/</td> <td>RIVERBEND ARENA DBA</td> <td>10/11/2022</td> <td>166,500</td> <td>YES</td> </tr> <tr> <td>/</td> <td>SANDERS, DEREK K</td> <td>02/04/2022</td> <td>0</td> <td>4</td> </tr> <tr> <td>/</td> <td>MORA, SABRA K &</td> <td>09/01/2020</td> <td>95,000</td> <td>YES</td> </tr> <tr> <td>2076/315</td> <td>MCNICHOL, SHANE P &</td> <td>12/14/2009</td> <td>83,000</td> <td>YES</td> </tr> <tr> <td>1665/824</td> <td>KURTH, DANIEL D &</td> <td>03/23/2005</td> <td>58,000</td> <td>YES</td> </tr> <tr> <td>831/152</td> <td> </td> <td> </td> <td>30,500</td> <td>No</td> </tr> </tbody> </table>					Bk/Pg	Grantor	Date	Price	Code	/	RIVERBEND ARENA DBA	10/11/2022	166,500	YES	/	SANDERS, DEREK K	02/04/2022	0	4	/	MORA, SABRA K &	09/01/2020	95,000	YES	2076/315	MCNICHOL, SHANE P &	12/14/2009	83,000	YES	1665/824	KURTH, DANIEL D &	03/23/2005	58,000	YES	831/152			30,500	No																																																																			
Code	Type	Active	Maximum	Exemption																																																																																																																					
H	Homestead	Yes	1,000	1,000																																																																																																																					
Bk/Pg	Grantor	Date	Price	Code																																																																																																																					
/	RIVERBEND ARENA DBA	10/11/2022	166,500	YES																																																																																																																					
/	SANDERS, DEREK K	02/04/2022	0	4																																																																																																																					
/	MORA, SABRA K &	09/01/2020	95,000	YES																																																																																																																					
2076/315	MCNICHOL, SHANE P &	12/14/2009	83,000	YES																																																																																																																					
1665/824	KURTH, DANIEL D &	03/23/2005	58,000	YES																																																																																																																					
831/152			30,500	No																																																																																																																					
Parcel Valuation <table border="1"> <thead> <tr> <th>Source</th> <th>REAL</th> <th>Fair Cash</th> <th>Capped</th> <th>Asmnt Level</th> <th>Assessed</th> <th>Levy Rate</th> <th>80.060</th> <th>Current Tax</th> </tr> </thead> <tbody> <tr> <td>Remove Cap</td> <td>2023</td> <td>Land Value 70,739</td> <td>70,739</td> <td>11%</td> <td>7,781</td> <td>Assessed</td> <td>18,687</td> <td>1,496.08</td> </tr> <tr> <td>Year Frozen</td> <td>0</td> <td>Improvements 116,303</td> <td>99,148</td> <td> </td> <td>10,906</td> <td>Penalty</td> <td>0</td> <td> </td> </tr> <tr> <td>Uncapped Value</td> <td>0</td> <td>Mobile Home 0</td> <td>0</td> <td> </td> <td>0</td> <td>Exemption</td> <td>1,000</td> <td>-80.00</td> </tr> <tr> <td>TIF Project ID</td> <td>0</td> <td>Total Value 187,042</td> <td>169,887</td> <td> </td> <td>18,687</td> <td>Total Taxable</td> <td>17,687</td> <td>1,416.00</td> </tr> </tbody> </table>										Source	REAL	Fair Cash	Capped	Asmnt Level	Assessed	Levy Rate	80.060	Current Tax	Remove Cap	2023	Land Value 70,739	70,739	11%	7,781	Assessed	18,687	1,496.08	Year Frozen	0	Improvements 116,303	99,148		10,906	Penalty	0		Uncapped Value	0	Mobile Home 0	0		0	Exemption	1,000	-80.00	TIF Project ID	0	Total Value 187,042	169,887		18,687	Total Taxable	17,687	1,416.00																																																																			
Source	REAL	Fair Cash	Capped	Asmnt Level	Assessed	Levy Rate	80.060	Current Tax																																																																																																																	
Remove Cap	2023	Land Value 70,739	70,739	11%	7,781	Assessed	18,687	1,496.08																																																																																																																	
Year Frozen	0	Improvements 116,303	99,148		10,906	Penalty	0																																																																																																																		
Uncapped Value	0	Mobile Home 0	0		0	Exemption	1,000	-80.00																																																																																																																	
TIF Project ID	0	Total Value 187,042	169,887		18,687	Total Taxable	17,687	1,416.00																																																																																																																	
Assessment History <table border="1"> <thead> <tr> <th>Tax Year</th> <th>Statement Number</th> <th>Billed Owner</th> <th>Tax Area</th> <th>Total Value</th> <th>Exemptions</th> <th>Taxable Value</th> <th>Billed Tax</th> </tr> </thead> <tbody> <tr><td>2025</td><td>2025-660003572</td><td>WOMACK, JEREMIAH &</td><td>19</td><td>164,939</td><td>1000</td><td>17,143</td><td>1,372.00</td></tr> <tr><td>2024</td><td>2024-660003572</td><td>WOMACK, JEREMIAH &</td><td>19</td><td>166,000</td><td>1000</td><td>17,260</td><td>1,388.00</td></tr> <tr><td>2023</td><td>2023-660003572</td><td>WOMACK, JEREMIAH &</td><td>19</td><td>166,500</td><td>1000</td><td>17,315</td><td>1,395.00</td></tr> <tr><td>2022</td><td>2022-660003572</td><td>RIVERBEND ARENA DBA</td><td>19</td><td>95,974</td><td>0</td><td>10,557</td><td>856.00</td></tr> <tr><td>2021</td><td>2021-660003572</td><td>SANDERS, DEREK K</td><td>19</td><td>96,373</td><td>0</td><td>10,601</td><td>849.00</td></tr> <tr><td>2020</td><td>2020-660003572</td><td>SANDERS, DEREK K</td><td>19</td><td>92,489</td><td>1000</td><td>8,938</td><td>722.00</td></tr> <tr><td>2019</td><td>2019-660003572</td><td>MORA, SABRA K &</td><td>19</td><td>87,719</td><td>1000</td><td>8,649</td><td>715.00</td></tr> <tr><td>2018</td><td>2018-660003572</td><td>MORA, SABRA K &</td><td>19</td><td>92,419</td><td>1000</td><td>9,166</td><td>765.00</td></tr> <tr><td>2017</td><td>2017-660003572</td><td>MORA, SABRA K &</td><td>19</td><td>91,621</td><td>1000</td><td>9,078</td><td>764.00</td></tr> <tr><td>2016</td><td>2016-660003572</td><td>MORA, SABRA K &</td><td>19</td><td>89,107</td><td>1000</td><td>8,802</td><td>749.00</td></tr> <tr><td>2015</td><td>2015-660003572</td><td>MORA, SABRA K &</td><td>19</td><td>87,767</td><td>1000</td><td>8,588</td><td>745.00</td></tr> <tr><td>2014</td><td>2014-660003572</td><td>MORA, SABRA K &</td><td>19</td><td>89,471</td><td>1000</td><td>8,309</td><td>746.00</td></tr> <tr><td>2013</td><td>2013-660003572</td><td>MORA, SABRA K &</td><td>19</td><td>84,991</td><td>1000</td><td>8,037</td><td>677.00</td></tr> </tbody> </table>										Tax Year	Statement Number	Billed Owner	Tax Area	Total Value	Exemptions	Taxable Value	Billed Tax	2025	2025-660003572	WOMACK, JEREMIAH &	19	164,939	1000	17,143	1,372.00	2024	2024-660003572	WOMACK, JEREMIAH &	19	166,000	1000	17,260	1,388.00	2023	2023-660003572	WOMACK, JEREMIAH &	19	166,500	1000	17,315	1,395.00	2022	2022-660003572	RIVERBEND ARENA DBA	19	95,974	0	10,557	856.00	2021	2021-660003572	SANDERS, DEREK K	19	96,373	0	10,601	849.00	2020	2020-660003572	SANDERS, DEREK K	19	92,489	1000	8,938	722.00	2019	2019-660003572	MORA, SABRA K &	19	87,719	1000	8,649	715.00	2018	2018-660003572	MORA, SABRA K &	19	92,419	1000	9,166	765.00	2017	2017-660003572	MORA, SABRA K &	19	91,621	1000	9,078	764.00	2016	2016-660003572	MORA, SABRA K &	19	89,107	1000	8,802	749.00	2015	2015-660003572	MORA, SABRA K &	19	87,767	1000	8,588	745.00	2014	2014-660003572	MORA, SABRA K &	19	89,471	1000	8,309	746.00	2013	2013-660003572	MORA, SABRA K &	19	84,991	1000	8,037	677.00
Tax Year	Statement Number	Billed Owner	Tax Area	Total Value	Exemptions	Taxable Value	Billed Tax																																																																																																																		
2025	2025-660003572	WOMACK, JEREMIAH &	19	164,939	1000	17,143	1,372.00																																																																																																																		
2024	2024-660003572	WOMACK, JEREMIAH &	19	166,000	1000	17,260	1,388.00																																																																																																																		
2023	2023-660003572	WOMACK, JEREMIAH &	19	166,500	1000	17,315	1,395.00																																																																																																																		
2022	2022-660003572	RIVERBEND ARENA DBA	19	95,974	0	10,557	856.00																																																																																																																		
2021	2021-660003572	SANDERS, DEREK K	19	96,373	0	10,601	849.00																																																																																																																		
2020	2020-660003572	SANDERS, DEREK K	19	92,489	1000	8,938	722.00																																																																																																																		
2019	2019-660003572	MORA, SABRA K &	19	87,719	1000	8,649	715.00																																																																																																																		
2018	2018-660003572	MORA, SABRA K &	19	92,419	1000	9,166	765.00																																																																																																																		
2017	2017-660003572	MORA, SABRA K &	19	91,621	1000	9,078	764.00																																																																																																																		
2016	2016-660003572	MORA, SABRA K &	19	89,107	1000	8,802	749.00																																																																																																																		
2015	2015-660003572	MORA, SABRA K &	19	87,767	1000	8,588	745.00																																																																																																																		
2014	2014-660003572	MORA, SABRA K &	19	89,471	1000	8,309	746.00																																																																																																																		
2013	2013-660003572	MORA, SABRA K &	19	84,991	1000	8,037	677.00																																																																																																																		



Rogers

Assessment Property Record Card for Tax Year 2026

Data provided by LISA DELOZIER County Assessor

Date 04/17/2026
 Time 06:18:56
 Page 2

Lot Data	Square-Foot - NBHD 1205 #1	Primary Image
Lot Size Lot Count Units Buildable 10500 Non-Ag Acres 0.2411 Topography Street Access Utilities Amenities LAND QUALITY 0 0 Method Square-Foot Base Lot Value 10,501.00 x 2.35 = 24,677 Factor Value Adjustments 2.8666 Lot Value 70,739		

Residential Data	
Type	1 Single Family Residence
Condition	3 - Average
Quality	3 - Average
Architecture	TRAD TRADITIONAL
Style	100% One Story
Exterior Wall	80% Frame, Siding, Vinyl 20% Veneer, Masonry
Base/Total Area	1,256 / 1,256
Style	100% One Story
HVAC	100% Warmed & Cooled Air
Roof Cover	1 Composition Shingle
Area on Slab	0
Fixture/RghIn	8 /
Bed/F/H Bath	3 / 1.0 /
Basement Area	
Garage Type	
Remodel	RMA -
Year/Eff Age	1959 / 30

660003572	11/14/25
660003572_001.JPG	12/6/2025

GRM Approach	
GRM Code	
Gross Rent	0.00
Indicated Value	

Multiple Regression			
MRA Code	1	Test	
Adusted R	0.8445		
Indicated Value	102,808	81.85	Per SqFt

Direct Comparables			
Selection Model	A	Adam Test	
Adjustment Model	1	2022 Residential	
Comparables	8		
Indicated Value	119,570		Per SqFt

Value Reconciliation			
Selected Approach	Cost Approach		
Improvements	114,617		
Lot Value	70,739		
Indicated Value	185,356	147.58	Per SqFt
Agland Value			
Site Improvements	1,686		
Total Value	187,042	148.92	Total Value Per SqFt

Cost Approach				Manual : 01/2025			
Base Cost	105.98	Total Misc Impr	+ 1,870				
Roofing Adj	+ 4.96	Garage Cost	+ 0				
Subfloor Adj	+ 0.00	Total RCN	= 168,591				
Heat/Cool Adj	+ 12.64	Depreciation (37%)	- 62,379				
Plumbing Adj	+ 9.16	Lump Sums	+ 8,405				
Basement Adj	+ 0.00	RCNLD	= 114,617				
Adj Base Cost	= 132.74	Lot Value	+ 70,739				
Total Area	x 1,256	Indicated Value	= 185,356				
Adjusted Cost	= 166,721	Value Per SqFt	147.58				

Miscellaneous Improvements								
Code	Description	Sketch ID	Size	Year	Units	Unit Cost	Depr	Value
PRCH	SLAB PORCH - COVERED	8765	14x5		70	26.71		1,870
WODC	Wood Deck - Covered	8766	20x12		240	35.02		8,405



Rogers

Assessment Property Record Card for Tax Year 2026

Data provided by LISA DELOZIER County Assessor

Date 04/17/2026

Time 06:18:56

Page 3

Sketch Image

660003572

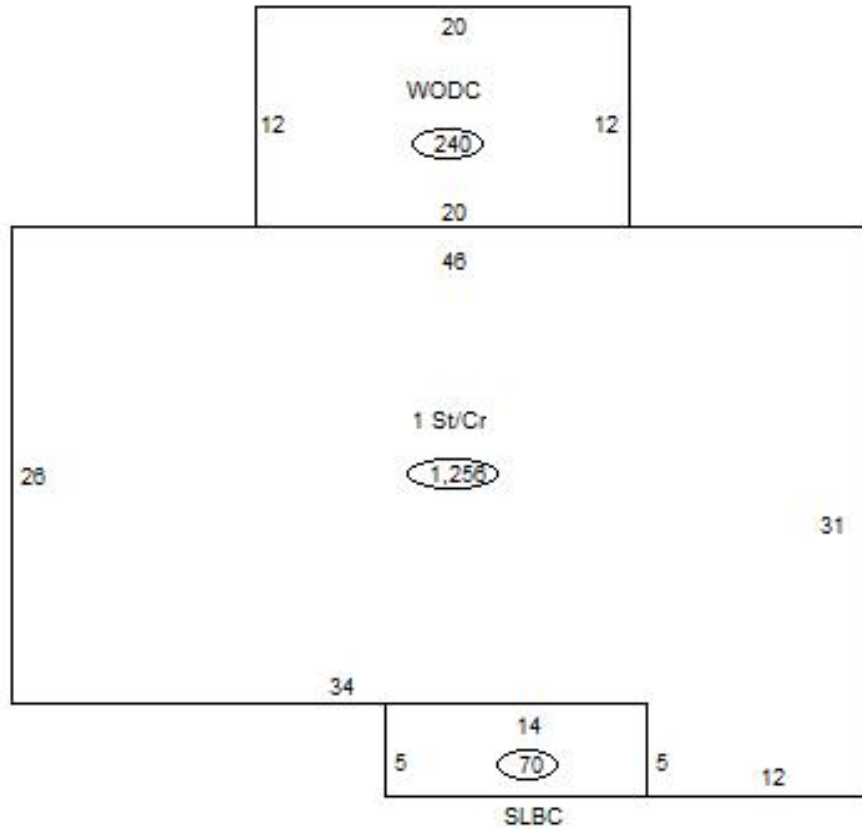

Sketch Vector Information

Sequence	Code	Type	Built Over	Scale	Section Label	Base Area	Multiplier	Total Area
1	R	1	Crawl	13	1 St/Cr	1,256	1.000	1,256
2	M	PRCH		13	SLBC	70	1.000	70
3	M	WODC		13	WODC	240	1.000	240
Total Building Area						1,256		1,256



Rogers



Assessment Property Record Card for Tax Year 2026

Data provided by LISA DELOZIER County Assessor

Date 04/17/2026
Time 06:18:57
Page 4

660003572

Outbuildings/Site Improvements

Building Image	Code	Description	Dimensions	Floor	Roofing	Total Units
	PCPT	Carport - Portable - NCV	18x20x8	Gravel	Formed Metal	360
	Qual 3	Cond 3	Year 2010	Eff Age 12		
		Valuation Summary	Modifier Total	RCN	Depr (100% Phys/ % Func)	RCNLD
		Base Cost (4.67 x 360)	1,681	1,681	1,681	
	SHDS	Shed - Small	10x16x8	Plank	Composition Shingle	160
	Qual 2	Cond 3	Year 2010	Eff Age 12		
		Valuation Summary	Modifier Total	RCN	Depr (46% Phys/ % Func)	RCNLD
		Base Cost (19.51 x 160)	3,122	3,122	1,436	1,686