



Rogers

Assessment Property Record Card for Tax Year 2026

Data provided by LISA DELOZIER County Assessor

Date 04/17/2026
Time 02:07:08
Page 1

Assessment Data					Primary Image																																																																																																																				
Account 660003719 Parcel ID 000000-00-0-00630-001-0026 Cadastral ID 05-21-15-03850 Property Type REAL - Real Property Property Class RRP VI Area 4 Tax Area 7 - OWASSO/LIMESTONE FIRE Name ID 254715 TILIDETZKE, LAURA L REVOCABLE TRUST 5683 E HUNTER LN CLAREMORE OK 74019-0000 Parcel Location Situs 05683 E HUNTER LN Subdivision QUAIL CREEK AMENDED Lot/Block 0026 / 0001 Parcel Size 1 - Lots Sec/Twn/Rng 5 / 21 / 15 / 5 Neighborhood 1107 - R-V04-SW OWASSO School District S021 - OWASSO SCHOOLS																																																																																																																									
Legal Description Lot/Long: 36.32410975 -95.72766256 LOT 26 BLOCK 1 QUAIL CREEK AMENDED																																																																																																																									
Exemptions <table border="1"> <thead> <tr> <th>Code</th> <th>Type</th> <th>Active</th> <th>Maximum</th> <th>Exemption</th> </tr> </thead> <tbody> <tr> <td>H</td> <td>Homestead</td> <td>Yes</td> <td>1,000</td> <td>1,000</td> </tr> <tr> <td>A</td> <td>Add-Homestead</td> <td>No</td> <td>1,000</td> <td></td> </tr> </tbody> </table>					Code	Type	Active	Maximum	Exemption	H	Homestead	Yes	1,000	1,000	A	Add-Homestead	No	1,000		Building Permits <table border="1"> <thead> <tr> <th>Number</th> <th>Description</th> <th>Opened</th> <th>Closed</th> <th>Amount</th> </tr> </thead> <tbody> <tr> <td></td> <td></td> <td></td> <td></td> <td></td> </tr> </tbody> </table>					Number	Description	Opened	Closed	Amount																																																																																												
Code	Type	Active	Maximum	Exemption																																																																																																																					
H	Homestead	Yes	1,000	1,000																																																																																																																					
A	Add-Homestead	No	1,000																																																																																																																						
Number	Description	Opened	Closed	Amount																																																																																																																					
Parcel Valuation <table border="1"> <thead> <tr> <th>Source</th> <th>REAL</th> <th>Fair Cash</th> <th>Capped</th> <th>Asmnt Level</th> <th>Assessed</th> <th>Levy Rate</th> <th>108.538</th> <th>Current Tax</th> </tr> </thead> <tbody> <tr> <td>Remove Cap</td> <td>0</td> <td>Land Value 54,207</td> <td>25,072</td> <td>11%</td> <td>2,758</td> <td>Assessed</td> <td>16,850</td> <td>1,828.87</td> </tr> <tr> <td>Year Frozen</td> <td>0</td> <td>Improvements 173,779</td> <td>128,115</td> <td></td> <td>14,092</td> <td>Penalty</td> <td>0</td> <td></td> </tr> <tr> <td>Uncapped Value</td> <td>0</td> <td>Mobile Home 0</td> <td>0</td> <td></td> <td>0</td> <td>Exemption</td> <td>1,000</td> <td>-98.00</td> </tr> <tr> <td>TIF Project ID</td> <td>0</td> <td>Total Value 227,986</td> <td>153,187</td> <td></td> <td>16,850</td> <td>Total Taxable</td> <td>15,850</td> <td>1,731.00</td> </tr> </tbody> </table>					Source	REAL	Fair Cash	Capped	Asmnt Level	Assessed	Levy Rate	108.538	Current Tax	Remove Cap	0	Land Value 54,207	25,072	11%	2,758	Assessed	16,850	1,828.87	Year Frozen	0	Improvements 173,779	128,115		14,092	Penalty	0		Uncapped Value	0	Mobile Home 0	0		0	Exemption	1,000	-98.00	TIF Project ID	0	Total Value 227,986	153,187		16,850	Total Taxable	15,850	1,731.00	Sale History <table border="1"> <thead> <tr> <th>Bk/Pg</th> <th>Grantor</th> <th>Date</th> <th>Price</th> <th>Code</th> </tr> </thead> <tbody> <tr> <td>/</td> <td>TILIDETZKE, LOUIS & UTRY & BREWSTER CONSTR INC</td> <td>05/29/2019</td> <td>0</td> <td>4</td> </tr> <tr> <td>925/818</td> <td>UTRY & BREWSTER CONSTR INC</td> <td>08/20/1993</td> <td>65,000</td> <td>Yes</td> </tr> <tr> <td>915/613</td> <td>TILIDETZKE, LOUIS &</td> <td>05/19/1993</td> <td>0</td> <td>No</td> </tr> <tr> <td>896/877</td> <td>LOWE, RICHARD F &</td> <td>10/26/1992</td> <td>6,558</td> <td>Yes</td> </tr> </tbody> </table>					Bk/Pg	Grantor	Date	Price	Code	/	TILIDETZKE, LOUIS & UTRY & BREWSTER CONSTR INC	05/29/2019	0	4	925/818	UTRY & BREWSTER CONSTR INC	08/20/1993	65,000	Yes	915/613	TILIDETZKE, LOUIS &	05/19/1993	0	No	896/877	LOWE, RICHARD F &	10/26/1992	6,558	Yes																																										
Source	REAL	Fair Cash	Capped	Asmnt Level	Assessed	Levy Rate	108.538	Current Tax																																																																																																																	
Remove Cap	0	Land Value 54,207	25,072	11%	2,758	Assessed	16,850	1,828.87																																																																																																																	
Year Frozen	0	Improvements 173,779	128,115		14,092	Penalty	0																																																																																																																		
Uncapped Value	0	Mobile Home 0	0		0	Exemption	1,000	-98.00																																																																																																																	
TIF Project ID	0	Total Value 227,986	153,187		16,850	Total Taxable	15,850	1,731.00																																																																																																																	
Bk/Pg	Grantor	Date	Price	Code																																																																																																																					
/	TILIDETZKE, LOUIS & UTRY & BREWSTER CONSTR INC	05/29/2019	0	4																																																																																																																					
925/818	UTRY & BREWSTER CONSTR INC	08/20/1993	65,000	Yes																																																																																																																					
915/613	TILIDETZKE, LOUIS &	05/19/1993	0	No																																																																																																																					
896/877	LOWE, RICHARD F &	10/26/1992	6,558	Yes																																																																																																																					
Assessment History <table border="1"> <thead> <tr> <th>Tax Year</th> <th>Statement Number</th> <th>Billed Owner</th> <th>Tax Area</th> <th>Total Value</th> <th>Exemptions</th> <th>Taxable Value</th> <th>Billed Tax</th> </tr> </thead> <tbody> <tr><td>2025</td><td>2025-660003719</td><td>TILIDETZKE, LAURA L</td><td>7</td><td>223,118</td><td>1000</td><td>15,360</td><td>1,678.00</td></tr> <tr><td>2024</td><td>2024-660003719</td><td>TILIDETZKE, LAURA L</td><td>7</td><td>232,957</td><td>1000</td><td>14,884</td><td>1,657.00</td></tr> <tr><td>2023</td><td>2023-660003719</td><td>TILIDETZKE, LAURA L</td><td>7</td><td>178,751</td><td>1000</td><td>14,421</td><td>1,571.00</td></tr> <tr><td>2022</td><td>2022-660003719</td><td>TILIDETZKE, LAURA</td><td>7</td><td>175,627</td><td>1000</td><td>13,972</td><td>1,583.00</td></tr> <tr><td>2021</td><td>2021-660003719</td><td>TILIDETZKE, LAURA</td><td>7</td><td>166,250</td><td>1000</td><td>13,535</td><td>1,517.00</td></tr> <tr><td>2020</td><td>2020-660003719</td><td>TILIDETZKE, LAURA</td><td>7</td><td>163,773</td><td>1000</td><td>13,112</td><td>1,469.00</td></tr> <tr><td>2019</td><td>2019-660003719</td><td>TILIDETZKE, LAURA</td><td>7</td><td>157,936</td><td>1000</td><td>12,702</td><td>1,424.00</td></tr> <tr><td>2018</td><td>2018-660003719</td><td>TILIDETZKE, LOUIS &</td><td>7</td><td>163,463</td><td>1000</td><td>12,303</td><td>1,335.00</td></tr> <tr><td>2017</td><td>2017-660003719</td><td>TILIDETZKE, LOUIS &</td><td>7</td><td>162,232</td><td>1000</td><td>11,915</td><td>1,305.00</td></tr> <tr><td>2016</td><td>2016-660003719</td><td>TILIDETZKE, LOUIS &</td><td>7</td><td>158,444</td><td>2000</td><td>10,539</td><td>1,171.00</td></tr> <tr><td>2015</td><td>2015-660003719</td><td>TILIDETZKE, LOUIS &</td><td>7</td><td>155,698</td><td>1000</td><td>11,174</td><td>1,234.00</td></tr> <tr><td>2014</td><td>2014-660003719</td><td>TILIDETZKE, LOUIS &</td><td>7</td><td>157,933</td><td>1000</td><td>10,820</td><td>1,205.00</td></tr> <tr><td>2013</td><td>2013-660003719</td><td>TILIDETZKE, LOUIS &</td><td>7</td><td>149,787</td><td>1000</td><td>10,475</td><td>1,145.00</td></tr> </tbody> </table>										Tax Year	Statement Number	Billed Owner	Tax Area	Total Value	Exemptions	Taxable Value	Billed Tax	2025	2025-660003719	TILIDETZKE, LAURA L	7	223,118	1000	15,360	1,678.00	2024	2024-660003719	TILIDETZKE, LAURA L	7	232,957	1000	14,884	1,657.00	2023	2023-660003719	TILIDETZKE, LAURA L	7	178,751	1000	14,421	1,571.00	2022	2022-660003719	TILIDETZKE, LAURA	7	175,627	1000	13,972	1,583.00	2021	2021-660003719	TILIDETZKE, LAURA	7	166,250	1000	13,535	1,517.00	2020	2020-660003719	TILIDETZKE, LAURA	7	163,773	1000	13,112	1,469.00	2019	2019-660003719	TILIDETZKE, LAURA	7	157,936	1000	12,702	1,424.00	2018	2018-660003719	TILIDETZKE, LOUIS &	7	163,463	1000	12,303	1,335.00	2017	2017-660003719	TILIDETZKE, LOUIS &	7	162,232	1000	11,915	1,305.00	2016	2016-660003719	TILIDETZKE, LOUIS &	7	158,444	2000	10,539	1,171.00	2015	2015-660003719	TILIDETZKE, LOUIS &	7	155,698	1000	11,174	1,234.00	2014	2014-660003719	TILIDETZKE, LOUIS &	7	157,933	1000	10,820	1,205.00	2013	2013-660003719	TILIDETZKE, LOUIS &	7	149,787	1000	10,475	1,145.00
Tax Year	Statement Number	Billed Owner	Tax Area	Total Value	Exemptions	Taxable Value	Billed Tax																																																																																																																		
2025	2025-660003719	TILIDETZKE, LAURA L	7	223,118	1000	15,360	1,678.00																																																																																																																		
2024	2024-660003719	TILIDETZKE, LAURA L	7	232,957	1000	14,884	1,657.00																																																																																																																		
2023	2023-660003719	TILIDETZKE, LAURA L	7	178,751	1000	14,421	1,571.00																																																																																																																		
2022	2022-660003719	TILIDETZKE, LAURA	7	175,627	1000	13,972	1,583.00																																																																																																																		
2021	2021-660003719	TILIDETZKE, LAURA	7	166,250	1000	13,535	1,517.00																																																																																																																		
2020	2020-660003719	TILIDETZKE, LAURA	7	163,773	1000	13,112	1,469.00																																																																																																																		
2019	2019-660003719	TILIDETZKE, LAURA	7	157,936	1000	12,702	1,424.00																																																																																																																		
2018	2018-660003719	TILIDETZKE, LOUIS &	7	163,463	1000	12,303	1,335.00																																																																																																																		
2017	2017-660003719	TILIDETZKE, LOUIS &	7	162,232	1000	11,915	1,305.00																																																																																																																		
2016	2016-660003719	TILIDETZKE, LOUIS &	7	158,444	2000	10,539	1,171.00																																																																																																																		
2015	2015-660003719	TILIDETZKE, LOUIS &	7	155,698	1000	11,174	1,234.00																																																																																																																		
2014	2014-660003719	TILIDETZKE, LOUIS &	7	157,933	1000	10,820	1,205.00																																																																																																																		
2013	2013-660003719	TILIDETZKE, LOUIS &	7	149,787	1000	10,475	1,145.00																																																																																																																		



Rogers

Assessment Property Record Card for Tax Year 2026

Data provided by LISA DELOZIER County Assessor

Date 04/17/2026
Time 02:07:08
Page 2

Lot Data	Square-Foot - NBHD 1107 #1	Primary Image
Lot Size		
Lot Count		
Units Buildable	1	
Non-Ag Acres	1.2008	
Topography		
Street Access		
Utilities		
Amenities	LAND QUALITY	
	0	
	0	
Method	Square-Foot	
Base Lot Value	52,305.00 x 1.04 = 54,207	
Factor Value		
Adjustments	1.0000	
Lot Value	54,207	

Residential Data	
Type	1 Single Family Residence
Condition	3 - Average
Quality	2.5 - Fair
Architecture	
Style	100% One Story
Exterior Wall	60% Veneer, Masonry 40% Frame, Siding, Vinyl
Base/Total Area	1,660 / 1,660
Style	100% One Story
HVAC	100% Warmed & Cooled Air
Roof Cover	1 Composition Shingle
Area on Slab	1,660
Fixture/RghIn	11 /
Bed/F/H Bath	4 / 2.0 /
Basement Area	
Garage Type	483 Attached Garage - Unfinished
Remodel	
Year/Eff Age	1993 / 25

\\tsclient\C\Users\Randy Necessary\Pictures\101_0330\IMG_0059. 3/31/2022

GRM Approach	
GRM Code	
Gross Rent	0.00
Indicated Value	

Multiple Regression			
MRA Code	1	Test	
Adusted R	0.8445		
Indicated Value	205,365	123.71	Per SqFt

Direct Comparables	
Selection Model	A Adam Test
Adjustment Model	1 2022 Residential
Comparables	3
Indicated Value	293,860 Per SqFt

Cost Approach				Manual : 01/2025			
Base Cost	101.00	Total Misc Impr	+ 13,023	Roofing Adj	+ 4.43	Garage Cost	+ 13,345
Subfloor Adj	+ -1.15	Total RCN	= 232,590	Heat/Cool Adj	+ 11.47	Depreciation (34%)	- 79,081
Plumbing Adj	+ 8.48	Lump Sums	+ 0	Basement Adj	+ 0.00	RCNLD	= 153,509
Adj Base Cost	= 124.23	Lot Value	+ 54,207	Total Area	x 1,660	Indicated Value	= 207,716
		Value Per SqFt	125.13	Adjusted Cost	= 206,222		

Value Reconciliation			
Selected Approach	Cost Approach		
Improvements	153,509		
Lot Value	54,207		
Indicated Value	207,716	125.13	Per SqFt
Agland Value			
Site Improvements	20,270		
Total Value	227,986	137.34	Total Value Per SqFt

Miscellaneous Improvements								
Code	Description	Sketch ID	Size	Year	Units	Unit Cost	Depr	Value
FPR1	FIREPLACE - RESIDENTIAL 1 STORY	0		1	1	5,095.98		5,096
PRCH	SLAB PORCH - COVERED	9160	13x7		91	23.98		2,182
PRCH	SLAB PORCH - COVERED	9161	184		184	23.63		4,348
PATO	SLAB PORCH - OPEN	9162	132		132	10.58		1,397



Rogers

Assessment Property Record Card for Tax Year 2026

Data provided by LISA DELOZIER County Assessor

Date 04/17/2026
 Time 02:07:08
 Page 3

Sketch Image

660003719

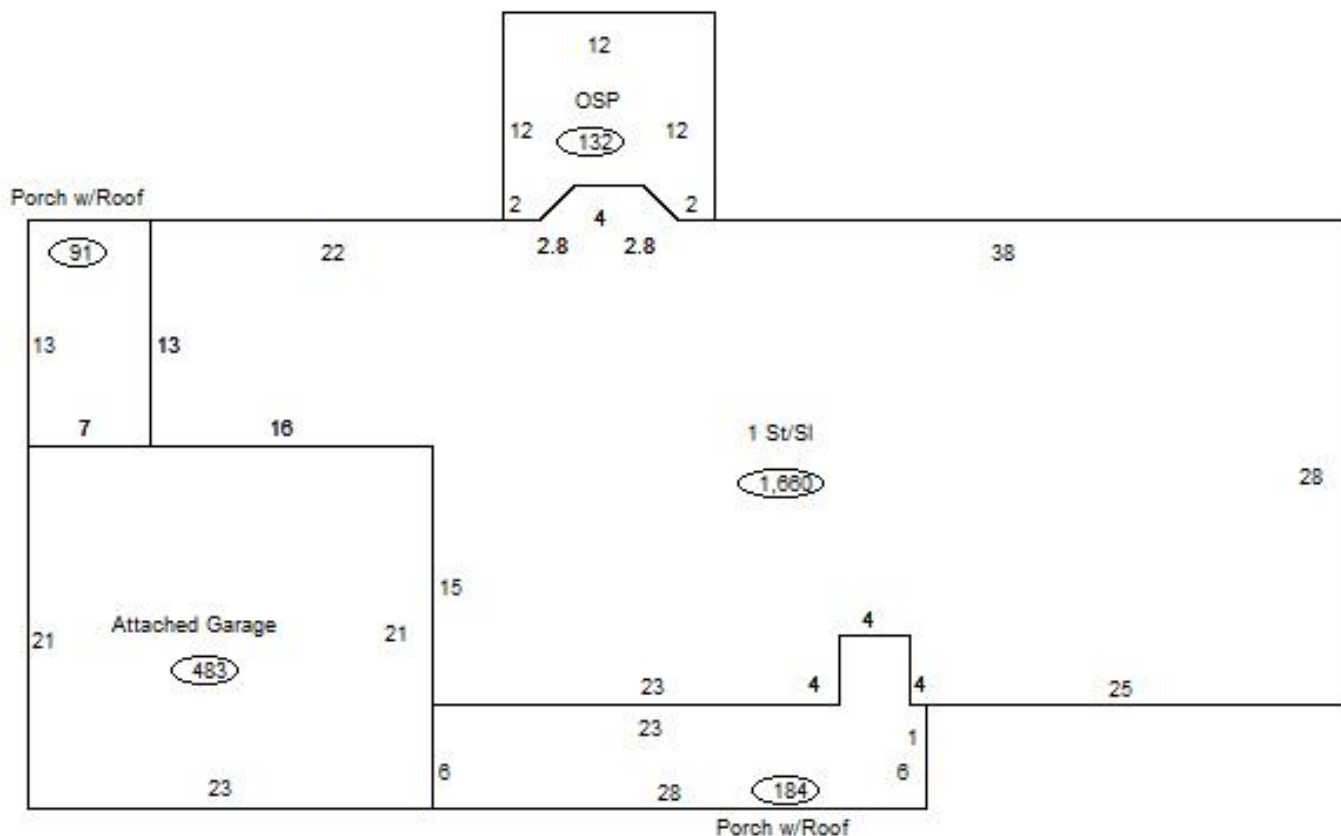

Sketch Vector Information

Sequence	Code	Type	Built Over	Scale	Section Label	Base Area	Multiplier	Total Area
1	R	1	Slab	13	1 St/Sl	1,660	1.000	1,660
2	G	1		13	Attached Garage	483	1.000	483
3	M	PRCH		13	SLBC	91	1.000	91
4	M	PRCH		13	SLBC	184	1.000	184
5	M	PATO		13	Open Slab	132	1.000	132
Total Building Area						1,660		1,660



Rogers

Assessment Property Record Card for Tax Year 2026

Data provided by LISA DELOZIER County Assessor

Date 04/17/2026
Time 02:07:08
Page 4

660003719

Outbuildings/Site Improvements

Building Image	Code	Description	Dimensions	Floor	Roofing	Total Units
	UTIL	SHOP BUILDING	0x0x0			720
	Qual 2	Cond 3	Year	Eff Age		
		Valuation Summary	Modifier Total	RCN	Depr (10% Phys/ % Func)	RCNLD
		Base Cost (31.28 x 720)	22,522	22,522	2,252	20,270