



Rogers

Assessment Property Record Card for Tax Year 2026

Data provided by LISA DELOZIER County Assessor

Date 04/17/2026
 Time 01:56:17
 Page 1

Assessment Data					Primary Image																																																																																																																				
Account 660003720 Parcel ID 000000-00-0-00630-001-0027 Cadastral ID 05-21-15-03860 Property Type REAL - Real Property Property Class RRP VI Area 4 Tax Area 7 - OWASSO/LIMESTONE FIRE Name ID 257151 GIESLER, DARREN W & ANGELA M 5705 HUNTER LN CLAREMORE OK 74019-0000																																																																																																																									
Parcel Location Situs 05705 HUNTER LN Subdivision QUAIL CREEK AMENDED Lot/Block 0027 / 0001 Parcel Size 1 - Lots Sec/Twn/Rng 5 / 21 / 15 / 5 Neighborhood 1107 - R-V04-SW OWASSO School District S021 - OWASSO SCHOOLS																																																																																																																									
Legal Description Lat/Long: 36.32410603 -95.72708703 LOT 27 BLOCK 1 QUAIL CREEK AMENDED					Building Permits <table border="1"> <thead> <tr> <th>Number</th> <th>Description</th> <th>Opened</th> <th>Closed</th> <th>Amount</th> </tr> </thead> <tbody> <tr> <td>5835</td> <td></td> <td>01/2000</td> <td>11/2001</td> <td></td> </tr> </tbody> </table>					Number	Description	Opened	Closed	Amount	5835		01/2000	11/2001																																																																																																							
Number	Description	Opened	Closed	Amount																																																																																																																					
5835		01/2000	11/2001																																																																																																																						
Exemptions <table border="1"> <thead> <tr> <th>Code</th> <th>Type</th> <th>Active</th> <th>Maximum</th> <th>Exemption</th> </tr> </thead> <tbody> <tr> <td>H</td> <td>Homestead</td> <td>Yes</td> <td>1,000</td> <td>1,000</td> </tr> </tbody> </table>					Code	Type	Active	Maximum	Exemption	H	Homestead	Yes	1,000	1,000	Sale History <table border="1"> <thead> <tr> <th>Bk/Pg</th> <th>Grantor</th> <th>Date</th> <th>Price</th> <th>Code</th> </tr> </thead> <tbody> <tr> <td>930/542</td> <td>SECRETARY HOUSING & URBAN-DEV</td> <td>09/20/1993</td> <td>0</td> <td>No</td> </tr> <tr> <td>914/29</td> <td>BANCOKLAHOMA MORTGAGE CORP</td> <td>04/27/1993</td> <td>0</td> <td>No</td> </tr> <tr> <td>911/679</td> <td>TATUM, DOUGLAS LEE</td> <td>02/04/1993</td> <td>0</td> <td>No</td> </tr> <tr> <td>859/348</td> <td></td> <td></td> <td>65,000</td> <td>No</td> </tr> </tbody> </table>					Bk/Pg	Grantor	Date	Price	Code	930/542	SECRETARY HOUSING & URBAN-DEV	09/20/1993	0	No	914/29	BANCOKLAHOMA MORTGAGE CORP	04/27/1993	0	No	911/679	TATUM, DOUGLAS LEE	02/04/1993	0	No	859/348			65,000	No																																																																													
Code	Type	Active	Maximum	Exemption																																																																																																																					
H	Homestead	Yes	1,000	1,000																																																																																																																					
Bk/Pg	Grantor	Date	Price	Code																																																																																																																					
930/542	SECRETARY HOUSING & URBAN-DEV	09/20/1993	0	No																																																																																																																					
914/29	BANCOKLAHOMA MORTGAGE CORP	04/27/1993	0	No																																																																																																																					
911/679	TATUM, DOUGLAS LEE	02/04/1993	0	No																																																																																																																					
859/348			65,000	No																																																																																																																					
Parcel Valuation <table border="1"> <thead> <tr> <th>Source</th> <th>REAL</th> <th>Fair Cash</th> <th>Capped</th> <th>Asmnt Level</th> <th>Assessed</th> <th>Levy Rate</th> <th>108.538</th> <th>Current Tax</th> </tr> </thead> <tbody> <tr> <td>Remove Cap</td> <td>0</td> <td>Land Value 54,137</td> <td>29,753</td> <td>11%</td> <td>3,273</td> <td>Assessed</td> <td>15,732</td> <td>1,707.52</td> </tr> <tr> <td>Year Frozen</td> <td>0</td> <td>Improvements 143,470</td> <td>113,263</td> <td></td> <td>12,459</td> <td>Penalty</td> <td>0</td> <td></td> </tr> <tr> <td>Uncapped Value</td> <td>0</td> <td>Mobile Home 0</td> <td>0</td> <td></td> <td>0</td> <td>Exemption</td> <td>1,000</td> <td>-98.00</td> </tr> <tr> <td>TIF Project ID</td> <td>0</td> <td>Total Value 197,607</td> <td>143,016</td> <td></td> <td>15,732</td> <td>Total Taxable</td> <td>14,732</td> <td>1,610.00</td> </tr> </tbody> </table>										Source	REAL	Fair Cash	Capped	Asmnt Level	Assessed	Levy Rate	108.538	Current Tax	Remove Cap	0	Land Value 54,137	29,753	11%	3,273	Assessed	15,732	1,707.52	Year Frozen	0	Improvements 143,470	113,263		12,459	Penalty	0		Uncapped Value	0	Mobile Home 0	0		0	Exemption	1,000	-98.00	TIF Project ID	0	Total Value 197,607	143,016		15,732	Total Taxable	14,732	1,610.00																																																																			
Source	REAL	Fair Cash	Capped	Asmnt Level	Assessed	Levy Rate	108.538	Current Tax																																																																																																																	
Remove Cap	0	Land Value 54,137	29,753	11%	3,273	Assessed	15,732	1,707.52																																																																																																																	
Year Frozen	0	Improvements 143,470	113,263		12,459	Penalty	0																																																																																																																		
Uncapped Value	0	Mobile Home 0	0		0	Exemption	1,000	-98.00																																																																																																																	
TIF Project ID	0	Total Value 197,607	143,016		15,732	Total Taxable	14,732	1,610.00																																																																																																																	
Assessment History <table border="1"> <thead> <tr> <th>Tax Year</th> <th>Statement Number</th> <th>Billed Owner</th> <th>Tax Area</th> <th>Total Value</th> <th>Exemptions</th> <th>Taxable Value</th> <th>Billed Tax</th> </tr> </thead> <tbody> <tr><td>2025</td><td>2025-660003720</td><td>GIESLER, DARREN W &</td><td>7</td><td>185,864</td><td>1000</td><td>14,273</td><td>1,560.00</td></tr> <tr><td>2024</td><td>2024-660003720</td><td>GIESLER, DARREN W &</td><td>7</td><td>193,094</td><td>1000</td><td>13,829</td><td>1,541.00</td></tr> <tr><td>2023</td><td>2023-660003720</td><td>GIESLER, DARREN W &</td><td>7</td><td>147,101</td><td>1000</td><td>13,397</td><td>1,461.00</td></tr> <tr><td>2022</td><td>2022-660003720</td><td>GIESLER, DARREN W &</td><td>7</td><td>143,634</td><td>1000</td><td>12,978</td><td>1,471.00</td></tr> <tr><td>2021</td><td>2021-660003720</td><td>GIESLER, DARREN W &</td><td>7</td><td>140,522</td><td>1000</td><td>12,571</td><td>1,410.00</td></tr> <tr><td>2020</td><td>2020-660003720</td><td>GIESLER, DARREN W &</td><td>7</td><td>138,565</td><td>1000</td><td>12,176</td><td>1,364.00</td></tr> <tr><td>2019</td><td>2019-660003720</td><td>GIESLER, DARREN W &</td><td>7</td><td>134,302</td><td>1000</td><td>11,791</td><td>1,323.00</td></tr> <tr><td>2018</td><td>2018-660003720</td><td>GIESLER, DARREN W &</td><td>7</td><td>139,155</td><td>1000</td><td>11,419</td><td>1,240.00</td></tr> <tr><td>2017</td><td>2017-660003720</td><td>GIESLER, DARREN W &</td><td>7</td><td>138,164</td><td>1000</td><td>11,057</td><td>1,212.00</td></tr> <tr><td>2016</td><td>2016-660003720</td><td>GIESLER, DARREN W &</td><td>7</td><td>135,186</td><td>1000</td><td>10,706</td><td>1,175.00</td></tr> <tr><td>2015</td><td>2015-660003720</td><td>GIESLER, DARREN W &</td><td>7</td><td>134,080</td><td>1000</td><td>10,365</td><td>1,145.00</td></tr> <tr><td>2014</td><td>2014-660003720</td><td>GIESLER, DARREN W &</td><td>7</td><td>135,620</td><td>1000</td><td>10,035</td><td>1,119.00</td></tr> <tr><td>2013</td><td>2013-660003720</td><td>GIESLER, DARREN W &</td><td>7</td><td>129,518</td><td>1000</td><td>9,713</td><td>1,063.00</td></tr> </tbody> </table>										Tax Year	Statement Number	Billed Owner	Tax Area	Total Value	Exemptions	Taxable Value	Billed Tax	2025	2025-660003720	GIESLER, DARREN W &	7	185,864	1000	14,273	1,560.00	2024	2024-660003720	GIESLER, DARREN W &	7	193,094	1000	13,829	1,541.00	2023	2023-660003720	GIESLER, DARREN W &	7	147,101	1000	13,397	1,461.00	2022	2022-660003720	GIESLER, DARREN W &	7	143,634	1000	12,978	1,471.00	2021	2021-660003720	GIESLER, DARREN W &	7	140,522	1000	12,571	1,410.00	2020	2020-660003720	GIESLER, DARREN W &	7	138,565	1000	12,176	1,364.00	2019	2019-660003720	GIESLER, DARREN W &	7	134,302	1000	11,791	1,323.00	2018	2018-660003720	GIESLER, DARREN W &	7	139,155	1000	11,419	1,240.00	2017	2017-660003720	GIESLER, DARREN W &	7	138,164	1000	11,057	1,212.00	2016	2016-660003720	GIESLER, DARREN W &	7	135,186	1000	10,706	1,175.00	2015	2015-660003720	GIESLER, DARREN W &	7	134,080	1000	10,365	1,145.00	2014	2014-660003720	GIESLER, DARREN W &	7	135,620	1000	10,035	1,119.00	2013	2013-660003720	GIESLER, DARREN W &	7	129,518	1000	9,713	1,063.00
Tax Year	Statement Number	Billed Owner	Tax Area	Total Value	Exemptions	Taxable Value	Billed Tax																																																																																																																		
2025	2025-660003720	GIESLER, DARREN W &	7	185,864	1000	14,273	1,560.00																																																																																																																		
2024	2024-660003720	GIESLER, DARREN W &	7	193,094	1000	13,829	1,541.00																																																																																																																		
2023	2023-660003720	GIESLER, DARREN W &	7	147,101	1000	13,397	1,461.00																																																																																																																		
2022	2022-660003720	GIESLER, DARREN W &	7	143,634	1000	12,978	1,471.00																																																																																																																		
2021	2021-660003720	GIESLER, DARREN W &	7	140,522	1000	12,571	1,410.00																																																																																																																		
2020	2020-660003720	GIESLER, DARREN W &	7	138,565	1000	12,176	1,364.00																																																																																																																		
2019	2019-660003720	GIESLER, DARREN W &	7	134,302	1000	11,791	1,323.00																																																																																																																		
2018	2018-660003720	GIESLER, DARREN W &	7	139,155	1000	11,419	1,240.00																																																																																																																		
2017	2017-660003720	GIESLER, DARREN W &	7	138,164	1000	11,057	1,212.00																																																																																																																		
2016	2016-660003720	GIESLER, DARREN W &	7	135,186	1000	10,706	1,175.00																																																																																																																		
2015	2015-660003720	GIESLER, DARREN W &	7	134,080	1000	10,365	1,145.00																																																																																																																		
2014	2014-660003720	GIESLER, DARREN W &	7	135,620	1000	10,035	1,119.00																																																																																																																		
2013	2013-660003720	GIESLER, DARREN W &	7	129,518	1000	9,713	1,063.00																																																																																																																		



Rogers

Assessment Property Record Card for Tax Year 2026

Data provided by LISA DELOZIER County Assessor

Date 04/17/2026
 Time 01:56:17
 Page 2

Lot Data		Square-Foot - NBHD 1107 #1	
Lot Size			
Lot Count			
Units Buildable	8000		
Non-Ag Acres	1.1979		
Topography			
Street Access			
Utilities			
Amenities	LAND QUALITY	0	
		0	
Method	Square-Foot		
Base Lot Value	52,181.00 x 1.04 = 54,137		
Factor Value			
Adjustments	1.0000		
Lot Value	54,137		



\\tsclient\C\Users\Randy Necessary\Pictures\101_0330\IMG_0062. 3/31/2022

Residential Data	
Type	1 Single Family Residence
Condition	3 - Average
Quality	2.5 - Fair
Architecture	
Style	100% One Story
Exterior Wall	90% Veneer, Stone 10% Frame, Siding, Vinyl
Base/Total Area	1,421 / 1,421
Style	100% One Story
HVAC	100% Warmed & Cooled Air
Roof Cover	1 Composition Shingle
Area on Slab	1,421
Fixture/RghIn	11 /
Bed/F/H Bath	3 / 2.0 /
Basement Area	
Garage Type	480 Attached Garage - Unfinished 2 Stalls
Remodel	
Year/Eff Age	1975 / 38

GRM Approach	
GRM Code	
Gross Rent	0.00
Indicated Value	

Multiple Regression			
MRA Code	1	Test	
Adjusted R	0.8445		
Indicated Value	179,400	126.25	Per SqFt

Direct Comparables			
Selection Model	A	Adam Test	
Adjustment Model	1	2022 Residential	
Comparables	3		
Indicated Value	289,280		Per SqFt

Cost Approach				Manual : 01/2025			
Base Cost	112.82	Total Misc Impr	+	10,547			
Roofing Adj	+ 4.58	Garage Cost	+	13,282			
Subfloor Adj	+ -1.20	Total RCN	=	219,330			
Heat/Cool Adj	+ 11.47	Depreciation (47%)	-	103,085			
Plumbing Adj	+ 9.91	Lump Sums	+	0			
Basement Adj	+ 0.00	RCNLD	=	116,245			
Adj Base Cost	= 137.58	Lot Value	+	54,137			
Total Area	x 1,421	Indicated Value	=	170,382			
Adjusted Cost	= 195,501	Value Per SqFt		119.90			

Value Reconciliation			
Selected Approach	Cost Approach		
Improvements	116,245		
Lot Value	54,137		
Indicated Value	170,382	119.90	Per SqFt
Agland Value			
Site Improvements	27,225		
Total Value	197,607	139.06	Total Value Per SqFt

Miscellaneous Improvements								
Code	Description	Sketch ID	Size	Year	Units	Unit Cost	Depr	Value
FPR1	FIREPLACE - RESIDENTIAL 1 STORY	0		1	1	5,095.98		5,096
PRCH	SLAB PORCH - COVERED	9165	24x7		168	23.69		3,980
PATO	SLAB PORCH - OPEN	9166	14x10		140	10.51		1,471



Sketch Image

660003720

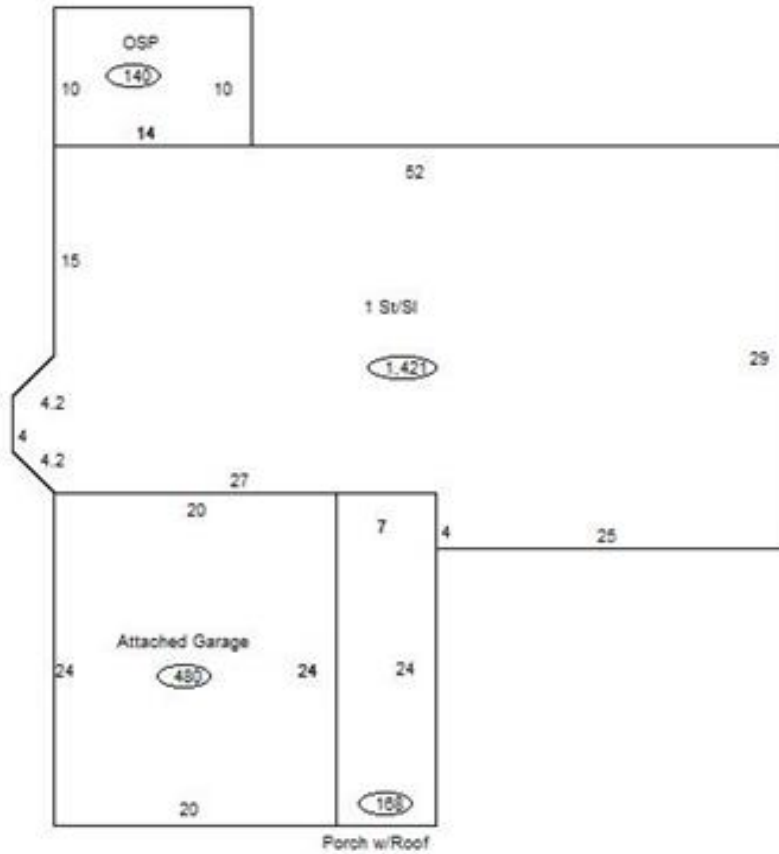

Sketch Vector Information

Sequence	Code	Type	Built Over	Scale	Section Label	Base Area	Multiplier	Total Area
1	R	1	Slab	13	1 St/Sl	1,421	1.000	1,421
2	G	1		13	Attached Garage	480	1.000	480
3	M	PRCH		13	SLBC	168	1.000	168
4	M	PATO		13	Open Slab	140	1.000	140
Total Building Area						1,421		1,421



Rogers

Assessment Property Record Card for Tax Year 2026

Data provided by LISA DELOZIER County Assessor

Date 04/17/2026
Time 01:56:18
Page 4

660003720

Outbuildings/Site Improvements

Building Image	Code	Description	Dimensions	Floor	Roofing	Total Units
	UTIL	SHOP BUILDING	0x0x0			1,200
	Qual 2	Cond 3	Year	Eff Age		
		Valuation Summary	Modifier Total	RCN	Depr (25% Phys/ % Func)	RCNLD
		Base Cost (30.25 x 1,200)	36,300	36,300	9,075	27,225