



# Rogers

## Assessment Property Record Card for Tax Year 2026

Data provided by LISA DELOZIER County Assessor

Date 04/17/2026  
Time 05:23:43  
Page 1

Assessment Data					Primary Image				
Account	660003749								
Parcel ID	000000-00-0-00693-001-0001								
Cadastral ID	05-21-15-04150								
Property Type	REAL - Real Property								
Property Class	RRP	VI Area 4							
Tax Area	7 - OWASSO/LIMESTONE FIRE								
Name ID	286281								
PHILLIPS, WILLIAM E &									
DEBRA									
19805 S COVEY CT									
CLAREMORE OK 74019-0000									
Parcel Location									
Situs	19805 S COVEY CT								
Subdivision	RODEN ADDITION AMD								
Lot/Block	0001 / 0001	Parcel Size 1 - Lots							
Sec/Twn/Rng	5 / 21 / 15 / 5								
Neighborhood	1107 - R-V04-SW OWASSO								
School District	S021 - OWASSO SCHOOLS								
Legal Description									
Lot/Long: 36.32595650 -95.72977330									
LOT 1 BLOCK 1 RODEN ADDITION AMD.									
Building Permits									
Number	Description	Opened	Closed	Amount					
R2009 0718	R10-NEW POLE BARN 60X60	08/2009	01/2010	37,000					
Exemptions									
Code	Type	Active	Maximum	Exemption					
H	Homestead	Yes	1,000	1,000					
Sale History									
Bk/Pg	Grantor	Date	Price	Code					
1611/94	PHILLIPS, WILLIAM E	07/26/2004	0	4					
Parcel Valuation									
Source	REAL	Fair Cash	Capped	Asmnt Level	Assessed	Levy Rate	108.538	Current Tax	
Remove Cap	0	Land Value	53,758	20,410	11%	2,245	Assessed	12,886	
Year Frozen	0	Improvements	96,738	96,738		10,641	Penalty	0	
Uncapped Value	0	Mobile Home	0	0		0	Exemption	1,000	
TIF Project ID	0	Total Value	150,496	117,148		12,886	Total Taxable	11,886	
								1,301.00	
Assessment History									
Tax Year	Statement Number	Billed Owner	Tax Area	Total Value	Exemptions	Taxable Value	Billed Tax		
2025	2025-660003749	PHILLIPS, WILLIAM E &	7	149,434	1000	11,511	1,260.00		
2024	2024-660003749	PHILLIPS, WILLIAM E &	7	155,191	1000	11,147	1,244.00		
2023	2023-660003749	PHILLIPS, WILLIAM E &	7	107,208	1000	10,793	1,179.00		
2022	2022-660003749	PHILLIPS, WILLIAM E &	7	108,943	1000	10,984	1,247.00		
2021	2021-660003749	PHILLIPS, WILLIAM E &	7	119,711	1000	12,165	1,365.00		
2020	2020-660003749	PHILLIPS, WILLIAM E &	7	117,648	1000	11,781	1,321.00		
2019	2019-660003749	PHILLIPS, WILLIAM E &	7	112,809	1000	11,409	1,280.00		
2018	2018-660003749	PHILLIPS, WILLIAM E &	7	115,410	1000	11,650	1,265.00		
2017	2017-660003749	PHILLIPS, WILLIAM E &	7	114,286	1000	11,282	1,236.00		
2016	2016-660003749	PHILLIPS, WILLIAM E &	7	111,174	1000	10,924	1,198.00		
2015	2015-660003749	PHILLIPS, WILLIAM E &	7	108,934	1000	10,577	1,168.00		
2014	2014-660003749	PHILLIPS, WILLIAM E &	7	129,296	1000	10,240	1,141.00		
2013	2013-660003749	PHILLIPS, WILLIAM E &	7	124,422	1000	9,912	1,085.00		



# Rogers

## Assessment Property Record Card for Tax Year 2026

Data provided by LISA DELOZIER County Assessor

Date 04/17/2026  
Time 05:23:43  
Page 2

Lot Data	Square-Foot - NBHD 1107 #1	Primary Image
Lot Size		
Lot Count		
Units Buildable	1	
Non-Ag Acres	1.1826	
Topography		
Street Access		
Utilities		
Amenities	LAND QUALITY	
	0	
	0	
Method	Square-Foot	
Base Lot Value	51,516.00 x 1.04 = 53,758	
Factor Value		
Adjustments	1.0000	
Lot Value	53,758	

Residential Data	
Type	1 Single Family Residence
Condition	3 - Average
Quality	2 - Fair
Architecture	
Style	100% One Story
Exterior Wall	100% Frame, Siding, Wood
Base/Total Area	1,838 / 1,838
Style	100% One Story
HVAC	100% Forced Air Furnace
Roof Cover	4 Metal, Preformed
Area on Slab	0
Fixture/RghIn	8 /
Bed/F/H Bath	3 / 2.0 /
Basement Area	
Garage Type	
Remodel	
Year/Eff Age	1968 / 44

\\tsclient\C\Users\Randy Necessary\Pictures\101\_0331\IMG\_0060. 4/1/2022

GRM Approach	
GRM Code	
Gross Rent	0.00
Indicated Value	

Multiple Regression			
MRA Code	1 Test		
Adjusted R	0.8445		
Indicated Value	109,685	59.68	Per SqFt

Direct Comparables	
Selection Model	A Adam Test
Adjustment Model	1 2022 Residential
Comparables	
Indicated Value	

Cost Approach				Manual : 01/2025			
Base Cost	82.92	Total Misc Impr	+ 19,090				
Roofing Adj	+ 4.47	Garage Cost	+ 0				
Subfloor Adj	+ 2.43	Total RCN	= 202,725				
Heat/Cool Adj	+ 5.00	Depreciation ( 54%)	- 109,472				
Plumbing Adj	+ 5.09	Lump Sums	+ 0				
Basement Adj	+ 0.00	RCNLD	= 93,253				
Adj Base Cost	= 99.91	Lot Value	+ 53,758				
Total Area	x 1,838	Indicated Value	= 147,011				
Adjusted Cost	= 183,635	Value Per SqFt	79.98				

Value Reconciliation			
Selected Approach	Cost Approach		
Improvements	93,253		
Lot Value	53,758		
Indicated Value	147,011	79.98	Per SqFt
Agland Value			
Site Improvements	3,485		
Total Value	150,496	81.88	Total Value Per SqFt

Miscellaneous Improvements								
Code	Description	Sketch ID	Size	Year	Units	Unit Cost	Depr	Value
FPR1	FIREPLACE - RESIDENTIAL 1 STORY	0		2	2	4,576.55		9,153
FPR1	FIREPLACE - RESIDENTIAL 1 STORY	0		1	1	4,576.55		4,577
PATO	SLAB PORCH - OPEN	9253	5x4		20	10.24		205
PRCH	SLAB PORCH - COVERED	9254	24x10		240	20.54		4,930
PATO	SLAB PORCH - OPEN	9255		22	22	10.24		225



Sketch Image

660003749

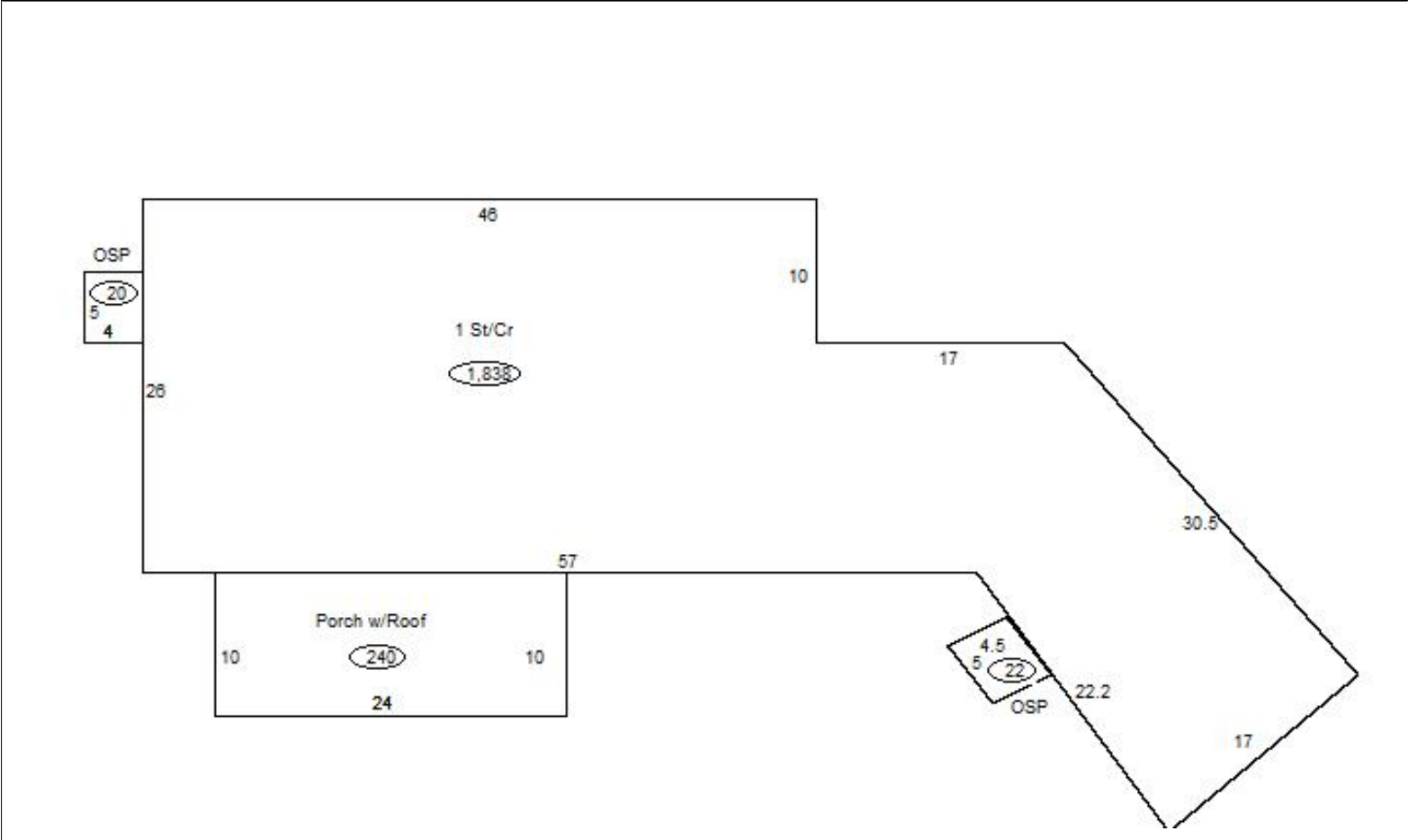

Sketch Vector Information

Sequence	Code	Type	Built Over	Scale	Section Label	Base Area	Multiplier	Total Area
1	R	1	Crawl	13	1 St/Cr	1,838	1.000	1,838
2	M	PATO		13	Open Slab	20	1.000	20
3	M	PRCH		13	SLBC	240	1.000	240
4	M	PATO		13	Open Slab	22	1.000	22
<b>Total Building Area</b>						1,838		1,838



# Rogers



## Assessment Property Record Card for Tax Year 2026

Data provided by LISA DELOZIER County Assessor

Date 04/17/2026  
 Time 05:23:43  
 Page 4

660003749

### Outbuildings/Site Improvements

Building Image	Code	Description	Dimensions	Floor	Roofing	Total Units	
	DTGF	DETACHED GARAGE FAIR	0x0x0			396	
	Qual	2	Cond 3	Year	Eff Age		
	<b>Valuation Summary</b>		<b>Modifier Total</b>		<b>RCN</b>	<b>Depr (45% Phys/ % Func)</b>	<b>RCNLD</b>
	Base Cost (16.00 x 396)		6,336		6,336	2,851	3,485
	STF	STG FAIR	0x0x0				
	Qual		Cond	Year	Eff Age		
	<b>Valuation Summary</b>		<b>Modifier Total</b>		<b>RCN</b>	<b>Depr (100% Phys/ % Func)</b>	<b>RCNLD</b>
	Base Cost (4.68 x )						
	STF	STG FAIR	0x0x0				
	Qual		Cond	Year	Eff Age		
	<b>Valuation Summary</b>		<b>Modifier Total</b>		<b>RCN</b>	<b>Depr (100% Phys/ % Func)</b>	<b>RCNLD</b>
	Base Cost (4.68 x )						