



# Rogers

## Assessment Property Record Card for Tax Year 2026

Data provided by LISA DELOZIER County Assessor

Date 04/16/2026  
Time 23:13:56  
Page 1

| Assessment Data  |                            |                    |           |             | Primary Image |                       |               |         |             |  |  |  |  |  |
|--|----------------------------|--------------------|-----------|-------------|---------------|-----------------------|---------------|---------|-------------|--|--|--|--|--|
| Account  | 660003786                  |                    |           |             |               |                       |               |         |             |  |  |  |  |  |
| Parcel ID  | 000000-00-0-10045-003-0015 |                    |           |             |               |                       |               |         |             |  |  |  |  |  |
| Cadastral ID   | 05-21-16-00310             |                    |           |             |               |                       |               |         |             |  |  |  |  |  |
| Property Type  | REAL - Real Property       |                    |           |             |               |                       |               |         |             |  |  |  |  |  |
| Property Class   | URP                        | VI Area            | 1         |             |               |                       |               |         |             |  |  |  |  |  |
| Tax Area   | 17 - CLAREMORE OT          |                    |           |             |               |                       |               |         |             |  |  |  |  |  |
| Name ID  | 319374                     |                    |           |             |               |                       |               |         |             |  |  |  |  |  |
| KUE, KAY   |                            |                    |           |             |               |                       |               |         |             |  |  |  |  |  |
| 1006 W 18TH ST<br>CLAREMORE OK 74017-0000  |                            |                    |           |             |               |                       |               |         |             |  |  |  |  |  |
| Parcel Location  |                            |                    |           |             |               |                       |               |         |             |  |  |  |  |  |
| Situs  | 01006 W 18TH ST N          |                    |           |             |               |                       |               |         |             |  |  |  |  |  |
| Subdivision  | CHAMBERS TERRACE           |                    |           |             |               |                       |               |         |             |  |  |  |  |  |
| Lot/Block  | 0015 / 0003                | Parcel Size        | 1 - Lots  |             |               |                       |               |         |             |  |  |  |  |  |
| Sec/Twn/Rng  | 5 / 21 / 16 / 5            |                    |           |             |               |                       |               |         |             |  |  |  |  |  |
| Neighborhood   | 1183 - R-V01-SW CLAREMORE  |                    |           |             |               |                       |               |         |             |  |  |  |  |  |
| School District  | S001 - CLAREMORE SCHOOLS   |                    |           |             |               |                       |               |         |             |  |  |  |  |  |
| Legal Description Lat/Long: 36.32704749 -95.61978410   |                            |                    |           |             |               |                       |               |         |             |  |  |  |  |  |
| Building Permits   |                            |                    |           |             |               |                       |               |         |             |  |  |  |  |  |
| LOT 15 BLOCK 3 CHAMBERS TERRACE  |                            |                    |           |             |               |                       |               |         |             |  |  |  |  |  |
| <table border="1"> <thead> <tr> <th>Number</th> <th>Description</th> <th>Opened</th> <th>Closed</th> <th>Amount</th> </tr> </thead> <tbody> <tr> <td></td> <td></td> <td></td> <td></td> <td></td> </tr> </tbody> </table> |                            |                    |           |             | Number        | Description           | Opened        | Closed  | Amount      |  |  |  |  |  |
| Number   | Description                | Opened             | Closed    | Amount      |               |                       |               |         |             |  |  |  |  |  |
|  |                            |                    |           |             |               |                       |               |         |             |  |  |  |  |  |
| Exemptions   |                            |                    |           |             |               |                       |               |         |             |  |  |  |  |  |
| Sale History   |                            |                    |           |             |               |                       |               |         |             |  |  |  |  |  |
| Code   | Type                       | Active             | Maximum   | Exemption   | Bk/Pg         | Grantor               | Date          | Price   | Code        |  |  |  |  |  |
| H  | Homestead                  | Yes                | 1,000     | 1,000       | 2577/800      | MCCAMISH, TROY D &    | 09/10/2016    | 128,000 | YES         |  |  |  |  |  |
| H  | Homestead                  | No                 | 1,000     |             | 1526/899      | HAMILTON, TRICIA M    | 09/24/2003    | 95,000  | YES         |  |  |  |  |  |
|  |                            |                    |           |             | 1030/808      | COX, ROBERT L & GWYNN | 06/28/1996    | 72,000  | Yes         |  |  |  |  |  |
|  |                            |                    |           |             | 767/266       |                       |               | 57,000  | No          |  |  |  |  |  |
|  |                            |                    |           |             | 791/149       |                       |               | 58,500  | No          |  |  |  |  |  |
| Parcel Valuation   |                            |                    |           |             |               |                       |               |         |             |  |  |  |  |  |
| Source   | REAL                       |                    | Fair Cash | Capped      | Asmnt Level   | Assessed              | Levy Rate     | 92.430  | Current Tax |  |  |  |  |  |
| Remove Cap   | 2017                       | Land Value         | 105,575   | 29,815      | 11%           | 3,280                 | Assessed      | 14,765  | 1,364.73    |  |  |  |  |  |
| Year Frozen  | 0                          | Improvements       | 115,315   | 104,406     |               | 11,485                | Penalty       | 0       |             |  |  |  |  |  |
| Uncapped Value   | 0                          | Mobile Home        | 0         | 0           |               | 0                     | Exemption     | 1,000   | -93.00      |  |  |  |  |  |
| TIF Project ID   | 0                          | Total Value        | 220,890   | 134,221     |               | 14,765                | Total Taxable | 13,765  | 1,272.00    |  |  |  |  |  |
| Assessment History   |                            |                    |           |             |               |                       |               |         |             |  |  |  |  |  |
| Tax Year   | Statement Number           | Billed Owner       | Tax Area  | Total Value | Exemptions    | Taxable Value         | Billed Tax    |         |             |  |  |  |  |  |
| 2025   | 2025-660003786             | KUE, KAY           | 17        | 217,039     | 1000          | 13,334                | 1,232.00      |         |             |  |  |  |  |  |
| 2024   | 2024-660003786             | KUE, KAY           | 17        | 251,024     | 1000          | 12,916                | 1,194.00      |         |             |  |  |  |  |  |
| 2023   | 2023-660003786             | KUE, KAY           | 17        | 130,526     | 1000          | 12,512                | 1,146.00      |         |             |  |  |  |  |  |
| 2022   | 2022-660003786             | KUE, KAY           | 17        | 119,256     | 1000          | 12,118                | 1,122.00      |         |             |  |  |  |  |  |
| 2021   | 2021-660003786             | KUE, KAY           | 17        | 124,493     | 1000          | 12,694                | 1,121.00      |         |             |  |  |  |  |  |
| 2020   | 2020-660003786             | KUE, KAY           | 17        | 121,331     | 1000          | 12,346                | 1,131.00      |         |             |  |  |  |  |  |
| 2019   | 2019-660003786             | KUE, KAY           | 17        | 128,067     | 1000          | 13,087                | 1,212.00      |         |             |  |  |  |  |  |
| 2018   | 2018-660003786             | KUE, KAY           | 17        | 131,979     | 1000          | 13,518                | 1,249.00      |         |             |  |  |  |  |  |
| 2017   | 2017-660003786             | KUE, KAY           | 17        | 130,874     | 1000          | 13,396                | 1,230.00      |         |             |  |  |  |  |  |
| 2016   | 2016-660003786             | KUE, KAY           | 17        | 107,836     | 1000          | 10,765                | 1,010.00      |         |             |  |  |  |  |  |
| 2015   | 2015-660003786             | MCCAMISH, TROY D & | 17        | 105,166     | 1000          | 10,422                | 940.00        |         |             |  |  |  |  |  |
| 2014   | 2014-660003786             | MCCAMISH, TROY D & | 17        | 108,297     | 1000          | 10,089                | 936.00        |         |             |  |  |  |  |  |
| 2013   | 2013-660003786             | MCCAMISH, TROY D & | 17        | 104,075     | 1000          | 9,766                 | 894.00        |         |             |  |  |  |  |  |



# Rogers

## Assessment Property Record Card for Tax Year 2026

Data provided by LISA DELOZIER County Assessor

Date 04/16/2026  
Time 23:13:56  
Page 2

| Lot Data   | Square-Foot - NBHD 1183 #1 | Primary Image |
|--|----------------------------|---------------|
| <b>Lot Size</b><br><b>Lot Count</b> 1<br><b>Units Buildable</b> 10000<br><b>Non-Ag Acres</b> 0.7123<br><b>Topography</b><br><b>Street Access</b><br><b>Utilities</b><br><b>Amenities</b> LOT SIZE ADJUSTMENT 0<br>0<br><b>Method</b> Square-Foot<br><b>Base Lot Value</b> 31,028.00 x 3.40 = 105,575<br><b>Factor Value</b><br><b>Adjustments</b> 1.0000<br><b>Lot Value</b> 105,575 |                            |               |

| Residential Data       |   |
|------------------------|---|
| <b>Type</b>            | 1 Single Family Residence                 |
| <b>Condition</b>       | 3 - Average                               |
| <b>Quality</b>         | 2.5 - Fair                                |
| <b>Architecture</b>    |   |
| <b>Style</b>           | 100% One Story                            |
| <b>Exterior Wall</b>   | 50% Veneer, Stone 50% Frame, Siding, Wood |
| <b>Base/Total Area</b> | 1,432 / 1,432                             |
| <b>Style</b>           | 100% One Story                            |
| <b>HVAC</b>            | 100% Warmed & Cooled Air                  |
| <b>Roof Cover</b>      | 1 Composition Shingle                     |
| <b>Area on Slab</b>    | 1,432                                     |
| <b>Fixture/RghIn</b>   | 11 /                                      |
| <b>Bed/F/H Bath</b>    | 3 / 2.0 /                                 |
| <b>Basement Area</b>   |   |
| <b>Garage Type</b>     | 462 Attached Garage - Unfinished 2 Stalls |
| <b>Remodel</b>         |   |
| <b>Year/Eff Age</b>    | 1978 / 36                                 |



\\tsclient\T\LOGAN\LOGAN RESIDENTIAL VI\2023-4-19\IMG\_005! 4/19/2023

| GRM Approach           |      |
|------------------------|------|
| <b>GRM Code</b>        |      |
| <b>Gross Rent</b>      | 0.00 |
| <b>Indicated Value</b> |      |

| Multiple Regression    |         |        |          |
|------------------------|---------|--------|----------|
| <b>MRA Code</b>        | 1       | Test   |          |
| <b>Adusted R</b>       | 0.8445  |        |          |
| <b>Indicated Value</b> | 153,988 | 107.53 | Per SqFt |

| Direct Comparables      |                    |
|-------------------------|--------------------|
| <b>Selection Model</b>  | A Adam Test        |
| <b>Adjustment Model</b> | 1 2022 Residential |
| <b>Comparables</b>      | 6                  |
| <b>Indicated Value</b>  | 173,920 Per SqFt   |

| Cost Approach        |           |                            |   | Manual : 01/2025 |  |  |  |
|----------------------|-----------|----------------------------|---|------------------|--|--|--|
| <b>Base Cost</b>     | 104.17    | <b>Total Misc Impr</b>     | + | 12,349           |  |  |  |
| <b>Roofing Adj</b>   | + 4.47    | <b>Garage Cost</b>         | + | 12,931           |  |  |  |
| <b>Subfloor Adj</b>  | + -1.19   | <b>Total RCN</b>           | = | 209,664          |  |  |  |
| <b>Heat/Cool Adj</b> | + 11.47   | <b>Depreciation ( 45%)</b> | - | 94,349           |  |  |  |
| <b>Plumbing Adj</b>  | + 9.84    | <b>Lump Sums</b>           | + | 0                |  |  |  |
| <b>Basement Adj</b>  | + 0.00    | <b>RCNLD</b>               | = | 115,315          |  |  |  |
| <b>Adj Base Cost</b> | = 128.76  | <b>Lot Value</b>           | + | 105,575          |  |  |  |
| <b>Total Area</b>    | x 1,432   | <b>Indicated Value</b>     | = | 220,890          |  |  |  |
| <b>Adjusted Cost</b> | = 184,384 | <b>Value Per SqFt</b>      |   | 154.25           |  |  |  |

| Value Reconciliation     |               |        |                      |
|--------------------------|---------------|--------|----------------------|
| <b>Selected Approach</b> | Cost Approach |        |                      |
| <b>Improvements</b>      | 115,315       |        |                      |
| <b>Lot Value</b>         | 105,575       |        |                      |
| <b>Indicated Value</b>   | 220,890       | 154.25 | Per SqFt             |
| <b>Agland Value</b>      |               |        |                      |
| <b>Site Improvements</b> |               |        |                      |
| <b>Total Value</b>       | 220,890       | 154.25 | Total Value Per SqFt |

| Miscellaneous Improvements |                                 |           |       |      |       |           |      |       |
|----------------------------|---------------------------------|-----------|-------|------|-------|-----------|------|-------|
| Code                       | Description                     | Sketch ID | Size  | Year | Units | Unit Cost | Depr | Value |
| FPR1                       | FIREPLACE - RESIDENTIAL 1 STORY | 0         |       | 1    | 1     | 5,095.98  |      | 5,096 |
| PRCH                       | SLAB PORCH - COVERED            | 9379      |       | 110  | 110   | 23.92     |      | 2,631 |
| PRCH                       | SLAB PORCH - COVERED            | 9380      | 14x14 |      | 196   | 23.58     |      | 4,622 |



# Rogers

## Assessment Property Record Card for Tax Year 2026

Data provided by LISA DELOZIER County Assessor

Date 04/16/2026  
 Time 23:13:56  
 Page 3

Sketch Image

660003786

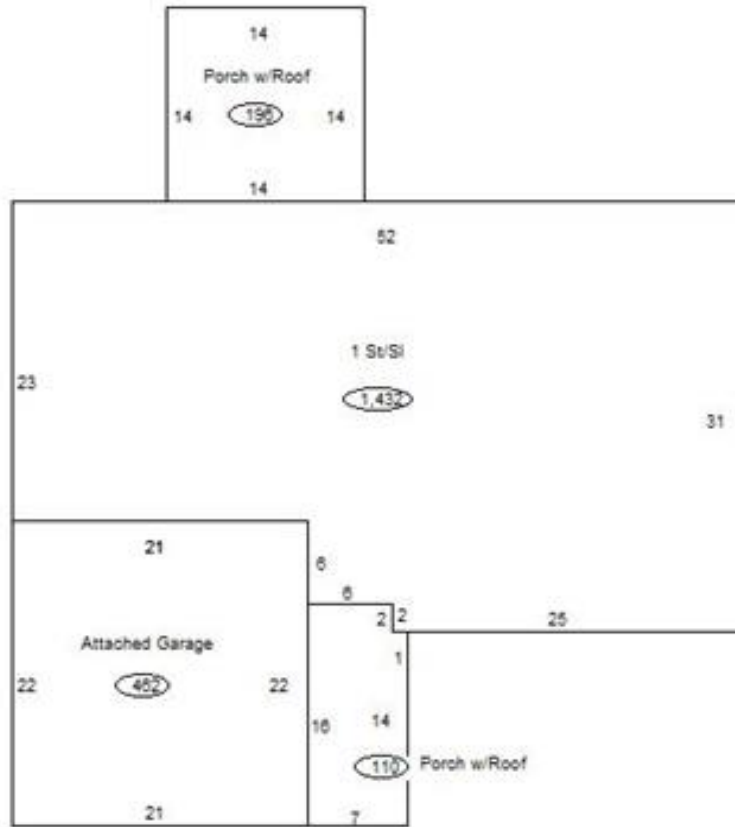

### Sketch Vector Information

| Sequence                   | Code | Type | Built Over | Scale | Section Label   | Base Area | Multiplier | Total Area |
|----------------------------|------|------|------------|-------|-----------------|-----------|------------|------------|
| 1                          | R    | 1    | Slab       | 13    | 1 St/Sl         | 1,432     | 1.000      | 1,432      |
| 2                          | G    | 1    |            | 13    | Attached Garage | 462       | 1.000      | 462        |
| 3                          | M    | PRCH |            | 13    | SLBC            | 110       | 1.000      | 110        |
| 4                          | M    | PRCH |            | 13    | SLBC            | 196       | 1.000      | 196        |
| <b>Total Building Area</b> |      |      |            |       |                 | 1,432     |            | 1,432      |



# Rogers

## Assessment Property Record Card for Tax Year 2026

Data provided by LISA DELOZIER County Assessor

Date 04/16/2026  
Time 23:13:56  
Page 4

660003786

### Outbuildings/Site Improvements

| Building Image   | Code | Description         | Dimensions     | Floor | Roofing                  | Total Units |
|--|------|---------------------|----------------|-------|--------------------------|-------------|
|  | STF  | STG FAIR            | 0x0x0          |       |                          |             |
|  | Qual | 2                   | Cond           | Year  | Eff Age                  |             |
|  |      | Valuation Summary   | Modifier Total | RCN   | Depr (100% Phys/ % Func) | RCNLD       |
|  |      | Base Cost (4.68 x ) |                |       |                          |             |