



# Rogers

## Assessment Property Record Card for Tax Year 2026

Data provided by LISA DELOZIER County Assessor

Date 04/17/2026  
Time 02:06:55  
Page 1

Assessment Data					Primary Image																																																																																																																				
<b>Account</b> 660003823 <b>Parcel ID</b> 000000-00-0-10050-004-0006 <b>Cadastral ID</b> 05-21-16-00680 <b>Property Type</b> REAL - Real Property <b>Property Class</b> URP VI Area 1 <b>Tax Area</b> 17 - CLAREMORE OT <b>Name ID</b> 260089 GRACE, DENNIS PETER &  DEBRA LYNN 1108 W 20TH ST CLAREMORE OK 74017-0000  <b>Parcel Location</b> <b>Situs</b> 01108 W 20TH ST N <b>Subdivision</b> CHAMBERS TERRACE II <b>Lot/Block</b> 0006 / 0004 <b>Parcel Size</b> 1 - Lots <b>Sec/Twn/Rng</b> 5 / 21 / 16 / 5 <b>Neighborhood</b> 1183 - R-V01-SW CLAREMORE <b>School District</b> S001 - CLAREMORE SCHOOLS																																																																																																																									
<b>Legal Description</b> Lot/Long: 36.32890443 -95.62162773																																																																																																																									
<b>Building Permits</b>					<table border="1"> <thead> <tr> <th>Number</th> <th>Description</th> <th>Opened</th> <th>Closed</th> <th>Amount</th> </tr> </thead> <tbody> <tr> <td colspan="5" style="height: 100px;"> </td> </tr> </tbody> </table>					Number	Description	Opened	Closed	Amount																																																																																																											
Number	Description	Opened	Closed	Amount																																																																																																																					
<b>Exemptions</b>					<b>Sale History</b>																																																																																																																				
<table border="1"> <thead> <tr> <th>Code</th> <th>Type</th> <th>Active</th> <th>Maximum</th> <th>Exemption</th> </tr> </thead> <tbody> <tr> <td>H</td> <td>Homestead</td> <td>Yes</td> <td>1,000</td> <td>1,000</td> </tr> </tbody> </table>					Code	Type	Active	Maximum	Exemption	H	Homestead	Yes	1,000	1,000	<table border="1"> <thead> <tr> <th>Bk/Pg</th> <th>Grantor</th> <th>Date</th> <th>Price</th> <th>Code</th> </tr> </thead> <tbody> <tr> <td>976/510</td> <td>WEAVER, GARY G</td> <td>12/16/1994</td> <td>68,500</td> <td>No</td> </tr> <tr> <td>904/229</td> <td>SELLER</td> <td>12/30/1992</td> <td>53,500</td> <td>No</td> </tr> <tr> <td>877/383</td> <td>FIRST FEDERAL SAVINGS</td> <td>03/27/1992</td> <td>0</td> <td>No</td> </tr> </tbody> </table>					Bk/Pg	Grantor	Date	Price	Code	976/510	WEAVER, GARY G	12/16/1994	68,500	No	904/229	SELLER	12/30/1992	53,500	No	877/383	FIRST FEDERAL SAVINGS	03/27/1992	0	No																																																																																		
Code	Type	Active	Maximum	Exemption																																																																																																																					
H	Homestead	Yes	1,000	1,000																																																																																																																					
Bk/Pg	Grantor	Date	Price	Code																																																																																																																					
976/510	WEAVER, GARY G	12/16/1994	68,500	No																																																																																																																					
904/229	SELLER	12/30/1992	53,500	No																																																																																																																					
877/383	FIRST FEDERAL SAVINGS	03/27/1992	0	No																																																																																																																					
<b>Parcel Valuation</b>																																																																																																																									
<table border="1"> <thead> <tr> <th>Source</th> <th>REAL</th> <th>Fair Cash</th> <th>Capped</th> <th>Asmnt Level</th> <th>Assessed</th> <th>Levy Rate</th> <th>92.430</th> <th>Current Tax</th> </tr> </thead> <tbody> <tr> <td>Remove Cap</td> <td>0</td> <td>Land Value 46,296</td> <td>25,707</td> <td>11%</td> <td>2,828</td> <td>Assessed</td> <td>15,502</td> <td>1,432.85</td> </tr> <tr> <td>Year Frozen</td> <td>0</td> <td>Improvements 127,896</td> <td>115,221</td> <td></td> <td>12,674</td> <td>Penalty</td> <td>0</td> <td></td> </tr> <tr> <td>Uncapped Value</td> <td>0</td> <td>Mobile Home 0</td> <td>0</td> <td></td> <td>0</td> <td>Exemption</td> <td>1,000</td> <td>-93.00</td> </tr> <tr> <td>TIF Project ID</td> <td>0</td> <td>Total Value 174,192</td> <td>140,928</td> <td></td> <td>15,502</td> <td>Total Taxable</td> <td>14,502</td> <td>1,340.00</td> </tr> </tbody> </table>		Source	REAL	Fair Cash	Capped	Asmnt Level	Assessed	Levy Rate	92.430	Current Tax	Remove Cap	0	Land Value 46,296	25,707	11%	2,828	Assessed	15,502	1,432.85	Year Frozen	0	Improvements 127,896	115,221		12,674	Penalty	0		Uncapped Value	0	Mobile Home 0	0		0	Exemption	1,000	-93.00	TIF Project ID	0	Total Value 174,192	140,928		15,502	Total Taxable	14,502	1,340.00																																																																											
Source	REAL	Fair Cash	Capped	Asmnt Level	Assessed	Levy Rate	92.430	Current Tax																																																																																																																	
Remove Cap	0	Land Value 46,296	25,707	11%	2,828	Assessed	15,502	1,432.85																																																																																																																	
Year Frozen	0	Improvements 127,896	115,221		12,674	Penalty	0																																																																																																																		
Uncapped Value	0	Mobile Home 0	0		0	Exemption	1,000	-93.00																																																																																																																	
TIF Project ID	0	Total Value 174,192	140,928		15,502	Total Taxable	14,502	1,340.00																																																																																																																	
<b>Assessment History</b>																																																																																																																									
<table border="1"> <thead> <tr> <th>Tax Year</th> <th>Statement Number</th> <th>Billed Owner</th> <th>Tax Area</th> <th>Total Value</th> <th>Exemptions</th> <th>Taxable Value</th> <th>Billed Tax</th> </tr> </thead> <tbody> <tr><td>2025</td><td>2025-660003823</td><td>GRACE, DENNIS PETER &amp;</td><td>17</td><td>169,913</td><td>1000</td><td>14,050</td><td>1,299.00</td></tr> <tr><td>2024</td><td>2024-660003823</td><td>GRACE, DENNIS PETER &amp;</td><td>17</td><td>172,431</td><td>1000</td><td>13,612</td><td>1,258.00</td></tr> <tr><td>2023</td><td>2023-660003823</td><td>GRACE, DENNIS PETER &amp;</td><td>17</td><td>143,012</td><td>1000</td><td>13,187</td><td>1,208.00</td></tr> <tr><td>2022</td><td>2022-660003823</td><td>GRACE, DENNIS PETER &amp;</td><td>17</td><td>129,717</td><td>1000</td><td>12,774</td><td>1,182.00</td></tr> <tr><td>2021</td><td>2021-660003823</td><td>GRACE, DENNIS PETER &amp;</td><td>17</td><td>134,027</td><td>1000</td><td>12,372</td><td>1,092.00</td></tr> <tr><td>2020</td><td>2020-660003823</td><td>GRACE, DENNIS PETER &amp;</td><td>17</td><td>129,379</td><td>1000</td><td>11,983</td><td>1,097.00</td></tr> <tr><td>2019</td><td>2019-660003823</td><td>GRACE, DENNIS PETER &amp;</td><td>17</td><td>114,590</td><td>1000</td><td>11,605</td><td>1,075.00</td></tr> <tr><td>2018</td><td>2018-660003823</td><td>GRACE, DENNIS PETER &amp;</td><td>17</td><td>119,260</td><td>1000</td><td>11,978</td><td>1,107.00</td></tr> <tr><td>2017</td><td>2017-660003823</td><td>GRACE, DENNIS PETER &amp;</td><td>17</td><td>118,275</td><td>1000</td><td>11,600</td><td>1,065.00</td></tr> <tr><td>2016</td><td>2016-660003823</td><td>GRACE, DENNIS PETER &amp;</td><td>17</td><td>115,299</td><td>1000</td><td>11,233</td><td>1,054.00</td></tr> <tr><td>2015</td><td>2015-660003823</td><td>GRACE, DENNIS PETER &amp;</td><td>17</td><td>111,786</td><td>1000</td><td>10,877</td><td>981.00</td></tr> <tr><td>2014</td><td>2014-660003823</td><td>GRACE, DENNIS PETER &amp;</td><td>17</td><td>115,084</td><td>1000</td><td>10,531</td><td>977.00</td></tr> <tr><td>2013</td><td>2013-660003823</td><td>GRACE, DENNIS PETER &amp;</td><td>17</td><td>108,887</td><td>1000</td><td>10,195</td><td>933.00</td></tr> </tbody> </table>										Tax Year	Statement Number	Billed Owner	Tax Area	Total Value	Exemptions	Taxable Value	Billed Tax	2025	2025-660003823	GRACE, DENNIS PETER &	17	169,913	1000	14,050	1,299.00	2024	2024-660003823	GRACE, DENNIS PETER &	17	172,431	1000	13,612	1,258.00	2023	2023-660003823	GRACE, DENNIS PETER &	17	143,012	1000	13,187	1,208.00	2022	2022-660003823	GRACE, DENNIS PETER &	17	129,717	1000	12,774	1,182.00	2021	2021-660003823	GRACE, DENNIS PETER &	17	134,027	1000	12,372	1,092.00	2020	2020-660003823	GRACE, DENNIS PETER &	17	129,379	1000	11,983	1,097.00	2019	2019-660003823	GRACE, DENNIS PETER &	17	114,590	1000	11,605	1,075.00	2018	2018-660003823	GRACE, DENNIS PETER &	17	119,260	1000	11,978	1,107.00	2017	2017-660003823	GRACE, DENNIS PETER &	17	118,275	1000	11,600	1,065.00	2016	2016-660003823	GRACE, DENNIS PETER &	17	115,299	1000	11,233	1,054.00	2015	2015-660003823	GRACE, DENNIS PETER &	17	111,786	1000	10,877	981.00	2014	2014-660003823	GRACE, DENNIS PETER &	17	115,084	1000	10,531	977.00	2013	2013-660003823	GRACE, DENNIS PETER &	17	108,887	1000	10,195	933.00
Tax Year	Statement Number	Billed Owner	Tax Area	Total Value	Exemptions	Taxable Value	Billed Tax																																																																																																																		
2025	2025-660003823	GRACE, DENNIS PETER &	17	169,913	1000	14,050	1,299.00																																																																																																																		
2024	2024-660003823	GRACE, DENNIS PETER &	17	172,431	1000	13,612	1,258.00																																																																																																																		
2023	2023-660003823	GRACE, DENNIS PETER &	17	143,012	1000	13,187	1,208.00																																																																																																																		
2022	2022-660003823	GRACE, DENNIS PETER &	17	129,717	1000	12,774	1,182.00																																																																																																																		
2021	2021-660003823	GRACE, DENNIS PETER &	17	134,027	1000	12,372	1,092.00																																																																																																																		
2020	2020-660003823	GRACE, DENNIS PETER &	17	129,379	1000	11,983	1,097.00																																																																																																																		
2019	2019-660003823	GRACE, DENNIS PETER &	17	114,590	1000	11,605	1,075.00																																																																																																																		
2018	2018-660003823	GRACE, DENNIS PETER &	17	119,260	1000	11,978	1,107.00																																																																																																																		
2017	2017-660003823	GRACE, DENNIS PETER &	17	118,275	1000	11,600	1,065.00																																																																																																																		
2016	2016-660003823	GRACE, DENNIS PETER &	17	115,299	1000	11,233	1,054.00																																																																																																																		
2015	2015-660003823	GRACE, DENNIS PETER &	17	111,786	1000	10,877	981.00																																																																																																																		
2014	2014-660003823	GRACE, DENNIS PETER &	17	115,084	1000	10,531	977.00																																																																																																																		
2013	2013-660003823	GRACE, DENNIS PETER &	17	108,887	1000	10,195	933.00																																																																																																																		



# Rogers

## Assessment Property Record Card for Tax Year 2026

Data provided by LISA DELOZIER County Assessor

Date 04/17/2026  
Time 02:06:55  
Page 2

Lot Data	Square-Foot - NBHD 1183 #1	Primary Image
Lot Size		
Lot Count	1	
Units Buildable	10000	
Non-Ag Acres	0.2175	
Topography		
Street Access		
Utilities		
Amenities	LOT SIZE ADJUSTMENT	
	0	
	0	
Method	Square-Foot	
Base Lot Value	9,472.00 x 4.89 = 46,296	
Factor Value		
Adjustments	1.0000	
Lot Value	46,296	

Residential Data	
Type	1 Single Family Residence
Condition	3 - Average
Quality	2.5 - Fair
Architecture	
Style	100% One Story
Exterior Wall	100% Veneer, Stone
Base/Total Area	1,464 / 1,464
Style	100% One Story
HVAC	100% Warmed & Cooled Air
Roof Cover	1 Composition Shingle
Area on Slab	1,464
Fixture/RghIn	11 /
Bed/F/H Bath	3 / 2.0 /
Basement Area	
Garage Type	504 Attached Garage - Unfinished 2 Stalls
Remodel	
Year/Eff Age	1980 / 35

Cost Approach		Manual : 01/2025	
Base Cost	113.50	Total Misc Impr	+ 9,444
Roofing Adj	+ 4.55	Garage Cost	+ 13,810
Subfloor Adj	+ -1.18	Total RCN	= 225,213
Heat/Cool Adj	+ 11.47	Depreciation ( 44%)	- 99,094
Plumbing Adj	+ 9.61	Lump Sums	+ 1,777
Basement Adj	+ 0.00	RCNLD	= 127,896
Adj Base Cost	= 137.95	Lot Value	+ 46,296
Total Area	x 1,464	Indicated Value	= 174,192
Adjusted Cost	= 201,959	Value Per SqFt	118.98

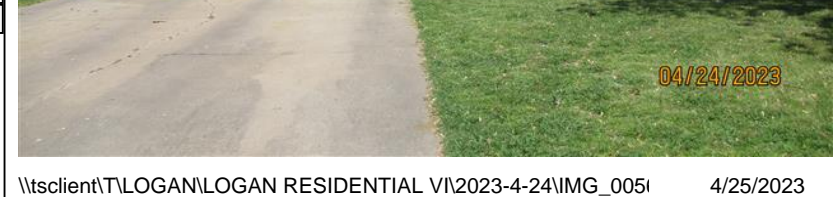

\\tsclient\TLOGAN\LOGAN RESIDENTIAL VI\2023-4-24\IMG\_005I 4/25/2023

GRM Approach	
GRM Code	
Gross Rent	0.00
Indicated Value	

Multiple Regression			
MRA Code	1	Test	
Adusted R	0.8445		
Indicated Value	161,583	110.37	Per SqFt

Direct Comparables	
Selection Model	A Adam Test
Adjustment Model	1 2022 Residential
Comparables	6
Indicated Value	178,390 Per SqFt

Value Reconciliation			
Selected Approach	Cost Approach		
Improvements	127,896		
Lot Value	46,296		
Indicated Value	174,192	118.98	Per SqFt
Agland Value			
Site Improvements			
Total Value	174,192	118.98	Total Value Per SqFt

Miscellaneous Improvements								
Code	Description	Sketch ID	Size	Year	Units	Unit Cost	Depr	Value
FPR1	FIREPLACE - RESIDENTIAL 1 STORY	0		1	1	5,095.98		5,096
PRCH	SLAB PORCH - COVERED	9527		184	184	23.63		4,348
WODO	WOOD DECK - OPEN	9528	12x10		120	24.68	40%	1,777



# Rogers

## Assessment Property Record Card for Tax Year 2026

Data provided by LISA DELOZIER County Assessor

Date 04/17/2026  
 Time 02:06:55  
 Page 3

### Sketch Image

660003823

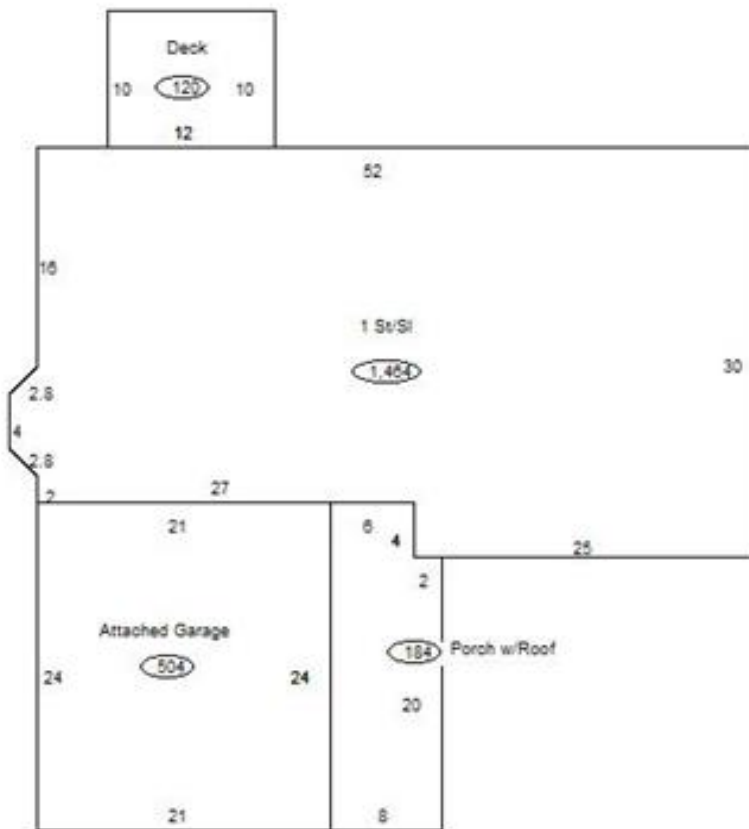

### Sketch Vector Information

Sequence	Code	Type	Built Over	Scale	Section Label	Base Area	Multiplier	Total Area
1	R	1	Slab	13	1 St/SI	1,464	1.000	1,464
2	G	1		13	Attached Garage	504	1.000	504
3	M	PRCH		13	SLBC	184	1.000	184
4	M	WODO		13	WODO	120	1.000	120
<b>Total Building Area</b>						1,464		1,464