



Rogers

Assessment Property Record Card for Tax Year 2026

Data provided by LISA DELOZIER County Assessor

Date 04/17/2026
Time 02:25:23
Page 1

Assessment Data					Primary Image																																																																																																																				
Account 660003871 Parcel ID 000000-00-0-10350-002-0008 Cadastral ID 05-21-16-01160 Property Type REAL - Real Property Property Class URP VI Area 1 Tax Area 17 - CLAREMORE OT Name ID 296836 REED, ROBERT G III & CHELSEA L 18805 TIMBERLAKE DR CLAREMORE OK 74017-0000																																																																																																																									
Parcel Location Situs 01634 N LEE ST Subdivision PARKWAY Lot/Block 0008 / 0002 Parcel Size 1 - Lots Sec/Twn/Rng 5 / 21 / 16 / 5 Neighborhood 1183 - R-V01-SW CLAREMORE School District S001 - CLAREMORE SCHOOLS																																																																																																																									
Legal Description Lot/Long: 36.32376065 -95.62389987 LOT 8 BLOCK 2 PARKWAY					Building Permits <table border="1"> <thead> <tr> <th>Number</th> <th>Description</th> <th>Opened</th> <th>Closed</th> <th>Amount</th> </tr> </thead> <tbody> <tr> <td colspan="5"> </td> </tr> </tbody> </table>					Number	Description	Opened	Closed	Amount																																																																																																											
Number	Description	Opened	Closed	Amount																																																																																																																					
Exemptions <table border="1"> <thead> <tr> <th>Code</th> <th>Type</th> <th>Active</th> <th>Maximum</th> <th>Exemption</th> </tr> </thead> <tbody> <tr> <td colspan="5"> </td> </tr> </tbody> </table>					Code	Type	Active	Maximum	Exemption						Sale History <table border="1"> <thead> <tr> <th>Bk/Pg</th> <th>Grantor</th> <th>Date</th> <th>Price</th> <th>Code</th> </tr> </thead> <tbody> <tr> <td>2166/928</td> <td>STIMSON, TERRANCE J &</td> <td>03/15/2011</td> <td>160,000</td> <td>YES</td> </tr> <tr> <td>785/484</td> <td></td> <td></td> <td>8,000</td> <td>No</td> </tr> </tbody> </table>					Bk/Pg	Grantor	Date	Price	Code	2166/928	STIMSON, TERRANCE J &	03/15/2011	160,000	YES	785/484			8,000	No																																																																																							
Code	Type	Active	Maximum	Exemption																																																																																																																					
Bk/Pg	Grantor	Date	Price	Code																																																																																																																					
2166/928	STIMSON, TERRANCE J &	03/15/2011	160,000	YES																																																																																																																					
785/484			8,000	No																																																																																																																					
Parcel Valuation <table border="1"> <thead> <tr> <th>Source</th> <th>REAL</th> <th>Fair Cash</th> <th>Capped</th> <th>Asmnt Level</th> <th>Assessed</th> <th>Levy Rate</th> <th>92.430</th> <th>Current Tax</th> </tr> </thead> <tbody> <tr> <td>Remove Cap</td> <td></td> <td>Land Value 45,507</td> <td>38,785</td> <td>11%</td> <td>4,266</td> <td>Assessed</td> <td>22,422</td> <td>2,072.47</td> </tr> <tr> <td>Year Frozen</td> <td>0</td> <td>Improvements 165,050</td> <td>165,050</td> <td></td> <td>18,156</td> <td>Penalty</td> <td>0</td> <td></td> </tr> <tr> <td>Uncapped Value</td> <td>0</td> <td>Mobile Home 0</td> <td>0</td> <td></td> <td>0</td> <td>Exemption</td> <td>0</td> <td>0.00</td> </tr> <tr> <td>TIF Project ID</td> <td>0</td> <td>Total Value 210,557</td> <td>203,835</td> <td></td> <td>22,422</td> <td>Total Taxable</td> <td>22,422</td> <td>2,072.00</td> </tr> </tbody> </table>										Source	REAL	Fair Cash	Capped	Asmnt Level	Assessed	Levy Rate	92.430	Current Tax	Remove Cap		Land Value 45,507	38,785	11%	4,266	Assessed	22,422	2,072.47	Year Frozen	0	Improvements 165,050	165,050		18,156	Penalty	0		Uncapped Value	0	Mobile Home 0	0		0	Exemption	0	0.00	TIF Project ID	0	Total Value 210,557	203,835		22,422	Total Taxable	22,422	2,072.00																																																																			
Source	REAL	Fair Cash	Capped	Asmnt Level	Assessed	Levy Rate	92.430	Current Tax																																																																																																																	
Remove Cap		Land Value 45,507	38,785	11%	4,266	Assessed	22,422	2,072.47																																																																																																																	
Year Frozen	0	Improvements 165,050	165,050		18,156	Penalty	0																																																																																																																		
Uncapped Value	0	Mobile Home 0	0		0	Exemption	0	0.00																																																																																																																	
TIF Project ID	0	Total Value 210,557	203,835		22,422	Total Taxable	22,422	2,072.00																																																																																																																	
Assessment History <table border="1"> <thead> <tr> <th>Tax Year</th> <th>Statement Number</th> <th>Billed Owner</th> <th>Tax Area</th> <th>Total Value</th> <th>Exemptions</th> <th>Taxable Value</th> <th>Billed Tax</th> </tr> </thead> <tbody> <tr><td>2025</td><td>2025-660003871</td><td>REED, ROBERT G III &</td><td>17</td><td>204,857</td><td>0</td><td>21,355</td><td>1,974.00</td></tr> <tr><td>2024</td><td>2024-660003871</td><td>REED, ROBERT G III &</td><td>17</td><td>206,178</td><td>0</td><td>20,337</td><td>1,880.00</td></tr> <tr><td>2023</td><td>2023-660003871</td><td>REED, ROBERT G III &</td><td>17</td><td>177,231</td><td>0</td><td>19,369</td><td>1,774.00</td></tr> <tr><td>2022</td><td>2022-660003871</td><td>REED, ROBERT G III &</td><td>17</td><td>167,697</td><td>0</td><td>18,447</td><td>1,708.00</td></tr> <tr><td>2021</td><td>2021-660003871</td><td>REED, ROBERT G III &</td><td>17</td><td>187,433</td><td>0</td><td>20,618</td><td>1,821.00</td></tr> <tr><td>2020</td><td>2020-660003871</td><td>REED, ROBERT G III &</td><td>17</td><td>188,359</td><td>0</td><td>20,623</td><td>1,888.00</td></tr> <tr><td>2019</td><td>2019-660003871</td><td>REED, ROBERT G III &</td><td>17</td><td>178,552</td><td>0</td><td>19,641</td><td>1,819.00</td></tr> <tr><td>2018</td><td>2018-660003871</td><td>REED, ROBERT G III &</td><td>17</td><td>185,981</td><td>0</td><td>20,458</td><td>1,890.00</td></tr> <tr><td>2017</td><td>2017-660003871</td><td>REED, ROBERT G III &</td><td>17</td><td>184,347</td><td>0</td><td>20,278</td><td>1,862.00</td></tr> <tr><td>2016</td><td>2016-660003871</td><td>REED, ROBERT G III &</td><td>17</td><td>175,967</td><td>0</td><td>19,356</td><td>1,817.00</td></tr> <tr><td>2015</td><td>2015-660003871</td><td>REED, ROBERT G III &</td><td>17</td><td>170,119</td><td>0</td><td>18,713</td><td>1,688.00</td></tr> <tr><td>2014</td><td>2014-660003871</td><td>REED, ROBERT G III &</td><td>17</td><td>173,049</td><td>0</td><td>18,962</td><td>1,758.00</td></tr> <tr><td>2013</td><td>2013-660003871</td><td>REED, ROBERT G III &</td><td>17</td><td>164,175</td><td>0</td><td>18,059</td><td>1,653.00</td></tr> </tbody> </table>										Tax Year	Statement Number	Billed Owner	Tax Area	Total Value	Exemptions	Taxable Value	Billed Tax	2025	2025-660003871	REED, ROBERT G III &	17	204,857	0	21,355	1,974.00	2024	2024-660003871	REED, ROBERT G III &	17	206,178	0	20,337	1,880.00	2023	2023-660003871	REED, ROBERT G III &	17	177,231	0	19,369	1,774.00	2022	2022-660003871	REED, ROBERT G III &	17	167,697	0	18,447	1,708.00	2021	2021-660003871	REED, ROBERT G III &	17	187,433	0	20,618	1,821.00	2020	2020-660003871	REED, ROBERT G III &	17	188,359	0	20,623	1,888.00	2019	2019-660003871	REED, ROBERT G III &	17	178,552	0	19,641	1,819.00	2018	2018-660003871	REED, ROBERT G III &	17	185,981	0	20,458	1,890.00	2017	2017-660003871	REED, ROBERT G III &	17	184,347	0	20,278	1,862.00	2016	2016-660003871	REED, ROBERT G III &	17	175,967	0	19,356	1,817.00	2015	2015-660003871	REED, ROBERT G III &	17	170,119	0	18,713	1,688.00	2014	2014-660003871	REED, ROBERT G III &	17	173,049	0	18,962	1,758.00	2013	2013-660003871	REED, ROBERT G III &	17	164,175	0	18,059	1,653.00
Tax Year	Statement Number	Billed Owner	Tax Area	Total Value	Exemptions	Taxable Value	Billed Tax																																																																																																																		
2025	2025-660003871	REED, ROBERT G III &	17	204,857	0	21,355	1,974.00																																																																																																																		
2024	2024-660003871	REED, ROBERT G III &	17	206,178	0	20,337	1,880.00																																																																																																																		
2023	2023-660003871	REED, ROBERT G III &	17	177,231	0	19,369	1,774.00																																																																																																																		
2022	2022-660003871	REED, ROBERT G III &	17	167,697	0	18,447	1,708.00																																																																																																																		
2021	2021-660003871	REED, ROBERT G III &	17	187,433	0	20,618	1,821.00																																																																																																																		
2020	2020-660003871	REED, ROBERT G III &	17	188,359	0	20,623	1,888.00																																																																																																																		
2019	2019-660003871	REED, ROBERT G III &	17	178,552	0	19,641	1,819.00																																																																																																																		
2018	2018-660003871	REED, ROBERT G III &	17	185,981	0	20,458	1,890.00																																																																																																																		
2017	2017-660003871	REED, ROBERT G III &	17	184,347	0	20,278	1,862.00																																																																																																																		
2016	2016-660003871	REED, ROBERT G III &	17	175,967	0	19,356	1,817.00																																																																																																																		
2015	2015-660003871	REED, ROBERT G III &	17	170,119	0	18,713	1,688.00																																																																																																																		
2014	2014-660003871	REED, ROBERT G III &	17	173,049	0	18,962	1,758.00																																																																																																																		
2013	2013-660003871	REED, ROBERT G III &	17	164,175	0	18,059	1,653.00																																																																																																																		



Rogers

Assessment Property Record Card for Tax Year 2026

Data provided by LISA DELOZIER County Assessor

Date 04/17/2026
 Time 02:25:23
 Page 2

Lot Data		Square-Foot - NBHD 1183 #1	
Lot Size			
Lot Count	1		
Units Buildable	10000		
Non-Ag Acres	0.2109		
Topography			
Street Access			
Utilities			
Amenities	LOT SIZE ADJUSTMENT	0	0
Method	Square-Foot		
Base Lot Value	9,185.00 x 4.95 = 45,507		
Factor Value			
Adjustments	1.0000		
Lot Value	45,507		



\\tsclient\T\TOMMY DUNLAP\New folder (176)\IMG_0050.JPG 4/19/2023

Residential Data	
Type	5 Duplex
Condition	3 - Average
Quality	2.5 - Fair
Architecture	R3 Res Nbhd 3
Style	100% 1 1/2 Story Finished
Exterior Wall	100% Frame, Siding, Vinyl
Base/Total Area	1,484 / 2,104
Style	100% 1 1/2 Story Finished
HVAC	100% Warmed & Cooled Air
Roof Cover	1 Composition Shingle
Area on Slab	1,484
Fixture/RghIn	17 /
Bed/F/H Bath	6 / 4.0 /
Basement Area	
Garage Type	528 Attached Garage - Unfinished 2 Stalls
Remodel	
Year/Eff Age	1990 / 27

GRM Approach	
GRM Code	
Gross Rent	0.00
Indicated Value	

Multiple Regression			
MRA Code	1 Test		
Adusted R	0.8445		
Indicated Value	213,064	101.27	Per SqFt

Direct Comparables	
Selection Model	A Adam Test
Adjustment Model	1 2022 Residential
Comparables	
Indicated Value	

Cost Approach		Manual : 01/2025	
Base Cost	96.65	Total Misc Impr	+ 8,154
Roofing Adj	+ 2.84	Garage Cost	+ 18,459
Subfloor Adj	+ -0.33	Total RCN	= 279,745
Heat/Cool Adj	+ 11.22	Depreciation (41%)	- 114,695
Plumbing Adj	+ 9.93	Lump Sums	+ 0
Basement Adj	+ 0.00	RCNLD	= 165,050
Adj Base Cost	= 120.31	Lot Value	+ 45,507
Total Area	x 2,104	Indicated Value	= 210,557
Adjusted Cost	= 253,132	Value Per SqFt	100.07

Value Reconciliation			
Selected Approach	Cost Approach		
Improvements	165,050		
Lot Value	45,507		
Indicated Value	210,557	100.07	Per SqFt
Agland Value			
Site Improvements			
Total Value	210,557	100.07	Total Value Per SqFt

Miscellaneous Improvements								
Code	Description	Sketch ID	Size	Year	Units	Unit Cost	Depr	Value
PRCH	SLAB PORCH - COVERED	9714	10x5		50	25.92		1,296
PRCH	SLAB PORCH - COVERED	9715	10x5		50	25.92		1,296
PRCH	SLAB PORCH - COVERED	9716	12x9		108	25.75		2,781
PRCH	SLAB PORCH - COVERED	9717	12x9		108	25.75		2,781



Rogers

Assessment Property Record Card for Tax Year 2026

Data provided by LISA DELOZIER County Assessor

Date 04/17/2026
 Time 02:25:23
 Page 3

Sketch Image

660003871

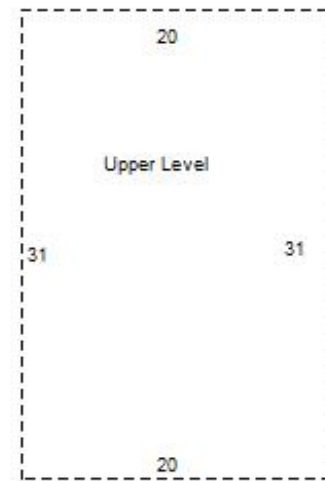
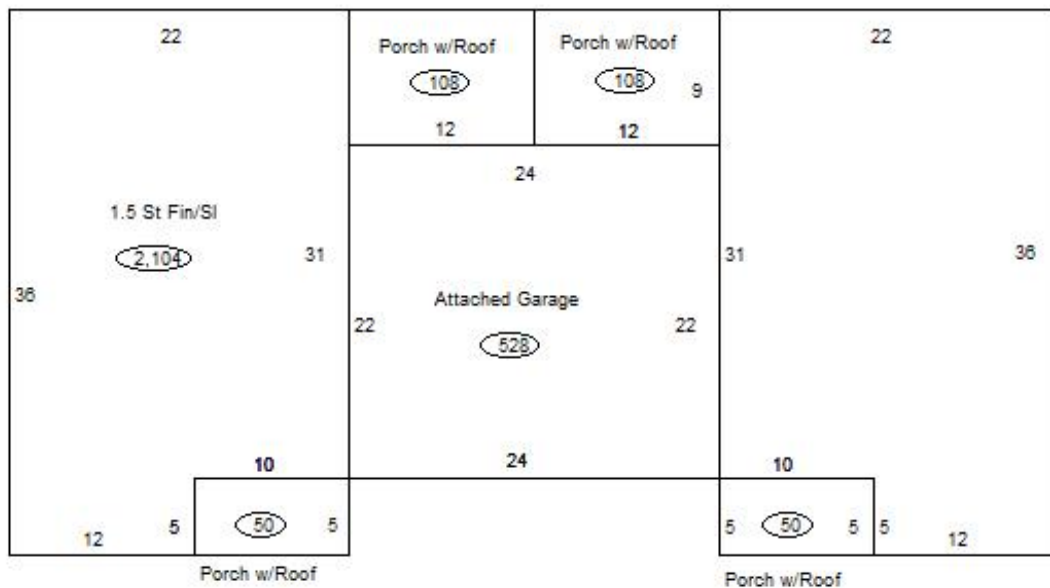

Sketch Vector Information

Sequence	Code	Type	Built Over	Scale	Section Label	Base Area	Multiplier	Total Area
1	R	5	Slab	13	1.5 St Fin/Sl	1,484	1.418	2,104
2	G	1		13	Attached Garage	528	1.000	528
3	M	PRCH		13	SLBC	50	1.000	50
4	M	PRCH		13	SLBC	50	1.000	50
5	M	PRCH		13	SLBC	108	1.000	108
6	M	PRCH		13	SLBC	108	1.000	108
7	U	^UL	Overhang	13	Upper Level	620	1.000	620
Total Building Area						1,484		2,104