



Rogers

Assessment Property Record Card for Tax Year 2026

Data provided by LISA DELOZIER County Assessor

Date 04/17/2026
 Time 06:48:15
 Page 1

Assessment Data					Primary Image																																																																																																																				
Account 660003931 Parcel ID 000000-00-0-10772-002-0022 Cadastral ID 05-21-16-03340 Property Type REAL - Real Property Property Class URP VI Area 1 Tax Area 17 - CLAREMORE OT Name ID 304723 GIBSON, JOHN A & EVELYN A BULL 808 W 23RD ST N CLAREMORE OK 74017-0000																																																																																																																									
Parcel Location Situs 00808 W 23RD ST N Subdivision SPRINGBROOK ESTATES I Lot/Block 0022 / 0002 Parcel Size 1 - Lots Sec/Twn/Rng 5 / 21 / 16 / 5 Neighborhood 1183 - R-V01-SW CLAREMORE School District S001 - CLAREMORE SCHOOLS																																																																																																																									
Legal Description Lot/Long: 36.33162925 -95.61653589					Building Permits																																																																																																																				
LOT 22 BLOCK 2 SPRINGBROOK EST I					<table border="1"> <thead> <tr> <th>Number</th> <th>Description</th> <th>Opened</th> <th>Closed</th> <th>Amount</th> </tr> </thead> <tbody> <tr> <td>2187</td> <td></td> <td>01/2001</td> <td>11/2001</td> <td></td> </tr> </tbody> </table>					Number	Description	Opened	Closed	Amount	2187		01/2001	11/2001																																																																																																							
Number	Description	Opened	Closed	Amount																																																																																																																					
2187		01/2001	11/2001																																																																																																																						
Exemptions					Sale History																																																																																																																				
<table border="1"> <thead> <tr> <th>Code</th> <th>Type</th> <th>Active</th> <th>Maximum</th> <th>Exemption</th> </tr> </thead> <tbody> <tr> <td>H</td> <td>Homestead</td> <td>Yes</td> <td>1,000</td> <td>1,000</td> </tr> </tbody> </table>					Code	Type	Active	Maximum	Exemption	H	Homestead	Yes	1,000	1,000	<table border="1"> <thead> <tr> <th>Bk/Pg</th> <th>Grantor</th> <th>Date</th> <th>Price</th> <th>Code</th> </tr> </thead> <tbody> <tr> <td>2168/808</td> <td>MCCONNELL, JESSICA D &</td> <td>04/18/2011</td> <td>111,000</td> <td>YES</td> </tr> <tr> <td>1703/250</td> <td>HUSONG, CARMON JOAN</td> <td>08/12/2005</td> <td>102,000</td> <td>YES</td> </tr> <tr> <td>1152/529</td> <td>WAREHIME, LELAND R &</td> <td>01/19/1999</td> <td>75,500</td> <td>Yes</td> </tr> <tr> <td>1065/773</td> <td>KELLER, BOB G TRUST</td> <td>05/16/1997</td> <td>7,000</td> <td>No</td> </tr> </tbody> </table>					Bk/Pg	Grantor	Date	Price	Code	2168/808	MCCONNELL, JESSICA D &	04/18/2011	111,000	YES	1703/250	HUSONG, CARMON JOAN	08/12/2005	102,000	YES	1152/529	WAREHIME, LELAND R &	01/19/1999	75,500	Yes	1065/773	KELLER, BOB G TRUST	05/16/1997	7,000	No																																																																													
Code	Type	Active	Maximum	Exemption																																																																																																																					
H	Homestead	Yes	1,000	1,000																																																																																																																					
Bk/Pg	Grantor	Date	Price	Code																																																																																																																					
2168/808	MCCONNELL, JESSICA D &	04/18/2011	111,000	YES																																																																																																																					
1703/250	HUSONG, CARMON JOAN	08/12/2005	102,000	YES																																																																																																																					
1152/529	WAREHIME, LELAND R &	01/19/1999	75,500	Yes																																																																																																																					
1065/773	KELLER, BOB G TRUST	05/16/1997	7,000	No																																																																																																																					
Parcel Valuation																																																																																																																									
<table border="1"> <thead> <tr> <th>Source</th> <th>REAL</th> <th>Fair Cash</th> <th>Capped</th> <th>Asmnt Level</th> <th>Assessed</th> <th>Levy Rate</th> <th>92.430</th> <th>Current Tax</th> </tr> </thead> <tbody> <tr> <td>Remove Cap</td> <td>0</td> <td>Land Value 40,570</td> <td>27,541</td> <td>11%</td> <td>3,030</td> <td>Assessed</td> <td>17,489</td> <td>1,616.51</td> </tr> <tr> <td>Year Frozen</td> <td>0</td> <td>Improvements 131,445</td> <td>131,445</td> <td></td> <td>14,459</td> <td>Penalty</td> <td>0</td> <td></td> </tr> <tr> <td>Uncapped Value</td> <td>0</td> <td>Mobile Home 0</td> <td>0</td> <td></td> <td>0</td> <td>Exemption</td> <td>1,000</td> <td>-93.00</td> </tr> <tr> <td>TIF Project ID</td> <td>0</td> <td>Total Value 172,015</td> <td>158,986</td> <td></td> <td>17,489</td> <td>Total Taxable</td> <td>16,489</td> <td>1,524.00</td> </tr> </tbody> </table>		Source	REAL	Fair Cash	Capped	Asmnt Level	Assessed	Levy Rate	92.430	Current Tax	Remove Cap	0	Land Value 40,570	27,541	11%	3,030	Assessed	17,489	1,616.51	Year Frozen	0	Improvements 131,445	131,445		14,459	Penalty	0		Uncapped Value	0	Mobile Home 0	0		0	Exemption	1,000	-93.00	TIF Project ID	0	Total Value 172,015	158,986		17,489	Total Taxable	16,489	1,524.00																																																																											
Source	REAL	Fair Cash	Capped	Asmnt Level	Assessed	Levy Rate	92.430	Current Tax																																																																																																																	
Remove Cap	0	Land Value 40,570	27,541	11%	3,030	Assessed	17,489	1,616.51																																																																																																																	
Year Frozen	0	Improvements 131,445	131,445		14,459	Penalty	0																																																																																																																		
Uncapped Value	0	Mobile Home 0	0		0	Exemption	1,000	-93.00																																																																																																																	
TIF Project ID	0	Total Value 172,015	158,986		17,489	Total Taxable	16,489	1,524.00																																																																																																																	
Assessment History																																																																																																																									
<table border="1"> <thead> <tr> <th>Tax Year</th> <th>Statement Number</th> <th>Billed Owner</th> <th>Tax Area</th> <th>Total Value</th> <th>Exemptions</th> <th>Taxable Value</th> <th>Billed Tax</th> </tr> </thead> <tbody> <tr><td>2025</td><td>2025-660003931</td><td>GIBSON, JOHN A &</td><td>17</td><td>168,761</td><td>1000</td><td>15,979</td><td>1,477.00</td></tr> <tr><td>2024</td><td>2024-660003931</td><td>GIBSON, JOHN A &</td><td>17</td><td>171,437</td><td>1000</td><td>15,484</td><td>1,431.00</td></tr> <tr><td>2023</td><td>2023-660003931</td><td>GIBSON, JOHN A &</td><td>17</td><td>168,916</td><td>1000</td><td>15,004</td><td>1,374.00</td></tr> <tr><td>2022</td><td>2022-660003931</td><td>GIBSON, JOHN A &</td><td>17</td><td>158,680</td><td>1000</td><td>14,539</td><td>1,346.00</td></tr> <tr><td>2021</td><td>2021-660003931</td><td>GIBSON, JOHN A &</td><td>17</td><td>137,146</td><td>1000</td><td>14,086</td><td>1,244.00</td></tr> <tr><td>2020</td><td>2020-660003931</td><td>GIBSON, JOHN A &</td><td>17</td><td>134,903</td><td>1000</td><td>13,655</td><td>1,250.00</td></tr> <tr><td>2019</td><td>2019-660003931</td><td>GIBSON, JOHN A &</td><td>17</td><td>129,343</td><td>1000</td><td>13,228</td><td>1,225.00</td></tr> <tr><td>2018</td><td>2018-660003931</td><td>GIBSON, JOHN A &</td><td>17</td><td>131,824</td><td>1000</td><td>13,501</td><td>1,247.00</td></tr> <tr><td>2017</td><td>2017-660003931</td><td>GIBSON, JOHN A &</td><td>17</td><td>130,728</td><td>1000</td><td>13,263</td><td>1,218.00</td></tr> <tr><td>2016</td><td>2016-660003931</td><td>GIBSON, JOHN A &</td><td>17</td><td>127,305</td><td>1000</td><td>12,847</td><td>1,206.00</td></tr> <tr><td>2015</td><td>2015-660003931</td><td>GIBSON, JOHN A &</td><td>17</td><td>124,548</td><td>1000</td><td>12,444</td><td>1,122.00</td></tr> <tr><td>2014</td><td>2014-660003931</td><td>GIBSON, JOHN A &</td><td>17</td><td>126,708</td><td>1000</td><td>12,053</td><td>1,118.00</td></tr> <tr><td>2013</td><td>2013-660003931</td><td>GIBSON, JOHN A &</td><td>17</td><td>118,142</td><td>1000</td><td>11,673</td><td>1,068.00</td></tr> </tbody> </table>										Tax Year	Statement Number	Billed Owner	Tax Area	Total Value	Exemptions	Taxable Value	Billed Tax	2025	2025-660003931	GIBSON, JOHN A &	17	168,761	1000	15,979	1,477.00	2024	2024-660003931	GIBSON, JOHN A &	17	171,437	1000	15,484	1,431.00	2023	2023-660003931	GIBSON, JOHN A &	17	168,916	1000	15,004	1,374.00	2022	2022-660003931	GIBSON, JOHN A &	17	158,680	1000	14,539	1,346.00	2021	2021-660003931	GIBSON, JOHN A &	17	137,146	1000	14,086	1,244.00	2020	2020-660003931	GIBSON, JOHN A &	17	134,903	1000	13,655	1,250.00	2019	2019-660003931	GIBSON, JOHN A &	17	129,343	1000	13,228	1,225.00	2018	2018-660003931	GIBSON, JOHN A &	17	131,824	1000	13,501	1,247.00	2017	2017-660003931	GIBSON, JOHN A &	17	130,728	1000	13,263	1,218.00	2016	2016-660003931	GIBSON, JOHN A &	17	127,305	1000	12,847	1,206.00	2015	2015-660003931	GIBSON, JOHN A &	17	124,548	1000	12,444	1,122.00	2014	2014-660003931	GIBSON, JOHN A &	17	126,708	1000	12,053	1,118.00	2013	2013-660003931	GIBSON, JOHN A &	17	118,142	1000	11,673	1,068.00
Tax Year	Statement Number	Billed Owner	Tax Area	Total Value	Exemptions	Taxable Value	Billed Tax																																																																																																																		
2025	2025-660003931	GIBSON, JOHN A &	17	168,761	1000	15,979	1,477.00																																																																																																																		
2024	2024-660003931	GIBSON, JOHN A &	17	171,437	1000	15,484	1,431.00																																																																																																																		
2023	2023-660003931	GIBSON, JOHN A &	17	168,916	1000	15,004	1,374.00																																																																																																																		
2022	2022-660003931	GIBSON, JOHN A &	17	158,680	1000	14,539	1,346.00																																																																																																																		
2021	2021-660003931	GIBSON, JOHN A &	17	137,146	1000	14,086	1,244.00																																																																																																																		
2020	2020-660003931	GIBSON, JOHN A &	17	134,903	1000	13,655	1,250.00																																																																																																																		
2019	2019-660003931	GIBSON, JOHN A &	17	129,343	1000	13,228	1,225.00																																																																																																																		
2018	2018-660003931	GIBSON, JOHN A &	17	131,824	1000	13,501	1,247.00																																																																																																																		
2017	2017-660003931	GIBSON, JOHN A &	17	130,728	1000	13,263	1,218.00																																																																																																																		
2016	2016-660003931	GIBSON, JOHN A &	17	127,305	1000	12,847	1,206.00																																																																																																																		
2015	2015-660003931	GIBSON, JOHN A &	17	124,548	1000	12,444	1,122.00																																																																																																																		
2014	2014-660003931	GIBSON, JOHN A &	17	126,708	1000	12,053	1,118.00																																																																																																																		
2013	2013-660003931	GIBSON, JOHN A &	17	118,142	1000	11,673	1,068.00																																																																																																																		



Rogers

Assessment Property Record Card for Tax Year 2026

Data provided by LISA DELOZIER County Assessor

Date 04/17/2026
Time 06:48:16
Page 2

Lot Data	Square-Foot - NBHD 1183 #1	Primary Image
Lot Size		
Lot Count	1	
Units Buildable	8000	
Non-Ag Acres	0.1863	
Topography		
Street Access		
Utilities		
Amenities	LOT SIZE ADJUSTMENT	
	0	
	0	
Method	Square-Foot	
Base Lot Value	8,114.00 x 5.00 = 40,570	
Factor Value		
Adjustments	1.0000	
Lot Value	40,570	

Residential Data	
Type	1 Single Family Residence
Condition	3 - Average
Quality	2.5 - Fair
Architecture	R3 Res Nbhd 3
Style	100% One Story
Exterior Wall	90% Frame, Siding, Vinyl 10% Veneer, Masonry
Base/Total Area	1,288 / 1,288
Style	100% One Story
HVAC	100% Warmed & Cooled Air
Roof Cover	1 Composition Shingle
Area on Slab	1,288
Fixture/RghIn	11 /
Bed/F/H Bath	3 / 2.0 /
Basement Area	
Garage Type	440 Attached Garage - Unfinished 2 Stalls
Remodel	
Year/Eff Age	1998 / 21

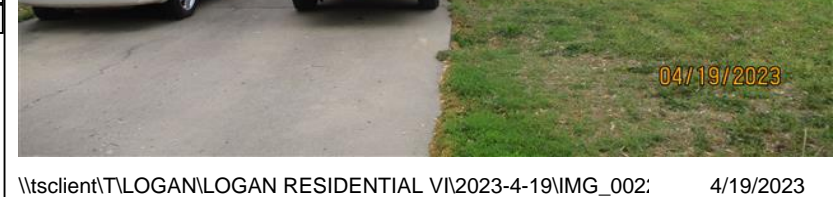

\\tsclient\T\LOGAN\LOGAN RESIDENTIAL VI\2023-4-19\IMG_002: 4/19/2023

GRM Approach	
GRM Code	
Gross Rent	0.00
Indicated Value	

Multiple Regression			
MRA Code	1	Test	
Adjusted R	0.8445		
Indicated Value	164,266	127.54	Per SqFt

Direct Comparables			
Selection Model	A	Adam Test	
Adjustment Model	1	2022 Residential	
Comparables	6		
Indicated Value	175,020		Per SqFt

Cost Approach				Manual : 01/2025			
Base Cost	99.64	Total Misc Impr	+	6,007			
Roofing Adj	+ 4.56	Garage Cost	+	12,487			
Subfloor Adj	+ -1.16	Total RCN	=	180,061			
Heat/Cool Adj	+ 11.47	Depreciation (27%)	-	48,616			
Plumbing Adj	+ 10.93	Lump Sums	+	0			
Basement Adj	+ 0.00	RCNLD	=	131,445			
Adj Base Cost	= 125.44	Lot Value	+	40,570			
Total Area	x 1,288	Indicated Value	=	172,015			
Adjusted Cost	= 161,567	Value Per SqFt		133.55			

Value Reconciliation			
Selected Approach	Cost Approach		
Improvements	131,445		
Lot Value	40,570		
Indicated Value	172,015	133.55	Per SqFt
Agland Value			
Site Improvements			
Total Value	172,015	133.55	Total Value Per SqFt

Miscellaneous Improvements								
Code	Description	Sketch ID	Size	Year	Units	Unit Cost	Depr	Value
PRCH	SLAB PORCH - COVERED	9972	18x6		108	23.92		2,583
PRCH	SLAB PORCH - COVERED	9973	16x9		144	23.78		3,424



Rogers

Assessment Property Record Card for Tax Year 2026

Data provided by LISA DELOZIER County Assessor

Date 04/17/2026
 Time 06:48:16
 Page 3

Sketch Image

660003931

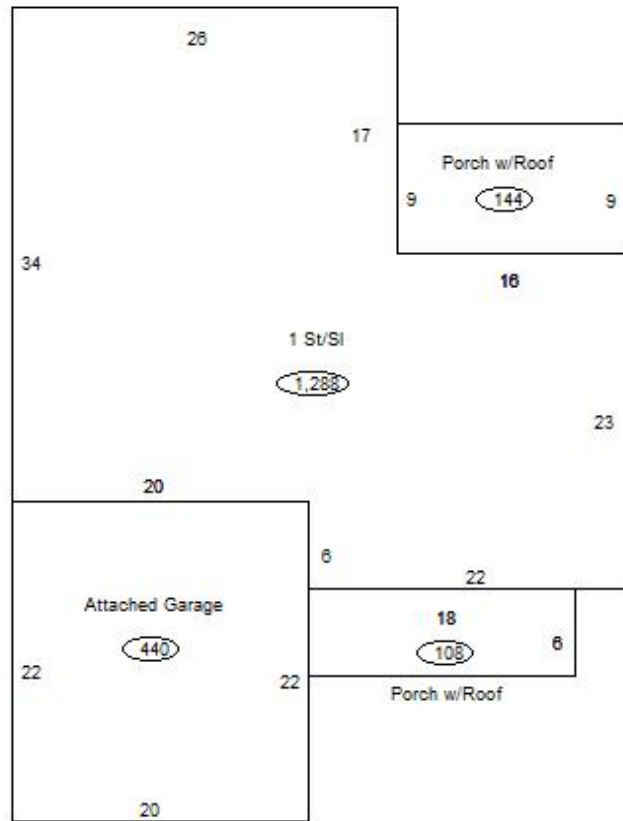

Sketch Vector Information

Sequence	Code	Type	Built Over	Scale	Section Label	Base Area	Multiplier	Total Area
1	R	1	Slab	13	1 St/Sl	1,288	1.000	1,288
2	G	1		13	Attached Garage	440	1.000	440
3	M	PRCH		13	SLBC	108	1.000	108
4	M	PRCH		13	SLBC	144	1.000	144
Total Building Area						1,288		1,288