



# Rogers

## Assessment Property Record Card for Tax Year 2026

Data provided by LISA DELOZIER County Assessor

Date 04/17/2026  
Time 01:56:32  
Page 1

Assessment Data					Primary Image				
Account	660003933								
Parcel ID	000000-00-0-10772-002-0024								
Cadastral ID	05-21-16-03360								
Property Type	REAL - Real Property								
Property Class	URP	VI Area	1						
Tax Area	17 - CLAREMORE OT								
Name ID	62304								
ARRINGTON, WILLIE JULIUS									
802 W 23RD ST N CLAREMORE OK 74017-0000									
Parcel Location									
Situs	00802 W 23RD ST N								
Subdivision	SPRINGBROOK ESTATES I								
Lot/Block	0024 / 0002	Parcel Size	1 - Lots						
Sec/Twn/Rng	5 / 21 / 16 / 5								
Neighborhood	1183 - R-V01-SW CLAREMORE								
School District	S001 - CLAREMORE SCHOOLS								
Legal Description Lat/Long: 36.33164094 -95.61602718									
Building Permits									
LOT 24 BLOCK 2 SPRINGBROOK EST I									
Exemptions									
Code	Type	Active	Maximum	Exemption	Sale History				
H	Homestead	Yes	1,000	1,000	Bk/Pg	Grantor	Date	Price	Code
Parcel Valuation									
Source	REAL	Fair Cash	Capped	Asmnt Level	Assessed	Levy Rate	92.430	Current Tax	
Remove Cap	0	Land Value	58,313	26,458	11%	2,910	Assessed	12,765	1,179.87
Year Frozen	0	Improvements	95,654	89,593		9,855	Penalty	0	
Uncapped Value	0	Mobile Home	0	0		0	Exemption	1,000	-93.00
TIF Project ID	0	Total Value	153,967	116,051		12,765	Total Taxable	11,765	1,087.00
Assessment History									
Tax Year	Statement Number	Billed Owner			Tax Area	Total Value	Exemptions	Taxable Value	Billed Tax
2025	2025-660003933	ARRINGTON, WILLIE JULIUS			17	150,841	1000	11,394	1,053.00
2024	2024-660003933	ARRINGTON, WILLIE JULIUS			17	158,129	1000	11,033	1,020.00
2023	2023-660003933	ARRINGTON, WILLIE JULIUS			17	114,998	1000	10,683	979.00
2022	2022-660003933	ARRINGTON, WILLIE JULIUS			17	103,111	1000	10,342	957.00
2021	2021-660003933	ARRINGTON, WILLIE JULIUS			17	103,305	1000	10,364	915.00
2020	2020-660003933	ARRINGTON, WILLIE JULIUS			17	101,687	1000	10,186	933.00
2019	2019-660003933	ARRINGTON, WILLIE JULIUS			17	99,292	1000	9,922	919.00
2018	2018-660003933	ARRINGTON, WILLIE JULIUS			17	103,163	1000	10,242	946.00
2017	2017-660003933	ARRINGTON, WILLIE JULIUS			17	102,342	1000	9,915	911.00
2016	2016-660003933	ARRINGTON, WILLIE JULIUS			17	99,810	1000	9,597	901.00
2015	2015-660003933	ARRINGTON, WILLIE JULIUS			17	97,195	1000	9,288	838.00
2014	2014-660003933	ARRINGTON, WILLIE JULIUS			17	97,972	1000	8,989	834.00
2013	2013-660003933	ARRINGTON, WILLIE JULIUS			17	93,542	1000	8,698	796.00



# Rogers

## Assessment Property Record Card for Tax Year 2026

Data provided by LISA DELOZIER County Assessor

Date 04/17/2026  
 Time 01:56:33  
 Page 2

Lot Data	Square-Foot - NBHD 1183 #1	Primary Image
<b>Lot Size</b> <b>Lot Count</b> 1 <b>Units Buildable</b> 8000 <b>Non-Ag Acres</b> 0.3178 <b>Topography</b> <b>Street Access</b> <b>Utilities</b> <b>Amenities</b> LOT SIZE ADJUSTMENT 0 0 <b>Method</b> Square-Foot <b>Base Lot Value</b> 13,842.00 x 4.21 = 58,313 <b>Factor Value</b> <b>Adjustments</b> 1.0000 <b>Lot Value</b> 58,313		

Residential Data	
<b>Type</b>	1 Single Family Residence
<b>Condition</b>	3 - Average
<b>Quality</b>	2 - Fair
<b>Architecture</b>	R3 Res Nbhd 3
<b>Style</b>	100% One Story
<b>Exterior Wall</b>	60% Veneer, Stone 40% Frame, Siding, Vinyl
<b>Base/Total Area</b>	1,164 / 1,164
<b>Style</b>	100% One Story
<b>HVAC</b>	100% Warmed & Cooled Air
<b>Roof Cover</b>	1 Composition Shingle
<b>Area on Slab</b>	1,164
<b>Fixture/RghIn</b>	11 /
<b>Bed/F/H Bath</b>	3 / 2.0 /
<b>Basement Area</b>	
<b>Garage Type</b>	400 Attached Garage - Unfinished 2 Stalls
<b>Remodel</b>	
<b>Year/Eff Age</b>	1983 / 32

\\tsclient\T\LOGAN\LOGAN RESIDENTIAL VI\2023-4-19\IMG\_002 4/19/2023

GRM Approach	
<b>GRM Code</b>	
<b>Gross Rent</b>	0.00
<b>Indicated Value</b>	

Multiple Regression			
<b>MRA Code</b>	1	Test	
<b>Adusted R</b>	0.8445		
<b>Indicated Value</b>	122,500	105.24	Per SqFt

Direct Comparables			
<b>Selection Model</b>	A	Adam Test	
<b>Adjustment Model</b>	1	2022 Residential	
<b>Comparables</b>	6		
<b>Indicated Value</b>	148,070		Per SqFt

Cost Approach				Manual : 01/2025	
<b>Base Cost</b>	105.46	<b>Total Misc Impr</b>	+	8,453	
<b>Roofing Adj</b>	+ 4.32	<b>Garage Cost</b>	+	9,944	
<b>Subfloor Adj</b>	+ 0.00	<b>Total RCN</b>	=	170,811	
<b>Heat/Cool Adj</b>	+ 10.30	<b>Depreciation ( 44%)</b>	-	75,157	
<b>Plumbing Adj</b>	+ 10.86	<b>Lump Sums</b>	+	0	
<b>Basement Adj</b>	+ 0.00	<b>RCNLD</b>	=	95,654	
<b>Adj Base Cost</b>	= 130.94	<b>Lot Value</b>	+	58,313	
<b>Total Area</b>	x 1,164	<b>Indicated Value</b>	=	153,967	
<b>Adjusted Cost</b>	= 152,414	<b>Value Per SqFt</b>		132.27	

Value Reconciliation			
<b>Selected Approach</b>	Cost Approach		
<b>Improvements</b>	95,654		
<b>Lot Value</b>	58,313		
<b>Indicated Value</b>	153,967	132.27	Per SqFt
<b>Agland Value</b>			
<b>Site Improvements</b>			
<b>Total Value</b>	153,967	132.27	Total Value Per SqFt

Miscellaneous Improvements								
Code	Description	Sketch ID	Size	Year	Units	Unit Cost	Depr	Value
FPR1	FIREPLACE - RESIDENTIAL 1 STORY	0		1	1	4,576.55		4,577
PRCH	SLAB PORCH - COVERED	9980	12x6		72	21.07		1,517
PATO	SLAB PORCH - OPEN	9981	296		296	7.97		2,359



# Rogers

## Assessment Property Record Card for Tax Year 2026

Data provided by LISA DELOZIER County Assessor

Date 04/17/2026  
 Time 01:56:33  
 Page 3

Sketch Image

660003933

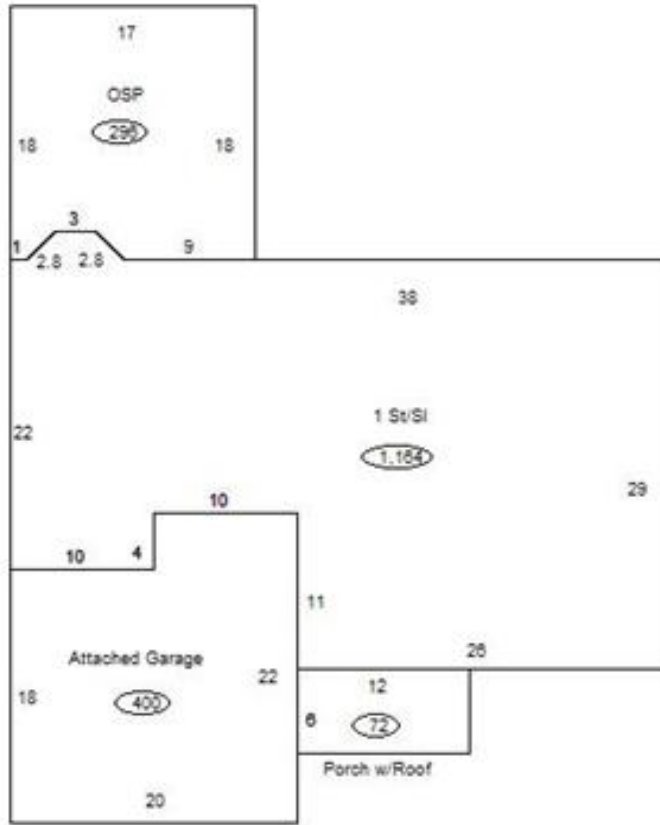

### Sketch Vector Information

Sequence	Code	Type	Built Over	Scale	Section Label	Base Area	Multiplier	Total Area
1	R	1	Slab	13	1 St/SI	1,164	1.000	1,164
2	G	1		13	Attached Garage	400	1.000	400
3	M	PRCH		13	SLBC	72	1.000	72
4	M	PATO		13	Open Slab	296	1.000	296
<b>Total Building Area</b>						<b>1,164</b>		<b>1,164</b>



# Rogers

## Assessment Property Record Card for Tax Year 2026

Data provided by LISA DELOZIER County Assessor

Date 04/17/2026  
Time 01:56:33  
Page 4

660003933

### Outbuildings/Site Improvements

Building Image	Code	Description	Dimensions	Floor	Roofing	Total Units
	STF STG FAIR		0x0x0			
	Qual 2	Cond	Year	Eff Age		
<b>Valuation Summary</b>		<b>Modifier Total</b>	<b>RCN</b>	<b>Depr (100% Phys/ % Func)</b>	<b>RCNLD</b>	
Base Cost (4.68 x )						