



Rogers

Assessment Property Record Card for Tax Year 2026

Data provided by LISA DELOZIER County Assessor

Date 04/17/2026

Time 18:01:03

Page 1

Assessment Data					Primary Image																																																																																																																				
Account 660003938 Parcel ID 000000-00-0-10772-003-0005 Cadastral ID 05-21-16-03410 Property Type REAL - Real Property Property Class URP VI Area 1 Tax Area 17 - CLAREMORE OT Name ID 300992 HARDESTY, MICHAEL PEET 805 W 23RD ST N CLAREMORE OK 74017-0000 Parcel Location Situs 00805 W 23RD ST N Subdivision SPRINGBROOK ESTATES I Lot/Block 0005 / 0003 Parcel Size 1 - Lots Sec/Twn/Rng 5 / 21 / 16 / 5 Neighborhood 1183 - R-V01-SW CLAREMORE School District S001 - CLAREMORE SCHOOLS																																																																																																																									
Legal Description Lot/Long: 36.33165596 -95.61539496																																																																																																																									
Building Permits					<table border="1"> <thead> <tr> <th>Number</th> <th>Description</th> <th>Opened</th> <th>Closed</th> <th>Amount</th> </tr> </thead> <tbody> <tr> <td colspan="5"> </td> </tr> </tbody> </table>					Number	Description	Opened	Closed	Amount																																																																																																											
Number	Description	Opened	Closed	Amount																																																																																																																					
Exemptions					Sale History																																																																																																																				
<table border="1"> <thead> <tr> <th>Code</th> <th>Type</th> <th>Active</th> <th>Maximum</th> <th>Exemption</th> </tr> </thead> <tbody> <tr> <td>H</td> <td>Homestead</td> <td>Yes</td> <td>1,000</td> <td>1,000</td> </tr> </tbody> </table>					Code	Type	Active	Maximum	Exemption	H	Homestead	Yes	1,000	1,000	<table border="1"> <thead> <tr> <th>Bk/Pg</th> <th>Grantor</th> <th>Date</th> <th>Price</th> <th>Code</th> </tr> </thead> <tbody> <tr> <td>2048/599</td> <td>JJB PROPERTIES LLC</td> <td>08/03/2009</td> <td>102,500</td> <td>YES</td> </tr> <tr> <td>1242/467</td> <td>CLARK, BRIAN C &</td> <td>08/14/2000</td> <td>59,500</td> <td>No</td> </tr> <tr> <td>908/695</td> <td>SECRETARY OF VETERAN-AFFAIRS</td> <td>03/16/1993</td> <td>57,500</td> <td>No</td> </tr> <tr> <td>895/757</td> <td>SIMMONS, JOSEPH BENJAMIN</td> <td>10/15/1992</td> <td>0</td> <td>No</td> </tr> </tbody> </table>					Bk/Pg	Grantor	Date	Price	Code	2048/599	JJB PROPERTIES LLC	08/03/2009	102,500	YES	1242/467	CLARK, BRIAN C &	08/14/2000	59,500	No	908/695	SECRETARY OF VETERAN-AFFAIRS	03/16/1993	57,500	No	895/757	SIMMONS, JOSEPH BENJAMIN	10/15/1992	0	No																																																																													
Code	Type	Active	Maximum	Exemption																																																																																																																					
H	Homestead	Yes	1,000	1,000																																																																																																																					
Bk/Pg	Grantor	Date	Price	Code																																																																																																																					
2048/599	JJB PROPERTIES LLC	08/03/2009	102,500	YES																																																																																																																					
1242/467	CLARK, BRIAN C &	08/14/2000	59,500	No																																																																																																																					
908/695	SECRETARY OF VETERAN-AFFAIRS	03/16/1993	57,500	No																																																																																																																					
895/757	SIMMONS, JOSEPH BENJAMIN	10/15/1992	0	No																																																																																																																					
Parcel Valuation																																																																																																																									
<table border="1"> <thead> <tr> <th>Source</th> <th>REAL</th> <th>Fair Cash</th> <th>Capped</th> <th>Asmnt Level</th> <th>Assessed</th> <th>Levy Rate</th> <th>92.430</th> <th>Current Tax</th> </tr> </thead> <tbody> <tr> <td>Remove Cap</td> <td>2010</td> <td>Land Value</td> <td>43,765</td> <td>25,721</td> <td>11%</td> <td>2,829</td> <td>Assessed</td> <td>13,224</td> <td>1,222.29</td> </tr> <tr> <td>Year Frozen</td> <td>0</td> <td>Improvements</td> <td>101,984</td> <td>94,498</td> <td></td> <td>10,395</td> <td>Penalty</td> <td>0</td> <td></td> </tr> <tr> <td>Uncapped Value</td> <td>0</td> <td>Mobile Home</td> <td>0</td> <td>0</td> <td></td> <td>0</td> <td>Exemption</td> <td>1,000</td> <td>-92.00</td> </tr> <tr> <td>TIF Project ID</td> <td>0</td> <td>Total Value</td> <td>145,749</td> <td>120,219</td> <td></td> <td>13,224</td> <td>Total Taxable</td> <td>12,224</td> <td>1,130.00</td> </tr> </tbody> </table>		Source	REAL	Fair Cash	Capped	Asmnt Level	Assessed	Levy Rate	92.430	Current Tax	Remove Cap	2010	Land Value	43,765	25,721	11%	2,829	Assessed	13,224	1,222.29	Year Frozen	0	Improvements	101,984	94,498		10,395	Penalty	0		Uncapped Value	0	Mobile Home	0	0		0	Exemption	1,000	-92.00	TIF Project ID	0	Total Value	145,749	120,219		13,224	Total Taxable	12,224	1,130.00																																																																							
Source	REAL	Fair Cash	Capped	Asmnt Level	Assessed	Levy Rate	92.430	Current Tax																																																																																																																	
Remove Cap	2010	Land Value	43,765	25,721	11%	2,829	Assessed	13,224	1,222.29																																																																																																																
Year Frozen	0	Improvements	101,984	94,498		10,395	Penalty	0																																																																																																																	
Uncapped Value	0	Mobile Home	0	0		0	Exemption	1,000	-92.00																																																																																																																
TIF Project ID	0	Total Value	145,749	120,219		13,224	Total Taxable	12,224	1,130.00																																																																																																																
Assessment History																																																																																																																									
<table border="1"> <thead> <tr> <th>Tax Year</th> <th>Statement Number</th> <th>Billed Owner</th> <th>Tax Area</th> <th>Total Value</th> <th>Exemptions</th> <th>Taxable Value</th> <th>Billed Tax</th> </tr> </thead> <tbody> <tr><td>2025</td><td>2025-660003938</td><td>HARDESTY, MICHAEL PEET</td><td>17</td><td>142,304</td><td>1000</td><td>11,839</td><td>1,094.00</td></tr> <tr><td>2024</td><td>2024-660003938</td><td>HARDESTY, MICHAEL PEET</td><td>17</td><td>141,256</td><td>1000</td><td>11,465</td><td>1,060.00</td></tr> <tr><td>2023</td><td>2023-660003938</td><td>HARDESTY, MICHAEL PEET</td><td>17</td><td>118,825</td><td>1000</td><td>11,102</td><td>1,017.00</td></tr> <tr><td>2022</td><td>2022-660003938</td><td>HARDESTY, MICHAEL PEET</td><td>17</td><td>106,815</td><td>1000</td><td>10,750</td><td>995.00</td></tr> <tr><td>2021</td><td>2021-660003938</td><td>HARDESTY, MICHAEL PEET</td><td>17</td><td>113,354</td><td>1000</td><td>10,747</td><td>949.00</td></tr> <tr><td>2020</td><td>2020-660003938</td><td>HARDESTY, MICHAEL PEET</td><td>17</td><td>111,549</td><td>1000</td><td>10,405</td><td>953.00</td></tr> <tr><td>2019</td><td>2019-660003938</td><td>HARDESTY, MICHAEL PEET</td><td>17</td><td>100,660</td><td>1000</td><td>10,073</td><td>933.00</td></tr> <tr><td>2018</td><td>2018-660003938</td><td>HARDESTY, MICHAEL PEET</td><td>17</td><td>105,913</td><td>1000</td><td>10,650</td><td>984.00</td></tr> <tr><td>2017</td><td>2017-660003938</td><td>HARDESTY, MICHAEL PEET</td><td>17</td><td>105,063</td><td>1000</td><td>10,557</td><td>970.00</td></tr> <tr><td>2016</td><td>2016-660003938</td><td>HARDESTY, MICHAEL PEET</td><td>17</td><td>102,482</td><td>1000</td><td>10,273</td><td>964.00</td></tr> <tr><td>2015</td><td>2015-660003938</td><td>HARDESTY, MICHAEL PEET</td><td>17</td><td>99,765</td><td>1000</td><td>9,974</td><td>900.00</td></tr> <tr><td>2014</td><td>2014-660003938</td><td>HARDESTY, MICHAEL PEET</td><td>17</td><td>100,515</td><td>1000</td><td>9,765</td><td>906.00</td></tr> <tr><td>2013</td><td>2013-660003938</td><td>HARDESTY, MICHAEL PEET</td><td>17</td><td>95,011</td><td>1000</td><td>9,451</td><td>865.00</td></tr> </tbody> </table>										Tax Year	Statement Number	Billed Owner	Tax Area	Total Value	Exemptions	Taxable Value	Billed Tax	2025	2025-660003938	HARDESTY, MICHAEL PEET	17	142,304	1000	11,839	1,094.00	2024	2024-660003938	HARDESTY, MICHAEL PEET	17	141,256	1000	11,465	1,060.00	2023	2023-660003938	HARDESTY, MICHAEL PEET	17	118,825	1000	11,102	1,017.00	2022	2022-660003938	HARDESTY, MICHAEL PEET	17	106,815	1000	10,750	995.00	2021	2021-660003938	HARDESTY, MICHAEL PEET	17	113,354	1000	10,747	949.00	2020	2020-660003938	HARDESTY, MICHAEL PEET	17	111,549	1000	10,405	953.00	2019	2019-660003938	HARDESTY, MICHAEL PEET	17	100,660	1000	10,073	933.00	2018	2018-660003938	HARDESTY, MICHAEL PEET	17	105,913	1000	10,650	984.00	2017	2017-660003938	HARDESTY, MICHAEL PEET	17	105,063	1000	10,557	970.00	2016	2016-660003938	HARDESTY, MICHAEL PEET	17	102,482	1000	10,273	964.00	2015	2015-660003938	HARDESTY, MICHAEL PEET	17	99,765	1000	9,974	900.00	2014	2014-660003938	HARDESTY, MICHAEL PEET	17	100,515	1000	9,765	906.00	2013	2013-660003938	HARDESTY, MICHAEL PEET	17	95,011	1000	9,451	865.00
Tax Year	Statement Number	Billed Owner	Tax Area	Total Value	Exemptions	Taxable Value	Billed Tax																																																																																																																		
2025	2025-660003938	HARDESTY, MICHAEL PEET	17	142,304	1000	11,839	1,094.00																																																																																																																		
2024	2024-660003938	HARDESTY, MICHAEL PEET	17	141,256	1000	11,465	1,060.00																																																																																																																		
2023	2023-660003938	HARDESTY, MICHAEL PEET	17	118,825	1000	11,102	1,017.00																																																																																																																		
2022	2022-660003938	HARDESTY, MICHAEL PEET	17	106,815	1000	10,750	995.00																																																																																																																		
2021	2021-660003938	HARDESTY, MICHAEL PEET	17	113,354	1000	10,747	949.00																																																																																																																		
2020	2020-660003938	HARDESTY, MICHAEL PEET	17	111,549	1000	10,405	953.00																																																																																																																		
2019	2019-660003938	HARDESTY, MICHAEL PEET	17	100,660	1000	10,073	933.00																																																																																																																		
2018	2018-660003938	HARDESTY, MICHAEL PEET	17	105,913	1000	10,650	984.00																																																																																																																		
2017	2017-660003938	HARDESTY, MICHAEL PEET	17	105,063	1000	10,557	970.00																																																																																																																		
2016	2016-660003938	HARDESTY, MICHAEL PEET	17	102,482	1000	10,273	964.00																																																																																																																		
2015	2015-660003938	HARDESTY, MICHAEL PEET	17	99,765	1000	9,974	900.00																																																																																																																		
2014	2014-660003938	HARDESTY, MICHAEL PEET	17	100,515	1000	9,765	906.00																																																																																																																		
2013	2013-660003938	HARDESTY, MICHAEL PEET	17	95,011	1000	9,451	865.00																																																																																																																		



Rogers

Assessment Property Record Card for Tax Year 2026

Data provided by LISA DELOZIER County Assessor

Date 04/17/2026
Time 18:01:04
Page 2

Lot Data	Square-Foot - NBHD 1183 #1	Primary Image
Lot Size Lot Count 1 Units Buildable 8000 Non-Ag Acres 0.2009 Topography Street Access Utilities Amenities LOT SIZE ADJUSTMENT 0 0 Method Square-Foot Base Lot Value 8,753.00 x 5.00 = 43,765 Factor Value Adjustments 1.0000 Lot Value 43,765		

Residential Data	
Type	1 Single Family Residence
Condition	3 - Average
Quality	2 - Fair
Architecture	R3 Res Nbhd 3
Style	100% One Story
Exterior Wall	70% Veneer, Masonry 30% Frame, Siding, Wood
Base/Total Area	1,280 / 1,280
Style	100% One Story
HVAC	100% Warmed & Cooled Air
Roof Cover	1 Composition Shingle
Area on Slab	1,280
Fixture/RghIn	11 /
Bed/F/H Bath	3 / 2.0 /
Basement Area	
Garage Type	400 Attached Garage - Unfinished 2 Stalls
Remodel	
Year/Eff Age	1981 / 34



\\tsclient\T\LOGAN\LOGAN RESIDENTIAL VI\2023-4-18\IMG_005i 4/18/2023

GRM Approach	
GRM Code	
Gross Rent	0.00
Indicated Value	

Multiple Regression			
MRA Code	1	Test	
Adusted R	0.8445		
Indicated Value	126,251	98.63	Per SqFt

Direct Comparables	
Selection Model	A Adam Test
Adjustment Model	1 2022 Residential
Comparables	6
Indicated Value	152,700 Per SqFt

Cost Approach				Manual : 01/2025	
Base Cost	95.95	Total Misc Impr	+	13,514	
Roofing Adj	+ 4.02	Garage Cost	+	9,944	
Subfloor Adj	+ 0.00	Total RCN	=	177,250	
Heat/Cool Adj	+ 10.30	Depreciation (45%)	-	79,763	
Plumbing Adj	+ 9.88	Lump Sums	+	4,497	
Basement Adj	+ 0.00	RCNLD	=	101,984	
Adj Base Cost	= 120.15	Lot Value	+	43,765	
Total Area	x 1,280	Indicated Value	=	145,749	
Adjusted Cost	= 153,792	Value Per SqFt		113.87	

Value Reconciliation			
Selected Approach	Cost Approach		
Improvements	101,984		
Lot Value	43,765		
Indicated Value	145,749	113.87	Per SqFt
Agland Value			
Site Improvements			
Total Value	145,749	113.87	Total Value Per SqFt

Miscellaneous Improvements								
Code	Description	Sketch ID	Size	Year	Units	Unit Cost	Depr	Value
FPR1	FIREPLACE - RESIDENTIAL 1 STORY	0		1	1	4,576.55		4,577
PRCH	SLAB PORCH - COVERED	10001	12x4		48	21.14		1,015
PRCH	SLAB PORCH - COVERED	10002	28x14		392	20.21		7,922
WODO	WOOD DECK - OPEN	144966	20x14		280	16.06		4,497



Rogers

Assessment Property Record Card for Tax Year 2026

Data provided by LISA DELOZIER County Assessor

Date 04/17/2026
 Time 18:01:04
 Page 3

Sketch Image

660003938

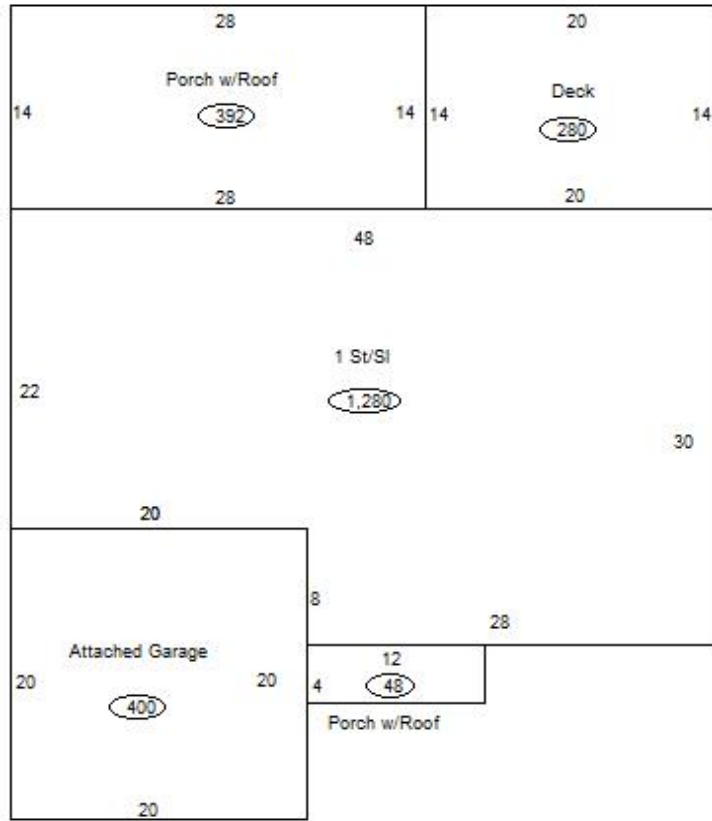

Sketch Vector Information

Sequence	Code	Type	Built Over	Scale	Section Label	Base Area	Multiplier	Total Area
1	R	1	Slab	13	1 St/Sl	1,280	1.000	1,280
2	G	1		13	Attached Garage	400	1.000	400
3	M	PRCH		13	SLBC	48	1.000	48
4	M	PRCH		13	SLBC	392	1.000	392
5	M	WODO		13	WODO	280	1.000	280
Total Building Area						1,280		1,280



Rogers



Assessment Property Record Card for Tax Year 2026

Data provided by LISA DELOZIER County Assessor

Date 04/17/2026
Time 18:01:04
Page 4

660003938

Outbuildings/Site Improvements

Building Image	Code	Description	Dimensions	Floor	Roofing	Total Units
	STF Qual 2	STG FAIR Cond	0x0x0 Year		Eff Age	
Valuation Summary		Modifier Total		RCN	Depr (100% Phys/ % Func)	RCNLD
Base Cost (4.68 x)						
	STF Qual 2	STG FAIR Cond	0x0x0 Year		Eff Age	
Valuation Summary		Modifier Total		RCN	Depr (100% Phys/ % Func)	RCNLD
Base Cost (4.68 x)						