



# Rogers

## Assessment Property Record Card for Tax Year 2026

Data provided by LISA DELOZIER County Assessor

Date 04/17/2026  
 Time 02:53:01  
 Page 1

Assessment Data					Primary Image																																																																																																																				
<b>Account</b> 660003994 <b>Parcel ID</b> 000000-00-0-10430-006-0031 <b>Cadastral ID</b> 05-21-16-04000 <b>Property Type</b> REAL - Real Property <b>Property Class</b> URP VI Area 1 <b>Tax Area</b> 17 - CLAREMORE OT <b>Name ID</b> 273681 RIDDLES, GEORGE J & DORCAS M  TRUSTEES 10325 E ROSE GLEN BLVD CLAREMORE OK 74019-0000  <b>Parcel Location</b> <b>Situs</b> 00414 N BOLING AVE <b>Subdivision</b> STATE PREPARATORY <b>Lot/Block</b> 0031 / 0006 <b>Parcel Size</b> 3 - Lots <b>Sec/Twn/Rng</b> 5 / 21 / 16 / 5 <b>Neighborhood</b> 1183 - R-V01-SW CLAREMORE <b>School District</b> S001 - CLAREMORE SCHOOLS																																																																																																																									
<b>Legal Description</b> Lat/Long: 36.32230008 -95.63022784 LOTS 29 THRU 31 BLOCK 6 STATE PREPARATORY																																																																																																																									
<b>Exemptions</b> <table border="1"> <thead> <tr> <th>Code</th> <th>Type</th> <th>Active</th> <th>Maximum</th> <th>Exemption</th> </tr> </thead> <tbody> <tr> <td></td> <td></td> <td></td> <td></td> <td></td> </tr> </tbody> </table>					Code	Type	Active	Maximum	Exemption						<b>Building Permits</b> <table border="1"> <thead> <tr> <th>Number</th> <th>Description</th> <th>Opened</th> <th>Closed</th> <th>Amount</th> </tr> </thead> <tbody> <tr> <td></td> <td></td> <td></td> <td></td> <td></td> </tr> </tbody> </table>					Number	Description	Opened	Closed	Amount																																																																																																	
Code	Type	Active	Maximum	Exemption																																																																																																																					
Number	Description	Opened	Closed	Amount																																																																																																																					
<b>Parcel Valuation</b> <table border="1"> <thead> <tr> <th>Source</th> <th>REAL</th> <th>Fair Cash</th> <th>Capped</th> <th>Asmnt Level</th> <th>Assessed</th> <th>Levy Rate</th> <th>92.430</th> <th>Current Tax</th> </tr> </thead> <tbody> <tr> <td>Remove Cap</td> <td>0</td> <td>Land Value 45,936</td> <td>20,309</td> <td>11%</td> <td>2,234</td> <td>Assessed</td> <td>11,952</td> <td>1,104.72</td> </tr> <tr> <td>Year Frozen</td> <td>0</td> <td>Improvements 101,481</td> <td>88,346</td> <td></td> <td>9,718</td> <td>Penalty</td> <td>0</td> <td></td> </tr> <tr> <td>Uncapped Value</td> <td>0</td> <td>Mobile Home 0</td> <td>0</td> <td></td> <td>0</td> <td>Exemption</td> <td>0</td> <td>0.00</td> </tr> <tr> <td>TIF Project ID</td> <td>0</td> <td>Total Value 147,417</td> <td>108,655</td> <td></td> <td>11,952</td> <td>Total Taxable</td> <td>11,952</td> <td>1,105.00</td> </tr> </tbody> </table>					Source	REAL	Fair Cash	Capped	Asmnt Level	Assessed	Levy Rate	92.430	Current Tax	Remove Cap	0	Land Value 45,936	20,309	11%	2,234	Assessed	11,952	1,104.72	Year Frozen	0	Improvements 101,481	88,346		9,718	Penalty	0		Uncapped Value	0	Mobile Home 0	0		0	Exemption	0	0.00	TIF Project ID	0	Total Value 147,417	108,655		11,952	Total Taxable	11,952	1,105.00	<b>Sale History</b> <table border="1"> <thead> <tr> <th>Bk/Pg</th> <th>Grantor</th> <th>Date</th> <th>Price</th> <th>Code</th> </tr> </thead> <tbody> <tr> <td>941/368</td> <td>ROOSA, DANIEL D</td> <td>12/30/1993</td> <td>42,500</td> <td>Yes</td> </tr> </tbody> </table>					Bk/Pg	Grantor	Date	Price	Code	941/368	ROOSA, DANIEL D	12/30/1993	42,500	Yes																																																									
Source	REAL	Fair Cash	Capped	Asmnt Level	Assessed	Levy Rate	92.430	Current Tax																																																																																																																	
Remove Cap	0	Land Value 45,936	20,309	11%	2,234	Assessed	11,952	1,104.72																																																																																																																	
Year Frozen	0	Improvements 101,481	88,346		9,718	Penalty	0																																																																																																																		
Uncapped Value	0	Mobile Home 0	0		0	Exemption	0	0.00																																																																																																																	
TIF Project ID	0	Total Value 147,417	108,655		11,952	Total Taxable	11,952	1,105.00																																																																																																																	
Bk/Pg	Grantor	Date	Price	Code																																																																																																																					
941/368	ROOSA, DANIEL D	12/30/1993	42,500	Yes																																																																																																																					
<b>Assessment History</b> <table border="1"> <thead> <tr> <th>Tax Year</th> <th>Statement Number</th> <th>Billed Owner</th> <th>Tax Area</th> <th>Total Value</th> <th>Exemptions</th> <th>Taxable Value</th> <th>Billed Tax</th> </tr> </thead> <tbody> <tr><td>2025</td><td>2025-660003994</td><td>RIDDLES, GEORGE J &amp; DORCAS M</td><td>17</td><td>144,476</td><td>0</td><td>11,383</td><td>1,052.00</td></tr> <tr><td>2024</td><td>2024-660003994</td><td>RIDDLES, GEORGE J &amp; DORCAS M</td><td>17</td><td>136,917</td><td>0</td><td>10,841</td><td>1,002.00</td></tr> <tr><td>2023</td><td>2023-660003994</td><td>RIDDLES, GEORGE J &amp; DORCAS M</td><td>17</td><td>115,164</td><td>0</td><td>10,324</td><td>946.00</td></tr> <tr><td>2022</td><td>2022-660003994</td><td>RIDDLES, GEORGE J &amp; DORCAS M</td><td>17</td><td>89,392</td><td>0</td><td>9,833</td><td>910.00</td></tr> <tr><td>2021</td><td>2021-660003994</td><td>RIDDLES, GEORGE J &amp; DORCAS M</td><td>17</td><td>86,275</td><td>0</td><td>9,490</td><td>838.00</td></tr> <tr><td>2020</td><td>2020-660003994</td><td>RIDDLES, GEORGE J &amp; DORCAS M</td><td>17</td><td>84,894</td><td>0</td><td>9,338</td><td>855.00</td></tr> <tr><td>2019</td><td>2019-660003994</td><td>RIDDLES, GEORGE J &amp; DORCAS M</td><td>17</td><td>82,845</td><td>0</td><td>9,019</td><td>835.00</td></tr> <tr><td>2018</td><td>2018-660003994</td><td>RIDDLES, GEORGE J &amp; DORCAS M</td><td>17</td><td>88,717</td><td>0</td><td>8,589</td><td>794.00</td></tr> <tr><td>2017</td><td>2017-660003994</td><td>RIDDLES, GEORGE J &amp; DORCAS M</td><td>17</td><td>87,976</td><td>0</td><td>8,180</td><td>751.00</td></tr> <tr><td>2016</td><td>2016-660003994</td><td>RIDDLES, GEORGE J &amp; DORCAS M</td><td>17</td><td>83,945</td><td>0</td><td>7,791</td><td>731.00</td></tr> <tr><td>2015</td><td>2015-660003994</td><td>RIDDLES, GEORGE J &amp; DORCAS M</td><td>17</td><td>67,453</td><td>0</td><td>7,420</td><td>669.00</td></tr> <tr><td>2014</td><td>2014-660003994</td><td>RIDDLES, GEORGE J &amp; DORCAS M</td><td>17</td><td>67,358</td><td>0</td><td>7,409</td><td>687.00</td></tr> <tr><td>2013</td><td>2013-660003994</td><td>RIDDLES, GEORGE J &amp; DORCAS M</td><td>17</td><td>81,907</td><td>0</td><td>8,770</td><td>803.00</td></tr> </tbody> </table>										Tax Year	Statement Number	Billed Owner	Tax Area	Total Value	Exemptions	Taxable Value	Billed Tax	2025	2025-660003994	RIDDLES, GEORGE J & DORCAS M	17	144,476	0	11,383	1,052.00	2024	2024-660003994	RIDDLES, GEORGE J & DORCAS M	17	136,917	0	10,841	1,002.00	2023	2023-660003994	RIDDLES, GEORGE J & DORCAS M	17	115,164	0	10,324	946.00	2022	2022-660003994	RIDDLES, GEORGE J & DORCAS M	17	89,392	0	9,833	910.00	2021	2021-660003994	RIDDLES, GEORGE J & DORCAS M	17	86,275	0	9,490	838.00	2020	2020-660003994	RIDDLES, GEORGE J & DORCAS M	17	84,894	0	9,338	855.00	2019	2019-660003994	RIDDLES, GEORGE J & DORCAS M	17	82,845	0	9,019	835.00	2018	2018-660003994	RIDDLES, GEORGE J & DORCAS M	17	88,717	0	8,589	794.00	2017	2017-660003994	RIDDLES, GEORGE J & DORCAS M	17	87,976	0	8,180	751.00	2016	2016-660003994	RIDDLES, GEORGE J & DORCAS M	17	83,945	0	7,791	731.00	2015	2015-660003994	RIDDLES, GEORGE J & DORCAS M	17	67,453	0	7,420	669.00	2014	2014-660003994	RIDDLES, GEORGE J & DORCAS M	17	67,358	0	7,409	687.00	2013	2013-660003994	RIDDLES, GEORGE J & DORCAS M	17	81,907	0	8,770	803.00
Tax Year	Statement Number	Billed Owner	Tax Area	Total Value	Exemptions	Taxable Value	Billed Tax																																																																																																																		
2025	2025-660003994	RIDDLES, GEORGE J & DORCAS M	17	144,476	0	11,383	1,052.00																																																																																																																		
2024	2024-660003994	RIDDLES, GEORGE J & DORCAS M	17	136,917	0	10,841	1,002.00																																																																																																																		
2023	2023-660003994	RIDDLES, GEORGE J & DORCAS M	17	115,164	0	10,324	946.00																																																																																																																		
2022	2022-660003994	RIDDLES, GEORGE J & DORCAS M	17	89,392	0	9,833	910.00																																																																																																																		
2021	2021-660003994	RIDDLES, GEORGE J & DORCAS M	17	86,275	0	9,490	838.00																																																																																																																		
2020	2020-660003994	RIDDLES, GEORGE J & DORCAS M	17	84,894	0	9,338	855.00																																																																																																																		
2019	2019-660003994	RIDDLES, GEORGE J & DORCAS M	17	82,845	0	9,019	835.00																																																																																																																		
2018	2018-660003994	RIDDLES, GEORGE J & DORCAS M	17	88,717	0	8,589	794.00																																																																																																																		
2017	2017-660003994	RIDDLES, GEORGE J & DORCAS M	17	87,976	0	8,180	751.00																																																																																																																		
2016	2016-660003994	RIDDLES, GEORGE J & DORCAS M	17	83,945	0	7,791	731.00																																																																																																																		
2015	2015-660003994	RIDDLES, GEORGE J & DORCAS M	17	67,453	0	7,420	669.00																																																																																																																		
2014	2014-660003994	RIDDLES, GEORGE J & DORCAS M	17	67,358	0	7,409	687.00																																																																																																																		
2013	2013-660003994	RIDDLES, GEORGE J & DORCAS M	17	81,907	0	8,770	803.00																																																																																																																		



# Rogers

## Assessment Property Record Card for Tax Year 2026

Data provided by LISA DELOZIER County Assessor

Date 04/17/2026  
Time 02:53:01  
Page 2

Lot Data	Square-Foot - NBHD 1183 #1	Primary Image
<b>Lot Size</b> <b>Lot Count</b> 1 <b>Units Buildable</b> 9375 <b>Non-Ag Acres</b> 0.2144 <b>Topography</b> <b>Street Access</b> <b>Utilities</b> <b>Amenities</b> LOT SIZE ADJUSTMENT 0 0 <b>Method</b> Square-Foot <b>Base Lot Value</b> 9,341.00 x 4.92 = 45,936 <b>Factor Value</b> <b>Adjustments</b> 1.0000 <b>Lot Value</b> 45,936		
<b>Residential Data</b>		

<b>Type</b>	5 Duplex
<b>Condition</b>	3 - Average
<b>Quality</b>	2 - Fair
<b>Architecture</b>	R3 Res Nbhd 3
<b>Style</b>	100% 1 1/2 Story Finished
<b>Exterior Wall</b>	100% Veneer, Masonry
<b>Base/Total Area</b>	918 / 1,462
<b>Style</b>	100% 1 1/2 Story Finished
<b>HVAC</b>	100% Warmed & Cooled Air
<b>Roof Cover</b>	1 Composition Shingle
<b>Area on Slab</b>	918
<b>Fixture/RghIn</b>	16 /
<b>Bed/F/H Bath</b>	4 / 3.5 /
<b>Basement Area</b>	
<b>Garage Type</b>	
<b>Remodel</b>	
<b>Year/Eff Age</b>	1975 / 38



\\tsclient\T\LOGAN\LOGAN RESIDENTIAL VI\2023-4-28\IMG\_004' 4/28/2023

GRM Approach	
<b>GRM Code</b>	
<b>Gross Rent</b>	0.00
<b>Indicated Value</b>	

Multiple Regression			
<b>MRA Code</b>	1	Test	
<b>Adusted R</b>	0.8445		
<b>Indicated Value</b>	93,856	64.20	Per SqFt

Direct Comparables	
<b>Selection Model</b>	A Adam Test
<b>Adjustment Model</b>	1 2022 Residential
<b>Comparables</b>	
<b>Indicated Value</b>	

Cost Approach				Manual : 01/2025			
<b>Base Cost</b>	107.93	<b>Total Misc Impr</b>	+ 19,642				
<b>Roofing Adj</b>	+ 2.67	<b>Garage Cost</b>	+ 0				
<b>Subfloor Adj</b>	+ 0.00	<b>Total RCN</b>	= 215,916				
<b>Heat/Cool Adj</b>	+ 10.74	<b>Depreciation ( 53%)</b>	- 114,435				
<b>Plumbing Adj</b>	+ 12.91	<b>Lump Sums</b>	+ 0				
<b>Basement Adj</b>	+ 0.00	<b>RCNLD</b>	= 101,481				
<b>Adj Base Cost</b>	= 134.25	<b>Lot Value</b>	+ 45,936				
<b>Total Area</b>	x 1,462	<b>Indicated Value</b>	= 147,417				
<b>Adjusted Cost</b>	= 196,274	<b>Value Per SqFt</b>	100.83				

Value Reconciliation			
<b>Selected Approach</b>	Cost Approach		
<b>Improvements</b>	101,481		
<b>Lot Value</b>	45,936		
<b>Indicated Value</b>	147,417	100.83	Per SqFt
<b>Agland Value</b>			
<b>Site Improvements</b>			
<b>Total Value</b>	147,417	100.83	Total Value Per SqFt

Miscellaneous Improvements								
Code	Description	Sketch ID	Size	Year	Units	Unit Cost	Depr	Value
FPR1	FIREPLACE - RESIDENTIAL 1 STORY	0		1	1	4,773.09		4,773
FPR1	FIREPLACE - RESIDENTIAL 1 STORY	0		1	1	4,773.09		4,773
PRCH	SLAB PORCH - COVERED	123992	34x10		340	23.97		8,150
PRCH	SLAB PORCH - COVERED	123993	10x4		40	24.32		973
PRCH	SLAB PORCH - COVERED	123994	10x4		40	24.32		973



# Rogers

## Assessment Property Record Card for Tax Year 2026

Data provided by LISA DELOZIER County Assessor

Date 04/17/2026  
 Time 02:53:01  
 Page 3

### Sketch Image

660003994

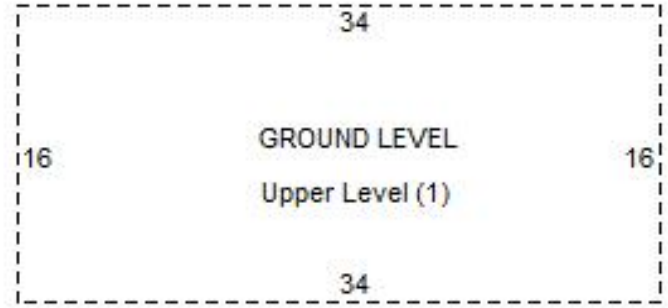
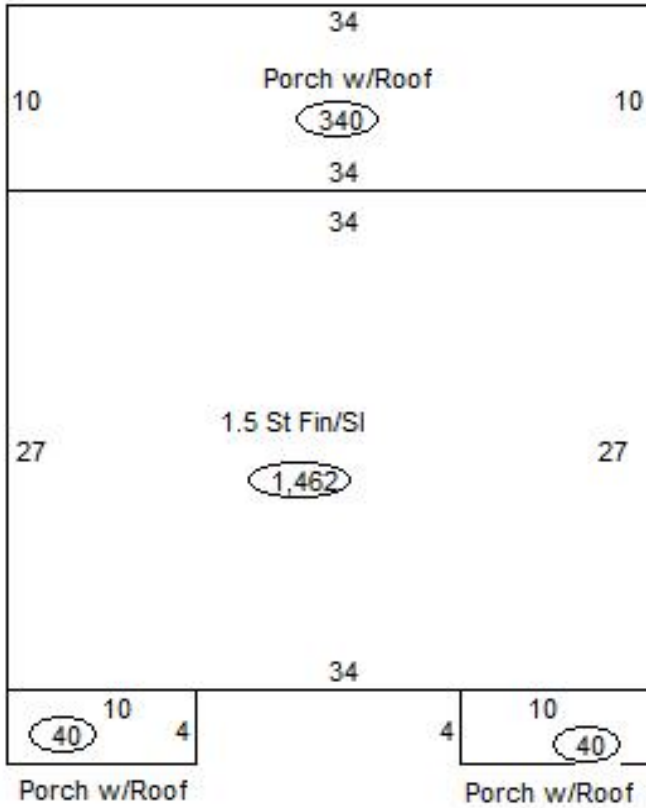

### Sketch Vector Information

Sequence	Code	Type	Built Over	Scale	Section Label	Base Area	Multiplier	Total Area
1	R	5	Slab	13	1.5 St Fin/Sl	918	1.593	1,462
2	U	^UL		13	Upper Level (1)	544	1.000	544
3	M	PRCH		13	SLBC	340	1.000	340
4	M	PRCH		13	SLBC	40	1.000	40
5	M	PRCH		13	SLBC	40	1.000	40
6	N	0		13	GROUND LEVEL		0.000	
<b>Total Building Area</b>						918		1,462