



# Rogers

## Assessment Property Record Card for Tax Year 2026

Data provided by LISA DELOZIER County Assessor

Date 04/17/2026  
 Time 02:15:20  
 Page 1

Assessment Data					Primary Image																																																																																																																				
<b>Account</b> 660004012 <b>Parcel ID</b> 000000-00-0-10230-001-0006 <b>Cadastral ID</b> 05-21-16-05640 <b>Property Type</b> REAL - Real Property <b>Property Class</b> URP VI Area 1 <b>Tax Area</b> 17 - CLAREMORE OT <b>Name ID</b> 276895 STANTON, JOHNNNA S  1501 N LANG ST CLAREMORE OK 74017-0000  <b>Parcel Location</b> <b>Situs</b> 01501 LANG <b>Subdivision</b> LINDWOOD <b>Lot/Block</b> 0006 / 0001 <b>Parcel Size</b> 1 - Lots <b>Sec/Twn/Rng</b> 5 / 21 / 16 / 5 <b>Neighborhood</b> 1183 - R-V01-SW CLAREMORE <b>School District</b> S001 - CLAREMORE SCHOOLS																																																																																																																									
<b>Legal Description</b> Lot/Long: 36.32294093 -95.61697180																																																																																																																									
<b>Building Permits</b>					<table border="1"> <thead> <tr> <th>Number</th> <th>Description</th> <th>Opened</th> <th>Closed</th> <th>Amount</th> </tr> </thead> <tbody> <tr> <td colspan="5"> </td> </tr> </tbody> </table>					Number	Description	Opened	Closed	Amount																																																																																																											
Number	Description	Opened	Closed	Amount																																																																																																																					
<b>Exemptions</b>					<b>Sale History</b>																																																																																																																				
<table border="1"> <thead> <tr> <th>Code</th> <th>Type</th> <th>Active</th> <th>Maximum</th> <th>Exemption</th> </tr> </thead> <tbody> <tr> <td>H</td> <td>Homestead</td> <td>Yes</td> <td>1,000</td> <td>1,000</td> </tr> </tbody> </table>					Code	Type	Active	Maximum	Exemption	H	Homestead	Yes	1,000	1,000	<table border="1"> <thead> <tr> <th>Bk/Pg</th> <th>Grantor</th> <th>Date</th> <th>Price</th> <th>Code</th> </tr> </thead> <tbody> <tr> <td>1295/205</td> <td>CLARKE, TIMOTHY C &amp;</td> <td>06/08/2001</td> <td>70,000</td> <td>YES</td> </tr> <tr> <td>919/832</td> <td>DICKSON, BILLIE SUSAN-TRUSTEE</td> <td>06/16/1993</td> <td>42,000</td> <td>Yes</td> </tr> <tr> <td>806/225</td> <td></td> <td></td> <td>34,000</td> <td>No</td> </tr> </tbody> </table>					Bk/Pg	Grantor	Date	Price	Code	1295/205	CLARKE, TIMOTHY C &	06/08/2001	70,000	YES	919/832	DICKSON, BILLIE SUSAN-TRUSTEE	06/16/1993	42,000	Yes	806/225			34,000	No																																																																																		
Code	Type	Active	Maximum	Exemption																																																																																																																					
H	Homestead	Yes	1,000	1,000																																																																																																																					
Bk/Pg	Grantor	Date	Price	Code																																																																																																																					
1295/205	CLARKE, TIMOTHY C &	06/08/2001	70,000	YES																																																																																																																					
919/832	DICKSON, BILLIE SUSAN-TRUSTEE	06/16/1993	42,000	Yes																																																																																																																					
806/225			34,000	No																																																																																																																					
<b>Parcel Valuation</b>																																																																																																																									
<table border="1"> <thead> <tr> <th>Source</th> <th>REAL</th> </tr> </thead> <tbody> <tr> <td>Remove Cap</td> <td>2002</td> </tr> <tr> <td>Year Frozen</td> <td>0</td> </tr> <tr> <td>Uncapped Value</td> <td>0</td> </tr> <tr> <td>TIF Project ID</td> <td>0</td> </tr> </tbody> </table>		Source	REAL	Remove Cap	2002	Year Frozen	0	Uncapped Value	0	TIF Project ID	0	<table border="1"> <thead> <tr> <th>Fair Cash</th> <th>Capped</th> <th>Asmnt Level</th> <th>Assessed</th> </tr> </thead> <tbody> <tr> <td>Land Value 34,755</td> <td>23,088</td> <td>11%</td> <td>2,540</td> </tr> <tr> <td>Improvements 67,775</td> <td>59,551</td> <td></td> <td>6,551</td> </tr> <tr> <td>Mobile Home 0</td> <td>0</td> <td></td> <td>0</td> </tr> <tr> <td>Total Value 102,530</td> <td>82,639</td> <td></td> <td>9,091</td> </tr> </tbody> </table>			Fair Cash	Capped	Asmnt Level	Assessed	Land Value 34,755	23,088	11%	2,540	Improvements 67,775	59,551		6,551	Mobile Home 0	0		0	Total Value 102,530	82,639		9,091	<table border="1"> <thead> <tr> <th>Levy Rate</th> <th>Current Tax</th> </tr> </thead> <tbody> <tr> <td>92.430</td> <td>840.28</td> </tr> <tr> <td>Assessed 9,091</td> <td></td> </tr> <tr> <td>Penalty 0</td> <td></td> </tr> <tr> <td>Exemption 1,000</td> <td>-92.00</td> </tr> <tr> <td>Total Taxable 8,091</td> <td>748.00</td> </tr> </tbody> </table>		Levy Rate	Current Tax	92.430	840.28	Assessed 9,091		Penalty 0		Exemption 1,000	-92.00	Total Taxable 8,091	748.00																																																																									
Source	REAL																																																																																																																								
Remove Cap	2002																																																																																																																								
Year Frozen	0																																																																																																																								
Uncapped Value	0																																																																																																																								
TIF Project ID	0																																																																																																																								
Fair Cash	Capped	Asmnt Level	Assessed																																																																																																																						
Land Value 34,755	23,088	11%	2,540																																																																																																																						
Improvements 67,775	59,551		6,551																																																																																																																						
Mobile Home 0	0		0																																																																																																																						
Total Value 102,530	82,639		9,091																																																																																																																						
Levy Rate	Current Tax																																																																																																																								
92.430	840.28																																																																																																																								
Assessed 9,091																																																																																																																									
Penalty 0																																																																																																																									
Exemption 1,000	-92.00																																																																																																																								
Total Taxable 8,091	748.00																																																																																																																								
<b>Assessment History</b>																																																																																																																									
<table border="1"> <thead> <tr> <th>Tax Year</th> <th>Statement Number</th> <th>Billed Owner</th> <th>Tax Area</th> <th>Total Value</th> <th>Exemptions</th> <th>Taxable Value</th> <th>Billed Tax</th> </tr> </thead> <tbody> <tr><td>2025</td><td>2025-660004012</td><td>STANTON, JOHNNNA S</td><td>17</td><td>100,271</td><td>1000</td><td>7,826</td><td>723.00</td></tr> <tr><td>2024</td><td>2024-660004012</td><td>STANTON, JOHNNNA S</td><td>17</td><td>96,369</td><td>1000</td><td>7,569</td><td>700.00</td></tr> <tr><td>2023</td><td>2023-660004012</td><td>STANTON, JOHNNNA S</td><td>17</td><td>86,338</td><td>1000</td><td>7,319</td><td>670.00</td></tr> <tr><td>2022</td><td>2022-660004012</td><td>STANTON, JOHNNNA S</td><td>17</td><td>73,912</td><td>1000</td><td>7,077</td><td>655.00</td></tr> <tr><td>2021</td><td>2021-660004012</td><td>STANTON, JOHNNNA S</td><td>17</td><td>71,289</td><td>1000</td><td>6,842</td><td>604.00</td></tr> <tr><td>2020</td><td>2020-660004012</td><td>STANTON, JOHNNNA S</td><td>17</td><td>70,277</td><td>1000</td><td>6,730</td><td>616.00</td></tr> <tr><td>2019</td><td>2019-660004012</td><td>STANTON, JOHNNNA S</td><td>17</td><td>68,864</td><td>1000</td><td>6,575</td><td>609.00</td></tr> <tr><td>2018</td><td>2018-660004012</td><td>STANTON, JOHNNNA S</td><td>17</td><td>72,571</td><td>1000</td><td>6,983</td><td>645.00</td></tr> <tr><td>2017</td><td>2017-660004012</td><td>STANTON, JOHNNNA S</td><td>17</td><td>72,063</td><td>1000</td><td>6,927</td><td>636.00</td></tr> <tr><td>2016</td><td>2016-660004012</td><td>STANTON, JOHNNNA S</td><td>17</td><td>70,426</td><td>1000</td><td>6,747</td><td>633.00</td></tr> <tr><td>2015</td><td>2015-660004012</td><td>STANTON, JOHNNNA S</td><td>17</td><td>70,807</td><td>1000</td><td>6,789</td><td>612.00</td></tr> <tr><td>2014</td><td>2014-660004012</td><td>STANTON, JOHNNNA S</td><td>17</td><td>71,310</td><td>1000</td><td>6,695</td><td>621.00</td></tr> <tr><td>2013</td><td>2013-660004012</td><td>STANTON, JOHNNNA S</td><td>17</td><td>67,916</td><td>1000</td><td>6,471</td><td>592.00</td></tr> </tbody> </table>										Tax Year	Statement Number	Billed Owner	Tax Area	Total Value	Exemptions	Taxable Value	Billed Tax	2025	2025-660004012	STANTON, JOHNNNA S	17	100,271	1000	7,826	723.00	2024	2024-660004012	STANTON, JOHNNNA S	17	96,369	1000	7,569	700.00	2023	2023-660004012	STANTON, JOHNNNA S	17	86,338	1000	7,319	670.00	2022	2022-660004012	STANTON, JOHNNNA S	17	73,912	1000	7,077	655.00	2021	2021-660004012	STANTON, JOHNNNA S	17	71,289	1000	6,842	604.00	2020	2020-660004012	STANTON, JOHNNNA S	17	70,277	1000	6,730	616.00	2019	2019-660004012	STANTON, JOHNNNA S	17	68,864	1000	6,575	609.00	2018	2018-660004012	STANTON, JOHNNNA S	17	72,571	1000	6,983	645.00	2017	2017-660004012	STANTON, JOHNNNA S	17	72,063	1000	6,927	636.00	2016	2016-660004012	STANTON, JOHNNNA S	17	70,426	1000	6,747	633.00	2015	2015-660004012	STANTON, JOHNNNA S	17	70,807	1000	6,789	612.00	2014	2014-660004012	STANTON, JOHNNNA S	17	71,310	1000	6,695	621.00	2013	2013-660004012	STANTON, JOHNNNA S	17	67,916	1000	6,471	592.00
Tax Year	Statement Number	Billed Owner	Tax Area	Total Value	Exemptions	Taxable Value	Billed Tax																																																																																																																		
2025	2025-660004012	STANTON, JOHNNNA S	17	100,271	1000	7,826	723.00																																																																																																																		
2024	2024-660004012	STANTON, JOHNNNA S	17	96,369	1000	7,569	700.00																																																																																																																		
2023	2023-660004012	STANTON, JOHNNNA S	17	86,338	1000	7,319	670.00																																																																																																																		
2022	2022-660004012	STANTON, JOHNNNA S	17	73,912	1000	7,077	655.00																																																																																																																		
2021	2021-660004012	STANTON, JOHNNNA S	17	71,289	1000	6,842	604.00																																																																																																																		
2020	2020-660004012	STANTON, JOHNNNA S	17	70,277	1000	6,730	616.00																																																																																																																		
2019	2019-660004012	STANTON, JOHNNNA S	17	68,864	1000	6,575	609.00																																																																																																																		
2018	2018-660004012	STANTON, JOHNNNA S	17	72,571	1000	6,983	645.00																																																																																																																		
2017	2017-660004012	STANTON, JOHNNNA S	17	72,063	1000	6,927	636.00																																																																																																																		
2016	2016-660004012	STANTON, JOHNNNA S	17	70,426	1000	6,747	633.00																																																																																																																		
2015	2015-660004012	STANTON, JOHNNNA S	17	70,807	1000	6,789	612.00																																																																																																																		
2014	2014-660004012	STANTON, JOHNNNA S	17	71,310	1000	6,695	621.00																																																																																																																		
2013	2013-660004012	STANTON, JOHNNNA S	17	67,916	1000	6,471	592.00																																																																																																																		



# Rogers

## Assessment Property Record Card for Tax Year 2026

Data provided by LISA DELOZIER County Assessor

Date 04/17/2026  
 Time 02:15:20  
 Page 2

Lot Data	Square-Foot - NBHD 1183 #1	Primary Image
<b>Lot Size</b> <b>Lot Count</b> 1 <b>Units Buildable</b> 1 <b>Non-Ag Acres</b> 0.1596 <b>Topography</b> <b>Street Access</b> <b>Utilities</b> <b>Amenities</b> LOT SIZE ADJUSTMENT 0 0 <b>Method</b> Square-Foot <b>Base Lot Value</b> 6,951.00 x 5.00 = 34,755 <b>Factor Value</b> <b>Adjustments</b> 1.0000 <b>Lot Value</b> 34,755		
<b>Residential Data</b> <b>Type</b> 1 Single Family Residence <b>Condition</b> 3 - Average <b>Quality</b> 2 - Fair <b>Architecture</b> R3 Res Nbhd 3 <b>Style</b> 100% One Story <b>Exterior Wall</b> 100% Veneer, Masonry <b>Base/Total Area</b> 1,020 / 1,020 <b>Style</b> 100% One Story <b>HVAC</b> 100% Warmed & Cooled Air <b>Roof Cover</b> 1 Composition Shingle <b>Area on Slab</b> 1,020 <b>Fixture/RghIn</b> 4 / <b>Bed/F/H Bath</b> 3 / 1.0 / <b>Basement Area</b> <b>Garage Type</b> 300 Attached Garage - Unfinished <b>Remodel</b> <b>Year/Eff Age</b> 1973 / 40		

\\tsclient\T\LOGAN\LOGAN RESIDENTIAL VI\2023-4-18\IMG\_0001 4/18/2023

Residential Data	
<b>Type</b>	1 Single Family Residence
<b>Condition</b>	3 - Average
<b>Quality</b>	2 - Fair
<b>Architecture</b>	R3 Res Nbhd 3
<b>Style</b>	100% One Story
<b>Exterior Wall</b>	100% Veneer, Masonry
<b>Base/Total Area</b>	1,020 / 1,020
<b>Style</b>	100% One Story
<b>HVAC</b>	100% Warmed & Cooled Air
<b>Roof Cover</b>	1 Composition Shingle
<b>Area on Slab</b>	1,020
<b>Fixture/RghIn</b>	4 /
<b>Bed/F/H Bath</b>	3 / 1.0 /
<b>Basement Area</b>	
<b>Garage Type</b>	300 Attached Garage - Unfinished
<b>Remodel</b>	
<b>Year/Eff Age</b>	1973 / 40

GRM Approach	
<b>GRM Code</b>	
<b>Gross Rent</b>	0.00
<b>Indicated Value</b>	

Multiple Regression			
<b>MRA Code</b>	1	Test	
<b>Adjusted R</b>	0.8445		
<b>Indicated Value</b>	97,188	95.28	Per SqFt

Direct Comparables	
<b>Selection Model</b>	A Adam Test
<b>Adjustment Model</b>	1 2022 Residential
<b>Comparables</b>	
<b>Indicated Value</b>	115,670 Per SqFt

Cost Approach				Manual : 01/2025	
<b>Base Cost</b>	104.41	<b>Total Misc Impr</b>	+	1,057	
<b>Roofing Adj</b>	+ 4.29	<b>Garage Cost</b>	+	8,106	
<b>Subfloor Adj</b>	+ 0.00	<b>Total RCN</b>	=	135,551	
<b>Heat/Cool Adj</b>	+ 10.30	<b>Depreciation ( 50%)</b>	-	67,776	
<b>Plumbing Adj</b>	+ 4.91	<b>Lump Sums</b>	+	0	
<b>Basement Adj</b>	+ 0.00	<b>RCNLD</b>	=	67,775	
<b>Adj Base Cost</b>	= 123.91	<b>Lot Value</b>	+	34,755	
<b>Total Area</b>	x 1,020	<b>Indicated Value</b>	=	102,530	
<b>Adjusted Cost</b>	= 126,388	<b>Value Per SqFt</b>		100.52	

Value Reconciliation			
<b>Selected Approach</b>	Cost Approach		
<b>Improvements</b>	67,775		
<b>Lot Value</b>	34,755		
<b>Indicated Value</b>	102,530	100.52	Per SqFt
<b>Agland Value</b>			
<b>Site Improvements</b>			
<b>Total Value</b>	102,530	100.52	Total Value Per SqFt

Miscellaneous Improvements								
Code	Description	Sketch ID	Size	Year	Units	Unit Cost	Depr	Value
PRCH	SLAB PORCH - COVERED	10171	10x5		50	21.14		1,057



# Rogers

## Assessment Property Record Card for Tax Year 2026

Data provided by LISA DELOZIER County Assessor

Date 04/17/2026

Time 02:15:20

Page 3

### Sketch Image

660004012

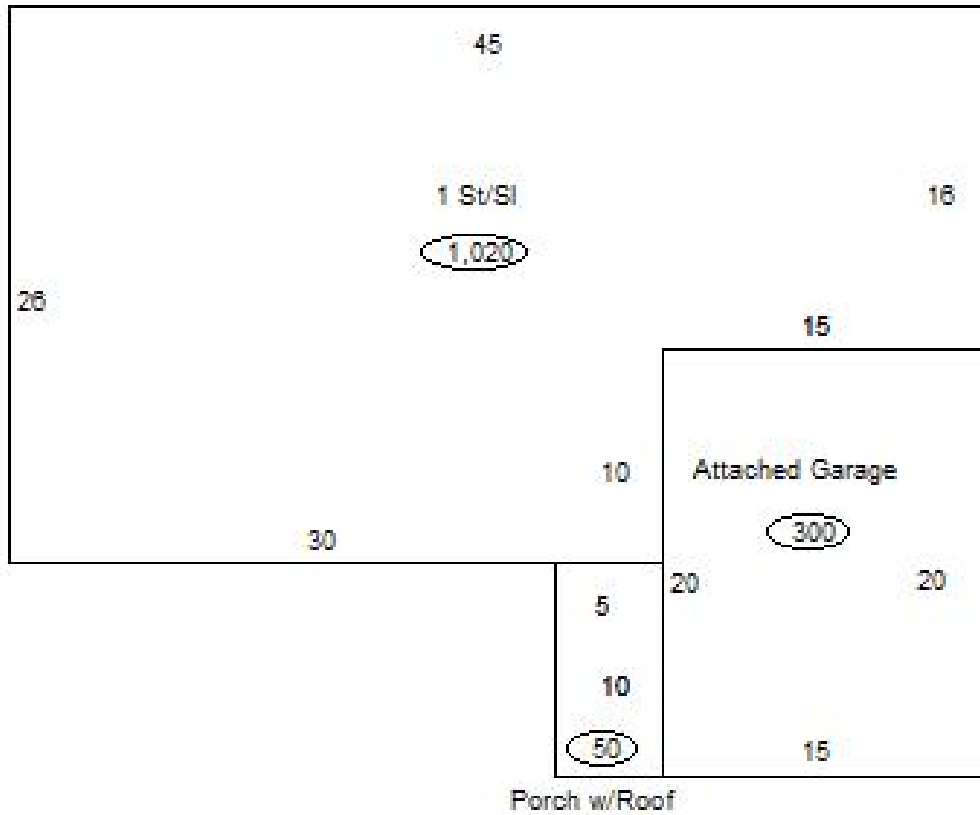

### Sketch Vector Information

Sequence	Code	Type	Built Over	Scale	Section Label	Base Area	Multiplier	Total Area
1	R	1	Slab	13	1 St/Sl	1,020	1.000	1,020
2	G	1		13	Attached Garage	300	1.000	300
3	M	PRCH		13	SLBC	50	1.000	50
<b>Total Building Area</b>						1,020		1,020