



# Rogers

## Assessment Property Record Card for Tax Year 2026

Data provided by LISA DELOZIER County Assessor

Date 04/17/2026  
Time 16:33:03  
Page 1

Assessment Data					Primary Image																																																																																																																				
<b>Account</b> 660004079 <b>Parcel ID</b> 000000-00-0-10260-001-0009 <b>Cadastral ID</b> 05-21-16-06300 <b>Property Type</b> REAL - Real Property <b>Property Class</b> URP VI Area 1 <b>Tax Area</b> 17 - CLAREMORE OT <b>Name ID</b> 312792 AZEVEDO, GARTH TERRANCE & AMANDA ANN  1602 N CHAMBERS TERR CLAREMORE OK 74017-0000  <b>Parcel Location</b> <b>Situs</b> 01602 N CHAMBERS TER <b>Subdivision</b> MEADOW VIEW <b>Lot/Block</b> 0009 / 0001 <b>Parcel Size</b> 1 - Lots <b>Sec/Twn/Rng</b> 5 / 21 / 16 / 5 <b>Neighborhood</b> 1183 - R-V01-SW CLAREMORE <b>School District</b> S001 - CLAREMORE SCHOOLS																																																																																																																									
<b>Legal Description</b> Lat/Long: 36.32405632 -95.62167201																																																																																																																									
<b>Building Permits</b>					<table border="1"> <thead> <tr> <th>Number</th> <th>Description</th> <th>Opened</th> <th>Closed</th> <th>Amount</th> </tr> </thead> <tbody> <tr> <td>2941</td> <td>SUN ROOM R4</td> <td>05/2002</td> <td>02/2004</td> <td>10,586</td> </tr> </tbody> </table>					Number	Description	Opened	Closed	Amount	2941	SUN ROOM R4	05/2002	02/2004	10,586																																																																																																						
Number	Description	Opened	Closed	Amount																																																																																																																					
2941	SUN ROOM R4	05/2002	02/2004	10,586																																																																																																																					
<b>Exemptions</b>					<b>Sale History</b>																																																																																																																				
<table border="1"> <thead> <tr> <th>Code</th> <th>Type</th> <th>Active</th> <th>Maximum</th> <th>Exemption</th> </tr> </thead> <tbody> <tr> <td colspan="5">LOT 9 BLOCK 1 MEADOW VIEW</td> </tr> </tbody> </table>					Code	Type	Active	Maximum	Exemption	LOT 9 BLOCK 1 MEADOW VIEW					<table border="1"> <thead> <tr> <th>Bk/Pg</th> <th>Grantor</th> <th>Date</th> <th>Price</th> <th>Code</th> </tr> </thead> <tbody> <tr> <td>2414/889</td> <td>COPE, ROBERT W</td> <td>07/02/2014</td> <td>85,000</td> <td>YES</td> </tr> <tr> <td>2050/637</td> <td>LANE, LARRY H &amp; BARBARA D-&amp;</td> <td>08/19/2009</td> <td>95,000</td> <td>YES</td> </tr> <tr> <td>1250/6</td> <td>PHILLIPS, G SAMUEL &amp; LINDA-L</td> <td>09/29/2000</td> <td>72,000</td> <td>Yes</td> </tr> <tr> <td>1218/764</td> <td>SECRETARY OF HOUSING &amp;-URBAN I</td> <td>03/10/2000</td> <td>0</td> <td>No</td> </tr> <tr> <td>1205/241</td> <td>SIMONS, ROY E &amp; CHERILYN M</td> <td>11/18/1999</td> <td>0</td> <td>No</td> </tr> <tr> <td>1039/357</td> <td>STEINMITZ, JOHN E &amp;</td> <td>08/30/1996</td> <td>57,000</td> <td>Yes</td> </tr> </tbody> </table>					Bk/Pg	Grantor	Date	Price	Code	2414/889	COPE, ROBERT W	07/02/2014	85,000	YES	2050/637	LANE, LARRY H & BARBARA D-&	08/19/2009	95,000	YES	1250/6	PHILLIPS, G SAMUEL & LINDA-L	09/29/2000	72,000	Yes	1218/764	SECRETARY OF HOUSING &-URBAN I	03/10/2000	0	No	1205/241	SIMONS, ROY E & CHERILYN M	11/18/1999	0	No	1039/357	STEINMITZ, JOHN E &	08/30/1996	57,000	Yes																																																																			
Code	Type	Active	Maximum	Exemption																																																																																																																					
LOT 9 BLOCK 1 MEADOW VIEW																																																																																																																									
Bk/Pg	Grantor	Date	Price	Code																																																																																																																					
2414/889	COPE, ROBERT W	07/02/2014	85,000	YES																																																																																																																					
2050/637	LANE, LARRY H & BARBARA D-&	08/19/2009	95,000	YES																																																																																																																					
1250/6	PHILLIPS, G SAMUEL & LINDA-L	09/29/2000	72,000	Yes																																																																																																																					
1218/764	SECRETARY OF HOUSING &-URBAN I	03/10/2000	0	No																																																																																																																					
1205/241	SIMONS, ROY E & CHERILYN M	11/18/1999	0	No																																																																																																																					
1039/357	STEINMITZ, JOHN E &	08/30/1996	57,000	Yes																																																																																																																					
<b>Parcel Valuation</b>																																																																																																																									
<table border="1"> <thead> <tr> <th>Source</th> <th>REAL</th> </tr> </thead> <tbody> <tr> <td>Remove Cap</td> <td>2015</td> </tr> <tr> <td>Year Frozen</td> <td>0</td> </tr> <tr> <td>Uncapped Value</td> <td>0</td> </tr> <tr> <td>TIF Project ID</td> <td>0</td> </tr> </tbody> </table>		Source	REAL	Remove Cap	2015	Year Frozen	0	Uncapped Value	0	TIF Project ID	0	<table border="1"> <thead> <tr> <th>Fair Cash</th> <th>Capped</th> <th>Asmnt Level</th> <th>Assessed</th> </tr> </thead> <tbody> <tr> <td>Land Value</td> <td>34,870</td> <td>34,870</td> <td>3,836</td> </tr> <tr> <td>Improvements</td> <td>72,549</td> <td>72,549</td> <td>7,980</td> </tr> <tr> <td>Mobile Home</td> <td>0</td> <td>0</td> <td>0</td> </tr> <tr> <td>Total Value</td> <td>107,419</td> <td>107,419</td> <td>11,816</td> </tr> </tbody> </table>			Fair Cash	Capped	Asmnt Level	Assessed	Land Value	34,870	34,870	3,836	Improvements	72,549	72,549	7,980	Mobile Home	0	0	0	Total Value	107,419	107,419	11,816	<table border="1"> <thead> <tr> <th>Levy Rate</th> <th>Current Tax</th> </tr> </thead> <tbody> <tr> <td>92.430</td> <td>1,092.15</td> </tr> <tr> <td>Assessed</td> <td>11,816</td> </tr> <tr> <td>Penalty</td> <td>0</td> </tr> <tr> <td>Exemption</td> <td>0</td> </tr> <tr> <td>Total Taxable</td> <td>11,816</td> </tr> </tbody> </table>		Levy Rate	Current Tax	92.430	1,092.15	Assessed	11,816	Penalty	0	Exemption	0	Total Taxable	11,816																																																																									
Source	REAL																																																																																																																								
Remove Cap	2015																																																																																																																								
Year Frozen	0																																																																																																																								
Uncapped Value	0																																																																																																																								
TIF Project ID	0																																																																																																																								
Fair Cash	Capped	Asmnt Level	Assessed																																																																																																																						
Land Value	34,870	34,870	3,836																																																																																																																						
Improvements	72,549	72,549	7,980																																																																																																																						
Mobile Home	0	0	0																																																																																																																						
Total Value	107,419	107,419	11,816																																																																																																																						
Levy Rate	Current Tax																																																																																																																								
92.430	1,092.15																																																																																																																								
Assessed	11,816																																																																																																																								
Penalty	0																																																																																																																								
Exemption	0																																																																																																																								
Total Taxable	11,816																																																																																																																								
<b>Assessment History</b>																																																																																																																									
<table border="1"> <thead> <tr> <th>Tax Year</th> <th>Statement Number</th> <th>Billed Owner</th> <th>Tax Area</th> <th>Total Value</th> <th>Exemptions</th> <th>Taxable Value</th> <th>Billed Tax</th> </tr> </thead> <tbody> <tr><td>2025</td><td>2025-660004079</td><td>AZEVEDO, GARTH TERRANCE &amp;</td><td>17</td><td>105,019</td><td>0</td><td>11,552</td><td>1,068.00</td></tr> <tr><td>2024</td><td>2024-660004079</td><td>AZEVEDO, GARTH TERRANCE &amp;</td><td>17</td><td>111,667</td><td>0</td><td>11,462</td><td>1,059.00</td></tr> <tr><td>2023</td><td>2023-660004079</td><td>AZEVEDO, GARTH TERRANCE &amp;</td><td>17</td><td>106,847</td><td>0</td><td>10,916</td><td>1,000.00</td></tr> <tr><td>2022</td><td>2022-660004079</td><td>AZEVEDO, GARTH TERRANCE &amp;</td><td>17</td><td>94,515</td><td>0</td><td>10,397</td><td>962.00</td></tr> <tr><td>2021</td><td>2021-660004079</td><td>AZEVEDO, GARTH TERRANCE &amp;</td><td>17</td><td>93,539</td><td>0</td><td>10,289</td><td>909.00</td></tr> <tr><td>2020</td><td>2020-660004079</td><td>AZEVEDO, GARTH TERRANCE &amp;</td><td>17</td><td>92,107</td><td>0</td><td>10,132</td><td>928.00</td></tr> <tr><td>2019</td><td>2019-660004079</td><td>AZEVEDO, GARTH TERRANCE &amp;</td><td>17</td><td>87,835</td><td>0</td><td>9,662</td><td>895.00</td></tr> <tr><td>2018</td><td>2018-660004079</td><td>AZEVEDO, GARTH TERRANCE &amp;</td><td>17</td><td>91,087</td><td>0</td><td>10,020</td><td>926.00</td></tr> <tr><td>2017</td><td>2017-660004079</td><td>AZEVEDO, GARTH TERRANCE &amp;</td><td>17</td><td>90,382</td><td>0</td><td>9,942</td><td>913.00</td></tr> <tr><td>2016</td><td>2016-660004079</td><td>AZEVEDO, GARTH TERRANCE &amp;</td><td>17</td><td>88,240</td><td>0</td><td>9,706</td><td>911.00</td></tr> <tr><td>2015</td><td>2015-660004079</td><td>AZEVEDO, GARTH TERRANCE &amp;</td><td>17</td><td>85,939</td><td>0</td><td>9,453</td><td>853.00</td></tr> <tr><td>2014</td><td>2014-660004079</td><td>AZEVEDO, GARTH TERRANCE &amp;</td><td>17</td><td>86,587</td><td>0</td><td>9,525</td><td>883.00</td></tr> <tr><td>2013</td><td>2013-660004079</td><td>COPE, ROBERT W</td><td>17</td><td>82,687</td><td>0</td><td>9,096</td><td>832.00</td></tr> </tbody> </table>										Tax Year	Statement Number	Billed Owner	Tax Area	Total Value	Exemptions	Taxable Value	Billed Tax	2025	2025-660004079	AZEVEDO, GARTH TERRANCE &	17	105,019	0	11,552	1,068.00	2024	2024-660004079	AZEVEDO, GARTH TERRANCE &	17	111,667	0	11,462	1,059.00	2023	2023-660004079	AZEVEDO, GARTH TERRANCE &	17	106,847	0	10,916	1,000.00	2022	2022-660004079	AZEVEDO, GARTH TERRANCE &	17	94,515	0	10,397	962.00	2021	2021-660004079	AZEVEDO, GARTH TERRANCE &	17	93,539	0	10,289	909.00	2020	2020-660004079	AZEVEDO, GARTH TERRANCE &	17	92,107	0	10,132	928.00	2019	2019-660004079	AZEVEDO, GARTH TERRANCE &	17	87,835	0	9,662	895.00	2018	2018-660004079	AZEVEDO, GARTH TERRANCE &	17	91,087	0	10,020	926.00	2017	2017-660004079	AZEVEDO, GARTH TERRANCE &	17	90,382	0	9,942	913.00	2016	2016-660004079	AZEVEDO, GARTH TERRANCE &	17	88,240	0	9,706	911.00	2015	2015-660004079	AZEVEDO, GARTH TERRANCE &	17	85,939	0	9,453	853.00	2014	2014-660004079	AZEVEDO, GARTH TERRANCE &	17	86,587	0	9,525	883.00	2013	2013-660004079	COPE, ROBERT W	17	82,687	0	9,096	832.00
Tax Year	Statement Number	Billed Owner	Tax Area	Total Value	Exemptions	Taxable Value	Billed Tax																																																																																																																		
2025	2025-660004079	AZEVEDO, GARTH TERRANCE &	17	105,019	0	11,552	1,068.00																																																																																																																		
2024	2024-660004079	AZEVEDO, GARTH TERRANCE &	17	111,667	0	11,462	1,059.00																																																																																																																		
2023	2023-660004079	AZEVEDO, GARTH TERRANCE &	17	106,847	0	10,916	1,000.00																																																																																																																		
2022	2022-660004079	AZEVEDO, GARTH TERRANCE &	17	94,515	0	10,397	962.00																																																																																																																		
2021	2021-660004079	AZEVEDO, GARTH TERRANCE &	17	93,539	0	10,289	909.00																																																																																																																		
2020	2020-660004079	AZEVEDO, GARTH TERRANCE &	17	92,107	0	10,132	928.00																																																																																																																		
2019	2019-660004079	AZEVEDO, GARTH TERRANCE &	17	87,835	0	9,662	895.00																																																																																																																		
2018	2018-660004079	AZEVEDO, GARTH TERRANCE &	17	91,087	0	10,020	926.00																																																																																																																		
2017	2017-660004079	AZEVEDO, GARTH TERRANCE &	17	90,382	0	9,942	913.00																																																																																																																		
2016	2016-660004079	AZEVEDO, GARTH TERRANCE &	17	88,240	0	9,706	911.00																																																																																																																		
2015	2015-660004079	AZEVEDO, GARTH TERRANCE &	17	85,939	0	9,453	853.00																																																																																																																		
2014	2014-660004079	AZEVEDO, GARTH TERRANCE &	17	86,587	0	9,525	883.00																																																																																																																		
2013	2013-660004079	COPE, ROBERT W	17	82,687	0	9,096	832.00																																																																																																																		



# Rogers

## Assessment Property Record Card for Tax Year 2026

Data provided by LISA DELOZIER County Assessor

Date 04/17/2026  
Time 16:33:03  
Page 2

Lot Data	Square-Foot - NBHD 1183 #1	Primary Image
Lot Size		
Lot Count	1	
Units Buildable	10000	
Non-Ag Acres	0.1601	
Topography		
Street Access		
Utilities		
Amenities	LOT SIZE ADJUSTMENT	
	0	
	0	
Method	Square-Foot	
Base Lot Value	6,974.00 x 5.00 = 34,870	
Factor Value		
Adjustments	1.0000	
Lot Value	34,870	

Residential Data	
Type	1 Single Family Residence
Condition	3 - Average
Quality	2 - Fair
Architecture	R3 Res Nbhd 3
Style	100% One Story
Exterior Wall	100% Veneer, Masonry
Base/Total Area	1,026 / 1,026
Style	100% One Story
HVAC	100% Warmed & Cooled Air
Roof Cover	1 Composition Shingle
Area on Slab	1,026
Fixture/RghIn	4 /
Bed/F/H Bath	3 / 1.0 /
Basement Area	
Garage Type	324 Attached Garage - Unfinished
Remodel	
Year/Eff Age	1970 / 42

\\tsclient\T\LOGAN\LOGAN RESIDENTIAL VI\2023-4-21\IMG\_001; 4/24/2023

GRM Approach	
GRM Code	
Gross Rent	0.00
Indicated Value	

Multiple Regression			
MRA Code	1	Test	
Adusted R	0.8445		
Indicated Value	97,011	94.55	Per SqFt

Direct Comparables			
Selection Model	A	Adam Test	
Adjustment Model	1	2022 Residential	
Comparables	6		
Indicated Value	122,880		Per SqFt

Cost Approach				Manual : 01/2025	
Base Cost	106.89	Total Misc Impr	+	12,849	
Roofing Adj	+ 4.38	Garage Cost	+	8,547	
Subfloor Adj	+ 0.00	Total RCN	=	151,144	
Heat/Cool Adj	+ 10.30	Depreciation ( 52%)	-	78,595	
Plumbing Adj	+ 4.89	Lump Sums	+	0	
Basement Adj	+ 0.00	RCNLD	=	72,549	
Adj Base Cost	= 126.46	Lot Value	+	34,870	
Total Area	x 1,026	Indicated Value	=	107,419	
Adjusted Cost	= 129,748	Value Per SqFt		104.70	

Value Reconciliation			
Selected Approach	Cost Approach		
Improvements	72,549		
Lot Value	34,870		
Indicated Value	107,419	104.70	Per SqFt
Agland Value			
Site Improvements			
Total Value	107,419	104.70	Total Value Per SqFt

Miscellaneous Improvements								
Code	Description	Sketch ID	Size	Year	Units	Unit Cost	Depr	Value
PRCH	SLAB PORCH - COVERED	10420	18x3		54	21.12		1,140
EPSW	ENCLOSED PORCH - SOLID WALL	10421	18x12		216	54.21		11,709



# Rogers

## Assessment Property Record Card for Tax Year 2026

Data provided by LISA DELOZIER County Assessor

Date 04/17/2026

Time 16:33:03

Page 3

Sketch Image

660004079

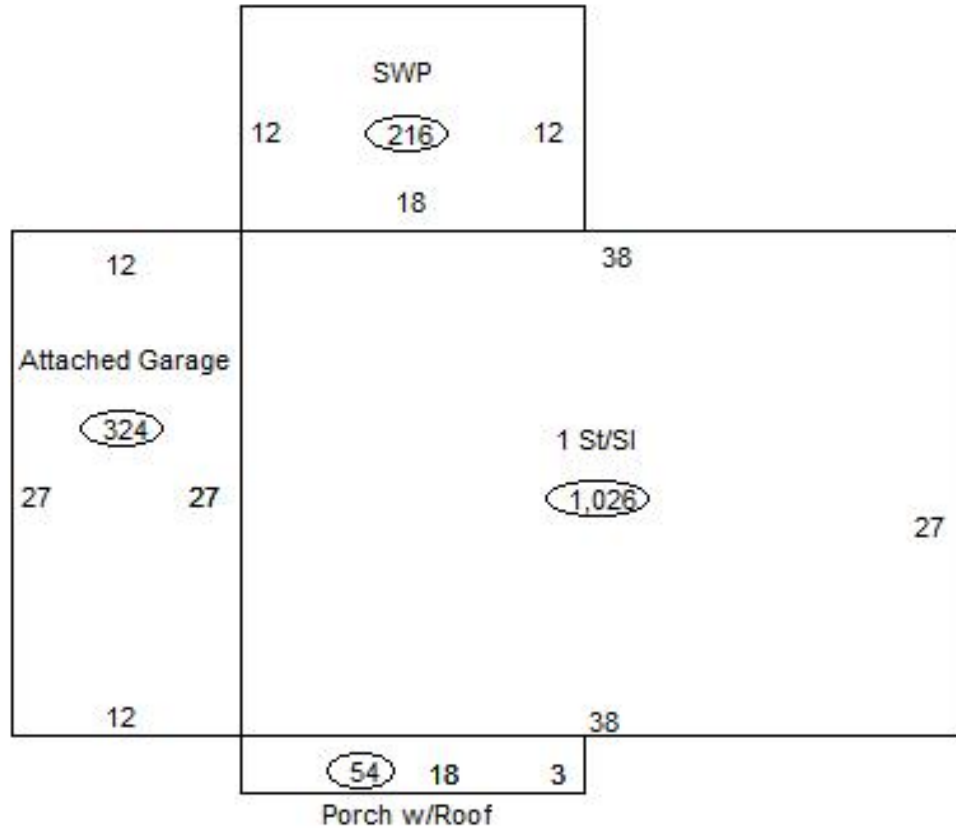

### Sketch Vector Information

Sequence	Code	Type	Built Over	Scale	Section Label	Base Area	Multiplier	Total Area
1	R	1	Slab	13	1 St/SI	1,026	1.000	1,026
2	G	1		13	Attached Garage	324	1.000	324
3	M	PRCH		13	SLBC	54	1.000	54
4	M	EPSW		13	EPSW	216	1.000	216
<b>Total Building Area</b>						1,026		1,026