



# Rogers

## Assessment Property Record Card for Tax Year 2026

Data provided by LISA DELOZIER County Assessor

Date 04/17/2026  
Time 03:27:41  
Page 1

Assessment Data					Primary Image																																																																																																																				
<b>Account</b> 660004224 <b>Parcel ID</b> 000000-00-0-10510-001-0004 <b>Cadastral ID</b> 05-21-16-07750 <b>Property Type</b> REAL - Real Property <b>Property Class</b> URP VI Area 1 <b>Tax Area</b> 17 - CLAREMORE OT <b>Name ID</b> 309556 WALKER, DONNA  1928 S MEMORIAL DR CLAREMORE OK 74017-0000  <b>Parcel Location</b> <b>Situs</b> 01928 S MEMORIAL DR <b>Subdivision</b> WILL ROGERS HGTS I <b>Lot/Block</b> 0004 / 0001 Parcel Size 1 - Lots <b>Sec/Twn/Rng</b> 5 / 21 / 16 / 5 <b>Neighborhood</b> 1183 - R-V01-SW CLAREMORE <b>School District</b> S001 - CLAREMORE SCHOOLS																																																																																																																									
<b>Legal Description</b> Lot/Long: 36.32811130 -95.63173491																																																																																																																									
<b>Legal Description</b> LOT 4 BLOCK 1 WILL ROGERS HGTS I					<b>Building Permits</b> <table border="1"> <thead> <tr> <th>Number</th> <th>Description</th> <th>Opened</th> <th>Closed</th> <th>Amount</th> </tr> </thead> <tbody> <tr> <td> </td> <td> </td> <td> </td> <td> </td> <td> </td> </tr> </tbody> </table>					Number	Description	Opened	Closed	Amount																																																																																																											
Number	Description	Opened	Closed	Amount																																																																																																																					
<b>Exemptions</b> <table border="1"> <thead> <tr> <th>Code</th> <th>Type</th> <th>Active</th> <th>Maximum</th> <th>Exemption</th> </tr> </thead> <tbody> <tr> <td>H</td> <td>Homestead</td> <td>Yes</td> <td>1,000</td> <td>1,000</td> </tr> <tr> <td>H</td> <td>Homestead</td> <td>No</td> <td>1,000</td> <td> </td> </tr> </tbody> </table>					Code	Type	Active	Maximum	Exemption	H	Homestead	Yes	1,000	1,000	H	Homestead	No	1,000		<b>Sale History</b> <table border="1"> <thead> <tr> <th>Bk/Pg</th> <th>Grantor</th> <th>Date</th> <th>Price</th> <th>Code</th> </tr> </thead> <tbody> <tr> <td>2321/301</td> <td>SWEETEN, RON S &amp;</td> <td>04/22/2013</td> <td>135,000</td> <td>YES</td> </tr> <tr> <td>2115/519</td> <td>WILLIAMS, JOHN D &amp; PENNY</td> <td>06/21/2010</td> <td>135,000</td> <td>YES</td> </tr> </tbody> </table>					Bk/Pg	Grantor	Date	Price	Code	2321/301	SWEETEN, RON S &	04/22/2013	135,000	YES	2115/519	WILLIAMS, JOHN D & PENNY	06/21/2010	135,000	YES																																																																																		
Code	Type	Active	Maximum	Exemption																																																																																																																					
H	Homestead	Yes	1,000	1,000																																																																																																																					
H	Homestead	No	1,000																																																																																																																						
Bk/Pg	Grantor	Date	Price	Code																																																																																																																					
2321/301	SWEETEN, RON S &	04/22/2013	135,000	YES																																																																																																																					
2115/519	WILLIAMS, JOHN D & PENNY	06/21/2010	135,000	YES																																																																																																																					
<b>Parcel Valuation</b> <table border="1"> <thead> <tr> <th>Source</th> <th>REAL</th> <th>Fair Cash</th> <th>Capped</th> <th>Asmnt Level</th> <th>Assessed</th> <th>Levy Rate</th> <th>92.430</th> <th>Current Tax</th> </tr> </thead> <tbody> <tr> <td>Remove Cap</td> <td>2014</td> <td>Land Value 103,471</td> <td>29,549</td> <td>11%</td> <td>3,250</td> <td>Assessed</td> <td>17,553</td> <td>1,622.42</td> </tr> <tr> <td>Year Frozen</td> <td>0</td> <td>Improvements 139,424</td> <td>130,023</td> <td> </td> <td>14,303</td> <td>Penalty</td> <td>0</td> <td> </td> </tr> <tr> <td>Uncapped Value</td> <td>0</td> <td>Mobile Home 0</td> <td>0</td> <td> </td> <td>0</td> <td>Exemption</td> <td>1,000</td> <td>-92.00</td> </tr> <tr> <td>TIF Project ID</td> <td>0</td> <td>Total Value 242,895</td> <td>159,572</td> <td> </td> <td>17,553</td> <td>Total Taxable</td> <td>16,553</td> <td>1,530.00</td> </tr> </tbody> </table>										Source	REAL	Fair Cash	Capped	Asmnt Level	Assessed	Levy Rate	92.430	Current Tax	Remove Cap	2014	Land Value 103,471	29,549	11%	3,250	Assessed	17,553	1,622.42	Year Frozen	0	Improvements 139,424	130,023		14,303	Penalty	0		Uncapped Value	0	Mobile Home 0	0		0	Exemption	1,000	-92.00	TIF Project ID	0	Total Value 242,895	159,572		17,553	Total Taxable	16,553	1,530.00																																																																			
Source	REAL	Fair Cash	Capped	Asmnt Level	Assessed	Levy Rate	92.430	Current Tax																																																																																																																	
Remove Cap	2014	Land Value 103,471	29,549	11%	3,250	Assessed	17,553	1,622.42																																																																																																																	
Year Frozen	0	Improvements 139,424	130,023		14,303	Penalty	0																																																																																																																		
Uncapped Value	0	Mobile Home 0	0		0	Exemption	1,000	-92.00																																																																																																																	
TIF Project ID	0	Total Value 242,895	159,572		17,553	Total Taxable	16,553	1,530.00																																																																																																																	
<b>Assessment History</b> <table border="1"> <thead> <tr> <th>Tax Year</th> <th>Statement Number</th> <th>Billed Owner</th> <th>Tax Area</th> <th>Total Value</th> <th>Exemptions</th> <th>Taxable Value</th> <th>Billed Tax</th> </tr> </thead> <tbody> <tr><td>2025</td><td>2025-660004224</td><td>WALKER, DONNA</td><td>17</td><td>240,979</td><td>1000</td><td>16,042</td><td>1,483.00</td></tr> <tr><td>2024</td><td>2024-660004224</td><td>WALKER, DONNA</td><td>17</td><td>273,736</td><td>1000</td><td>15,546</td><td>1,437.00</td></tr> <tr><td>2023</td><td>2023-660004224</td><td>WALKER, DONNA</td><td>17</td><td>153,284</td><td>1000</td><td>15,064</td><td>1,380.00</td></tr> <tr><td>2022</td><td>2022-660004224</td><td>WALKER, DONNA</td><td>17</td><td>141,780</td><td>1000</td><td>14,596</td><td>1,351.00</td></tr> <tr><td>2021</td><td>2021-660004224</td><td>WALKER, DONNA</td><td>17</td><td>148,164</td><td>1000</td><td>15,298</td><td>1,351.00</td></tr> <tr><td>2020</td><td>2020-660004224</td><td>WALKER, DONNA</td><td>17</td><td>145,766</td><td>1000</td><td>15,034</td><td>1,377.00</td></tr> <tr><td>2019</td><td>2019-660004224</td><td>WALKER, DONNA</td><td>17</td><td>142,033</td><td>1000</td><td>14,624</td><td>1,354.00</td></tr> <tr><td>2018</td><td>2018-660004224</td><td>WALKER, DONNA</td><td>17</td><td>150,189</td><td>1000</td><td>15,365</td><td>1,420.00</td></tr> <tr><td>2017</td><td>2017-660004224</td><td>WALKER, DONNA</td><td>17</td><td>148,954</td><td>1000</td><td>14,889</td><td>1,367.00</td></tr> <tr><td>2016</td><td>2016-660004224</td><td>WALKER, DONNA</td><td>17</td><td>145,067</td><td>1000</td><td>14,426</td><td>1,354.00</td></tr> <tr><td>2015</td><td>2015-660004224</td><td>WALKER, DONNA</td><td>17</td><td>136,151</td><td>1000</td><td>13,977</td><td>1,261.00</td></tr> <tr><td>2014</td><td>2014-660004224</td><td>WALKER, DONNA</td><td>17</td><td>137,243</td><td>0</td><td>15,097</td><td>1,400.00</td></tr> <tr><td>2013</td><td>2013-660004224</td><td>WALKER, DONNA</td><td>17</td><td>129,838</td><td>1000</td><td>13,282</td><td>1,215.00</td></tr> </tbody> </table>										Tax Year	Statement Number	Billed Owner	Tax Area	Total Value	Exemptions	Taxable Value	Billed Tax	2025	2025-660004224	WALKER, DONNA	17	240,979	1000	16,042	1,483.00	2024	2024-660004224	WALKER, DONNA	17	273,736	1000	15,546	1,437.00	2023	2023-660004224	WALKER, DONNA	17	153,284	1000	15,064	1,380.00	2022	2022-660004224	WALKER, DONNA	17	141,780	1000	14,596	1,351.00	2021	2021-660004224	WALKER, DONNA	17	148,164	1000	15,298	1,351.00	2020	2020-660004224	WALKER, DONNA	17	145,766	1000	15,034	1,377.00	2019	2019-660004224	WALKER, DONNA	17	142,033	1000	14,624	1,354.00	2018	2018-660004224	WALKER, DONNA	17	150,189	1000	15,365	1,420.00	2017	2017-660004224	WALKER, DONNA	17	148,954	1000	14,889	1,367.00	2016	2016-660004224	WALKER, DONNA	17	145,067	1000	14,426	1,354.00	2015	2015-660004224	WALKER, DONNA	17	136,151	1000	13,977	1,261.00	2014	2014-660004224	WALKER, DONNA	17	137,243	0	15,097	1,400.00	2013	2013-660004224	WALKER, DONNA	17	129,838	1000	13,282	1,215.00
Tax Year	Statement Number	Billed Owner	Tax Area	Total Value	Exemptions	Taxable Value	Billed Tax																																																																																																																		
2025	2025-660004224	WALKER, DONNA	17	240,979	1000	16,042	1,483.00																																																																																																																		
2024	2024-660004224	WALKER, DONNA	17	273,736	1000	15,546	1,437.00																																																																																																																		
2023	2023-660004224	WALKER, DONNA	17	153,284	1000	15,064	1,380.00																																																																																																																		
2022	2022-660004224	WALKER, DONNA	17	141,780	1000	14,596	1,351.00																																																																																																																		
2021	2021-660004224	WALKER, DONNA	17	148,164	1000	15,298	1,351.00																																																																																																																		
2020	2020-660004224	WALKER, DONNA	17	145,766	1000	15,034	1,377.00																																																																																																																		
2019	2019-660004224	WALKER, DONNA	17	142,033	1000	14,624	1,354.00																																																																																																																		
2018	2018-660004224	WALKER, DONNA	17	150,189	1000	15,365	1,420.00																																																																																																																		
2017	2017-660004224	WALKER, DONNA	17	148,954	1000	14,889	1,367.00																																																																																																																		
2016	2016-660004224	WALKER, DONNA	17	145,067	1000	14,426	1,354.00																																																																																																																		
2015	2015-660004224	WALKER, DONNA	17	136,151	1000	13,977	1,261.00																																																																																																																		
2014	2014-660004224	WALKER, DONNA	17	137,243	0	15,097	1,400.00																																																																																																																		
2013	2013-660004224	WALKER, DONNA	17	129,838	1000	13,282	1,215.00																																																																																																																		



# Rogers

## Assessment Property Record Card for Tax Year 2026

Data provided by LISA DELOZIER County Assessor

Date 04/17/2026  
Time 03:27:42  
Page 2

Lot Data	Square-Foot - NBHD 1183 #1	Primary Image
Lot Size		
Lot Count	1	
Units Buildable	15000	
Non-Ag Acres	0.6947	
Topography		
Street Access		
Utilities		
Amenities	LOT SIZE ADJUSTMENT	
	0	
	0	
Method	Square-Foot	
Base Lot Value	30,263.00 x 3.42 = 103,471	
Factor Value		
Adjustments	1.0000	
Lot Value	103,471	

Residential Data	
Type	1 Single Family Residence
Condition	3 - Average
Quality	3 - Average
Architecture	R3 Res Nbhd 3
Style	100% One Story
Exterior Wall	100% Veneer, Masonry
Base/Total Area	1,910 / 1,910
Style	100% One Story
HVAC	100% Warmed & Cooled Air
Roof Cover	1 Composition Shingle
Area on Slab	1,910
Fixture/RghIn	8 /
Bed/F/H Bath	3 / 2.0 /
Basement Area	
Garage Type	441 Attached Garage - Unfinished 2 Stalls
Remodel	
Year/Eff Age	1965 / 46

\\tsclient\T\TOMMY DUNLAP\New folder (169)\IMG_0008.JPG		4/13/2023
---	--	-----------

GRM Approach	
GRM Code	
Gross Rent	0.00
Indicated Value	

Multiple Regression			
MRA Code	1	Test	
Adusted R	0.8445		
Indicated Value	193,509	101.31	Per SqFt

Direct Comparables	
Selection Model	A Adam Test
Adjustment Model	1 2022 Residential
Comparables	2
Indicated Value	217,180 Per SqFt

Value Reconciliation			
Selected Approach	Cost Approach		
Improvements	139,424		
Lot Value	103,471		
Indicated Value	242,895	127.17	Per SqFt
Agland Value			
Site Improvements			
Total Value	242,895	127.17	Total Value Per SqFt

Cost Approach				Manual : 01/2025			
Base Cost	108.56	Total Misc Impr	+	22,233			
Roofing Adj	+ 4.75	Garage Cost	+	14,522			
Subfloor Adj	+ -2.24	Total RCN	=	284,539			
Heat/Cool Adj	+ 12.64	Depreciation ( 51%)	-	145,115			
Plumbing Adj	+ 6.02	Lump Sums	+	0			
Basement Adj	+ 0.00	RCNLD	=	139,424			
Adj Base Cost	= 129.73	Lot Value	+	103,471			
Total Area	x 1,910	Indicated Value	=	242,895			
Adjusted Cost	= 247,784	Value Per SqFt		127.17			

Miscellaneous Improvements								
Code	Description	Sketch ID	Size	Year	Units	Unit Cost	Depr	Value
FPR1	FIREPLACE - RESIDENTIAL 1 STORY	0		1	1	5,615.40		5,615
PRCH	SLAB PORCH - COVERED	10710	32x4		128	26.53		3,396
PRCH	SLAB PORCH - COVERED	10711	522		522	25.33		13,222



# Rogers

## Assessment Property Record Card for Tax Year 2026

Data provided by LISA DELOZIER County Assessor

Date 04/17/2026  
 Time 03:27:42  
 Page 3

### Sketch Image

660004224

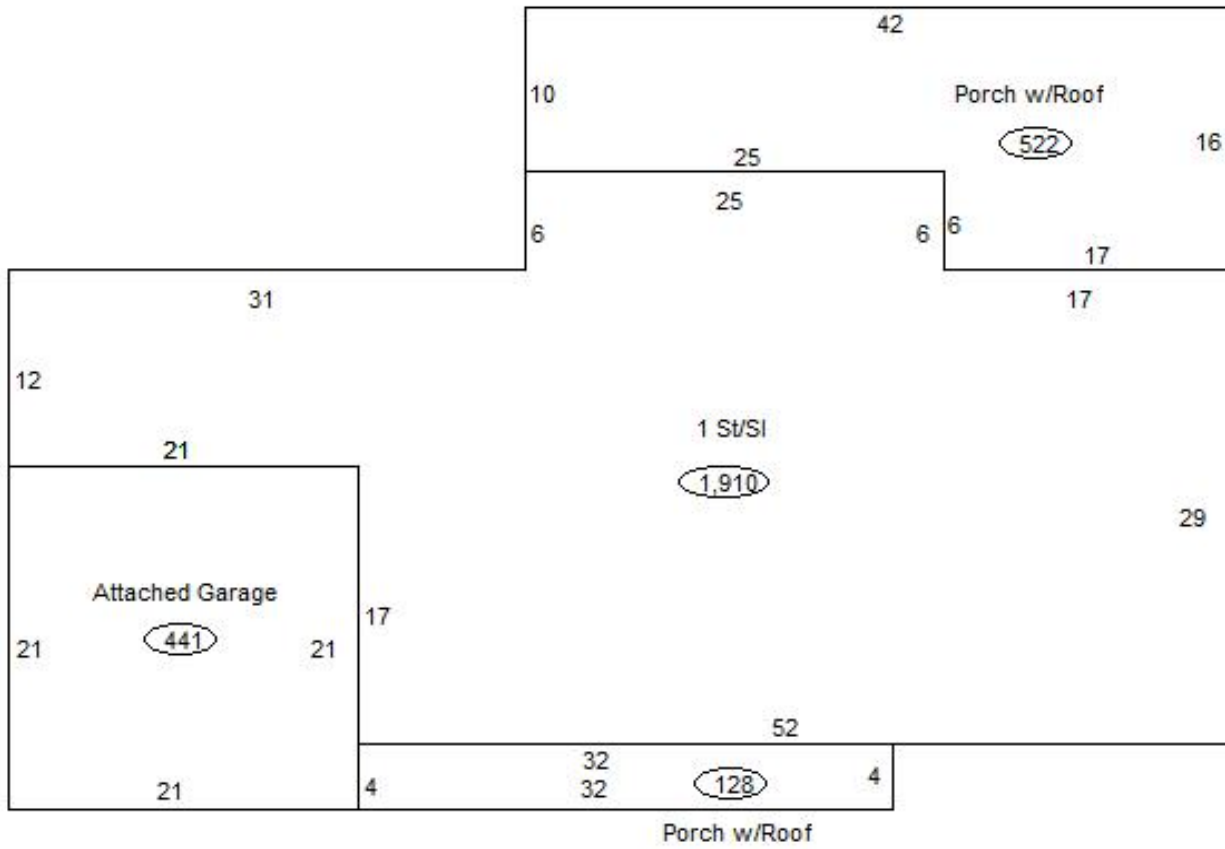

### Sketch Vector Information

Sequence	Code	Type	Built Over	Scale	Section Label	Base Area	Multiplier	Total Area
1	R	1	Slab	13	1 St/SI	1,910	1.000	1,910
2	G	1		13	Attached Garage	441	1.000	441
3	M	PRCH		13	SLBC	128	1.000	128
4	M	PRCH		13	SLBC	522	1.000	522
<b>Total Building Area</b>						1,910		1,910



# Rogers

## Assessment Property Record Card for Tax Year 2026

Data provided by LISA DELOZIER County Assessor

Date 04/17/2026  
Time 03:27:42  
Page 4

660004224

### Outbuildings/Site Improvements

Building Image	Code	Description	Dimensions	Floor	Roofing	Total Units
----------------	------	-------------	------------	-------	---------	-------------

STF	STG FAIR		0x0x0			
Qual	2	Cond	Year	Eff Age		

<b>Valuation Summary</b>		<b>Modifier Total</b>	<b>RCN</b>	<b>Depr (0% Phys/ % Func)</b>	<b>RCNLD</b>
Base Cost (4.68 x )					

STF	STG FAIR		0x0x0			
Qual	2	Cond	Year	Eff Age		

<b>Valuation Summary</b>		<b>Modifier Total</b>	<b>RCN</b>	<b>Depr (0% Phys/ % Func)</b>	<b>RCNLD</b>
Base Cost (4.68 x )					