



Rogers

Assessment Property Record Card for Tax Year 2026

Data provided by LISA DELOZIER County Assessor

Date 04/17/2026
Time 03:28:39
Page 1

Assessment Data					Primary Image																																																																																																																				
Account 660004265 Parcel ID 000000-00-0-10515-005-0007 Cadastral ID 05-21-16-08160 Property Type REAL - Real Property Property Class URP VI Area 1 Tax Area 17 - CLAREMORE OT Name ID 315243 BROWN, STEPHANIE JO 2008 VALLEY VIEW DR CLAREMORE OK 74017-0000 Parcel Location Situs 02008 VALLEY VIEW DR Subdivision WILL ROGERS HGTS II Lot/Block 0007 / 0005 Parcel Size 1 - Lots Sec/Twn/Rng 5 / 21 / 16 / 5 Neighborhood 1183 - R-V01-SW CLAREMORE School District S001 - CLAREMORE SCHOOLS																																																																																																																									
Legal Description Lot/Long: 36.33027870 -95.63047265																																																																																																																									
Building Permits					<table border="1"> <thead> <tr> <th>Number</th> <th>Description</th> <th>Opened</th> <th>Closed</th> <th>Amount</th> </tr> </thead> <tbody> <tr> <td> </td> <td> </td> <td> </td> <td> </td> <td> </td> </tr> </tbody> </table>					Number	Description	Opened	Closed	Amount																																																																																																											
Number	Description	Opened	Closed	Amount																																																																																																																					
Exemptions					Sale History																																																																																																																				
<table border="1"> <thead> <tr> <th>Code</th> <th>Type</th> <th>Active</th> <th>Maximum</th> <th>Exemption</th> </tr> </thead> <tbody> <tr> <td>H</td> <td>Homestead</td> <td>Yes</td> <td>1,000</td> <td>1,000</td> </tr> <tr> <td>H</td> <td>Homestead</td> <td>No</td> <td>1,000</td> <td> </td> </tr> </tbody> </table>					Code	Type	Active	Maximum	Exemption	H	Homestead	Yes	1,000	1,000	H	Homestead	No	1,000		<table border="1"> <thead> <tr> <th>Bk/Pg</th> <th>Grantor</th> <th>Date</th> <th>Price</th> <th>Code</th> </tr> </thead> <tbody> <tr> <td>2474/248</td> <td>COOPER, JAMES C TRUST</td> <td>05/20/2015</td> <td>0</td> <td>4</td> </tr> <tr> <td>2474/243</td> <td>COOPER, JAMES C</td> <td>04/16/2015</td> <td>0</td> <td>4</td> </tr> </tbody> </table>					Bk/Pg	Grantor	Date	Price	Code	2474/248	COOPER, JAMES C TRUST	05/20/2015	0	4	2474/243	COOPER, JAMES C	04/16/2015	0	4																																																																																		
Code	Type	Active	Maximum	Exemption																																																																																																																					
H	Homestead	Yes	1,000	1,000																																																																																																																					
H	Homestead	No	1,000																																																																																																																						
Bk/Pg	Grantor	Date	Price	Code																																																																																																																					
2474/248	COOPER, JAMES C TRUST	05/20/2015	0	4																																																																																																																					
2474/243	COOPER, JAMES C	04/16/2015	0	4																																																																																																																					
Parcel Valuation																																																																																																																									
<table border="1"> <thead> <tr> <th>Source</th> <th>REAL</th> <th>Fair Cash</th> <th>Capped</th> <th>Asmnt Level</th> <th>Assessed</th> <th>Levy Rate</th> <th>92.430</th> <th>Current Tax</th> </tr> </thead> <tbody> <tr> <td>Remove Cap</td> <td>0</td> <td>Land Value 89,474</td> <td>17,682</td> <td>11%</td> <td>1,945</td> <td>Assessed</td> <td>15,572</td> <td>1,439.32</td> </tr> <tr> <td>Year Frozen</td> <td>2005</td> <td>Improvements 222,239</td> <td>123,879</td> <td> </td> <td>13,627</td> <td>Penalty</td> <td>0</td> <td> </td> </tr> <tr> <td>Uncapped Value</td> <td>0</td> <td>Mobile Home 0</td> <td>0</td> <td> </td> <td>0</td> <td>Exemption</td> <td>1,000</td> <td>-92.00</td> </tr> <tr> <td>TIF Project ID</td> <td>0</td> <td>Total Value 311,713</td> <td>141,561</td> <td> </td> <td>15,572</td> <td>Total Taxable</td> <td>14,572</td> <td>1,347.00</td> </tr> </tbody> </table>		Source	REAL	Fair Cash	Capped	Asmnt Level	Assessed	Levy Rate	92.430	Current Tax	Remove Cap	0	Land Value 89,474	17,682	11%	1,945	Assessed	15,572	1,439.32	Year Frozen	2005	Improvements 222,239	123,879		13,627	Penalty	0		Uncapped Value	0	Mobile Home 0	0		0	Exemption	1,000	-92.00	TIF Project ID	0	Total Value 311,713	141,561		15,572	Total Taxable	14,572	1,347.00																																																																											
Source	REAL	Fair Cash	Capped	Asmnt Level	Assessed	Levy Rate	92.430	Current Tax																																																																																																																	
Remove Cap	0	Land Value 89,474	17,682	11%	1,945	Assessed	15,572	1,439.32																																																																																																																	
Year Frozen	2005	Improvements 222,239	123,879		13,627	Penalty	0																																																																																																																		
Uncapped Value	0	Mobile Home 0	0		0	Exemption	1,000	-92.00																																																																																																																	
TIF Project ID	0	Total Value 311,713	141,561		15,572	Total Taxable	14,572	1,347.00																																																																																																																	
Assessment History																																																																																																																									
<table border="1"> <thead> <tr> <th>Tax Year</th> <th>Statement Number</th> <th>Billed Owner</th> <th>Tax Area</th> <th>Total Value</th> <th>Exemptions</th> <th>Taxable Value</th> <th>Billed Tax</th> </tr> </thead> <tbody> <tr><td>2025</td><td>2025-660004265</td><td>BROWN, STEPHANIE JO</td><td>17</td><td>305,197</td><td>1000</td><td>14,118</td><td>1,305.00</td></tr> <tr><td>2024</td><td>2024-660004265</td><td>BROWN, STEPHANIE JO</td><td>17</td><td>306,364</td><td>1000</td><td>13,678</td><td>1,264.00</td></tr> <tr><td>2023</td><td>2023-660004265</td><td>BROWN, STEPHANIE JO</td><td>17</td><td>232,100</td><td>1000</td><td>13,251</td><td>1,214.00</td></tr> <tr><td>2022</td><td>2022-660004265</td><td>BROWN, STEPHANIE JO</td><td>17</td><td>225,234</td><td>1000</td><td>12,836</td><td>1,188.00</td></tr> <tr><td>2021</td><td>2021-660004265</td><td>BROWN, STEPHANIE JO</td><td>17</td><td>230,996</td><td>1000</td><td>12,432</td><td>1,098.00</td></tr> <tr><td>2020</td><td>2020-660004265</td><td>BROWN, STEPHANIE JO</td><td>17</td><td>232,844</td><td>1000</td><td>12,041</td><td>1,103.00</td></tr> <tr><td>2019</td><td>2019-660004265</td><td>BROWN, STEPHANIE JO</td><td>17</td><td>220,832</td><td>1000</td><td>11,662</td><td>1,080.00</td></tr> <tr><td>2018</td><td>2018-660004265</td><td>BROWN, STEPHANIE JO</td><td>17</td><td>234,074</td><td>1000</td><td>11,293</td><td>1,043.00</td></tr> <tr><td>2017</td><td>2017-660004265</td><td>BROWN, STEPHANIE JO</td><td>17</td><td>231,817</td><td>1000</td><td>10,935</td><td>1,004.00</td></tr> <tr><td>2016</td><td>2016-660004265</td><td>BROWN, STEPHANIE JO</td><td>17</td><td>225,939</td><td>1000</td><td>10,587</td><td>994.00</td></tr> <tr><td>2015</td><td>2015-660004265</td><td>BROWN, STEPHANIE JO</td><td>17</td><td>222,500</td><td>0</td><td>11,250</td><td>1,015.00</td></tr> <tr><td>2014</td><td>2014-660004265</td><td>COOPER, JAMES C</td><td>17</td><td>227,419</td><td>1000</td><td>10,250</td><td>950.00</td></tr> <tr><td>2013</td><td>2013-660004265</td><td>COOPER, JAMES C</td><td>17</td><td>218,131</td><td>1000</td><td>10,249</td><td>938.00</td></tr> </tbody> </table>										Tax Year	Statement Number	Billed Owner	Tax Area	Total Value	Exemptions	Taxable Value	Billed Tax	2025	2025-660004265	BROWN, STEPHANIE JO	17	305,197	1000	14,118	1,305.00	2024	2024-660004265	BROWN, STEPHANIE JO	17	306,364	1000	13,678	1,264.00	2023	2023-660004265	BROWN, STEPHANIE JO	17	232,100	1000	13,251	1,214.00	2022	2022-660004265	BROWN, STEPHANIE JO	17	225,234	1000	12,836	1,188.00	2021	2021-660004265	BROWN, STEPHANIE JO	17	230,996	1000	12,432	1,098.00	2020	2020-660004265	BROWN, STEPHANIE JO	17	232,844	1000	12,041	1,103.00	2019	2019-660004265	BROWN, STEPHANIE JO	17	220,832	1000	11,662	1,080.00	2018	2018-660004265	BROWN, STEPHANIE JO	17	234,074	1000	11,293	1,043.00	2017	2017-660004265	BROWN, STEPHANIE JO	17	231,817	1000	10,935	1,004.00	2016	2016-660004265	BROWN, STEPHANIE JO	17	225,939	1000	10,587	994.00	2015	2015-660004265	BROWN, STEPHANIE JO	17	222,500	0	11,250	1,015.00	2014	2014-660004265	COOPER, JAMES C	17	227,419	1000	10,250	950.00	2013	2013-660004265	COOPER, JAMES C	17	218,131	1000	10,249	938.00
Tax Year	Statement Number	Billed Owner	Tax Area	Total Value	Exemptions	Taxable Value	Billed Tax																																																																																																																		
2025	2025-660004265	BROWN, STEPHANIE JO	17	305,197	1000	14,118	1,305.00																																																																																																																		
2024	2024-660004265	BROWN, STEPHANIE JO	17	306,364	1000	13,678	1,264.00																																																																																																																		
2023	2023-660004265	BROWN, STEPHANIE JO	17	232,100	1000	13,251	1,214.00																																																																																																																		
2022	2022-660004265	BROWN, STEPHANIE JO	17	225,234	1000	12,836	1,188.00																																																																																																																		
2021	2021-660004265	BROWN, STEPHANIE JO	17	230,996	1000	12,432	1,098.00																																																																																																																		
2020	2020-660004265	BROWN, STEPHANIE JO	17	232,844	1000	12,041	1,103.00																																																																																																																		
2019	2019-660004265	BROWN, STEPHANIE JO	17	220,832	1000	11,662	1,080.00																																																																																																																		
2018	2018-660004265	BROWN, STEPHANIE JO	17	234,074	1000	11,293	1,043.00																																																																																																																		
2017	2017-660004265	BROWN, STEPHANIE JO	17	231,817	1000	10,935	1,004.00																																																																																																																		
2016	2016-660004265	BROWN, STEPHANIE JO	17	225,939	1000	10,587	994.00																																																																																																																		
2015	2015-660004265	BROWN, STEPHANIE JO	17	222,500	0	11,250	1,015.00																																																																																																																		
2014	2014-660004265	COOPER, JAMES C	17	227,419	1000	10,250	950.00																																																																																																																		
2013	2013-660004265	COOPER, JAMES C	17	218,131	1000	10,249	938.00																																																																																																																		



Rogers

Assessment Property Record Card for Tax Year 2026

Data provided by LISA DELOZIER County Assessor

Date 04/17/2026
Time 03:28:40
Page 2

Lot Data		Square-Foot - NBHD 1183 #1		Primary Image				
Lot Size								
Lot Count	1							
Units Buildable	10500							
Non-Ag Acres	0.5779							
Topography								
Street Access								
Utilities								
Amenities	LOT SIZE ADJUSTMENT	0						
		0						
Method	Square-Foot							
Base Lot Value	25,173.00 x 3.55 = 89,474			\\tsclient\T\TOMMY DUNLAP\New folder (169)\IMG_0079.JPG 4/13/2023				
Factor Value				GRM Approach				
Adjustments	1.0000			GRM Code				
Lot Value	89,474			Gross Rent 0.00				
Residential Data				Indicated Value				
Type	1 Single Family Residence			Multiple Regression				
Condition	3 - Average			MRA Code 1 Test				
Quality	4 - Good			Adusted R 0.8445				
Architecture	R3 Res Nbhd 3			Indicated Value 363,483 121.57 Per SqFt				
Style	100% 1 1/2 Story Finished			Direct Comparables				
Exterior Wall	100% Veneer, Masonry			Selection Model A Adam Test				
Base/Total Area	1,798 / 2,990			Adjustment Model 1 2022 Residential				
Style	100% 1 1/2 Story Finished			Comparables				
HVAC	100% Warmed & Cooled Air			Indicated Value 7,550 Per SqFt				
Roof Cover	1 Composition Shingle			Value Reconciliation				
Area on Slab	1,798			Selected Approach Cost Approach				
Fixture/RghIn	10 /			Improvements 209,453				
Bed/F/H Bath	3 / 2.5 /			Lot Value 89,474				
Basement Area				Indicated Value 298,927 99.98 Per SqFt				
Garage Type	480 Attached Garage - Unfinished 2 Stalls			Agland Value				
Remodel				Site Improvements 12,786				
Year/Eff Age	1966 / 45			Total Value 311,713 104.25 Total Value Per SqFt				
Cost Approach		Manual : 01/2025						
Base Cost	101.91	Total Misc Impr	+ 21,022					
Roofing Adj	+ 3.73	Garage Cost	+ 23,506					
Subfloor Adj	+ -2.85	Total RCN	= 418,906					
Heat/Cool Adj	+ 16.31	Depreciation (50%)	- 209,453					
Plumbing Adj	+ 6.11	Lump Sums	+ 0					
Basement Adj	+ 0.00	RCNLD	= 209,453					
Adj Base Cost	= 125.21	Lot Value	+ 89,474					
Total Area	x 2,990	Indicated Value	= 298,927					
Adjusted Cost	= 374,378	Value Per SqFt	99.98					
Miscellaneous Improvements								
Code	Description	Sketch ID	Size	Year	Units	Unit Cost	Depr	Value
FPR1	FIREPLACE - RESIDENTIAL 1 STORY	0		1	1	7,243.87		7,244
PRCH	SLAB PORCH - COVERED	10877	35x4		140	32.63		4,568
PRCH	SLAB PORCH - COVERED	10878	24x12		288	31.98		9,210



Rogers

Assessment Property Record Card for Tax Year 2026

Data provided by LISA DELOZIER County Assessor

Date 04/17/2026

Time 03:28:40

Page 3

Sketch Image

660004265

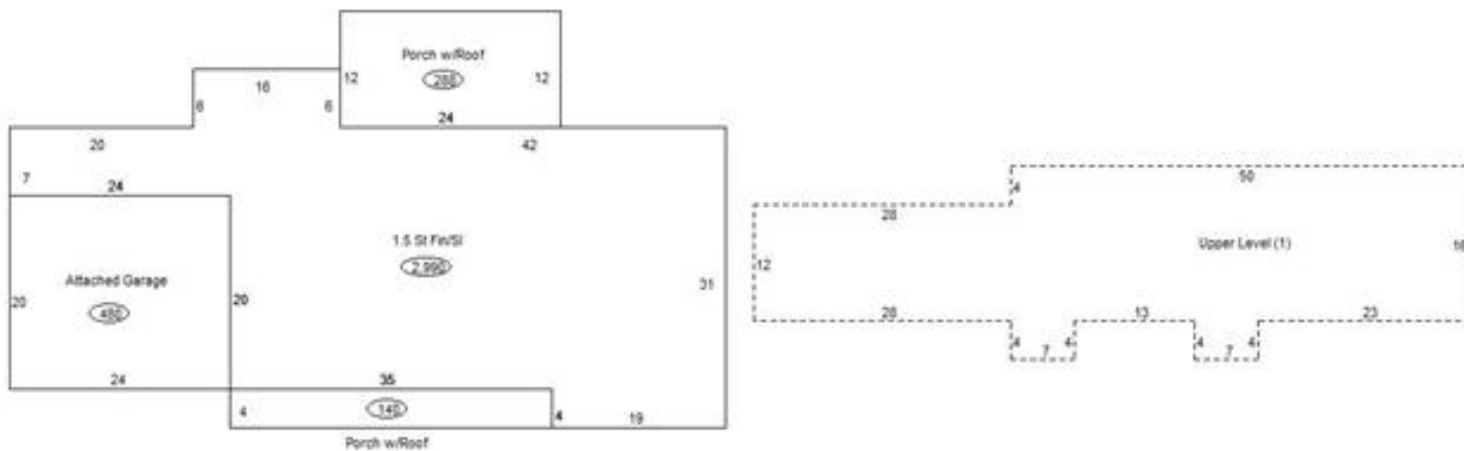

Sketch Vector Information

Sequence	Code	Type	Built Over	Scale	Section Label	Base Area	Multiplier	Total Area
1	R	5	Slab	13	1.5 St Fin/SI	1,798	1.663	2,990
2	G	1		13	Attached Garage	480	1.000	480
3	M	PRCH		13	SLBC	140	1.000	140
4	M	PRCH		13	SLBC	288	1.000	288
5	U	^UL		13	Upper Level (1)	1,192	1.000	1,192
Total Building Area						1,798		2,990



Rogers

Assessment Property Record Card for Tax Year 2026

Data provided by LISA DELOZIER County Assessor

Date 04/17/2026
Time 03:28:40
Page 4

660004265

Outbuildings/Site Improvements

Building Image	Code	Description	Dimensions	Floor	Roofing	Total Units	
	STF	STG FAIR	0x0x0			240	
	Qual	2	Cond 3	Year	Eff Age		
	Valuation Summary		Modifier Total	RCN	Depr (30% Phys/ % Func)	RCNLD	
	Base Cost (4.68 x 240)		1,123		1,123	337	786
	SG	SWIM-GUNITE				1	
	Qual	3	Cond 3	Year	Eff Age		
	Valuation Summary		Modifier Total	RCN	Depr (60% Phys/ % Func)	RCNLD	
	Base Cost (30,000.00 x 1)		30,000		30,000	18,000	12,000
	CP	Carport Dirt	0x0x0				
	Qual		Cond	Year	Eff Age		
	Valuation Summary		Modifier Total	RCN	Depr (100% Phys/ % Func)	RCNLD	
	Base Cost (3.50 x)						
	LT	LEAN-TO	0x0x0				
	Qual		Cond	Year	Eff Age		
	Valuation Summary		Modifier Total	RCN	Depr (100% Phys/ % Func)	RCNLD	
	Base Cost (2.92 x)						