



# Rogers

## Assessment Property Record Card for Tax Year 2026

Data provided by LISA DELOZIER County Assessor

Date 04/17/2026  
Time 02:57:48  
Page 1

Assessment Data					Primary Image																																																	
<b>Account</b> 660004275 <b>Parcel ID</b> 000000-00-0-10520-001-0008 <b>Cadastral ID</b> 05-21-16-08260 <b>Property Type</b> REAL - Real Property <b>Property Class</b> URP VI Area 1 <b>Tax Area</b> 17 - CLAREMORE OT <b>Name ID</b> 280322 HARJO, HOWARD R  1520 VALLEY VIEW DR CLAREMORE OK 74017-0000  <b>Parcel Location</b> <b>Situs</b> 01520 VALLEY VIEW DR <b>Subdivision</b> WILL ROGERS HGTS III <b>Lot/Block</b> 0008 / 0001 <b>Parcel Size</b> 1 - Lots <b>Sec/Twn/Rng</b> 5 / 21 / 16 / 5 <b>Neighborhood</b> 1183 - R-V01-SW CLAREMORE <b>School District</b> S001 - CLAREMORE SCHOOLS					<p>\\tsclient\T\TOMMY DUNLAP\New folder (172)\IMG_0015.JPG 4/14/2023</p>																																																	
<b>Legal Description</b> Lat/Long: 36.32790559 -95.63001424																																																						
LOT 8 BLOCK 1 WILL ROGERS HGTS III					<b>Building Permits</b> <table border="1"> <thead> <tr> <th>Number</th> <th>Description</th> <th>Opened</th> <th>Closed</th> <th>Amount</th> </tr> </thead> <tbody> <tr> <td> </td> <td> </td> <td> </td> <td> </td> <td> </td> </tr> </tbody> </table>					Number	Description	Opened	Closed	Amount																																								
Number	Description	Opened	Closed	Amount																																																		
<b>Exemptions</b>					<b>Sale History</b>																																																	
<b>Code</b>	<b>Type</b>	<b>Active</b>	<b>Maximum</b>	<b>Exemption</b>	<b>Bk/Pg</b>	<b>Grantor</b>	<b>Date</b>	<b>Price</b>	<b>Code</b>																																													
					1392/830	BIRD, STACIA L	07/22/2002	110,000	YES																																													
					1372/898	DAVIDSON, JACK D-TRUSTEE	04/24/2002	0	4																																													
<b>Parcel Valuation</b>					<table border="1"> <thead> <tr> <th>Source</th> <th>REAL</th> <th>Fair Cash</th> <th>Capped</th> <th>Asmnt Level</th> <th>Assessed</th> <th>Levy Rate</th> <th>92.430</th> <th>Current Tax</th> </tr> </thead> <tbody> <tr> <td>Remove Cap</td> <td>2003</td> <td>Land Value 58,929</td> <td>32,372</td> <td>11%</td> <td>3,561</td> <td>Assessed</td> <td>16,555</td> <td>1,530.18</td> </tr> <tr> <td>Year Frozen</td> <td>0</td> <td>Improvements 121,053</td> <td>118,125</td> <td> </td> <td>12,994</td> <td>Penalty</td> <td>0</td> <td> </td> </tr> <tr> <td>Uncapped Value</td> <td>0</td> <td>Mobile Home 0</td> <td>0</td> <td> </td> <td>0</td> <td>Exemption</td> <td>0</td> <td>0.00</td> </tr> <tr> <td>TIF Project ID</td> <td>0</td> <td>Total Value 179,982</td> <td>150,497</td> <td> </td> <td>16,555</td> <td>Total Taxable</td> <td>16,555</td> <td>1,530.00</td> </tr> </tbody> </table>					Source	REAL	Fair Cash	Capped	Asmnt Level	Assessed	Levy Rate	92.430	Current Tax	Remove Cap	2003	Land Value 58,929	32,372	11%	3,561	Assessed	16,555	1,530.18	Year Frozen	0	Improvements 121,053	118,125		12,994	Penalty	0		Uncapped Value	0	Mobile Home 0	0		0	Exemption	0	0.00	TIF Project ID	0	Total Value 179,982	150,497		16,555	Total Taxable	16,555	1,530.00
Source	REAL	Fair Cash	Capped	Asmnt Level	Assessed	Levy Rate	92.430	Current Tax																																														
Remove Cap	2003	Land Value 58,929	32,372	11%	3,561	Assessed	16,555	1,530.18																																														
Year Frozen	0	Improvements 121,053	118,125		12,994	Penalty	0																																															
Uncapped Value	0	Mobile Home 0	0		0	Exemption	0	0.00																																														
TIF Project ID	0	Total Value 179,982	150,497		16,555	Total Taxable	16,555	1,530.00																																														
<b>Assessment History</b>																																																						
Tax Year	Statement Number	Billed Owner	Tax Area	Total Value	Exemptions	Taxable Value	Billed Tax																																															
2025	2025-660004275	HARJO, HOWARD R	17	176,018	0	15,766	1,457.00																																															
2024	2024-660004275	HARJO, HOWARD R	17	185,654	0	15,016	1,388.00																																															
2023	2023-660004275	HARJO, HOWARD R	17	137,241	0	14,300	1,310.00																																															
2022	2022-660004275	HARJO, HOWARD R	17	123,816	0	13,620	1,261.00																																															
2021	2021-660004275	HARJO, HOWARD R	17	132,025	0	14,523	1,282.00																																															
2020	2020-660004275	HARJO, HOWARD R	17	129,909	0	14,207	1,301.00																																															
2019	2019-660004275	HARJO, HOWARD R	17	123,008	0	13,531	1,253.00																																															
2018	2018-660004275	HARJO, HOWARD R	17	128,394	0	14,123	1,305.00																																															
2017	2017-660004275	HARJO, HOWARD R	17	127,310	0	14,004	1,286.00																																															
2016	2016-660004275	HARJO, HOWARD R	17	124,076	0	13,648	1,281.00																																															
2015	2015-660004275	HARJO, HOWARD R	17	122,926	0	13,522	1,220.00																																															
2014	2014-660004275	HARJO, HOWARD R	17	123,952	0	13,512	1,253.00																																															
2013	2013-660004275	HARJO, HOWARD R	17	116,988	0	12,869	1,178.00																																															



# Rogers

## Assessment Property Record Card for Tax Year 2026

Data provided by LISA DELOZIER County Assessor

Date 04/17/2026  
 Time 02:57:48  
 Page 2

Lot Data		Square-Foot - NBHD 1183 #1	
Lot Size			
Lot Count	1		
Units Buildable	13358		
Non-Ag Acres	0.3229		
Topography			
Street Access			
Utilities			
Amenities	LOT SIZE ADJUSTMENT	0	0
Method	Square-Foot		
Base Lot Value	14,066.00 x 4.19 = 58,929		
Factor Value			
Adjustments	1.0000		
Lot Value	58,929		



\\tsclient\T\TOMMY DUNLAP\New folder (172)\IMG\_0015.JPG 4/14/2023

Residential Data	
Type	1 Single Family Residence
Condition	3 - Average
Quality	2.5 - Fair
Architecture	R3 Res Nbhd 3
Style	100% One Story
Exterior Wall	100% Veneer, Masonry
Base/Total Area	1,628 / 1,628
Style	100% One Story
HVAC	100% Warmed & Cooled Air
Roof Cover	1 Composition Shingle
Area on Slab	1,628
Fixture/RghIn	8 /
Bed/F/H Bath	3 / 2.0 /
Basement Area	
Garage Type	567 Attached Garage - Unfinished 2 Stalls
Remodel	
Year/Eff Age	1975 / 38

GRM Approach	
GRM Code	
Gross Rent	0.00
Indicated Value	

Multiple Regression			
MRA Code	1	Test	
Adusted R	0.8445		
Indicated Value	172,649	106.05	Per SqFt

Direct Comparables	
Selection Model	A Adam Test
Adjustment Model	1 2022 Residential
Comparables	6
Indicated Value	185,680 Per SqFt

Cost Approach		Manual : 01/2025	
Base Cost	102.65	Total Misc Impr	+ 11,836
Roofing Adj	+ 4.35	Garage Cost	+ 15,133
Subfloor Adj	+ -1.15	Total RCN	= 228,401
Heat/Cool Adj	+ 11.47	Depreciation ( 47%)	- 107,348
Plumbing Adj	+ 6.41	Lump Sums	+ 0
Basement Adj	+ 0.00	RCNLD	= 121,053
Adj Base Cost	= 123.73	Lot Value	+ 58,929
Total Area	x 1,628	Indicated Value	= 179,982
Adjusted Cost	= 201,432	Value Per SqFt	110.55

Value Reconciliation			
Selected Approach	Cost Approach		
Improvements	121,053		
Lot Value	58,929		
Indicated Value	179,982	110.55	Per SqFt
Agland Value			
Site Improvements			
Total Value	179,982	110.55	Total Value Per SqFt

Miscellaneous Improvements								
Code	Description	Sketch ID	Size	Year	Units	Unit Cost	Depr	Value
FPR1	FIREPLACE - RESIDENTIAL 1 STORY	0		1	1	5,095.98		5,096
PRCH	SLAB PORCH - COVERED	10929	12x6		72	24.04		1,731
EPKS	ENCLOSED PORCH - KNEEWALL SCREEN	10930	16x12		192	26.09		5,009



# Rogers

## Assessment Property Record Card for Tax Year 2026

Data provided by LISA DELOZIER County Assessor

Date 04/17/2026

Time 02:57:48

Page 3

### Sketch Image

660004275

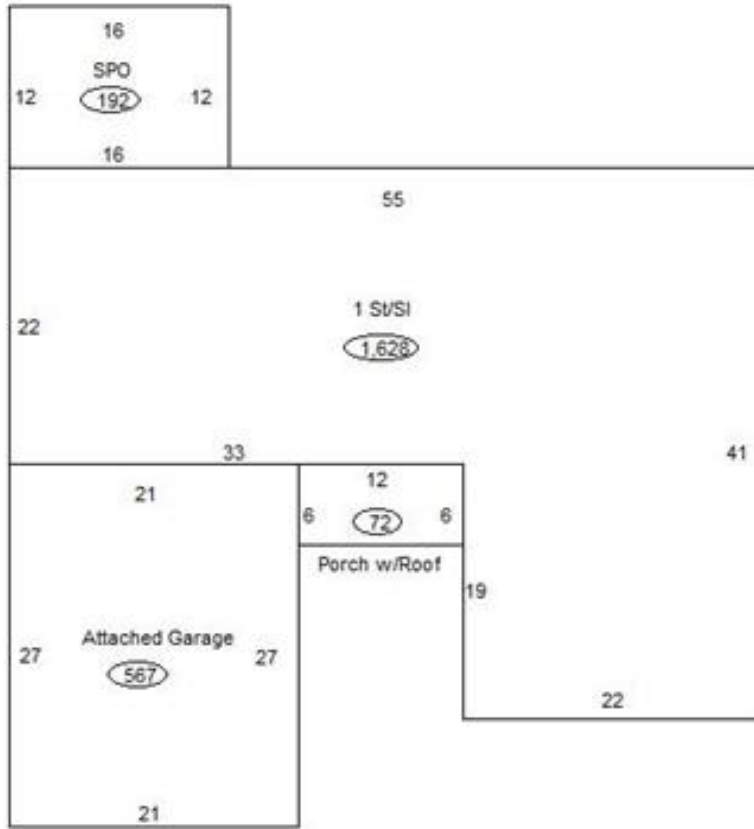

### Sketch Vector Information

Sequence	Code	Type	Built Over	Scale	Section Label	Base Area	Multiplier	Total Area
1	R	1	Slab	13	1 St/Sl	1,628	1.000	1,628
2	G	1		13	Attached Garage	567	1.000	567
3	M	PRCH		13	SLBC	72	1.000	72
4	M	EPKS		13	Screen Porch	192	1.000	192
<b>Total Building Area</b>						1,628		1,628