



Rogers

Assessment Property Record Card for Tax Year 2026

Data provided by LISA DELOZIER County Assessor

Date 04/17/2026
Time 03:28:54
Page 1

Assessment Data					Primary Image																																																																																																																				
Account 660004330 Parcel ID 000000-00-0-10525-002-0006 Cadastral ID 05-21-16-08810 Property Type REAL - Real Property Property Class URP VI Area 1 Tax Area 17 - CLAREMORE OT Name ID 55224 KREBS, GAILA JEANNE & DIANE KREBS 1455 MAPLEWOOD DR CLAREMORE OK 74017-0000 Parcel Location Situs 01455 MAPLEWOOD DR Subdivision WILL ROGERS HGTS IV Lot/Block 0006 / 0002 Parcel Size 1 - Lots Sec/Twn/Rng 5 / 21 / 16 / 5 Neighborhood 1183 - R-V01-SW CLAREMORE School District S001 - CLAREMORE SCHOOLS																																																																																																																									
Legal Description Lat/Long: 36.32560312 -95.62658549																																																																																																																									
Building Permits					<table border="1"> <thead> <tr> <th>Number</th> <th>Description</th> <th>Opened</th> <th>Closed</th> <th>Amount</th> </tr> </thead> <tbody> <tr> <td colspan="5" style="height: 100px;"> </td> </tr> </tbody> </table>					Number	Description	Opened	Closed	Amount																																																																																																											
Number	Description	Opened	Closed	Amount																																																																																																																					
Exemptions					Sale History																																																																																																																				
<table border="1"> <thead> <tr> <th>Code</th> <th>Type</th> <th>Active</th> <th>Maximum</th> <th>Exemption</th> </tr> </thead> <tbody> <tr> <td>H</td> <td>Homestead</td> <td>Yes</td> <td>1,000</td> <td>1,000</td> </tr> </tbody> </table>					Code	Type	Active	Maximum	Exemption	H	Homestead	Yes	1,000	1,000	<table border="1"> <thead> <tr> <th>Bk/Pg</th> <th>Grantor</th> <th>Date</th> <th>Price</th> <th>Code</th> </tr> </thead> <tbody> <tr> <td>769/288</td> <td></td> <td></td> <td>65,000</td> <td>No</td> </tr> </tbody> </table>					Bk/Pg	Grantor	Date	Price	Code	769/288			65,000	No																																																																																												
Code	Type	Active	Maximum	Exemption																																																																																																																					
H	Homestead	Yes	1,000	1,000																																																																																																																					
Bk/Pg	Grantor	Date	Price	Code																																																																																																																					
769/288			65,000	No																																																																																																																					
Parcel Valuation																																																																																																																									
<table border="1"> <thead> <tr> <th>Source</th> <th>REAL</th> <th>Fair Cash</th> <th>Capped</th> <th>Asmnt Level</th> <th>Assessed</th> <th>Levy Rate</th> <th>92.430</th> <th>Current Tax</th> </tr> </thead> <tbody> <tr> <td>Remove Cap</td> <td>0</td> <td>Land Value 49,384</td> <td>28,447</td> <td>11%</td> <td>3,129</td> <td>Assessed</td> <td>15,363</td> <td>1,420.00</td> </tr> <tr> <td>Year Frozen</td> <td>0</td> <td>Improvements 121,278</td> <td>111,219</td> <td></td> <td>12,234</td> <td>Penalty</td> <td>0</td> <td></td> </tr> <tr> <td>Uncapped Value</td> <td>0</td> <td>Mobile Home 0</td> <td>0</td> <td></td> <td>0</td> <td>Exemption</td> <td>1,000</td> <td>-92.00</td> </tr> <tr> <td>TIF Project ID</td> <td>0</td> <td>Total Value 170,662</td> <td>139,666</td> <td></td> <td>15,363</td> <td>Total Taxable</td> <td>14,363</td> <td>1,328.00</td> </tr> </tbody> </table>										Source	REAL	Fair Cash	Capped	Asmnt Level	Assessed	Levy Rate	92.430	Current Tax	Remove Cap	0	Land Value 49,384	28,447	11%	3,129	Assessed	15,363	1,420.00	Year Frozen	0	Improvements 121,278	111,219		12,234	Penalty	0		Uncapped Value	0	Mobile Home 0	0		0	Exemption	1,000	-92.00	TIF Project ID	0	Total Value 170,662	139,666		15,363	Total Taxable	14,363	1,328.00																																																																			
Source	REAL	Fair Cash	Capped	Asmnt Level	Assessed	Levy Rate	92.430	Current Tax																																																																																																																	
Remove Cap	0	Land Value 49,384	28,447	11%	3,129	Assessed	15,363	1,420.00																																																																																																																	
Year Frozen	0	Improvements 121,278	111,219		12,234	Penalty	0																																																																																																																		
Uncapped Value	0	Mobile Home 0	0		0	Exemption	1,000	-92.00																																																																																																																	
TIF Project ID	0	Total Value 170,662	139,666		15,363	Total Taxable	14,363	1,328.00																																																																																																																	
Assessment History																																																																																																																									
<table border="1"> <thead> <tr> <th>Tax Year</th> <th>Statement Number</th> <th>Billed Owner</th> <th>Tax Area</th> <th>Total Value</th> <th>Exemptions</th> <th>Taxable Value</th> <th>Billed Tax</th> </tr> </thead> <tbody> <tr><td>2025</td><td>2025-660004330</td><td>KREBS, GAILA JEANNE &</td><td>17</td><td>166,718</td><td>1000</td><td>13,916</td><td>1,286.00</td></tr> <tr><td>2024</td><td>2024-660004330</td><td>KREBS, GAILA JEANNE</td><td>17</td><td>170,614</td><td>1000</td><td>13,482</td><td>1,246.00</td></tr> <tr><td>2023</td><td>2023-660004330</td><td>KREBS, GAILA JEANNE</td><td>17</td><td>135,579</td><td>1000</td><td>13,060</td><td>1,196.00</td></tr> <tr><td>2022</td><td>2022-660004330</td><td>KREBS, GAILA JEANNE</td><td>17</td><td>124,265</td><td>1000</td><td>12,650</td><td>1,171.00</td></tr> <tr><td>2021</td><td>2021-660004330</td><td>KREBS, GAILA JEANNE</td><td>17</td><td>130,701</td><td>1000</td><td>12,253</td><td>1,082.00</td></tr> <tr><td>2020</td><td>2020-660004330</td><td>KREBS, GAILA JEANNE</td><td>17</td><td>131,624</td><td>1000</td><td>11,867</td><td>1,087.00</td></tr> <tr><td>2019</td><td>2019-660004330</td><td>KREBS, GAILA JEANNE</td><td>17</td><td>121,460</td><td>1000</td><td>11,492</td><td>1,064.00</td></tr> <tr><td>2018</td><td>2018-660004330</td><td>KREBS, GAILA JEANNE</td><td>17</td><td>125,164</td><td>1000</td><td>11,128</td><td>1,028.00</td></tr> <tr><td>2017</td><td>2017-660004330</td><td>KREBS, GAILA JEANNE</td><td>17</td><td>124,136</td><td>1000</td><td>10,776</td><td>990.00</td></tr> <tr><td>2016</td><td>2016-660004330</td><td>KREBS, GAILA JEANNE</td><td>17</td><td>120,948</td><td>1000</td><td>10,433</td><td>979.00</td></tr> <tr><td>2015</td><td>2015-660004330</td><td>KREBS, GAILA JEANNE</td><td>17</td><td>120,112</td><td>1000</td><td>10,100</td><td>911.00</td></tr> <tr><td>2014</td><td>2014-660004330</td><td>KREBS, GAILA JEANNE</td><td>17</td><td>122,423</td><td>1000</td><td>9,776</td><td>907.00</td></tr> <tr><td>2013</td><td>2013-660004330</td><td>KREBS, GAILA JEANNE</td><td>17</td><td>116,888</td><td>1000</td><td>9,462</td><td>866.00</td></tr> </tbody> </table>										Tax Year	Statement Number	Billed Owner	Tax Area	Total Value	Exemptions	Taxable Value	Billed Tax	2025	2025-660004330	KREBS, GAILA JEANNE &	17	166,718	1000	13,916	1,286.00	2024	2024-660004330	KREBS, GAILA JEANNE	17	170,614	1000	13,482	1,246.00	2023	2023-660004330	KREBS, GAILA JEANNE	17	135,579	1000	13,060	1,196.00	2022	2022-660004330	KREBS, GAILA JEANNE	17	124,265	1000	12,650	1,171.00	2021	2021-660004330	KREBS, GAILA JEANNE	17	130,701	1000	12,253	1,082.00	2020	2020-660004330	KREBS, GAILA JEANNE	17	131,624	1000	11,867	1,087.00	2019	2019-660004330	KREBS, GAILA JEANNE	17	121,460	1000	11,492	1,064.00	2018	2018-660004330	KREBS, GAILA JEANNE	17	125,164	1000	11,128	1,028.00	2017	2017-660004330	KREBS, GAILA JEANNE	17	124,136	1000	10,776	990.00	2016	2016-660004330	KREBS, GAILA JEANNE	17	120,948	1000	10,433	979.00	2015	2015-660004330	KREBS, GAILA JEANNE	17	120,112	1000	10,100	911.00	2014	2014-660004330	KREBS, GAILA JEANNE	17	122,423	1000	9,776	907.00	2013	2013-660004330	KREBS, GAILA JEANNE	17	116,888	1000	9,462	866.00
Tax Year	Statement Number	Billed Owner	Tax Area	Total Value	Exemptions	Taxable Value	Billed Tax																																																																																																																		
2025	2025-660004330	KREBS, GAILA JEANNE &	17	166,718	1000	13,916	1,286.00																																																																																																																		
2024	2024-660004330	KREBS, GAILA JEANNE	17	170,614	1000	13,482	1,246.00																																																																																																																		
2023	2023-660004330	KREBS, GAILA JEANNE	17	135,579	1000	13,060	1,196.00																																																																																																																		
2022	2022-660004330	KREBS, GAILA JEANNE	17	124,265	1000	12,650	1,171.00																																																																																																																		
2021	2021-660004330	KREBS, GAILA JEANNE	17	130,701	1000	12,253	1,082.00																																																																																																																		
2020	2020-660004330	KREBS, GAILA JEANNE	17	131,624	1000	11,867	1,087.00																																																																																																																		
2019	2019-660004330	KREBS, GAILA JEANNE	17	121,460	1000	11,492	1,064.00																																																																																																																		
2018	2018-660004330	KREBS, GAILA JEANNE	17	125,164	1000	11,128	1,028.00																																																																																																																		
2017	2017-660004330	KREBS, GAILA JEANNE	17	124,136	1000	10,776	990.00																																																																																																																		
2016	2016-660004330	KREBS, GAILA JEANNE	17	120,948	1000	10,433	979.00																																																																																																																		
2015	2015-660004330	KREBS, GAILA JEANNE	17	120,112	1000	10,100	911.00																																																																																																																		
2014	2014-660004330	KREBS, GAILA JEANNE	17	122,423	1000	9,776	907.00																																																																																																																		
2013	2013-660004330	KREBS, GAILA JEANNE	17	116,888	1000	9,462	866.00																																																																																																																		



Rogers

Assessment Property Record Card for Tax Year 2026

Data provided by LISA DELOZIER County Assessor

Date 04/17/2026
Time 03:28:55
Page 2

Lot Data	Square-Foot - NBHD 1183 #1	Primary Image
Lot Size Lot Count 1 Units Buildable 10500 Non-Ag Acres 0.2432 Topography Street Access Utilities Amenities LOT SIZE ADJUSTMENT 0 0 Method Square-Foot Base Lot Value 10,595.00 x 4.66 = 49,384 Factor Value Adjustments 1.0000 Lot Value 49,384		 <p>\\tsclient\T\TOMMY DUNLAP\New folder (175)\IMG_0029.JPG 4/19/2023</p>

Residential Data	
Type	1 Single Family Residence
Condition	3 - Average
Quality	2.5 - Fair
Architecture	R3 Res Nbhd 3
Style	100% One Story
Exterior Wall	75% Veneer, Masonry 25% Frame, Siding, Wood
Base/Total Area	1,586 / 1,586
Style	100% One Story
HVAC	100% Warmed & Cooled Air
Roof Cover	1 Composition Shingle
Area on Slab	1,586
Fixture/RghIn	11 /
Bed/F/H Bath	3 / 2.0 /
Basement Area	
Garage Type	483 Attached Garage - Unfinished 2 Stalls
Remodel	
Year/Eff Age	1978 / 36

GRM Approach

GRM Code	
Gross Rent	0.00
Indicated Value	

Multiple Regression

MRA Code	1 Test
Adusted R	0.8445
Indicated Value	165,312 104.23 Per SqFt

Direct Comparables

Selection Model	A Adam Test
Adjustment Model	1 2022 Residential
Comparables	6
Indicated Value	183,170 Per SqFt

Value Reconciliation

Selected Approach	Cost Approach
Improvements	121,278
Lot Value	49,384
Indicated Value	170,662 107.61 Per SqFt
Agland Value	
Site Improvements	
Total Value	170,662 107.61 Total Value Per SqFt

Cost Approach Manual : 01/2025

Base Cost	101.06	Total Misc Impr	+ 9,497
Roofing Adj	+ 4.37	Garage Cost	+ 13,345
Subfloor Adj	+ -1.15	Total RCN	= 220,505
Heat/Cool Adj	+ 11.47	Depreciation (45%)	- 99,227
Plumbing Adj	+ 8.88	Lump Sums	+ 0
Basement Adj	+ 0.00	RCNLD	= 121,278
Adj Base Cost	= 124.63	Lot Value	+ 49,384
Total Area	x 1,586	Indicated Value	= 170,662
Adjusted Cost	= 197,663	Value Per SqFt	107.61

Miscellaneous Improvements

Code	Description	Sketch ID	Size	Year	Units	Unit Cost	Depr	Value
FPR1	FIREPLACE - RESIDENTIAL 1 STORY	0		1	1	5,095.98		5,096
PRCH	SLAB PORCH - COVERED	11149	18x8		144	23.78		3,424
PATO	SLAB PORCH - OPEN	11150	18x5		90	10.86		977
SHLT	UG			1 2024	1	0.00		



Rogers

Assessment Property Record Card for Tax Year 2026

Data provided by LISA DELOZIER County Assessor

Date 04/17/2026
 Time 03:28:55
 Page 3

Sketch Image

660004330

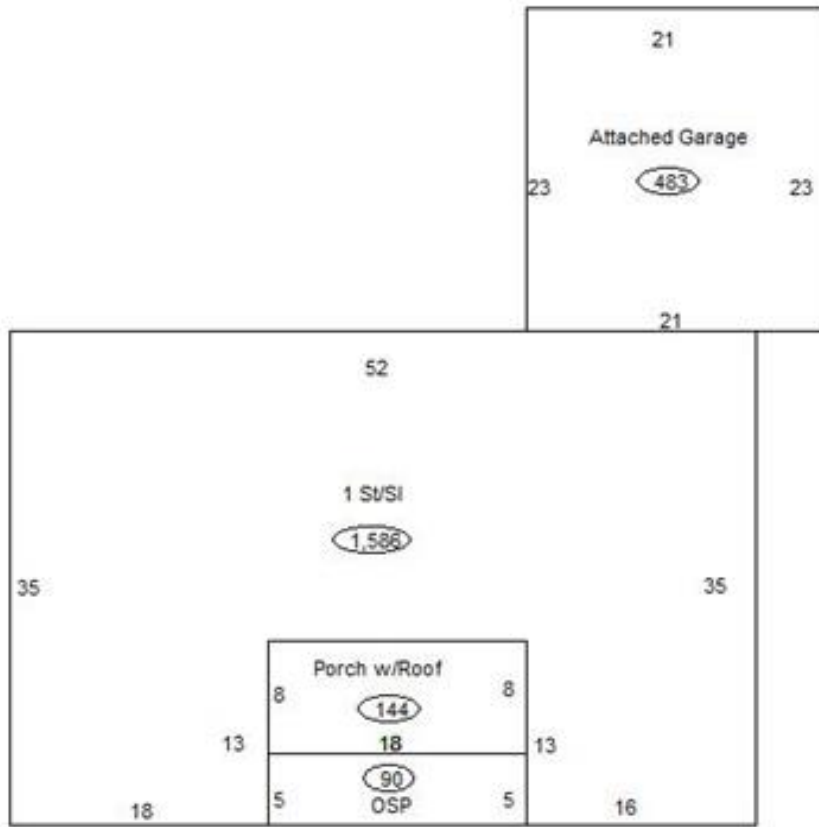

Sketch Vector Information

Sequence	Code	Type	Built Over	Scale	Section Label	Base Area	Multiplier	Total Area
1	R	1	Slab	13	1 St/Sl	1,586	1.000	1,586
2	G	1		13	Attached Garage	483	1.000	483
3	M	PRCH		13	SLBC	144	1.000	144
4	M	PATO		13	Open Slab	90	1.000	90
Total Building Area						1,586		1,586