



Rogers

Assessment Property Record Card for Tax Year 2026

Data provided by LISA DELOZIER County Assessor

Date 04/17/2026
Time 15:17:23
Page 1

Assessment Data					Primary Image														
Account 660004341 Parcel ID 000000-00-0-10525-002-0017 Cadastral ID 05-21-16-08920 Property Type REAL - Real Property Property Class URP VI Area 1 Tax Area 17 - CLAREMORE OT Name ID 329333 ABRAHAM, MONICA DIANE 1466 PARADISE PKWY CLAREMORE OK 74017-0000 Parcel Location Situs 01466 PARADISE PKWY Subdivision WILL ROGERS HGTS IV Lot/Block 0017 / 0002 Parcel Size 1 - Lots Sec/Twn/Rng 5 / 21 / 16 / 5 Neighborhood 1183 - R-V01-SW CLAREMORE School District S001 - CLAREMORE SCHOOLS					<p>\\tsclient\T\TOMMY DUNLAP\New folder (175)\IMG_0060.JPG 4/18/2023</p>														
Legal Description Lot/Long: 36.32489317 -95.62806680																			
LOT 17 BLOCK 2 WILL ROGERS HGTS IV					Building Permits <table border="1"> <thead> <tr> <th>Number</th> <th>Description</th> <th>Opened</th> <th>Closed</th> <th>Amount</th> </tr> </thead> <tbody> <tr> <td colspan="5"> </td> </tr> </tbody> </table>					Number	Description	Opened	Closed	Amount					
Number	Description	Opened	Closed	Amount															
Exemptions					Sale History														
Code	Type	Active	Maximum	Exemption	Bk/Pg	Grantor	Date	Price	Code										
H	Homestead	No	1,000		/	HURD, WILLIAM H JR	11/08/2019	143,500	YES										
					832/491			56,500	No										
Parcel Valuation																			
Source	REAL		Fair Cash	Capped	Asmnt Level	Assessed	Levy Rate	92.430	Current Tax										
Remove Cap	2020		Land Value 49,739	49,739	11%	5,471	Assessed	19,919	1,841.11										
Year Frozen	0		Improvements 131,347	131,347		14,448	Penalty	0											
Uncapped Value	0		Mobile Home 0	0		0	Exemption	0	0.00										
TIF Project ID	0		Total Value 181,086	181,086		19,919	Total Taxable	19,919	1,841.00										
Assessment History																			
Tax Year	Statement Number	Billed Owner			Tax Area	Total Value	Exemptions	Taxable Value	Billed Tax										
2025	2025-660004341	ABRAHAM, MONICA DIANE			17	174,559	0	18,988	1,755.00										
2024	2024-660004341	ABRAHAM, MONICA DIANE			17	179,625	0	18,084	1,671.00										
2023	2023-660004341	ABRAHAM, MONICA DIANE			17	156,574	0	17,223	1,578.00										
2022	2022-660004341	ABRAHAM, MONICA DIANE			17	149,237	0	16,416	1,520.00										
2021	2021-660004341	ABRAHAM, MONICA DIANE			17	153,694	0	16,906	1,493.00										
2020	2020-660004341	ABRAHAM, MONICA DIANE			17	151,212	0	16,633	1,523.00										
2019	2019-660004341	HURD, WILLIAM H JR			17	127,035	1000	12,169	1,127.00										
2018	2018-660004341	HURD, WILLIAM H JR			17	132,644	1000	11,786	1,089.00										
2017	2017-660004341	HURD, WILLIAM H JR			17	131,517	1000	11,413	1,048.00										
2016	2016-660004341	HURD, WILLIAM H JR			17	128,138	1000	11,051	1,037.00										
2015	2015-660004341	HURD, WILLIAM H JR			17	125,673	1000	10,700	965.00										
2014	2014-660004341	HURD, WILLIAM H JR			17	126,742	1000	10,360	961.00										
2013	2013-660004341	HURD, WILLIAM H JR			17	120,672	1000	10,029	918.00										



Rogers

Assessment Property Record Card for Tax Year 2026

Data provided by LISA DELOZIER County Assessor

Date 04/17/2026
Time 15:17:23
Page 2

Lot Data		Square-Foot - NBHD 1183 #1	
Lot Size			
Lot Count	1		
Units Buildable	10500		
Non-Ag Acres	0.2462		
Topography			
Street Access			
Utilities			
Amenities	LOT SIZE ADJUSTMENT	0	0
Method	Square-Foot		
Base Lot Value	10,724.00 x 4.64 = 49,739		
Factor Value			
Adjustments	1.0000		
Lot Value	49,739		



\\tsclient\T\TOMMY DUNLAP\New folder (175)\IMG_0060.JPG 4/18/2023

Residential Data	
Type	1 Single Family Residence
Condition	3 - Average
Quality	2.5 - Fair
Architecture	
Style	100% One Story
Exterior Wall	80% Veneer, Masonry 20% Frame, Siding, Vinyl
Base/Total Area	1,698 / 1,698
Style	100% One Story
HVAC	100% Warmed & Cooled Air
Roof Cover	1 Composition Shingle
Area on Slab	1,698
Fixture/RghIn	11 /
Bed/F/H Bath	4 / 2.0 /
Basement Area	
Garage Type	528 Attached Garage - Unfinished 2 Stalls
Remodel	
Year/Eff Age	1979 / 35

GRM Approach	
GRM Code	
Gross Rent	0.00
Indicated Value	

Multiple Regression			
MRA Code	1	Test	
Adusted R	0.8445		
Indicated Value	177,138	104.32	Per SqFt

Direct Comparables	
Selection Model	A Adam Test
Adjustment Model	1 2022 Residential
Comparables	6
Indicated Value	194,050 Per SqFt

Value Reconciliation			
Selected Approach	Cost Approach		
Improvements	131,347		
Lot Value	49,739		
Indicated Value	181,086	106.65	Per SqFt
Agland Value			
Site Improvements			
Total Value	181,086	106.65	Total Value Per SqFt

Cost Approach				Manual : 01/2025			
Base Cost	102.42	Total Misc Impr	+	7,227			
Roofing Adj	+ 4.41	Garage Cost	+	14,325			
Subfloor Adj	+ -1.15	Total RCN	=	234,549			
Heat/Cool Adj	+ 11.47	Depreciation (44%)	-	103,202			
Plumbing Adj	+ 8.29	Lump Sums	+	0			
Basement Adj	+ 0.00	RCNLD	=	131,347			
Adj Base Cost	= 125.44	Lot Value	+	49,739			
Total Area	x 1,698	Indicated Value	=	181,086			
Adjusted Cost	= 212,997	Value Per SqFt		106.65			

Miscellaneous Improvements								
Code	Description	Sketch ID	Size	Year	Units	Unit Cost	Depr	Value
FPR1	FIREPLACE - RESIDENTIAL 1 STORY	0		1	1	5,095.98		5,096
PRCH	SLAB PORCH - COVERED	11194		32	32	24.17		773
PATO	SLAB PORCH - OPEN	11195	16x8		128	10.61		1,358



Rogers

Assessment Property Record Card for Tax Year 2026

Data provided by LISA DELOZIER County Assessor

Date 04/17/2026
 Time 15:17:23
 Page 3

Sketch Image

660004341

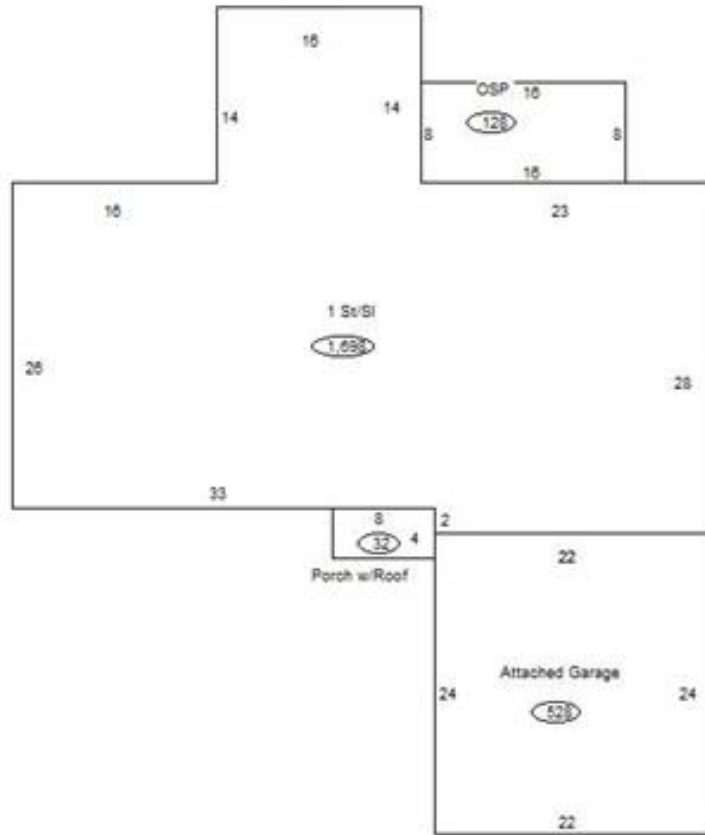

Sketch Vector Information

Sequence	Code	Type	Built Over	Scale	Section Label	Base Area	Multiplier	Total Area
1	R	1	Slab	13	1 St/Sl	1,698	1.000	1,698
2	G	1		13	Attached Garage	528	1.000	528
3	M	PRCH		13	SLBC	32	1.000	32
4	M	PATO		13	Open Slab	128	1.000	128
Total Building Area						1,698		1,698