



Rogers

Assessment Property Record Card for Tax Year 2026

Data provided by LISA DELOZIER County Assessor

Date 04/16/2026
Time 23:07:51
Page 1

Assessment Data					Primary Image																																																																																																																				
Account 660004440 Parcel ID 000000-00-0-00525-001-0002 Cadastral ID 05-21-17-01760 Property Type REAL - Real Property Property Class RRP VI Area 3 Tax Area 93 - JUSTUS/TRI-DISTRICT FIRE Name ID 329747 ATKINSON, CHRISTOPHER RAY 19998 COTTRELL DR CLAREMORE OK 74019-0000 Parcel Location Situs 19998 S COTTRELL DR Subdivision MOUNTAIN MEADOWS Lot/Block 0002 / 0001 Parcel Size .5 - Lots Sec/Twn/Rng 5 / 21 / 17 / 5 Neighborhood 1070 - R-V03-SE JUSTUS-SEQUOYAH School District S009 - JUSTUS-TIAWAH SCHOOLS					 <p>660004440 07/15/25</p> <p>660004440_001.JPG 8/11/2025</p>																																																																																																																				
Legal Description Lat/Long: 36.32305045 -95.52018102																																																																																																																									
S2 LOT 2 BLOCK 1 MOUNTAIN MEADOWS					Building Permits <table border="1"> <thead> <tr> <th>Number</th> <th>Description</th> <th>Opened</th> <th>Closed</th> <th>Amount</th> </tr> </thead> <tbody> <tr> <td colspan="5"> </td> </tr> </tbody> </table>					Number	Description	Opened	Closed	Amount																																																																																																											
Number	Description	Opened	Closed	Amount																																																																																																																					
Exemptions <table border="1"> <thead> <tr> <th>Code</th> <th>Type</th> <th>Active</th> <th>Maximum</th> <th>Exemption</th> </tr> </thead> <tbody> <tr> <td>H</td> <td>Homestead</td> <td>No</td> <td>1,000</td> <td></td> </tr> </tbody> </table>					Code	Type	Active	Maximum	Exemption	H	Homestead	No	1,000		Sale History <table border="1"> <thead> <tr> <th>Bk/Pg</th> <th>Grantor</th> <th>Date</th> <th>Price</th> <th>Code</th> </tr> </thead> <tbody> <tr> <td>/</td> <td>JOCHMANS, AARON M &</td> <td>12/20/2019</td> <td>162,500</td> <td>YES</td> </tr> <tr> <td>1204/811</td> <td>COLLINS, BRYCE &</td> <td>12/06/1999</td> <td>95,000</td> <td>No</td> </tr> <tr> <td>1002/678</td> <td>STIMSON, TERRANCE J &</td> <td>09/20/1995</td> <td>11,000</td> <td>No</td> </tr> <tr> <td>858/699</td> <td></td> <td></td> <td>30,000</td> <td>No</td> </tr> </tbody> </table>					Bk/Pg	Grantor	Date	Price	Code	/	JOCHMANS, AARON M &	12/20/2019	162,500	YES	1204/811	COLLINS, BRYCE &	12/06/1999	95,000	No	1002/678	STIMSON, TERRANCE J &	09/20/1995	11,000	No	858/699			30,000	No																																																																													
Code	Type	Active	Maximum	Exemption																																																																																																																					
H	Homestead	No	1,000																																																																																																																						
Bk/Pg	Grantor	Date	Price	Code																																																																																																																					
/	JOCHMANS, AARON M &	12/20/2019	162,500	YES																																																																																																																					
1204/811	COLLINS, BRYCE &	12/06/1999	95,000	No																																																																																																																					
1002/678	STIMSON, TERRANCE J &	09/20/1995	11,000	No																																																																																																																					
858/699			30,000	No																																																																																																																					
Parcel Valuation <table border="1"> <thead> <tr> <th>Source</th> <th>REAL</th> <th>Fair Cash</th> <th>Capped</th> <th>Asmnt Level</th> <th>Assessed</th> <th>Levy Rate</th> <th>93.050</th> <th>Current Tax</th> </tr> </thead> <tbody> <tr> <td>Remove Cap</td> <td>2020</td> <td>Land Value 73,201</td> <td>44,973</td> <td>11%</td> <td>4,947</td> <td>Assessed</td> <td>22,487</td> <td>2,092.42</td> </tr> <tr> <td>Year Frozen</td> <td>0</td> <td>Improvements 159,459</td> <td>159,459</td> <td></td> <td>17,540</td> <td>Penalty</td> <td>0</td> <td></td> </tr> <tr> <td>Uncapped Value</td> <td>0</td> <td>Mobile Home 0</td> <td>0</td> <td></td> <td>0</td> <td>Exemption</td> <td>0</td> <td>0.00</td> </tr> <tr> <td>TIF Project ID</td> <td>0</td> <td>Total Value 232,660</td> <td>204,432</td> <td></td> <td>22,487</td> <td>Total Taxable</td> <td>22,487</td> <td>2,092.00</td> </tr> </tbody> </table>										Source	REAL	Fair Cash	Capped	Asmnt Level	Assessed	Levy Rate	93.050	Current Tax	Remove Cap	2020	Land Value 73,201	44,973	11%	4,947	Assessed	22,487	2,092.42	Year Frozen	0	Improvements 159,459	159,459		17,540	Penalty	0		Uncapped Value	0	Mobile Home 0	0		0	Exemption	0	0.00	TIF Project ID	0	Total Value 232,660	204,432		22,487	Total Taxable	22,487	2,092.00																																																																			
Source	REAL	Fair Cash	Capped	Asmnt Level	Assessed	Levy Rate	93.050	Current Tax																																																																																																																	
Remove Cap	2020	Land Value 73,201	44,973	11%	4,947	Assessed	22,487	2,092.42																																																																																																																	
Year Frozen	0	Improvements 159,459	159,459		17,540	Penalty	0																																																																																																																		
Uncapped Value	0	Mobile Home 0	0		0	Exemption	0	0.00																																																																																																																	
TIF Project ID	0	Total Value 232,660	204,432		22,487	Total Taxable	22,487	2,092.00																																																																																																																	
Assessment History <table border="1"> <thead> <tr> <th>Tax Year</th> <th>Statement Number</th> <th>Billed Owner</th> <th>Tax Area</th> <th>Total Value</th> <th>Exemptions</th> <th>Taxable Value</th> <th>Billed Tax</th> </tr> </thead> <tbody> <tr><td>2025</td><td>2025-660004440</td><td>ATKINSON, CHRISTOPHER RAY</td><td>93</td><td>226,334</td><td>0</td><td>21,417</td><td>1,993.00</td></tr> <tr><td>2024</td><td>2024-660004440</td><td>ATKINSON, CHRISTOPHER RAY</td><td>93</td><td>243,716</td><td>0</td><td>20,397</td><td>2,028.00</td></tr> <tr><td>2023</td><td>2023-660004440</td><td>ATKINSON, CHRISTOPHER RAY</td><td>93</td><td>176,598</td><td>0</td><td>19,426</td><td>1,929.00</td></tr> <tr><td>2022</td><td>2022-660004440</td><td>ATKINSON, CHRISTOPHER RAY</td><td>93</td><td>176,729</td><td>0</td><td>19,132</td><td>1,897.00</td></tr> <tr><td>2021</td><td>2021-660004440</td><td>ATKINSON, CHRISTOPHER RAY</td><td>93</td><td>165,643</td><td>0</td><td>18,221</td><td>1,838.00</td></tr> <tr><td>2020</td><td>2020-660004440</td><td>ATKINSON, CHRISTOPHER RAY</td><td>93</td><td>163,232</td><td>0</td><td>17,956</td><td>1,753.00</td></tr> <tr><td>2019</td><td>2019-660004440</td><td>JOCHMANS, AARON M &</td><td>93</td><td>128,708</td><td>1000</td><td>9,590</td><td>968.00</td></tr> <tr><td>2018</td><td>2018-660004440</td><td>JOCHMANS, AARON M &</td><td>93</td><td>132,276</td><td>1000</td><td>9,282</td><td>939.00</td></tr> <tr><td>2017</td><td>2017-660004440</td><td>JOCHMANS, AARON M &</td><td>93</td><td>124,217</td><td>1000</td><td>8,236</td><td>792.00</td></tr> <tr><td>2016</td><td>2016-660004440</td><td>JOCHMANS, AARON M &</td><td>93</td><td>120,929</td><td>1000</td><td>7,967</td><td>797.00</td></tr> <tr><td>2015</td><td>2015-660004440</td><td>JOCHMANS, AARON M &</td><td>93</td><td>119,290</td><td>1000</td><td>7,706</td><td>764.00</td></tr> <tr><td>2014</td><td>2014-660004440</td><td>JOCHMANS, AARON M &</td><td>93</td><td>120,291</td><td>1000</td><td>7,453</td><td>725.00</td></tr> <tr><td>2013</td><td>2013-660004440</td><td>JOCHMANS, AARON M &</td><td>93</td><td>113,158</td><td>1000</td><td>7,207</td><td>710.00</td></tr> </tbody> </table>										Tax Year	Statement Number	Billed Owner	Tax Area	Total Value	Exemptions	Taxable Value	Billed Tax	2025	2025-660004440	ATKINSON, CHRISTOPHER RAY	93	226,334	0	21,417	1,993.00	2024	2024-660004440	ATKINSON, CHRISTOPHER RAY	93	243,716	0	20,397	2,028.00	2023	2023-660004440	ATKINSON, CHRISTOPHER RAY	93	176,598	0	19,426	1,929.00	2022	2022-660004440	ATKINSON, CHRISTOPHER RAY	93	176,729	0	19,132	1,897.00	2021	2021-660004440	ATKINSON, CHRISTOPHER RAY	93	165,643	0	18,221	1,838.00	2020	2020-660004440	ATKINSON, CHRISTOPHER RAY	93	163,232	0	17,956	1,753.00	2019	2019-660004440	JOCHMANS, AARON M &	93	128,708	1000	9,590	968.00	2018	2018-660004440	JOCHMANS, AARON M &	93	132,276	1000	9,282	939.00	2017	2017-660004440	JOCHMANS, AARON M &	93	124,217	1000	8,236	792.00	2016	2016-660004440	JOCHMANS, AARON M &	93	120,929	1000	7,967	797.00	2015	2015-660004440	JOCHMANS, AARON M &	93	119,290	1000	7,706	764.00	2014	2014-660004440	JOCHMANS, AARON M &	93	120,291	1000	7,453	725.00	2013	2013-660004440	JOCHMANS, AARON M &	93	113,158	1000	7,207	710.00
Tax Year	Statement Number	Billed Owner	Tax Area	Total Value	Exemptions	Taxable Value	Billed Tax																																																																																																																		
2025	2025-660004440	ATKINSON, CHRISTOPHER RAY	93	226,334	0	21,417	1,993.00																																																																																																																		
2024	2024-660004440	ATKINSON, CHRISTOPHER RAY	93	243,716	0	20,397	2,028.00																																																																																																																		
2023	2023-660004440	ATKINSON, CHRISTOPHER RAY	93	176,598	0	19,426	1,929.00																																																																																																																		
2022	2022-660004440	ATKINSON, CHRISTOPHER RAY	93	176,729	0	19,132	1,897.00																																																																																																																		
2021	2021-660004440	ATKINSON, CHRISTOPHER RAY	93	165,643	0	18,221	1,838.00																																																																																																																		
2020	2020-660004440	ATKINSON, CHRISTOPHER RAY	93	163,232	0	17,956	1,753.00																																																																																																																		
2019	2019-660004440	JOCHMANS, AARON M &	93	128,708	1000	9,590	968.00																																																																																																																		
2018	2018-660004440	JOCHMANS, AARON M &	93	132,276	1000	9,282	939.00																																																																																																																		
2017	2017-660004440	JOCHMANS, AARON M &	93	124,217	1000	8,236	792.00																																																																																																																		
2016	2016-660004440	JOCHMANS, AARON M &	93	120,929	1000	7,967	797.00																																																																																																																		
2015	2015-660004440	JOCHMANS, AARON M &	93	119,290	1000	7,706	764.00																																																																																																																		
2014	2014-660004440	JOCHMANS, AARON M &	93	120,291	1000	7,453	725.00																																																																																																																		
2013	2013-660004440	JOCHMANS, AARON M &	93	113,158	1000	7,207	710.00																																																																																																																		



Rogers

Assessment Property Record Card for Tax Year 2026

Data provided by LISA DELOZIER County Assessor

Date 04/16/2026
Time 23:07:51
Page 2

Lot Data		Square-Foot - NBHD 1070 #1		Primary Image	
Lot Size					
Lot Count					
Units Buildable	5500				
Non-Ag Acres	1.1609				
Topography					
Street Access					
Utilities					
Amenities	LAND QUALITY	0			
		0			
Method	Square-Foot				
Base Lot Value	50,570.00 x 1.45 = 73,201				
Factor Value					
Adjustments	1.0000				
Lot Value	73,201				
Residential Data				660004440_001.JPG 8/11/2025	
Type	1 Single Family Residence			GRM Approach	
Condition	3 - Average			GRM Code	
Quality	2.5 - Fair			Gross Rent 0.00	
Architecture				Indicated Value	
Style	100% One Story			Multiple Regression	
Exterior Wall	20% Veneer, Masonry 80% Frame, Siding, Wood			MRA Code 1 Test	
Base/Total Area	1,288 / 1,288			Adusted R 0.8445	
Style	100% One Story			Indicated Value 206,321 160.19 Per SqFt	
HVAC	100% Warmed & Cooled Air			Direct Comparables	
Roof Cover	4 Metal, Preformed			Selection Model A Adam Test	
Area on Slab	1,288			Adjustment Model 1 2022 Residential	
Fixture/RghIn	14 /			Comparables 3	
Bed/F/H Bath	3 / 2.0 /			Indicated Value 196,440 Per SqFt	
Basement Area				Value Reconciliation	
Garage Type	672 Attached Garage - Unfinished			Selected Approach Cost Approach	
Remodel				Improvements 136,931	
Year/Eff Age	1997 / 22			Lot Value 73,201	
Cost Approach		Manual : 01/2025		Indicated Value 210,132 163.15 Per SqFt	
Base Cost	96.50	Total Misc Impr	+ 4,529	Agland Value	
Roofing Adj	+ 5.15	Garage Cost	+ 17,418	Site Improvements 22,528	
Subfloor Adj	+ -1.15	Total RCN	= 183,887	Total Value 232,660 180.64 Total Value Per SqFt	
Heat/Cool Adj	+ 11.47	Depreciation (29%)	- 53,327		
Plumbing Adj	+ 13.76	Lump Sums	+ 6,371		
Basement Adj	+ 0.00	RCNLD	= 136,931		
Adj Base Cost	= 125.73	Lot Value	+ 73,201		
Total Area	x 1,288	Indicated Value	= 210,132		
Adjusted Cost	= 161,940	Value Per SqFt	163.15		

Miscellaneous Improvements							
Code	Description	Sketch ID	Size	Year	Units	Unit Cost	Depr Value
WODC	WOOD DECK - COVERED	11495	16x10		160	39.82	6,371
PRCH	SLAB PORCH - COVERED	11496	32x6		192	23.59	4,529



Rogers

Assessment Property Record Card for Tax Year 2026

Data provided by LISA DELOZIER County Assessor

Date 04/16/2026
 Time 23:07:51
 Page 3

Sketch Image

660004440

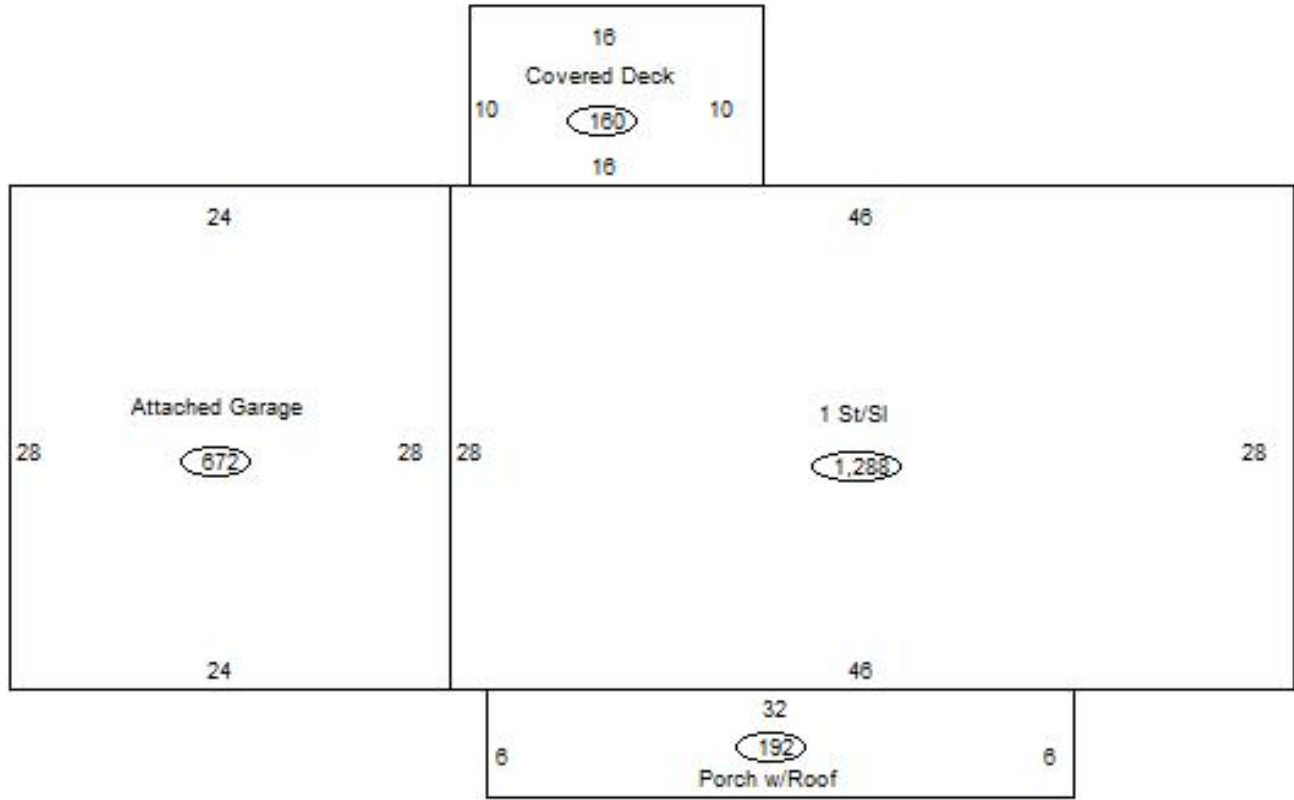

Sketch Vector Information

Sequence	Code	Type	Built Over	Scale	Section Label	Base Area	Multiplier	Total Area
1	R	1	Slab	13	1 St/Sl	1,288	1.000	1,288
2	G	1		13	Attached Garage	672	1.000	672
3	M	WODC		13	WODC	160	1.000	160
4	M	PRCH		13	SLBC	192	1.000	192
Total Building Area						1,288		1,288



Rogers

Assessment Property Record Card for Tax Year 2026

Data provided by LISA DELOZIER County Assessor

Date 04/16/2026
Time 23:07:52
Page 4

660004440

Outbuildings/Site Improvements

Building Image	Code	Description	Dimensions	Floor	Roofing	Total Units
	UTIL	SHOP BUILDING	24x36x0			864
	Qual 2	Cond 3	Year 2017	Eff Age 7		
Valuation Summary		Modifier Total		RCN	Depr (13% Phys/ % Func)	RCNLD
Base Cost (29.97 x 864)		25,894		25,894	3,366	22,528