



Rogers

Assessment Property Record Card for Tax Year 2026

Data provided by LISA DELOZIER County Assessor

Date 04/17/2026
Time 02:26:42
Page 1

Assessment Data					Primary Image																																																																																																																				
Account 660004443 Parcel ID 000000-00-0-00525-002-0003 Cadastral ID 05-21-17-01800 Property Type REAL - Real Property Property Class RRP VI Area 3 Tax Area 93 - JUSTUS/TRI-DISTRICT FIRE Name ID 296012 BUNNEY, JAMES D & JOHNETTA M 19975 MOUNTAIN LANE CLAREMORE OK 74019-0000																																																																																																																									
Parcel Location Situs 19975 MOUNTAIN LN Subdivision MOUNTAIN MEADOWS Lot/Block 0003 / 0002 Parcel Size 1 - Lots Sec/Twn/Rng 5 / 21 / 17 / 5 Neighborhood 1070 - R-V03-SE JUSTUS-SEQUOYAH School District S009 - JUSTUS-TIAWAH SCHOOLS																																																																																																																									
Legal Description Lat/Long: 36.32326475 -95.51678490					Building Permits <table border="1"> <thead> <tr> <th>Number</th> <th>Description</th> <th>Opened</th> <th>Closed</th> <th>Amount</th> </tr> </thead> <tbody> <tr> <td></td> <td></td> <td></td> <td></td> <td></td> </tr> </tbody> </table>					Number	Description	Opened	Closed	Amount																																																																																																											
Number	Description	Opened	Closed	Amount																																																																																																																					
Exemptions <table border="1"> <thead> <tr> <th>Code</th> <th>Type</th> <th>Active</th> <th>Maximum</th> <th>Exemption</th> </tr> </thead> <tbody> <tr> <td>H</td> <td>Homestead</td> <td>Yes</td> <td>1,000</td> <td>1,000</td> </tr> </tbody> </table>					Code	Type	Active	Maximum	Exemption	H	Homestead	Yes	1,000	1,000	Sale History <table border="1"> <thead> <tr> <th>Bk/Pg</th> <th>Grantor</th> <th>Date</th> <th>Price</th> <th>Code</th> </tr> </thead> <tbody> <tr> <td>1896/197</td> <td>GRIGGS, RONNIE J &</td> <td>08/30/2007</td> <td>126,500</td> <td>YES</td> </tr> <tr> <td>937/60</td> <td>STIMSON, TERRANCE J &</td> <td>11/22/1993</td> <td>9,000</td> <td>No</td> </tr> <tr> <td>873/837</td> <td></td> <td>02/13/1992</td> <td>17,500</td> <td>No</td> </tr> </tbody> </table>					Bk/Pg	Grantor	Date	Price	Code	1896/197	GRIGGS, RONNIE J &	08/30/2007	126,500	YES	937/60	STIMSON, TERRANCE J &	11/22/1993	9,000	No	873/837		02/13/1992	17,500	No																																																																																		
Code	Type	Active	Maximum	Exemption																																																																																																																					
H	Homestead	Yes	1,000	1,000																																																																																																																					
Bk/Pg	Grantor	Date	Price	Code																																																																																																																					
1896/197	GRIGGS, RONNIE J &	08/30/2007	126,500	YES																																																																																																																					
937/60	STIMSON, TERRANCE J &	11/22/1993	9,000	No																																																																																																																					
873/837		02/13/1992	17,500	No																																																																																																																					
Parcel Valuation <table border="1"> <thead> <tr> <th>Source</th> <th>REAL</th> <th>Fair Cash</th> <th>Capped</th> <th>Asmnt Level</th> <th>Assessed</th> <th>Levy Rate</th> <th>93.050</th> <th>Current Tax</th> </tr> </thead> <tbody> <tr> <td>Remove Cap</td> <td>2008</td> <td>Land Value 81,139</td> <td>61,287</td> <td>11%</td> <td>6,742</td> <td>Assessed</td> <td>16,861</td> <td>1,568.92</td> </tr> <tr> <td>Year Frozen</td> <td>2022</td> <td>Improvements 121,795</td> <td>91,995</td> <td></td> <td>10,119</td> <td>Penalty</td> <td>0</td> <td></td> </tr> <tr> <td>Uncapped Value</td> <td>0</td> <td>Mobile Home 0</td> <td>0</td> <td></td> <td>0</td> <td>Exemption</td> <td>1,000</td> <td>-83.00</td> </tr> <tr> <td>TIF Project ID</td> <td>0</td> <td>Total Value 202,934</td> <td>153,282</td> <td></td> <td>16,861</td> <td>Total Taxable</td> <td>15,861</td> <td>1,486.00</td> </tr> </tbody> </table>										Source	REAL	Fair Cash	Capped	Asmnt Level	Assessed	Levy Rate	93.050	Current Tax	Remove Cap	2008	Land Value 81,139	61,287	11%	6,742	Assessed	16,861	1,568.92	Year Frozen	2022	Improvements 121,795	91,995		10,119	Penalty	0		Uncapped Value	0	Mobile Home 0	0		0	Exemption	1,000	-83.00	TIF Project ID	0	Total Value 202,934	153,282		16,861	Total Taxable	15,861	1,486.00																																																																			
Source	REAL	Fair Cash	Capped	Asmnt Level	Assessed	Levy Rate	93.050	Current Tax																																																																																																																	
Remove Cap	2008	Land Value 81,139	61,287	11%	6,742	Assessed	16,861	1,568.92																																																																																																																	
Year Frozen	2022	Improvements 121,795	91,995		10,119	Penalty	0																																																																																																																		
Uncapped Value	0	Mobile Home 0	0		0	Exemption	1,000	-83.00																																																																																																																	
TIF Project ID	0	Total Value 202,934	153,282		16,861	Total Taxable	15,861	1,486.00																																																																																																																	
Assessment History <table border="1"> <thead> <tr> <th>Tax Year</th> <th>Statement Number</th> <th>Billed Owner</th> <th>Tax Area</th> <th>Total Value</th> <th>Exemptions</th> <th>Taxable Value</th> <th>Billed Tax</th> </tr> </thead> <tbody> <tr><td>2025</td><td>2025-660004443</td><td>BUNNEY, JAMES D &</td><td>93</td><td>203,645</td><td>1000</td><td>15,861</td><td>1,486.00</td></tr> <tr><td>2024</td><td>2024-660004443</td><td>BUNNEY, JAMES D &</td><td>93</td><td>220,830</td><td>1000</td><td>15,861</td><td>1,594.00</td></tr> <tr><td>2023</td><td>2023-660004443</td><td>BUNNEY, JAMES D &</td><td>93</td><td>163,007</td><td>1000</td><td>15,861</td><td>1,591.00</td></tr> <tr><td>2022</td><td>2022-660004443</td><td>BUNNEY, JAMES D &</td><td>93</td><td>164,618</td><td>1000</td><td>15,861</td><td>1,589.00</td></tr> <tr><td>2021</td><td>2021-660004443</td><td>BUNNEY, JAMES D &</td><td>93</td><td>148,818</td><td>1000</td><td>15,370</td><td>1,566.00</td></tr> <tr><td>2020</td><td>2020-660004443</td><td>BUNNEY, JAMES D &</td><td>93</td><td>146,575</td><td>1000</td><td>14,980</td><td>1,476.00</td></tr> <tr><td>2019</td><td>2019-660004443</td><td>BUNNEY, JAMES D &</td><td>93</td><td>141,046</td><td>1000</td><td>14,515</td><td>1,459.00</td></tr> <tr><td>2018</td><td>2018-660004443</td><td>BUNNEY, JAMES D &</td><td>93</td><td>143,446</td><td>1000</td><td>14,779</td><td>1,486.00</td></tr> <tr><td>2017</td><td>2017-660004443</td><td>BUNNEY, JAMES D &</td><td>93</td><td>142,369</td><td>1000</td><td>14,661</td><td>1,400.00</td></tr> <tr><td>2016</td><td>2016-660004443</td><td>BUNNEY, JAMES D &</td><td>93</td><td>138,950</td><td>1000</td><td>14,248</td><td>1,413.00</td></tr> <tr><td>2015</td><td>2015-660004443</td><td>BUNNEY, JAMES D &</td><td>93</td><td>136,058</td><td>1000</td><td>13,804</td><td>1,358.00</td></tr> <tr><td>2014</td><td>2014-660004443</td><td>BUNNEY, JAMES D &</td><td>93</td><td>138,162</td><td>1000</td><td>13,372</td><td>1,292.00</td></tr> <tr><td>2013</td><td>2013-660004443</td><td>BUNNEY, JAMES D &</td><td>93</td><td>128,827</td><td>1000</td><td>12,954</td><td>1,268.00</td></tr> </tbody> </table>										Tax Year	Statement Number	Billed Owner	Tax Area	Total Value	Exemptions	Taxable Value	Billed Tax	2025	2025-660004443	BUNNEY, JAMES D &	93	203,645	1000	15,861	1,486.00	2024	2024-660004443	BUNNEY, JAMES D &	93	220,830	1000	15,861	1,594.00	2023	2023-660004443	BUNNEY, JAMES D &	93	163,007	1000	15,861	1,591.00	2022	2022-660004443	BUNNEY, JAMES D &	93	164,618	1000	15,861	1,589.00	2021	2021-660004443	BUNNEY, JAMES D &	93	148,818	1000	15,370	1,566.00	2020	2020-660004443	BUNNEY, JAMES D &	93	146,575	1000	14,980	1,476.00	2019	2019-660004443	BUNNEY, JAMES D &	93	141,046	1000	14,515	1,459.00	2018	2018-660004443	BUNNEY, JAMES D &	93	143,446	1000	14,779	1,486.00	2017	2017-660004443	BUNNEY, JAMES D &	93	142,369	1000	14,661	1,400.00	2016	2016-660004443	BUNNEY, JAMES D &	93	138,950	1000	14,248	1,413.00	2015	2015-660004443	BUNNEY, JAMES D &	93	136,058	1000	13,804	1,358.00	2014	2014-660004443	BUNNEY, JAMES D &	93	138,162	1000	13,372	1,292.00	2013	2013-660004443	BUNNEY, JAMES D &	93	128,827	1000	12,954	1,268.00
Tax Year	Statement Number	Billed Owner	Tax Area	Total Value	Exemptions	Taxable Value	Billed Tax																																																																																																																		
2025	2025-660004443	BUNNEY, JAMES D &	93	203,645	1000	15,861	1,486.00																																																																																																																		
2024	2024-660004443	BUNNEY, JAMES D &	93	220,830	1000	15,861	1,594.00																																																																																																																		
2023	2023-660004443	BUNNEY, JAMES D &	93	163,007	1000	15,861	1,591.00																																																																																																																		
2022	2022-660004443	BUNNEY, JAMES D &	93	164,618	1000	15,861	1,589.00																																																																																																																		
2021	2021-660004443	BUNNEY, JAMES D &	93	148,818	1000	15,370	1,566.00																																																																																																																		
2020	2020-660004443	BUNNEY, JAMES D &	93	146,575	1000	14,980	1,476.00																																																																																																																		
2019	2019-660004443	BUNNEY, JAMES D &	93	141,046	1000	14,515	1,459.00																																																																																																																		
2018	2018-660004443	BUNNEY, JAMES D &	93	143,446	1000	14,779	1,486.00																																																																																																																		
2017	2017-660004443	BUNNEY, JAMES D &	93	142,369	1000	14,661	1,400.00																																																																																																																		
2016	2016-660004443	BUNNEY, JAMES D &	93	138,950	1000	14,248	1,413.00																																																																																																																		
2015	2015-660004443	BUNNEY, JAMES D &	93	136,058	1000	13,804	1,358.00																																																																																																																		
2014	2014-660004443	BUNNEY, JAMES D &	93	138,162	1000	13,372	1,292.00																																																																																																																		
2013	2013-660004443	BUNNEY, JAMES D &	93	128,827	1000	12,954	1,268.00																																																																																																																		



Rogers

Assessment Property Record Card for Tax Year 2026

Data provided by LISA DELOZIER County Assessor

Date 04/17/2026
 Time 02:26:42
 Page 2

Lot Data	Square-Foot - NBHD 1070 #1	Primary Image
Lot Size Lot Count Units Buildable 11000 Non-Ag Acres 1.5254 Topography Street Access Utilities Amenities LAND QUALITY 0 0 Method Square-Foot Base Lot Value 66,446.00 x 1.22 = 81,139 Factor Value Adjustments 1.0000 Lot Value 81,139		

Residential Data	
Type	1 Single Family Residence
Condition	3 - Average
Quality	2.5 - Fair
Architecture	
Style	100% One Story
Exterior Wall	20% Veneer, Masonry 80% Frame, Siding, Vinyl
Base/Total Area	1,272 / 1,272
Style	100% One Story
HVAC	100% Warmed & Cooled Air
Roof Cover	1 Composition Shingle
Area on Slab	1,272
Fixture/RghIn	11 /
Bed/F/H Bath	3 / 2.0 /
Basement Area	
Garage Type	492 Attached Garage - Unfinished
Remodel	PARTIAL -
Year/Eff Age	1993 / 25

GRM Approach
GRM Code Gross Rent 0.00 Indicated Value

Multiple Regression
MRA Code 1 Test Adusted R 0.8445 Indicated Value 162,097 127.43 Per SqFt

Direct Comparables
Selection Model A Adam Test Adjustment Model 1 2022 Residential Comparables 3 Indicated Value 175,220 Per SqFt

Cost Approach				Manual : 01/2025			
Base Cost	100.91	Total Misc Impr	+ 3,448	Roofing Adj	+ 4.58	Garage Cost	+ 13,545
Subfloor Adj	+ -1.17	Total RCN	= 178,359	Heat/Cool Adj	+ 11.47	Depreciation (34%)	- 60,642
Plumbing Adj	+ 11.07	Lump Sums	+ 4,078	Basement Adj	+ 0.00	RCNLD	= 121,795
Adj Base Cost	= 126.86	Lot Value	+ 81,139	Total Area	x 1,272	Indicated Value	= 202,934
		Value Per SqFt	159.54	Adjusted Cost	= 161,366		

Value Reconciliation
Selected Approach Cost Approach Improvements 121,795 Lot Value 81,139 Indicated Value 202,934 159.54 Per SqFt Agland Value Site Improvements Total Value 202,934 159.54 Total Value Per SqFt

Miscellaneous Improvements								
Code	Description	Sketch ID	Size	Year	Units	Unit Cost	Depr	Value
PRCH	SLAB PORCH - COVERED	11503	29x5		145	23.78		3,448
WODO	WOOD DECK - OPEN	11504	16x12		192	21.24		4,078



Rogers

Assessment Property Record Card for Tax Year 2026

Data provided by LISA DELOZIER County Assessor

Date 04/17/2026
 Time 02:26:42
 Page 3

Sketch Image

660004443

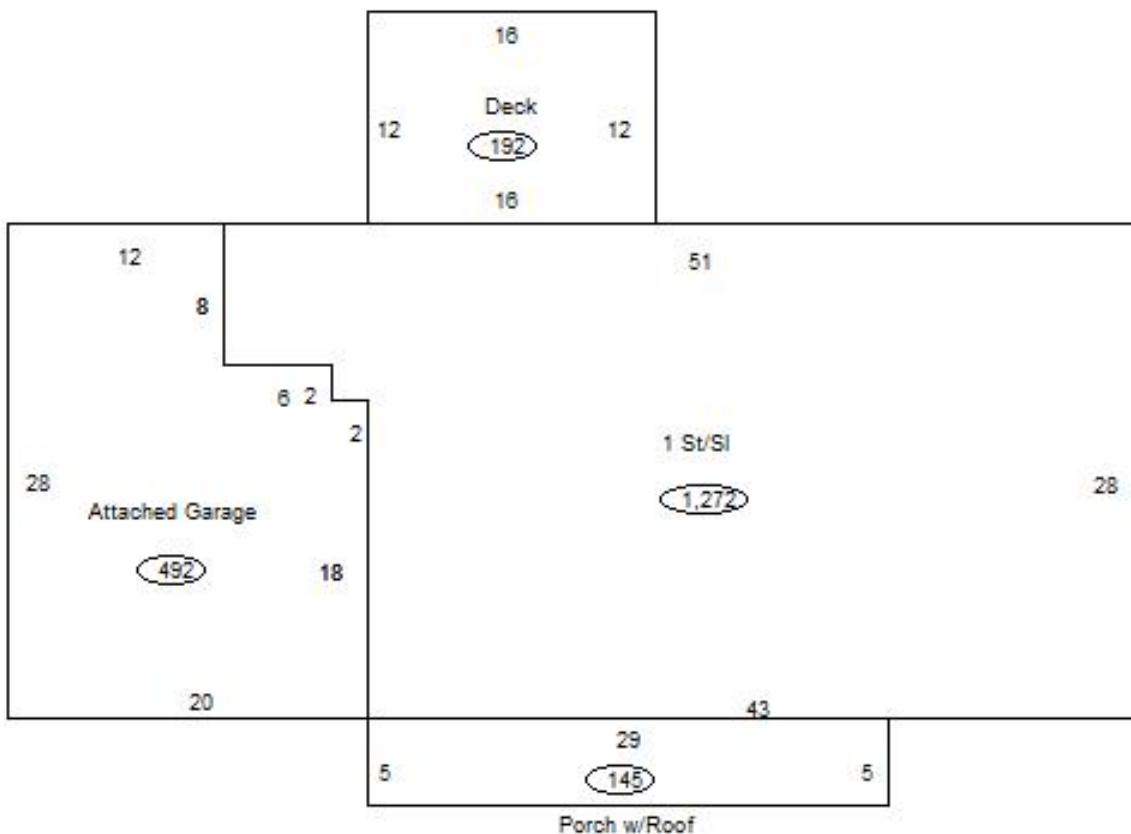

Sketch Vector Information

Sequence	Code	Type	Built Over	Scale	Section Label	Base Area	Multiplier	Total Area
1	R	1	Slab	13	1 St/Sl	1,272	1.000	1,272
2	G	1		13	Attached Garage	492	1.000	492
3	M	PRCH		13	SLBC	145	1.000	145
4	M	WODO		13	WODO	192	1.000	192
Total Building Area						1,272		1,272