



Rogers

Assessment Property Record Card for Tax Year 2026

Data provided by LISA DELOZIER County Assessor

Date 04/17/2026
Time 02:26:44
Page 1

Assessment Data					Primary Image																																																																																																																				
Account 660004444 Parcel ID 000000-00-0-00525-002-0004 Cadastral ID 05-21-17-01810 Property Type REAL - Real Property Property Class RRP VI Area 3 Tax Area 93 - JUSTUS/TRI-DISTRICT FIRE Name ID 332331 HARRIS, JESSICA MARIE & JENNIFER SALENA BEAN 19935 MOUNTAIN LN CLAREMORE OK 74019-0000 Parcel Location Situs 19935 MOUNTAIN LN Subdivision MOUNTAIN MEADOWS Lot/Block 0004 / 0002 Parcel Size 1 - Lots Sec/Twn/Rng 5 / 21 / 17 / 5 Neighborhood 1070 - R-V03-SE JUSTUS-SEQUOYAH School District S009 - JUSTUS-TIAWAH SCHOOLS																																																																																																																									
Legal Description Lot/Long: 36.32380514 -95.51680435										Building Permits <table border="1"> <thead> <tr> <th>Number</th> <th>Description</th> <th>Opened</th> <th>Closed</th> <th>Amount</th> </tr> </thead> <tbody> <tr> <td colspan="5"> </td> </tr> </tbody> </table>					Number	Description	Opened	Closed	Amount																																																																																																						
Number	Description	Opened	Closed	Amount																																																																																																																					
Exemptions <table border="1"> <thead> <tr> <th>Code</th> <th>Type</th> <th>Active</th> <th>Maximum</th> <th>Exemption</th> </tr> </thead> <tbody> <tr> <td>H</td> <td>Homestead</td> <td>Yes</td> <td>1,000</td> <td>1,000</td> </tr> </tbody> </table>					Code	Type	Active	Maximum	Exemption	H	Homestead	Yes	1,000	1,000	Sale History <table border="1"> <thead> <tr> <th>Bk/Pg</th> <th>Grantor</th> <th>Date</th> <th>Price</th> <th>Code</th> </tr> </thead> <tbody> <tr> <td>/</td> <td>SMITH, MICHAEL &</td> <td>09/25/2020</td> <td>205,000</td> <td>YES</td> </tr> <tr> <td>2700/757</td> <td>LONG, CRAIG M & ANGELA A</td> <td>03/23/2018</td> <td>170,000</td> <td>YES</td> </tr> <tr> <td>2311/331</td> <td>CUTTLER, DAVID MICHAEL &</td> <td>03/08/2013</td> <td>145,500</td> <td>YES</td> </tr> <tr> <td>1582/274</td> <td>THORNHILL, KENNETH JOHN &</td> <td>04/23/2004</td> <td>126,500</td> <td>YES</td> </tr> <tr> <td>1028/547</td> <td>WOODS, DAVID O</td> <td>06/11/1996</td> <td>91,500</td> <td>Yes</td> </tr> <tr> <td>1006/299</td> <td>GRIGGS, RONNIE J &</td> <td>10/26/1995</td> <td>88,000</td> <td>Yes</td> </tr> </tbody> </table>					Bk/Pg	Grantor	Date	Price	Code	/	SMITH, MICHAEL &	09/25/2020	205,000	YES	2700/757	LONG, CRAIG M & ANGELA A	03/23/2018	170,000	YES	2311/331	CUTTLER, DAVID MICHAEL &	03/08/2013	145,500	YES	1582/274	THORNHILL, KENNETH JOHN &	04/23/2004	126,500	YES	1028/547	WOODS, DAVID O	06/11/1996	91,500	Yes	1006/299	GRIGGS, RONNIE J &	10/26/1995	88,000	Yes																																																																			
Code	Type	Active	Maximum	Exemption																																																																																																																					
H	Homestead	Yes	1,000	1,000																																																																																																																					
Bk/Pg	Grantor	Date	Price	Code																																																																																																																					
/	SMITH, MICHAEL &	09/25/2020	205,000	YES																																																																																																																					
2700/757	LONG, CRAIG M & ANGELA A	03/23/2018	170,000	YES																																																																																																																					
2311/331	CUTTLER, DAVID MICHAEL &	03/08/2013	145,500	YES																																																																																																																					
1582/274	THORNHILL, KENNETH JOHN &	04/23/2004	126,500	YES																																																																																																																					
1028/547	WOODS, DAVID O	06/11/1996	91,500	Yes																																																																																																																					
1006/299	GRIGGS, RONNIE J &	10/26/1995	88,000	Yes																																																																																																																					
Parcel Valuation <table border="1"> <thead> <tr> <th>Source</th> <th>REAL</th> <th>Fair Cash</th> <th>Capped</th> <th>Asmnt Level</th> <th>Assessed</th> <th>Levy Rate</th> <th>93.050</th> <th>Current Tax</th> </tr> </thead> <tbody> <tr> <td>Remove Cap</td> <td>2021</td> <td>Land Value 82,526</td> <td>65,104</td> <td>11%</td> <td>7,161</td> <td>Assessed</td> <td>26,955</td> <td>2,508.16</td> </tr> <tr> <td>Year Frozen</td> <td>0</td> <td>Improvements 179,945</td> <td>179,945</td> <td></td> <td>19,794</td> <td>Penalty</td> <td>0</td> <td></td> </tr> <tr> <td>Uncapped Value</td> <td>1,849</td> <td>Mobile Home 0</td> <td>0</td> <td></td> <td>0</td> <td>Exemption</td> <td>1,000</td> <td>-83.00</td> </tr> <tr> <td>TIF Project ID</td> <td>0</td> <td>Total Value 262,471</td> <td>245,049</td> <td></td> <td>26,955</td> <td>Total Taxable</td> <td>25,955</td> <td>2,425.00</td> </tr> </tbody> </table>										Source	REAL	Fair Cash	Capped	Asmnt Level	Assessed	Levy Rate	93.050	Current Tax	Remove Cap	2021	Land Value 82,526	65,104	11%	7,161	Assessed	26,955	2,508.16	Year Frozen	0	Improvements 179,945	179,945		19,794	Penalty	0		Uncapped Value	1,849	Mobile Home 0	0		0	Exemption	1,000	-83.00	TIF Project ID	0	Total Value 262,471	245,049		26,955	Total Taxable	25,955	2,425.00																																																																			
Source	REAL	Fair Cash	Capped	Asmnt Level	Assessed	Levy Rate	93.050	Current Tax																																																																																																																	
Remove Cap	2021	Land Value 82,526	65,104	11%	7,161	Assessed	26,955	2,508.16																																																																																																																	
Year Frozen	0	Improvements 179,945	179,945		19,794	Penalty	0																																																																																																																		
Uncapped Value	1,849	Mobile Home 0	0		0	Exemption	1,000	-83.00																																																																																																																	
TIF Project ID	0	Total Value 262,471	245,049		26,955	Total Taxable	25,955	2,425.00																																																																																																																	
Assessment History <table border="1"> <thead> <tr> <th>Tax Year</th> <th>Statement Number</th> <th>Billed Owner</th> <th>Tax Area</th> <th>Total Value</th> <th>Exemptions</th> <th>Taxable Value</th> <th>Billed Tax</th> </tr> </thead> <tbody> <tr><td>2025</td><td>2025-660004444</td><td>HARRIS, JESSICA MARIE &</td><td>93</td><td>257,254</td><td>1000</td><td>24,973</td><td>2,334.00</td></tr> <tr><td>2024</td><td>2024-660004444</td><td>HARRIS, JESSICA MARIE &</td><td>93</td><td>277,108</td><td>0</td><td>25,217</td><td>2,507.00</td></tr> <tr><td>2023</td><td>2023-660004444</td><td>HARRIS, JESSICA MARIE &</td><td>93</td><td>218,324</td><td>0</td><td>24,016</td><td>2,384.00</td></tr> <tr><td>2022</td><td>2022-660004444</td><td>HARRIS, JESSICA MARIE &</td><td>93</td><td>220,415</td><td>0</td><td>23,299</td><td>2,311.00</td></tr> <tr><td>2021</td><td>2021-660004444</td><td>HARRIS, JESSICA MARIE &</td><td>93</td><td>201,725</td><td>0</td><td>22,190</td><td>2,237.00</td></tr> <tr><td>2020</td><td>2020-660004444</td><td>SMITH, MICHAEL &</td><td>93</td><td>180,842</td><td>0</td><td>19,893</td><td>1,943.00</td></tr> <tr><td>2019</td><td>2019-660004444</td><td>SMITH, MICHAEL &</td><td>93</td><td>173,647</td><td>0</td><td>19,101</td><td>1,902.00</td></tr> <tr><td>2018</td><td>2018-660004444</td><td>SMITH, MICHAEL &</td><td>93</td><td>152,517</td><td>1000</td><td>15,777</td><td>1,586.00</td></tr> <tr><td>2017</td><td>2017-660004444</td><td>LONG, CRAIG M & ANGELA A</td><td>93</td><td>151,254</td><td>1000</td><td>15,638</td><td>1,491.00</td></tr> <tr><td>2016</td><td>2016-660004444</td><td>LONG, CRAIG M & ANGELA A</td><td>93</td><td>147,496</td><td>1000</td><td>15,225</td><td>1,510.00</td></tr> <tr><td>2015</td><td>2015-660004444</td><td>LONG, CRAIG M & ANGELA A</td><td>93</td><td>145,313</td><td>0</td><td>15,984</td><td>1,558.00</td></tr> <tr><td>2014</td><td>2014-660004444</td><td>LONG, CRAIG M & ANGELA A</td><td>93</td><td>146,544</td><td>0</td><td>16,120</td><td>1,544.00</td></tr> <tr><td>2013</td><td>2013-660004444</td><td>LONG, CRAIG M & ANGELA A</td><td>93</td><td>151,909</td><td>1000</td><td>15,352</td><td>1,501.00</td></tr> </tbody> </table>										Tax Year	Statement Number	Billed Owner	Tax Area	Total Value	Exemptions	Taxable Value	Billed Tax	2025	2025-660004444	HARRIS, JESSICA MARIE &	93	257,254	1000	24,973	2,334.00	2024	2024-660004444	HARRIS, JESSICA MARIE &	93	277,108	0	25,217	2,507.00	2023	2023-660004444	HARRIS, JESSICA MARIE &	93	218,324	0	24,016	2,384.00	2022	2022-660004444	HARRIS, JESSICA MARIE &	93	220,415	0	23,299	2,311.00	2021	2021-660004444	HARRIS, JESSICA MARIE &	93	201,725	0	22,190	2,237.00	2020	2020-660004444	SMITH, MICHAEL &	93	180,842	0	19,893	1,943.00	2019	2019-660004444	SMITH, MICHAEL &	93	173,647	0	19,101	1,902.00	2018	2018-660004444	SMITH, MICHAEL &	93	152,517	1000	15,777	1,586.00	2017	2017-660004444	LONG, CRAIG M & ANGELA A	93	151,254	1000	15,638	1,491.00	2016	2016-660004444	LONG, CRAIG M & ANGELA A	93	147,496	1000	15,225	1,510.00	2015	2015-660004444	LONG, CRAIG M & ANGELA A	93	145,313	0	15,984	1,558.00	2014	2014-660004444	LONG, CRAIG M & ANGELA A	93	146,544	0	16,120	1,544.00	2013	2013-660004444	LONG, CRAIG M & ANGELA A	93	151,909	1000	15,352	1,501.00
Tax Year	Statement Number	Billed Owner	Tax Area	Total Value	Exemptions	Taxable Value	Billed Tax																																																																																																																		
2025	2025-660004444	HARRIS, JESSICA MARIE &	93	257,254	1000	24,973	2,334.00																																																																																																																		
2024	2024-660004444	HARRIS, JESSICA MARIE &	93	277,108	0	25,217	2,507.00																																																																																																																		
2023	2023-660004444	HARRIS, JESSICA MARIE &	93	218,324	0	24,016	2,384.00																																																																																																																		
2022	2022-660004444	HARRIS, JESSICA MARIE &	93	220,415	0	23,299	2,311.00																																																																																																																		
2021	2021-660004444	HARRIS, JESSICA MARIE &	93	201,725	0	22,190	2,237.00																																																																																																																		
2020	2020-660004444	SMITH, MICHAEL &	93	180,842	0	19,893	1,943.00																																																																																																																		
2019	2019-660004444	SMITH, MICHAEL &	93	173,647	0	19,101	1,902.00																																																																																																																		
2018	2018-660004444	SMITH, MICHAEL &	93	152,517	1000	15,777	1,586.00																																																																																																																		
2017	2017-660004444	LONG, CRAIG M & ANGELA A	93	151,254	1000	15,638	1,491.00																																																																																																																		
2016	2016-660004444	LONG, CRAIG M & ANGELA A	93	147,496	1000	15,225	1,510.00																																																																																																																		
2015	2015-660004444	LONG, CRAIG M & ANGELA A	93	145,313	0	15,984	1,558.00																																																																																																																		
2014	2014-660004444	LONG, CRAIG M & ANGELA A	93	146,544	0	16,120	1,544.00																																																																																																																		
2013	2013-660004444	LONG, CRAIG M & ANGELA A	93	151,909	1000	15,352	1,501.00																																																																																																																		



Rogers

Assessment Property Record Card for Tax Year 2026

Data provided by LISA DELOZIER County Assessor

Date 04/17/2026
 Time 02:26:44
 Page 2

Lot Data	Square-Foot - NBHD 1070 #1	Primary Image
Lot Size Lot Count Units Buildable 11000 Non-Ag Acres 1.589 Topography Street Access Utilities Amenities LAND QUALITY 0 0 Method Square-Foot Base Lot Value 69,219.00 x 1.19 = 82,526 Factor Value Adjustments 1.0000 Lot Value 82,526		

Residential Data	
Type	1 Single Family Residence
Condition	3 - Average
Quality	2.5 - Fair
Architecture	
Style	100% 1 1/2 Story Finished
Exterior Wall	20% Veneer, Masonry 80% Frame, Siding, Wood
Base/Total Area	1,064 / 1,828
Style	100% 1 1/2 Story Finished
HVAC	100% Warmed & Cooled Air
Roof Cover	1 Composition Shingle
Area on Slab	1,064
Fixture/RghIn	18 /
Bed/F/H Bath	3 / 2.0 /
Basement Area	
Garage Type	440 Attached Garage - Unfinished
Remodel	RMA -
Year/Eff Age	1995 / 15

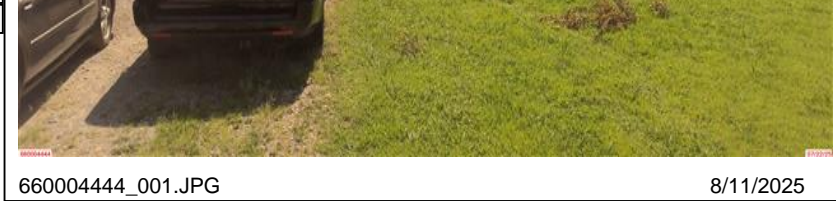

GRM Approach	
GRM Code	
Gross Rent	0.00
Indicated Value	

Multiple Regression			
MRA Code	1	Test	
Adusted R	0.8445		
Indicated Value	193,835	106.04	Per SqFt

Direct Comparables	
Selection Model	A Adam Test
Adjustment Model	1 2022 Residential
Comparables	
Indicated Value	

Cost Approach				Manual : 01/2025			
Base Cost	80.68	Total Misc Impr	+	12,294			
Roofing Adj	+ 2.70	Garage Cost	+	12,487			
Subfloor Adj	+ -0.71	Total RCN	=	219,445			
Heat/Cool Adj	+ 11.47	Depreciation (18%)	-	39,500			
Plumbing Adj	+ 12.35	Lump Sums	+	0			
Basement Adj	+ 0.00	RCNLD	=	179,945			
Adj Base Cost	= 106.49	Lot Value	+	82,526			
Total Area	x 1,828	Indicated Value	=	262,471			
Adjusted Cost	= 194,664	Value Per SqFt		143.58			

Value Reconciliation			
Selected Approach	Cost Approach		
Improvements	179,945		
Lot Value	82,526		
Indicated Value	262,471	143.58	Per SqFt
Agland Value			
Site Improvements			
Total Value	262,471	143.58	Total Value Per SqFt

Miscellaneous Improvements								
Code	Description	Sketch ID	Size	Year	Units	Unit Cost	Depr	Value
FPR1	FIREPLACE - RESIDENTIAL 1 STORY	0		1	1	5,095.98		5,096
PRCH	SLAB PORCH - COVERED	11507	32x6		192	23.59		4,529
PATO	SLAB PORCH - OPEN	11508	32x10		320	8.34		2,669



Rogers

Assessment Property Record Card for Tax Year 2026

Data provided by LISA DELOZIER County Assessor

Date 04/17/2026
 Time 02:26:44
 Page 3

Sketch Image

660004444

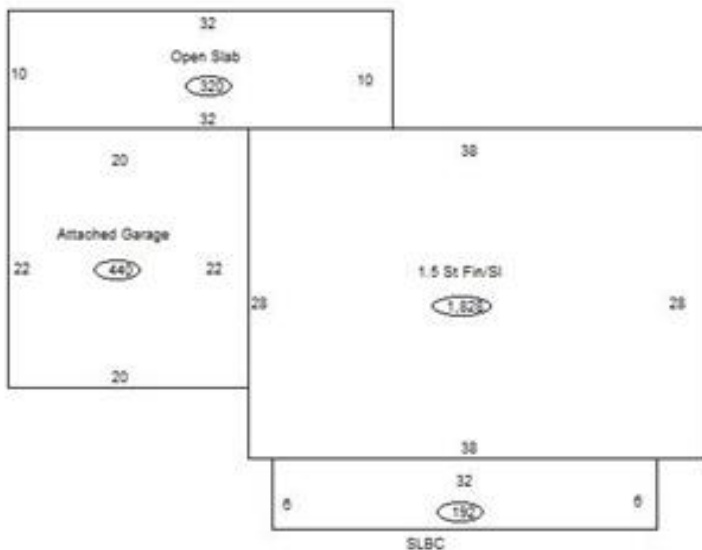

Sketch Vector Information

Sequence	Code	Type	Built Over	Scale	Section Label	Base Area	Multiplier	Total Area
1	R	5	Slab	13	1.5 St Fin/SI	1,064	1.718	1,828
2	G	1		13	Attached Garage	440	1.000	440
3	M	PRCH		13	SLBC	192	1.000	192
4	M	PATO		13	Open Slab	320	1.000	320
5	U	^UL	Overhang	13	Upper Level	764	1.000	764
Total Building Area						1,064		1,828