



Rogers

Assessment Property Record Card for Tax Year 2026

Data provided by LISA DELOZIER County Assessor

Date 04/17/2026
Time 02:26:46
Page 1

Assessment Data					Primary Image																																																																																																																				
Account 660004446 Parcel ID 000000-00-0-00525-002-0006 Cadastral ID 05-21-17-01830 Property Type REAL - Real Property Property Class RRP VI Area 3 Tax Area 93 - JUSTUS/TRI-DISTRICT FIRE Name ID 52634 SHRUM, BRIAN KEVIN & TANJA 19877 MOUNTAIN LN CLAREMORE OK 74019-0000 Parcel Location Situs 19877 MOUNTAIN LN Subdivision MOUNTAIN MEADOWS Lot/Block 0006 / 0002 Parcel Size 1 - Lots Sec/Twn/Rng 5 / 21 / 17 / 5 Neighborhood 1070 - R-V03-SE JUSTUS-SEQUOYAH School District S009 - JUSTUS-TIAWAH SCHOOLS																																																																																																																									
Legal Description Lot/Long: 36.32484567 -95.51677531																																																																																																																									
Building Permits					<table border="1"> <thead> <tr> <th>Number</th> <th>Description</th> <th>Opened</th> <th>Closed</th> <th>Amount</th> </tr> </thead> <tbody> <tr> <td colspan="5" style="height: 100px;"> </td> </tr> </tbody> </table>					Number	Description	Opened	Closed	Amount																																																																																																											
Number	Description	Opened	Closed	Amount																																																																																																																					
Exemptions					Sale History																																																																																																																				
<table border="1"> <thead> <tr> <th>Code</th> <th>Type</th> <th>Active</th> <th>Maximum</th> <th>Exemption</th> </tr> </thead> <tbody> <tr> <td>H</td> <td>Homestead</td> <td>Yes</td> <td>1,000</td> <td>1,000</td> </tr> </tbody> </table>					Code	Type	Active	Maximum	Exemption	H	Homestead	Yes	1,000	1,000	<table border="1"> <thead> <tr> <th>Bk/Pg</th> <th>Grantor</th> <th>Date</th> <th>Price</th> <th>Code</th> </tr> </thead> <tbody> <tr> <td>1033/520</td> <td>STIMSON, TERRANCE J &</td> <td>07/26/1996</td> <td>89,000</td> <td>Yes</td> </tr> <tr> <td>873/837</td> <td></td> <td>02/13/1992</td> <td>17,500</td> <td>No</td> </tr> </tbody> </table>					Bk/Pg	Grantor	Date	Price	Code	1033/520	STIMSON, TERRANCE J &	07/26/1996	89,000	Yes	873/837		02/13/1992	17,500	No																																																																																							
Code	Type	Active	Maximum	Exemption																																																																																																																					
H	Homestead	Yes	1,000	1,000																																																																																																																					
Bk/Pg	Grantor	Date	Price	Code																																																																																																																					
1033/520	STIMSON, TERRANCE J &	07/26/1996	89,000	Yes																																																																																																																					
873/837		02/13/1992	17,500	No																																																																																																																					
Parcel Valuation																																																																																																																									
<table border="1"> <thead> <tr> <th>Source</th> <th>REAL</th> <th>Fair Cash</th> <th>Capped</th> <th>Asmnt Level</th> <th>Assessed</th> <th>Levy Rate</th> <th>93.050</th> <th>Current Tax</th> </tr> </thead> <tbody> <tr> <td>Remove Cap</td> <td>0</td> <td>Land Value 80,942</td> <td>31,312</td> <td>11%</td> <td>3,444</td> <td>Assessed</td> <td>20,442</td> <td>1,902.13</td> </tr> <tr> <td>Year Frozen</td> <td>0</td> <td>Improvements 168,371</td> <td>154,531</td> <td></td> <td>16,998</td> <td>Penalty</td> <td>0</td> <td></td> </tr> <tr> <td>Uncapped Value</td> <td>0</td> <td>Mobile Home 0</td> <td>0</td> <td></td> <td>0</td> <td>Exemption</td> <td>1,000</td> <td>-83.00</td> </tr> <tr> <td>TIF Project ID</td> <td>0</td> <td>Total Value 249,313</td> <td>185,843</td> <td></td> <td>20,442</td> <td>Total Taxable</td> <td>19,442</td> <td>1,819.00</td> </tr> </tbody> </table>		Source	REAL	Fair Cash	Capped	Asmnt Level	Assessed	Levy Rate	93.050	Current Tax	Remove Cap	0	Land Value 80,942	31,312	11%	3,444	Assessed	20,442	1,902.13	Year Frozen	0	Improvements 168,371	154,531		16,998	Penalty	0		Uncapped Value	0	Mobile Home 0	0		0	Exemption	1,000	-83.00	TIF Project ID	0	Total Value 249,313	185,843		20,442	Total Taxable	19,442	1,819.00																																																																											
Source	REAL	Fair Cash	Capped	Asmnt Level	Assessed	Levy Rate	93.050	Current Tax																																																																																																																	
Remove Cap	0	Land Value 80,942	31,312	11%	3,444	Assessed	20,442	1,902.13																																																																																																																	
Year Frozen	0	Improvements 168,371	154,531		16,998	Penalty	0																																																																																																																		
Uncapped Value	0	Mobile Home 0	0		0	Exemption	1,000	-83.00																																																																																																																	
TIF Project ID	0	Total Value 249,313	185,843		20,442	Total Taxable	19,442	1,819.00																																																																																																																	
Assessment History																																																																																																																									
<table border="1"> <thead> <tr> <th>Tax Year</th> <th>Statement Number</th> <th>Billed Owner</th> <th>Tax Area</th> <th>Total Value</th> <th>Exemptions</th> <th>Taxable Value</th> <th>Billed Tax</th> </tr> </thead> <tbody> <tr><td>2025</td><td>2025-660004446</td><td>SHRUM, BRIAN KEVIN &</td><td>93</td><td>246,599</td><td>1000</td><td>18,848</td><td>1,763.00</td></tr> <tr><td>2024</td><td>2024-660004446</td><td>SHRUM, BRIAN KEVIN &</td><td>93</td><td>266,539</td><td>1000</td><td>18,270</td><td>1,833.00</td></tr> <tr><td>2023</td><td>2023-660004446</td><td>SHRUM, BRIAN KEVIN &</td><td>93</td><td>193,958</td><td>1000</td><td>17,708</td><td>1,774.00</td></tr> <tr><td>2022</td><td>2022-660004446</td><td>SHRUM, BRIAN KEVIN &</td><td>93</td><td>193,936</td><td>1000</td><td>17,164</td><td>1,719.00</td></tr> <tr><td>2021</td><td>2021-660004446</td><td>SHRUM, BRIAN KEVIN</td><td>93</td><td>185,072</td><td>1000</td><td>16,634</td><td>1,693.00</td></tr> <tr><td>2020</td><td>2020-660004446</td><td>SHRUM, BRIAN KEVIN</td><td>93</td><td>183,696</td><td>1000</td><td>16,121</td><td>1,588.00</td></tr> <tr><td>2019</td><td>2019-660004446</td><td>SHRUM, BRIAN KEVIN</td><td>93</td><td>174,823</td><td>1000</td><td>15,622</td><td>1,569.00</td></tr> <tr><td>2018</td><td>2018-660004446</td><td>SHRUM, BRIAN KEVIN</td><td>93</td><td>179,746</td><td>1000</td><td>15,138</td><td>1,522.00</td></tr> <tr><td>2017</td><td>2017-660004446</td><td>SHRUM, BRIAN KEVIN</td><td>93</td><td>178,708</td><td>1000</td><td>14,668</td><td>1,400.00</td></tr> <tr><td>2016</td><td>2016-660004446</td><td>SHRUM, BRIAN KEVIN</td><td>93</td><td>174,761</td><td>1000</td><td>14,212</td><td>1,410.00</td></tr> <tr><td>2015</td><td>2015-660004446</td><td>SHRUM, BRIAN KEVIN</td><td>93</td><td>169,941</td><td>1000</td><td>13,769</td><td>1,355.00</td></tr> <tr><td>2014</td><td>2014-660004446</td><td>SHRUM, BRIAN KEVIN</td><td>93</td><td>172,833</td><td>1000</td><td>13,338</td><td>1,288.00</td></tr> <tr><td>2013</td><td>2013-660004446</td><td>SHRUM, BRIAN KEVIN</td><td>93</td><td>164,351</td><td>1000</td><td>12,921</td><td>1,265.00</td></tr> </tbody> </table>										Tax Year	Statement Number	Billed Owner	Tax Area	Total Value	Exemptions	Taxable Value	Billed Tax	2025	2025-660004446	SHRUM, BRIAN KEVIN &	93	246,599	1000	18,848	1,763.00	2024	2024-660004446	SHRUM, BRIAN KEVIN &	93	266,539	1000	18,270	1,833.00	2023	2023-660004446	SHRUM, BRIAN KEVIN &	93	193,958	1000	17,708	1,774.00	2022	2022-660004446	SHRUM, BRIAN KEVIN &	93	193,936	1000	17,164	1,719.00	2021	2021-660004446	SHRUM, BRIAN KEVIN	93	185,072	1000	16,634	1,693.00	2020	2020-660004446	SHRUM, BRIAN KEVIN	93	183,696	1000	16,121	1,588.00	2019	2019-660004446	SHRUM, BRIAN KEVIN	93	174,823	1000	15,622	1,569.00	2018	2018-660004446	SHRUM, BRIAN KEVIN	93	179,746	1000	15,138	1,522.00	2017	2017-660004446	SHRUM, BRIAN KEVIN	93	178,708	1000	14,668	1,400.00	2016	2016-660004446	SHRUM, BRIAN KEVIN	93	174,761	1000	14,212	1,410.00	2015	2015-660004446	SHRUM, BRIAN KEVIN	93	169,941	1000	13,769	1,355.00	2014	2014-660004446	SHRUM, BRIAN KEVIN	93	172,833	1000	13,338	1,288.00	2013	2013-660004446	SHRUM, BRIAN KEVIN	93	164,351	1000	12,921	1,265.00
Tax Year	Statement Number	Billed Owner	Tax Area	Total Value	Exemptions	Taxable Value	Billed Tax																																																																																																																		
2025	2025-660004446	SHRUM, BRIAN KEVIN &	93	246,599	1000	18,848	1,763.00																																																																																																																		
2024	2024-660004446	SHRUM, BRIAN KEVIN &	93	266,539	1000	18,270	1,833.00																																																																																																																		
2023	2023-660004446	SHRUM, BRIAN KEVIN &	93	193,958	1000	17,708	1,774.00																																																																																																																		
2022	2022-660004446	SHRUM, BRIAN KEVIN &	93	193,936	1000	17,164	1,719.00																																																																																																																		
2021	2021-660004446	SHRUM, BRIAN KEVIN	93	185,072	1000	16,634	1,693.00																																																																																																																		
2020	2020-660004446	SHRUM, BRIAN KEVIN	93	183,696	1000	16,121	1,588.00																																																																																																																		
2019	2019-660004446	SHRUM, BRIAN KEVIN	93	174,823	1000	15,622	1,569.00																																																																																																																		
2018	2018-660004446	SHRUM, BRIAN KEVIN	93	179,746	1000	15,138	1,522.00																																																																																																																		
2017	2017-660004446	SHRUM, BRIAN KEVIN	93	178,708	1000	14,668	1,400.00																																																																																																																		
2016	2016-660004446	SHRUM, BRIAN KEVIN	93	174,761	1000	14,212	1,410.00																																																																																																																		
2015	2015-660004446	SHRUM, BRIAN KEVIN	93	169,941	1000	13,769	1,355.00																																																																																																																		
2014	2014-660004446	SHRUM, BRIAN KEVIN	93	172,833	1000	13,338	1,288.00																																																																																																																		
2013	2013-660004446	SHRUM, BRIAN KEVIN	93	164,351	1000	12,921	1,265.00																																																																																																																		



Rogers

Assessment Property Record Card for Tax Year 2026

Data provided by LISA DELOZIER County Assessor

Date 04/17/2026
Time 02:26:46
Page 2

Lot Data	Square-Foot - NBHD 1070 #1	Primary Image
Lot Size Lot Count Units Buildable 11000 Non-Ag Acres 1.5164 Topography Street Access Utilities Amenities LAND QUALITY 0 0 Method Square-Foot Base Lot Value 66,052.00 x 1.23 = 80,942 Factor Value Adjustments 1.0000 Lot Value 80,942		

Residential Data	
Type	1 Single Family Residence
Condition	3 - Average
Quality	2.5 - Fair
Architecture	
Style	100% One Story
Exterior Wall	90% Veneer, Masonry 10% Frame, Siding, Wood
Base/Total Area	1,476 / 1,476
Style	100% One Story
HVAC	100% Warmed & Cooled Air
Roof Cover	1 Composition Shingle
Area on Slab	1,476
Fixture/RghIn	11 /
Bed/F/H Bath	3 / 2.0 /
Basement Area	
Garage Type	506 Attached Garage - Unfinished
Remodel	
Year/Eff Age	1996 / 23

GRM Approach
GRM Code Gross Rent 0.00 Indicated Value

Multiple Regression
MRA Code 1 Test Adusted R 0.8445 Indicated Value 196,958 133.44 Per SqFt

Direct Comparables
Selection Model A Adam Test Adjustment Model 1 2022 Residential Comparables 4 Indicated Value 199,540 Per SqFt

Cost Approach				Manual : 01/2025			
Base Cost	106.48	Total Misc Impr	+ 8,324	Roofing Adj	+ 4.53	Garage Cost	+ 13,854
Subfloor Adj	+ -1.17	Total RCN	= 215,313	Heat/Cool Adj	+ 11.47	Depreciation (30%)	- 64,594
Plumbing Adj	+ 9.54	Lump Sums	+ 0	Basement Adj	+ 0.00	RCNLD	= 150,719
Adj Base Cost	= 130.85	Lot Value	+ 80,942	Total Area	x 1,476	Indicated Value	= 231,661
		Value Per SqFt	156.95	Adjusted Cost	= 193,135		

Value Reconciliation
Selected Approach Cost Approach Improvements 150,719 Lot Value 80,942 Indicated Value 231,661 156.95 Per SqFt Agland Value Site Improvements 17,652 Total Value 249,313 168.91 Total Value Per SqFt

Miscellaneous Improvements								
Code	Description	Sketch ID	Size	Year	Units	Unit Cost	Depr	Value
PRCH	SLAB PORCH - COVERED	11516	24x8		192	23.59		4,529
PRCH	SLAB PORCH - COVERED	11517	20x8		160	23.72		3,795



Rogers

Assessment Property Record Card for Tax Year 2026

Data provided by LISA DELOZIER County Assessor

Date 04/17/2026
 Time 02:26:46
 Page 3

Sketch Image

660004446

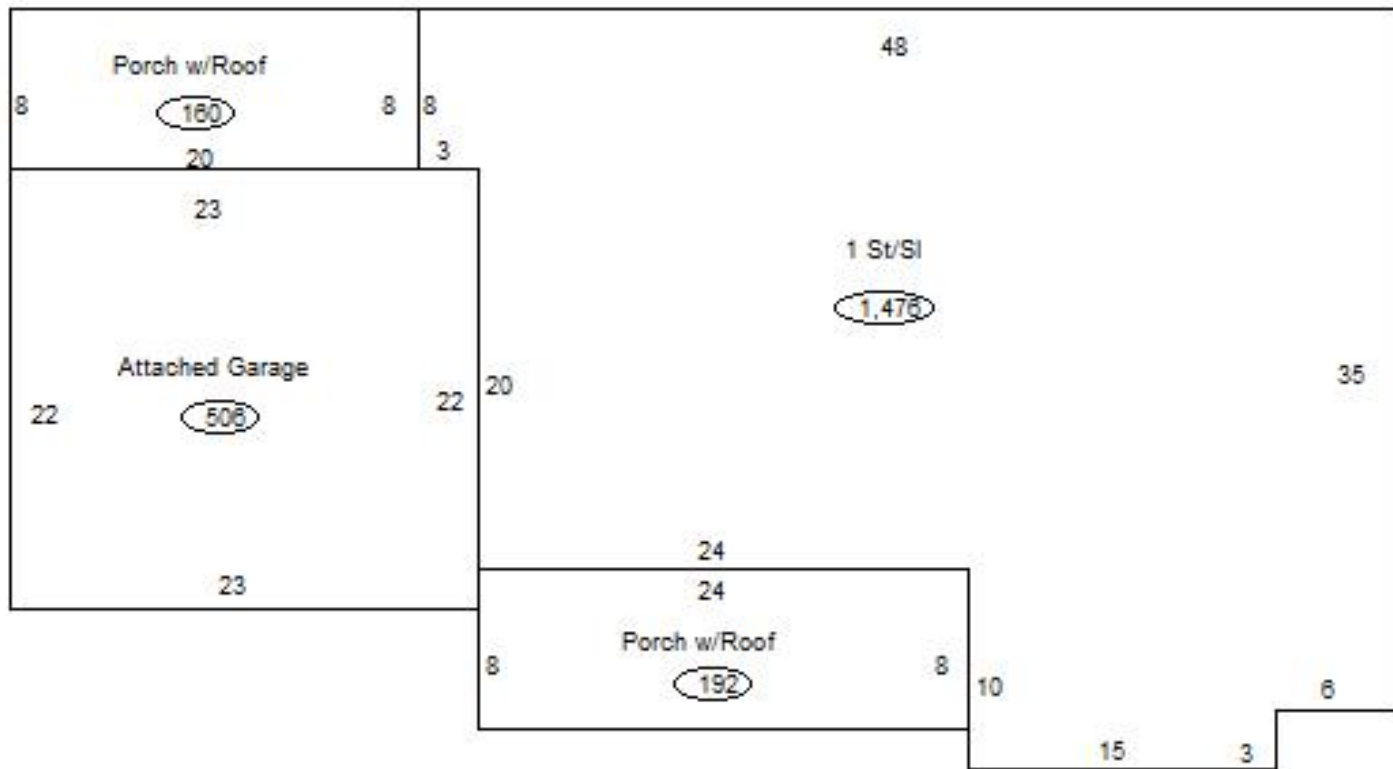

Sketch Vector Information

Sequence	Code	Type	Built Over	Scale	Section Label	Base Area	Multiplier	Total Area
1	R	1	Slab	13	1 St/Sl	1,476	1.000	1,476
2	G	1		13	Attached Garage	506	1.000	506
3	M	PRCH		13	SLBC	192	1.000	192
4	M	PRCH		13	SLBC	160	1.000	160
Total Building Area						1,476		1,476



Rogers

Assessment Property Record Card for Tax Year 2026

Data provided by LISA DELOZIER County Assessor

Date 04/17/2026
Time 02:26:46
Page 4

660004446

Outbuildings/Site Improvements

Building Image	Code	Description	Dimensions	Floor	Roofing	Total Units
	GRDT	GARAGE - DETACHED	0x0x0			720
	Qual 3	Cond 3	Year 2005	Eff Age		
		Valuation Summary	Modifier Total	RCN	Depr (10% Phys/ % Func)	RCNLD
		Base Cost (27.24 x 720)	19,613	19,613	1,961	17,652