



# Rogers

## Assessment Property Record Card for Tax Year 2026

Data provided by LISA DELOZIER County Assessor

Date 04/17/2026  
Time 12:18:48  
Page 1

Assessment Data					Primary Image																																																																																																																				
<b>Account</b> 660004451 <b>Parcel ID</b> 000000-00-0-00525-002-0013 <b>Cadastral ID</b> 05-21-17-01890 <b>Property Type</b> REAL - Real Property <b>Property Class</b> RRP VI Area 3 <b>Tax Area</b> 93 - JUSTUS/TRI-DISTRICT FIRE <b>Name ID</b> 256761 BAKER, MICHAEL A &  KATIE 19623 MOUNTAIN LN CLAREMORE OK 74019-0000					<p>660004451 07/21/25</p> <p>660004451_002.JPG 8/11/2025</p>																																																																																																																				
<b>Parcel Location</b> <b>Situs</b> 19595 S MOUNTAIN LN <b>Subdivision</b> MOUNTAIN MEADOWS <b>Lot/Block</b> 0013 / 0002 <b>Parcel Size</b> 1 - Lots <b>Sec/Twn/Rng</b> 5 / 21 / 17 / 5 <b>Neighborhood</b> 1070 - R-V03-SE JUSTUS-SEQUOYAH <b>School District</b> S009 - JUSTUS-TIAWAH SCHOOLS																																																																																																																									
<b>Legal Description</b> Lat/Long: 36.32868805 -95.51665451					<b>Building Permits</b> <table border="1"> <thead> <tr> <th>Number</th> <th>Description</th> <th>Opened</th> <th>Closed</th> <th>Amount</th> </tr> </thead> <tbody> <tr> <td colspan="5" style="height: 100px;"> </td> </tr> </tbody> </table>					Number	Description	Opened	Closed	Amount																																																																																																											
Number	Description	Opened	Closed	Amount																																																																																																																					
<b>Exemptions</b> <table border="1"> <thead> <tr> <th>Code</th> <th>Type</th> <th>Active</th> <th>Maximum</th> <th>Exemption</th> </tr> </thead> <tbody> <tr> <td colspan="5" style="height: 100px;"> </td> </tr> </tbody> </table>					Code	Type	Active	Maximum	Exemption						<b>Sale History</b> <table border="1"> <thead> <tr> <th>Bk/Pg</th> <th>Grantor</th> <th>Date</th> <th>Price</th> <th>Code</th> </tr> </thead> <tbody> <tr> <td>924/717</td> <td>KEELY, BUCKIE L &amp;</td> <td>08/06/1993</td> <td>18,900</td> <td>No</td> </tr> <tr> <td>812/806</td> <td></td> <td></td> <td>9,500</td> <td>No</td> </tr> </tbody> </table>					Bk/Pg	Grantor	Date	Price	Code	924/717	KEELY, BUCKIE L &	08/06/1993	18,900	No	812/806			9,500	No																																																																																							
Code	Type	Active	Maximum	Exemption																																																																																																																					
Bk/Pg	Grantor	Date	Price	Code																																																																																																																					
924/717	KEELY, BUCKIE L &	08/06/1993	18,900	No																																																																																																																					
812/806			9,500	No																																																																																																																					
<b>Parcel Valuation</b> <table border="1"> <thead> <tr> <th>Source</th> <th>REAL</th> <th>Fair Cash</th> <th>Capped</th> <th>Asmnt Level</th> <th>Assessed</th> <th>Levy Rate</th> <th>93.050</th> <th>Current Tax</th> </tr> </thead> <tbody> <tr> <td>Remove Cap</td> <td>0</td> <td>Land Value 92,737</td> <td>39,883</td> <td>11%</td> <td>4,387</td> <td>Assessed</td> <td>21,686</td> <td>2,017.88</td> </tr> <tr> <td>Year Frozen</td> <td>0</td> <td>Improvements 167,004</td> <td>157,260</td> <td></td> <td>17,299</td> <td>Penalty</td> <td>0</td> <td></td> </tr> <tr> <td>Uncapped Value</td> <td>6,658</td> <td>Mobile Home 0</td> <td>0</td> <td></td> <td>0</td> <td>Exemption</td> <td>0</td> <td>0.00</td> </tr> <tr> <td>TIF Project ID</td> <td>0</td> <td>Total Value 259,741</td> <td>197,143</td> <td></td> <td>21,686</td> <td>Total Taxable</td> <td>21,686</td> <td>2,018.00</td> </tr> </tbody> </table>										Source	REAL	Fair Cash	Capped	Asmnt Level	Assessed	Levy Rate	93.050	Current Tax	Remove Cap	0	Land Value 92,737	39,883	11%	4,387	Assessed	21,686	2,017.88	Year Frozen	0	Improvements 167,004	157,260		17,299	Penalty	0		Uncapped Value	6,658	Mobile Home 0	0		0	Exemption	0	0.00	TIF Project ID	0	Total Value 259,741	197,143		21,686	Total Taxable	21,686	2,018.00																																																																			
Source	REAL	Fair Cash	Capped	Asmnt Level	Assessed	Levy Rate	93.050	Current Tax																																																																																																																	
Remove Cap	0	Land Value 92,737	39,883	11%	4,387	Assessed	21,686	2,017.88																																																																																																																	
Year Frozen	0	Improvements 167,004	157,260		17,299	Penalty	0																																																																																																																		
Uncapped Value	6,658	Mobile Home 0	0		0	Exemption	0	0.00																																																																																																																	
TIF Project ID	0	Total Value 259,741	197,143		21,686	Total Taxable	21,686	2,018.00																																																																																																																	
<b>Assessment History</b> <table border="1"> <thead> <tr> <th>Tax Year</th> <th>Statement Number</th> <th>Billed Owner</th> <th>Tax Area</th> <th>Total Value</th> <th>Exemptions</th> <th>Taxable Value</th> <th>Billed Tax</th> </tr> </thead> <tbody> <tr><td>2025</td><td>2025-660004451</td><td>BAKER, MICHAEL A &amp;</td><td>93</td><td>242,318</td><td>0</td><td>19,955</td><td>1,857.00</td></tr> <tr><td>2024</td><td>2024-660004451</td><td>BAKER, MICHAEL A &amp;</td><td>93</td><td>262,427</td><td>0</td><td>19,005</td><td>1,890.00</td></tr> <tr><td>2023</td><td>2023-660004451</td><td>BAKER, MICHAEL A &amp;</td><td>93</td><td>164,551</td><td>0</td><td>18,101</td><td>1,797.00</td></tr> <tr><td>2022</td><td>2022-660004451</td><td>BAKER, MICHAEL A &amp;</td><td>93</td><td>165,266</td><td>0</td><td>17,527</td><td>1,738.00</td></tr> <tr><td>2021</td><td>2021-660004451</td><td>BAKER, MICHAEL A &amp;</td><td>93</td><td>154,968</td><td>0</td><td>16,692</td><td>1,683.00</td></tr> <tr><td>2020</td><td>2020-660004451</td><td>BAKER, MICHAEL A &amp;</td><td>93</td><td>152,733</td><td>0</td><td>15,897</td><td>1,553.00</td></tr> <tr><td>2019</td><td>2019-660004451</td><td>BAKER, MICHAEL A &amp;</td><td>93</td><td>147,244</td><td>0</td><td>15,140</td><td>1,508.00</td></tr> <tr><td>2018</td><td>2018-660004451</td><td>BAKER, MICHAEL A &amp;</td><td>93</td><td>152,269</td><td>0</td><td>14,419</td><td>1,437.00</td></tr> <tr><td>2017</td><td>2017-660004451</td><td>BAKER, MICHAEL A &amp;</td><td>93</td><td>151,411</td><td>0</td><td>13,732</td><td>1,299.00</td></tr> <tr><td>2016</td><td>2016-660004451</td><td>BAKER, MICHAEL A &amp;</td><td>93</td><td>147,984</td><td>0</td><td>13,079</td><td>1,286.00</td></tr> <tr><td>2015</td><td>2015-660004451</td><td>BAKER, MICHAEL A &amp;</td><td>93</td><td>145,049</td><td>0</td><td>12,456</td><td>1,214.00</td></tr> <tr><td>2014</td><td>2014-660004451</td><td>BAKER, MICHAEL A &amp;</td><td>93</td><td>146,946</td><td>0</td><td>11,863</td><td>1,137.00</td></tr> <tr><td>2013</td><td>2013-660004451</td><td>BAKER, MICHAEL A &amp;</td><td>93</td><td>133,334</td><td>0</td><td>10,688</td><td>1,038.00</td></tr> </tbody> </table>										Tax Year	Statement Number	Billed Owner	Tax Area	Total Value	Exemptions	Taxable Value	Billed Tax	2025	2025-660004451	BAKER, MICHAEL A &	93	242,318	0	19,955	1,857.00	2024	2024-660004451	BAKER, MICHAEL A &	93	262,427	0	19,005	1,890.00	2023	2023-660004451	BAKER, MICHAEL A &	93	164,551	0	18,101	1,797.00	2022	2022-660004451	BAKER, MICHAEL A &	93	165,266	0	17,527	1,738.00	2021	2021-660004451	BAKER, MICHAEL A &	93	154,968	0	16,692	1,683.00	2020	2020-660004451	BAKER, MICHAEL A &	93	152,733	0	15,897	1,553.00	2019	2019-660004451	BAKER, MICHAEL A &	93	147,244	0	15,140	1,508.00	2018	2018-660004451	BAKER, MICHAEL A &	93	152,269	0	14,419	1,437.00	2017	2017-660004451	BAKER, MICHAEL A &	93	151,411	0	13,732	1,299.00	2016	2016-660004451	BAKER, MICHAEL A &	93	147,984	0	13,079	1,286.00	2015	2015-660004451	BAKER, MICHAEL A &	93	145,049	0	12,456	1,214.00	2014	2014-660004451	BAKER, MICHAEL A &	93	146,946	0	11,863	1,137.00	2013	2013-660004451	BAKER, MICHAEL A &	93	133,334	0	10,688	1,038.00
Tax Year	Statement Number	Billed Owner	Tax Area	Total Value	Exemptions	Taxable Value	Billed Tax																																																																																																																		
2025	2025-660004451	BAKER, MICHAEL A &	93	242,318	0	19,955	1,857.00																																																																																																																		
2024	2024-660004451	BAKER, MICHAEL A &	93	262,427	0	19,005	1,890.00																																																																																																																		
2023	2023-660004451	BAKER, MICHAEL A &	93	164,551	0	18,101	1,797.00																																																																																																																		
2022	2022-660004451	BAKER, MICHAEL A &	93	165,266	0	17,527	1,738.00																																																																																																																		
2021	2021-660004451	BAKER, MICHAEL A &	93	154,968	0	16,692	1,683.00																																																																																																																		
2020	2020-660004451	BAKER, MICHAEL A &	93	152,733	0	15,897	1,553.00																																																																																																																		
2019	2019-660004451	BAKER, MICHAEL A &	93	147,244	0	15,140	1,508.00																																																																																																																		
2018	2018-660004451	BAKER, MICHAEL A &	93	152,269	0	14,419	1,437.00																																																																																																																		
2017	2017-660004451	BAKER, MICHAEL A &	93	151,411	0	13,732	1,299.00																																																																																																																		
2016	2016-660004451	BAKER, MICHAEL A &	93	147,984	0	13,079	1,286.00																																																																																																																		
2015	2015-660004451	BAKER, MICHAEL A &	93	145,049	0	12,456	1,214.00																																																																																																																		
2014	2014-660004451	BAKER, MICHAEL A &	93	146,946	0	11,863	1,137.00																																																																																																																		
2013	2013-660004451	BAKER, MICHAEL A &	93	133,334	0	10,688	1,038.00																																																																																																																		



# Rogers

## Assessment Property Record Card for Tax Year 2026

Data provided by LISA DELOZIER County Assessor

Date 04/17/2026  
 Time 12:18:48  
 Page 2

Lot Data	Square-Foot - NBHD 1070 #1	Primary Image
<b>Lot Size</b> <b>Lot Count</b> <b>Units Buildable</b> 5500 <b>Non-Ag Acres</b> 2.2895 <b>Topography</b> <b>Street Access</b> <b>Utilities</b> <b>Amenities</b> LAND QUALITY 0 0 <b>Method</b> Square-Foot <b>Base Lot Value</b> 99,730.00 x .93 = 92,737 <b>Factor Value</b> <b>Adjustments</b> 1.0000 <b>Lot Value</b> 92,737		

Residential Data	
<b>Type</b>	1 Single Family Residence
<b>Condition</b>	3 - Average
<b>Quality</b>	2 - Fair
<b>Architecture</b>	DMH LOWER VALUED MH
<b>Style</b>	100% One Story
<b>Exterior Wall</b>	100% Frame, Siding, Metal
<b>Base/Total Area</b>	2,400 / 2,400
<b>Style</b>	100% One Story
<b>HVAC</b>	100% Warmed & Cooled Air
<b>Roof Cover</b>	4 Metal, Preformed
<b>Area on Slab</b>	2,400
<b>Fixture/RghIn</b>	4 /
<b>Bed/F/H Bath</b>	3 / 1.0 /
<b>Basement Area</b>	
<b>Garage Type</b>	800 Attached Garage - Unfinished
<b>Remodel</b>	
<b>Year/Eff Age</b>	1999 / 20

GRM Approach
<b>GRM Code</b> <b>Gross Rent</b> 0.00 <b>Indicated Value</b>

Multiple Regression
<b>MRA Code</b> 1 Test <b>Adusted R</b> 0.8445 <b>Indicated Value</b> 262,516 109.38 Per SqFt

Direct Comparables
<b>Selection Model</b> A Adam Test <b>Adjustment Model</b> 1 2022 Residential <b>Comparables</b> 1 <b>Indicated Value</b> 4,840 Per SqFt

Cost Approach				Manual : 01/2025			
<b>Base Cost</b>	53.35	<b>Total Misc Impr</b>	+ 8,154	<b>Roofing Adj</b>	+ 4.03	<b>Garage Cost</b>	+ 17,448
<b>Subfloor Adj</b>	+ 0.00	<b>Total RCN</b>	= 193,050	<b>Heat/Cool Adj</b>	+ 10.30	<b>Depreciation ( 27%)</b>	- 52,124
<b>Plumbing Adj</b>	+ 2.09	<b>Lump Sums</b>	+ 0	<b>Basement Adj</b>	+ 0.00	<b>RCNLD</b>	= 140,926
<b>Adj Base Cost</b>	= 69.77	<b>Lot Value</b>	+ 92,737	<b>Total Area</b>	x 2,400	<b>Indicated Value</b>	= 233,663
		<b>Value Per SqFt</b>	97.36	<b>Adjusted Cost</b>	= 167,448		

Value Reconciliation
<b>Selected Approach</b> Cost Approach <b>Improvements</b> 140,926 <b>Lot Value</b> 92,737 <b>Indicated Value</b> 233,663 97.36 Per SqFt <b>Agland Value</b> <b>Site Improvements</b> 26,078 <b>Total Value</b> 259,741 108.23 Total Value Per SqFt

Miscellaneous Improvements								
Code	Description	Sketch ID	Size	Year	Units	Unit Cost	Depr	Value
PRCH	SLAB PORCH - COVERED	149335	6x4		24	21.22		509
PATO	SLAB PORCH - OPEN	149336	20x20		400	7.67		3,068
FPR1	FIREPLACE - RESIDENTIAL 1 STORY		1		1	4,576.55		4,577



# Rogers

## Assessment Property Record Card for Tax Year 2026

Data provided by LISA DELOZIER County Assessor

Date 04/17/2026  
 Time 12:18:48  
 Page 3

### Sketch Image

660004451

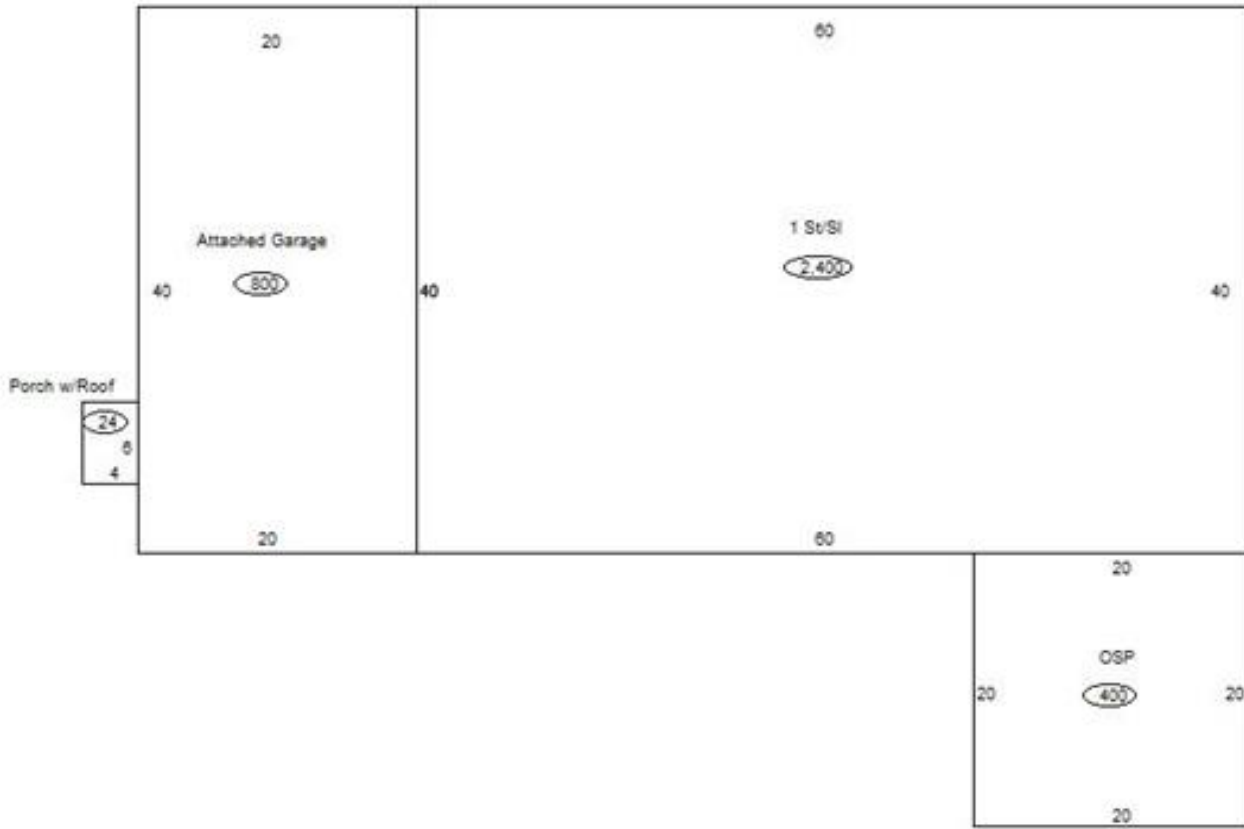

### Sketch Vector Information

Sequence	Code	Type	Built Over	Scale	Section Label	Base Area	Multiplier	Total Area
1	R	1	Slab	13	1 St/Sl	2,400	1.000	2,400
2	G	1		13	Attached Garage	800	1.000	800
3	M	PRCH		13	SLBC	24	1.000	24
4	M	PATO		13	Open Slab	400	1.000	400
<b>Total Building Area</b>						2,400		2,400



# Rogers



## Assessment Property Record Card for Tax Year 2026

Data provided by LISA DELOZIER County Assessor

Date 04/17/2026  
 Time 12:18:48  
 Page 4

660004451

### Outbuildings/Site Improvements

Building Image	Code	Description	Dimensions	Floor	Roofing	Total Units	
	LNT0	Lean To - Attached	30x14x10	Dirt	Formed Metal	420	
	Qual	3	Cond 3	Year 2025	Eff Age 1		
	<b>Valuation Summary</b>		<b>Modifier Total</b>		<b>RCN</b>	<b>Depr (6% Phys/ % Func)</b>	<b>RCNLD</b>
	Base Cost (9.03 x 420)		3,793		3,793	228	3,565
	LNT0	Lean To - Attached	30x12x10	Dirt	Formed Metal	360	
	Qual	3	Cond 3	Year 2025	Eff Age 1		
	<b>Valuation Summary</b>		<b>Modifier Total</b>		<b>RCN</b>	<b>Depr (6% Phys/ % Func)</b>	<b>RCNLD</b>
	Base Cost (9.14 x 360)		3,290		3,290	197	3,093
	UTIL	SHOP BUILDING	24x30x0			720	
	Qual	2	Cond 3	Year 2013	Eff Age 10		
	<b>Valuation Summary</b>		<b>Modifier Total</b>		<b>RCN</b>	<b>Depr (10% Phys/ % Func)</b>	<b>RCNLD</b>
	Base Cost (29.97 x 720)		21,578		21,578	2,158	19,420