



Rogers

Assessment Property Record Card for Tax Year 2026

Data provided by LISA DELOZIER County Assessor

Date 04/18/2026
 Time 06:34:42
 Page 1

Assessment Data					Primary Image																																																																																																																			
Account 660004462 Parcel ID 000000-00-0-00525-002-0023 Cadastral ID 05-21-17-01995 Property Type REAL - Real Property Property Class RRP VI Area 3 Tax Area 93 - JUSTUS/TRI-DISTRICT FIRE Name ID 330058 HORN, DELBERT J & TRACY L LONON 19324 COTTRELL DR CLAREMORE OK 74019-0000 Parcel Location Situs 19324 S COTTRELL DR Subdivision MOUNTAIN MEADOWS Lot/Block 0023 / 0002 Parcel Size 1 - Lots Sec/Twn/Rng 5 / 21 / 17 / 5 Neighborhood 1070 - R-V03-SE JUSTUS-SEQUOYAH School District S009 - JUSTUS-TIAWAH SCHOOLS					<p style="text-align: right; color: orange;">03/24/2021 13:01</p> <p>\\tsclient\VRANDY\RANDY VISUAL INSPECTION\2021-3-24\IMG_ 3/25/2021</p>																																																																																																																			
Legal Description Lat/Long: 36.33116736 -95.51969956 PT LOT 23 BLOCK 2 DESC AS BEG; SW/C LOT 22, N 338.99', S 72- 45 W 390.66' S 25-03 E 200' TO SW/C LOT 23, SELY TO POB MOUNTAIN MEADOWS																																																																																																																								
Exemptions <table border="1"> <thead> <tr> <th>Code</th> <th>Type</th> <th>Active</th> <th>Maximum</th> <th>Exemption</th> </tr> </thead> <tbody> <tr> <td>H</td> <td>Homestead</td> <td>Yes</td> <td>1,000</td> <td>1,000</td> </tr> </tbody> </table>					Code	Type	Active	Maximum	Exemption	H	Homestead	Yes	1,000	1,000	Building Permits <table border="1"> <thead> <tr> <th>Number</th> <th>Description</th> <th>Opened</th> <th>Closed</th> <th>Amount</th> </tr> </thead> <tbody> <tr> <td></td> <td></td> <td></td> <td></td> <td></td> </tr> </tbody> </table>					Number	Description	Opened	Closed	Amount																																																																																																
Code	Type	Active	Maximum	Exemption																																																																																																																				
H	Homestead	Yes	1,000	1,000																																																																																																																				
Number	Description	Opened	Closed	Amount																																																																																																																				
Parcel Valuation <table border="1"> <thead> <tr> <th>Source</th> <th>REAL</th> <th>Fair Cash</th> <th>Capped</th> <th>Asmnt Level</th> <th>Assessed</th> <th>Levy Rate</th> <th>93.050</th> <th>Current Tax</th> </tr> </thead> <tbody> <tr> <td>Remove Cap</td> <td>2021</td> <td>Land Value</td> <td>90,126</td> <td>36,254</td> <td>11%</td> <td>3,988</td> <td>Assessed</td> <td>27,699 2,577.39</td> </tr> <tr> <td>Year Frozen</td> <td>0</td> <td>Improvements</td> <td>229,920</td> <td>215,555</td> <td></td> <td>23,711</td> <td>Penalty</td> <td>0</td> </tr> <tr> <td>Uncapped Value</td> <td>0</td> <td>Mobile Home</td> <td>0</td> <td>0</td> <td></td> <td>0</td> <td>Exemption</td> <td>1,000 -83.00</td> </tr> <tr> <td>TIF Project ID</td> <td>0</td> <td>Total Value</td> <td>320,046</td> <td>251,809</td> <td></td> <td>27,699</td> <td>Total Taxable</td> <td>26,699 2,494.00</td> </tr> </tbody> </table>					Source	REAL	Fair Cash	Capped	Asmnt Level	Assessed	Levy Rate	93.050	Current Tax	Remove Cap	2021	Land Value	90,126	36,254	11%	3,988	Assessed	27,699 2,577.39	Year Frozen	0	Improvements	229,920	215,555		23,711	Penalty	0	Uncapped Value	0	Mobile Home	0	0		0	Exemption	1,000 -83.00	TIF Project ID	0	Total Value	320,046	251,809		27,699	Total Taxable	26,699 2,494.00	Sale History <table border="1"> <thead> <tr> <th>Bk/Pg</th> <th>Grantor</th> <th>Date</th> <th>Price</th> <th>Code</th> </tr> </thead> <tbody> <tr> <td>/</td> <td>AYERS, SUE</td> <td>02/12/2020</td> <td>175,000</td> <td>19</td> </tr> <tr> <td>2174/280</td> <td>BANK OF NEW YORK MELLON</td> <td>05/04/2011</td> <td>120,500</td> <td>3</td> </tr> <tr> <td>2148/108</td> <td>ESTEP, BILL R &</td> <td>12/16/2010</td> <td>0</td> <td>10</td> </tr> <tr> <td>1000/37</td> <td>STIMSON, TERRANCE J &</td> <td>08/25/1995</td> <td>11,000</td> <td>Yes</td> </tr> <tr> <td>858/699</td> <td></td> <td></td> <td>30,000</td> <td>No</td> </tr> </tbody> </table>					Bk/Pg	Grantor	Date	Price	Code	/	AYERS, SUE	02/12/2020	175,000	19	2174/280	BANK OF NEW YORK MELLON	05/04/2011	120,500	3	2148/108	ESTEP, BILL R &	12/16/2010	0	10	1000/37	STIMSON, TERRANCE J &	08/25/1995	11,000	Yes	858/699			30,000	No																																				
Source	REAL	Fair Cash	Capped	Asmnt Level	Assessed	Levy Rate	93.050	Current Tax																																																																																																																
Remove Cap	2021	Land Value	90,126	36,254	11%	3,988	Assessed	27,699 2,577.39																																																																																																																
Year Frozen	0	Improvements	229,920	215,555		23,711	Penalty	0																																																																																																																
Uncapped Value	0	Mobile Home	0	0		0	Exemption	1,000 -83.00																																																																																																																
TIF Project ID	0	Total Value	320,046	251,809		27,699	Total Taxable	26,699 2,494.00																																																																																																																
Bk/Pg	Grantor	Date	Price	Code																																																																																																																				
/	AYERS, SUE	02/12/2020	175,000	19																																																																																																																				
2174/280	BANK OF NEW YORK MELLON	05/04/2011	120,500	3																																																																																																																				
2148/108	ESTEP, BILL R &	12/16/2010	0	10																																																																																																																				
1000/37	STIMSON, TERRANCE J &	08/25/1995	11,000	Yes																																																																																																																				
858/699			30,000	No																																																																																																																				
Assessment History <table border="1"> <thead> <tr> <th>Tax Year</th> <th>Statement Number</th> <th>Billed Owner</th> <th>Tax Area</th> <th>Total Value</th> <th>Exemptions</th> <th>Taxable Value</th> <th>Billed Tax</th> </tr> </thead> <tbody> <tr><td>2025</td><td>2025-660004462</td><td>HORN, DELBERT J &</td><td>93</td><td>317,329</td><td>1000</td><td>25,892</td><td>2,419.00</td></tr> <tr><td>2024</td><td>2024-660004462</td><td>HORN, DELBERT J &</td><td>93</td><td>344,466</td><td>1000</td><td>25,109</td><td>2,513.00</td></tr> <tr><td>2023</td><td>2023-660004462</td><td>HORN, DELBERT J &</td><td>93</td><td>239,699</td><td>1000</td><td>24,349</td><td>2,434.00</td></tr> <tr><td>2022</td><td>2022-660004462</td><td>HORN, DELBERT J &</td><td>93</td><td>239,692</td><td>1000</td><td>23,610</td><td>2,358.00</td></tr> <tr><td>2021</td><td>2021-660004462</td><td>HORN, DELBERT J &</td><td>93</td><td>217,215</td><td>1000</td><td>22,894</td><td>2,324.00</td></tr> <tr><td>2020</td><td>2020-660004462</td><td>HORN, DELBERT J &</td><td>93</td><td>215,687</td><td>1000</td><td>22,726</td><td>2,232.00</td></tr> <tr><td>2019</td><td>2019-660004462</td><td>AYERS, SUE</td><td>93</td><td>226,638</td><td>1000</td><td>23,930</td><td>2,396.00</td></tr> <tr><td>2018</td><td>2018-660004462</td><td>AYERS, SUE</td><td>93</td><td>233,053</td><td>1000</td><td>24,636</td><td>2,469.00</td></tr> <tr><td>2017</td><td>2017-660004462</td><td>AYERS, SUE</td><td>93</td><td>231,101</td><td>1000</td><td>24,421</td><td>2,322.00</td></tr> <tr><td>2016</td><td>2016-660004462</td><td>AYERS, SUE</td><td>93</td><td>224,999</td><td>1000</td><td>23,750</td><td>2,348.00</td></tr> <tr><td>2015</td><td>2015-660004462</td><td>AYERS, SUE</td><td>93</td><td>220,300</td><td>1000</td><td>23,233</td><td>2,278.00</td></tr> <tr><td>2014</td><td>2014-660004462</td><td>AYERS, SUE</td><td>93</td><td>224,125</td><td>1000</td><td>22,591</td><td>2,175.00</td></tr> <tr><td>2013</td><td>2013-660004462</td><td>AYERS, SUE</td><td>93</td><td>210,821</td><td>1000</td><td>21,904</td><td>2,137.00</td></tr> </tbody> </table>									Tax Year	Statement Number	Billed Owner	Tax Area	Total Value	Exemptions	Taxable Value	Billed Tax	2025	2025-660004462	HORN, DELBERT J &	93	317,329	1000	25,892	2,419.00	2024	2024-660004462	HORN, DELBERT J &	93	344,466	1000	25,109	2,513.00	2023	2023-660004462	HORN, DELBERT J &	93	239,699	1000	24,349	2,434.00	2022	2022-660004462	HORN, DELBERT J &	93	239,692	1000	23,610	2,358.00	2021	2021-660004462	HORN, DELBERT J &	93	217,215	1000	22,894	2,324.00	2020	2020-660004462	HORN, DELBERT J &	93	215,687	1000	22,726	2,232.00	2019	2019-660004462	AYERS, SUE	93	226,638	1000	23,930	2,396.00	2018	2018-660004462	AYERS, SUE	93	233,053	1000	24,636	2,469.00	2017	2017-660004462	AYERS, SUE	93	231,101	1000	24,421	2,322.00	2016	2016-660004462	AYERS, SUE	93	224,999	1000	23,750	2,348.00	2015	2015-660004462	AYERS, SUE	93	220,300	1000	23,233	2,278.00	2014	2014-660004462	AYERS, SUE	93	224,125	1000	22,591	2,175.00	2013	2013-660004462	AYERS, SUE	93	210,821	1000	21,904	2,137.00
Tax Year	Statement Number	Billed Owner	Tax Area	Total Value	Exemptions	Taxable Value	Billed Tax																																																																																																																	
2025	2025-660004462	HORN, DELBERT J &	93	317,329	1000	25,892	2,419.00																																																																																																																	
2024	2024-660004462	HORN, DELBERT J &	93	344,466	1000	25,109	2,513.00																																																																																																																	
2023	2023-660004462	HORN, DELBERT J &	93	239,699	1000	24,349	2,434.00																																																																																																																	
2022	2022-660004462	HORN, DELBERT J &	93	239,692	1000	23,610	2,358.00																																																																																																																	
2021	2021-660004462	HORN, DELBERT J &	93	217,215	1000	22,894	2,324.00																																																																																																																	
2020	2020-660004462	HORN, DELBERT J &	93	215,687	1000	22,726	2,232.00																																																																																																																	
2019	2019-660004462	AYERS, SUE	93	226,638	1000	23,930	2,396.00																																																																																																																	
2018	2018-660004462	AYERS, SUE	93	233,053	1000	24,636	2,469.00																																																																																																																	
2017	2017-660004462	AYERS, SUE	93	231,101	1000	24,421	2,322.00																																																																																																																	
2016	2016-660004462	AYERS, SUE	93	224,999	1000	23,750	2,348.00																																																																																																																	
2015	2015-660004462	AYERS, SUE	93	220,300	1000	23,233	2,278.00																																																																																																																	
2014	2014-660004462	AYERS, SUE	93	224,125	1000	22,591	2,175.00																																																																																																																	
2013	2013-660004462	AYERS, SUE	93	210,821	1000	21,904	2,137.00																																																																																																																	



Rogers

Assessment Property Record Card for Tax Year 2026

Data provided by LISA DELOZIER County Assessor

Date 04/18/2026
Time 06:34:42
Page 2

Lot Data	Square-Foot - NBHD 1070 #1	Primary Image
Lot Size		
Lot Count		
Units Buildable	11000	
Non-Ag Acres	1.938	
Topography		
Street Access		
Utilities		
Amenities	LAND QUALITY	
	0	
	0	
Method	Square-Foot	
Base Lot Value	84,419.00 x 1.07 = 90,126	
Factor Value		
Adjustments	1.0000	
Lot Value	90,126	

Residential Data	
Type	1 Single Family Residence
Condition	3 - Average
Quality	3 - Average
Architecture	
Style	100% 1 1/2 Story Finished
Exterior Wall	100% Frame, Siding, Vinyl
Base/Total Area	1,742 / 2,582
Style	100% 1 1/2 Story Finished
HVAC	100% Warmed & Cooled Air
Roof Cover	1 Composition Shingle
Area on Slab	1,742
Fixture/RghIn	11 /
Bed/F/H Bath	3 / 2.0 /
Basement Area	
Garage Type	546 Attached Garage - Unfinished
Remodel	
Year/Eff Age	1996 / 23

Cost Approach		Manual : 01/2025	
Base Cost	86.53	Total Misc Impr	+ 26,301
Roofing Adj	+ 3.26	Garage Cost	+ 17,068
Subfloor Adj	+ -1.56	Total RCN	= 319,333
Heat/Cool Adj	+ 12.64	Depreciation (28%)	- 89,413
Plumbing Adj	+ 6.01	Lump Sums	+ 0
Basement Adj	+ 0.00	RCNLD	= 229,920
Adj Base Cost	= 106.88	Lot Value	+ 90,126
Total Area	x 2,582	Indicated Value	= 320,046
Adjusted Cost	= 275,964	Value Per SqFt	123.95



\\tsclient\VRANDY\RANDY VISUAL INSPECTION\2021-3-24\IMG_ 3/25/2021

GRM Approach	
GRM Code	
Gross Rent	0.00
Indicated Value	

Multiple Regression			
MRA Code	1	Test	
Adusted R	0.8445		
Indicated Value	282,408	109.38	Per SqFt

Direct Comparables	
Selection Model	A Adam Test
Adjustment Model	1 2022 Residential
Comparables	1
Indicated Value	5,540 Per SqFt

Value Reconciliation			
Selected Approach	Cost Approach		
Improvements	229,920		
Lot Value	90,126		
Indicated Value	320,046	123.95	Per SqFt
Agland Value			
Site Improvements			
Total Value	320,046	123.95	Total Value Per SqFt

Miscellaneous Improvements								
Code	Description	Sketch ID	Size	Year	Units	Unit Cost	Depr	Value
PRCH	SLAB PORCH - COVERED	11577	40x8		320	25.93		8,298
EPSW	ENCLOSED PORCH - SOLID WALL	11578	16x14		224	68.96		15,447
PRCH	SLAB PORCH - COVERED	11579	16x6		96	26.63		2,556



Rogers

Assessment Property Record Card for Tax Year 2026

Data provided by LISA DELOZIER County Assessor

Date 04/18/2026
 Time 06:34:42
 Page 3

Sketch Image

660004462

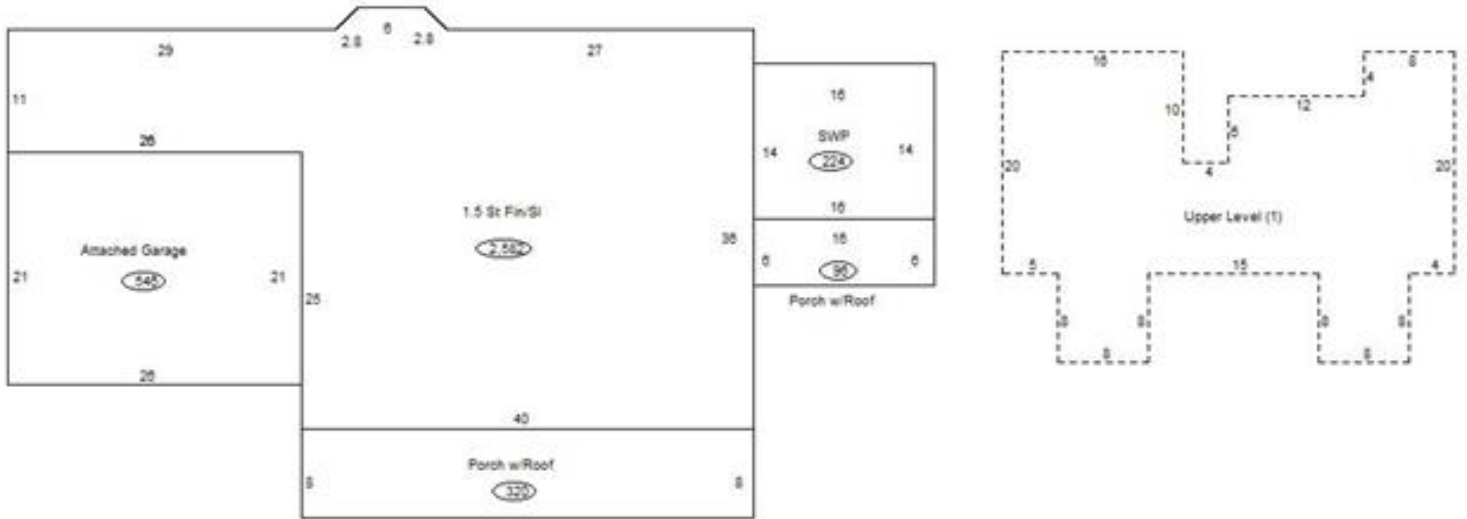

Sketch Vector Information

Sequence	Code	Type	Built Over	Scale	Section Label	Base Area	Multiplier	Total Area
1	R	5	Slab	13	1.5 St Fin/Sl	1,742	1.482	2,582
2	G	1		13	Attached Garage	546	1.000	546
3	M	PRCH		13	SLBC	320	1.000	320
4	M	EPSW		13	EPSW	224	1.000	224
5	M	PRCH		13	SLBC	96	1.000	96
6	U	^UL		13	Upper Level (1)	840	1.000	840
Total Building Area						1,742		2,582