



Rogers

Assessment Property Record Card for Tax Year 2026

Data provided by LISA DELOZIER County Assessor

Date 04/17/2026
 Time 01:54:26
 Page 1

Assessment Data					Primary Image									
Account	660004472													
Parcel ID	000000-00-0-00525-003-0007													
Cadastral ID	05-21-17-02100													
Property Type	REAL - Real Property													
Property Class	RRP	VI Area 3												
Tax Area	93 - JUSTUS/TRI-DISTRICT FIRE													
Name ID	271414													
GOOD, LONNIE R														
19862 MOUNTAIN LN CLAREMORE OK 74019-0000														
Parcel Location														
Situs	19862 MOUNTAIN LN													
Subdivision	MOUNTAIN MEADOWS													
Lot/Block	0007 / 0003	Parcel Size 1 - Lots												
Sec/Twn/Rng	5 / 21 / 17 / 5													
Neighborhood	1070 - R-V03-SE JUSTUS-SEQUOYAH													
School District	S009 - JUSTUS-TIAWAH SCHOOLS													
Legal Description Lat/Long: 36.32500778 -95.51798342														
LOT 7 BLOCK 3 MOUNTAIN MEADOWS														
Building Permits														
<table border="1"> <thead> <tr> <th>Number</th> <th>Description</th> <th>Opened</th> <th>Closed</th> <th>Amount</th> </tr> </thead> <tbody> <tr> <td> </td> <td> </td> <td> </td> <td> </td> <td> </td> </tr> </tbody> </table>					Number	Description	Opened	Closed	Amount					
Number	Description	Opened	Closed	Amount										
Exemptions														
Sale History														
Code	Type	Active	Maximum	Exemption	Bk/Pg	Grantor	Date	Price	Code					
					1175/583	BROCKMAN, JASON L & SARA-WARD	06/07/1999	83,000	Yes					
					1101/415	SMITH, ROBERT LEE JR &	03/04/1998	78,500	Yes					
					909/830	STIMSON, TERRANCE J &	03/26/1993	59,000	Yes					
					873/837		02/13/1992	17,500	No					
Parcel Valuation														
Source	REAL	Fair Cash	Capped	Asmnt Level	Assessed	Levy Rate	93.050	Current Tax						
Remove Cap	2000	Land Value	82,515	45,235	11%	4,976	Assessed	18,462	1,717.89					
Year Frozen	0	Improvements	122,598	122,598		13,486	Penalty	0						
Uncapped Value	0	Mobile Home	0	0		0	Exemption	0	0.00					
TIF Project ID	0	Total Value	205,113	167,833		18,462	Total Taxable	18,462	1,718.00					
Assessment History														
Tax Year	Statement Number	Billed Owner	Tax Area	Total Value	Exemptions	Taxable Value	Billed Tax							
2025	2025-660004472	GOOD, LONNIE R	93	204,237	0	17,582	1,636.00							
2024	2024-660004472	GOOD, LONNIE R	93	226,767	0	16,745	1,665.00							
2023	2023-660004472	GOOD, LONNIE R	93	144,981	0	15,948	1,583.00							
2022	2022-660004472	GOOD, LONNIE R	93	140,643	0	15,471	1,535.00							
2021	2021-660004472	GOOD, LONNIE R	93	139,036	0	15,294	1,542.00							
2020	2020-660004472	GOOD, LONNIE R	93	138,152	0	15,197	1,485.00							
2019	2019-660004472	GOOD, LONNIE R	93	131,908	0	14,510	1,446.00							
2018	2018-660004472	GOOD, LONNIE R	93	136,259	0	14,488	1,444.00							
2017	2017-660004472	GOOD, LONNIE R	93	135,232	0	13,799	1,304.00							
2016	2016-660004472	GOOD, LONNIE R	93	132,094	0	13,141	1,292.00							
2015	2015-660004472	GOOD, LONNIE R	93	129,906	0	12,515	1,220.00							
2014	2014-660004472	GOOD, LONNIE R	93	131,919	0	11,920	1,142.00							
2013	2013-660004472	GOOD, LONNIE R	93	124,948	0	11,353	1,103.00							



Rogers

Assessment Property Record Card for Tax Year 2026

Data provided by LISA DELOZIER County Assessor

Date 04/17/2026
Time 01:54:27
Page 2

Lot Data	Square-Foot - NBHD 1070 #1	Primary Image
Lot Size Lot Count Units Buildable 11000 Non-Ag Acres 1.5886 Topography Street Access Utilities Amenities LAND QUALITY 0 0 Method Square-Foot Base Lot Value 69,198.00 x 1.19 = 82,515 Factor Value Adjustments 1.0000 Lot Value 82,515		

Residential Data	
Type	1 Single Family Residence
Condition	3 - Average
Quality	2.5 - Fair
Architecture	
Style	100% One Story
Exterior Wall	80% Veneer, Masonry 20% Frame, Siding, Wood
Base/Total Area	1,196 / 1,196
Style	100% One Story
HVAC	100% Warmed & Cooled Air
Roof Cover	1 Composition Shingle
Area on Slab	1,196
Fixture/RghIn	11 /
Bed/F/H Bath	3 / 2.0 /
Basement Area	
Garage Type	483 Attached Garage - Unfinished
Remodel	
Year/Eff Age	1992 / 26

GRM Approach
GRM Code Gross Rent 0.00 Indicated Value

Multiple Regression
MRA Code 1 Test Adusted R 0.8445 Indicated Value 155,518 130.03 Per SqFt

Direct Comparables
Selection Model A Adam Test Adjustment Model 1 2022 Residential Comparables 3 Indicated Value 189,020 Per SqFt

Cost Approach				Manual : 01/2025			
Base Cost	104.02	Total Misc Impr	+ 19,118	Roofing Adj	+ 4.46	Garage Cost	+ 13,345
Subfloor Adj	+ -1.16	Total RCN	= 188,613	Heat/Cool Adj	+ 11.47	Depreciation (35%)	- 66,015
Plumbing Adj	+ 11.77	Lump Sums	+ 0	Basement Adj	+ 0.00	RCNLD	= 122,598
Adj Base Cost	= 130.56	Lot Value	+ 82,515	Total Area	x 1,196	Indicated Value	= 205,113
		Value Per SqFt	171.50	Adjusted Cost	= 156,150		

Value Reconciliation
Selected Approach Cost Approach Improvements 122,598 Lot Value 82,515 Indicated Value 205,113 171.50 Per SqFt Agland Value Site Improvements Total Value 205,113 171.50 Total Value Per SqFt

Miscellaneous Improvements								
Code	Description	Sketch ID	Size	Year	Units	Unit Cost	Depr	Value
PRCH	SLAB PORCH - COVERED	11602	23x6		138	23.81		3,286
EPSW	ENCLOSED PORCH - SOLID WALL	11603	20x12		240	61.62		14,789
PATO	SLAB PORCH - OPEN	149379	12x8		96	10.86		1,043



Rogers

Assessment Property Record Card for Tax Year 2026

Data provided by LISA DELOZIER County Assessor

Date 04/17/2026
 Time 01:54:27
 Page 3

Sketch Image

660004472

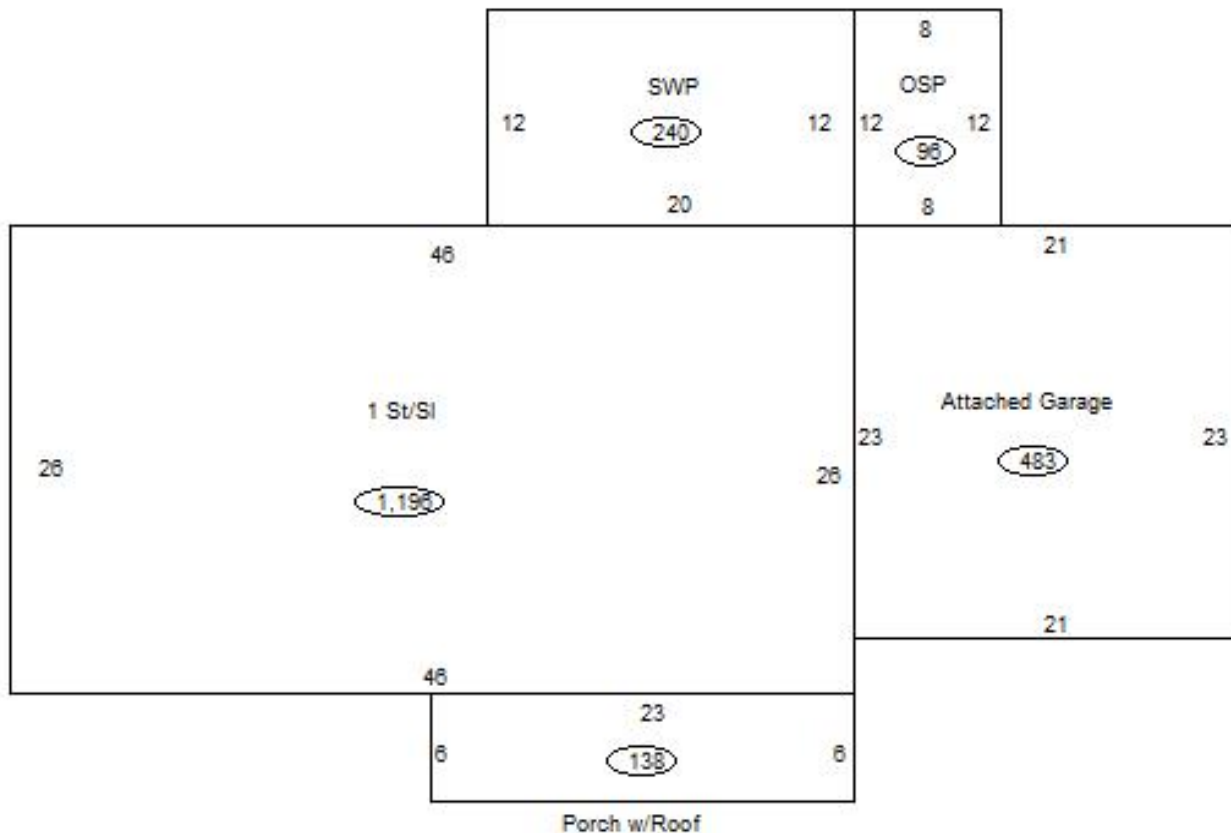

Sketch Vector Information

Sequence	Code	Type	Built Over	Scale	Section Label	Base Area	Multiplier	Total Area
1	R	1	Slab	13	1 St/Sl	1,196	1.000	1,196
2	G	1		13	Attached Garage	483	1.000	483
3	M	PRCH		13	SLBC	138	1.000	138
4	M	EPSW		13	EPSW	240	1.000	240
5	M	PATO		13	Open Slab	96	1.000	96
Total Building Area						1,196		1,196



Rogers

Assessment Property Record Card for Tax Year 2026

Data provided by LISA DELOZIER County Assessor

Date 04/17/2026
Time 01:54:27
Page 4

660004472

Outbuildings/Site Improvements

Building Image	Code	Description	Dimensions	Floor	Roofing	Total Units
	STF	STG FAIR	0x0x0			
	Qual	2	Cond	Year	Eff Age	
Valuation Summary		Modifier Total	RCN	Depr (100% Phys/ % Func)	RCNLD	
Base Cost (4.68 x)						