



Rogers

Assessment Property Record Card for Tax Year 2026

Data provided by LISA DELOZIER County Assessor

Date 04/18/2026
Time 07:42:56
Page 1

Assessment Data				Primary Image																																																																																																																					
Account 660004512 Parcel ID 22N15E-05-1-00000-000-0000 Cadastral ID 05-22-15-00200 Property Type REAL - Real Property Property Class CH VI Area 4 Tax Area 10 - OOLOGAH RURAL/NW FIRE Name ID 199614 OOLOGAH ASSEMBLY OF GOD CHURCH PO BOX 610 OOLOGAH OK 74053-0000 Parcel Location Situs 13462 S HWY 169 Subdivision Lot/Block / Parcel Size 19.97 - Acres Sec/Twn/Rng 5 / 22 / 15 / 1 Neighborhood 5001 - TASC 2016 School District S004 - OOLOGAH SCHOOLS																																																																																																																									
Legal Description Lat/Long: 36.41960573 -95.73173401										REVAL 2023 5/25/2022																																																																																																															
Legal Description TR IN N2 DESC AS; COMM NE/C NW; TH N89-49-33W ALG N/LINE OF NW 660.61' TO A PT ON N/LINE; TH S00-09-50W 1035.64 TO POB; TH S00-09-50W 934.05'; TH N64.11-41E 403.80'; TH S26-12-59E 148.78' TO PT ON N/RLY ROW OF HWY 169; TH N62-39-28E 310'; TH N27-20-32W				Building Permits																																																																																																																					
				<table border="1"> <thead> <tr> <th>Number</th> <th>Description</th> <th>Opened</th> <th>Closed</th> <th>Amount</th> </tr> </thead> <tbody> <tr> <td>C-09-07-02</td> <td>NEW CHURCH-121 X 185</td> <td>07/2009</td> <td>06/2011</td> <td>1,800,000</td> </tr> <tr> <td>R4</td> <td>SPLIT FROM THIS PARCEL R4</td> <td>11/2003</td> <td>10/2005</td> <td></td> </tr> </tbody> </table>						Number	Description	Opened	Closed	Amount	C-09-07-02	NEW CHURCH-121 X 185	07/2009	06/2011	1,800,000	R4	SPLIT FROM THIS PARCEL R4	11/2003	10/2005																																																																																																		
Number	Description	Opened	Closed	Amount																																																																																																																					
C-09-07-02	NEW CHURCH-121 X 185	07/2009	06/2011	1,800,000																																																																																																																					
R4	SPLIT FROM THIS PARCEL R4	11/2003	10/2005																																																																																																																						
Exemptions				Sale History																																																																																																																					
<table border="1"> <thead> <tr> <th>Code</th> <th>Type</th> <th>Active</th> <th>Maximum</th> <th>Exemption</th> </tr> </thead> <tbody> <tr> <td></td> <td></td> <td></td> <td></td> <td></td> </tr> </tbody> </table>				Code	Type	Active	Maximum	Exemption						<table border="1"> <thead> <tr> <th>Bk/Pg</th> <th>Grantor</th> <th>Date</th> <th>Price</th> <th>Code</th> </tr> </thead> <tbody> <tr> <td>1556/188</td> <td>BLACKWELL, JIMMIE CALVIN</td> <td>01/09/2004</td> <td>150,000</td> <td>2</td> </tr> <tr> <td>1118/841</td> <td>PENNER, EVERETT</td> <td>06/26/1998</td> <td>265,000</td> <td>No</td> </tr> </tbody> </table>						Bk/Pg	Grantor	Date	Price	Code	1556/188	BLACKWELL, JIMMIE CALVIN	01/09/2004	150,000	2	1118/841	PENNER, EVERETT	06/26/1998	265,000	No																																																																																							
Code	Type	Active	Maximum	Exemption																																																																																																																					
Bk/Pg	Grantor	Date	Price	Code																																																																																																																					
1556/188	BLACKWELL, JIMMIE CALVIN	01/09/2004	150,000	2																																																																																																																					
1118/841	PENNER, EVERETT	06/26/1998	265,000	No																																																																																																																					
Parcel Valuation																																																																																																																									
<table border="1"> <thead> <tr> <th>Source</th> <th>REAL</th> <th>Fair Cash</th> <th>Capped</th> <th>Asmnt Level</th> <th>Assessed</th> <th>Levy Rate</th> <th>108.182</th> <th>Current Tax</th> </tr> </thead> <tbody> <tr> <td>Remove Cap</td> <td>2005</td> <td>Land Value 282,537</td> <td>0</td> <td>11%</td> <td>0</td> <td>Assessed</td> <td>0</td> <td>0.00</td> </tr> <tr> <td>Year Frozen</td> <td>0</td> <td>Improvements 2,617,794</td> <td>0</td> <td></td> <td>0</td> <td>Penalty</td> <td>0</td> <td></td> </tr> <tr> <td>Uncapped Value</td> <td>0</td> <td>Mobile Home 0</td> <td>0</td> <td></td> <td>0</td> <td>Exemption</td> <td>0</td> <td>0.00</td> </tr> <tr> <td>TIF Project ID</td> <td>0</td> <td>Total Value 2,900,331</td> <td>0</td> <td></td> <td>0</td> <td>Total Taxable</td> <td>0</td> <td>0.00</td> </tr> </tbody> </table>		Source	REAL	Fair Cash	Capped	Asmnt Level	Assessed	Levy Rate	108.182	Current Tax	Remove Cap	2005	Land Value 282,537	0	11%	0	Assessed	0	0.00	Year Frozen	0	Improvements 2,617,794	0		0	Penalty	0		Uncapped Value	0	Mobile Home 0	0		0	Exemption	0	0.00	TIF Project ID	0	Total Value 2,900,331	0		0	Total Taxable	0	0.00																																																																											
Source	REAL	Fair Cash	Capped	Asmnt Level	Assessed	Levy Rate	108.182	Current Tax																																																																																																																	
Remove Cap	2005	Land Value 282,537	0	11%	0	Assessed	0	0.00																																																																																																																	
Year Frozen	0	Improvements 2,617,794	0		0	Penalty	0																																																																																																																		
Uncapped Value	0	Mobile Home 0	0		0	Exemption	0	0.00																																																																																																																	
TIF Project ID	0	Total Value 2,900,331	0		0	Total Taxable	0	0.00																																																																																																																	
Assessment History																																																																																																																									
<table border="1"> <thead> <tr> <th>Tax Year</th> <th>Statement Number</th> <th>Billed Owner</th> <th>Tax Area</th> <th>Total Value</th> <th>Exemptions</th> <th>Taxable Value</th> <th>Billed Tax</th> </tr> </thead> <tbody> <tr><td>2025</td><td>2025-660004512</td><td>OOLOGAH ASSEMBLY OF GOD CHURCH</td><td>10</td><td>2,868,664</td><td>0</td><td></td><td>.00</td></tr> <tr><td>2024</td><td>2024-660004512</td><td>OOLOGAH ASSEMBLY OF GOD CHURCH</td><td>10</td><td>2,446,303</td><td>0</td><td></td><td>.00</td></tr> <tr><td>2023</td><td>2023-660004512</td><td>OOLOGAH ASSEMBLY OF GOD CHURCH</td><td>10</td><td>2,756,660</td><td>0</td><td></td><td>.00</td></tr> <tr><td>2022</td><td>2022-660004512</td><td>OOLOGAH ASSEMBLY OF GOD CHURCH</td><td>10</td><td>2,311,319</td><td>0</td><td></td><td>.00</td></tr> <tr><td>2021</td><td>2021-660004512</td><td>OOLOGAH ASSEMBLY OF GOD CHURCH</td><td>10</td><td>2,311,319</td><td>0</td><td></td><td>.00</td></tr> <tr><td>2020</td><td>2020-660004512</td><td>OOLOGAH ASSEMBLY OF GOD CHURCH</td><td>10</td><td>2,311,319</td><td>0</td><td></td><td>.00</td></tr> <tr><td>2019</td><td>2019-660004512</td><td>OOLOGAH ASSEMBLY OF GOD CHURCH</td><td>10</td><td>2,311,319</td><td>0</td><td></td><td>.00</td></tr> <tr><td>2018</td><td>2018-660004512</td><td>OOLOGAH ASSEMBLY OF GOD CHURCH</td><td>10</td><td>2,283,781</td><td>0</td><td></td><td>.00</td></tr> <tr><td>2017</td><td>2017-660004512</td><td>OOLOGAH ASSEMBLY OF GOD CHURCH</td><td>10</td><td>2,283,781</td><td>0</td><td></td><td>.00</td></tr> <tr><td>2016</td><td>2016-660004512</td><td>OOLOGAH ASSEMBLY OF GOD CHURCH</td><td>10</td><td>2,132,962</td><td>0</td><td></td><td>.00</td></tr> <tr><td>2015</td><td>2015-660004512</td><td>OOLOGAH ASSEMBLY OF GOD CHURCH</td><td>10</td><td>2,132,962</td><td>0</td><td></td><td>.00</td></tr> <tr><td>2014</td><td>2014-660004512</td><td>OOLOGAH ASSEMBLY OF GOD CHURCH</td><td>10</td><td>2,132,962</td><td>0</td><td></td><td>.00</td></tr> <tr><td>2013</td><td>2013-660004512</td><td>OOLOGAH ASSEMBLY OF GOD CHURCH</td><td>10</td><td>1,907,227</td><td>0</td><td></td><td>.00</td></tr> </tbody> </table>										Tax Year	Statement Number	Billed Owner	Tax Area	Total Value	Exemptions	Taxable Value	Billed Tax	2025	2025-660004512	OOLOGAH ASSEMBLY OF GOD CHURCH	10	2,868,664	0		.00	2024	2024-660004512	OOLOGAH ASSEMBLY OF GOD CHURCH	10	2,446,303	0		.00	2023	2023-660004512	OOLOGAH ASSEMBLY OF GOD CHURCH	10	2,756,660	0		.00	2022	2022-660004512	OOLOGAH ASSEMBLY OF GOD CHURCH	10	2,311,319	0		.00	2021	2021-660004512	OOLOGAH ASSEMBLY OF GOD CHURCH	10	2,311,319	0		.00	2020	2020-660004512	OOLOGAH ASSEMBLY OF GOD CHURCH	10	2,311,319	0		.00	2019	2019-660004512	OOLOGAH ASSEMBLY OF GOD CHURCH	10	2,311,319	0		.00	2018	2018-660004512	OOLOGAH ASSEMBLY OF GOD CHURCH	10	2,283,781	0		.00	2017	2017-660004512	OOLOGAH ASSEMBLY OF GOD CHURCH	10	2,283,781	0		.00	2016	2016-660004512	OOLOGAH ASSEMBLY OF GOD CHURCH	10	2,132,962	0		.00	2015	2015-660004512	OOLOGAH ASSEMBLY OF GOD CHURCH	10	2,132,962	0		.00	2014	2014-660004512	OOLOGAH ASSEMBLY OF GOD CHURCH	10	2,132,962	0		.00	2013	2013-660004512	OOLOGAH ASSEMBLY OF GOD CHURCH	10	1,907,227	0		.00
Tax Year	Statement Number	Billed Owner	Tax Area	Total Value	Exemptions	Taxable Value	Billed Tax																																																																																																																		
2025	2025-660004512	OOLOGAH ASSEMBLY OF GOD CHURCH	10	2,868,664	0		.00																																																																																																																		
2024	2024-660004512	OOLOGAH ASSEMBLY OF GOD CHURCH	10	2,446,303	0		.00																																																																																																																		
2023	2023-660004512	OOLOGAH ASSEMBLY OF GOD CHURCH	10	2,756,660	0		.00																																																																																																																		
2022	2022-660004512	OOLOGAH ASSEMBLY OF GOD CHURCH	10	2,311,319	0		.00																																																																																																																		
2021	2021-660004512	OOLOGAH ASSEMBLY OF GOD CHURCH	10	2,311,319	0		.00																																																																																																																		
2020	2020-660004512	OOLOGAH ASSEMBLY OF GOD CHURCH	10	2,311,319	0		.00																																																																																																																		
2019	2019-660004512	OOLOGAH ASSEMBLY OF GOD CHURCH	10	2,311,319	0		.00																																																																																																																		
2018	2018-660004512	OOLOGAH ASSEMBLY OF GOD CHURCH	10	2,283,781	0		.00																																																																																																																		
2017	2017-660004512	OOLOGAH ASSEMBLY OF GOD CHURCH	10	2,283,781	0		.00																																																																																																																		
2016	2016-660004512	OOLOGAH ASSEMBLY OF GOD CHURCH	10	2,132,962	0		.00																																																																																																																		
2015	2015-660004512	OOLOGAH ASSEMBLY OF GOD CHURCH	10	2,132,962	0		.00																																																																																																																		
2014	2014-660004512	OOLOGAH ASSEMBLY OF GOD CHURCH	10	2,132,962	0		.00																																																																																																																		
2013	2013-660004512	OOLOGAH ASSEMBLY OF GOD CHURCH	10	1,907,227	0		.00																																																																																																																		



Rogers

Assessment Property Record Card for Tax Year 2026

Data provided by LISA DELOZIER County Assessor

Date 04/18/2026
 Time 07:42:56
 Page 2

Lot Data	Primary Image																																										
<table border="0"> <tr><td>Lot Size</td><td>0 x 0</td></tr> <tr><td>Lot Count</td><td>0</td></tr> <tr><td>Units Buildable</td><td>19.97</td></tr> <tr><td>Non-Ag Acres</td><td>19.745</td></tr> <tr><td>Topography</td><td></td></tr> <tr><td>Street Access</td><td></td></tr> <tr><td>Utilities</td><td></td></tr> <tr><td>Amenities</td><td>0</td></tr> <tr><td></td><td>0</td></tr> <tr><td>Value Model</td><td>1835 COMM</td></tr> <tr><td>Value Method</td><td>Square-Foot</td></tr> <tr><td>Base Lot Value</td><td>860,077.00 x .33 = 282,537</td></tr> <tr><td>Factor Value</td><td>0</td></tr> <tr><td>Adjustments</td><td></td></tr> <tr><td>Lot Value</td><td>282,537</td></tr> </table>	Lot Size	0 x 0	Lot Count	0	Units Buildable	19.97	Non-Ag Acres	19.745	Topography		Street Access		Utilities		Amenities	0		0	Value Model	1835 COMM	Value Method	Square-Foot	Base Lot Value	860,077.00 x .33 = 282,537	Factor Value	0	Adjustments		Lot Value	282,537													
Lot Size	0 x 0																																										
Lot Count	0																																										
Units Buildable	19.97																																										
Non-Ag Acres	19.745																																										
Topography																																											
Street Access																																											
Utilities																																											
Amenities	0																																										
	0																																										
Value Model	1835 COMM																																										
Value Method	Square-Foot																																										
Base Lot Value	860,077.00 x .33 = 282,537																																										
Factor Value	0																																										
Adjustments																																											
Lot Value	282,537																																										
<table border="0"> <tr><td colspan="2">Cost Approach</td></tr> <tr><td>Manual Date</td><td>01/2025</td></tr> <tr><td>Total Building Area</td><td>19,985</td></tr> <tr><td>Total Base Value</td><td>2,484,735</td></tr> <tr><td>Modifier Value</td><td></td></tr> <tr><td>Misc Improvements</td><td></td></tr> <tr><td>Replacement Cost New</td><td>2,484,735</td></tr> <tr><td>Phys/Func Depreciation Loss</td><td>()</td></tr> <tr><td>RCN Less Phys/Func</td><td>2,285,956</td></tr> <tr><td>Economic Depreciation</td><td></td></tr> <tr><td>RCNLD (All Sources)</td><td>2,285,956</td></tr> <tr><td>Depreciated Improvements</td><td></td></tr> <tr><td>Outbuilding Value</td><td>331,838</td></tr> <tr><td>Total Improvement Value</td><td>2,617,794</td></tr> <tr><td>Land Value</td><td>282,537</td></tr> <tr><td>Cost Approach Value</td><td>2,900,331 145.13/SqFt</td></tr> </table>	Cost Approach		Manual Date	01/2025	Total Building Area	19,985	Total Base Value	2,484,735	Modifier Value		Misc Improvements		Replacement Cost New	2,484,735	Phys/Func Depreciation Loss	()	RCN Less Phys/Func	2,285,956	Economic Depreciation		RCNLD (All Sources)	2,285,956	Depreciated Improvements		Outbuilding Value	331,838	Total Improvement Value	2,617,794	Land Value	282,537	Cost Approach Value	2,900,331 145.13/SqFt	<table border="0"> <tr><td colspan="2">Image Information</td></tr> <tr><td>Image ID</td><td>999864</td></tr> <tr><td>Image Date</td><td>5/25/2022</td></tr> <tr><td>Name</td><td>IMG_0001.JPG</td></tr> <tr><td>Description</td><td>REVAL 2023</td></tr> </table>	Image Information		Image ID	999864	Image Date	5/25/2022	Name	IMG_0001.JPG	Description	REVAL 2023
Cost Approach																																											
Manual Date	01/2025																																										
Total Building Area	19,985																																										
Total Base Value	2,484,735																																										
Modifier Value																																											
Misc Improvements																																											
Replacement Cost New	2,484,735																																										
Phys/Func Depreciation Loss	()																																										
RCN Less Phys/Func	2,285,956																																										
Economic Depreciation																																											
RCNLD (All Sources)	2,285,956																																										
Depreciated Improvements																																											
Outbuilding Value	331,838																																										
Total Improvement Value	2,617,794																																										
Land Value	282,537																																										
Cost Approach Value	2,900,331 145.13/SqFt																																										
Image Information																																											
Image ID	999864																																										
Image Date	5/25/2022																																										
Name	IMG_0001.JPG																																										
Description	REVAL 2023																																										
<table border="0"> <tr><td colspan="2">Income Approach</td></tr> <tr><td>Potential Gross Income (PGI)</td><td></td></tr> <tr><td>Vacancy & Collection Loss</td><td></td></tr> <tr><td>Miscellaneous Income</td><td></td></tr> <tr><td>Effective Gross Income (EGI)</td><td></td></tr> <tr><td>Total Expenses</td><td></td></tr> <tr><td>Net Operating Income (NOI)</td><td></td></tr> <tr><td>Income Capitalization Rate</td><td></td></tr> <tr><td>Indicated Value</td><td>0.00</td></tr> </table>	Income Approach		Potential Gross Income (PGI)		Vacancy & Collection Loss		Miscellaneous Income		Effective Gross Income (EGI)		Total Expenses		Net Operating Income (NOI)		Income Capitalization Rate		Indicated Value	0.00	<table border="0"> <tr><td colspan="2">Value Reconciliation</td></tr> <tr><td>Selected Valuation Method</td><td>Cost Approach</td></tr> <tr><td>Total Improvement Value</td><td>331,838</td></tr> <tr><td>Land Value</td><td>282,537</td></tr> <tr><td>Total Appraised Value</td><td>2,900,331 145.13/SqFt</td></tr> </table>	Value Reconciliation		Selected Valuation Method	Cost Approach	Total Improvement Value	331,838	Land Value	282,537	Total Appraised Value	2,900,331 145.13/SqFt														
Income Approach																																											
Potential Gross Income (PGI)																																											
Vacancy & Collection Loss																																											
Miscellaneous Income																																											
Effective Gross Income (EGI)																																											
Total Expenses																																											
Net Operating Income (NOI)																																											
Income Capitalization Rate																																											
Indicated Value	0.00																																										
Value Reconciliation																																											
Selected Valuation Method	Cost Approach																																										
Total Improvement Value	331,838																																										
Land Value	282,537																																										
Total Appraised Value	2,900,331 145.13/SqFt																																										



Rogers

Assessment Property Record Card for Tax Year 2026

Data provided by LISA DELOZIER County Assessor

Date 04/18/2026
Time 07:42:56
Page 3

Sketch Image

660004512

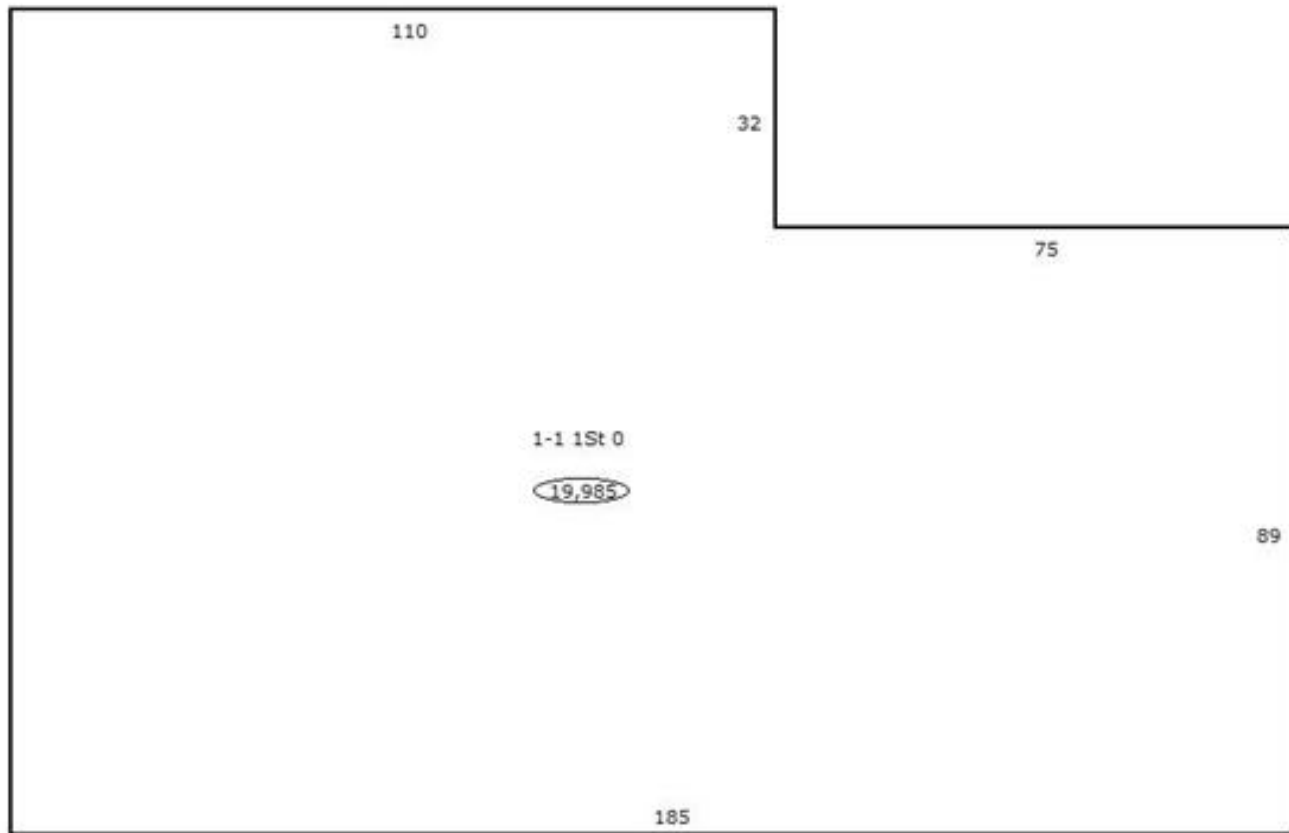

Sketch Vector Information

Sequence	Code	Type	Built Over	Scale	Section Label	Base Area	Multiplier	Total Area
1	C	309		25	1-1 1St 0	19,985	1.000	19,985
2	N	0		25	ALUM CNPY/CS		0.000	
Total Building Area						19,985		19,985



Rogers

Assessment Property Record Card for Tax Year 2026

Data provided by LISA DELOZIER County Assessor

Date 04/18/2026
Time 07:42:56
Page 4

Account 660004512
Parcel ID 22N15E-05-1-00000-000-0000
Cadastral ID 05-22-15-00200

Tax Area Code 10
Property Class CH
Owners Name OOLOGAH ASSEMBLY OF GOD CHURCH

Building Data

Building ID 2676
Building Sequence 1
Occupancy 1 309 Church 100%
Occupancy 2
Occupancy 3
Total Floor Area 19,985
Average Perimeter 612
Number Of Storys 1.00
Average Wall Ht 12.00
Year Built 2006
Effective Age 8
Construction Class 7 - Pre-Engineered Steel Frame
Quality 3 - Average
Condition 4 - Good
Exterior Wall 122 - Single Synth. Plaster on Steel Frame
Heating/Cooling 7 - Package Unit
Roof Type Gable
Roof Cover

Basement Area
Basement Levels
Basement Finish
Finish Code - 1
Finish Area - 1
Finish Code - 2
Finish Area - 2

Building Image



Image Information

Image Name IMG_0001.JPG
Image Date 5/25/2022
Image Name IMG_0001.JPG
Description REVAL 2023

Cost Calculations

Appraisal Zone 4
Zone Description
Base Cost 90.41
Wall Cost 10.11
HVAC Cost 23.81
Basement Cost 0.00
Total Base Cost 124.33
Total Area 19,985
Base RCN 2,484,735
Misc Impr Value

Manual Date 01/2025
Base Year 2026
Modifier Value
Total Replacement Cost 2,484,735
Physical Depreciation 8%
Functional Depreciation
Total Depreciation 8% (198,779)
Total RCNLD 2,285,956
Lump Sums
Total Building Value 2,285,956 \$ 114.38 Per SqFt



Rogers

Assessment Property Record Card for Tax Year 2026

Data provided by LISA DELOZIER County Assessor

Date 04/18/2026

Time 07:42:57

Page 5

660004512

Outbuildings/Site Improvements

Building Image	Code	Description	Dimensions	Floor	Roofing	Total Units
	FLV	ALUM CANOPY 24*40	0x0x0			10,368
	Qual	Cond	Year	Eff Age		
		Valuation Summary	Modifier Total	RCN	Depr (% Phys/ % Func)	RCNLD
		Base Cost (1.00 x 10,368)		10,368	518	9,850
	FLV	CONC SLAB 24*40	0x0x0			4,800
	Qual	Cond	Year	Eff Age		
		Valuation Summary	Modifier Total	RCN	Depr (% Phys/ % Func)	RCNLD
		Base Cost (1.00 x 4,800)		4,800	240	4,560
	FLV	SODIUM LIGHTS (8)	0x0x0			10,120
	Qual	Cond	Year	Eff Age		
		Valuation Summary	Modifier Total	RCN	Depr (% Phys/ % Func)	RCNLD
		Base Cost (1.00 x 10,120)		10,120	506	9,614
	FLV	MTL LIGHT POLES 2 @ 20'	0x0x0			2,800
	Qual	Cond	Year	Eff Age		
		Valuation Summary	Modifier Total	RCN	Depr (% Phys/ % Func)	RCNLD
		Base Cost (1.00 x 2,800)		2,800	140	2,660
	FLV	TIME & TEMP DBL SIDE 7*12	0x0x0			19,350
	Qual	Cond	Year	Eff Age		
		Valuation Summary	Modifier Total	RCN	Depr (% Phys/ % Func)	RCNLD
		Base Cost (1.00 x 19,350)		19,350	968	18,382
	FLV	CONTINUOUS DISPLAY	0x0x0			6,250
	Qual	Cond	Year	Eff Age		
		Valuation Summary	Modifier Total	RCN	Depr (% Phys/ % Func)	RCNLD
		Base Cost (1.00 x 6,250)		6,250	313	5,937
	FLV	DBL F PLASTIC SIGN 6*12	0x0x0			10,080
	Qual	Cond	Year	Eff Age		
		Valuation Summary	Modifier Total	RCN	Depr (% Phys/ % Func)	RCNLD
		Base Cost (1.00 x 10,080)		10,080	504	9,576



Rogers

Assessment Property Record Card for Tax Year 2026

Data provided by LISA DELOZIER County Assessor

Date 04/18/2026
Time 07:42:57
Page 6

PACN	PAVING - CONCRETE	0x0x0			63,858
Qual	Cond	Year	Eff Age		

	Valuation Summary	Modifier Total	RCN	Depr (% Phys/ % Func)	RCNLD
	Base Cost (4.42 x 63,858)		282,252	14,113	268,139
FLV	FR OUT BLDGS 2 @ 13*24 @ 5.00SF	0x0x0			3,120
Qual	Cond	Year	Eff Age		

	Valuation Summary	Modifier Total	RCN	Depr (% Phys/ % Func)	RCNLD
	Base Cost (1.00 x 3,120)		3,120		3,120

	Total Site Improvement Value	331,838
--	-------------------------------------	----------------