



Rogers

Assessment Property Record Card for Tax Year 2026

Data provided by LISA DELOZIER County Assessor

Date 04/17/2026
Time 02:13:49
Page 1

Assessment Data					Primary Image																																																																																																																				
Account 660004524 Parcel ID 22N15E-05-2-00000-000-0000 Cadastral ID 05-22-15-01310 Property Type REAL - Real Property Property Class RR VI Area 4 Tax Area 10 - OOLOGAH RURAL/NW FIRE Name ID 275661 JORDAN, KENNETH W & PAULA V 5144 E 410 RD OOLOGAH OK 74053-0000 Parcel Location Situs 05144 E 410 RD Subdivision Lot/Block / Parcel Size 2.5 - Acres Sec/Twn/Rng 5 / 22 / 15 / 2 Neighborhood 6010 - UNPLATTED School District S004 - OOLOGAH SCHOOLS																																																																																																																									
Legal Description Lat/Long: 36.42297130 -95.73760340																																																																																																																									
Legal Description W2 E2 N2 LOT 4 (GOV'T LOT 4 AKA NW NW)					Building Permits <table border="1"> <thead> <tr> <th>Number</th> <th>Description</th> <th>Opened</th> <th>Closed</th> <th>Amount</th> </tr> </thead> <tbody> <tr> <td> </td> <td> </td> <td> </td> <td> </td> <td> </td> </tr> </tbody> </table>					Number	Description	Opened	Closed	Amount																																																																																																											
Number	Description	Opened	Closed	Amount																																																																																																																					
Exemptions <table border="1"> <thead> <tr> <th>Code</th> <th>Type</th> <th>Active</th> <th>Maximum</th> <th>Exemption</th> </tr> </thead> <tbody> <tr> <td>H</td> <td>Homestead</td> <td>Yes</td> <td>1,000</td> <td>1,000</td> </tr> </tbody> </table>					Code	Type	Active	Maximum	Exemption	H	Homestead	Yes	1,000	1,000	Sale History <table border="1"> <thead> <tr> <th>Bk/Pg</th> <th>Grantor</th> <th>Date</th> <th>Price</th> <th>Code</th> </tr> </thead> <tbody> <tr> <td>1259/890</td> <td>TESTERMAN, JOHN R</td> <td>12/05/2000</td> <td>0</td> <td>No</td> </tr> </tbody> </table>					Bk/Pg	Grantor	Date	Price	Code	1259/890	TESTERMAN, JOHN R	12/05/2000	0	No																																																																																												
Code	Type	Active	Maximum	Exemption																																																																																																																					
H	Homestead	Yes	1,000	1,000																																																																																																																					
Bk/Pg	Grantor	Date	Price	Code																																																																																																																					
1259/890	TESTERMAN, JOHN R	12/05/2000	0	No																																																																																																																					
Parcel Valuation <table border="1"> <thead> <tr> <th>Source</th> <th>REAL</th> <th>Fair Cash</th> <th>Capped</th> <th>Asmnt Level</th> <th>Assessed</th> <th>Levy Rate</th> <th>108.182</th> <th>Current Tax</th> </tr> </thead> <tbody> <tr> <td>Remove Cap</td> <td>2001</td> <td>Land Value 42,583</td> <td>29,766</td> <td>11%</td> <td>3,274</td> <td>Assessed</td> <td>11,164</td> <td>1,207.74</td> </tr> <tr> <td>Year Frozen</td> <td>0</td> <td>Improvements 85,248</td> <td>71,729</td> <td></td> <td>7,890</td> <td>Penalty</td> <td>0</td> <td></td> </tr> <tr> <td>Uncapped Value</td> <td>0</td> <td>Mobile Home 0</td> <td>0</td> <td></td> <td>0</td> <td>Exemption</td> <td>1,000</td> <td>-94.00</td> </tr> <tr> <td>TIF Project ID</td> <td>0</td> <td>Total Value 127,831</td> <td>101,495</td> <td></td> <td>11,164</td> <td>Total Taxable</td> <td>10,164</td> <td>1,114.00</td> </tr> </tbody> </table>										Source	REAL	Fair Cash	Capped	Asmnt Level	Assessed	Levy Rate	108.182	Current Tax	Remove Cap	2001	Land Value 42,583	29,766	11%	3,274	Assessed	11,164	1,207.74	Year Frozen	0	Improvements 85,248	71,729		7,890	Penalty	0		Uncapped Value	0	Mobile Home 0	0		0	Exemption	1,000	-94.00	TIF Project ID	0	Total Value 127,831	101,495		11,164	Total Taxable	10,164	1,114.00																																																																			
Source	REAL	Fair Cash	Capped	Asmnt Level	Assessed	Levy Rate	108.182	Current Tax																																																																																																																	
Remove Cap	2001	Land Value 42,583	29,766	11%	3,274	Assessed	11,164	1,207.74																																																																																																																	
Year Frozen	0	Improvements 85,248	71,729		7,890	Penalty	0																																																																																																																		
Uncapped Value	0	Mobile Home 0	0		0	Exemption	1,000	-94.00																																																																																																																	
TIF Project ID	0	Total Value 127,831	101,495		11,164	Total Taxable	10,164	1,114.00																																																																																																																	
Assessment History <table border="1"> <thead> <tr> <th>Tax Year</th> <th>Statement Number</th> <th>Billed Owner</th> <th>Tax Area</th> <th>Total Value</th> <th>Exemptions</th> <th>Taxable Value</th> <th>Billed Tax</th> </tr> </thead> <tbody> <tr><td>2025</td><td>2025-660004524</td><td>JORDAN, KENNETH W & PAULA V</td><td>10</td><td>126,581</td><td>1000</td><td>9,839</td><td>1,079.00</td></tr> <tr><td>2024</td><td>2024-660004524</td><td>JORDAN, KENNETH W & PAULA V</td><td>10</td><td>132,562</td><td>1000</td><td>9,523</td><td>1,011.00</td></tr> <tr><td>2023</td><td>2023-660004524</td><td>JORDAN, KENNETH W & PAULA V</td><td>10</td><td>108,574</td><td>1000</td><td>9,218</td><td>972.00</td></tr> <tr><td>2022</td><td>2022-660004524</td><td>JORDAN, KENNETH W & PAULA V</td><td>10</td><td>110,745</td><td>1000</td><td>8,920</td><td>937.00</td></tr> <tr><td>2021</td><td>2021-660004524</td><td>JORDAN, KENNETH W & PAULA V</td><td>10</td><td>122,132</td><td>1000</td><td>8,630</td><td>913.00</td></tr> <tr><td>2020</td><td>2020-660004524</td><td>JORDAN, KENNETH W & PAULA V</td><td>10</td><td>120,482</td><td>1000</td><td>8,350</td><td>897.00</td></tr> <tr><td>2019</td><td>2019-660004524</td><td>JORDAN, KENNETH W & PAULA V</td><td>10</td><td>112,031</td><td>1000</td><td>8,078</td><td>852.00</td></tr> <tr><td>2018</td><td>2018-660004524</td><td>JORDAN, KENNETH W & PAULA V</td><td>10</td><td>118,207</td><td>1000</td><td>7,813</td><td>853.00</td></tr> <tr><td>2017</td><td>2017-660004524</td><td>JORDAN, KENNETH W & PAULA V</td><td>10</td><td>117,345</td><td>1000</td><td>7,557</td><td>872.00</td></tr> <tr><td>2016</td><td>2016-660004524</td><td>JORDAN, KENNETH W & PAULA V</td><td>10</td><td>114,691</td><td>1000</td><td>7,308</td><td>771.00</td></tr> <tr><td>2015</td><td>2015-660004524</td><td>JORDAN, KENNETH W & PAULA V</td><td>10</td><td>112,822</td><td>1000</td><td>7,066</td><td>705.00</td></tr> <tr><td>2014</td><td>2014-660004524</td><td>JORDAN, KENNETH W & PAULA V</td><td>10</td><td>112,573</td><td>1000</td><td>6,831</td><td>680.00</td></tr> <tr><td>2013</td><td>2013-660004524</td><td>JORDAN, KENNETH W & PAULA V</td><td>10</td><td>109,089</td><td>1000</td><td>6,603</td><td>636.00</td></tr> </tbody> </table>										Tax Year	Statement Number	Billed Owner	Tax Area	Total Value	Exemptions	Taxable Value	Billed Tax	2025	2025-660004524	JORDAN, KENNETH W & PAULA V	10	126,581	1000	9,839	1,079.00	2024	2024-660004524	JORDAN, KENNETH W & PAULA V	10	132,562	1000	9,523	1,011.00	2023	2023-660004524	JORDAN, KENNETH W & PAULA V	10	108,574	1000	9,218	972.00	2022	2022-660004524	JORDAN, KENNETH W & PAULA V	10	110,745	1000	8,920	937.00	2021	2021-660004524	JORDAN, KENNETH W & PAULA V	10	122,132	1000	8,630	913.00	2020	2020-660004524	JORDAN, KENNETH W & PAULA V	10	120,482	1000	8,350	897.00	2019	2019-660004524	JORDAN, KENNETH W & PAULA V	10	112,031	1000	8,078	852.00	2018	2018-660004524	JORDAN, KENNETH W & PAULA V	10	118,207	1000	7,813	853.00	2017	2017-660004524	JORDAN, KENNETH W & PAULA V	10	117,345	1000	7,557	872.00	2016	2016-660004524	JORDAN, KENNETH W & PAULA V	10	114,691	1000	7,308	771.00	2015	2015-660004524	JORDAN, KENNETH W & PAULA V	10	112,822	1000	7,066	705.00	2014	2014-660004524	JORDAN, KENNETH W & PAULA V	10	112,573	1000	6,831	680.00	2013	2013-660004524	JORDAN, KENNETH W & PAULA V	10	109,089	1000	6,603	636.00
Tax Year	Statement Number	Billed Owner	Tax Area	Total Value	Exemptions	Taxable Value	Billed Tax																																																																																																																		
2025	2025-660004524	JORDAN, KENNETH W & PAULA V	10	126,581	1000	9,839	1,079.00																																																																																																																		
2024	2024-660004524	JORDAN, KENNETH W & PAULA V	10	132,562	1000	9,523	1,011.00																																																																																																																		
2023	2023-660004524	JORDAN, KENNETH W & PAULA V	10	108,574	1000	9,218	972.00																																																																																																																		
2022	2022-660004524	JORDAN, KENNETH W & PAULA V	10	110,745	1000	8,920	937.00																																																																																																																		
2021	2021-660004524	JORDAN, KENNETH W & PAULA V	10	122,132	1000	8,630	913.00																																																																																																																		
2020	2020-660004524	JORDAN, KENNETH W & PAULA V	10	120,482	1000	8,350	897.00																																																																																																																		
2019	2019-660004524	JORDAN, KENNETH W & PAULA V	10	112,031	1000	8,078	852.00																																																																																																																		
2018	2018-660004524	JORDAN, KENNETH W & PAULA V	10	118,207	1000	7,813	853.00																																																																																																																		
2017	2017-660004524	JORDAN, KENNETH W & PAULA V	10	117,345	1000	7,557	872.00																																																																																																																		
2016	2016-660004524	JORDAN, KENNETH W & PAULA V	10	114,691	1000	7,308	771.00																																																																																																																		
2015	2015-660004524	JORDAN, KENNETH W & PAULA V	10	112,822	1000	7,066	705.00																																																																																																																		
2014	2014-660004524	JORDAN, KENNETH W & PAULA V	10	112,573	1000	6,831	680.00																																																																																																																		
2013	2013-660004524	JORDAN, KENNETH W & PAULA V	10	109,089	1000	6,603	636.00																																																																																																																		



Rogers

Assessment Property Record Card for Tax Year 2026

Data provided by LISA DELOZIER County Assessor

Date 04/17/2026
Time 02:13:49
Page 2

Lot Data	Square-Foot - NBHD 6010 #1	Primary Image
Lot Size Lot Count Units Buildable 2.5 Non-Ag Acres 2.3878 Topography Street Access Utilities Amenities LAND QUALITY 0 0 Method Square-Foot Base Lot Value 104,013.00 x .41 = 42,583 Factor Value Adjustments 1.0000 Lot Value 42,583		<p>\\tsclient\T\TOMMY DUNLAP\New folder (41)\IMG_0018.JPG 4/5/2022</p>

Residential Data	
Type	1 Single Family Residence
Condition	2 - Fair
Quality	2 - Fair
Architecture	
Style	100% One Story
Exterior Wall	100% Frame, Siding, Wood
Base/Total Area	1,248 / 1,248
Style	100% One Story
HVAC	100% Warmed & Cooled Air
Roof Cover	4 Metal, Preformed
Area on Slab	0
Fixture/RghIn	11 /
Bed/F/H Bath	3 / 2.0 /
Basement Area	
Garage Type	528 Attached Garage - Unfinished
Remodel	
Year/Eff Age	1990 / 36

Cost Approach				Manual : 01/2025			
Base Cost	88.09	Total Misc Impr	+ 4,526	Roofing Adj	+ 4.67	Garage Cost	+ 12,176
Subfloor Adj	+ 2.31	Total RCN	= 160,846	Heat/Cool Adj	+ 10.30	Depreciation (47%)	- 75,598
Plumbing Adj	+ 10.13	Lump Sums	+ 0	Basement Adj	+ 0.00	RCNLD	= 85,248
Adj Base Cost	= 115.50	Lot Value	+ 42,583	Total Area	x 1,248	Indicated Value	= 127,831
		Value Per SqFt	102.43	Adjusted Cost	= 144,144		

GRM Approach	
GRM Code	
Gross Rent	0.00
Indicated Value	

Multiple Regression			
MRA Code	1	Test	
Adusted R	0.8445		
Indicated Value	145,240	116.38	Per SqFt

Direct Comparables	
Selection Model	1 Res
Adjustment Model	A2 AO Test
Comparables	
Indicated Value	

Value Reconciliation			
Selected Approach	Cost Approach		
Improvements	85,248		
Lot Value	42,583		
Indicated Value	127,831	102.43	Per SqFt
Agland Value			
Site Improvements			
Total Value	127,831	102.43	Total Value Per SqFt

Miscellaneous Improvements							
Code	Description	Sketch ID	Size	Year	Units	Unit Cost	Depr Value
PRCH	SLAB PORCH - COVERED	11724	26x6		156	20.80	3,245
PATO	SLAB PORCH - OPEN	11725	16x8		128	10.01	1,281



Rogers

Assessment Property Record Card for Tax Year 2026

Data provided by LISA DELOZIER County Assessor

Date 04/17/2026

Time 02:13:49

Page 3

Sketch Image

660004524

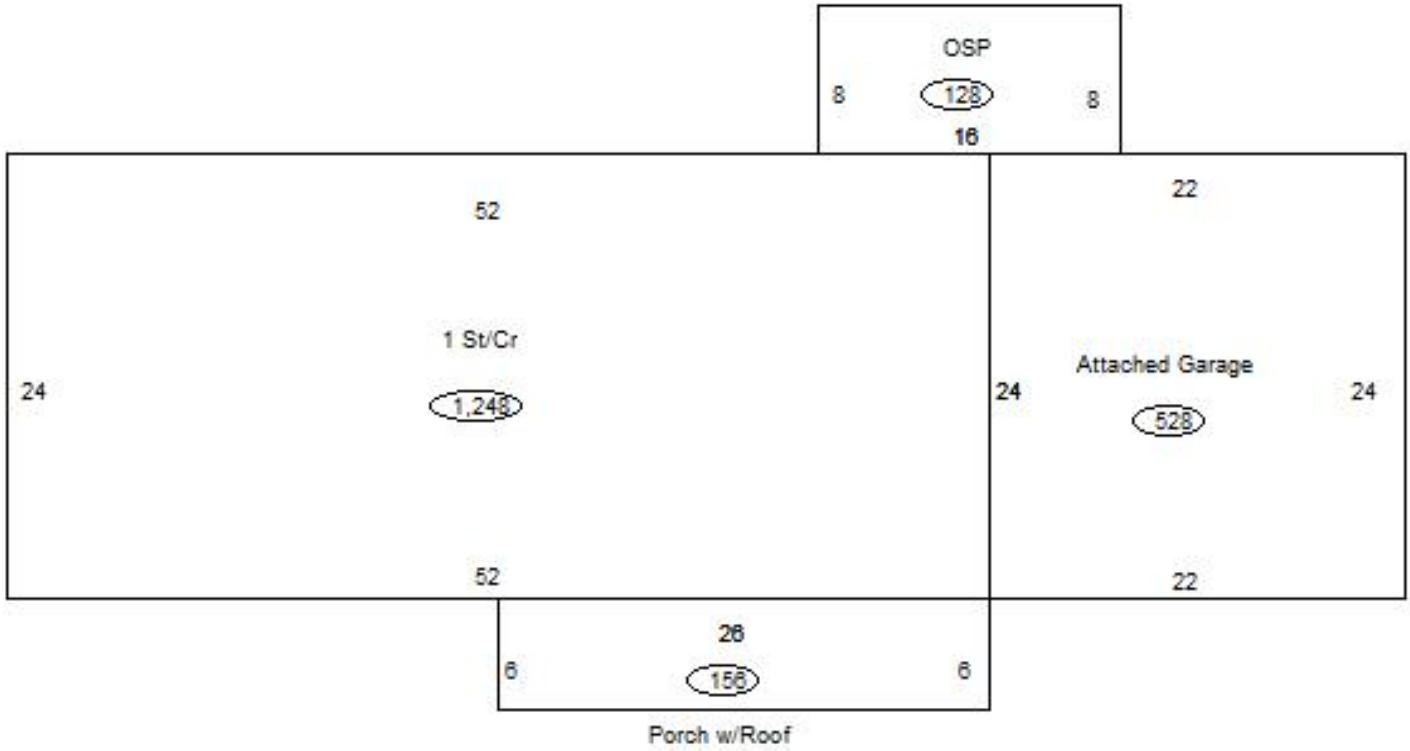

Sketch Vector Information

Sequence	Code	Type	Built Over	Scale	Section Label	Base Area	Multiplier	Total Area
1	R	1	Crawl	13	1 St/Cr	1,248	1.000	1,248
2	G	1		13	Attached Garage	528	1.000	528
3	M	PRCH		13	SLBC	156	1.000	156
4	M	PATO		13	Open Slab	128	1.000	128
Total Building Area						1,248		1,248