



Rogers

Assessment Property Record Card for Tax Year 2026

Data provided by LISA DELOZIER County Assessor

Date 04/17/2026
Time 04:15:06
Page 1

Assessment Data					Primary Image																																																																																																																				
Account 660004553 Parcel ID 000000-00-0-00489-001-0003 Cadastral ID 05-22-15-04030 Property Type REAL - Real Property Property Class RRP VI Area 4 Tax Area 10 - OOLOGAH RURAL/NW FIRE Name ID 195454 JACKSON, GERALD E & JOYCELENE M 14400 S 4090 RD OOLOGAH OK 74053-0000																																																																																																																									
Parcel Location Situs 13630 S LIONEL AVE Subdivision MEADOW ACRES Lot/Block 0003 / 0001 Parcel Size 1 - Lots Sec/Twn/Rng 5 / 22 / 15 / 5 Neighborhood 1066 - R-V02-NW OOLOGAH School District S004 - OOLOGAH SCHOOLS																																																																																																																									
Legal Description Lot/Long: 36.41417259 -95.72286929 LOT 3 BLOCK 1 MEADOW ACRES					Building Permits <table border="1"> <thead> <tr> <th>Number</th> <th>Description</th> <th>Opened</th> <th>Closed</th> <th>Amount</th> </tr> </thead> <tbody> <tr> <td> </td> <td> </td> <td> </td> <td> </td> <td> </td> </tr> </tbody> </table>					Number	Description	Opened	Closed	Amount																																																																																																											
Number	Description	Opened	Closed	Amount																																																																																																																					
Exemptions <table border="1"> <thead> <tr> <th>Code</th> <th>Type</th> <th>Active</th> <th>Maximum</th> <th>Exemption</th> </tr> </thead> <tbody> <tr> <td> </td> <td> </td> <td> </td> <td> </td> <td> </td> </tr> </tbody> </table>					Code	Type	Active	Maximum	Exemption						Sale History <table border="1"> <thead> <tr> <th>Bk/Pg</th> <th>Grantor</th> <th>Date</th> <th>Price</th> <th>Code</th> </tr> </thead> <tbody> <tr> <td>841/725</td> <td> </td> <td> </td> <td>16,000</td> <td>No</td> </tr> </tbody> </table>					Bk/Pg	Grantor	Date	Price	Code	841/725			16,000	No																																																																																												
Code	Type	Active	Maximum	Exemption																																																																																																																					
Bk/Pg	Grantor	Date	Price	Code																																																																																																																					
841/725			16,000	No																																																																																																																					
Parcel Valuation <table border="1"> <thead> <tr> <th>Source</th> <th>REAL</th> <th>Fair Cash</th> <th>Capped</th> <th>Asmnt Level</th> <th>Assessed</th> <th>Levy Rate</th> <th>108.182</th> <th>Current Tax</th> </tr> </thead> <tbody> <tr> <td>Remove Cap</td> <td>0</td> <td>Land Value 40,989</td> <td>18,703</td> <td>11%</td> <td>2,057</td> <td>Assessed</td> <td>3,395</td> <td>367.28</td> </tr> <tr> <td>Year Frozen</td> <td>0</td> <td>Improvements 5,457</td> <td>4,551</td> <td> </td> <td>501</td> <td>Penalty</td> <td>0</td> <td> </td> </tr> <tr> <td>Uncapped Value</td> <td>0</td> <td>Mobile Home 10,697</td> <td>7,613</td> <td> </td> <td>837</td> <td>Exemption</td> <td>0</td> <td>0.00</td> </tr> <tr> <td>TIF Project ID</td> <td>0</td> <td>Total Value 57,143</td> <td>30,867</td> <td> </td> <td>3,395</td> <td>Total Taxable</td> <td>3,395</td> <td>367.00</td> </tr> </tbody> </table>										Source	REAL	Fair Cash	Capped	Asmnt Level	Assessed	Levy Rate	108.182	Current Tax	Remove Cap	0	Land Value 40,989	18,703	11%	2,057	Assessed	3,395	367.28	Year Frozen	0	Improvements 5,457	4,551		501	Penalty	0		Uncapped Value	0	Mobile Home 10,697	7,613		837	Exemption	0	0.00	TIF Project ID	0	Total Value 57,143	30,867		3,395	Total Taxable	3,395	367.00																																																																			
Source	REAL	Fair Cash	Capped	Asmnt Level	Assessed	Levy Rate	108.182	Current Tax																																																																																																																	
Remove Cap	0	Land Value 40,989	18,703	11%	2,057	Assessed	3,395	367.28																																																																																																																	
Year Frozen	0	Improvements 5,457	4,551		501	Penalty	0																																																																																																																		
Uncapped Value	0	Mobile Home 10,697	7,613		837	Exemption	0	0.00																																																																																																																	
TIF Project ID	0	Total Value 57,143	30,867		3,395	Total Taxable	3,395	367.00																																																																																																																	
Assessment History <table border="1"> <thead> <tr> <th>Tax Year</th> <th>Statement Number</th> <th>Billed Owner</th> <th>Tax Area</th> <th>Total Value</th> <th>Exemptions</th> <th>Taxable Value</th> <th>Billed Tax</th> </tr> </thead> <tbody> <tr><td>2025</td><td>2025-660004553</td><td>JACKSON, GERALD E &</td><td>10</td><td>56,721</td><td>0</td><td>3,233</td><td>349.00</td></tr> <tr><td>2024</td><td>2024-660004553</td><td>JACKSON, GERALD E &</td><td>10</td><td>61,212</td><td>0</td><td>3,080</td><td>322.00</td></tr> <tr><td>2023</td><td>2023-660004553</td><td>JACKSON, GERALD E &</td><td>10</td><td>35,624</td><td>0</td><td>2,933</td><td>305.00</td></tr> <tr><td>2022</td><td>2022-660004553</td><td>JACKSON, GERALD E &</td><td>10</td><td>32,337</td><td>0</td><td>2,794</td><td>289.00</td></tr> <tr><td>2021</td><td>2021-660004553</td><td>JACKSON, GERALD E &</td><td>10</td><td>31,285</td><td>0</td><td>2,661</td><td>277.00</td></tr> <tr><td>2020</td><td>2020-660004553</td><td>JACKSON, GERALD E &</td><td>10</td><td>30,999</td><td>0</td><td>2,534</td><td>268.00</td></tr> <tr><td>2019</td><td>2019-660004553</td><td>JACKSON, GERALD E &</td><td>10</td><td>30,133</td><td>0</td><td>2,413</td><td>250.00</td></tr> <tr><td>2018</td><td>2018-660004553</td><td>JACKSON, GERALD E &</td><td>10</td><td>20,897</td><td>0</td><td>2,299</td><td>247.00</td></tr> <tr><td>2017</td><td>2017-660004553</td><td>JACKSON, GERALD E &</td><td>10</td><td>20,824</td><td>0</td><td>2,291</td><td>261.00</td></tr> <tr><td>2016</td><td>2016-660004553</td><td>JACKSON, GERALD E &</td><td>10</td><td>20,824</td><td>0</td><td>2,291</td><td>237.00</td></tr> <tr><td>2015</td><td>2015-660004553</td><td>JACKSON, GERALD E &</td><td>10</td><td>21,787</td><td>0</td><td>2,271</td><td>222.00</td></tr> <tr><td>2014</td><td>2014-660004553</td><td>JACKSON, GERALD E &</td><td>10</td><td>21,824</td><td>0</td><td>2,163</td><td>211.00</td></tr> <tr><td>2013</td><td>2013-660004553</td><td>JACKSON, GERALD E &</td><td>10</td><td>21,824</td><td>0</td><td>2,060</td><td>195.00</td></tr> </tbody> </table>										Tax Year	Statement Number	Billed Owner	Tax Area	Total Value	Exemptions	Taxable Value	Billed Tax	2025	2025-660004553	JACKSON, GERALD E &	10	56,721	0	3,233	349.00	2024	2024-660004553	JACKSON, GERALD E &	10	61,212	0	3,080	322.00	2023	2023-660004553	JACKSON, GERALD E &	10	35,624	0	2,933	305.00	2022	2022-660004553	JACKSON, GERALD E &	10	32,337	0	2,794	289.00	2021	2021-660004553	JACKSON, GERALD E &	10	31,285	0	2,661	277.00	2020	2020-660004553	JACKSON, GERALD E &	10	30,999	0	2,534	268.00	2019	2019-660004553	JACKSON, GERALD E &	10	30,133	0	2,413	250.00	2018	2018-660004553	JACKSON, GERALD E &	10	20,897	0	2,299	247.00	2017	2017-660004553	JACKSON, GERALD E &	10	20,824	0	2,291	261.00	2016	2016-660004553	JACKSON, GERALD E &	10	20,824	0	2,291	237.00	2015	2015-660004553	JACKSON, GERALD E &	10	21,787	0	2,271	222.00	2014	2014-660004553	JACKSON, GERALD E &	10	21,824	0	2,163	211.00	2013	2013-660004553	JACKSON, GERALD E &	10	21,824	0	2,060	195.00
Tax Year	Statement Number	Billed Owner	Tax Area	Total Value	Exemptions	Taxable Value	Billed Tax																																																																																																																		
2025	2025-660004553	JACKSON, GERALD E &	10	56,721	0	3,233	349.00																																																																																																																		
2024	2024-660004553	JACKSON, GERALD E &	10	61,212	0	3,080	322.00																																																																																																																		
2023	2023-660004553	JACKSON, GERALD E &	10	35,624	0	2,933	305.00																																																																																																																		
2022	2022-660004553	JACKSON, GERALD E &	10	32,337	0	2,794	289.00																																																																																																																		
2021	2021-660004553	JACKSON, GERALD E &	10	31,285	0	2,661	277.00																																																																																																																		
2020	2020-660004553	JACKSON, GERALD E &	10	30,999	0	2,534	268.00																																																																																																																		
2019	2019-660004553	JACKSON, GERALD E &	10	30,133	0	2,413	250.00																																																																																																																		
2018	2018-660004553	JACKSON, GERALD E &	10	20,897	0	2,299	247.00																																																																																																																		
2017	2017-660004553	JACKSON, GERALD E &	10	20,824	0	2,291	261.00																																																																																																																		
2016	2016-660004553	JACKSON, GERALD E &	10	20,824	0	2,291	237.00																																																																																																																		
2015	2015-660004553	JACKSON, GERALD E &	10	21,787	0	2,271	222.00																																																																																																																		
2014	2014-660004553	JACKSON, GERALD E &	10	21,824	0	2,163	211.00																																																																																																																		
2013	2013-660004553	JACKSON, GERALD E &	10	21,824	0	2,060	195.00																																																																																																																		



Rogers

Assessment Property Record Card for Tax Year 2026

Data provided by LISA DELOZIER County Assessor

Date 04/17/2026
 Time 04:15:06
 Page 2

Lot Data		Square-Foot - NBHD 1066 #1		Primary Image				
Lot Size								
Lot Count								
Units Buildable	1							
Non-Ag Acres	0.8962							
Topography								
Street Access								
Utilities								
Amenities	LAND QUALITY		0					
			0					
Method	Square-Foot							
Base Lot Value	39,037.00 x 1.05 = 40,989							
Factor Value								
Adjustments	1.0000							
Lot Value	40,989							
Residential Data				GRM Approach				
Type				GRM Code				
Condition	-			Gross Rent	0.00			
Quality	-			Indicated Value				
Architecture				Multiple Regression				
Style				MRA Code				
Exterior Wall				Adjusted R				
Base/Total Area /				Indicated Value				
Style				Direct Comparables				
HVAC				Selection Model	A Adam Test			
Roof Cover				Adjustment Model	1 2022 Residential			
Area on Slab				Comparables				
Fixture/RghIn /				Indicated Value				
Bed/F/H Bath / /				Value Reconciliation				
Basement Area				Selected Approach	Cost Approach			
Garage Type				Improvements				
Remodel				Lot Value	40,989			
Year/Eff Age /				Indicated Value	40,989	0.00	Per SqFt	
				Agland Value				
				Site Improvements	1,824			
				Total Value	42,813	0.00	Total Value Per SqFt	
Cost Approach				Manual : 01/2025				
Base Cost	0.00	Total Misc Impr	+ 0					
Roofing Adj	+ 0.00	Garage Cost	+ 0					
Subfloor Adj	+ 0.00	Total RCN	= 0					
Heat/Cool Adj	+ 0.00	Depreciation (0%)	- 0					
Plumbing Adj	+ 0.00	Lump Sums	+ 0					
Basement Adj	+ 0.00	RCNLD	= 0					
Adj Base Cost	= 0.00	Lot Value	+ 40,989					
Total Area	x	Indicated Value	= 40,989					
Adjusted Cost	= 0	Value Per SqFt	0.00					
Miscellaneous Improvements								
Code	Description	Sketch ID	Size	Year	Units	Unit Cost	Depr	Value



Rogers

Assessment Property Record Card for Tax Year 2026

Data provided by LISA DELOZIER County Assessor

Date 04/17/2026
Time 04:15:06
Page 3

660004553

Outbuildings/Site Improvements

Building Image	Code	Description	Dimensions	Floor	Roofing	Total Units
	DTGF	DETACHED GARAGE FAIR	0x0x0			380
	Qual 2	Cond 3	Year	Eff Age		
Valuation Summary		Modifier Total	RCN	Depr (70% Phys/ % Func)		RCNLD
Base Cost (16.00 x 380)		6,080		6,080 4,256		1,824



Rogers

Assessment Property Record Card for Tax Year 2026

Data provided by LISA DELOZIER County Assessor

Date 04/17/2026
 Time 04:15:06
 Page 4

Lot Data	Primary Image
Lot Size Lot Count Units Buildable Non-Ag Acres Topography Street Access Utilities Amenities LAND QUALITY Method Base Lot Value Factor Value Adjustments Lot Value	<p>C:\Users\RLN\Pictures\2018-02-13 02-13-18\02-13-18 054.JPG 2/14/2018</p>

Residential Data	
Type	6 Mobile Home 52 x 24
Condition	1.5 - Low
Quality	1.5 - Low
Architecture	6 MS ADJ
Style	100% Double Wide
Exterior Wall	100% Aluminum Sheet
Base/Total Area	1,248 / 1,248
Style	100% Double Wide
HVAC	
Roof Cover	14 Metal, Ribbed
Area on Slab	0
Fixture/RghIn	/
Bed/F/H Bath	/ /
Basement Area	
Garage Type	
Remodel	
Year/Eff Age	1972 / 65



GRM Approach	
GRM Code	
Gross Rent	0.00
Indicated Value	

Multiple Regression	
MRA Code	
Adjusted R	
Indicated Value	

Direct Comparables	
Selection Model	A Adam Test
Adjustment Model	1 2022 Residential
Comparables	
Indicated Value	

Cost Approach				Manual : 01/2025			
Base Cost	28.37	Total Misc Impr	+ 8,809				
Roofing Adj	+ 2.30	Garage Cost	+ 0				
Subfloor Adj	+ 0.00	Total RCN	= 53,487				
Heat/Cool Adj	+ 0.00	Depreciation (80%)	- 42,790				
Plumbing Adj	+ 5.13	Lump Sums	+ 3,633				
Basement Adj	+ 0.00	RCNLD	= 14,330				
Adj Base Cost	= 35.80	Lot Value	+ 0				
Total Area	x 1,248	Indicated Value	= 14,330				
Adjusted Cost	= 44,678	Value Per SqFt	11.48				

Value Reconciliation			
Selected Approach	Cost Approach		
Improvements	14,330		
Lot Value			
Indicated Value	14,330	11.48	Per SqFt
Agland Value			
Site Improvements			
Total Value	14,330	11.48	Total Value Per SqFt

Miscellaneous Improvements								
Code	Description	Sketch ID	Size	Year	Units	Unit Cost	Depr	Value
EPSW	ENCLOSED PORCH - SOLID WALL	140305	26x10		260	33.88		8,809
WODC	WOOD DECK - COVERED	140306	32x8		256	28.38	50%	3,633



Rogers

Assessment Property Record Card for Tax Year 2026

Data provided by LISA DELOZIER County Assessor

Date 04/17/2026

Time 04:15:06

Page 5

Sketch Image

660004553

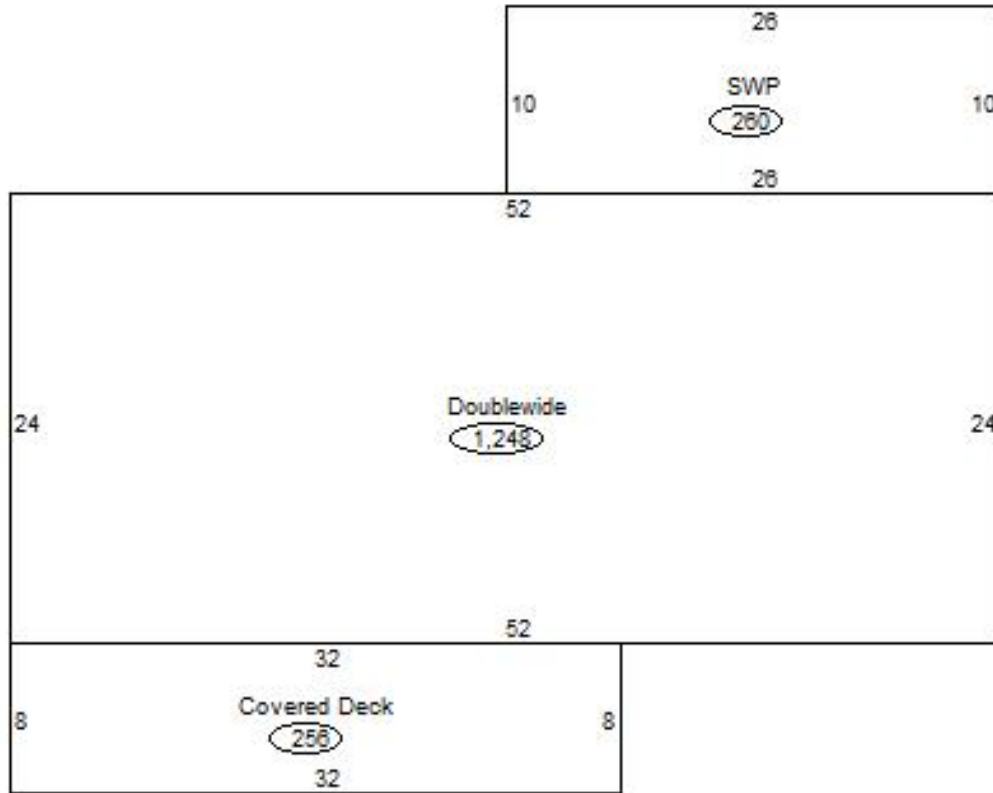

Sketch Vector Information

Sequence	Code	Type	Built Over	Scale	Section Label	Base Area	Multiplier	Total Area
1	R	14		13	Doublewide	1,248	1.000	1,248
2	M	EPSW		13	EPSW	260	1.000	260
3	M	WODC		13	WODC	256	1.000	256
Total Building Area						1,248		1,248