



Rogers

Assessment Property Record Card for Tax Year 2026

Data provided by LISA DELOZIER County Assessor

Date 04/17/2026
Time 05:18:00
Page 1

| Assessment Data | | | | | Primary Image | | | | | | | | | | | | | | |
|---|-------------------------|----------------------|------------------|------------------|--|---------------------------|----------------------|----------------------|--------------------|--------|-------------|--------|--------|--------|--|--|--|--|--|
| Account 660004644 Parcel ID 000000-00-0-00624-001-0034 Cadastral ID 05-22-15-04940 Property Type REAL - Real Property Property Class RRP VI Area 4 Tax Area 10 - OOLOGAH RURAL/NW FIRE Name ID 346893 SPRINGSTEEN, MICHAEL 5820 E IVA LYNN LN OOLOGAH OK 74053-0000 Parcel Location Situs 05820 E IVA LYNE LN Subdivision PRAIRIE ACRES Lot/Block 0034 / 0001 Parcel Size 1 - Lots Sec/Twn/Rng 5 / 22 / 15 / 5 Neighborhood 1066 - R-V02-NW OOLOGAH School District S004 - OOLOGAH SCHOOLS | | | | | <p>\\tsclient\T\TOMMY DUNLAP\New folder (45)\IMG_0014.JPG 4/8/2022</p> | | | | | | | | | | | | | | |
| Legal Description Lot/Long: 36.41785793 -95.72558236 | | | | | | | | | | | | | | | | | | | |
| LOT 34 BLOCK 1 PRAIRIE ACRES | | | | | Building Permits <table border="1"> <thead> <tr> <th>Number</th> <th>Description</th> <th>Opened</th> <th>Closed</th> <th>Amount</th> </tr> </thead> <tbody> <tr> <td> </td> <td> </td> <td> </td> <td> </td> <td> </td> </tr> </tbody> </table> | | | | | Number | Description | Opened | Closed | Amount | | | | | |
| Number | Description | Opened | Closed | Amount | | | | | | | | | | | | | | | |
| | | | | | | | | | | | | | | | | | | | |
| Exemptions | | | | | Sale History | | | | | | | | | | | | | | |
| Code | Type | Active | Maximum | Exemption | Bk/Pg | Grantor | Date | Price | Code | | | | | | | | | | |
| H | Homestead | No | 1,000 | | / | BACON, MARCIA L | 04/17/2025 | 250,000 | 22 | | | | | | | | | | |
| | | | | | 918/755 | PRITCHETT, JOHN L & KAY G | 06/11/1993 | 68,000 | Yes | | | | | | | | | | |
| | | | | | 835/121 | | | 65,000 | No | | | | | | | | | | |
| Parcel Valuation | | | | | | | | | | | | | | | | | | | |
| Source | REAL | | Fair Cash | Capped | Asmnt Level | Assessed | Levy Rate | 108.182 | Current Tax | | | | | | | | | | |
| Remove Cap | 2026 | Land Value | 136,961 | 136,961 | 11% | 15,066 | Assessed | 27,500 | 2,974.99 | | | | | | | | | | |
| Year Frozen | 2011 | Improvements | 113,040 | 113,040 | | 12,434 | Penalty | 0 | | | | | | | | | | | |
| Uncapped Value | 0 | Mobile Home | 0 | 0 | | 0 | Exemption | 0 | 0.00 | | | | | | | | | | |
| TIF Project ID | 0 | Total Value | 250,001 | 250,001 | | 27,500 | Total Taxable | 27,500 | 2,975.00 | | | | | | | | | | |
| Assessment History | | | | | | | | | | | | | | | | | | | |
| Tax Year | Statement Number | Billed Owner | | | Tax Area | Total Value | Exemptions | Taxable Value | Billed Tax | | | | | | | | | | |
| 2025 | 2025-660004644 | SPRINGSTEEN, MICHAEL | | | 10 | 147,620 | 1000 | 7,185 | 792.00 | | | | | | | | | | |
| 2024 | 2024-660004644 | BACON, MARCIA L | | | 10 | 152,765 | 1000 | 7,185 | 767.00 | | | | | | | | | | |
| 2023 | 2023-660004644 | BACON, MARCIA L | | | 10 | 113,016 | 1000 | 7,185 | 762.00 | | | | | | | | | | |
| 2022 | 2022-660004644 | BACON, MARCIA L | | | 10 | 121,286 | 1000 | 7,185 | 757.00 | | | | | | | | | | |
| 2021 | 2021-660004644 | BACON, MARCIA L | | | 10 | 128,040 | 1000 | 7,185 | 762.00 | | | | | | | | | | |
| 2020 | 2020-660004644 | BACON, MARCIA L | | | 10 | 125,914 | 1000 | 7,185 | 774.00 | | | | | | | | | | |
| 2019 | 2019-660004644 | BACON, MARCIA L | | | 10 | 122,202 | 1000 | 7,185 | 760.00 | | | | | | | | | | |
| 2018 | 2018-660004644 | BACON, MARCIA L | | | 10 | 127,300 | 1000 | 7,185 | 786.00 | | | | | | | | | | |
| 2017 | 2017-660004644 | BACON, MARCIA L | | | 10 | 125,504 | 1000 | 7,185 | 830.00 | | | | | | | | | | |
| 2016 | 2016-660004644 | BACON, MARCIA L | | | 10 | 122,906 | 1000 | 7,185 | 758.00 | | | | | | | | | | |
| 2015 | 2015-660004644 | BACON, MARCIA L | | | 10 | 121,914 | 1000 | 7,185 | 717.00 | | | | | | | | | | |
| 2014 | 2014-660004644 | BACON, MARCIA L | | | 10 | 123,192 | 1000 | 7,186 | 714.00 | | | | | | | | | | |
| 2013 | 2013-660004644 | BACON, MARCIA L | | | 10 | 118,321 | 1000 | 7,185 | 691.00 | | | | | | | | | | |



Rogers

Assessment Property Record Card for Tax Year 2026

Data provided by LISA DELOZIER County Assessor

Date 04/17/2026
Time 05:18:01
Page 2

| Lot Data | Square-Foot - NBHD 1066 #1 | Primary Image |
|-----------------|----------------------------|---------------|
| Lot Size | | |
| Lot Count | | |
| Units Buildable | 5000 | |
| Non-Ag Acres | 0.9361 | |
| Topography | | |
| Street Access | | |
| Utilities | | |
| Amenities | LAND QUALITY | |
| | 0 | |
| | 0 | |
| Method | Square-Foot | |
| Base Lot Value | 40,776.00 x 1.05 = 42,815 | |
| Factor Value | | |
| Adjustments | 3.1989 | |
| Lot Value | 136,961 | |

| Residential Data | |
|------------------|----------------------------------|
| Type | 1 Single Family Residence |
| Condition | 2 - Fair |
| Quality | 2.5 - Fair |
| Architecture | |
| Style | 100% One Story |
| Exterior Wall | 100% Veneer, Stone |
| Base/Total Area | 1,444 / 1,444 |
| Style | 100% One Story |
| HVAC | 100% Warmed & Cooled Air |
| Roof Cover | 4 Metal, Preformed |
| Area on Slab | 1,444 |
| Fixture/RghIn | 8 / |
| Bed/F/H Bath | 3 / 2.0 / |
| Basement Area | |
| Garage Type | 483 Attached Garage - Unfinished |
| Remodel | |
| Year/Eff Age | 1971 / 55 |



\\tsclient\T\TOMMY DUNLAP\New folder (45)\IMG_0014.JPG 4/8/2022

| Cost Approach | | Manual : 01/2025 | |
|---------------|-----------|---------------------|-----------|
| Base Cost | 109.02 | Total Misc Impr | + 8,937 |
| Roofing Adj | + 5.12 | Garage Cost | + 13,345 |
| Subfloor Adj | + -1.18 | Total RCN | = 212,385 |
| Heat/Cool Adj | + 11.47 | Depreciation (61%) | - 129,555 |
| Plumbing Adj | + 7.22 | Lump Sums | + 0 |
| Basement Adj | + 0.00 | RCNLD | = 82,830 |
| Adj Base Cost | = 131.65 | Lot Value | + 136,961 |
| Total Area | x 1,444 | Indicated Value | = 219,791 |
| Adjusted Cost | = 190,103 | Value Per SqFt | 152.21 |

| GRM Approach | |
|-----------------|------|
| GRM Code | |
| Gross Rent | 0.00 |
| Indicated Value | |

| Multiple Regression | | | |
|---------------------|---------|--------|----------|
| MRA Code | 1 | Test | |
| Adusted R | 0.8445 | | |
| Indicated Value | 180,526 | 125.02 | Per SqFt |

| Direct Comparables | |
|--------------------|--------------------|
| Selection Model | A Adam Test |
| Adjustment Model | 1 2022 Residential |
| Comparables | |
| Indicated Value | |

| Value Reconciliation | | | |
|----------------------|---------------|--------|----------------------|
| Selected Approach | Cost Approach | | |
| Improvements | 82,830 | | |
| Lot Value | 136,961 | | |
| Indicated Value | 219,791 | 152.21 | Per SqFt |
| Agland Value | | | |
| Site Improvements | 30,210 | | |
| Total Value | 250,001 | 173.13 | Total Value Per SqFt |

| Miscellaneous Improvements | | | | | | | | |
|----------------------------|---------------------------------|-----------|------|------|-------|-----------|------|-------|
| Code | Description | Sketch ID | Size | Year | Units | Unit Cost | Depr | Value |
| FPR1 | FIREPLACE - RESIDENTIAL 1 STORY | 0 | | 1 | 1 | 5,095.98 | | 5,096 |
| PRCH | SLAB PORCH - COVERED | 11910 | 27x6 | | 162 | 23.71 | | 3,841 |



Rogers

Assessment Property Record Card for Tax Year 2026

Data provided by LISA DELOZIER County Assessor

Date 04/17/2026
Time 05:18:01
Page 3

Sketch Image

660004644

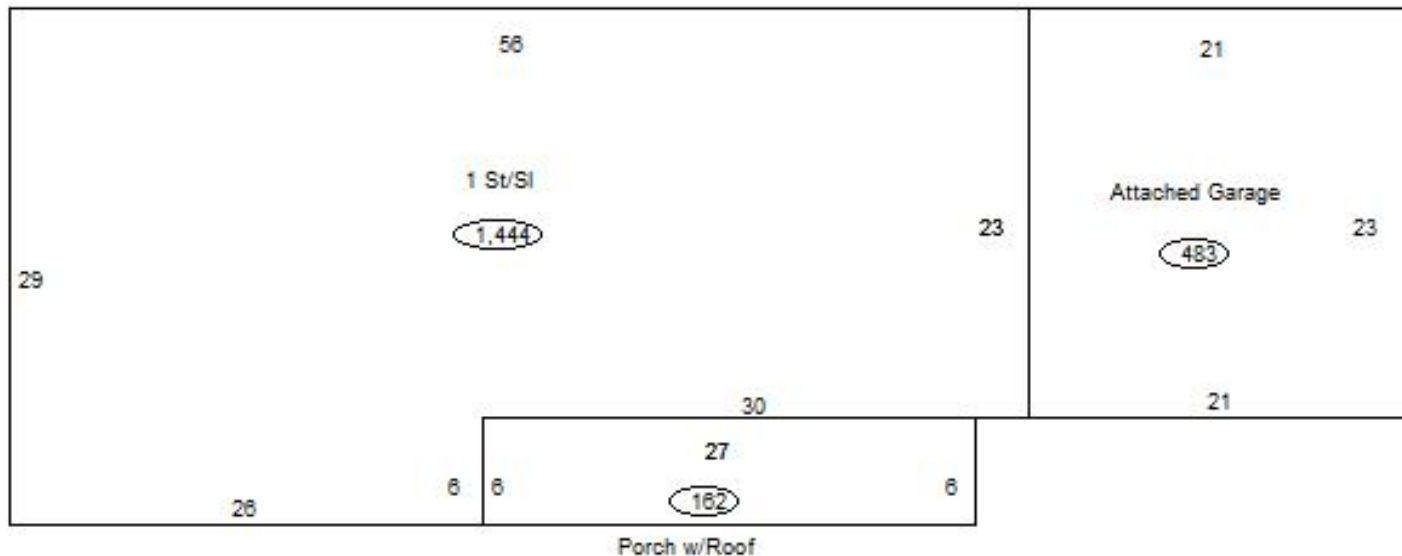

Sketch Vector Information

| Sequence | Code | Type | Built Over | Scale | Section Label | Base Area | Multiplier | Total Area |
|----------------------------|------|------|------------|-------|-----------------|-----------|------------|------------|
| 1 | R | 1 | Slab | 13 | 1 St/SI | 1,444 | 1.000 | 1,444 |
| 2 | G | 1 | | 13 | Attached Garage | 483 | 1.000 | 483 |
| 3 | M | PRCH | | 13 | SLBC | 162 | 1.000 | 162 |
| Total Building Area | | | | | | 1,444 | | 1,444 |



Rogers



Assessment Property Record Card for Tax Year 2026

Data provided by LISA DELOZIER County Assessor

Date 04/17/2026
Time 05:18:01
Page 4

660004644

Outbuildings/Site Improvements

| Building Image | Code | Description | Dimensions | Floor | Roofing | Total Units |
|--|---------------------------|----------------------|-----------------------|------------|--------------------------------|--------------|
|  | DTGF | DETACHED GARAGE FAIR | 0x0x0 | | | 1,728 |
| | Qual | 2 | Cond 3 | Year | Eff Age | |
| | Valuation Summary | | Modifier Total | RCN | Depr (40% Phys/ % Func) | RCNLD |
| | Base Cost (16.00 x 1,728) | | 27,648 | 27,648 | 11,059 | 16,589 |
|  | SV | SWIM VINYL | | | | 1 |
| | Qual | 3 | Cond 3 | Year | Eff Age | |
| | Valuation Summary | | Modifier Total | RCN | Depr (50% Phys/ % Func) | RCNLD |
| | Base Cost (25,000.00 x 1) | | 25,000 | 25,000 | 12,500 | 12,500 |
|  | LT | LEAN-TO | 16x24x0 | | | 384 |
| | Qual | 2 | Cond 3 | Year | Eff Age | |
| | Valuation Summary | | Modifier Total | RCN | Depr (0% Phys/ % Func) | RCNLD |
| | Base Cost (2.92 x 384) | | 1,121 | 1,121 | | 1,121 |