



Rogers

Assessment Property Record Card for Tax Year 2026

Data provided by LISA DELOZIER County Assessor

Date 04/17/2026
 Time 02:24:40
 Page 1

Assessment Data					Primary Image																																																																																																																				
Account 660004650 Parcel ID 22N16E-05-1-00000-000-0000 Cadastral ID 05-22-16-00200 Property Type REAL - Real Property Property Class RR VI Area 1 Tax Area 11 - SEQUOYAH/NW FIRE Name ID 297998 PASDACH, JOHN & ANGELA 11951 E KAY PL CLAREMORE OK 74017-0000																																																																																																																									
Parcel Location Situs 11951 KAY PL Subdivision Lot/Block / Parcel Size 2.5 - Acres Sec/Twn/Rng 5 / 22 / 16 / 1 Neighborhood 6030 - UNPLATTED School District S006 - SEQUOYAH SCHOOLS																																																																																																																									
Legal Description Lat/Long: 36.41924116 -95.61580336 BEG; 50' W OF NE/C S2 NE, S 305.13' W 357.5' N 305.01' TO N/L S2 NE E 357.5' TO POB					Building Permits <table border="1"> <thead> <tr> <th>Number</th> <th>Description</th> <th>Opened</th> <th>Closed</th> <th>Amount</th> </tr> </thead> <tbody> <tr> <td> </td> <td> </td> <td> </td> <td> </td> <td> </td> </tr> </tbody> </table>					Number	Description	Opened	Closed	Amount																																																																																																											
Number	Description	Opened	Closed	Amount																																																																																																																					
Exemptions <table border="1"> <thead> <tr> <th>Code</th> <th>Type</th> <th>Active</th> <th>Maximum</th> <th>Exemption</th> </tr> </thead> <tbody> <tr> <td>H</td> <td>Homestead</td> <td>Yes</td> <td>1,000</td> <td>1,000</td> </tr> </tbody> </table>					Code	Type	Active	Maximum	Exemption	H	Homestead	Yes	1,000	1,000	Sale History <table border="1"> <thead> <tr> <th>Bk/Pg</th> <th>Grantor</th> <th>Date</th> <th>Price</th> <th>Code</th> </tr> </thead> <tbody> <tr> <td>1957/912</td> <td>HORNER, DEWEY M & RUTH</td> <td>05/30/2008</td> <td>61,500</td> <td>8</td> </tr> <tr> <td>1351/850</td> <td>LOGAN, DANNY R</td> <td>01/29/2002</td> <td>61,500</td> <td>YES</td> </tr> <tr> <td>883/335</td> <td>WICKHAM, MICHAEL A</td> <td>05/29/1992</td> <td>44,500</td> <td>No</td> </tr> </tbody> </table>					Bk/Pg	Grantor	Date	Price	Code	1957/912	HORNER, DEWEY M & RUTH	05/30/2008	61,500	8	1351/850	LOGAN, DANNY R	01/29/2002	61,500	YES	883/335	WICKHAM, MICHAEL A	05/29/1992	44,500	No																																																																																		
Code	Type	Active	Maximum	Exemption																																																																																																																					
H	Homestead	Yes	1,000	1,000																																																																																																																					
Bk/Pg	Grantor	Date	Price	Code																																																																																																																					
1957/912	HORNER, DEWEY M & RUTH	05/30/2008	61,500	8																																																																																																																					
1351/850	LOGAN, DANNY R	01/29/2002	61,500	YES																																																																																																																					
883/335	WICKHAM, MICHAEL A	05/29/1992	44,500	No																																																																																																																					
Parcel Valuation <table border="1"> <thead> <tr> <th>Source</th> <th>REAL</th> <th>Fair Cash</th> <th>Capped</th> <th>Asmnt Level</th> <th>Assessed</th> <th>Levy Rate</th> <th>102.332</th> <th>Current Tax</th> </tr> </thead> <tbody> <tr> <td>Remove Cap</td> <td>2009</td> <td>Land Value 73,442</td> <td>29,856</td> <td>11%</td> <td>3,284</td> <td>Assessed</td> <td>9,972</td> <td>1,020.45</td> </tr> <tr> <td>Year Frozen</td> <td>0</td> <td>Improvements 84,707</td> <td>60,803</td> <td></td> <td>6,688</td> <td>Penalty</td> <td>0</td> <td></td> </tr> <tr> <td>Uncapped Value</td> <td>0</td> <td>Mobile Home 0</td> <td>0</td> <td></td> <td>0</td> <td>Exemption</td> <td>1,000</td> <td>-88.00</td> </tr> <tr> <td>TIF Project ID</td> <td>0</td> <td>Total Value 158,149</td> <td>90,659</td> <td></td> <td>9,972</td> <td>Total Taxable</td> <td>8,972</td> <td>932.00</td> </tr> </tbody> </table>										Source	REAL	Fair Cash	Capped	Asmnt Level	Assessed	Levy Rate	102.332	Current Tax	Remove Cap	2009	Land Value 73,442	29,856	11%	3,284	Assessed	9,972	1,020.45	Year Frozen	0	Improvements 84,707	60,803		6,688	Penalty	0		Uncapped Value	0	Mobile Home 0	0		0	Exemption	1,000	-88.00	TIF Project ID	0	Total Value 158,149	90,659		9,972	Total Taxable	8,972	932.00																																																																			
Source	REAL	Fair Cash	Capped	Asmnt Level	Assessed	Levy Rate	102.332	Current Tax																																																																																																																	
Remove Cap	2009	Land Value 73,442	29,856	11%	3,284	Assessed	9,972	1,020.45																																																																																																																	
Year Frozen	0	Improvements 84,707	60,803		6,688	Penalty	0																																																																																																																		
Uncapped Value	0	Mobile Home 0	0		0	Exemption	1,000	-88.00																																																																																																																	
TIF Project ID	0	Total Value 158,149	90,659		9,972	Total Taxable	8,972	932.00																																																																																																																	
Assessment History <table border="1"> <thead> <tr> <th>Tax Year</th> <th>Statement Number</th> <th>Billed Owner</th> <th>Tax Area</th> <th>Total Value</th> <th>Exemptions</th> <th>Taxable Value</th> <th>Billed Tax</th> </tr> </thead> <tbody> <tr><td>2025</td><td>2025-660004650</td><td>PASDACH, JOHN &</td><td>11</td><td>151,364</td><td>1000</td><td>8,681</td><td>903.00</td></tr> <tr><td>2024</td><td>2024-660004650</td><td>PASDACH, JOHN &</td><td>11</td><td>159,128</td><td>1000</td><td>8,401</td><td>877.00</td></tr> <tr><td>2023</td><td>2023-660004650</td><td>PASDACH, JOHN &</td><td>11</td><td>96,378</td><td>1000</td><td>8,126</td><td>866.00</td></tr> <tr><td>2022</td><td>2022-660004650</td><td>PASDACH, JOHN &</td><td>11</td><td>95,690</td><td>1000</td><td>7,861</td><td>843.00</td></tr> <tr><td>2021</td><td>2021-660004650</td><td>PASDACH, JOHN &</td><td>11</td><td>88,485</td><td>1000</td><td>7,603</td><td>788.00</td></tr> <tr><td>2020</td><td>2020-660004650</td><td>PASDACH, JOHN &</td><td>11</td><td>84,631</td><td>1000</td><td>7,352</td><td>786.00</td></tr> <tr><td>2019</td><td>2019-660004650</td><td>PASDACH, JOHN &</td><td>11</td><td>73,718</td><td>1000</td><td>7,109</td><td>751.00</td></tr> <tr><td>2018</td><td>2018-660004650</td><td>PASDACH, JOHN &</td><td>11</td><td>76,051</td><td>1000</td><td>7,365</td><td>785.00</td></tr> <tr><td>2017</td><td>2017-660004650</td><td>PASDACH, JOHN &</td><td>11</td><td>75,519</td><td>1000</td><td>7,307</td><td>761.00</td></tr> <tr><td>2016</td><td>2016-660004650</td><td>PASDACH, JOHN &</td><td>11</td><td>73,756</td><td>1000</td><td>7,113</td><td>746.00</td></tr> <tr><td>2015</td><td>2015-660004650</td><td>PASDACH, JOHN &</td><td>11</td><td>73,447</td><td>1000</td><td>7,079</td><td>748.00</td></tr> <tr><td>2014</td><td>2014-660004650</td><td>PASDACH, JOHN &</td><td>11</td><td>75,088</td><td>1000</td><td>6,953</td><td>735.00</td></tr> <tr><td>2013</td><td>2013-660004650</td><td>PASDACH, JOHN &</td><td>11</td><td>72,406</td><td>1000</td><td>6,722</td><td>699.00</td></tr> </tbody> </table>										Tax Year	Statement Number	Billed Owner	Tax Area	Total Value	Exemptions	Taxable Value	Billed Tax	2025	2025-660004650	PASDACH, JOHN &	11	151,364	1000	8,681	903.00	2024	2024-660004650	PASDACH, JOHN &	11	159,128	1000	8,401	877.00	2023	2023-660004650	PASDACH, JOHN &	11	96,378	1000	8,126	866.00	2022	2022-660004650	PASDACH, JOHN &	11	95,690	1000	7,861	843.00	2021	2021-660004650	PASDACH, JOHN &	11	88,485	1000	7,603	788.00	2020	2020-660004650	PASDACH, JOHN &	11	84,631	1000	7,352	786.00	2019	2019-660004650	PASDACH, JOHN &	11	73,718	1000	7,109	751.00	2018	2018-660004650	PASDACH, JOHN &	11	76,051	1000	7,365	785.00	2017	2017-660004650	PASDACH, JOHN &	11	75,519	1000	7,307	761.00	2016	2016-660004650	PASDACH, JOHN &	11	73,756	1000	7,113	746.00	2015	2015-660004650	PASDACH, JOHN &	11	73,447	1000	7,079	748.00	2014	2014-660004650	PASDACH, JOHN &	11	75,088	1000	6,953	735.00	2013	2013-660004650	PASDACH, JOHN &	11	72,406	1000	6,722	699.00
Tax Year	Statement Number	Billed Owner	Tax Area	Total Value	Exemptions	Taxable Value	Billed Tax																																																																																																																		
2025	2025-660004650	PASDACH, JOHN &	11	151,364	1000	8,681	903.00																																																																																																																		
2024	2024-660004650	PASDACH, JOHN &	11	159,128	1000	8,401	877.00																																																																																																																		
2023	2023-660004650	PASDACH, JOHN &	11	96,378	1000	8,126	866.00																																																																																																																		
2022	2022-660004650	PASDACH, JOHN &	11	95,690	1000	7,861	843.00																																																																																																																		
2021	2021-660004650	PASDACH, JOHN &	11	88,485	1000	7,603	788.00																																																																																																																		
2020	2020-660004650	PASDACH, JOHN &	11	84,631	1000	7,352	786.00																																																																																																																		
2019	2019-660004650	PASDACH, JOHN &	11	73,718	1000	7,109	751.00																																																																																																																		
2018	2018-660004650	PASDACH, JOHN &	11	76,051	1000	7,365	785.00																																																																																																																		
2017	2017-660004650	PASDACH, JOHN &	11	75,519	1000	7,307	761.00																																																																																																																		
2016	2016-660004650	PASDACH, JOHN &	11	73,756	1000	7,113	746.00																																																																																																																		
2015	2015-660004650	PASDACH, JOHN &	11	73,447	1000	7,079	748.00																																																																																																																		
2014	2014-660004650	PASDACH, JOHN &	11	75,088	1000	6,953	735.00																																																																																																																		
2013	2013-660004650	PASDACH, JOHN &	11	72,406	1000	6,722	699.00																																																																																																																		



Rogers

Assessment Property Record Card for Tax Year 2026

Data provided by LISA DELOZIER County Assessor

Date 04/17/2026
Time 02:24:40
Page 2

Lot Data	Square-Foot - UNPLATTED (ACRES)	Primary Image
Lot Size		
Lot Count		
Units Buildable	2.5	
Non-Ag Acres	0	
Topography		
Street Access		
Utilities		
Amenities	LAND QUALITY	
	0	
	0	
Method	Square-Foot	
Base Lot Value	107,333.00 x .68 = 73,442	
Factor Value		
Adjustments	1.0000	
Lot Value	73,442	

Residential Data	
Type	1 Single Family Residence
Condition	3 - Average
Quality	1.5 - Low
Architecture	
Style	100% One Story
Exterior Wall	100% Frame, Siding, Wood
Base/Total Area	864 / 864
Style	100% One Story
HVAC	100% Warmed & Cooled Air
Roof Cover	4 Metal, Preformed
Area on Slab	0
Fixture/RghIn	4 /
Bed/F/H Bath	2 / 1.0 /
Basement Area	
Garage Type	
Remodel	
Year/Eff Age	1980 / 35



\\tsclient\T\LOGAN\LOGAN RESIDENTIAL VI\2022-11-4\IMG_000! 11/4/2022

GRM Approach	
GRM Code	
Gross Rent	0.00
Indicated Value	

Multiple Regression			
MRA Code	1	Test	
Adusted R	0.8445		
Indicated Value	78,547	90.91	Per SqFt

Direct Comparables	
Selection Model	1 Res
Adjustment Model	A2 AO Test
Comparables	
Indicated Value	

Value Reconciliation			
Selected Approach	Cost Approach		
Improvements	64,692		
Lot Value	73,442		
Indicated Value	138,134	159.88	Per SqFt
Agland Value			
Site Improvements	20,015		
Total Value	158,149	183.04	Total Value Per SqFt

Cost Approach				Manual : 01/2025			
Base Cost	94.11	Total Misc Impr	+	7,626			
Roofing Adj	+ 5.10	Garage Cost	+				
Subfloor Adj	+ 2.59	Total RCN	=	108,930			
Heat/Cool Adj	+ 9.89	Depreciation (46%)	-	50,108			
Plumbing Adj	+ 5.56	Lump Sums	+	5,870			
Basement Adj	+ 0.00	RCNLD	=	64,692			
Adj Base Cost	= 117.25	Lot Value	+	73,442			
Total Area	x 864	Indicated Value	=	138,134			
Adjusted Cost	= 101,304	Value Per SqFt		159.88			

Miscellaneous Improvements								
Code	Description	Sketch ID	Size	Year	Units	Unit Cost	Depr	Value
EPSW	ENCLOSED PORCH - SOLID WALL	11927	12x12		144	52.96		7,626
WODC	WOOD DECK - COVERED	140791	14x12		168	34.94		5,870



Rogers

Assessment Property Record Card for Tax Year 2026

Data provided by LISA DELOZIER County Assessor

Date 04/17/2026

Time 02:24:40

Page 3

Sketch Image

660004650

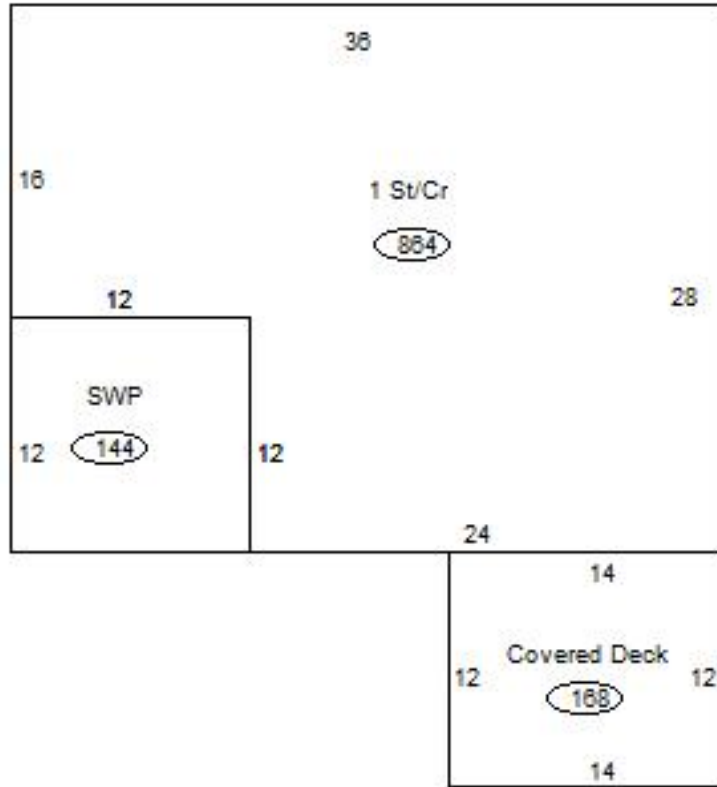

Sketch Vector Information

Sequence	Code	Type	Built Over	Scale	Section Label	Base Area	Multiplier	Total Area
1	R	1	Crawl	13	1 St/Cr	864	1.000	864
2	M	EPSW		13	EPSW	144	1.000	144
3	M	WODC		13	WODC	168	1.000	168
Total Building Area						864		864



Rogers



Assessment Property Record Card for Tax Year 2026

Data provided by LISA DELOZIER County Assessor

Date 04/17/2026
Time 02:24:40
Page 4

660004650

Outbuildings/Site Improvements

Building Image	Code	Description	Dimensions	Floor	Roofing	Total Units
	UTIL	SHOP BUILDING	0x0x0			720
	Qual 2	Cond 3	Year		Eff Age	
	Valuation Summary		Modifier Total	RCN	Depr (35% Phys/ % Func)	RCNLD
	Base Cost (31.28 x 720)	22,522		22,522	7,883	14,639
	BARN	BARN	0x0x0			540
	Qual 3	Cond 3	Year		Eff Age	
	Valuation Summary		Modifier Total	RCN	Depr (5% Phys/ % Func)	RCNLD
	Base Cost (10.48 x 540)	5,659		5,659	283	5,376
	STF	STG FAIR	0x0x0			
	Qual 2	Cond	Year		Eff Age	
	Valuation Summary		Modifier Total	RCN	Depr (100% Phys/ % Func)	RCNLD
	Base Cost (4.68 x)					