



Rogers

Assessment Property Record Card for Tax Year 2026

Data provided by LISA DELOZIER County Assessor

Date 04/17/2026
 Time 02:24:42
 Page 1

Assessment Data					Primary Image				
Account	660004656								
Parcel ID	22N16E-05-4-00000-000-0000								
Cadastral ID	05-22-16-00800								
Property Type	REAL - Real Property								
Property Class	RR	VI Area 1							
Tax Area	11 - SEQUOYAH/NW FIRE								
Name ID	332927								
ESLICK, RHONDA L									
13600 S 4150 RD CLAREMORE OK 74017-0000									
Parcel Location									
Situs	13600 S 4150 RD								
Subdivision									
Lot/Block	/	Parcel Size	2.38 - Acres						
Sec/Twn/Rng	5 / 22 / 16 / 4								
Neighborhood	6030 - UNPLATTED								
School District	S006 - SEQUOYAH SCHOOLS								
Legal Description Lat/Long: 36.41467911 -95.61554017									
Building Permits									
SE NE NE SE LESS N 16' FOR RD									
Exemptions									
Code	Type	Active	Maximum	Exemption	Bk/Pg	Grantor	Date	Price	Code
H	Homestead	No	1,000		/	ESLICK, DONAL FAMILY TRUST	06/25/2020	0	4
					2643/792	EMERSON, FRANCES LEE	04/17/2017	95,000	YES
Parcel Valuation									
Source	REAL	Fair Cash	Capped	Asmnt Level	Assessed	Levy Rate	102.332	Current Tax	
Remove Cap	2018	Land Value	74,194	38,153	11%	4,197	Assessed	12,675	1,297.05
Year Frozen	0	Improvements	26,550	18,941		2,083	Penalty	0	
Uncapped Value	0	Mobile Home	59,505	58,140		6,395	Exemption	0	0.00
TIF Project ID	0	Total Value	160,249	115,234		12,675	Total Taxable	12,675	1,297.00
Assessment History									
Tax Year	Statement Number	Billed Owner	Tax Area	Total Value	Exemptions	Taxable Value	Billed Tax		
2025	2025-660004656	ESLICK, RHONDA L	11	158,437	0	12,073	1,235.00		
2024	2024-660004656	ESLICK, RHONDA L	11	153,867	0	11,498	1,181.00		
2023	2023-660004656	ESLICK, RHONDA L	11	107,888	0	10,950	1,147.00		
2022	2022-660004656	ESLICK, RHONDA L	11	94,804	0	10,429	1,100.00		
2021	2021-660004656	ESLICK, RHONDA L	11	103,148	0	11,215	1,142.00		
2020	2020-660004656	ESLICK, DONAL FAMILY TRUST	11	99,242	0	10,681	1,122.00		
2019	2019-660004656	ESLICK, DONAL FAMILY TRUST	11	92,483	0	10,173	1,055.00		
2018	2018-660004656	ESLICK, DONAL FAMILY TRUST	11	95,105	0	10,462	1,096.00		
2017	2017-660004656	ESLICK, DONAL FAMILY TRUST	11	94,289	1000	8,947	929.00		
2016	2016-660004656	EMERSON, FRANCES LEE	11	87,798	1000	8,657	905.00		
2015	2015-660004656	EMERSON, FRANCES LEE	11	87,705	1000	8,648	911.00		
2014	2014-660004656	EMERSON, FRANCES LEE	11	87,630	1000	8,639	910.00		
2013	2013-660004656	EMERSON, FRANCES LEE	11	87,786	1000	8,657	897.00		



Rogers

Assessment Property Record Card for Tax Year 2026

Data provided by LISA DELOZIER County Assessor

Date 04/17/2026
 Time 02:24:42
 Page 2

Lot Data	Square-Foot - UNPLATTED (ACRES)	Primary Image
Lot Size		
Lot Count		
Units Buildable	2.38	
Non-Ag Acres	0	
Topography		
Street Access		
Utilities		
Amenities	LAND QUALITY	
	0	
	0	
Method	Square-Foot	
Base Lot Value	110,338.00 x .67 = 74,194	
Factor Value		
Adjustments	1.0000	
Lot Value	74,194	

Residential Data	
Type	1 Single Family Residence
Condition	1 - Low
Quality	1.5 - Low
Architecture	
Style	100% One Story
Exterior Wall	100% Veneer, Stone
Base/Total Area	880 / 880
Style	100% One Story
HVAC	
Roof Cover	1 Composition Shingle
Area on Slab	0
Fixture/RghIn	4 /
Bed/F/H Bath	2 / 1.0 /
Basement Area	
Garage Type	
Remodel	
Year/Eff Age	1955 / 99



\\tsclient\T\LOGAN\LOGAN RESIDENTIAL VI\2023-3-17\IMG_000' 3/17/2023

GRM Approach	
GRM Code	
Gross Rent	0.00
Indicated Value	

Multiple Regression			
MRA Code	1	Test	
Adusted R	0.8445		
Indicated Value	42,572	48.38	Per SqFt

Direct Comparables	
Selection Model	1 Res
Adjustment Model	A2 AO Test
Comparables	
Indicated Value	

Cost Approach				Manual : 01/2025	
Base Cost	107.90	Total Misc Impr	+	3,968	
Roofing Adj	+ 4.22	Garage Cost	+		
Subfloor Adj	+ 2.50	Total RCN	=	109,647	
Heat/Cool Adj	+ 0.00	Depreciation (80%)	-	87,718	
Plumbing Adj	+ 5.47	Lump Sums	+	0	
Basement Adj	+ 0.00	RCNLD	=	21,929	
Adj Base Cost	= 120.09	Lot Value	+	74,194	
Total Area	x 880	Indicated Value	=	96,123	
Adjusted Cost	= 105,679	Value Per SqFt		109.23	

Value Reconciliation			
Selected Approach	Cost Approach		
Improvements	21,929		
Lot Value	74,194		
Indicated Value	96,123	109.23	Per SqFt
Agland Value			
Site Improvements	4,621		
Total Value	100,744	114.48	Total Value Per SqFt

Miscellaneous Improvements								
Code	Description	Sketch ID	Size	Year	Units	Unit Cost	Depr	Value
SHLT	STORM SHELTER	0		1 2011	1	0.00		
PRCH	SLAB PORCH - COVERED	11936	18x6		108	20.24		2,186
PATO	SLAB PORCH - OPEN	11937	20x10		200	8.91		1,782



Rogers

Assessment Property Record Card for Tax Year 2026

Data provided by LISA DELOZIER County Assessor

Date 04/17/2026

Time 02:24:42

Page 3

Sketch Image

660004656

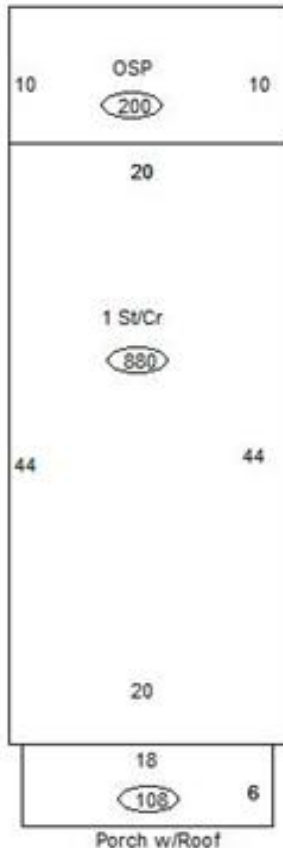

Sketch Vector Information

Sequence	Code	Type	Built Over	Scale	Section Label	Base Area	Multiplier	Total Area
1	R	1	Crawl	13	1 St/Cr	880	1.000	880
2	M	PRCH		13	SLBC	108	1.000	108
3	M	PATO		13	Open Slab	200	1.000	200
Total Building Area						880		880



Rogers



Assessment Property Record Card for Tax Year 2026

Data provided by LISA DELOZIER County Assessor

Date 04/17/2026
 Time 02:24:42
 Page 4

660004656

Outbuildings/Site Improvements

Building Image	Code	Description	Dimensions	Floor	Roofing	Total Units
	STF STG FAIR		0x0x0			400
	Qual 2	Cond 3	Year	Eff Age		
	Valuation Summary		Modifier Total	RCN	Depr (60% Phys/ % Func)	RCNLD
Base Cost (4.68 x 400)		1,872		1,872	1,123	749
	DTGF DETACHED GARAGE FAIR		0x0x0			484
	Qual 2	Cond 3	Year	Eff Age		
	Valuation Summary		Modifier Total	RCN	Depr (50% Phys/ % Func)	RCNLD
Base Cost (16.00 x 484)		7,744		7,744	3,872	3,872



Rogers

Assessment Property Record Card for Tax Year 2026

Data provided by LISA DELOZIER County Assessor

Date 04/17/2026
 Time 02:24:43
 Page 5

Lot Data	Primary Image
Lot Size Lot Count Units Buildable Non-Ag Acres Topography Street Access Utilities Amenities LAND QUALITY Method Base Lot Value Factor Value Adjustments Lot Value	

Residential Data	
Type	6 Mobile Home 56 x 30
Condition	4 - Good
Quality	4.3 - Good
Architecture	6 MS ADJ
Style	100% Double Wide
Exterior Wall	100% Frame, Siding, Vinyl
Base/Total Area	1,680 / 1,680
Style	100% Double Wide
HVAC	100% Warmed & Cooled Air
Roof Cover	1 Composition Shingle
Area on Slab	0
Fixture/RghIn	/
Bed/F/H Bath	2 / /
Basement Area	
Garage Type	
Remodel	
Year/Eff Age	2004 / 13

\\tsclient\T\LOGAN\LOGAN RESIDENTIAL VI\2022-11-2\IMG_002 11/2/2022

GRM Approach	
GRM Code	
Gross Rent	0.00
Indicated Value	

Multiple Regression	
MRA Code	
Adusted R	
Indicated Value	

Direct Comparables	
Selection Model	1 Res
Adjustment Model	A2 AO Test
Comparables	
Indicated Value	

Cost Approach				Manual : 01/2025			
Base Cost	41.32	Total Misc Impr	+ 0	Roofing Adj	+ 3.74	Garage Cost	+ 0
Subfloor Adj	+ 0.00	Total RCN	= 104,395	Heat/Cool Adj	+ 3.74	Depreciation (43%)	- 44,890
Plumbing Adj	+ 13.34	Lump Sums	+ 0	Basement Adj	+ 0.00	RCNLD	= 59,505
Adj Base Cost	= 62.14	Lot Value	+ 59,505	Total Area	x 1,680	Indicated Value	= 59,505
		Value Per SqFt	35.42	Adjusted Cost	= 104,395		

Value Reconciliation			
Selected Approach	Cost Approach		
Improvements	59,505		
Lot Value			
Indicated Value	59,505	35.42	Per SqFt
Agland Value			
Site Improvements			
Total Value	59,505	35.42	Total Value Per SqFt

Miscellaneous Improvements							
Code	Description	Sketch ID	Size	Year	Units	Unit Cost	Depr Value



Rogers

Assessment Property Record Card for Tax Year 2026

Data provided by LISA DELOZIER County Assessor

Date 04/17/2026
Time 02:24:43
Page 6

Sketch Image

660004656



Sketch Vector Information

Sequence	Code	Type	Built Over	Scale	Section Label	Base Area	Multiplier	Total Area
1	R	14		10	Doublewide	1,680	1.000	1,680
Total Building Area						1,680		1,680