



Rogers

Assessment Property Record Card for Tax Year 2026

Data provided by LISA DELOZIER County Assessor

Date 04/17/2026
Time 02:24:44
Page 1

Assessment Data					Primary Image																																																																																																																				
Account 660004660 Parcel ID 22N16E-05-1-00000-000-0000 Cadastral ID 05-22-16-01200 Property Type REAL - Real Property Property Class RR VI Area 1 Tax Area 11 - SEQUOYAH/NW FIRE Name ID 36304 CAMPBELL, ROBERT D JR & DANA M 11560 E KAY ST CLAREMORE OK 74017-0000 Parcel Location Situs 11560 E KAY ST Subdivision Lot/Block / Parcel Size 2.76 - Acres Sec/Twn/Rng 5 / 22 / 16 / 1 Neighborhood 6030 - UNPLATTED School District S006 - SEQUOYAH SCHOOLS																																																																																																																									
Legal Description Lat/Long: 36.41741092 -95.62330933 TR S2 NE, BEG: 355' N SW/C S2 NE, N 305', E 395.31', S 305', W 395.33' TO POB																																																																																																																									
Exemptions <table border="1"> <thead> <tr> <th>Code</th> <th>Type</th> <th>Active</th> <th>Maximum</th> <th>Exemption</th> </tr> </thead> <tbody> <tr> <td>H</td> <td>Homestead</td> <td>Yes</td> <td>1,000</td> <td>1,000</td> </tr> </tbody> </table>					Code	Type	Active	Maximum	Exemption	H	Homestead	Yes	1,000	1,000	Building Permits <table border="1"> <thead> <tr> <th>Number</th> <th>Description</th> <th>Opened</th> <th>Closed</th> <th>Amount</th> </tr> </thead> <tbody> <tr> <td colspan="5"> </td> </tr> </tbody> </table>					Number	Description	Opened	Closed	Amount																																																																																																	
Code	Type	Active	Maximum	Exemption																																																																																																																					
H	Homestead	Yes	1,000	1,000																																																																																																																					
Number	Description	Opened	Closed	Amount																																																																																																																					
Parcel Valuation <table border="1"> <thead> <tr> <th>Source</th> <th>REAL</th> <th>Fair Cash</th> <th>Capped</th> <th>Asmnt Level</th> <th>Assessed</th> <th>Levy Rate</th> <th>102.332</th> <th>Current Tax</th> </tr> </thead> <tbody> <tr> <td>Remove Cap</td> <td>0</td> <td>Land Value 76,615</td> <td>40,586</td> <td>11%</td> <td>4,464</td> <td>Assessed</td> <td>9,753</td> <td>998.04</td> </tr> <tr> <td>Year Frozen</td> <td>0</td> <td>Improvements 89,769</td> <td>48,084</td> <td></td> <td>5,289</td> <td>Penalty</td> <td>0</td> <td></td> </tr> <tr> <td>Uncapped Value</td> <td>0</td> <td>Mobile Home 0</td> <td>0</td> <td></td> <td>0</td> <td>Exemption</td> <td>1,000</td> <td>-88.00</td> </tr> <tr> <td>TIF Project ID</td> <td>0</td> <td>Total Value 166,384</td> <td>88,670</td> <td></td> <td>9,753</td> <td>Total Taxable</td> <td>8,753</td> <td>910.00</td> </tr> </tbody> </table>					Source	REAL	Fair Cash	Capped	Asmnt Level	Assessed	Levy Rate	102.332	Current Tax	Remove Cap	0	Land Value 76,615	40,586	11%	4,464	Assessed	9,753	998.04	Year Frozen	0	Improvements 89,769	48,084		5,289	Penalty	0		Uncapped Value	0	Mobile Home 0	0		0	Exemption	1,000	-88.00	TIF Project ID	0	Total Value 166,384	88,670		9,753	Total Taxable	8,753	910.00	Sale History <table border="1"> <thead> <tr> <th>Bk/Pg</th> <th>Grantor</th> <th>Date</th> <th>Price</th> <th>Code</th> </tr> </thead> <tbody> <tr> <td colspan="5"> </td> </tr> </tbody> </table>					Bk/Pg	Grantor	Date	Price	Code																																																														
Source	REAL	Fair Cash	Capped	Asmnt Level	Assessed	Levy Rate	102.332	Current Tax																																																																																																																	
Remove Cap	0	Land Value 76,615	40,586	11%	4,464	Assessed	9,753	998.04																																																																																																																	
Year Frozen	0	Improvements 89,769	48,084		5,289	Penalty	0																																																																																																																		
Uncapped Value	0	Mobile Home 0	0		0	Exemption	1,000	-88.00																																																																																																																	
TIF Project ID	0	Total Value 166,384	88,670		9,753	Total Taxable	8,753	910.00																																																																																																																	
Bk/Pg	Grantor	Date	Price	Code																																																																																																																					
Assessment History <table border="1"> <thead> <tr> <th>Tax Year</th> <th>Statement Number</th> <th>Billed Owner</th> <th>Tax Area</th> <th>Total Value</th> <th>Exemptions</th> <th>Taxable Value</th> <th>Billed Tax</th> </tr> </thead> <tbody> <tr><td>2025</td><td>2025-660004660</td><td>CAMPBELL, ROBERT D JR &</td><td>11</td><td>151,487</td><td>1000</td><td>8,469</td><td>881.00</td></tr> <tr><td>2024</td><td>2024-660004660</td><td>CAMPBELL, ROBERT D JR &</td><td>11</td><td>151,740</td><td>1000</td><td>8,194</td><td>856.00</td></tr> <tr><td>2023</td><td>2023-660004660</td><td>CAMPBELL, ROBERT D JR &</td><td>11</td><td>95,711</td><td>1000</td><td>7,926</td><td>845.00</td></tr> <tr><td>2022</td><td>2022-660004660</td><td>CAMPBELL, ROBERT D JR &</td><td>11</td><td>93,711</td><td>1000</td><td>7,667</td><td>823.00</td></tr> <tr><td>2021</td><td>2021-660004660</td><td>CAMPBELL, ROBERT D JR &</td><td>11</td><td>82,245</td><td>1000</td><td>7,414</td><td>768.00</td></tr> <tr><td>2020</td><td>2020-660004660</td><td>CAMPBELL, ROBERT D JR &</td><td>11</td><td>77,186</td><td>1000</td><td>7,169</td><td>768.00</td></tr> <tr><td>2019</td><td>2019-660004660</td><td>CAMPBELL, ROBERT D JR &</td><td>11</td><td>72,100</td><td>1000</td><td>6,931</td><td>733.00</td></tr> <tr><td>2018</td><td>2018-660004660</td><td>CAMPBELL, ROBERT D JR &</td><td>11</td><td>75,998</td><td>1000</td><td>6,983</td><td>746.00</td></tr> <tr><td>2017</td><td>2017-660004660</td><td>CAMPBELL, ROBERT D JR &</td><td>11</td><td>75,625</td><td>1000</td><td>6,751</td><td>704.00</td></tr> <tr><td>2016</td><td>2016-660004660</td><td>CAMPBELL, ROBERT D JR &</td><td>11</td><td>74,582</td><td>1000</td><td>6,525</td><td>686.00</td></tr> <tr><td>2015</td><td>2015-660004660</td><td>CAMPBELL, ROBERT D JR &</td><td>11</td><td>73,444</td><td>1000</td><td>6,306</td><td>668.00</td></tr> <tr><td>2014</td><td>2014-660004660</td><td>CAMPBELL, ROBERT D JR &</td><td>11</td><td>74,421</td><td>1000</td><td>6,093</td><td>645.00</td></tr> <tr><td>2013</td><td>2013-660004660</td><td>CAMPBELL, ROBERT D JR &</td><td>11</td><td>74,741</td><td>1000</td><td>5,886</td><td>613.00</td></tr> </tbody> </table>					Tax Year	Statement Number	Billed Owner	Tax Area	Total Value	Exemptions	Taxable Value	Billed Tax	2025	2025-660004660	CAMPBELL, ROBERT D JR &	11	151,487	1000	8,469	881.00	2024	2024-660004660	CAMPBELL, ROBERT D JR &	11	151,740	1000	8,194	856.00	2023	2023-660004660	CAMPBELL, ROBERT D JR &	11	95,711	1000	7,926	845.00	2022	2022-660004660	CAMPBELL, ROBERT D JR &	11	93,711	1000	7,667	823.00	2021	2021-660004660	CAMPBELL, ROBERT D JR &	11	82,245	1000	7,414	768.00	2020	2020-660004660	CAMPBELL, ROBERT D JR &	11	77,186	1000	7,169	768.00	2019	2019-660004660	CAMPBELL, ROBERT D JR &	11	72,100	1000	6,931	733.00	2018	2018-660004660	CAMPBELL, ROBERT D JR &	11	75,998	1000	6,983	746.00	2017	2017-660004660	CAMPBELL, ROBERT D JR &	11	75,625	1000	6,751	704.00	2016	2016-660004660	CAMPBELL, ROBERT D JR &	11	74,582	1000	6,525	686.00	2015	2015-660004660	CAMPBELL, ROBERT D JR &	11	73,444	1000	6,306	668.00	2014	2014-660004660	CAMPBELL, ROBERT D JR &	11	74,421	1000	6,093	645.00	2013	2013-660004660	CAMPBELL, ROBERT D JR &	11	74,741	1000	5,886	613.00	\\tsclient\T\LOGAN\LOGAN RESIDENTIAL VI\2022-11-2\IMG_003i 11/2/2022				
Tax Year	Statement Number	Billed Owner	Tax Area	Total Value	Exemptions	Taxable Value	Billed Tax																																																																																																																		
2025	2025-660004660	CAMPBELL, ROBERT D JR &	11	151,487	1000	8,469	881.00																																																																																																																		
2024	2024-660004660	CAMPBELL, ROBERT D JR &	11	151,740	1000	8,194	856.00																																																																																																																		
2023	2023-660004660	CAMPBELL, ROBERT D JR &	11	95,711	1000	7,926	845.00																																																																																																																		
2022	2022-660004660	CAMPBELL, ROBERT D JR &	11	93,711	1000	7,667	823.00																																																																																																																		
2021	2021-660004660	CAMPBELL, ROBERT D JR &	11	82,245	1000	7,414	768.00																																																																																																																		
2020	2020-660004660	CAMPBELL, ROBERT D JR &	11	77,186	1000	7,169	768.00																																																																																																																		
2019	2019-660004660	CAMPBELL, ROBERT D JR &	11	72,100	1000	6,931	733.00																																																																																																																		
2018	2018-660004660	CAMPBELL, ROBERT D JR &	11	75,998	1000	6,983	746.00																																																																																																																		
2017	2017-660004660	CAMPBELL, ROBERT D JR &	11	75,625	1000	6,751	704.00																																																																																																																		
2016	2016-660004660	CAMPBELL, ROBERT D JR &	11	74,582	1000	6,525	686.00																																																																																																																		
2015	2015-660004660	CAMPBELL, ROBERT D JR &	11	73,444	1000	6,306	668.00																																																																																																																		
2014	2014-660004660	CAMPBELL, ROBERT D JR &	11	74,421	1000	6,093	645.00																																																																																																																		
2013	2013-660004660	CAMPBELL, ROBERT D JR &	11	74,741	1000	5,886	613.00																																																																																																																		



Rogers

Assessment Property Record Card for Tax Year 2026

Data provided by LISA DELOZIER County Assessor

Date 04/17/2026
 Time 02:24:44
 Page 2

Lot Data		Square-Foot - UNPLATTED (ACRES)		Primary Image				
Lot Size								
Lot Count								
Units Buildable	2.76							
Non-Ag Acres	2.7554							
Topography								
Street Access								
Utilities								
Amenities	LAND QUALITY		0					
			0					
Method	Square-Foot							
Base Lot Value	120,024.00 x .64 = 76,615			<p>\\tsclient\T\LOGAN\LOGAN RESIDENTIAL VI\2022-11-2\IMG_003 11/2/2022</p>				
Factor Value				GRM Approach				
Adjustments	1.0000			GRM Code				
Lot Value	76,615			Gross Rent 0.00				
Residential Data				Indicated Value				
Type				Multiple Regression				
Condition	-			MRA Code				
Quality	-			Adusted R				
Architecture				Indicated Value				
Style				Direct Comparables				
Exterior Wall				Selection Model 1 Res				
Base/Total Area /				Adjustment Model A2 AO Test				
Style				Comparables				
HVAC				Indicated Value				
Roof Cover				Value Reconciliation				
Area on Slab				Selected Approach Cost Approach				
Fixture/RghIn /				Improvements				
Bed/F/H Bath / /				Lot Value 76,615				
Basement Area				Indicated Value 76,615 0.00 Per SqFt				
Garage Type				Agland Value				
Remodel				Site Improvements 52,977				
Year/Eff Age /				Total Value 129,592 0.00 Total Value Per SqFt				
Cost Approach				Manual : 01/2025				
Base Cost	0.00	Total Misc Impr	+ 0					
Roofing Adj	+ 0.00	Garage Cost	+ 0					
Subfloor Adj	+ 0.00	Total RCN	= 0					
Heat/Cool Adj	+ 0.00	Depreciation (0%)	- 0					
Plumbing Adj	+ 0.00	Lump Sums	+ 0					
Basement Adj	+ 0.00	RCNLD	= 0					
Adj Base Cost	= 0.00	Lot Value	+ 76,615					
Total Area	x	Indicated Value	= 76,615					
Adjusted Cost	= 0	Value Per SqFt	0.00					
Miscellaneous Improvements								
Code	Description	Sketch ID	Size	Year	Units	Unit Cost	Depr	Value



Rogers



Assessment Property Record Card for Tax Year 2026

Data provided by LISA DELOZIER County Assessor

Date 04/17/2026
Time 02:24:44
Page 3

660004660

Outbuildings/Site Improvements

Building Image	Code	Description	Dimensions	Floor	Roofing	Total Units
	UTIL	SHOP BUILDING	0x0x0			2,000
	Qual 2	Cond 3	Year	Eff Age		
	Valuation Summary		Modifier Total	RCN	Depr (5% Phys/ % Func)	RCNLD
	Base Cost (26.89 x 2,000)		53,780	53,780	2,689	51,091
	BARN	BARN	0x0x0			360
	Qual 3	Cond 3	Year	Eff Age		
	Valuation Summary		Modifier Total	RCN	Depr (50% Phys/ % Func)	RCNLD
	Base Cost (10.48 x 360)		3,773	3,773	1,887	1,886



Rogers

Assessment Property Record Card for Tax Year 2026

Data provided by LISA DELOZIER County Assessor

Date 04/17/2026
 Time 02:24:45
 Page 4

Lot Data		Primary Image						
Lot Size	-							
Lot Count								
Units Buildable								
Non-Ag Acres								
Topography								
Street Access								
Utilities								
Amenities	LAND QUALITY							
Method								
Base Lot Value								
Factor Value								
Adjustments								
Lot Value								
Residential Data								
Type	6 Mobile Home 62 x 28							
Condition	3 - Average							
Quality	3 - Average							
Architecture								
Style	100% Double Wide							
Exterior Wall	100% Frame, Siding, Wood							
Base/Total Area	1,736 / 1,736							
Style	100% Double Wide							
HVAC	100% Warmed & Cooled Air							
Roof Cover	1 Composition Shingle							
Area on Slab	0							
Fixture/RghIn	11 /							
Bed/F/H Bath	3 / 2.0 /							
Basement Area								
Garage Type								
Remodel								
Year/Eff Age	1982 / 33							
Cost Approach		Manual : 01/2025						
Base Cost	56.67	Total Misc Impr	+ 5,349					
Roofing Adj	+ 2.56	Garage Cost	+ 0					
Subfloor Adj	+ 0.00	Total RCN	= 126,869					
Heat/Cool Adj	+ 2.50	Depreciation (71%)	- 90,077					
Plumbing Adj	+ 8.27	Lump Sums	+ 0					
Basement Adj	+ 0.00	RCNLD	= 36,792					
Adj Base Cost	= 70.00	Lot Value	+ 0					
Total Area	x 1,736	Indicated Value	= 36,792					
Adjusted Cost	= 121,520	Value Per SqFt	21.19					
		GRM Approach						
		GRM Code						
		Gross Rent	0.00					
		Indicated Value						
		Multiple Regression						
		MRA Code	1 Test					
		Adusted R	0.8445					
		Indicated Value	156,446 90.12 Per SqFt					
		Direct Comparables						
		Selection Model	1 Res					
		Adjustment Model	A2 AO Test					
		Comparables						
		Indicated Value						
		Value Reconciliation						
		Selected Approach	Cost Approach					
		Improvements	36,792					
		Lot Value						
		Indicated Value	36,792 21.19 Per SqFt					
		Agland Value						
		Site Improvements						
		Total Value	36,792 21.19 Total Value Per SqFt					
Miscellaneous Improvements								
Code	Description	Sketch ID	Size	Year	Units	Unit Cost	Depr	Value
PRCH	SLAB PORCH - COVERED	11941	344		344	15.55		5,349



Rogers

Assessment Property Record Card for Tax Year 2026

Data provided by LISA DELOZIER County Assessor

Date 04/17/2026
Time 02:24:45
Page 5

Sketch Image

660004660

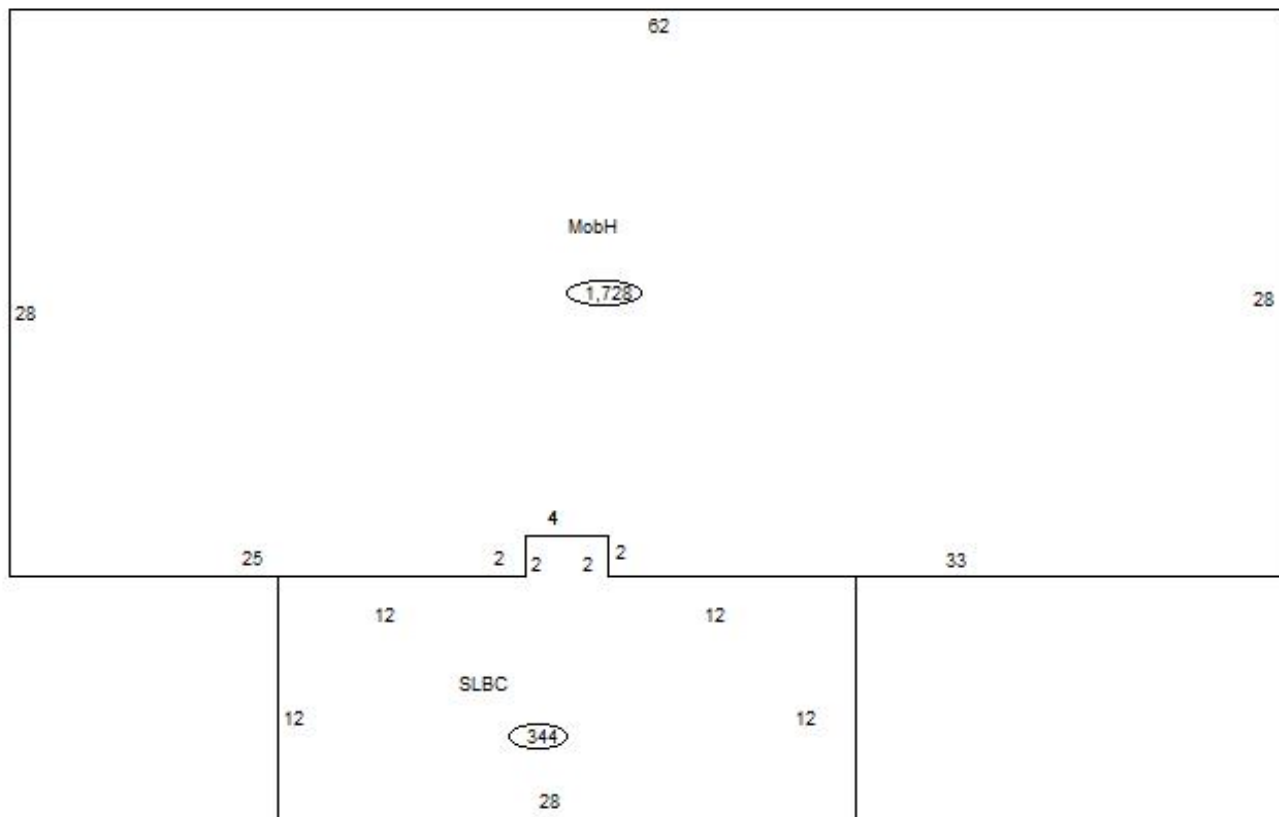

Sketch Vector Information

Sequence	Code	Type	Built Over	Scale	Section Label	Base Area	Multiplier	Total Area
1	R	14		10	MobH	1,728	1.000	1,728
2	M	PRCH		10	SLBC	344	1.000	344
Total Building Area						1,728		1,728