



Rogers

Assessment Property Record Card for Tax Year 2026

Data provided by LISA DELOZIER County Assessor

Date 04/17/2026
 Time 04:16:14
 Page 2

| Lot Data | | Square-Foot - UNPLATTED (ACRES) | | Primary Image | | | | |
|-----------------------------------|---------------------------|---------------------------------|----------|-----------------------------|---------------|-----------|----------------------|-------|
| Lot Size | | | | | | | | |
| Lot Count | | | | | | | | |
| Units Buildable | 2.5 | | | | | | | |
| Non-Ag Acres | 0 | | | | | | | |
| Topography | | | | | | | | |
| Street Access | | | | | | | | |
| Utilities | | | | | | | | |
| Amenities | LAND QUALITY | | 0 | | | | | |
| | | | 0 | | | | | |
| Method | Square-Foot | | | | | | | |
| Base Lot Value | 108,439.00 x .68 = 73,719 | | | | | | | |
| Factor Value | | | | | | | | |
| Adjustments | 1.0000 | | | | | | | |
| Lot Value | 73,719 | | | | | | | |
| Residential Data | | | | GRM Approach | | | | |
| Type | | | | GRM Code | | | | |
| Condition | - | | | Gross Rent | 0.00 | | | |
| Quality | - | | | Indicated Value | | | | |
| Architecture | | | | Multiple Regression | | | | |
| Style | | | | MRA Code | | | | |
| Exterior Wall | | | | Adusted R | | | | |
| Base/Total Area | / | | | Indicated Value | | | | |
| Style | | | | Direct Comparables | | | | |
| HVAC | | | | Selection Model | 1 Res | | | |
| Roof Cover | | | | Adjustment Model | A2 AO Test | | | |
| Area on Slab | | | | Comparables | | | | |
| Fixture/RghIn | / | | | Indicated Value | | | | |
| Bed/F/H Bath | / / | | | Value Reconciliation | | | | |
| Basement Area | | | | Selected Approach | Cost Approach | | | |
| Garage Type | | | | Improvements | | | | |
| Remodel | | | | Lot Value | 73,719 | | | |
| Year/Eff Age | / | | | Indicated Value | 73,719 | 0.00 | Per SqFt | |
| | | | | Agland Value | | | | |
| | | | | Site Improvements | 4,387 | | | |
| | | | | Total Value | 78,106 | 0.00 | Total Value Per SqFt | |
| Cost Approach | | | | Manual : 01/2025 | | | | |
| Base Cost | 0.00 | Total Misc Impr | + 0 | | | | | |
| Roofing Adj | + 0.00 | Garage Cost | + 0 | | | | | |
| Subfloor Adj | + 0.00 | Total RCN | = 0 | | | | | |
| Heat/Cool Adj | + 0.00 | Depreciation (0%) | - 0 | | | | | |
| Plumbing Adj | + 0.00 | Lump Sums | + 0 | | | | | |
| Basement Adj | + 0.00 | RCNLD | = 0 | | | | | |
| Adj Base Cost | = 0.00 | Lot Value | + 73,719 | | | | | |
| Total Area | x | Indicated Value | = 73,719 | | | | | |
| Adjusted Cost | = 0 | Value Per SqFt | 0.00 | | | | | |
| Miscellaneous Improvements | | | | | | | | |
| Code | Description | Sketch ID | Size | Year | Units | Unit Cost | Depr | Value |



Rogers



Assessment Property Record Card for Tax Year 2026

Data provided by LISA DELOZIER County Assessor

Date 04/17/2026
Time 04:16:15
Page 3

660004676

Outbuildings/Site Improvements

| Building Image | Code | Description | Dimensions | Floor | Roofing | Total Units |
|--|--------------------------|--------------|-----------------------|------------|--------------------------------|--------------|
|  | STF | STG FAIR | 0x0x0 | | | 414 |
| | Qual | 2 | Cond 3 | Year 2011 | Eff Age | |
| | Valuation Summary | | Modifier Total | RCN | Depr (0% Phys/ % Func) | RCNLD |
| | Base Cost (4.68 x 414) | | 1,938 | | 1,938 | 1,938 |
|  | STF | STG FAIR | 0x0x0 | | | 414 |
| | Qual | 2 | Cond 3 | Year 2011 | Eff Age | |
| | Valuation Summary | | Modifier Total | RCN | Depr (0% Phys/ % Func) | RCNLD |
| | Base Cost (4.68 x 414) | | 1,938 | | 1,938 | 1,938 |
|  | LF | LOAFING SHED | 0x0x0 | | | 300 |
| | Qual | 3 | Cond 3 | Year | Eff Age | |
| | Valuation Summary | | Modifier Total | RCN | Depr (60% Phys/ % Func) | RCNLD |
| | Base Cost (4.26 x 300) | | 1,278 | | 1,278 | 767 |
| | | | | | | 511 |



Rogers

Assessment Property Record Card for Tax Year 2026

Data provided by LISA DELOZIER County Assessor

Date 04/17/2026
 Time 04:16:15
 Page 4

| Lot Data | | Primary Image | |
|-------------------------|---------------------------|--|----------|
| Lot Size | - | | |
| Lot Count | | | |
| Units Buildable | | | |
| Non-Ag Acres | | | |
| Topography | | | |
| Street Access | | | |
| Utilities | | | |
| Amenities | LAND QUALITY | | |
| Method | | | |
| Base Lot Value | | | |
| Factor Value | | \\tsclient\T\LOGAN\LOGAN RESIDENTIAL VI\2022-11-2\IMG_003; 11/2/2022 | |
| Adjustments | | GRM Approach | |
| Lot Value | | GRM Code | |
| Residential Data | | Gross Rent 0.00 | |
| Type | 6 Mobile Home 48 x 24 | Indicated Value | |
| Condition | 3 - Average | Multiple Regression | |
| Quality | 3.3 - Average | MRA Code | |
| Architecture | 6 MS ADJ | Adusted R | |
| Style | 100% Double Wide | Indicated Value | |
| Exterior Wall | 100% Frame, Siding, Vinyl | Direct Comparables | |
| Base/Total Area | 1,152 / 1,152 | Selection Model 1 Res | |
| Style | 100% Double Wide | Adjustment Model A2 AO Test | |
| HVAC | | Comparables | |
| Roof Cover | 14 Metal, Ribbed | Indicated Value | |
| Area on Slab | 0 | Value Reconciliation | |
| Fixture/RghIn | / | Selected Approach Cost Approach | |
| Bed/F/H Bath | / / | Improvements 30,508 | |
| Basement Area | | Lot Value | |
| Garage Type | | Indicated Value 30,508 26.48 Per SqFt | |
| Remodel | | Agland Value | |
| Year/Eff Age | 1983 / 32 | Site Improvements | |
| Cost Approach | | Total Value 30,508 26.48 Total Value Per SqFt | |
| Manual : 01/2025 | | | |
| Base Cost | 37.30 | Total Misc Impr | + 0 |
| Roofing Adj | + 3.06 | Garage Cost | + 0 |
| Subfloor Adj | + 0.00 | Total RCN | = 59,628 |
| Heat/Cool Adj | + 0.00 | Depreciation (70%) | - 41,740 |
| Plumbing Adj | + 11.40 | Lump Sums | + 12,620 |
| Basement Adj | + 0.00 | RCNLD | = 30,508 |
| Adj Base Cost | = 51.76 | Lot Value | + 30,508 |
| Total Area | x 1,152 | Indicated Value | = 30,508 |
| Adjusted Cost | = 59,628 | Value Per SqFt | 26.48 |

| Miscellaneous Improvements | | | | | | | | |
|----------------------------|---------------------|-----------|-------|------|-------|-----------|------|-------|
| Code | Description | Sketch ID | Size | Year | Units | Unit Cost | Depr | Value |
| WODC | WOOD DECK - COVERED | 140797 | 14x12 | | 168 | 44.53 | 25% | 5,611 |
| WODC | WOOD DECK - COVERED | 140798 | 22x12 | | 264 | 35.40 | 25% | 7,009 |



Rogers

Assessment Property Record Card for Tax Year 2026

Data provided by LISA DELOZIER County Assessor

Date 04/17/2026

Time 04:16:15

Page 5

Sketch Image

660004676

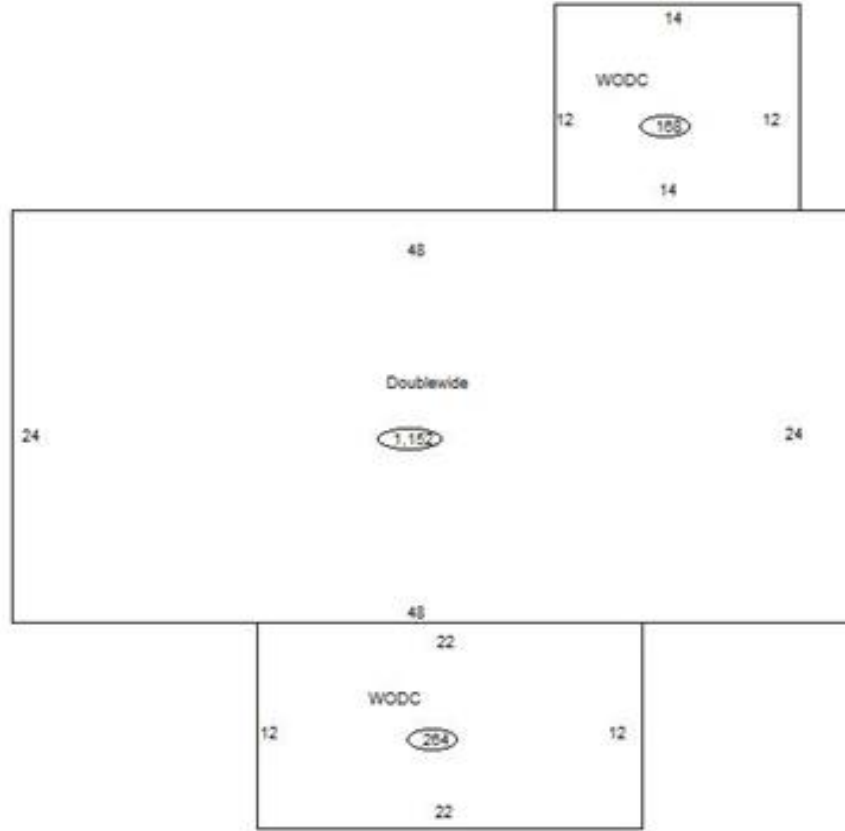

Sketch Vector Information

| Sequence | Code | Type | Built Over | Scale | Section Label | Base Area | Multiplier | Total Area |
|----------------------------|------|------|------------|-------|---------------|-----------|------------|------------|
| 1 | R | 14 | | 10 | Doublewide | 1,152 | 1.000 | 1,152 |
| 2 | M | WODC | | 10 | WODC | 168 | 1.000 | 168 |
| 3 | M | WODC | | 10 | WODC | 264 | 1.000 | 264 |
| Total Building Area | | | | | | 1,152 | | 1,152 |