



Rogers

Assessment Property Record Card for Tax Year 2026

Data provided by LISA DELOZIER County Assessor

Date 04/17/2026
 Time 03:31:02
 Page 1

Assessment Data					Primary Image																																																																																																																				
Account 660004799 Parcel ID 19N17E-06-2-00000-000-0000 Cadastral ID 06-19-17-00500 Property Type REAL - Real Property Property Class RR VI Area 3 Tax Area 2 - INOLA RURAL Name ID 149924 CASTLEBERRY, JOHN ED & JOLENE M FAMILY REVOCABLE TRUST 16534 E 590 RD INOLA OK 74036-0000 Parcel Location Situs 16534 E 590 RD Subdivision Lot/Block / Parcel Size 2 - Acres Sec/Twn/Rng 6 / 19 / 17 / 2 Neighborhood 1917 - UNPLATTED School District S005 - INOLA SCHOOLS					 <p>660004799_003.JPG 12/4/2025</p>																																																																																																																				
Legal Description Lat/Long: 36.16208332 -95.53669534 N 290.4', E 300' W 10.33 AC LOT 2																																																																																																																									
Exemptions <table border="1"> <thead> <tr> <th>Code</th> <th>Type</th> <th>Active</th> <th>Maximum</th> <th>Exemption</th> </tr> </thead> <tbody> <tr> <td>H</td> <td>Homestead</td> <td>Yes</td> <td>1,000</td> <td>1,000</td> </tr> </tbody> </table>					Code	Type	Active	Maximum	Exemption	H	Homestead	Yes	1,000	1,000	Building Permits <table border="1"> <thead> <tr> <th>Number</th> <th>Description</th> <th>Opened</th> <th>Closed</th> <th>Amount</th> </tr> </thead> <tbody> <tr> <td>R12</td> <td>R12-NEW ADDITION TO UTILITY ROOM</td> <td>08/2010</td> <td>07/2011</td> <td></td> </tr> </tbody> </table>					Number	Description	Opened	Closed	Amount	R12	R12-NEW ADDITION TO UTILITY ROOM	08/2010	07/2011																																																																																													
Code	Type	Active	Maximum	Exemption																																																																																																																					
H	Homestead	Yes	1,000	1,000																																																																																																																					
Number	Description	Opened	Closed	Amount																																																																																																																					
R12	R12-NEW ADDITION TO UTILITY ROOM	08/2010	07/2011																																																																																																																						
Parcel Valuation <table border="1"> <thead> <tr> <th>Source</th> <th>REAL</th> <th>Fair Cash</th> <th>Capped</th> <th>Asmnt Level</th> <th>Assessed</th> <th>Levy Rate</th> <th>80.060</th> <th>Current Tax</th> </tr> </thead> <tbody> <tr> <td>Remove Cap</td> <td>0</td> <td>Land Value 55,853</td> <td>42,356</td> <td>11%</td> <td>4,659</td> <td>Assessed</td> <td>24,865</td> <td>1,990.69</td> </tr> <tr> <td>Year Frozen</td> <td>0</td> <td>Improvements 222,236</td> <td>183,696</td> <td></td> <td>20,206</td> <td>Penalty</td> <td>0</td> <td></td> </tr> <tr> <td>Uncapped Value</td> <td>0</td> <td>Mobile Home 0</td> <td>0</td> <td></td> <td>0</td> <td>Exemption</td> <td>1,000</td> <td>-80.00</td> </tr> <tr> <td>TIF Project ID</td> <td>0</td> <td>Total Value 278,089</td> <td>226,052</td> <td></td> <td>24,865</td> <td>Total Taxable</td> <td>23,865</td> <td>1,911.00</td> </tr> </tbody> </table>					Source	REAL	Fair Cash	Capped	Asmnt Level	Assessed	Levy Rate	80.060	Current Tax	Remove Cap	0	Land Value 55,853	42,356	11%	4,659	Assessed	24,865	1,990.69	Year Frozen	0	Improvements 222,236	183,696		20,206	Penalty	0		Uncapped Value	0	Mobile Home 0	0		0	Exemption	1,000	-80.00	TIF Project ID	0	Total Value 278,089	226,052		24,865	Total Taxable	23,865	1,911.00	Sale History <table border="1"> <thead> <tr> <th>Bk/Pg</th> <th>Grantor</th> <th>Date</th> <th>Price</th> <th>Code</th> </tr> </thead> <tbody> <tr> <td></td> <td></td> <td></td> <td></td> <td></td> </tr> </tbody> </table>					Bk/Pg	Grantor	Date	Price	Code																																																														
Source	REAL	Fair Cash	Capped	Asmnt Level	Assessed	Levy Rate	80.060	Current Tax																																																																																																																	
Remove Cap	0	Land Value 55,853	42,356	11%	4,659	Assessed	24,865	1,990.69																																																																																																																	
Year Frozen	0	Improvements 222,236	183,696		20,206	Penalty	0																																																																																																																		
Uncapped Value	0	Mobile Home 0	0		0	Exemption	1,000	-80.00																																																																																																																	
TIF Project ID	0	Total Value 278,089	226,052		24,865	Total Taxable	23,865	1,911.00																																																																																																																	
Bk/Pg	Grantor	Date	Price	Code																																																																																																																					
Assessment History <table border="1"> <thead> <tr> <th>Tax Year</th> <th>Statement Number</th> <th>Billed Owner</th> <th>Tax Area</th> <th>Total Value</th> <th>Exemptions</th> <th>Taxable Value</th> <th>Billed Tax</th> </tr> </thead> <tbody> <tr><td>2025</td><td>2025-660004799</td><td>CASTLEBERRY, JOHN ED &</td><td>2</td><td>235,360</td><td>1000</td><td>23,141</td><td>1,853.00</td></tr> <tr><td>2024</td><td>2024-660004799</td><td>CASTLEBERRY, JOHN ED &</td><td>2</td><td>247,453</td><td>1000</td><td>22,439</td><td>1,804.00</td></tr> <tr><td>2023</td><td>2023-660004799</td><td>CASTLEBERRY, JOHN ED &</td><td>2</td><td>212,964</td><td>1000</td><td>21,756</td><td>1,752.00</td></tr> <tr><td>2022</td><td>2022-660004799</td><td>CASTLEBERRY, JOHN ED &</td><td>2</td><td>200,845</td><td>1000</td><td>21,093</td><td>1,711.00</td></tr> <tr><td>2021</td><td>2021-660004799</td><td>CASTLEBERRY, JOHN ED &</td><td>2</td><td>214,695</td><td>1000</td><td>21,770</td><td>1,744.00</td></tr> <tr><td>2020</td><td>2020-660004799</td><td>CASTLEBERRY, JOHN ED &</td><td>2</td><td>207,583</td><td>1000</td><td>21,108</td><td>1,705.00</td></tr> <tr><td>2019</td><td>2019-660004799</td><td>CASTLEBERRY, JOHN E &</td><td>2</td><td>195,125</td><td>1000</td><td>20,464</td><td>1,691.00</td></tr> <tr><td>2018</td><td>2018-660004799</td><td>CASTLEBERRY, JOHN E &</td><td>2</td><td>196,324</td><td>1000</td><td>20,595</td><td>1,719.00</td></tr> <tr><td>2017</td><td>2017-660004799</td><td>CASTLEBERRY, JOHN E &</td><td>2</td><td>194,593</td><td>1000</td><td>20,327</td><td>1,710.00</td></tr> <tr><td>2016</td><td>2016-660004799</td><td>CASTLEBERRY, JOHN E &</td><td>2</td><td>189,311</td><td>1000</td><td>19,706</td><td>1,677.00</td></tr> <tr><td>2015</td><td>2015-660004799</td><td>CASTLEBERRY, JOHN E &</td><td>2</td><td>182,756</td><td>1000</td><td>19,103</td><td>1,658.00</td></tr> <tr><td>2014</td><td>2014-660004799</td><td>CASTLEBERRY, JOHN E &</td><td>2</td><td>184,351</td><td>1000</td><td>18,727</td><td>1,681.00</td></tr> <tr><td>2013</td><td>2013-660004799</td><td>CASTLEBERRY, JOHN E &</td><td>2</td><td>175,257</td><td>1000</td><td>18,153</td><td>1,529.00</td></tr> </tbody> </table>										Tax Year	Statement Number	Billed Owner	Tax Area	Total Value	Exemptions	Taxable Value	Billed Tax	2025	2025-660004799	CASTLEBERRY, JOHN ED &	2	235,360	1000	23,141	1,853.00	2024	2024-660004799	CASTLEBERRY, JOHN ED &	2	247,453	1000	22,439	1,804.00	2023	2023-660004799	CASTLEBERRY, JOHN ED &	2	212,964	1000	21,756	1,752.00	2022	2022-660004799	CASTLEBERRY, JOHN ED &	2	200,845	1000	21,093	1,711.00	2021	2021-660004799	CASTLEBERRY, JOHN ED &	2	214,695	1000	21,770	1,744.00	2020	2020-660004799	CASTLEBERRY, JOHN ED &	2	207,583	1000	21,108	1,705.00	2019	2019-660004799	CASTLEBERRY, JOHN E &	2	195,125	1000	20,464	1,691.00	2018	2018-660004799	CASTLEBERRY, JOHN E &	2	196,324	1000	20,595	1,719.00	2017	2017-660004799	CASTLEBERRY, JOHN E &	2	194,593	1000	20,327	1,710.00	2016	2016-660004799	CASTLEBERRY, JOHN E &	2	189,311	1000	19,706	1,677.00	2015	2015-660004799	CASTLEBERRY, JOHN E &	2	182,756	1000	19,103	1,658.00	2014	2014-660004799	CASTLEBERRY, JOHN E &	2	184,351	1000	18,727	1,681.00	2013	2013-660004799	CASTLEBERRY, JOHN E &	2	175,257	1000	18,153	1,529.00
Tax Year	Statement Number	Billed Owner	Tax Area	Total Value	Exemptions	Taxable Value	Billed Tax																																																																																																																		
2025	2025-660004799	CASTLEBERRY, JOHN ED &	2	235,360	1000	23,141	1,853.00																																																																																																																		
2024	2024-660004799	CASTLEBERRY, JOHN ED &	2	247,453	1000	22,439	1,804.00																																																																																																																		
2023	2023-660004799	CASTLEBERRY, JOHN ED &	2	212,964	1000	21,756	1,752.00																																																																																																																		
2022	2022-660004799	CASTLEBERRY, JOHN ED &	2	200,845	1000	21,093	1,711.00																																																																																																																		
2021	2021-660004799	CASTLEBERRY, JOHN ED &	2	214,695	1000	21,770	1,744.00																																																																																																																		
2020	2020-660004799	CASTLEBERRY, JOHN ED &	2	207,583	1000	21,108	1,705.00																																																																																																																		
2019	2019-660004799	CASTLEBERRY, JOHN E &	2	195,125	1000	20,464	1,691.00																																																																																																																		
2018	2018-660004799	CASTLEBERRY, JOHN E &	2	196,324	1000	20,595	1,719.00																																																																																																																		
2017	2017-660004799	CASTLEBERRY, JOHN E &	2	194,593	1000	20,327	1,710.00																																																																																																																		
2016	2016-660004799	CASTLEBERRY, JOHN E &	2	189,311	1000	19,706	1,677.00																																																																																																																		
2015	2015-660004799	CASTLEBERRY, JOHN E &	2	182,756	1000	19,103	1,658.00																																																																																																																		
2014	2014-660004799	CASTLEBERRY, JOHN E &	2	184,351	1000	18,727	1,681.00																																																																																																																		
2013	2013-660004799	CASTLEBERRY, JOHN E &	2	175,257	1000	18,153	1,529.00																																																																																																																		



Rogers

Assessment Property Record Card for Tax Year 2026

Data provided by LISA DELOZIER County Assessor

Date 04/17/2026
 Time 03:31:02
 Page 2

Lot Data	Square-Foot - NBHD 1917 #1	Primary Image
Lot Size Lot Count Units Buildable 2 Non-Ag Acres 1.9604 Topography Street Access Utilities Amenities LAND QUALITY FLOOD ZONE Method Square-Foot Base Lot Value 85,397.00 x .65 = 55,853 Factor Value Adjustments Lot Value 55,853		

Residential Data	
Type	1 Single Family Residence
Condition	3 - Average
Quality	3.5 - Average
Architecture	TRAD TRADITIONAL
Style	100% 1 1/2 Story Finished
Exterior Wall	100% Veneer, Masonry
Base/Total Area	1,370 / 2,514
Style	100% 1 1/2 Story Finished
HVAC	100% Warmed & Cooled Air
Roof Cover	1 Composition Shingle
Area on Slab	0
Fixture/RghIn	17 /
Bed/F/H Bath	4 / 4.0 /
Basement Area	
Garage Type	440 Attached Garage - Finished 2 Stalls
Remodel	
Year/Eff Age	1977 / 37

660004799_003.JPG	12/4/2025
-------------------	-----------

GRM Approach	
GRM Code	
Gross Rent	0.00
Indicated Value	

Multiple Regression			
MRA Code	1	Test	
Adusted R	0.8445		
Indicated Value	289,363	115.10	Per SqFt

Direct Comparables	
Selection Model	1 Res
Adjustment Model	A2 AO Test
Comparables	
Indicated Value	

Cost Approach				Manual : 01/2025			
Base Cost	99.66	Total Misc Impr	+	15,997			
Roofing Adj	+ 3.17	Garage Cost	+	22,691			
Subfloor Adj	+ 0.00	Total RCN	=	360,555			
Heat/Cool Adj	+ 14.47	Depreciation (44%)	-	158,644			
Plumbing Adj	+ 10.73	Lump Sums	+	10,125			
Basement Adj	+ 0.00	RCNLD	=	212,036			
Adj Base Cost	= 128.03	Lot Value	+	55,853			
Total Area	x 2,514	Indicated Value	=	267,889			
Adjusted Cost	= 321,867	Value Per SqFt		106.56			

Value Reconciliation			
Selected Approach	Cost Approach		
Improvements	212,036		
Lot Value	55,853		
Indicated Value	267,889	106.56	Per SqFt
Agland Value			
Site Improvements	10,200		
Total Value	278,089	110.62	Total Value Per SqFt

Miscellaneous Improvements							
Code	Description	Sketch ID	Size	Year	Units	Unit Cost	Depr Value
FPR1	FIREPLACE - RESIDENTIAL 1 STORY	0		1	1	6,429.63	6,430
PRCH	SLAB PORCH - COVERED	117848	34x5		170	28.92	4,916
PATO	SLAB PORCH - OPEN	117849	48x10		480	9.69	4,651
BALW	BALCONY - WOOD	117850	32x10		320	31.64	10,125



Rogers

Assessment Property Record Card for Tax Year 2026

Data provided by LISA DELOZIER County Assessor

Date 04/17/2026

Time 03:31:02

Page 3

Sketch Image

660004799

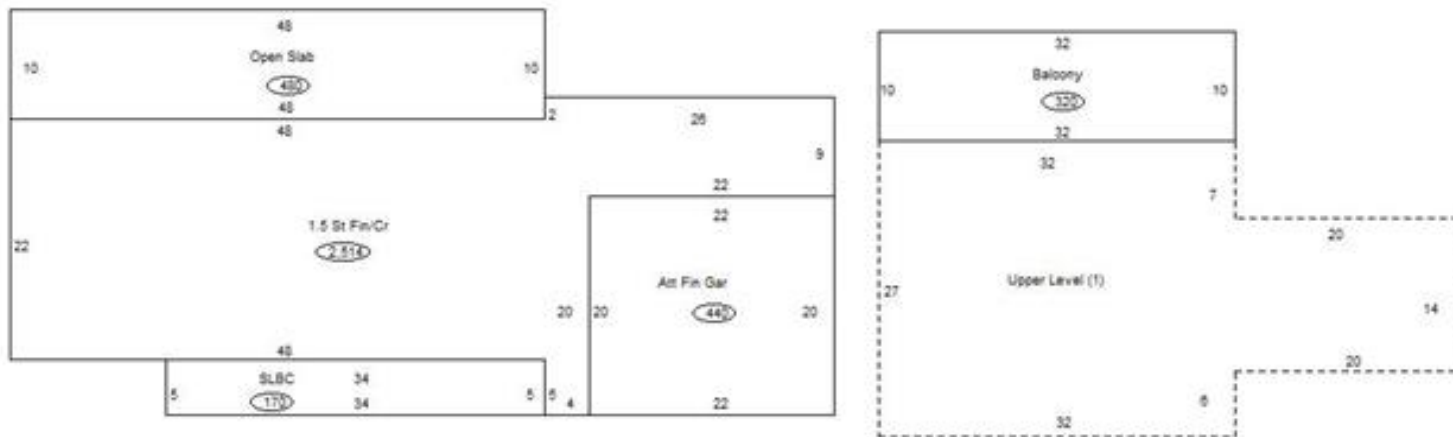

Sketch Vector Information

Sequence	Code	Type	Built Over	Scale	Section Label	Base Area	Multiplier	Total Area
1	R	5	Crawl	13	1.5 St Fin/Cr	1,370	1.835	2,514
2	G	5		13	Att Fin Gar	440	1.000	440
3	U	^UL		13	Upper Level (1)	1,144	1.000	1,144
4	M	PRCH		13	SLBC	170	1.000	170
5	M	PATO		13	Open Slab	480	1.000	480
6	M	BALW		13	Balcoony	320	1.000	320
Total Building Area						1,370		2,514



Rogers



Assessment Property Record Card for Tax Year 2026

Data provided by LISA DELOZIER County Assessor

Date 04/17/2026
 Time 03:31:02
 Page 4

660004799

Outbuildings/Site Improvements

Building Image	Code	Description	Dimensions	Floor	Roofing	Total Units	
	SHDS	Shed - Small	12x28x8	Plank	Composition Shingle	336	
	Qual	2	Cond 3	Year 2000	Eff Age 20		
		Valuation Summary	Modifier Total	RCN	Depr (59% Phys/ % Func)	RCNLD	
		Base Cost (16.84 x 336)	5,658		5,658	3,338	2,320
	BNGP	Barn - General Purpose	22x23x8	Dirt	Composition Shingle	506	
	Qual	4	Cond 4	Year 1990	Eff Age 22		
		Valuation Summary	Modifier Total	RCN	Depr (51% Phys/ % Func)	RCNLD	
		Base Cost (31.78 x 506)	16,081		16,081	8,201	7,880