



Rogers

Assessment Property Record Card for Tax Year 2026

Data provided by LISA DELOZIER County Assessor

Date 04/17/2026
Time 16:36:47
Page 1

Assessment Data					Primary Image																																																																																																																				
Account 660004842 Parcel ID 20N16E-06-2-00000-000-0000 Cadastral ID 06-20-16-01400 Property Type REAL - Real Property Property Class RR VI Area 3 Tax Area 4 - VERDIGRIS/VERD FIRE Name ID 178684 WOOD, RONALD RAY & G GAYLE TRUSTEES 25447 S 4130 RD CLAREMORE OK 74019-0000 Parcel Location Situs 25447 S 4130 RD Subdivision Lot/Block / Parcel Size .46 - Acres Sec/Twn/Rng 6 / 20 / 16 / 2 Neighborhood 2016 - UNPLATTED LAND School District S008 - VERDIGRIS SCHOOLS					 <p>D:\Appraisers\JAYSON\JAYSON RESIDENTIAL VI\2021-10-12\IM\ 10/12/2021</p>																																																																																																																				
Legal Description Lat/Long: 36.24293730 -95.65451560 S 95', N 293', S 510', W 210' GOV'T LOT 5																																																																																																																									
Exemptions <table border="1"> <thead> <tr> <th>Code</th> <th>Type</th> <th>Active</th> <th>Maximum</th> <th>Exemption</th> </tr> </thead> <tbody> <tr> <td>H</td> <td>Homestead</td> <td>Yes</td> <td>1,000</td> <td>1,000</td> </tr> </tbody> </table>					Code	Type	Active	Maximum	Exemption	H	Homestead	Yes	1,000	1,000	Building Permits <table border="1"> <thead> <tr> <th>Number</th> <th>Description</th> <th>Opened</th> <th>Closed</th> <th>Amount</th> </tr> </thead> <tbody> <tr> <td colspan="5"> </td> </tr> </tbody> </table>					Number	Description	Opened	Closed	Amount																																																																																																	
Code	Type	Active	Maximum	Exemption																																																																																																																					
H	Homestead	Yes	1,000	1,000																																																																																																																					
Number	Description	Opened	Closed	Amount																																																																																																																					
Parcel Valuation <table border="1"> <thead> <tr> <th>Source</th> <th>REAL</th> <th>Fair Cash</th> <th>Capped</th> <th>Asmnt Level</th> <th>Assessed</th> <th>Levy Rate</th> <th>104.132</th> <th>Current Tax</th> </tr> </thead> <tbody> <tr> <td>Remove Cap</td> <td>0</td> <td>Land Value 12,673</td> <td>4,188</td> <td>11%</td> <td>461</td> <td>Assessed</td> <td>5,615</td> <td>584.70</td> </tr> <tr> <td>Year Frozen</td> <td>2013</td> <td>Improvements 141,811</td> <td>46,861</td> <td></td> <td>5,154</td> <td>Penalty</td> <td>0</td> <td></td> </tr> <tr> <td>Uncapped Value</td> <td>0</td> <td>Mobile Home 0</td> <td>0</td> <td></td> <td>0</td> <td>Exemption</td> <td>1,000</td> <td>-87.00</td> </tr> <tr> <td>TIF Project ID</td> <td>0</td> <td>Total Value 154,484</td> <td>51,049</td> <td></td> <td>5,615</td> <td>Total Taxable</td> <td>4,615</td> <td>498.00</td> </tr> </tbody> </table>					Source	REAL	Fair Cash	Capped	Asmnt Level	Assessed	Levy Rate	104.132	Current Tax	Remove Cap	0	Land Value 12,673	4,188	11%	461	Assessed	5,615	584.70	Year Frozen	2013	Improvements 141,811	46,861		5,154	Penalty	0		Uncapped Value	0	Mobile Home 0	0		0	Exemption	1,000	-87.00	TIF Project ID	0	Total Value 154,484	51,049		5,615	Total Taxable	4,615	498.00	Sale History <table border="1"> <thead> <tr> <th>Bk/Pg</th> <th>Grantor</th> <th>Date</th> <th>Price</th> <th>Code</th> </tr> </thead> <tbody> <tr> <td colspan="5"> </td> </tr> </tbody> </table>					Bk/Pg	Grantor	Date	Price	Code																																																														
Source	REAL	Fair Cash	Capped	Asmnt Level	Assessed	Levy Rate	104.132	Current Tax																																																																																																																	
Remove Cap	0	Land Value 12,673	4,188	11%	461	Assessed	5,615	584.70																																																																																																																	
Year Frozen	2013	Improvements 141,811	46,861		5,154	Penalty	0																																																																																																																		
Uncapped Value	0	Mobile Home 0	0		0	Exemption	1,000	-87.00																																																																																																																	
TIF Project ID	0	Total Value 154,484	51,049		5,615	Total Taxable	4,615	498.00																																																																																																																	
Bk/Pg	Grantor	Date	Price	Code																																																																																																																					
Assessment History <table border="1"> <thead> <tr> <th>Tax Year</th> <th>Statement Number</th> <th>Billed Owner</th> <th>Tax Area</th> <th>Total Value</th> <th>Exemptions</th> <th>Taxable Value</th> <th>Billed Tax</th> </tr> </thead> <tbody> <tr><td>2025</td><td>2025-660004842</td><td>WOOD, RONALD RAY &</td><td>4</td><td>122,876</td><td>1000</td><td>4,615</td><td>497.00</td></tr> <tr><td>2024</td><td>2024-660004842</td><td>WOOD, RONALD RAY &</td><td>4</td><td>139,003</td><td>1000</td><td>4,615</td><td>453.00</td></tr> <tr><td>2023</td><td>2023-660004842</td><td>WOOD, RONALD RAY &</td><td>4</td><td>119,628</td><td>1000</td><td>4,616</td><td>446.00</td></tr> <tr><td>2022</td><td>2022-660004842</td><td>WOOD, RONALD RAY &</td><td>4</td><td>119,626</td><td>1000</td><td>4,616</td><td>454.00</td></tr> <tr><td>2021</td><td>2021-660004842</td><td>WOOD, RONALD RAY &</td><td>4</td><td>118,237</td><td>1000</td><td>4,615</td><td>442.00</td></tr> <tr><td>2020</td><td>2020-660004842</td><td>WOOD, RONALD RAY &</td><td>4</td><td>117,722</td><td>1000</td><td>4,615</td><td>443.00</td></tr> <tr><td>2019</td><td>2019-660004842</td><td>WOOD, RONALD RAY &</td><td>4</td><td>109,417</td><td>1000</td><td>4,615</td><td>450.00</td></tr> <tr><td>2018</td><td>2018-660004842</td><td>WOOD, RONALD RAY &</td><td>4</td><td>112,426</td><td>1000</td><td>4,616</td><td>450.00</td></tr> <tr><td>2017</td><td>2017-660004842</td><td>WOOD, RONALD RAY &</td><td>4</td><td>111,442</td><td>1000</td><td>4,615</td><td>451.00</td></tr> <tr><td>2016</td><td>2016-660004842</td><td>WOOD, RONALD RAY &</td><td>4</td><td>108,352</td><td>1000</td><td>4,615</td><td>453.00</td></tr> <tr><td>2015</td><td>2015-660004842</td><td>WOOD, RONALD RAY &</td><td>4</td><td>104,944</td><td>1000</td><td>4,615</td><td>456.00</td></tr> <tr><td>2014</td><td>2014-660004842</td><td>WOOD, RONALD RAY &</td><td>4</td><td>108,403</td><td>1000</td><td>4,616</td><td>432.00</td></tr> <tr><td>2013</td><td>2013-660004842</td><td>WOOD, RONALD RAY &</td><td>4</td><td>101,710</td><td>1000</td><td>4,615</td><td>447.00</td></tr> </tbody> </table>										Tax Year	Statement Number	Billed Owner	Tax Area	Total Value	Exemptions	Taxable Value	Billed Tax	2025	2025-660004842	WOOD, RONALD RAY &	4	122,876	1000	4,615	497.00	2024	2024-660004842	WOOD, RONALD RAY &	4	139,003	1000	4,615	453.00	2023	2023-660004842	WOOD, RONALD RAY &	4	119,628	1000	4,616	446.00	2022	2022-660004842	WOOD, RONALD RAY &	4	119,626	1000	4,616	454.00	2021	2021-660004842	WOOD, RONALD RAY &	4	118,237	1000	4,615	442.00	2020	2020-660004842	WOOD, RONALD RAY &	4	117,722	1000	4,615	443.00	2019	2019-660004842	WOOD, RONALD RAY &	4	109,417	1000	4,615	450.00	2018	2018-660004842	WOOD, RONALD RAY &	4	112,426	1000	4,616	450.00	2017	2017-660004842	WOOD, RONALD RAY &	4	111,442	1000	4,615	451.00	2016	2016-660004842	WOOD, RONALD RAY &	4	108,352	1000	4,615	453.00	2015	2015-660004842	WOOD, RONALD RAY &	4	104,944	1000	4,615	456.00	2014	2014-660004842	WOOD, RONALD RAY &	4	108,403	1000	4,616	432.00	2013	2013-660004842	WOOD, RONALD RAY &	4	101,710	1000	4,615	447.00
Tax Year	Statement Number	Billed Owner	Tax Area	Total Value	Exemptions	Taxable Value	Billed Tax																																																																																																																		
2025	2025-660004842	WOOD, RONALD RAY &	4	122,876	1000	4,615	497.00																																																																																																																		
2024	2024-660004842	WOOD, RONALD RAY &	4	139,003	1000	4,615	453.00																																																																																																																		
2023	2023-660004842	WOOD, RONALD RAY &	4	119,628	1000	4,616	446.00																																																																																																																		
2022	2022-660004842	WOOD, RONALD RAY &	4	119,626	1000	4,616	454.00																																																																																																																		
2021	2021-660004842	WOOD, RONALD RAY &	4	118,237	1000	4,615	442.00																																																																																																																		
2020	2020-660004842	WOOD, RONALD RAY &	4	117,722	1000	4,615	443.00																																																																																																																		
2019	2019-660004842	WOOD, RONALD RAY &	4	109,417	1000	4,615	450.00																																																																																																																		
2018	2018-660004842	WOOD, RONALD RAY &	4	112,426	1000	4,616	450.00																																																																																																																		
2017	2017-660004842	WOOD, RONALD RAY &	4	111,442	1000	4,615	451.00																																																																																																																		
2016	2016-660004842	WOOD, RONALD RAY &	4	108,352	1000	4,615	453.00																																																																																																																		
2015	2015-660004842	WOOD, RONALD RAY &	4	104,944	1000	4,615	456.00																																																																																																																		
2014	2014-660004842	WOOD, RONALD RAY &	4	108,403	1000	4,616	432.00																																																																																																																		
2013	2013-660004842	WOOD, RONALD RAY &	4	101,710	1000	4,615	447.00																																																																																																																		



Rogers

Assessment Property Record Card for Tax Year 2026

Data provided by LISA DELOZIER County Assessor

Date 04/17/2026
 Time 16:36:47
 Page 2

Lot Data	Square-Foot - UNPLATTED LAND (ACRES)	Primary Image
Lot Size		
Lot Count		
Units Buildable	2764	
Non-Ag Acres	0.5104	
Topography		
Street Access		
Utilities		
Amenities	LAND QUALITY	
	0	
	0	
Method	Square-Foot	
Base Lot Value	22,234.00 x .57 = 12,673	
Factor Value		
Adjustments	1.0000	
Lot Value	12,673	

Residential Data	
Type	1 Single Family Residence
Condition	4.5 - Good
Quality	3 - Average
Architecture	TRAD TRADITIONAL
Style	100% One Story
Exterior Wall	100% Veneer, Masonry
Base/Total Area	1,548 / 1,548
Style	100% One Story
HVAC	100% Warmed & Cooled Air
Roof Cover	1 Composition Shingle
Area on Slab	1,548
Fixture/RghIn	4 /
Bed/F/H Bath	2 / 1.0 /
Basement Area	
Garage Type	240 Attached Garage - Finished 1 Stalls
Remodel	
Year/Eff Age	1964 / 33

D:\Appraisers\JAYSON\JAYSON RESIDENTIAL VI\2021-10-12\IM 10/12/2021

GRM Approach	
GRM Code	
Gross Rent	0.00
Indicated Value	

Multiple Regression			
MRA Code	1	Test	
Adusted R	0.8445		
Indicated Value	151,389	97.80	Per SqFt

Direct Comparables	
Selection Model	1 Res
Adjustment Model	A2 AO Test
Comparables	
Indicated Value	

Cost Approach				Manual : 01/2025	
Base Cost	110.69	Total Misc Impr	+	21,732	
Roofing Adj	+ 4.83	Garage Cost	+	12,034	
Subfloor Adj	+ -2.31	Total RCN	=	234,743	
Heat/Cool Adj	+ 12.64	Depreciation (41%)	-	96,245	
Plumbing Adj	+ 3.98	Lump Sums	+	0	
Basement Adj	+ 0.00	RCNLD	=	138,498	
Adj Base Cost	= 129.83	Lot Value	+	12,673	
Total Area	x 1,548	Indicated Value	=	151,171	
Adjusted Cost	= 200,977	Value Per SqFt		97.66	

Value Reconciliation			
Selected Approach	Cost Approach		
Improvements	138,498		
Lot Value	12,673		
Indicated Value	151,171	97.66	Per SqFt
Agland Value			
Site Improvements	3,313		
Total Value	154,484	99.80	Total Value Per SqFt

Miscellaneous Improvements								
Code	Description	Sketch ID	Size	Year	Units	Unit Cost	Depr	Value
FPR1	FIREPLACE - RESIDENTIAL 1 STORY	0		1	1	5,615.40		5,615
PRCH	SLAB PORCH - COVERED	12195	7x5		35	26.82		939
EPSW	ENCLOSED PORCH - SOLID WALL	12196	22x10		220	68.99		15,178



Rogers

Assessment Property Record Card for Tax Year 2026

Data provided by LISA DELOZIER County Assessor

Date 04/17/2026
 Time 16:36:47
 Page 3

Sketch Image

660004842

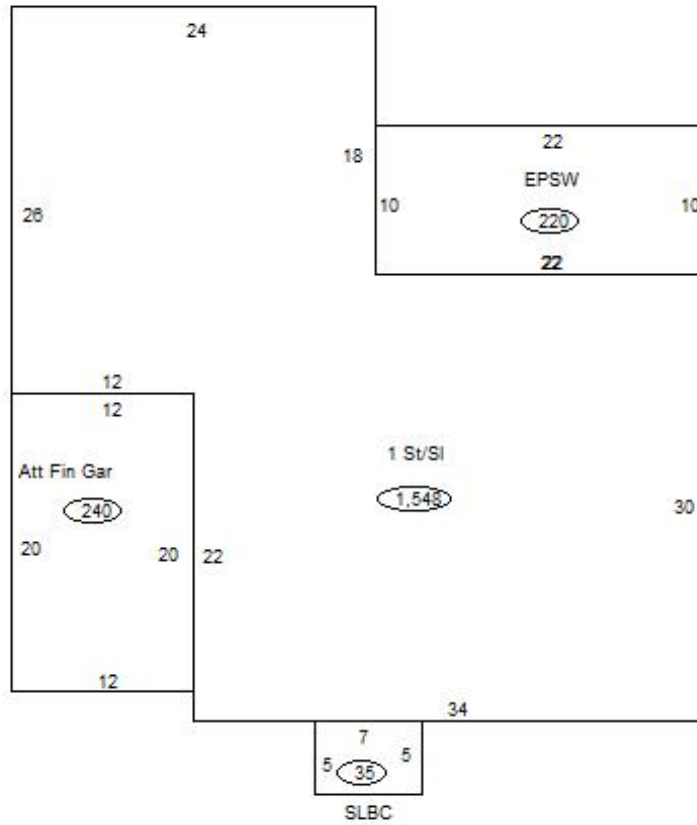

Sketch Vector Information

Sequence	Code	Type	Built Over	Scale	Section Label	Base Area	Multiplier	Total Area
1	R	1	Slab	13	1 St/SI	1,548	1.000	1,548
2	G	5	Slab	13	Att Fin Gar	240	1.000	240
3	M	PRCH		13	SLBC	35	1.000	35
4	M	EPSW		13	EPSW	220	1.000	220
Total Building Area						1,548		1,548



Rogers

Assessment Property Record Card for Tax Year 2026

Data provided by LISA DELOZIER County Assessor

Date 04/17/2026
 Time 16:36:47
 Page 4

660004842

Outbuildings/Site Improvements

Building Image	Code	Description	Dimensions	Floor	Roofing	Total Units
	PCPT	Carport - Portable	12x20x8	Gravel	Formed Metal	240
Qual	3	Cond 3	Year 2010	Eff Age 12		
Valuation Summary		Modifier Total	RCN	Depr (53% Phys/ % Func)		RCNLD
Base Cost (4.38 x 240)		1,051		1,051	557	494
SHDS	Shed - Small		8x16x8	Plank	Formed Metal	128
Qual	3	Cond 3	Year 2010	Eff Age 12		
Valuation Summary		Modifier Total	RCN	Depr (46% Phys/ % Func)		RCNLD
Base Cost (26.61 x 128)		3,406		3,406	1,567	1,839
SHDS	Shed - Small		6x8x5	Plank	Formed Metal	48
Qual	3	Cond 3	Year 2010	Eff Age 12		
Valuation Summary		Modifier Total	RCN	Depr (46% Phys/ % Func)		RCNLD
Base Cost (37.81 x 48)		1,815		1,815	835	980