



# Rogers

## Assessment Property Record Card for Tax Year 2026

Data provided by LISA DELOZIER County Assessor

Date 04/18/2026  
 Time 06:26:07  
 Page 1

Assessment Data					Primary Image																																																																																																																				
<b>Account</b> 660004977 <b>Parcel ID</b> 000000-00-0-00468-009-0016 <b>Cadastral ID</b> 06-21-15-01960 <b>Property Type</b> REAL - Real Property <b>Property Class</b> RRP VI Area 4 <b>Tax Area</b> 7 - OWASSO/LIMESTONE FIRE <b>Name ID</b> 349641 HERNANDEZ, RICARDO  11738 N 149TH E AVE COLLINSVILLE OK 74021-6131  <b>Parcel Location</b> <b>Situs</b> 11738 N 194TH E AVE <b>Subdivision</b> LOOKING GLASS ESTATE <b>Lot/Block</b> 0016 / 0009 Parcel Size 1 - Lots <b>Sec/Twn/Rng</b> 6 / 21 / 15 / 5 <b>Neighborhood</b> 1014 - R-V04-SW OWASSO <b>School District</b> S021 - OWASSO SCHOOLS					<p>04/21/2022 11:57</p> <p>\\tsclient\C\Users\Randy Necessary\Pictures\101_0421\IMG_0066. 4/22/2022</p>																																																																																																																				
<b>Legal Description</b> Lot/Long: 36.32409358 -95.75686487 LOT 16 BLOCK 9 LOOKING GLASS ESTATES																																																																																																																									
<b>Exemptions</b> <table border="1"> <thead> <tr> <th>Code</th> <th>Type</th> <th>Active</th> <th>Maximum</th> <th>Exemption</th> </tr> </thead> <tbody> <tr> <td>H</td> <td>Homestead</td> <td>No</td> <td>1,000</td> <td></td> </tr> </tbody> </table>					Code	Type	Active	Maximum	Exemption	H	Homestead	No	1,000		<b>Building Permits</b> <table border="1"> <thead> <tr> <th>Number</th> <th>Description</th> <th>Opened</th> <th>Closed</th> <th>Amount</th> </tr> </thead> <tbody> <tr> <td></td> <td></td> <td></td> <td></td> <td></td> </tr> </tbody> </table>					Number	Description	Opened	Closed	Amount																																																																																																	
Code	Type	Active	Maximum	Exemption																																																																																																																					
H	Homestead	No	1,000																																																																																																																						
Number	Description	Opened	Closed	Amount																																																																																																																					
<b>Parcel Valuation</b> <table border="1"> <thead> <tr> <th>Source</th> <th>REAL</th> <th>Fair Cash</th> <th>Capped</th> <th>Asmnt Level</th> <th>Assessed</th> <th>Levy Rate</th> <th>108.538</th> <th>Current Tax</th> </tr> </thead> <tbody> <tr> <td>Remove Cap</td> <td>2027</td> <td>Land Value 26,578</td> <td>25,031</td> <td>11%</td> <td>2,753</td> <td>Assessed</td> <td>18,292</td> <td>1,985.38</td> </tr> <tr> <td>Year Frozen</td> <td>0</td> <td>Improvements 141,266</td> <td>141,266</td> <td></td> <td>15,539</td> <td>Penalty</td> <td>0</td> <td></td> </tr> <tr> <td>Uncapped Value</td> <td>0</td> <td>Mobile Home 0</td> <td>0</td> <td></td> <td>0</td> <td>Exemption</td> <td>0</td> <td>0.00</td> </tr> <tr> <td>TIF Project ID</td> <td>0</td> <td>Total Value 167,844</td> <td>166,297</td> <td></td> <td>18,292</td> <td>Total Taxable</td> <td>18,292</td> <td>1,985.00</td> </tr> </tbody> </table>					Source	REAL	Fair Cash	Capped	Asmnt Level	Assessed	Levy Rate	108.538	Current Tax	Remove Cap	2027	Land Value 26,578	25,031	11%	2,753	Assessed	18,292	1,985.38	Year Frozen	0	Improvements 141,266	141,266		15,539	Penalty	0		Uncapped Value	0	Mobile Home 0	0		0	Exemption	0	0.00	TIF Project ID	0	Total Value 167,844	166,297		18,292	Total Taxable	18,292	1,985.00	<b>Sale History</b> <table border="1"> <thead> <tr> <th>Bk/Pg</th> <th>Grantor</th> <th>Date</th> <th>Price</th> <th>Code</th> </tr> </thead> <tbody> <tr> <td>/</td> <td>PACC OIL INVESTMENTS LLC</td> <td>02/20/2026</td> <td>225,000</td> <td>YES</td> </tr> <tr> <td>/</td> <td>SHAFFER, RYAN JOSEPH &amp;</td> <td>09/27/2019</td> <td>124,500</td> <td>YES</td> </tr> <tr> <td>2162/527</td> <td>SECRETARY OF VETERANS-AFFAIRS</td> <td>02/09/2011</td> <td>0</td> <td>1</td> </tr> <tr> <td>2134/736</td> <td>BRIGGS, DAVID MATTHEW</td> <td>10/20/2010</td> <td>0</td> <td>10</td> </tr> <tr> <td>1716/149</td> <td>T-MAC CONSTRUCTION INC</td> <td>09/29/2005</td> <td>102,000</td> <td>YES</td> </tr> <tr> <td>1688/1</td> <td>INTRINSIC PROPERTIES INC</td> <td>06/16/2005</td> <td>10,000</td> <td>YES</td> </tr> </tbody> </table>					Bk/Pg	Grantor	Date	Price	Code	/	PACC OIL INVESTMENTS LLC	02/20/2026	225,000	YES	/	SHAFFER, RYAN JOSEPH &	09/27/2019	124,500	YES	2162/527	SECRETARY OF VETERANS-AFFAIRS	02/09/2011	0	1	2134/736	BRIGGS, DAVID MATTHEW	10/20/2010	0	10	1716/149	T-MAC CONSTRUCTION INC	09/29/2005	102,000	YES	1688/1	INTRINSIC PROPERTIES INC	06/16/2005	10,000	YES																																
Source	REAL	Fair Cash	Capped	Asmnt Level	Assessed	Levy Rate	108.538	Current Tax																																																																																																																	
Remove Cap	2027	Land Value 26,578	25,031	11%	2,753	Assessed	18,292	1,985.38																																																																																																																	
Year Frozen	0	Improvements 141,266	141,266		15,539	Penalty	0																																																																																																																		
Uncapped Value	0	Mobile Home 0	0		0	Exemption	0	0.00																																																																																																																	
TIF Project ID	0	Total Value 167,844	166,297		18,292	Total Taxable	18,292	1,985.00																																																																																																																	
Bk/Pg	Grantor	Date	Price	Code																																																																																																																					
/	PACC OIL INVESTMENTS LLC	02/20/2026	225,000	YES																																																																																																																					
/	SHAFFER, RYAN JOSEPH &	09/27/2019	124,500	YES																																																																																																																					
2162/527	SECRETARY OF VETERANS-AFFAIRS	02/09/2011	0	1																																																																																																																					
2134/736	BRIGGS, DAVID MATTHEW	10/20/2010	0	10																																																																																																																					
1716/149	T-MAC CONSTRUCTION INC	09/29/2005	102,000	YES																																																																																																																					
1688/1	INTRINSIC PROPERTIES INC	06/16/2005	10,000	YES																																																																																																																					
<b>Assessment History</b> <table border="1"> <thead> <tr> <th>Tax Year</th> <th>Statement Number</th> <th>Billed Owner</th> <th>Tax Area</th> <th>Total Value</th> <th>Exemptions</th> <th>Taxable Value</th> <th>Billed Tax</th> </tr> </thead> <tbody> <tr><td>2025</td><td>2025-660004977</td><td>PACC OIL INVESTMENTS LLC</td><td>7</td><td>165,652</td><td>0</td><td>17,422</td><td>1,891.00</td></tr> <tr><td>2024</td><td>2024-660004977</td><td>PACC OIL INVESTMENTS LLC</td><td>7</td><td>178,369</td><td>0</td><td>16,592</td><td>1,831.00</td></tr> <tr><td>2023</td><td>2023-660004977</td><td>PACC OIL INVESTMENTS LLC</td><td>7</td><td>143,656</td><td>0</td><td>15,802</td><td>1,707.00</td></tr> <tr><td>2022</td><td>2022-660004977</td><td>PACC OIL INVESTMENTS LLC</td><td>7</td><td>142,181</td><td>0</td><td>15,051</td><td>1,690.00</td></tr> <tr><td>2021</td><td>2021-660004977</td><td>PACC OIL INVESTMENTS LLC</td><td>7</td><td>130,312</td><td>0</td><td>14,334</td><td>1,592.00</td></tr> <tr><td>2020</td><td>2020-660004977</td><td>PACC OIL INVESTMENTS LLC</td><td>7</td><td>128,230</td><td>0</td><td>14,105</td><td>1,564.00</td></tr> <tr><td>2019</td><td>2019-660004977</td><td>SHAFFER, RYAN JOSEPH &amp;</td><td>7</td><td>123,080</td><td>1000</td><td>12,539</td><td>1,405.00</td></tr> <tr><td>2018</td><td>2018-660004977</td><td>SHAFFER, RYAN JOSEPH &amp;</td><td>7</td><td>121,404</td><td>1000</td><td>12,354</td><td>1,341.00</td></tr> <tr><td>2017</td><td>2017-660004977</td><td>SHAFFER, RYAN JOSEPH &amp;</td><td>7</td><td>120,336</td><td>1000</td><td>12,237</td><td>1,340.00</td></tr> <tr><td>2016</td><td>2016-660004977</td><td>SHAFFER, RYAN JOSEPH &amp;</td><td>7</td><td>117,176</td><td>1000</td><td>11,889</td><td>1,303.00</td></tr> <tr><td>2015</td><td>2015-660004977</td><td>SHAFFER, RYAN JOSEPH &amp;</td><td>7</td><td>119,719</td><td>1000</td><td>12,169</td><td>1,342.00</td></tr> <tr><td>2014</td><td>2014-660004977</td><td>SHAFFER, RYAN JOSEPH &amp;</td><td>7</td><td>121,848</td><td>1000</td><td>12,238</td><td>1,360.00</td></tr> <tr><td>2013</td><td>2013-660004977</td><td>SHAFFER, RYAN JOSEPH &amp;</td><td>7</td><td>119,809</td><td>1000</td><td>11,852</td><td>1,294.00</td></tr> </tbody> </table>										Tax Year	Statement Number	Billed Owner	Tax Area	Total Value	Exemptions	Taxable Value	Billed Tax	2025	2025-660004977	PACC OIL INVESTMENTS LLC	7	165,652	0	17,422	1,891.00	2024	2024-660004977	PACC OIL INVESTMENTS LLC	7	178,369	0	16,592	1,831.00	2023	2023-660004977	PACC OIL INVESTMENTS LLC	7	143,656	0	15,802	1,707.00	2022	2022-660004977	PACC OIL INVESTMENTS LLC	7	142,181	0	15,051	1,690.00	2021	2021-660004977	PACC OIL INVESTMENTS LLC	7	130,312	0	14,334	1,592.00	2020	2020-660004977	PACC OIL INVESTMENTS LLC	7	128,230	0	14,105	1,564.00	2019	2019-660004977	SHAFFER, RYAN JOSEPH &	7	123,080	1000	12,539	1,405.00	2018	2018-660004977	SHAFFER, RYAN JOSEPH &	7	121,404	1000	12,354	1,341.00	2017	2017-660004977	SHAFFER, RYAN JOSEPH &	7	120,336	1000	12,237	1,340.00	2016	2016-660004977	SHAFFER, RYAN JOSEPH &	7	117,176	1000	11,889	1,303.00	2015	2015-660004977	SHAFFER, RYAN JOSEPH &	7	119,719	1000	12,169	1,342.00	2014	2014-660004977	SHAFFER, RYAN JOSEPH &	7	121,848	1000	12,238	1,360.00	2013	2013-660004977	SHAFFER, RYAN JOSEPH &	7	119,809	1000	11,852	1,294.00
Tax Year	Statement Number	Billed Owner	Tax Area	Total Value	Exemptions	Taxable Value	Billed Tax																																																																																																																		
2025	2025-660004977	PACC OIL INVESTMENTS LLC	7	165,652	0	17,422	1,891.00																																																																																																																		
2024	2024-660004977	PACC OIL INVESTMENTS LLC	7	178,369	0	16,592	1,831.00																																																																																																																		
2023	2023-660004977	PACC OIL INVESTMENTS LLC	7	143,656	0	15,802	1,707.00																																																																																																																		
2022	2022-660004977	PACC OIL INVESTMENTS LLC	7	142,181	0	15,051	1,690.00																																																																																																																		
2021	2021-660004977	PACC OIL INVESTMENTS LLC	7	130,312	0	14,334	1,592.00																																																																																																																		
2020	2020-660004977	PACC OIL INVESTMENTS LLC	7	128,230	0	14,105	1,564.00																																																																																																																		
2019	2019-660004977	SHAFFER, RYAN JOSEPH &	7	123,080	1000	12,539	1,405.00																																																																																																																		
2018	2018-660004977	SHAFFER, RYAN JOSEPH &	7	121,404	1000	12,354	1,341.00																																																																																																																		
2017	2017-660004977	SHAFFER, RYAN JOSEPH &	7	120,336	1000	12,237	1,340.00																																																																																																																		
2016	2016-660004977	SHAFFER, RYAN JOSEPH &	7	117,176	1000	11,889	1,303.00																																																																																																																		
2015	2015-660004977	SHAFFER, RYAN JOSEPH &	7	119,719	1000	12,169	1,342.00																																																																																																																		
2014	2014-660004977	SHAFFER, RYAN JOSEPH &	7	121,848	1000	12,238	1,360.00																																																																																																																		
2013	2013-660004977	SHAFFER, RYAN JOSEPH &	7	119,809	1000	11,852	1,294.00																																																																																																																		



# Rogers

## Assessment Property Record Card for Tax Year 2026

Data provided by LISA DELOZIER County Assessor

Date 04/18/2026  
 Time 06:26:07  
 Page 2

Lot Data	Square-Foot - NBHD 1014 #1	Primary Image
<b>Lot Size</b> <b>Lot Count</b> <b>Units Buildable</b> 1 <b>Non-Ag Acres</b> 0.3299 <b>Topography</b> <b>Street Access</b> <b>Utilities</b> <b>Amenities</b> LAND QUALITY 0 0 <b>Method</b> Square-Foot <b>Base Lot Value</b> 14,370.00 x 1.85 = 26,578 <b>Factor Value</b> <b>Adjustments</b> 1.0000 <b>Lot Value</b> 26,578		

Residential Data	
<b>Type</b>	1 Single Family Residence
<b>Condition</b>	3 - Average
<b>Quality</b>	2.5 - Fair
<b>Architecture</b>	
<b>Style</b>	100% One Story
<b>Exterior Wall</b>	10% Veneer, Masonry 90% Frame, Siding, Wood
<b>Base/Total Area</b>	1,252 / 1,252
<b>Style</b>	100% One Story
<b>HVAC</b>	100% Warmed & Cooled Air
<b>Roof Cover</b>	1 Composition Shingle
<b>Area on Slab</b>	1,252
<b>Fixture/RghIn</b>	11 /
<b>Bed/F/H Bath</b>	3 / 2.0 /
<b>Basement Area</b>	
<b>Garage Type</b>	420 Attached Garage - Unfinished
<b>Remodel</b>	
<b>Year/Eff Age</b>	2005 / 16

\\tsclient\C\Users\Randy Necessary\Pictures\101\_0421\IMG\_0066. 4/22/2022

Cost Approach		Manual : 01/2025	
<b>Base Cost</b>	98.84	<b>Total Misc Impr</b>	+ 5,927
<b>Roofing Adj</b>	+ 4.50	<b>Garage Cost</b>	+ 12,100
<b>Subfloor Adj</b>	+ -1.15	<b>Total RCN</b>	= 174,402
<b>Heat/Cool Adj</b>	+ 11.47	<b>Depreciation ( 19%)</b>	- 33,136
<b>Plumbing Adj</b>	+ 11.24	<b>Lump Sums</b>	+ 0
<b>Basement Adj</b>	+ 0.00	<b>RCNLD</b>	= 141,266
<b>Adj Base Cost</b>	= 124.90	<b>Lot Value</b>	+ 26,578
<b>Total Area</b>	x 1,252	<b>Indicated Value</b>	= 167,844
<b>Adjusted Cost</b>	= 156,375	<b>Value Per SqFt</b>	134.06

GRM Approach	
<b>GRM Code</b>	
<b>Gross Rent</b>	0.00
<b>Indicated Value</b>	

Multiple Regression			
<b>MRA Code</b>	1	Test	
<b>Adusted R</b>	0.8445		
<b>Indicated Value</b>	169,400	135.30	Per SqFt

Direct Comparables	
<b>Selection Model</b>	A Adam Test
<b>Adjustment Model</b>	1 2022 Residential
<b>Comparables</b>	8
<b>Indicated Value</b>	167,290 Per SqFt

Value Reconciliation			
<b>Selected Approach</b>	Cost Approach		
<b>Improvements</b>	141,266		
<b>Lot Value</b>	26,578		
<b>Indicated Value</b>	167,844	134.06	Per SqFt
<b>Agland Value</b>			
<b>Site Improvements</b>			
<b>Total Value</b>	167,844	134.06	Total Value Per SqFt

Miscellaneous Improvements								
Code	Description	Sketch ID	Size	Year	Units	Unit Cost	Depr	Value
PRCH	SLAB PORCH - COVERED	12647		84	84	24.00		2,016
PRCH	SLAB PORCH - COVERED	12648	15x11		165	23.70		3,911



**Rogers**  
**Assessment Property Record Card for Tax Year 2026**

Data provided by LISA DELOZIER County Assessor

Date 04/18/2026  
 Time 06:26:08  
 Page 3

Sketch Image

660004977

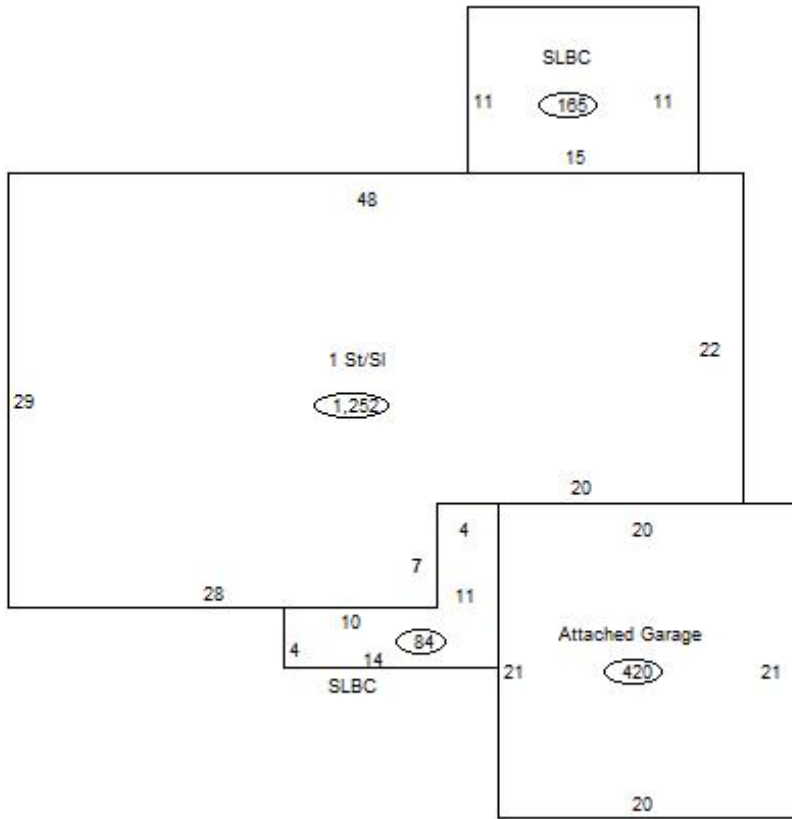

**Sketch Vector Information**

Sequence	Code	Type	Built Over	Scale	Section Label	Base Area	Multiplier	Total Area
1	R	1	Slab	13	1 St/SI	1,252	1.000	1,252
2	G	1		13	Attached Garage	420	1.000	420
3	M	PRCH		13	SLBC	84	1.000	84
4	M	PRCH		13	SLBC	165	1.000	165
<b>Total Building Area</b>						1,252		1,252