



Rogers

Assessment Property Record Card for Tax Year 2026

Data provided by LISA DELOZIER County Assessor

Date 04/17/2026
Time 15:40:33
Page 1

Assessment Data					Primary Image																																																																																																																				
Account 660004984 Parcel ID 000000-00-0-00468-009-0023 Cadastral ID 06-21-15-02030 Property Type REAL - Real Property Property Class RRP VI Area 4 Tax Area 7 - OWASSO/LIMESTONE FIRE Name ID 322282 GUTIERREZ, MAURICIO 11608 N 194TH E AVE COLLINSVILLE OK 74021-0000 Parcel Location Situs 11608 N 194TH E AVE Subdivision LOOKING GLASS ESTATE Lot/Block 0023 / 0009 Parcel Size 1 - Lots Sec/Twn/Rng 6 / 21 / 15 / 5 Neighborhood 1014 - R-V04-SW OWASSO School District S021 - OWASSO SCHOOLS																																																																																																																									
Legal Description Lot/Long: 36.32236604 -95.75681195																																																																																																																									
Building Permits					<table border="1"> <thead> <tr> <th>Number</th> <th>Description</th> <th>Opened</th> <th>Closed</th> <th>Amount</th> </tr> </thead> <tbody> <tr> <td>R2017 01 27</td> <td>R18-NEW 1504 SQ FT SFR</td> <td>02/2017</td> <td>08/2017</td> <td>105,000</td> </tr> </tbody> </table>					Number	Description	Opened	Closed	Amount	R2017 01 27	R18-NEW 1504 SQ FT SFR	02/2017	08/2017	105,000																																																																																																						
Number	Description	Opened	Closed	Amount																																																																																																																					
R2017 01 27	R18-NEW 1504 SQ FT SFR	02/2017	08/2017	105,000																																																																																																																					
Exemptions					Sale History																																																																																																																				
<table border="1"> <thead> <tr> <th>Code</th> <th>Type</th> <th>Active</th> <th>Maximum</th> <th>Exemption</th> </tr> </thead> <tbody> <tr> <td>H</td> <td>Homestead</td> <td>Yes</td> <td>1,000</td> <td>1,000</td> </tr> </tbody> </table>					Code	Type	Active	Maximum	Exemption	H	Homestead	Yes	1,000	1,000	<table border="1"> <thead> <tr> <th>Bk/Pg</th> <th>Grantor</th> <th>Date</th> <th>Price</th> <th>Code</th> </tr> </thead> <tbody> <tr> <td>2655/665</td> <td>VENTURE HOMES LLC</td> <td>08/17/2017</td> <td>160,000</td> <td>YES</td> </tr> <tr> <td>2655/663</td> <td>VENTURE HOMES</td> <td>07/31/2017</td> <td>0</td> <td>6</td> </tr> <tr> <td>2608/842</td> <td>HENDERSHOT, SID</td> <td>01/31/2017</td> <td>0</td> <td>WB</td> </tr> <tr> <td>2580/38</td> <td>HENDERSHOT, RONDA & SID</td> <td>09/09/2016</td> <td>0</td> <td>WB</td> </tr> <tr> <td>2414/440</td> <td>SIMPSON, PHYLLIS E</td> <td>06/17/2014</td> <td>7,000</td> <td>YES</td> </tr> </tbody> </table>					Bk/Pg	Grantor	Date	Price	Code	2655/665	VENTURE HOMES LLC	08/17/2017	160,000	YES	2655/663	VENTURE HOMES	07/31/2017	0	6	2608/842	HENDERSHOT, SID	01/31/2017	0	WB	2580/38	HENDERSHOT, RONDA & SID	09/09/2016	0	WB	2414/440	SIMPSON, PHYLLIS E	06/17/2014	7,000	YES																																																																								
Code	Type	Active	Maximum	Exemption																																																																																																																					
H	Homestead	Yes	1,000	1,000																																																																																																																					
Bk/Pg	Grantor	Date	Price	Code																																																																																																																					
2655/665	VENTURE HOMES LLC	08/17/2017	160,000	YES																																																																																																																					
2655/663	VENTURE HOMES	07/31/2017	0	6																																																																																																																					
2608/842	HENDERSHOT, SID	01/31/2017	0	WB																																																																																																																					
2580/38	HENDERSHOT, RONDA & SID	09/09/2016	0	WB																																																																																																																					
2414/440	SIMPSON, PHYLLIS E	06/17/2014	7,000	YES																																																																																																																					
Parcel Valuation																																																																																																																									
<table border="1"> <thead> <tr> <th>Source</th> <th>REAL</th> <th>Fair Cash</th> <th>Capped</th> <th>Asmnt Level</th> <th>Assessed</th> <th>Levy Rate</th> <th>108.538</th> <th>Current Tax</th> </tr> </thead> <tbody> <tr> <td>Remove Cap</td> <td>2018</td> <td>Land Value 26,079</td> <td>26,079</td> <td>11%</td> <td>2,869</td> <td>Assessed</td> <td>23,213</td> <td>2,519.49</td> </tr> <tr> <td>Year Frozen</td> <td>0</td> <td>Improvements 190,199</td> <td>184,948</td> <td></td> <td>20,344</td> <td>Penalty</td> <td>0</td> <td></td> </tr> <tr> <td>Uncapped Value</td> <td>0</td> <td>Mobile Home 0</td> <td>0</td> <td></td> <td>0</td> <td>Exemption</td> <td>1,000</td> <td>-97.00</td> </tr> <tr> <td>TIF Project ID</td> <td>0</td> <td>Total Value 216,278</td> <td>211,027</td> <td></td> <td>23,213</td> <td>Total Taxable</td> <td>22,213</td> <td>2,422.00</td> </tr> </tbody> </table>		Source	REAL	Fair Cash	Capped	Asmnt Level	Assessed	Levy Rate	108.538	Current Tax	Remove Cap	2018	Land Value 26,079	26,079	11%	2,869	Assessed	23,213	2,519.49	Year Frozen	0	Improvements 190,199	184,948		20,344	Penalty	0		Uncapped Value	0	Mobile Home 0	0		0	Exemption	1,000	-97.00	TIF Project ID	0	Total Value 216,278	211,027		23,213	Total Taxable	22,213	2,422.00																																																																											
Source	REAL	Fair Cash	Capped	Asmnt Level	Assessed	Levy Rate	108.538	Current Tax																																																																																																																	
Remove Cap	2018	Land Value 26,079	26,079	11%	2,869	Assessed	23,213	2,519.49																																																																																																																	
Year Frozen	0	Improvements 190,199	184,948		20,344	Penalty	0																																																																																																																		
Uncapped Value	0	Mobile Home 0	0		0	Exemption	1,000	-97.00																																																																																																																	
TIF Project ID	0	Total Value 216,278	211,027		23,213	Total Taxable	22,213	2,422.00																																																																																																																	
Assessment History																																																																																																																									
<table border="1"> <thead> <tr> <th>Tax Year</th> <th>Statement Number</th> <th>Billed Owner</th> <th>Tax Area</th> <th>Total Value</th> <th>Exemptions</th> <th>Taxable Value</th> <th>Billed Tax</th> </tr> </thead> <tbody> <tr><td>2025</td><td>2025-660004984</td><td>GUTIERREZ, MAURICIO</td><td>7</td><td>210,335</td><td>1000</td><td>21,537</td><td>2,348.00</td></tr> <tr><td>2024</td><td>2024-660004984</td><td>GUTIERREZ, MAURICIO</td><td>7</td><td>224,395</td><td>1000</td><td>20,881</td><td>2,318.00</td></tr> <tr><td>2023</td><td>2023-660004984</td><td>GUTIERREZ, MAURICIO</td><td>7</td><td>209,776</td><td>1000</td><td>20,244</td><td>2,200.00</td></tr> <tr><td>2022</td><td>2022-660004984</td><td>GUTIERREZ, MAURICIO</td><td>7</td><td>211,659</td><td>1000</td><td>19,625</td><td>2,218.00</td></tr> <tr><td>2021</td><td>2021-660004984</td><td>GUTIERREZ, MAURICIO</td><td>7</td><td>182,070</td><td>1000</td><td>19,024</td><td>2,126.00</td></tr> <tr><td>2020</td><td>2020-660004984</td><td>GUTIERREZ, MAURICIO</td><td>7</td><td>179,299</td><td>1000</td><td>18,441</td><td>2,059.00</td></tr> <tr><td>2019</td><td>2019-660004984</td><td>GUTIERREZ, MAURICIO</td><td>7</td><td>172,257</td><td>1000</td><td>17,875</td><td>1,998.00</td></tr> <tr><td>2018</td><td>2018-660004984</td><td>GUTIERREZ, MAURICIO</td><td>7</td><td>166,590</td><td>1000</td><td>17,325</td><td>1,875.00</td></tr> <tr><td>2017</td><td>2017-660004984</td><td>GUTIERREZ, MAURICIO</td><td>7</td><td>15,000</td><td>0</td><td>1,650</td><td>179.00</td></tr> <tr><td>2016</td><td>2016-660004984</td><td>HENDERSHOT, SID</td><td>7</td><td>15,000</td><td>0</td><td>1,650</td><td>179.00</td></tr> <tr><td>2015</td><td>2015-660004984</td><td>HENDERSHOT, SID &</td><td>7</td><td>20,000</td><td>0</td><td>2,200</td><td>240.00</td></tr> <tr><td>2014</td><td>2014-660004984</td><td>HENDERSHOT, SID &</td><td>7</td><td>20,000</td><td>0</td><td>295</td><td>32.00</td></tr> <tr><td>2013</td><td>2013-660004984</td><td>SIMPSON, PHYLLIS E</td><td>7</td><td>25,000</td><td>0</td><td>281</td><td>30.00</td></tr> </tbody> </table>										Tax Year	Statement Number	Billed Owner	Tax Area	Total Value	Exemptions	Taxable Value	Billed Tax	2025	2025-660004984	GUTIERREZ, MAURICIO	7	210,335	1000	21,537	2,348.00	2024	2024-660004984	GUTIERREZ, MAURICIO	7	224,395	1000	20,881	2,318.00	2023	2023-660004984	GUTIERREZ, MAURICIO	7	209,776	1000	20,244	2,200.00	2022	2022-660004984	GUTIERREZ, MAURICIO	7	211,659	1000	19,625	2,218.00	2021	2021-660004984	GUTIERREZ, MAURICIO	7	182,070	1000	19,024	2,126.00	2020	2020-660004984	GUTIERREZ, MAURICIO	7	179,299	1000	18,441	2,059.00	2019	2019-660004984	GUTIERREZ, MAURICIO	7	172,257	1000	17,875	1,998.00	2018	2018-660004984	GUTIERREZ, MAURICIO	7	166,590	1000	17,325	1,875.00	2017	2017-660004984	GUTIERREZ, MAURICIO	7	15,000	0	1,650	179.00	2016	2016-660004984	HENDERSHOT, SID	7	15,000	0	1,650	179.00	2015	2015-660004984	HENDERSHOT, SID &	7	20,000	0	2,200	240.00	2014	2014-660004984	HENDERSHOT, SID &	7	20,000	0	295	32.00	2013	2013-660004984	SIMPSON, PHYLLIS E	7	25,000	0	281	30.00
Tax Year	Statement Number	Billed Owner	Tax Area	Total Value	Exemptions	Taxable Value	Billed Tax																																																																																																																		
2025	2025-660004984	GUTIERREZ, MAURICIO	7	210,335	1000	21,537	2,348.00																																																																																																																		
2024	2024-660004984	GUTIERREZ, MAURICIO	7	224,395	1000	20,881	2,318.00																																																																																																																		
2023	2023-660004984	GUTIERREZ, MAURICIO	7	209,776	1000	20,244	2,200.00																																																																																																																		
2022	2022-660004984	GUTIERREZ, MAURICIO	7	211,659	1000	19,625	2,218.00																																																																																																																		
2021	2021-660004984	GUTIERREZ, MAURICIO	7	182,070	1000	19,024	2,126.00																																																																																																																		
2020	2020-660004984	GUTIERREZ, MAURICIO	7	179,299	1000	18,441	2,059.00																																																																																																																		
2019	2019-660004984	GUTIERREZ, MAURICIO	7	172,257	1000	17,875	1,998.00																																																																																																																		
2018	2018-660004984	GUTIERREZ, MAURICIO	7	166,590	1000	17,325	1,875.00																																																																																																																		
2017	2017-660004984	GUTIERREZ, MAURICIO	7	15,000	0	1,650	179.00																																																																																																																		
2016	2016-660004984	HENDERSHOT, SID	7	15,000	0	1,650	179.00																																																																																																																		
2015	2015-660004984	HENDERSHOT, SID &	7	20,000	0	2,200	240.00																																																																																																																		
2014	2014-660004984	HENDERSHOT, SID &	7	20,000	0	295	32.00																																																																																																																		
2013	2013-660004984	SIMPSON, PHYLLIS E	7	25,000	0	281	30.00																																																																																																																		



Rogers

Assessment Property Record Card for Tax Year 2026

Data provided by LISA DELOZIER County Assessor

Date 04/17/2026
Time 15:40:34
Page 2

Lot Data		Square-Foot - NBHD 1014 #1	
Lot Size			
Lot Count			
Units Buildable	1		
Non-Ag Acres	0.3236		
Topography			
Street Access			
Utilities			
Amenities	LAND QUALITY	0	
		0	
Method	Square-Foot		
Base Lot Value	14,097.00 x 1.85 = 26,079		
Factor Value			
Adjustments	1.0000		
Lot Value	26,079		



\\tsclient\C\Users\Randy Necessary\Pictures\101_0421\IMG_0083. 4/22/2022

Residential Data	
Type	1 Single Family Residence
Condition	3 - Average
Quality	2.5 - Fair
Architecture	
Style	100% One Story
Exterior Wall	100% Frame, Siding, Wood
Base/Total Area	1,556 / 1,556
Style	100% One Story
HVAC	100% Warmed & Cooled Air
Roof Cover	1 Composition Shingle
Area on Slab	1,556
Fixture/RghIn	11 /
Bed/F/H Bath	4 / 2.0 / 11.0
Basement Area	
Garage Type	400 Attached Garage - Unfinished
Remodel	
Year/Eff Age	2017 / 7

GRM Approach

GRM Code	
Gross Rent	0.00
Indicated Value	

Multiple Regression

MRA Code	1 Test
Adjusted R	0.8445
Indicated Value	206,644 132.80 Per SqFt

Direct Comparables

Selection Model	A Adam Test
Adjustment Model	1 2022 Residential
Comparables	2
Indicated Value	240,460 Per SqFt

Value Reconciliation

Selected Approach	Cost Approach
Improvements	190,199
Lot Value	26,079
Indicated Value	216,278 139.00 Per SqFt
Agland Value	
Site Improvements	
Total Value	216,278 139.00 Total Value Per SqFt

Cost Approach		Manual : 01/2025	
Base Cost	92.94	Total Misc Impr	+ 11,417
Roofing Adj	+ 4.30	Garage Cost	+ 11,700
Subfloor Adj	+ -1.18	Total RCN	= 204,515
Heat/Cool Adj	+ 11.47	Depreciation (7%)	- 14,316
Plumbing Adj	+ 9.05	Lump Sums	+ 0
Basement Adj	+ 0.00	RCNLD	= 190,199
Adj Base Cost	= 116.58	Lot Value	+ 26,079
Total Area	x 1,556	Indicated Value	= 216,278
Adjusted Cost	= 181,398	Value Per SqFt	139.00

Miscellaneous Improvements

Code	Description	Sketch ID	Size	Year	Units	Unit Cost	Depr	Value
PATO	SLAB PORCH - OPEN	133868	4x3		12	10.86		130
PATO	SLAB PORCH - OPEN	133869	10x4		40	10.86		434
PRCH	SLAB PORCH - COVERED	133870	19x10		190	23.60		4,484
PRCH	SLAB PORCH - COVERED	133871	21x13		273	23.33		6,369



Rogers
Assessment Property Record Card for Tax Year 2026

Data provided by LISA DELOZIER County Assessor

Date 04/17/2026
 Time 15:40:34
 Page 3

Sketch Image

660004984

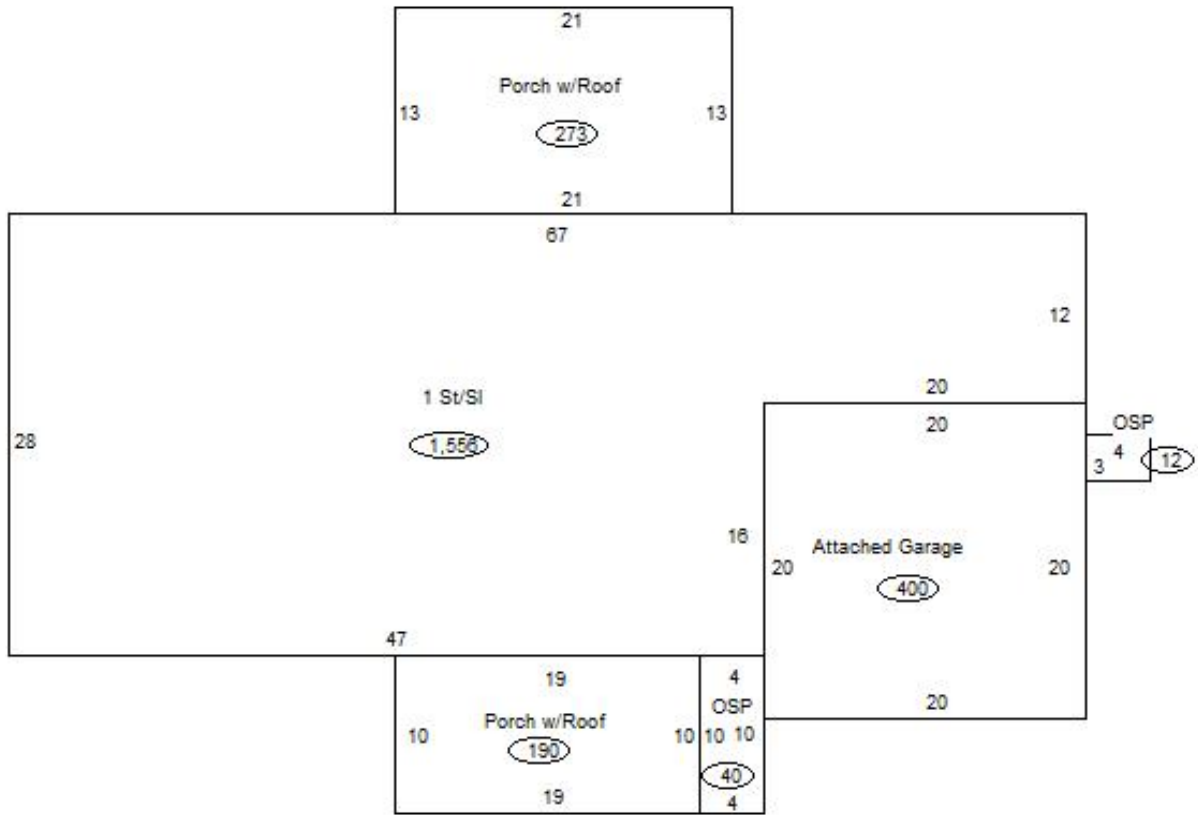

Sketch Vector Information

Sequence	Code	Type	Built Over	Scale	Section Label	Base Area	Multiplier	Total Area
1	R	1	Slab	13	1 St/Sl	1,556	1.000	1,556
2	G	1		13	Attached Garage	400	1.000	400
3	M	PATO		13	Open Slab	12	1.000	12
4	M	PATO		13	Open Slab	40	1.000	40
5	M	PRCH		13	SLBC	190	1.000	190
6	M	PRCH		13	SLBC	273	1.000	273
Total Building Area						1,556		1,556