



Rogers

Assessment Property Record Card for Tax Year 2026

Data provided by LISA DELOZIER County Assessor

Date 04/17/2026
Time 02:30:21
Page 1

Assessment Data					Primary Image																																																																																																																				
Account 660004997 Parcel ID 000000-00-0-00468-010-0012 Cadastral ID 06-21-15-02160 Property Type REAL - Real Property Property Class RRP VI Area 4 Tax Area 7 - OWASSO/LIMESTONE FIRE Name ID 336268 2004 PROPERTIES LLC- SERIES "R" 19992 E WOODHAVEN RD OWASSO OK 74055-0000 Parcel Location Situs 11725 N 194TH E AVE Subdivision LOOKING GLASS ESTATE Lot/Block 0012 / 0010 Parcel Size 1 - Lots Sec/Twn/Rng 6 / 21 / 15 / 5 Neighborhood 1014 - R-V04-SW OWASSO School District S021 - OWASSO SCHOOLS																																																																																																																									
Legal Description Lot/Long: 36.32488239 -95.75620049 LOT 12 BLOCK 10 LOOKING GLASS ESTATES																																																																																																																									
					Building Permits <table border="1"> <thead> <tr> <th>Number</th> <th>Description</th> <th>Opened</th> <th>Closed</th> <th>Amount</th> </tr> </thead> <tbody> <tr> <td>9708</td> <td>R7 FOR GARAGE ADDN & LIVING ROC</td> <td>07/2005</td> <td>12/2006</td> <td>22,200</td> </tr> </tbody> </table>					Number	Description	Opened	Closed	Amount	9708	R7 FOR GARAGE ADDN & LIVING ROC	07/2005	12/2006	22,200																																																																																																						
Number	Description	Opened	Closed	Amount																																																																																																																					
9708	R7 FOR GARAGE ADDN & LIVING ROC	07/2005	12/2006	22,200																																																																																																																					
Exemptions <table border="1"> <thead> <tr> <th>Code</th> <th>Type</th> <th>Active</th> <th>Maximum</th> <th>Exemption</th> </tr> </thead> <tbody> <tr> <td></td> <td></td> <td></td> <td></td> <td></td> </tr> </tbody> </table>					Code	Type	Active	Maximum	Exemption						Sale History <table border="1"> <thead> <tr> <th>Bk/Pg</th> <th>Grantor</th> <th>Date</th> <th>Price</th> <th>Code</th> </tr> </thead> <tbody> <tr> <td>/</td> <td>2004 PROPERTIES LLC</td> <td>09/15/2021</td> <td>0</td> <td>4</td> </tr> <tr> <td>2562/552</td> <td>FIRST UNITED BANK & TRUST CO</td> <td>07/05/2016</td> <td>75,000</td> <td>3</td> </tr> <tr> <td>2530/787</td> <td>BEACH, BRENT & AMELIA</td> <td>02/04/2016</td> <td>0</td> <td>10</td> </tr> <tr> <td>2275/333</td> <td>COLBERT, CYAN J</td> <td>09/26/2012</td> <td>98,000</td> <td>YES</td> </tr> <tr> <td>1875/415</td> <td>CREWS, STEPHEN R</td> <td>05/22/2007</td> <td>91,000</td> <td>YES</td> </tr> <tr> <td>1633/651</td> <td>AMERIQUEST MORTGAGE CO</td> <td>10/26/2004</td> <td>17,000</td> <td>YES</td> </tr> </tbody> </table>					Bk/Pg	Grantor	Date	Price	Code	/	2004 PROPERTIES LLC	09/15/2021	0	4	2562/552	FIRST UNITED BANK & TRUST CO	07/05/2016	75,000	3	2530/787	BEACH, BRENT & AMELIA	02/04/2016	0	10	2275/333	COLBERT, CYAN J	09/26/2012	98,000	YES	1875/415	CREWS, STEPHEN R	05/22/2007	91,000	YES	1633/651	AMERIQUEST MORTGAGE CO	10/26/2004	17,000	YES																																																																			
Code	Type	Active	Maximum	Exemption																																																																																																																					
Bk/Pg	Grantor	Date	Price	Code																																																																																																																					
/	2004 PROPERTIES LLC	09/15/2021	0	4																																																																																																																					
2562/552	FIRST UNITED BANK & TRUST CO	07/05/2016	75,000	3																																																																																																																					
2530/787	BEACH, BRENT & AMELIA	02/04/2016	0	10																																																																																																																					
2275/333	COLBERT, CYAN J	09/26/2012	98,000	YES																																																																																																																					
1875/415	CREWS, STEPHEN R	05/22/2007	91,000	YES																																																																																																																					
1633/651	AMERIQUEST MORTGAGE CO	10/26/2004	17,000	YES																																																																																																																					
Parcel Valuation <table border="1"> <thead> <tr> <th>Source</th> <th>REAL</th> <th>Fair Cash</th> <th>Capped</th> <th>Asmnt Level</th> <th>Assessed</th> <th>Levy Rate</th> <th>108.538</th> <th>Current Tax</th> </tr> </thead> <tbody> <tr> <td>Remove Cap</td> <td>2017</td> <td>Land Value</td> <td>32,539</td> <td>32,539</td> <td>11%</td> <td>3,579</td> <td>Assessed</td> <td>9,499 1,031.00</td> </tr> <tr> <td>Year Frozen</td> <td>0</td> <td>Improvements</td> <td>53,817</td> <td>53,817</td> <td></td> <td>5,920</td> <td>Penalty</td> <td>0</td> </tr> <tr> <td>Uncapped Value</td> <td>0</td> <td>Mobile Home</td> <td>0</td> <td>0</td> <td></td> <td>0</td> <td>Exemption</td> <td>0 0.00</td> </tr> <tr> <td>TIF Project ID</td> <td>0</td> <td>Total Value</td> <td>86,356</td> <td>86,356</td> <td></td> <td>9,499</td> <td>Total Taxable</td> <td>9,499 1,031.00</td> </tr> </tbody> </table>										Source	REAL	Fair Cash	Capped	Asmnt Level	Assessed	Levy Rate	108.538	Current Tax	Remove Cap	2017	Land Value	32,539	32,539	11%	3,579	Assessed	9,499 1,031.00	Year Frozen	0	Improvements	53,817	53,817		5,920	Penalty	0	Uncapped Value	0	Mobile Home	0	0		0	Exemption	0 0.00	TIF Project ID	0	Total Value	86,356	86,356		9,499	Total Taxable	9,499 1,031.00																																																																			
Source	REAL	Fair Cash	Capped	Asmnt Level	Assessed	Levy Rate	108.538	Current Tax																																																																																																																	
Remove Cap	2017	Land Value	32,539	32,539	11%	3,579	Assessed	9,499 1,031.00																																																																																																																	
Year Frozen	0	Improvements	53,817	53,817		5,920	Penalty	0																																																																																																																	
Uncapped Value	0	Mobile Home	0	0		0	Exemption	0 0.00																																																																																																																	
TIF Project ID	0	Total Value	86,356	86,356		9,499	Total Taxable	9,499 1,031.00																																																																																																																	
Assessment History <table border="1"> <thead> <tr> <th>Tax Year</th> <th>Statement Number</th> <th>Billed Owner</th> <th>Tax Area</th> <th>Total Value</th> <th>Exemptions</th> <th>Taxable Value</th> <th>Billed Tax</th> </tr> </thead> <tbody> <tr><td>2025</td><td>2025-660004997</td><td>2004 PROPERTIES LLC-</td><td>7</td><td>87,348</td><td>0</td><td>9,608</td><td>1,043.00</td></tr> <tr><td>2024</td><td>2024-660004997</td><td>2004 PROPERTIES LLC-</td><td>7</td><td>96,771</td><td>0</td><td>10,645</td><td>1,175.00</td></tr> <tr><td>2023</td><td>2023-660004997</td><td>2004 PROPERTIES LLC-</td><td>7</td><td>95,864</td><td>0</td><td>10,545</td><td>1,139.00</td></tr> <tr><td>2022</td><td>2022-660004997</td><td>2004 PROPERTIES LLC-</td><td>7</td><td>95,861</td><td>0</td><td>10,545</td><td>1,184.00</td></tr> <tr><td>2021</td><td>2021-660004997</td><td>2004 PROPERTIES LLC</td><td>7</td><td>98,553</td><td>0</td><td>10,841</td><td>1,204.00</td></tr> <tr><td>2020</td><td>2020-660004997</td><td>2004 PROPERTIES LLC</td><td>7</td><td>98,018</td><td>0</td><td>10,782</td><td>1,196.00</td></tr> <tr><td>2019</td><td>2019-660004997</td><td>2004 PROPERTIES LLC</td><td>7</td><td>93,515</td><td>0</td><td>10,287</td><td>1,141.00</td></tr> <tr><td>2018</td><td>2018-660004997</td><td>2004 PROPERTIES LLC</td><td>7</td><td>91,952</td><td>0</td><td>10,115</td><td>1,086.00</td></tr> <tr><td>2017</td><td>2017-660004997</td><td>2004 PROPERTIES LLC</td><td>7</td><td>91,193</td><td>0</td><td>10,031</td><td>1,087.00</td></tr> <tr><td>2016</td><td>2016-660004997</td><td>2004 PROPERTIES LLC</td><td>7</td><td>88,867</td><td>0</td><td>9,775</td><td>1,060.00</td></tr> <tr><td>2015</td><td>2015-660004997</td><td>BEACH, BRENT & AMELIA</td><td>7</td><td>92,927</td><td>0</td><td>10,222</td><td>1,115.00</td></tr> <tr><td>2014</td><td>2014-660004997</td><td>BEACH, BRENT & AMELIA</td><td>7</td><td>94,763</td><td>0</td><td>10,424</td><td>1,147.00</td></tr> <tr><td>2013</td><td>2013-660004997</td><td>BEACH, BRENT & AMELIA</td><td>7</td><td>95,443</td><td>0</td><td>10,499</td><td>1,134.00</td></tr> </tbody> </table>										Tax Year	Statement Number	Billed Owner	Tax Area	Total Value	Exemptions	Taxable Value	Billed Tax	2025	2025-660004997	2004 PROPERTIES LLC-	7	87,348	0	9,608	1,043.00	2024	2024-660004997	2004 PROPERTIES LLC-	7	96,771	0	10,645	1,175.00	2023	2023-660004997	2004 PROPERTIES LLC-	7	95,864	0	10,545	1,139.00	2022	2022-660004997	2004 PROPERTIES LLC-	7	95,861	0	10,545	1,184.00	2021	2021-660004997	2004 PROPERTIES LLC	7	98,553	0	10,841	1,204.00	2020	2020-660004997	2004 PROPERTIES LLC	7	98,018	0	10,782	1,196.00	2019	2019-660004997	2004 PROPERTIES LLC	7	93,515	0	10,287	1,141.00	2018	2018-660004997	2004 PROPERTIES LLC	7	91,952	0	10,115	1,086.00	2017	2017-660004997	2004 PROPERTIES LLC	7	91,193	0	10,031	1,087.00	2016	2016-660004997	2004 PROPERTIES LLC	7	88,867	0	9,775	1,060.00	2015	2015-660004997	BEACH, BRENT & AMELIA	7	92,927	0	10,222	1,115.00	2014	2014-660004997	BEACH, BRENT & AMELIA	7	94,763	0	10,424	1,147.00	2013	2013-660004997	BEACH, BRENT & AMELIA	7	95,443	0	10,499	1,134.00
Tax Year	Statement Number	Billed Owner	Tax Area	Total Value	Exemptions	Taxable Value	Billed Tax																																																																																																																		
2025	2025-660004997	2004 PROPERTIES LLC-	7	87,348	0	9,608	1,043.00																																																																																																																		
2024	2024-660004997	2004 PROPERTIES LLC-	7	96,771	0	10,645	1,175.00																																																																																																																		
2023	2023-660004997	2004 PROPERTIES LLC-	7	95,864	0	10,545	1,139.00																																																																																																																		
2022	2022-660004997	2004 PROPERTIES LLC-	7	95,861	0	10,545	1,184.00																																																																																																																		
2021	2021-660004997	2004 PROPERTIES LLC	7	98,553	0	10,841	1,204.00																																																																																																																		
2020	2020-660004997	2004 PROPERTIES LLC	7	98,018	0	10,782	1,196.00																																																																																																																		
2019	2019-660004997	2004 PROPERTIES LLC	7	93,515	0	10,287	1,141.00																																																																																																																		
2018	2018-660004997	2004 PROPERTIES LLC	7	91,952	0	10,115	1,086.00																																																																																																																		
2017	2017-660004997	2004 PROPERTIES LLC	7	91,193	0	10,031	1,087.00																																																																																																																		
2016	2016-660004997	2004 PROPERTIES LLC	7	88,867	0	9,775	1,060.00																																																																																																																		
2015	2015-660004997	BEACH, BRENT & AMELIA	7	92,927	0	10,222	1,115.00																																																																																																																		
2014	2014-660004997	BEACH, BRENT & AMELIA	7	94,763	0	10,424	1,147.00																																																																																																																		
2013	2013-660004997	BEACH, BRENT & AMELIA	7	95,443	0	10,499	1,134.00																																																																																																																		



Rogers

Assessment Property Record Card for Tax Year 2026

Data provided by LISA DELOZIER County Assessor

Date 04/17/2026
 Time 02:30:21
 Page 2

Lot Data		Square-Foot - NBHD 1014 #1	
Lot Size			
Lot Count			
Units Buildable	1		
Non-Ag Acres	0.4154		
Topography			
Street Access			
Utilities			
Amenities	LAND QUALITY	0	
		0	
Method	Square-Foot		
Base Lot Value	18,096.00 x 1.80 = 32,539		
Factor Value			
Adjustments	1.0000		
Lot Value	32,539		



\\tsclient\C\Users\Randy Necessary\Pictures\101_0421\IMG_0115. 4/25/2022

Residential Data	
Type	1 Single Family Residence
Condition	3 - Average
Quality	2 - Fair
Architecture	
Style	100% One Story
Exterior Wall	100% Frame, Siding, Vinyl
Base/Total Area	1,056 / 1,056
Style	100% One Story
HVAC	100% Warmed & Cooled Air
Roof Cover	1 Composition Shingle
Area on Slab	0
Fixture/RghIn	4 /
Bed/F/H Bath	2 / 1.0 /
Basement Area	
Garage Type	480 Attached Garage - Unfinished
Remodel	RMA -
Year/Eff Age	1950 / 51

GRM Approach	
GRM Code	
Gross Rent	0.00
Indicated Value	

Multiple Regression			
MRA Code	1 Test		
Adjusted R	0.8445		
Indicated Value	96,526	91.41	Per SqFt

Direct Comparables			
Selection Model	A Adam Test		
Adjustment Model	1 2022 Residential		
Comparables	3		
Indicated Value	167,700		Per SqFt

Cost Approach				Manual : 01/2025			
Base Cost	92.13	Total Misc Impr	+ 1,350				
Roofing Adj	+ 4.17	Garage Cost	+ 11,285				
Subfloor Adj	+ 2.43	Total RCN	= 132,787				
Heat/Cool Adj	+ 10.30	Depreciation (60%)	- 79,672				
Plumbing Adj	+ 4.75	Lump Sums	+ 702				
Basement Adj	+ 0.00	RCNLD	= 53,817				
Adj Base Cost	= 113.78	Lot Value	+ 32,539				
Total Area	x 1,056	Indicated Value	= 86,356				
Adjusted Cost	= 120,152	Value Per SqFt	81.78				

Value Reconciliation			
Selected Approach	Cost Approach		
Improvements	53,817		
Lot Value	32,539		
Indicated Value	86,356	81.78	Per SqFt
Agland Value			
Site Improvements			
Total Value	86,356	81.78	Total Value Per SqFt

Miscellaneous Improvements								
Code	Description	Sketch ID	Size	Year	Units	Unit Cost	Depr	Value
PRCH	SLAB PORCH - COVERED	12693	16x4		64	21.09		1,350
WODO	WOOD DECK - OPEN	12695	10x8		80	25.07	65%	702



Rogers

Assessment Property Record Card for Tax Year 2026

Data provided by LISA DELOZIER County Assessor

Date 04/17/2026
 Time 02:30:21
 Page 3

Sketch Image

660004997

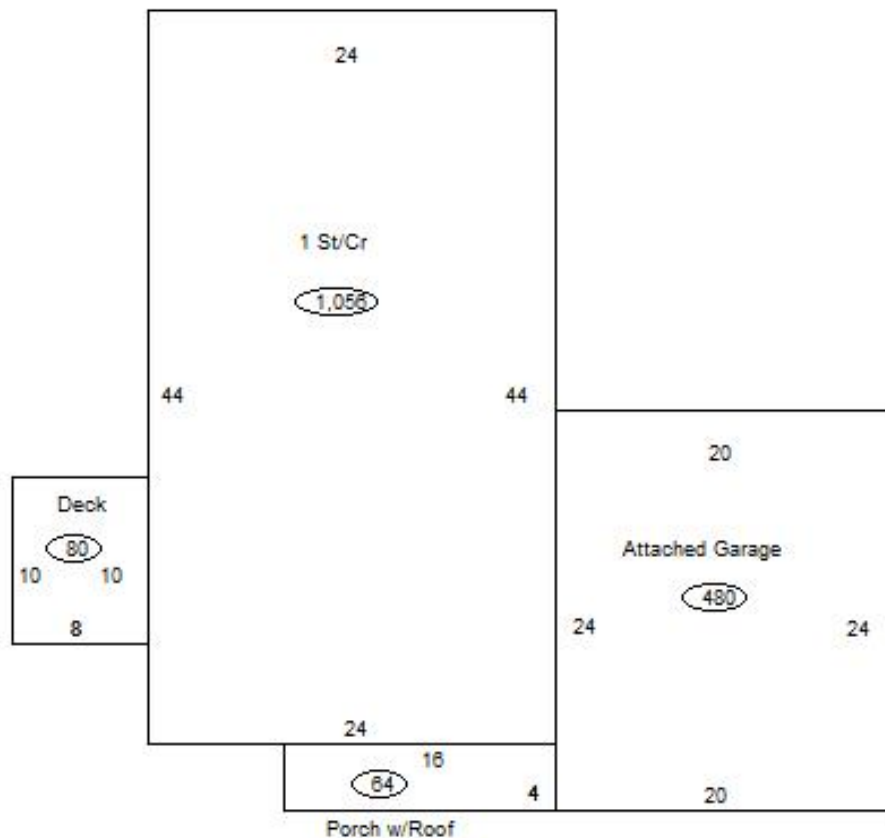

Sketch Vector Information

Sequence	Code	Type	Built Over	Scale	Section Label	Base Area	Multiplier	Total Area
1	R	1	Crawl	13	1 St/Cr	1,056	1.000	1,056
2	M	PRCH		13	SLBC	64	1.000	64
3	G	1		13	Attached Garage	480	1.000	480
4	M	WODO		13	WODO	80	1.000	80
Total Building Area						1,056		1,056