



# Rogers

## Assessment Property Record Card for Tax Year 2026

Data provided by LISA DELOZIER County Assessor

Date 04/17/2026  
Time 14:33:45  
Page 1

Assessment Data					Primary Image																																																																																																																				
<b>Account</b> 660005026 <b>Parcel ID</b> 000000-00-0-00468-015-0004 <b>Cadastral ID</b> 06-21-15-02450 <b>Property Type</b> REAL - Real Property <b>Property Class</b> RRP VI Area 4 <b>Tax Area</b> 7 - OWASSO/LIMESTONE FIRE <b>Name ID</b> 264600 CUMMINGS, SYLESTER L &  ANGELINE M CUMMINGS-TRUST 12107 N 193RD E AVE COLLINSVILLE OK 74021-0000																																																																																																																									
<b>Parcel Location</b> <b>Situs</b> 12107 N 193RD E AVE <b>Subdivision</b> LOOKING GLASS ESTATE <b>Lot/Block</b> 0004 / 0015 <b>Parcel Size</b> 1 - Lots <b>Sec/Twn/Rng</b> 6 / 21 / 15 / 5 <b>Neighborhood</b> 1014 - R-V04-SW OWASSO <b>School District</b> S021 - OWASSO SCHOOLS																																																																																																																									
<b>Legal Description</b> Lot/Long: 36.32948551 -95.75758797					<b>Building Permits</b> <table border="1"> <thead> <tr> <th>Number</th> <th>Description</th> <th>Opened</th> <th>Closed</th> <th>Amount</th> </tr> </thead> <tbody> <tr> <td>6114</td> <td>DET GARAGE</td> <td>01/2000</td> <td>07/2001</td> <td></td> </tr> </tbody> </table>					Number	Description	Opened	Closed	Amount	6114	DET GARAGE	01/2000	07/2001																																																																																																							
Number	Description	Opened	Closed	Amount																																																																																																																					
6114	DET GARAGE	01/2000	07/2001																																																																																																																						
<b>Exemptions</b> <table border="1"> <thead> <tr> <th>Code</th> <th>Type</th> <th>Active</th> <th>Maximum</th> <th>Exemption</th> </tr> </thead> <tbody> <tr> <td>H</td> <td>Homestead</td> <td>Yes</td> <td>1,000</td> <td>1,000</td> </tr> </tbody> </table>					Code	Type	Active	Maximum	Exemption	H	Homestead	Yes	1,000	1,000	<b>Sale History</b> <table border="1"> <thead> <tr> <th>Bk/Pg</th> <th>Grantor</th> <th>Date</th> <th>Price</th> <th>Code</th> </tr> </thead> <tbody> <tr> <td>1047/468</td> <td>BURNS, IRENE LOIS</td> <td>12/06/1996</td> <td></td> <td>0 No</td> </tr> </tbody> </table>					Bk/Pg	Grantor	Date	Price	Code	1047/468	BURNS, IRENE LOIS	12/06/1996		0 No																																																																																												
Code	Type	Active	Maximum	Exemption																																																																																																																					
H	Homestead	Yes	1,000	1,000																																																																																																																					
Bk/Pg	Grantor	Date	Price	Code																																																																																																																					
1047/468	BURNS, IRENE LOIS	12/06/1996		0 No																																																																																																																					
<b>Parcel Valuation</b> <table border="1"> <thead> <tr> <th>Source</th> <th>REAL</th> <th>Fair Cash</th> <th>Capped</th> <th>Asmnt Level</th> <th>Assessed</th> <th>Levy Rate</th> <th>108.538</th> <th>Current Tax</th> </tr> </thead> <tbody> <tr> <td>Remove Cap</td> <td>0</td> <td>Land Value 26,999</td> <td>11,272</td> <td>11%</td> <td>1,240</td> <td>Assessed</td> <td>10,184</td> <td>1,105.35</td> </tr> <tr> <td>Year Frozen</td> <td>0</td> <td>Improvements 115,950</td> <td>81,306</td> <td></td> <td>8,944</td> <td>Penalty</td> <td>0</td> <td></td> </tr> <tr> <td>Uncapped Value</td> <td>0</td> <td>Mobile Home 0</td> <td>0</td> <td></td> <td>0</td> <td>Exemption</td> <td>1,000</td> <td>-97.00</td> </tr> <tr> <td>TIF Project ID</td> <td>0</td> <td>Total Value 142,949</td> <td>92,578</td> <td></td> <td>10,184</td> <td>Total Taxable</td> <td>9,184</td> <td>1,008.00</td> </tr> </tbody> </table>										Source	REAL	Fair Cash	Capped	Asmnt Level	Assessed	Levy Rate	108.538	Current Tax	Remove Cap	0	Land Value 26,999	11,272	11%	1,240	Assessed	10,184	1,105.35	Year Frozen	0	Improvements 115,950	81,306		8,944	Penalty	0		Uncapped Value	0	Mobile Home 0	0		0	Exemption	1,000	-97.00	TIF Project ID	0	Total Value 142,949	92,578		10,184	Total Taxable	9,184	1,008.00																																																																			
Source	REAL	Fair Cash	Capped	Asmnt Level	Assessed	Levy Rate	108.538	Current Tax																																																																																																																	
Remove Cap	0	Land Value 26,999	11,272	11%	1,240	Assessed	10,184	1,105.35																																																																																																																	
Year Frozen	0	Improvements 115,950	81,306		8,944	Penalty	0																																																																																																																		
Uncapped Value	0	Mobile Home 0	0		0	Exemption	1,000	-97.00																																																																																																																	
TIF Project ID	0	Total Value 142,949	92,578		10,184	Total Taxable	9,184	1,008.00																																																																																																																	
<b>Assessment History</b> <table border="1"> <thead> <tr> <th>Tax Year</th> <th>Statement Number</th> <th>Billed Owner</th> <th>Tax Area</th> <th>Total Value</th> <th>Exemptions</th> <th>Taxable Value</th> <th>Billed Tax</th> </tr> </thead> <tbody> <tr><td>2025</td><td>2025-660005026</td><td>CUMMINGS, SYLESTER L &amp;</td><td>7</td><td>143,662</td><td>1000</td><td>8,887</td><td>976.00</td></tr> <tr><td>2024</td><td>2024-660005026</td><td>CUMMINGS, SYLESTER L &amp;</td><td>7</td><td>155,205</td><td>1000</td><td>8,599</td><td>963.00</td></tr> <tr><td>2023</td><td>2023-660005026</td><td>CUMMINGS, SYLESTER L &amp;</td><td>7</td><td>123,591</td><td>1000</td><td>8,320</td><td>913.00</td></tr> <tr><td>2022</td><td>2022-660005026</td><td>CUMMINGS, SYLESTER L &amp;</td><td>7</td><td>124,987</td><td>1000</td><td>8,048</td><td>917.00</td></tr> <tr><td>2021</td><td>2021-660005026</td><td>CUMMINGS, SYLESTER L &amp;</td><td>7</td><td>122,455</td><td>1000</td><td>7,785</td><td>878.00</td></tr> <tr><td>2020</td><td>2020-660005026</td><td>CUMMINGS, SYLESTER L &amp;</td><td>7</td><td>120,523</td><td>1000</td><td>7,529</td><td>849.00</td></tr> <tr><td>2019</td><td>2019-660005026</td><td>CUMMINGS, SYLESTER L &amp;</td><td>7</td><td>115,803</td><td>1000</td><td>7,280</td><td>822.00</td></tr> <tr><td>2018</td><td>2018-660005026</td><td>CUMMINGS, SYLESTER L &amp;</td><td>7</td><td>113,825</td><td>1000</td><td>7,039</td><td>770.00</td></tr> <tr><td>2017</td><td>2017-660005026</td><td>CUMMINGS, SYLESTER L &amp;</td><td>7</td><td>112,869</td><td>1000</td><td>6,805</td><td>751.00</td></tr> <tr><td>2016</td><td>2016-660005026</td><td>CUMMINGS, SYLESTER L &amp;</td><td>7</td><td>109,875</td><td>1000</td><td>6,578</td><td>727.00</td></tr> <tr><td>2015</td><td>2015-660005026</td><td>CUMMINGS, SYLESTER L &amp;</td><td>7</td><td>112,652</td><td>1000</td><td>6,358</td><td>708.00</td></tr> <tr><td>2014</td><td>2014-660005026</td><td>CUMMINGS, SYLESTER L &amp;</td><td>7</td><td>114,123</td><td>1000</td><td>6,143</td><td>690.00</td></tr> <tr><td>2013</td><td>2013-660005026</td><td>CUMMINGS, SYLESTER L &amp;</td><td>7</td><td>113,530</td><td>1000</td><td>5,935</td><td>655.00</td></tr> </tbody> </table>										Tax Year	Statement Number	Billed Owner	Tax Area	Total Value	Exemptions	Taxable Value	Billed Tax	2025	2025-660005026	CUMMINGS, SYLESTER L &	7	143,662	1000	8,887	976.00	2024	2024-660005026	CUMMINGS, SYLESTER L &	7	155,205	1000	8,599	963.00	2023	2023-660005026	CUMMINGS, SYLESTER L &	7	123,591	1000	8,320	913.00	2022	2022-660005026	CUMMINGS, SYLESTER L &	7	124,987	1000	8,048	917.00	2021	2021-660005026	CUMMINGS, SYLESTER L &	7	122,455	1000	7,785	878.00	2020	2020-660005026	CUMMINGS, SYLESTER L &	7	120,523	1000	7,529	849.00	2019	2019-660005026	CUMMINGS, SYLESTER L &	7	115,803	1000	7,280	822.00	2018	2018-660005026	CUMMINGS, SYLESTER L &	7	113,825	1000	7,039	770.00	2017	2017-660005026	CUMMINGS, SYLESTER L &	7	112,869	1000	6,805	751.00	2016	2016-660005026	CUMMINGS, SYLESTER L &	7	109,875	1000	6,578	727.00	2015	2015-660005026	CUMMINGS, SYLESTER L &	7	112,652	1000	6,358	708.00	2014	2014-660005026	CUMMINGS, SYLESTER L &	7	114,123	1000	6,143	690.00	2013	2013-660005026	CUMMINGS, SYLESTER L &	7	113,530	1000	5,935	655.00
Tax Year	Statement Number	Billed Owner	Tax Area	Total Value	Exemptions	Taxable Value	Billed Tax																																																																																																																		
2025	2025-660005026	CUMMINGS, SYLESTER L &	7	143,662	1000	8,887	976.00																																																																																																																		
2024	2024-660005026	CUMMINGS, SYLESTER L &	7	155,205	1000	8,599	963.00																																																																																																																		
2023	2023-660005026	CUMMINGS, SYLESTER L &	7	123,591	1000	8,320	913.00																																																																																																																		
2022	2022-660005026	CUMMINGS, SYLESTER L &	7	124,987	1000	8,048	917.00																																																																																																																		
2021	2021-660005026	CUMMINGS, SYLESTER L &	7	122,455	1000	7,785	878.00																																																																																																																		
2020	2020-660005026	CUMMINGS, SYLESTER L &	7	120,523	1000	7,529	849.00																																																																																																																		
2019	2019-660005026	CUMMINGS, SYLESTER L &	7	115,803	1000	7,280	822.00																																																																																																																		
2018	2018-660005026	CUMMINGS, SYLESTER L &	7	113,825	1000	7,039	770.00																																																																																																																		
2017	2017-660005026	CUMMINGS, SYLESTER L &	7	112,869	1000	6,805	751.00																																																																																																																		
2016	2016-660005026	CUMMINGS, SYLESTER L &	7	109,875	1000	6,578	727.00																																																																																																																		
2015	2015-660005026	CUMMINGS, SYLESTER L &	7	112,652	1000	6,358	708.00																																																																																																																		
2014	2014-660005026	CUMMINGS, SYLESTER L &	7	114,123	1000	6,143	690.00																																																																																																																		
2013	2013-660005026	CUMMINGS, SYLESTER L &	7	113,530	1000	5,935	655.00																																																																																																																		



# Rogers

## Assessment Property Record Card for Tax Year 2026

Data provided by LISA DELOZIER County Assessor

Date 04/17/2026  
Time 14:33:45  
Page 2

Lot Data	Square-Foot - NBHD 1014 #1	Primary Image
Lot Size		
Lot Count		
Units Buildable	1	
Non-Ag Acres	0.3359	
Topography		
Street Access		
Utilities		
Amenities	LAND QUALITY	
	0	
	0	
Method	Square-Foot	
Base Lot Value	14,633.00 x 1.85 = 26,999	
Factor Value		
Adjustments	1.0000	
Lot Value	26,999	

Residential Data	
Type	1 Single Family Residence
Condition	3 - Average
Quality	2 - Fair
Architecture	
Style	100% One Story
Exterior Wall	100% Frame, Siding, Wood
Base/Total Area	1,440 / 1,440
Style	100% One Story
HVAC	100% Warmed & Cooled Air
Roof Cover	1 Composition Shingle
Area on Slab	0
Fixture/RghIn	11 /
Bed/F/H Bath	3 / 2.0 /
Basement Area	
Garage Type	
Remodel	
Year/Eff Age	1997 / 22

Cost Approach		Manual : 01/2025	
Base Cost	85.11	Total Misc Impr	+ 6,260
Roofing Adj	+ 3.84	Garage Cost	+
Subfloor Adj	+ 2.26	Total RCN	= 165,078
Heat/Cool Adj	+ 10.30	Depreciation ( 31%)	- 51,174
Plumbing Adj	+ 8.78	Lump Sums	+ 2,046
Basement Adj	+ 0.00	RCNLD	= 115,950
Adj Base Cost	= 110.29	Lot Value	+ 26,999
Total Area	x 1,440	Indicated Value	= 142,949
Adjusted Cost	= 158,818	Value Per SqFt	99.27



\\tsclient\C\Users\Randy Necessary\Pictures\101\_0422\IMG\_0057. 4/26/2022

GRM Approach	
GRM Code	
Gross Rent	0.00
Indicated Value	

Multiple Regression	
MRA Code	1 Test
Adusted R	0.8445
Indicated Value	115,395 80.14 Per SqFt

Direct Comparables	
Selection Model	A Adam Test
Adjustment Model	1 2022 Residential
Comparables	5
Indicated Value	153,780 Per SqFt

Value Reconciliation	
Selected Approach	Cost Approach
Improvements	115,950
Lot Value	26,999
Indicated Value	142,949 99.27 Per SqFt
Agland Value	
Site Improvements	
Total Value	142,949 99.27 Total Value Per SqFt

Miscellaneous Improvements								
Code	Description	Sketch ID	Size	Year	Units	Unit Cost	Depr	Value
FPR1	FIREPLACE - RESIDENTIAL 1 STORY	0		1	1	4,576.55		4,577
PRCH	SLAB PORCH - COVERED	12745	20x4		80	21.04		1,683
WODO	WOOD DECK - OPEN	12746	18x12		216	18.94	50%	2,046



# Rogers

## Assessment Property Record Card for Tax Year 2026

Data provided by LISA DELOZIER County Assessor

Date 04/17/2026  
 Time 14:33:45  
 Page 3

### Sketch Image

660005026

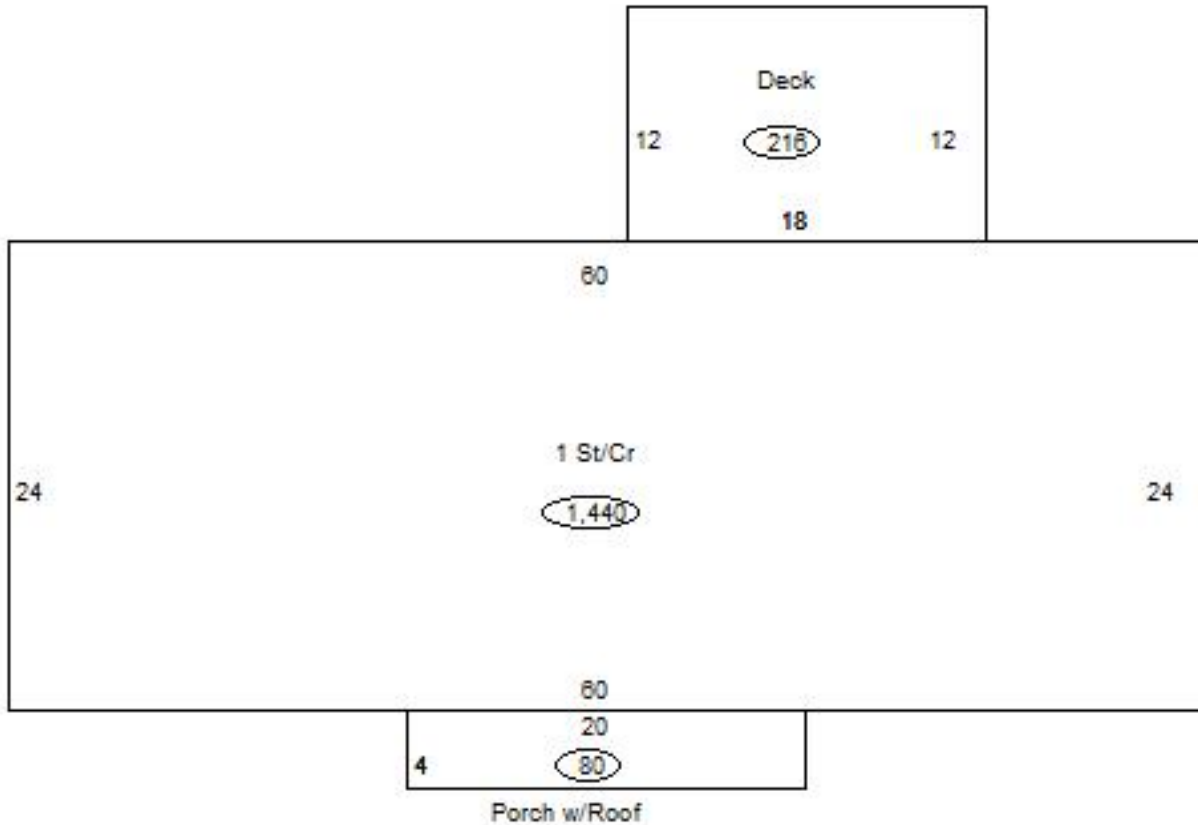

### Sketch Vector Information

Sequence	Code	Type	Built Over	Scale	Section Label	Base Area	Multiplier	Total Area
1	R	1	Crawl	13	1 St/Cr	1,440	1.000	1,440
2	M	PRCH		13	SLBC	80	1.000	80
3	M	WODO		13	WODO	216	1.000	216
<b>Total Building Area</b>						1,440		1,440



# Rogers

## Assessment Property Record Card for Tax Year 2026

Data provided by LISA DELOZIER County Assessor

Date 04/17/2026  
Time 14:33:45  
Page 4

660005026

### Outbuildings/Site Improvements

Building Image	Code	Description	Dimensions	Floor	Roofing	Total Units
	STF	STG FAIR	0x0x0			
	Qual 2	Cond 3	Year	Eff Age 1520		
<b>Valuation Summary</b>		<b>Modifier Total</b>	<b>RCN</b>	<b>Depr (100% Phys/ % Func)</b>	<b>RCNLD</b>	
Base Cost (4.68 x )						