



Rogers

Assessment Property Record Card for Tax Year 2026

Data provided by LISA DELOZIER County Assessor

Date 04/17/2026
Time 08:35:49
Page 1

Assessment Data					Primary Image														
Account 660005036 Parcel ID 000000-00-0-00468-015-0014 Cadastral ID 06-21-15-02550 Property Type REAL - Real Property Property Class RRP VI Area 4 Tax Area 7 - OWASSO/LIMESTONE FIRE Name ID 253252 DEVORE, STEVEN L & DEBORAH L 12102 N 194TH E AVE COLLINSVILLE OK 74021-0000																			
Parcel Location Situs 12102 N 194TH E AVE Subdivision LOOKING GLASS ESTATE Lot/Block 0014 / 0015 Parcel Size 1 - Lots Sec/Twn/Rng 6 / 21 / 15 / 5 Neighborhood 1014 - R-V04-SW OWASSO School District S021 - OWASSO SCHOOLS																			
Legal Description Lat/Long: 36.32922489 -95.75699197					Building Permits														
LOT 14 BLOCK 15 LOOKING GLASS ESTATES					<table border="1"> <thead> <tr> <th>Number</th> <th>Description</th> <th>Opened</th> <th>Closed</th> <th>Amount</th> </tr> </thead> <tbody> <tr> <td> </td> <td> </td> <td> </td> <td> </td> <td> </td> </tr> </tbody> </table>					Number	Description	Opened	Closed	Amount					
Number	Description	Opened	Closed	Amount															
Exemptions					Sale History														
Code	Type	Active	Maximum	Exemption	Bk/Pg	Grantor	Date	Price	Code										
HV	Veteran	Yes	999,999	7,084	882/418	SUNRISE HOMES INC	05/21/1992	35,000	No										
Parcel Valuation																			
Source	REAL		Fair Cash	Capped	Asmnt Level	Assessed	Levy Rate	108.538	Current Tax										
Remove Cap	0	Land Value	26,650	11,104	11%	1,221	Assessed	7,084	768.88										
Year Frozen	0	Improvements	70,859	53,299		5,863	Penalty	0											
Uncapped Value	0	Mobile Home	0	0		0	Exemption	7,084	-694.00										
TIF Project ID	0	Total Value	97,509	64,403		7,084	Total Taxable	0	75.00										
Assessment History																			
Tax Year	Statement Number	Billed Owner			Tax Area	Total Value	Exemptions	Taxable Value	Billed Tax										
2025	2025-660005036	DEVORE, STEVEN L &			7	96,530	6878		73.00										
2024	2024-660005036	DEVORE, STEVEN L &			7	105,070	6677		95.00										
2023	2023-660005036	DEVORE, STEVEN L &			7	82,956	6483		93.00										
2022	2022-660005036	DEVORE, STEVEN L &			7	84,179	6294		90.00										
2021	2021-660005036	DEVORE, STEVEN L &			7	84,542	6111		87.00										
2020	2020-660005036	DEVORE, STEVEN L &			7	83,324	5933		85.00										
2019	2019-660005036	DEVORE, STEVEN L &			7	81,583	5760		82.00										
2018	2018-660005036	DEVORE, STEVEN L &			7	81,094	5592		80.00										
2017	2017-660005036	DEVORE, STEVEN L &			7	80,458	5430		78.00										
2016	2016-660005036	DEVORE, STEVEN L &			7	78,384	5272		75.00										
2015	2015-660005036	DEVORE, STEVEN L &			7	84,838	5118		73.00										
2014	2014-660005036	DEVORE, STEVEN L &			7	85,468	4969		71.00										
2013	2013-660005036	DEVORE, STEVEN L &			7	86,571	4825		69.00										



Rogers

Assessment Property Record Card for Tax Year 2026

Data provided by LISA DELOZIER County Assessor

Date 04/17/2026
Time 08:35:49
Page 2

Lot Data	Square-Foot - NBHD 1014 #1	Primary Image
Lot Size Lot Count Units Buildable 1 Non-Ag Acres 0.3309 Topography Street Access Utilities Amenities LAND QUALITY 0 0 Method Square-Foot Base Lot Value 14,415.00 x 1.85 = 26,650 Factor Value Adjustments 1.0000 Lot Value 26,650		
Residential Data Type 1 Single Family Residence Condition 2 - Fair Quality 1.5 - Low Architecture Style 100% One Story Exterior Wall 100% Frame, Siding, Vinyl Base/Total Area 1,472 / 1,472 Style 100% One Story HVAC 100% Wall Furnace Roof Cover 1 Composition Shingle Area on Slab 0 Fixture/RghIn 11 / Bed/F/H Bath 3 / 2.0 / Basement Area Garage Type Remodel Year/Eff Age 1982 / 44		

\\tsclient\C\Users\Randy Necessary\Pictures\101_0422\IMG_0083. 4/26/2022

Residential Data	
Type	1 Single Family Residence
Condition	2 - Fair
Quality	1.5 - Low
Architecture	
Style	100% One Story
Exterior Wall	100% Frame, Siding, Vinyl
Base/Total Area	1,472 / 1,472
Style	100% One Story
HVAC	100% Wall Furnace
Roof Cover	1 Composition Shingle
Area on Slab	0
Fixture/RghIn	11 /
Bed/F/H Bath	3 / 2.0 /
Basement Area	
Garage Type	
Remodel	
Year/Eff Age	1982 / 44

GRM Approach

GRM Code	
Gross Rent	0.00
Indicated Value	

Multiple Regression

MRA Code	1 Test
Adusted R	0.8445
Indicated Value	82,831 56.27 Per SqFt

Direct Comparables

Selection Model	A Adam Test
Adjustment Model	1 2022 Residential
Comparables	
Indicated Value	

Value Reconciliation

Selected Approach	Cost Approach
Improvements	70,859
Lot Value	26,650
Indicated Value	97,509 66.24 Per SqFt
Agland Value	
Site Improvements	
Total Value	97,509 66.24 Total Value Per SqFt

Cost Approach Manual : 01/2025

Base Cost	82.03	Total Misc Impr	+ 2,900
Roofing Adj	+ 3.83	Garage Cost	+ 0
Subfloor Adj	+ 2.34	Total RCN	= 145,949
Heat/Cool Adj	+ 0.73	Depreciation (54%)	- 78,812
Plumbing Adj	+ 8.25	Lump Sums	+ 3,722
Basement Adj	+ 0.00	RCNLD	= 70,859
Adj Base Cost	= 97.18	Lot Value	+ 26,650
Total Area	x 1,472	Indicated Value	= 97,509
Adjusted Cost	= 143,049	Value Per SqFt	66.24

Miscellaneous Improvements

Code	Description	Sketch ID	Size	Year	Units	Unit Cost	Depr	Value
PRCH	SLAB PORCH - COVERED	12763	18x8		144	20.14		2,900
WODO	WOOD DECK - OPEN	138679	20x10		200	18.61		3,722



Rogers

Assessment Property Record Card for Tax Year 2026

Data provided by LISA DELOZIER County Assessor

Date 04/17/2026

Time 08:35:49

Page 3

Sketch Image

660005036

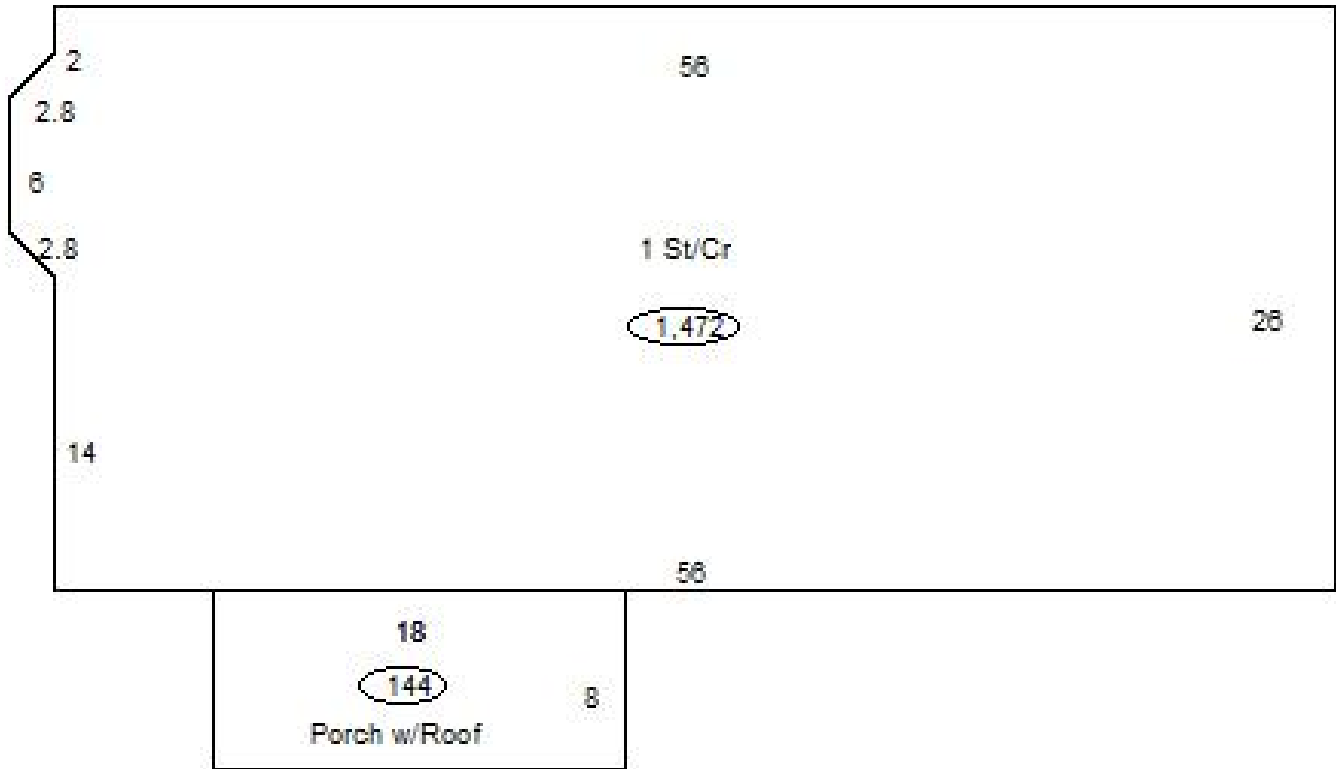

Sketch Vector Information

Sequence	Code	Type	Built Over	Scale	Section Label	Base Area	Multiplier	Total Area
1	R	1	Crawl	13	1 St/Cr	1,472	1.000	1,472
2	M	PRCH		13	SLBC	144	1.000	144
3	M	WODO		13	WODO	200	1.000	200
Total Building Area						1,472		1,472



Rogers

Assessment Property Record Card for Tax Year 2026

Data provided by LISA DELOZIER County Assessor

Date 04/17/2026
Time 08:35:49
Page 4

660005036

Outbuildings/Site Improvements

Building Image	Code	Description	Dimensions	Floor	Roofing	Total Units
	STF	STG FAIR	0x0x0			
	Qual	2	Cond 2	Year	Eff Age	2026
Valuation Summary		Modifier Total		RCN	Depr (100% Phys/ % Func)	RCNLD
Base Cost (4.68 x)						