



Rogers

Assessment Property Record Card for Tax Year 2026

Data provided by LISA DELOZIER County Assessor

Date 04/17/2026
Time 01:59:07
Page 1

Assessment Data					Primary Image																																																																																																																				
Account 660005081 Parcel ID 000000-00-0-00471-001-0001 Cadastral ID 06-21-15-03010 Property Type REAL - Real Property Property Class RRP VI Area 4 Tax Area 7 - OWASSO/LIMESTONE FIRE Name ID 277224 WISK, JAY A 12211 N 195TH E AVE COLLINSVILLE OK 74021-0000 Parcel Location Situs 12211 N 195TH E AVE Subdivision LOOKING GLASS EXT Lot/Block 0001 / 0001 Parcel Size 1 - Lots Sec/Twn/Rng 6 / 21 / 15 / 5 Neighborhood 1014 - R-V04-SW OWASSO School District S021 - OWASSO SCHOOLS																																																																																																																									
Legal Description Lot/Long: 36.33050537 -95.75400659																																																																																																																									
Building Permits					<table border="1"> <thead> <tr> <th>Number</th> <th>Description</th> <th>Opened</th> <th>Closed</th> <th>Amount</th> </tr> </thead> <tbody> <tr> <td colspan="5" style="height: 100px;"> </td> </tr> </tbody> </table>					Number	Description	Opened	Closed	Amount																																																																																																											
Number	Description	Opened	Closed	Amount																																																																																																																					
Exemptions					Sale History																																																																																																																				
<table border="1"> <thead> <tr> <th>Code</th> <th>Type</th> <th>Active</th> <th>Maximum</th> <th>Exemption</th> </tr> </thead> <tbody> <tr> <td>H</td> <td>Homestead</td> <td>Yes</td> <td>1,000</td> <td>1,000</td> </tr> </tbody> </table>					Code	Type	Active	Maximum	Exemption	H	Homestead	Yes	1,000	1,000	<table border="1"> <thead> <tr> <th>Bk/Pg</th> <th>Grantor</th> <th>Date</th> <th>Price</th> <th>Code</th> </tr> </thead> <tbody> <tr> <td>1301/530</td> <td>COOPER, THOMAS KEVIN &</td> <td>06/28/2001</td> <td>103,000</td> <td>YES</td> </tr> <tr> <td>976/643</td> <td>MARTIN, DAVIE D</td> <td>12/12/1994</td> <td>59,500</td> <td>Yes</td> </tr> <tr> <td>971/358</td> <td>MARTIN, BETTY L</td> <td>10/19/1994</td> <td>0</td> <td>No</td> </tr> <tr> <td>904/116</td> <td>SELLER</td> <td>01/14/1993</td> <td>0</td> <td>No</td> </tr> </tbody> </table>					Bk/Pg	Grantor	Date	Price	Code	1301/530	COOPER, THOMAS KEVIN &	06/28/2001	103,000	YES	976/643	MARTIN, DAVIE D	12/12/1994	59,500	Yes	971/358	MARTIN, BETTY L	10/19/1994	0	No	904/116	SELLER	01/14/1993	0	No																																																																													
Code	Type	Active	Maximum	Exemption																																																																																																																					
H	Homestead	Yes	1,000	1,000																																																																																																																					
Bk/Pg	Grantor	Date	Price	Code																																																																																																																					
1301/530	COOPER, THOMAS KEVIN &	06/28/2001	103,000	YES																																																																																																																					
976/643	MARTIN, DAVIE D	12/12/1994	59,500	Yes																																																																																																																					
971/358	MARTIN, BETTY L	10/19/1994	0	No																																																																																																																					
904/116	SELLER	01/14/1993	0	No																																																																																																																					
Parcel Valuation																																																																																																																									
<table border="1"> <thead> <tr> <th>Source</th> <th>REAL</th> </tr> </thead> <tbody> <tr> <td>Remove Cap</td> <td>2002</td> </tr> <tr> <td>Year Frozen</td> <td>0</td> </tr> <tr> <td>Uncapped Value</td> <td>0</td> </tr> <tr> <td>TIF Project ID</td> <td>0</td> </tr> </tbody> </table>		Source	REAL	Remove Cap	2002	Year Frozen	0	Uncapped Value	0	TIF Project ID	0	<table border="1"> <thead> <tr> <th>Fair Cash</th> <th>Capped</th> <th>Asmnt Level</th> <th>Assessed</th> </tr> </thead> <tbody> <tr> <td>Land Value</td> <td>76,197</td> <td>46,933</td> <td>5,163</td> </tr> <tr> <td>Improvements</td> <td>113,172</td> <td>106,533</td> <td>11,719</td> </tr> <tr> <td>Mobile Home</td> <td>0</td> <td>0</td> <td>0</td> </tr> <tr> <td>Total Value</td> <td>189,369</td> <td>153,466</td> <td>16,882</td> </tr> </tbody> </table>			Fair Cash	Capped	Asmnt Level	Assessed	Land Value	76,197	46,933	5,163	Improvements	113,172	106,533	11,719	Mobile Home	0	0	0	Total Value	189,369	153,466	16,882	<table border="1"> <thead> <tr> <th>Levy Rate</th> <th>Current Tax</th> </tr> </thead> <tbody> <tr> <td>108.538</td> <td>1,832.34</td> </tr> <tr> <td>Assessed</td> <td>16,882</td> </tr> <tr> <td>Penalty</td> <td>0</td> </tr> <tr> <td>Exemption</td> <td>1,000</td> </tr> <tr> <td>Total Taxable</td> <td>15,882</td> </tr> </tbody> </table>		Levy Rate	Current Tax	108.538	1,832.34	Assessed	16,882	Penalty	0	Exemption	1,000	Total Taxable	15,882																																																																									
Source	REAL																																																																																																																								
Remove Cap	2002																																																																																																																								
Year Frozen	0																																																																																																																								
Uncapped Value	0																																																																																																																								
TIF Project ID	0																																																																																																																								
Fair Cash	Capped	Asmnt Level	Assessed																																																																																																																						
Land Value	76,197	46,933	5,163																																																																																																																						
Improvements	113,172	106,533	11,719																																																																																																																						
Mobile Home	0	0	0																																																																																																																						
Total Value	189,369	153,466	16,882																																																																																																																						
Levy Rate	Current Tax																																																																																																																								
108.538	1,832.34																																																																																																																								
Assessed	16,882																																																																																																																								
Penalty	0																																																																																																																								
Exemption	1,000																																																																																																																								
Total Taxable	15,882																																																																																																																								
Assessment History																																																																																																																									
<table border="1"> <thead> <tr> <th>Tax Year</th> <th>Statement Number</th> <th>Billed Owner</th> <th>Tax Area</th> <th>Total Value</th> <th>Exemptions</th> <th>Taxable Value</th> <th>Billed Tax</th> </tr> </thead> <tbody> <tr><td>2025</td><td>2025-660005081</td><td>WISK, JAY A</td><td>7</td><td>181,147</td><td>1000</td><td>15,389</td><td>1,681.00</td></tr> <tr><td>2024</td><td>2024-660005081</td><td>WISK, JAY A</td><td>7</td><td>295,812</td><td>1000</td><td>14,912</td><td>1,660.00</td></tr> <tr><td>2023</td><td>2023-660005081</td><td>WISK, JAY A</td><td>7</td><td>141,998</td><td>1000</td><td>14,449</td><td>1,575.00</td></tr> <tr><td>2022</td><td>2022-660005081</td><td>WISK, JAY A</td><td>7</td><td>136,355</td><td>1000</td><td>13,999</td><td>1,585.00</td></tr> <tr><td>2021</td><td>2021-660005081</td><td>WISK, JAY A</td><td>7</td><td>133,271</td><td>1000</td><td>13,660</td><td>1,530.00</td></tr> <tr><td>2020</td><td>2020-660005081</td><td>WISK, JAY A</td><td>7</td><td>131,076</td><td>1000</td><td>13,235</td><td>1,482.00</td></tr> <tr><td>2019</td><td>2019-660005081</td><td>WISK, JAY A</td><td>7</td><td>125,642</td><td>1000</td><td>12,821</td><td>1,436.00</td></tr> <tr><td>2018</td><td>2018-660005081</td><td>WISK, JAY A</td><td>7</td><td>130,054</td><td>1000</td><td>13,306</td><td>1,443.00</td></tr> <tr><td>2017</td><td>2017-660005081</td><td>WISK, JAY A</td><td>7</td><td>128,828</td><td>1000</td><td>13,171</td><td>1,441.00</td></tr> <tr><td>2016</td><td>2016-660005081</td><td>WISK, JAY A</td><td>7</td><td>125,519</td><td>1000</td><td>12,807</td><td>1,403.00</td></tr> <tr><td>2015</td><td>2015-660005081</td><td>WISK, JAY A</td><td>7</td><td>121,974</td><td>1000</td><td>12,417</td><td>1,370.00</td></tr> <tr><td>2014</td><td>2014-660005081</td><td>WISK, JAY A</td><td>7</td><td>124,489</td><td>1000</td><td>12,116</td><td>1,347.00</td></tr> <tr><td>2013</td><td>2013-660005081</td><td>WISK, JAY A</td><td>7</td><td>117,694</td><td>1000</td><td>11,734</td><td>1,281.00</td></tr> </tbody> </table>										Tax Year	Statement Number	Billed Owner	Tax Area	Total Value	Exemptions	Taxable Value	Billed Tax	2025	2025-660005081	WISK, JAY A	7	181,147	1000	15,389	1,681.00	2024	2024-660005081	WISK, JAY A	7	295,812	1000	14,912	1,660.00	2023	2023-660005081	WISK, JAY A	7	141,998	1000	14,449	1,575.00	2022	2022-660005081	WISK, JAY A	7	136,355	1000	13,999	1,585.00	2021	2021-660005081	WISK, JAY A	7	133,271	1000	13,660	1,530.00	2020	2020-660005081	WISK, JAY A	7	131,076	1000	13,235	1,482.00	2019	2019-660005081	WISK, JAY A	7	125,642	1000	12,821	1,436.00	2018	2018-660005081	WISK, JAY A	7	130,054	1000	13,306	1,443.00	2017	2017-660005081	WISK, JAY A	7	128,828	1000	13,171	1,441.00	2016	2016-660005081	WISK, JAY A	7	125,519	1000	12,807	1,403.00	2015	2015-660005081	WISK, JAY A	7	121,974	1000	12,417	1,370.00	2014	2014-660005081	WISK, JAY A	7	124,489	1000	12,116	1,347.00	2013	2013-660005081	WISK, JAY A	7	117,694	1000	11,734	1,281.00
Tax Year	Statement Number	Billed Owner	Tax Area	Total Value	Exemptions	Taxable Value	Billed Tax																																																																																																																		
2025	2025-660005081	WISK, JAY A	7	181,147	1000	15,389	1,681.00																																																																																																																		
2024	2024-660005081	WISK, JAY A	7	295,812	1000	14,912	1,660.00																																																																																																																		
2023	2023-660005081	WISK, JAY A	7	141,998	1000	14,449	1,575.00																																																																																																																		
2022	2022-660005081	WISK, JAY A	7	136,355	1000	13,999	1,585.00																																																																																																																		
2021	2021-660005081	WISK, JAY A	7	133,271	1000	13,660	1,530.00																																																																																																																		
2020	2020-660005081	WISK, JAY A	7	131,076	1000	13,235	1,482.00																																																																																																																		
2019	2019-660005081	WISK, JAY A	7	125,642	1000	12,821	1,436.00																																																																																																																		
2018	2018-660005081	WISK, JAY A	7	130,054	1000	13,306	1,443.00																																																																																																																		
2017	2017-660005081	WISK, JAY A	7	128,828	1000	13,171	1,441.00																																																																																																																		
2016	2016-660005081	WISK, JAY A	7	125,519	1000	12,807	1,403.00																																																																																																																		
2015	2015-660005081	WISK, JAY A	7	121,974	1000	12,417	1,370.00																																																																																																																		
2014	2014-660005081	WISK, JAY A	7	124,489	1000	12,116	1,347.00																																																																																																																		
2013	2013-660005081	WISK, JAY A	7	117,694	1000	11,734	1,281.00																																																																																																																		



Rogers

Assessment Property Record Card for Tax Year 2026

Data provided by LISA DELOZIER County Assessor

Date 04/17/2026
Time 01:59:07
Page 2

Lot Data	Square-Foot - NBHD 1014 #1	Primary Image
Lot Size Lot Count Units Buildable 1 Non-Ag Acres 2.6576 Topography Street Access Utilities Amenities LAND QUALITY 0 0 Method Square-Foot Base Lot Value 115,764.00 x .66 = 76,197 Factor Value Adjustments 1.0000 Lot Value 76,197		
Residential Data Type 1 Single Family Residence Condition 3 - Average Quality 2 - Fair Architecture Style 100% One Story Exterior Wall 60% Veneer, Masonry 40% Frame, Siding, Vinyl Base/Total Area 1,400 / 1,400 Style 100% One Story HVAC 100% Warmed & Cooled Air Roof Cover 1 Composition Shingle Area on Slab 1,400 Fixture/RghIn 11 / Bed/F/H Bath 3 / 2.0 / Basement Area Garage Type Remodel Year/Eff Age 1981 / 34		

\\tsclient\C\Users\Randy Necessary\Pictures\101_0425\IMG_0047. 4/27/2022

Residential Data	
Type	1 Single Family Residence
Condition	3 - Average
Quality	2 - Fair
Architecture	
Style	100% One Story
Exterior Wall	60% Veneer, Masonry 40% Frame, Siding, Vinyl
Base/Total Area	1,400 / 1,400
Style	100% One Story
HVAC	100% Warmed & Cooled Air
Roof Cover	1 Composition Shingle
Area on Slab	1,400
Fixture/RghIn	11 /
Bed/F/H Bath	3 / 2.0 /
Basement Area	
Garage Type	
Remodel	
Year/Eff Age	1981 / 34

GRM Approach	
GRM Code	
Gross Rent	0.00
Indicated Value	

Multiple Regression	
MRA Code	1 Test
Adjusted R	0.8445
Indicated Value	113,757 81.26 Per SqFt

Direct Comparables	
Selection Model	A Adam Test
Adjustment Model	1 2022 Residential
Comparables	8
Indicated Value	172,490 Per SqFt

Cost Approach		Manual : 01/2025	
Base Cost	92.82	Total Misc Impr	+ 11,654
Roofing Adj	+ 3.95	Garage Cost	+
Subfloor Adj	+ 0.00	Total RCN	= 174,194
Heat/Cool Adj	+ 10.30	Depreciation (45%)	- 78,387
Plumbing Adj	+ 9.03	Lump Sums	+ 0
Basement Adj	+ 0.00	RCNLD	= 95,807
Adj Base Cost	= 116.10	Lot Value	+ 76,197
Total Area	x 1,400	Indicated Value	= 172,004
Adjusted Cost	= 162,540	Value Per SqFt	122.86

Value Reconciliation	
Selected Approach	Cost Approach
Improvements	95,807
Lot Value	76,197
Indicated Value	172,004 122.86 Per SqFt
Agland Value	
Site Improvements	17,365
Total Value	189,369 135.26 Total Value Per SqFt

Miscellaneous Improvements								
Code	Description	Sketch ID	Size	Year	Units	Unit Cost	Depr	Value
FPR1	FIREPLACE - RESIDENTIAL 1 STORY	0		1	1	4,576.55		4,577
PRCH	SLAB PORCH - COVERED	12807	34x8		272	20.44		5,560
PRCH	SLAB PORCH - COVERED	12808	12x6		72	21.07		1,517



Rogers

Assessment Property Record Card for Tax Year 2026

Data provided by LISA DELOZIER County Assessor

Date 04/17/2026
Time 01:59:07
Page 3

Sketch Image

660005081

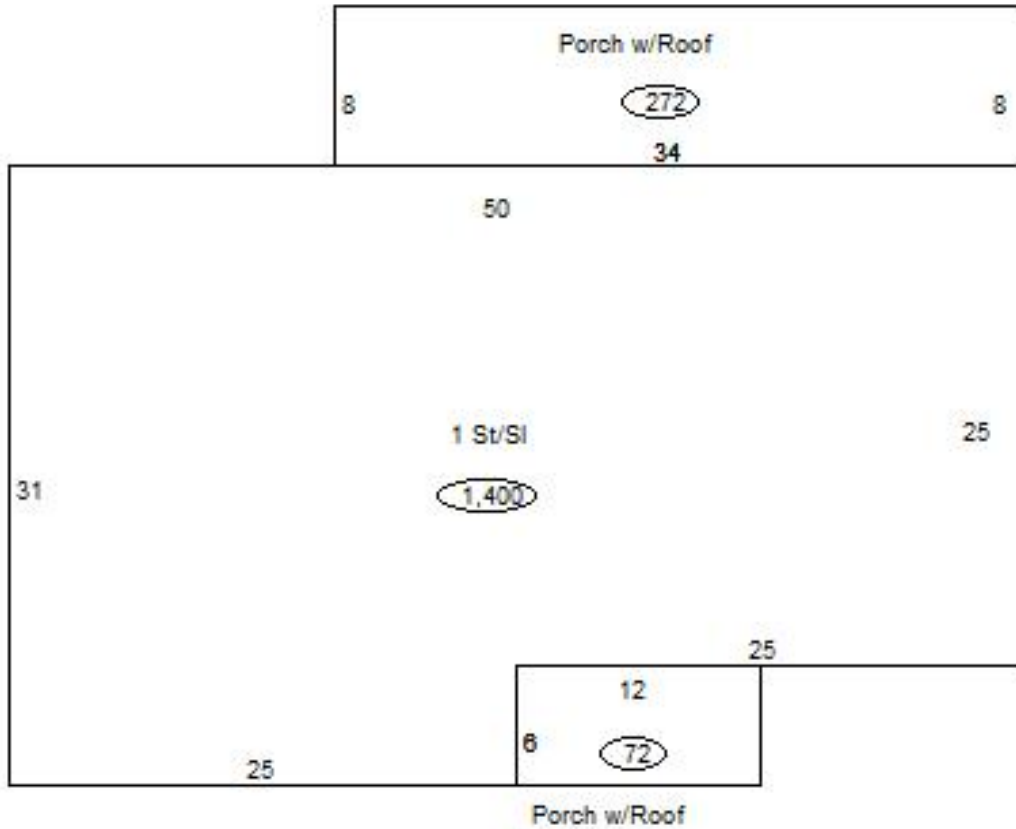

Sketch Vector Information

Sequence	Code	Type	Built Over	Scale	Section Label	Base Area	Multiplier	Total Area
1	R	1	Slab	13	1 St/Sl	1,400	1.000	1,400
2	M	PRCH		13	SLBC	272	1.000	272
3	M	PRCH		13	SLBC	72	1.000	72
Total Building Area						1,400		1,400



Rogers

Assessment Property Record Card for Tax Year 2026

Data provided by LISA DELOZIER County Assessor

Date 04/17/2026
 Time 01:59:08
 Page 4

660005081

Outbuildings/Site Improvements

Building Image	Code	Description	Dimensions	Floor	Roofing	Total Units
	UTIL SHOP		0x0x0			1,120
	Qual 1	Cond 3	Year	Eff Age		
Valuation Summary		Modifier Total		RCN	Depr (45% Phys/ % Func)	RCNLD
Base Cost (28.19 x 1,120)		31,573		31,573	14,208	17,365