



Rogers

Assessment Property Record Card for Tax Year 2026

Data provided by LISA DELOZIER County Assessor

Date 04/17/2026
Time 03:57:07
Page 1

Assessment Data					Primary Image																																																																																																																				
Account 660005121 Parcel ID 000000-00-0-00471-004-0013 Cadastral ID 06-21-15-03410 Property Type REAL - Real Property Property Class RRP VI Area 4 Tax Area 7 - OWASSO/LIMESTONE FIRE Name ID 277685 AL-KAZAZ, GAHLIB TRUST PO BOX 471352 TULSA OK 74147-0000 Parcel Location Situs 11623 N 195TH E AVE Subdivision LOOKING GLASS EXT Lot/Block 0013 / 0004 Parcel Size 2 - Lots Sec/Twn/Rng 6 / 21 / 15 / 5 Neighborhood 1014 - R-V04-SW OWASSO School District S021 - OWASSO SCHOOLS																																																																																																																									
Legal Description Lat/Long: 36.32338324 -95.75493478																																																																																																																									
Legal Description LOTS 12 & 13 BLOCK 4 LOOKING GLASS EXT.					Building Permits <table border="1"> <thead> <tr> <th>Number</th> <th>Description</th> <th>Opened</th> <th>Closed</th> <th>Amount</th> </tr> </thead> <tbody> <tr> <td> </td> <td> </td> <td> </td> <td> </td> <td> </td> </tr> </tbody> </table>					Number	Description	Opened	Closed	Amount																																																																																																											
Number	Description	Opened	Closed	Amount																																																																																																																					
Exemptions <table border="1"> <thead> <tr> <th>Code</th> <th>Type</th> <th>Active</th> <th>Maximum</th> <th>Exemption</th> </tr> </thead> <tbody> <tr> <td> </td> <td> </td> <td> </td> <td> </td> <td> </td> </tr> </tbody> </table>					Code	Type	Active	Maximum	Exemption						Sale History <table border="1"> <thead> <tr> <th>Bk/Pg</th> <th>Grantor</th> <th>Date</th> <th>Price</th> <th>Code</th> </tr> </thead> <tbody> <tr> <td>1317/647</td> <td>FEDERAL NATIONAL MOTRGAGAE-A</td> <td>08/29/2001</td> <td>0</td> <td>9</td> </tr> <tr> <td>1310/478</td> <td>COX, RUBY</td> <td>05/22/2001</td> <td>0</td> <td>10</td> </tr> </tbody> </table>					Bk/Pg	Grantor	Date	Price	Code	1317/647	FEDERAL NATIONAL MOTRGAGAE-A	08/29/2001	0	9	1310/478	COX, RUBY	05/22/2001	0	10																																																																																							
Code	Type	Active	Maximum	Exemption																																																																																																																					
Bk/Pg	Grantor	Date	Price	Code																																																																																																																					
1317/647	FEDERAL NATIONAL MOTRGAGAE-A	08/29/2001	0	9																																																																																																																					
1310/478	COX, RUBY	05/22/2001	0	10																																																																																																																					
Parcel Valuation <table border="1"> <thead> <tr> <th>Source</th> <th>REAL</th> <th>Fair Cash</th> <th>Capped</th> <th>Asmnt Level</th> <th>Assessed</th> <th>Levy Rate</th> <th>108.538</th> <th>Current Tax</th> </tr> </thead> <tbody> <tr> <td>Remove Cap</td> <td>2002</td> <td>Land Value 25,384</td> <td>17,910</td> <td>11%</td> <td>1,970</td> <td>Assessed</td> <td>6,407</td> <td>695.40</td> </tr> <tr> <td>Year Frozen</td> <td>0</td> <td>Improvements 46,308</td> <td>40,337</td> <td></td> <td>4,437</td> <td>Penalty</td> <td>0</td> <td></td> </tr> <tr> <td>Uncapped Value</td> <td>0</td> <td>Mobile Home 0</td> <td>0</td> <td></td> <td>0</td> <td>Exemption</td> <td>0</td> <td>0.00</td> </tr> <tr> <td>TIF Project ID</td> <td>0</td> <td>Total Value 71,692</td> <td>58,247</td> <td></td> <td>6,407</td> <td>Total Taxable</td> <td>6,407</td> <td>695.00</td> </tr> </tbody> </table>										Source	REAL	Fair Cash	Capped	Asmnt Level	Assessed	Levy Rate	108.538	Current Tax	Remove Cap	2002	Land Value 25,384	17,910	11%	1,970	Assessed	6,407	695.40	Year Frozen	0	Improvements 46,308	40,337		4,437	Penalty	0		Uncapped Value	0	Mobile Home 0	0		0	Exemption	0	0.00	TIF Project ID	0	Total Value 71,692	58,247		6,407	Total Taxable	6,407	695.00																																																																			
Source	REAL	Fair Cash	Capped	Asmnt Level	Assessed	Levy Rate	108.538	Current Tax																																																																																																																	
Remove Cap	2002	Land Value 25,384	17,910	11%	1,970	Assessed	6,407	695.40																																																																																																																	
Year Frozen	0	Improvements 46,308	40,337		4,437	Penalty	0																																																																																																																		
Uncapped Value	0	Mobile Home 0	0		0	Exemption	0	0.00																																																																																																																	
TIF Project ID	0	Total Value 71,692	58,247		6,407	Total Taxable	6,407	695.00																																																																																																																	
Assessment History <table border="1"> <thead> <tr> <th>Tax Year</th> <th>Statement Number</th> <th>Billed Owner</th> <th>Tax Area</th> <th>Total Value</th> <th>Exemptions</th> <th>Taxable Value</th> <th>Billed Tax</th> </tr> </thead> <tbody> <tr><td>2025</td><td>2025-660005121</td><td>AL-KAZAZ, GAHLIB TRUST</td><td>7</td><td>71,305</td><td>0</td><td>6,102</td><td>663.00</td></tr> <tr><td>2024</td><td>2024-660005121</td><td>AL-KAZAZ, GAHLIB TRUST</td><td>7</td><td>77,936</td><td>0</td><td>5,812</td><td>641.00</td></tr> <tr><td>2023</td><td>2023-660005121</td><td>AL-KAZAZ, GAHLIB TRUST</td><td>7</td><td>50,318</td><td>0</td><td>5,535</td><td>598.00</td></tr> <tr><td>2022</td><td>2022-660005121</td><td>AL-KAZAZ, GAHLIB TRUST</td><td>7</td><td>50,317</td><td>0</td><td>5,386</td><td>605.00</td></tr> <tr><td>2021</td><td>2021-660005121</td><td>AL-KAZAZ, GAHLIB TRUST</td><td>7</td><td>46,636</td><td>0</td><td>5,130</td><td>569.00</td></tr> <tr><td>2020</td><td>2020-660005121</td><td>AL-KAZAZ, GAHLIB TRUST</td><td>7</td><td>47,276</td><td>0</td><td>5,200</td><td>576.00</td></tr> <tr><td>2019</td><td>2019-660005121</td><td>AL-KAZAZ, GAHLIB TRUST</td><td>7</td><td>45,422</td><td>0</td><td>4,996</td><td>554.00</td></tr> <tr><td>2018</td><td>2018-660005121</td><td>AL-KAZAZ, GAHLIB TRUST</td><td>7</td><td>50,456</td><td>0</td><td>5,550</td><td>596.00</td></tr> <tr><td>2017</td><td>2017-660005121</td><td>AL-KAZAZ, GAHLIB TRUST</td><td>7</td><td>50,128</td><td>0</td><td>5,514</td><td>598.00</td></tr> <tr><td>2016</td><td>2016-660005121</td><td>AL-KAZAZ, GAHLIB TRUST</td><td>7</td><td>49,071</td><td>0</td><td>5,398</td><td>585.00</td></tr> <tr><td>2015</td><td>2015-660005121</td><td>AL-KAZAZ, GAHLIB TRUST</td><td>7</td><td>48,945</td><td>0</td><td>5,384</td><td>588.00</td></tr> <tr><td>2014</td><td>2014-660005121</td><td>AL-KAZAZ, GAHLIB TRUST</td><td>7</td><td>50,372</td><td>0</td><td>5,541</td><td>609.00</td></tr> <tr><td>2013</td><td>2013-660005121</td><td>AL-KAZAZ, GAHLIB TRUST</td><td>7</td><td>48,823</td><td>0</td><td>5,371</td><td>580.00</td></tr> </tbody> </table>										Tax Year	Statement Number	Billed Owner	Tax Area	Total Value	Exemptions	Taxable Value	Billed Tax	2025	2025-660005121	AL-KAZAZ, GAHLIB TRUST	7	71,305	0	6,102	663.00	2024	2024-660005121	AL-KAZAZ, GAHLIB TRUST	7	77,936	0	5,812	641.00	2023	2023-660005121	AL-KAZAZ, GAHLIB TRUST	7	50,318	0	5,535	598.00	2022	2022-660005121	AL-KAZAZ, GAHLIB TRUST	7	50,317	0	5,386	605.00	2021	2021-660005121	AL-KAZAZ, GAHLIB TRUST	7	46,636	0	5,130	569.00	2020	2020-660005121	AL-KAZAZ, GAHLIB TRUST	7	47,276	0	5,200	576.00	2019	2019-660005121	AL-KAZAZ, GAHLIB TRUST	7	45,422	0	4,996	554.00	2018	2018-660005121	AL-KAZAZ, GAHLIB TRUST	7	50,456	0	5,550	596.00	2017	2017-660005121	AL-KAZAZ, GAHLIB TRUST	7	50,128	0	5,514	598.00	2016	2016-660005121	AL-KAZAZ, GAHLIB TRUST	7	49,071	0	5,398	585.00	2015	2015-660005121	AL-KAZAZ, GAHLIB TRUST	7	48,945	0	5,384	588.00	2014	2014-660005121	AL-KAZAZ, GAHLIB TRUST	7	50,372	0	5,541	609.00	2013	2013-660005121	AL-KAZAZ, GAHLIB TRUST	7	48,823	0	5,371	580.00
Tax Year	Statement Number	Billed Owner	Tax Area	Total Value	Exemptions	Taxable Value	Billed Tax																																																																																																																		
2025	2025-660005121	AL-KAZAZ, GAHLIB TRUST	7	71,305	0	6,102	663.00																																																																																																																		
2024	2024-660005121	AL-KAZAZ, GAHLIB TRUST	7	77,936	0	5,812	641.00																																																																																																																		
2023	2023-660005121	AL-KAZAZ, GAHLIB TRUST	7	50,318	0	5,535	598.00																																																																																																																		
2022	2022-660005121	AL-KAZAZ, GAHLIB TRUST	7	50,317	0	5,386	605.00																																																																																																																		
2021	2021-660005121	AL-KAZAZ, GAHLIB TRUST	7	46,636	0	5,130	569.00																																																																																																																		
2020	2020-660005121	AL-KAZAZ, GAHLIB TRUST	7	47,276	0	5,200	576.00																																																																																																																		
2019	2019-660005121	AL-KAZAZ, GAHLIB TRUST	7	45,422	0	4,996	554.00																																																																																																																		
2018	2018-660005121	AL-KAZAZ, GAHLIB TRUST	7	50,456	0	5,550	596.00																																																																																																																		
2017	2017-660005121	AL-KAZAZ, GAHLIB TRUST	7	50,128	0	5,514	598.00																																																																																																																		
2016	2016-660005121	AL-KAZAZ, GAHLIB TRUST	7	49,071	0	5,398	585.00																																																																																																																		
2015	2015-660005121	AL-KAZAZ, GAHLIB TRUST	7	48,945	0	5,384	588.00																																																																																																																		
2014	2014-660005121	AL-KAZAZ, GAHLIB TRUST	7	50,372	0	5,541	609.00																																																																																																																		
2013	2013-660005121	AL-KAZAZ, GAHLIB TRUST	7	48,823	0	5,371	580.00																																																																																																																		



Rogers

Assessment Property Record Card for Tax Year 2026

Data provided by LISA DELOZIER County Assessor

Date 04/17/2026
 Time 03:57:07
 Page 2

Lot Data		Square-Foot - NBHD 1014 #1	
Lot Size			
Lot Count			
Units Buildable	2		
Non-Ag Acres	0.315		
Topography			
Street Access			
Utilities			
Amenities	LAND QUALITY	0	0
Method	Square-Foot		
Base Lot Value	13,721.00 x 1.85 = 25,384		
Factor Value			
Adjustments	1.0000		
Lot Value	25,384		



\\tsclient\A\TOMMY DUNLAP\New folder (350)\IMG_0036.JPG 4/30/2024

Residential Data	
Type	1 Single Family Residence
Condition	2.5 - Fair
Quality	2 - Fair
Architecture	
Style	100% One Story
Exterior Wall	100% Veneer, Masonry
Base/Total Area	1,519 / 1,519
Style	100% One Story
HVAC	100% Warmed & Cooled Air
Roof Cover	1 Composition Shingle
Area on Slab	1,519
Fixture/RghIn	11 /
Bed/F/H Bath	3 / 2.0 /
Basement Area	
Garage Type	480 Attached Garage - Unfinished
Remodel	
Year/Eff Age	1978 / 42

GRM Approach	
GRM Code	
Gross Rent	0.00
Indicated Value	

Multiple Regression			
MRA Code	1	Test	
Adusted R	0.8445		
Indicated Value	142,296	93.68	Per SqFt

Direct Comparables	
Selection Model	A Adam Test
Adjustment Model	1 2022 Residential
Comparables	
Indicated Value	

Cost Approach				Manual : 01/2025			
Base Cost	99.10	Total Misc Impr	+ 5,086				
Roofing Adj	+ 4.04	Garage Cost	+ 11,285				
Subfloor Adj	+ 0.00	Total RCN	= 201,340				
Heat/Cool Adj	+ 10.30	Depreciation (77%)	- 155,032				
Plumbing Adj	+ 8.33	Lump Sums	+ 0				
Basement Adj	+ 0.00	RCNLD	= 46,308				
Adj Base Cost	= 121.77	Lot Value	+ 25,384				
Total Area	x 1,519	Indicated Value	= 71,692				
Adjusted Cost	= 184,969	Value Per SqFt	47.20				

Value Reconciliation			
Selected Approach	Cost Approach		
Improvements	46,308		
Lot Value	25,384		
Indicated Value	71,692	47.20	Per SqFt
Agland Value			
Site Improvements			
Total Value	71,692	47.20	Total Value Per SqFt

Miscellaneous Improvements								
Code	Description	Sketch ID	Size	Year	Units	Unit Cost	Depr	Value
FPR1	FIREPLACE - RESIDENTIAL 1 STORY	0		1	1	4,576.55		4,577
PRCH	SLAB PORCH - COVERED	12867	6x4		24	21.22		509



Rogers

Assessment Property Record Card for Tax Year 2026

Data provided by LISA DELOZIER County Assessor

Date 04/17/2026
 Time 03:57:07
 Page 3

Sketch Image

660005121

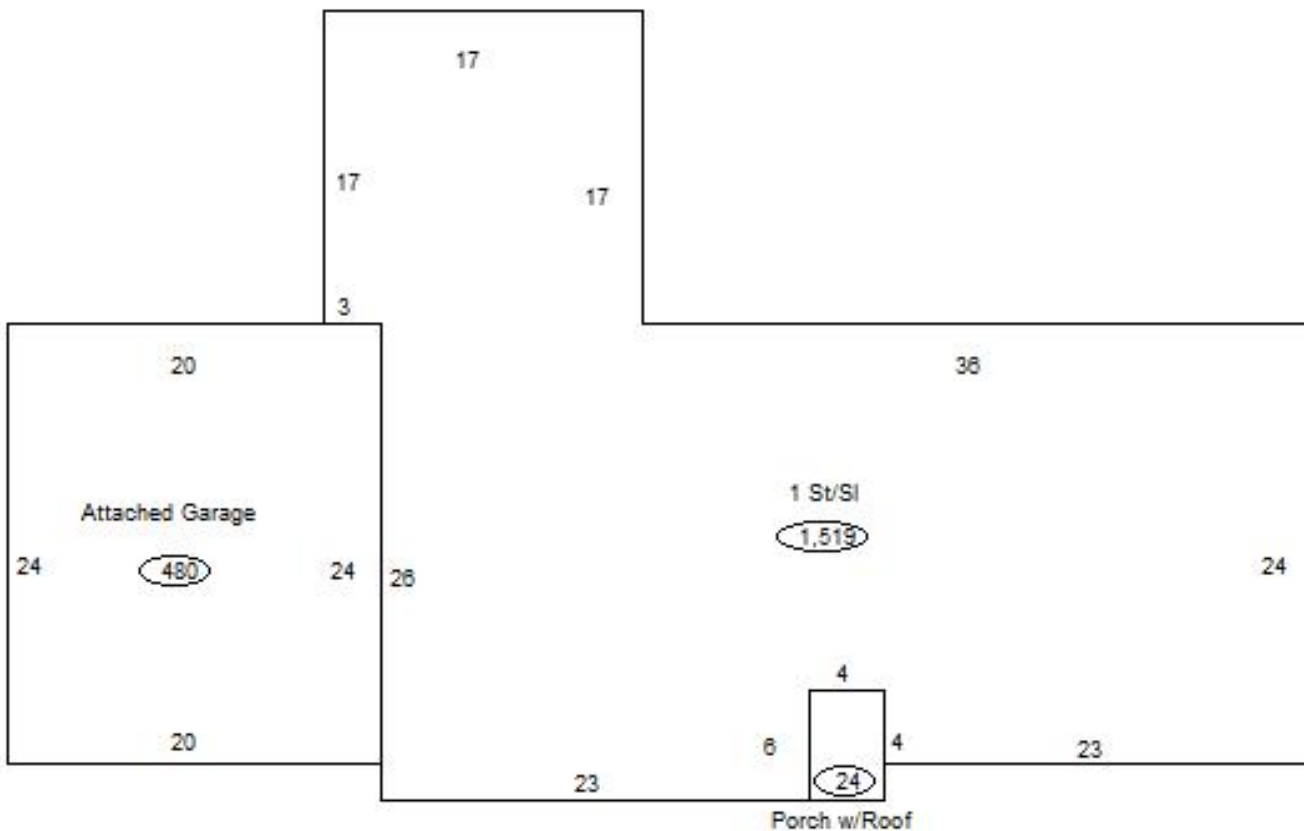

Sketch Vector Information

Sequence	Code	Type	Built Over	Scale	Section Label	Base Area	Multiplier	Total Area
1	R	1	Slab	13	1 St/Sl	1,519	1.000	1,519
2	G	1		13	Attached Garage	480	1.000	480
3	M	PRCH		13	SLBC	24	1.000	24
Total Building Area						1,519		1,519