



Rogers

Assessment Property Record Card for Tax Year 2026

Data provided by LISA DELOZIER County Assessor

Date 04/17/2026
Time 01:59:15
Page 1

Assessment Data					Primary Image																																																																																																																				
Account 660005124 Parcel ID 000000-00-0-00471-004-0016 Cadastral ID 06-21-15-03440 Property Type REAL - Real Property Property Class RRP VI Area 4 Tax Area 7 - OWASSO/LIMESTONE FIRE Name ID 286991 GREGORY, MAX 11745 N 195TH E AVE COLLINSVILLE OK 74021-0000 Parcel Location Situs 11745 N 195TH E AVE Subdivision LOOKING GLASS EXT Lot/Block 0016 / 0004 Parcel Size 1 - Lots Sec/Twn/Rng 6 / 21 / 15 / 5 Neighborhood 1014 - R-V04-SW OWASSO School District S021 - OWASSO SCHOOLS																																																																																																																									
Legal Description Lot/Long: 36.32434026 -95.75487975																																																																																																																									
Legal Description LOT 16 BLOCK 4 LOOKING GLASS EXT.					Building Permits <table border="1"> <thead> <tr> <th>Number</th> <th>Description</th> <th>Opened</th> <th>Closed</th> <th>Amount</th> </tr> </thead> <tbody> <tr> <td>6577</td> <td>NEW HOME</td> <td>01/2000</td> <td>11/2001</td> <td>40,000</td> </tr> </tbody> </table>					Number	Description	Opened	Closed	Amount	6577	NEW HOME	01/2000	11/2001	40,000																																																																																																						
Number	Description	Opened	Closed	Amount																																																																																																																					
6577	NEW HOME	01/2000	11/2001	40,000																																																																																																																					
Exemptions <table border="1"> <thead> <tr> <th>Code</th> <th>Type</th> <th>Active</th> <th>Maximum</th> <th>Exemption</th> </tr> </thead> <tbody> <tr> <td>H</td> <td>Homestead</td> <td>Yes</td> <td>1,000</td> <td>1,000</td> </tr> </tbody> </table>					Code	Type	Active	Maximum	Exemption	H	Homestead	Yes	1,000	1,000	Sale History <table border="1"> <thead> <tr> <th>Bk/Pg</th> <th>Grantor</th> <th>Date</th> <th>Price</th> <th>Code</th> </tr> </thead> <tbody> <tr> <td>1627/584</td> <td>DEUTSCHE BANK TRUST CO-AMERIC</td> <td>10/05/2004</td> <td>70,000</td> <td>3</td> </tr> <tr> <td>1482/657</td> <td>BAKER, TYSON R &</td> <td>05/27/2003</td> <td>0</td> <td>10</td> </tr> <tr> <td>1350/895</td> <td>FRUNK, CHARLES WILLIAM &</td> <td>01/16/2002</td> <td>85,000</td> <td>YES</td> </tr> <tr> <td>1256/222</td> <td>HOLLEY, HAROLD ELLIS</td> <td>11/07/2000</td> <td>3,000</td> <td>No</td> </tr> </tbody> </table>					Bk/Pg	Grantor	Date	Price	Code	1627/584	DEUTSCHE BANK TRUST CO-AMERIC	10/05/2004	70,000	3	1482/657	BAKER, TYSON R &	05/27/2003	0	10	1350/895	FRUNK, CHARLES WILLIAM &	01/16/2002	85,000	YES	1256/222	HOLLEY, HAROLD ELLIS	11/07/2000	3,000	No																																																																													
Code	Type	Active	Maximum	Exemption																																																																																																																					
H	Homestead	Yes	1,000	1,000																																																																																																																					
Bk/Pg	Grantor	Date	Price	Code																																																																																																																					
1627/584	DEUTSCHE BANK TRUST CO-AMERIC	10/05/2004	70,000	3																																																																																																																					
1482/657	BAKER, TYSON R &	05/27/2003	0	10																																																																																																																					
1350/895	FRUNK, CHARLES WILLIAM &	01/16/2002	85,000	YES																																																																																																																					
1256/222	HOLLEY, HAROLD ELLIS	11/07/2000	3,000	No																																																																																																																					
Parcel Valuation <table border="1"> <thead> <tr> <th>Source</th> <th>REAL</th> <th>Fair Cash</th> <th>Capped</th> <th>Asmnt Level</th> <th>Assessed</th> <th>Levy Rate</th> <th>108.538</th> <th>Current Tax</th> </tr> </thead> <tbody> <tr> <td>Remove Cap</td> <td>2005</td> <td>Land Value 25,240</td> <td>22,328</td> <td>11%</td> <td>2,456</td> <td>Assessed</td> <td>9,780</td> <td>1,061.50</td> </tr> <tr> <td>Year Frozen</td> <td>0</td> <td>Improvements 68,091</td> <td>66,583</td> <td></td> <td>7,324</td> <td>Penalty</td> <td>0</td> <td></td> </tr> <tr> <td>Uncapped Value</td> <td>0</td> <td>Mobile Home 0</td> <td>0</td> <td></td> <td>0</td> <td>Exemption</td> <td>1,000</td> <td>-98.00</td> </tr> <tr> <td>TIF Project ID</td> <td>0</td> <td>Total Value 93,331</td> <td>88,911</td> <td></td> <td>9,780</td> <td>Total Taxable</td> <td>8,780</td> <td>964.00</td> </tr> </tbody> </table>										Source	REAL	Fair Cash	Capped	Asmnt Level	Assessed	Levy Rate	108.538	Current Tax	Remove Cap	2005	Land Value 25,240	22,328	11%	2,456	Assessed	9,780	1,061.50	Year Frozen	0	Improvements 68,091	66,583		7,324	Penalty	0		Uncapped Value	0	Mobile Home 0	0		0	Exemption	1,000	-98.00	TIF Project ID	0	Total Value 93,331	88,911		9,780	Total Taxable	8,780	964.00																																																																			
Source	REAL	Fair Cash	Capped	Asmnt Level	Assessed	Levy Rate	108.538	Current Tax																																																																																																																	
Remove Cap	2005	Land Value 25,240	22,328	11%	2,456	Assessed	9,780	1,061.50																																																																																																																	
Year Frozen	0	Improvements 68,091	66,583		7,324	Penalty	0																																																																																																																		
Uncapped Value	0	Mobile Home 0	0		0	Exemption	1,000	-98.00																																																																																																																	
TIF Project ID	0	Total Value 93,331	88,911		9,780	Total Taxable	8,780	964.00																																																																																																																	
Assessment History <table border="1"> <thead> <tr> <th>Tax Year</th> <th>Statement Number</th> <th>Billed Owner</th> <th>Tax Area</th> <th>Total Value</th> <th>Exemptions</th> <th>Taxable Value</th> <th>Billed Tax</th> </tr> </thead> <tbody> <tr><td>2025</td><td>2025-660005124</td><td>GREGORY, MAX</td><td>7</td><td>92,936</td><td>1000</td><td>8,495</td><td>932.00</td></tr> <tr><td>2024</td><td>2024-660005124</td><td>GREGORY, MAX</td><td>7</td><td>101,215</td><td>1000</td><td>8,219</td><td>922.00</td></tr> <tr><td>2023</td><td>2023-660005124</td><td>GREGORY, MAX</td><td>7</td><td>81,367</td><td>1000</td><td>7,950</td><td>873.00</td></tr> <tr><td>2022</td><td>2022-660005124</td><td>GREGORY, MAX</td><td>7</td><td>81,649</td><td>1000</td><td>7,981</td><td>910.00</td></tr> <tr><td>2021</td><td>2021-660005124</td><td>GREGORY, MAX</td><td>7</td><td>81,199</td><td>1000</td><td>7,932</td><td>895.00</td></tr> <tr><td>2020</td><td>2020-660005124</td><td>GREGORY, MAX</td><td>7</td><td>82,232</td><td>1000</td><td>7,910</td><td>891.00</td></tr> <tr><td>2019</td><td>2019-660005124</td><td>GREGORY, MAX</td><td>7</td><td>78,640</td><td>1000</td><td>7,650</td><td>864.00</td></tr> <tr><td>2018</td><td>2018-660005124</td><td>GREGORY, MAX</td><td>7</td><td>83,484</td><td>1000</td><td>8,089</td><td>883.00</td></tr> <tr><td>2017</td><td>2017-660005124</td><td>GREGORY, MAX</td><td>7</td><td>82,865</td><td>1000</td><td>7,824</td><td>862.00</td></tr> <tr><td>2016</td><td>2016-660005124</td><td>GREGORY, MAX</td><td>7</td><td>80,944</td><td>1000</td><td>7,567</td><td>834.00</td></tr> <tr><td>2015</td><td>2015-660005124</td><td>GREGORY, MAX</td><td>7</td><td>79,627</td><td>1000</td><td>7,317</td><td>813.00</td></tr> <tr><td>2014</td><td>2014-660005124</td><td>GREGORY, MAX</td><td>7</td><td>82,163</td><td>1000</td><td>7,075</td><td>792.00</td></tr> <tr><td>2013</td><td>2013-660005124</td><td>GREGORY, MAX</td><td>7</td><td>84,446</td><td>1000</td><td>6,839</td><td>753.00</td></tr> </tbody> </table>										Tax Year	Statement Number	Billed Owner	Tax Area	Total Value	Exemptions	Taxable Value	Billed Tax	2025	2025-660005124	GREGORY, MAX	7	92,936	1000	8,495	932.00	2024	2024-660005124	GREGORY, MAX	7	101,215	1000	8,219	922.00	2023	2023-660005124	GREGORY, MAX	7	81,367	1000	7,950	873.00	2022	2022-660005124	GREGORY, MAX	7	81,649	1000	7,981	910.00	2021	2021-660005124	GREGORY, MAX	7	81,199	1000	7,932	895.00	2020	2020-660005124	GREGORY, MAX	7	82,232	1000	7,910	891.00	2019	2019-660005124	GREGORY, MAX	7	78,640	1000	7,650	864.00	2018	2018-660005124	GREGORY, MAX	7	83,484	1000	8,089	883.00	2017	2017-660005124	GREGORY, MAX	7	82,865	1000	7,824	862.00	2016	2016-660005124	GREGORY, MAX	7	80,944	1000	7,567	834.00	2015	2015-660005124	GREGORY, MAX	7	79,627	1000	7,317	813.00	2014	2014-660005124	GREGORY, MAX	7	82,163	1000	7,075	792.00	2013	2013-660005124	GREGORY, MAX	7	84,446	1000	6,839	753.00
Tax Year	Statement Number	Billed Owner	Tax Area	Total Value	Exemptions	Taxable Value	Billed Tax																																																																																																																		
2025	2025-660005124	GREGORY, MAX	7	92,936	1000	8,495	932.00																																																																																																																		
2024	2024-660005124	GREGORY, MAX	7	101,215	1000	8,219	922.00																																																																																																																		
2023	2023-660005124	GREGORY, MAX	7	81,367	1000	7,950	873.00																																																																																																																		
2022	2022-660005124	GREGORY, MAX	7	81,649	1000	7,981	910.00																																																																																																																		
2021	2021-660005124	GREGORY, MAX	7	81,199	1000	7,932	895.00																																																																																																																		
2020	2020-660005124	GREGORY, MAX	7	82,232	1000	7,910	891.00																																																																																																																		
2019	2019-660005124	GREGORY, MAX	7	78,640	1000	7,650	864.00																																																																																																																		
2018	2018-660005124	GREGORY, MAX	7	83,484	1000	8,089	883.00																																																																																																																		
2017	2017-660005124	GREGORY, MAX	7	82,865	1000	7,824	862.00																																																																																																																		
2016	2016-660005124	GREGORY, MAX	7	80,944	1000	7,567	834.00																																																																																																																		
2015	2015-660005124	GREGORY, MAX	7	79,627	1000	7,317	813.00																																																																																																																		
2014	2014-660005124	GREGORY, MAX	7	82,163	1000	7,075	792.00																																																																																																																		
2013	2013-660005124	GREGORY, MAX	7	84,446	1000	6,839	753.00																																																																																																																		



Rogers

Assessment Property Record Card for Tax Year 2026

Data provided by LISA DELOZIER County Assessor

Date 04/17/2026
Time 01:59:15
Page 2

Lot Data		Square-Foot - NBHD 1014 #1	
Lot Size			
Lot Count			
Units Buildable	1		
Non-Ag Acres	0.3132		
Topography			
Street Access			
Utilities			
Amenities	LAND QUALITY	0	
		0	
Method	Square-Foot		
Base Lot Value	13,643.00 x 1.85 = 25,240		
Factor Value			
Adjustments	1.0000		
Lot Value	25,240		



\\tsclient\C\Users\Randy Necessary\Pictures\101_0426\IMG_0067. 4/28/2022

Residential Data	
Type	1 Single Family Residence
Condition	3 - Average
Quality	2 - Fair
Architecture	
Style	100% One Story
Exterior Wall	100% Frame, Siding, Wood
Base/Total Area	1,318 / 1,318
Style	100% One Story
HVAC	100% Warmed & Cooled Air
Roof Cover	1 Composition Shingle
Area on Slab	0
Fixture/RghIn	7 /
Bed/F/H Bath	3 / 1.5 /
Basement Area	
Garage Type	432 Attached Garage - Unfinished 1 Stalls
Remodel	
Year/Eff Age	1960 / 50

GRM Approach

GRM Code	
Gross Rent	0.00
Indicated Value	

Multiple Regression

MRA Code	1 Test
Adjusted R	0.8445
Indicated Value	114,021 86.51 Per SqFt

Direct Comparables

Selection Model	A Adam Test
Adjustment Model	1 2022 Residential
Comparables	1
Indicated Value	105,730 Per SqFt

Value Reconciliation

Selected Approach	Cost Approach
Improvements	66,811
Lot Value	25,240
Indicated Value	92,051 69.84 Per SqFt
Agland Value	
Site Improvements	1,280
Total Value	93,331 70.81 Total Value Per SqFt

Cost Approach		Manual : 01/2025	
Base Cost	91.26	Total Misc Impr	+ 1,891
Roofing Adj	+ 4.08	Garage Cost	+ 10,480
Subfloor Adj	+ 2.33	Total RCN	= 162,953
Heat/Cool Adj	+ 10.30	Depreciation (59%)	- 96,142
Plumbing Adj	+ 6.28	Lump Sums	+ 0
Basement Adj	+ 0.00	RCNLD	= 66,811
Adj Base Cost	= 114.25	Lot Value	+ 25,240
Total Area	x 1,318	Indicated Value	= 92,051
Adjusted Cost	= 150,582	Value Per SqFt	69.84

Miscellaneous Improvements

Code	Description	Sketch ID	Size	Year	Units	Unit Cost	Depr	Value
PRCH	SLAB PORCH - COVERED	12874	15x6		90	21.01		1,891



Rogers

Assessment Property Record Card for Tax Year 2026

Data provided by LISA DELOZIER County Assessor

Date 04/17/2026

Time 01:59:15

Page 3

Sketch Image

660005124

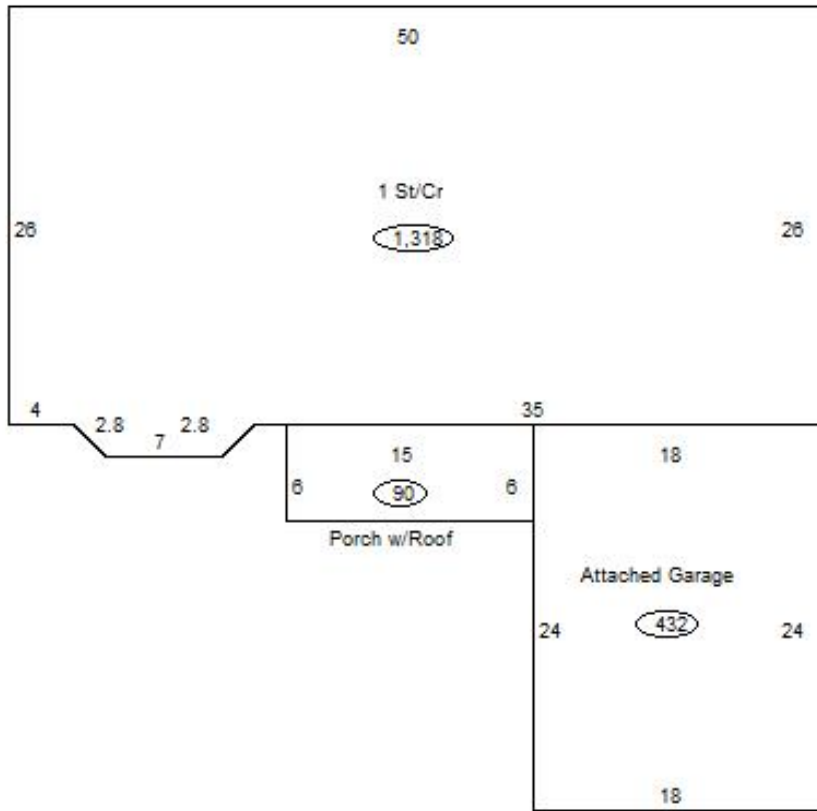

Sketch Vector Information

Sequence	Code	Type	Built Over	Scale	Section Label	Base Area	Multiplier	Total Area
1	R	1	Crawl	13	1 St/Cr	1,318	1.000	1,318
2	G	1		13	Attached Garage	432	1.000	432
3	M	PRCH		13	SLBC	90	1.000	90
Total Building Area						1,318		1,318



Rogers



Assessment Property Record Card for Tax Year 2026

Data provided by LISA DELOZIER County Assessor

Date 04/17/2026
 Time 01:59:15
 Page 4

660005124

Outbuildings/Site Improvements

Building Image	Code	Description	Dimensions	Floor	Roofing	Total Units
	BARN BARN		12x20x0			240
	Qual 2	Cond 2	Year	Eff Age	2026	
	Valuation Summary		Modifier Total	RCN	Depr (50% Phys/ % Func)	RCNLD
Base Cost (8.72 x 240)		2,093		2,093	1,047	1,046
	LT LEAN-TO		10x20x0			200
	Qual 2	Cond 2	Year	Eff Age		
	Valuation Summary		Modifier Total	RCN	Depr (60% Phys/ % Func)	RCNLD
Base Cost (2.92 x 200)		584		584	350	234
	STF STG FAIR		0x0x0			
	Qual	Cond	Year	Eff Age		
	Valuation Summary		Modifier Total	RCN	Depr (100% Phys/ % Func)	RCNLD
Base Cost (4.68 x)						