



# Rogers

## Assessment Property Record Card for Tax Year 2026

Data provided by LISA DELOZIER County Assessor

Date 04/17/2026  
 Time 15:05:01  
 Page 1

Assessment Data					Primary Image																																																																																																																				
<b>Account</b> 660005527 <b>Parcel ID</b> 21N16E-06-1-00000-000-0000 <b>Cadastral ID</b> 06-21-16-01510 <b>Property Type</b> REAL - Real Property <b>Property Class</b> UR VI Area 1 <b>Tax Area</b> 34 - CLARM OT & SCHL/NW FD <b>Name ID</b> 285178 FINGERLE, PHILLIP H &  JOAN M-TRUSTEES 2275 W LOWRY RD CLAREMORE OK 74017-0000  <b>Parcel Location</b> <b>Situs</b> 02275 E LOWRY RD <b>Subdivision</b> <b>Lot/Block</b> / <b>Parcel Size</b> 3.79 - Acres <b>Sec/Twn/Rng</b> 6 / 21 / 16 / 1 <b>Neighborhood</b> 2116 - UNPLATTED <b>School District</b> S001 - CLAREMORE SCHOOLS																																																																																																																									
<b>Legal Description</b> Lat/Long: 36.33531390 -95.63747662																																																																																																																									
<b>Legal Description</b> E 225.6' OF GOVT LOT 2 LESS THE S 579' THEREOF					<b>Building Permits</b> <table border="1"> <thead> <tr> <th>Number</th> <th>Description</th> <th>Opened</th> <th>Closed</th> <th>Amount</th> </tr> </thead> <tbody> <tr> <td></td> <td></td> <td></td> <td></td> <td></td> </tr> </tbody> </table>					Number	Description	Opened	Closed	Amount																																																																																																											
Number	Description	Opened	Closed	Amount																																																																																																																					
<b>Exemptions</b> <table border="1"> <thead> <tr> <th>Code</th> <th>Type</th> <th>Active</th> <th>Maximum</th> <th>Exemption</th> </tr> </thead> <tbody> <tr> <td>H</td> <td>Homestead</td> <td>Yes</td> <td>1,000</td> <td>1,000</td> </tr> </tbody> </table>					Code	Type	Active	Maximum	Exemption	H	Homestead	Yes	1,000	1,000	<b>Sale History</b> <table border="1"> <thead> <tr> <th>Bk/Pg</th> <th>Grantor</th> <th>Date</th> <th>Price</th> <th>Code</th> </tr> </thead> <tbody> <tr> <td>1581/672</td> <td>MABRY, JEANNE KING &amp;</td> <td>04/12/2004</td> <td>275,000</td> <td>YES</td> </tr> <tr> <td>788/314</td> <td></td> <td></td> <td>27,000</td> <td>No</td> </tr> </tbody> </table>					Bk/Pg	Grantor	Date	Price	Code	1581/672	MABRY, JEANNE KING &	04/12/2004	275,000	YES	788/314			27,000	No																																																																																							
Code	Type	Active	Maximum	Exemption																																																																																																																					
H	Homestead	Yes	1,000	1,000																																																																																																																					
Bk/Pg	Grantor	Date	Price	Code																																																																																																																					
1581/672	MABRY, JEANNE KING &	04/12/2004	275,000	YES																																																																																																																					
788/314			27,000	No																																																																																																																					
<b>Parcel Valuation</b> <table border="1"> <thead> <tr> <th>Source</th> <th>REAL</th> <th>Fair Cash</th> <th>Capped</th> <th>Asmnt Level</th> <th>Assessed</th> <th>Levy Rate</th> <th>106.442</th> <th>Current Tax</th> </tr> </thead> <tbody> <tr> <td>Remove Cap</td> <td>2005</td> <td>Land Value 72,865</td> <td>63,741</td> <td>11%</td> <td>7,012</td> <td>Assessed</td> <td>31,292</td> <td>3,330.77</td> </tr> <tr> <td>Year Frozen</td> <td>0</td> <td>Improvements 220,728</td> <td>220,728</td> <td></td> <td>24,280</td> <td>Penalty</td> <td>0</td> <td></td> </tr> <tr> <td>Uncapped Value</td> <td>0</td> <td>Mobile Home 0</td> <td>0</td> <td></td> <td>0</td> <td>Exemption</td> <td>1,000</td> <td>-93.00</td> </tr> <tr> <td>TIF Project ID</td> <td>0</td> <td>Total Value 293,593</td> <td>284,469</td> <td></td> <td>31,292</td> <td>Total Taxable</td> <td>30,292</td> <td>3,238.00</td> </tr> </tbody> </table>										Source	REAL	Fair Cash	Capped	Asmnt Level	Assessed	Levy Rate	106.442	Current Tax	Remove Cap	2005	Land Value 72,865	63,741	11%	7,012	Assessed	31,292	3,330.77	Year Frozen	0	Improvements 220,728	220,728		24,280	Penalty	0		Uncapped Value	0	Mobile Home 0	0		0	Exemption	1,000	-93.00	TIF Project ID	0	Total Value 293,593	284,469		31,292	Total Taxable	30,292	3,238.00																																																																			
Source	REAL	Fair Cash	Capped	Asmnt Level	Assessed	Levy Rate	106.442	Current Tax																																																																																																																	
Remove Cap	2005	Land Value 72,865	63,741	11%	7,012	Assessed	31,292	3,330.77																																																																																																																	
Year Frozen	0	Improvements 220,728	220,728		24,280	Penalty	0																																																																																																																		
Uncapped Value	0	Mobile Home 0	0		0	Exemption	1,000	-93.00																																																																																																																	
TIF Project ID	0	Total Value 293,593	284,469		31,292	Total Taxable	30,292	3,238.00																																																																																																																	
<b>Assessment History</b> <table border="1"> <thead> <tr> <th>Tax Year</th> <th>Statement Number</th> <th>Billed Owner</th> <th>Tax Area</th> <th>Total Value</th> <th>Exemptions</th> <th>Taxable Value</th> <th>Billed Tax</th> </tr> </thead> <tbody> <tr><td>2025</td><td>2025-660005527</td><td>FINGERLE, PHILLIP H &amp;</td><td>34</td><td>288,979</td><td>1000</td><td>29,380</td><td>3,142.00</td></tr> <tr><td>2024</td><td>2024-660005527</td><td>FINGERLE, PHILLIP H &amp;</td><td>34</td><td>297,798</td><td>1000</td><td>28,495</td><td>3,047.00</td></tr> <tr><td>2023</td><td>2023-660005527</td><td>FINGERLE, PHILLIP H &amp;</td><td>34</td><td>260,331</td><td>1000</td><td>27,636</td><td>2,932.00</td></tr> <tr><td>2022</td><td>2022-660005527</td><td>FINGERLE, PHILLIP H &amp;</td><td>34</td><td>260,326</td><td>1000</td><td>27,636</td><td>2,950.00</td></tr> <tr><td>2021</td><td>2021-660005527</td><td>FINGERLE, PHILLIP H &amp;</td><td>34</td><td>260,437</td><td>1000</td><td>27,291</td><td>2,795.00</td></tr> <tr><td>2020</td><td>2020-660005527</td><td>FINGERLE, PHILLIP H &amp;</td><td>34</td><td>257,486</td><td>1000</td><td>26,466</td><td>2,809.00</td></tr> <tr><td>2019</td><td>2019-660005527</td><td>FINGERLE, PHILLIP H &amp;</td><td>34</td><td>242,425</td><td>1000</td><td>25,667</td><td>2,753.00</td></tr> <tr><td>2018</td><td>2018-660005527</td><td>FINGERLE, PHILLIP H &amp;</td><td>34</td><td>251,861</td><td>1000</td><td>26,705</td><td>2,860.00</td></tr> <tr><td>2017</td><td>2017-660005527</td><td>FINGERLE, PHILLIP H &amp;</td><td>34</td><td>249,496</td><td>1000</td><td>26,445</td><td>2,788.00</td></tr> <tr><td>2016</td><td>2016-660005527</td><td>FINGERLE, PHILLIP H &amp;</td><td>34</td><td>243,269</td><td>1000</td><td>25,760</td><td>2,795.00</td></tr> <tr><td>2015</td><td>2015-660005527</td><td>FINGERLE, PHILLIP H &amp;</td><td>34</td><td>313,591</td><td>1000</td><td>31,647</td><td>3,275.00</td></tr> <tr><td>2014</td><td>2014-660005527</td><td>FINGERLE, PHILLIP H &amp;</td><td>34</td><td>317,861</td><td>1000</td><td>30,696</td><td>3,219.00</td></tr> <tr><td>2013</td><td>2013-660005527</td><td>FINGERLE, PHILLIP H &amp;</td><td>34</td><td>297,760</td><td>1000</td><td>29,773</td><td>3,078.00</td></tr> </tbody> </table>										Tax Year	Statement Number	Billed Owner	Tax Area	Total Value	Exemptions	Taxable Value	Billed Tax	2025	2025-660005527	FINGERLE, PHILLIP H &	34	288,979	1000	29,380	3,142.00	2024	2024-660005527	FINGERLE, PHILLIP H &	34	297,798	1000	28,495	3,047.00	2023	2023-660005527	FINGERLE, PHILLIP H &	34	260,331	1000	27,636	2,932.00	2022	2022-660005527	FINGERLE, PHILLIP H &	34	260,326	1000	27,636	2,950.00	2021	2021-660005527	FINGERLE, PHILLIP H &	34	260,437	1000	27,291	2,795.00	2020	2020-660005527	FINGERLE, PHILLIP H &	34	257,486	1000	26,466	2,809.00	2019	2019-660005527	FINGERLE, PHILLIP H &	34	242,425	1000	25,667	2,753.00	2018	2018-660005527	FINGERLE, PHILLIP H &	34	251,861	1000	26,705	2,860.00	2017	2017-660005527	FINGERLE, PHILLIP H &	34	249,496	1000	26,445	2,788.00	2016	2016-660005527	FINGERLE, PHILLIP H &	34	243,269	1000	25,760	2,795.00	2015	2015-660005527	FINGERLE, PHILLIP H &	34	313,591	1000	31,647	3,275.00	2014	2014-660005527	FINGERLE, PHILLIP H &	34	317,861	1000	30,696	3,219.00	2013	2013-660005527	FINGERLE, PHILLIP H &	34	297,760	1000	29,773	3,078.00
Tax Year	Statement Number	Billed Owner	Tax Area	Total Value	Exemptions	Taxable Value	Billed Tax																																																																																																																		
2025	2025-660005527	FINGERLE, PHILLIP H &	34	288,979	1000	29,380	3,142.00																																																																																																																		
2024	2024-660005527	FINGERLE, PHILLIP H &	34	297,798	1000	28,495	3,047.00																																																																																																																		
2023	2023-660005527	FINGERLE, PHILLIP H &	34	260,331	1000	27,636	2,932.00																																																																																																																		
2022	2022-660005527	FINGERLE, PHILLIP H &	34	260,326	1000	27,636	2,950.00																																																																																																																		
2021	2021-660005527	FINGERLE, PHILLIP H &	34	260,437	1000	27,291	2,795.00																																																																																																																		
2020	2020-660005527	FINGERLE, PHILLIP H &	34	257,486	1000	26,466	2,809.00																																																																																																																		
2019	2019-660005527	FINGERLE, PHILLIP H &	34	242,425	1000	25,667	2,753.00																																																																																																																		
2018	2018-660005527	FINGERLE, PHILLIP H &	34	251,861	1000	26,705	2,860.00																																																																																																																		
2017	2017-660005527	FINGERLE, PHILLIP H &	34	249,496	1000	26,445	2,788.00																																																																																																																		
2016	2016-660005527	FINGERLE, PHILLIP H &	34	243,269	1000	25,760	2,795.00																																																																																																																		
2015	2015-660005527	FINGERLE, PHILLIP H &	34	313,591	1000	31,647	3,275.00																																																																																																																		
2014	2014-660005527	FINGERLE, PHILLIP H &	34	317,861	1000	30,696	3,219.00																																																																																																																		
2013	2013-660005527	FINGERLE, PHILLIP H &	34	297,760	1000	29,773	3,078.00																																																																																																																		



# Rogers

## Assessment Property Record Card for Tax Year 2026

Data provided by LISA DELOZIER County Assessor

Date 04/17/2026  
Time 15:05:01  
Page 2

Lot Data	Square-Foot - NBHD 2116 #1	Primary Image
<b>Lot Size</b> <b>Lot Count</b> <b>Units Buildable</b> 3.79 <b>Non-Ag Acres</b> 3.7638 <b>Topography</b> <b>Street Access</b> <b>Utilities</b> <b>Amenities</b> LAND QUALITY 0 0 <b>Method</b> Square-Foot <b>Base Lot Value</b> 163,951.00 x .44 = 72,865 <b>Factor Value</b> <b>Adjustments</b> 1.0000 <b>Lot Value</b> 72,865		
<b>Residential Data</b> <b>Type</b> 1 Single Family Residence <b>Condition</b> 3 - Average <b>Quality</b> 3 - Average <b>Architecture</b> <b>Style</b> 100% 2 1/2 Story Finished <b>Exterior Wall</b> 5% Veneer, Masonry 95% Frame, Siding, Wood <b>Base/Total Area</b> 1,099 / 2,748 <b>Style</b> 100% 2 1/2 Story Finished <b>HVAC</b> 100% Warmed & Cooled Air <b>Roof Cover</b> 1 Composition Shingle <b>Area on Slab</b> 1,099 <b>Fixture/RghIn</b> 14 / <b>Bed/F/H Bath</b> 4 / 3.0 / <b>Basement Area</b> <b>Garage Type</b> 576 Attached Garage - Unfinished <b>Remodel</b> <b>Year/Eff Age</b> 1988 / 29		

\\tsclient\T\LOGAN\LOGAN RESIDENTIAL VI\2023-11-1\IMG\_0001 11/1/2023

GRM Approach	
<b>GRM Code</b>	
<b>Gross Rent</b>	0.00
<b>Indicated Value</b>	

Multiple Regression			
<b>MRA Code</b>	1	Test	
<b>Adusted R</b>	0.8445		
<b>Indicated Value</b>	297,117	108.12	Per SqFt

Direct Comparables	
<b>Selection Model</b>	A Adam Test
<b>Adjustment Model</b>	NewTest
<b>Comparables</b>	
<b>Indicated Value</b>	

Value Reconciliation			
<b>Selected Approach</b>	Cost Approach		
<b>Improvements</b>	212,070		
<b>Lot Value</b>	72,865		
<b>Indicated Value</b>	284,935	103.69	Per SqFt
<b>Agland Value</b>			
<b>Site Improvements</b>	8,658		
<b>Total Value</b>	293,593	106.84	Total Value Per SqFt

Cost Approach				Manual : 01/2025			
<b>Base Cost</b>	81.44	<b>Total Misc Impr</b>	+ 32,381				
<b>Roofing Adj</b>	+ 2.16	<b>Garage Cost</b>	+ 17,775				
<b>Subfloor Adj</b>	+ -1.02	<b>Total RCN</b>	= 331,359				
<b>Heat/Cool Adj</b>	+ 12.64	<b>Depreciation ( 36%)</b>	- 119,289				
<b>Plumbing Adj</b>	+ 7.11	<b>Lump Sums</b>	+ 0				
<b>Basement Adj</b>	+ 0.00	<b>RCNLD</b>	= 212,070				
<b>Adj Base Cost</b>	= 102.33	<b>Lot Value</b>	+ 72,865				
<b>Total Area</b>	x 2,748	<b>Indicated Value</b>	= 284,935				
<b>Adjusted Cost</b>	= 281,203	<b>Value Per SqFt</b>	103.69				

Miscellaneous Improvements								
Code	Description	Sketch ID	Size	Year	Units	Unit Cost	Depr	Value
FPR1	FIREPLACE - RESIDENTIAL 1 STORY	0		1	1	5,615.40		5,615
PRCH	SLAB PORCH - COVERED	13150		167	167	26.41		4,410
PRCH	SLAB PORCH - COVERED	13151	15x10		150	26.46		3,969
PRCH	SLAB PORCH - COVERED	13152	15x10		150	26.46		3,969
PRCH	SLAB PORCH - COVERED	13153	571		571	25.25		14,418



Sketch Image

660005527

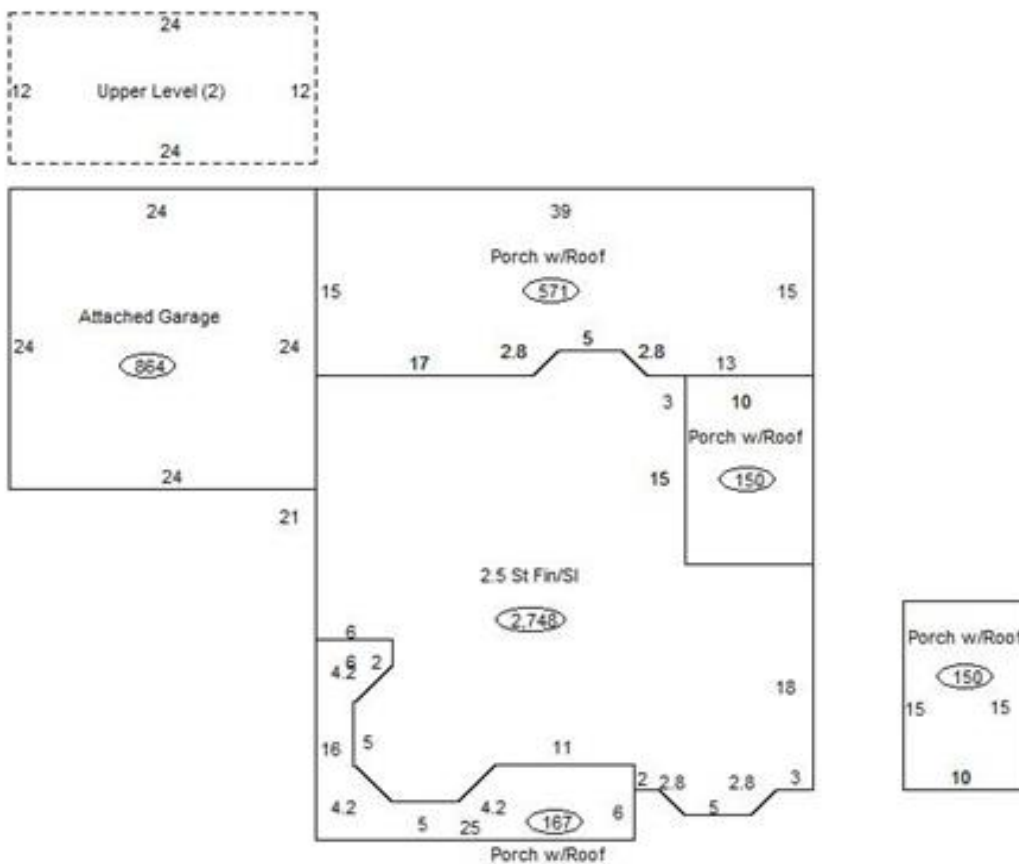

Sketch Vector Information

Sequence	Code	Type	Built Over	Scale	Section Label	Base Area	Multiplier	Total Area
1	R	7	Slab	13	2.5 St Fin/Sl	1,099	2.500	2,748
2	G	1		13	Attached Garage	576	1.000	576
3	M	PRCH		13	SLBC	167	1.000	167
4	M	PRCH		13	SLBC	150	1.000	150
5	M	PRCH		13	SLBC	150	1.000	150
6	M	PRCH		13	SLBC	571	1.000	571
7	U	^UL		13	Upper Level (2)	288	1.000	288
<b>Total Building Area</b>						<b>1,099</b>		<b>2,748</b>



# Rogers

## Assessment Property Record Card for Tax Year 2026

Data provided by LISA DELOZIER County Assessor

Date 04/17/2026  
 Time 15:05:02  
 Page 4

660005527

### Outbuildings/Site Improvements

Building Image	Code	Description	Dimensions	Floor	Roofing	Total Units	
	STF	STG FAIR	14x14x0			196	
	Qual	2	Cond	Year	2019	Eff Age	
	<b>Valuation Summary</b>		<b>Modifier Total</b>	<b>RCN</b>	<b>Depr (0% Phys/ % Func)</b>		<b>RCNLD</b>
	Base Cost (4.68 x 196)		917		917	917	
	DTGF	DETACHED GARAGE FAIR	0x0x0			468	
	Qual	2	Cond 3	Year	2009	Eff Age	
	<b>Valuation Summary</b>		<b>Modifier Total</b>	<b>RCN</b>	<b>Depr (20% Phys/ % Func)</b>		<b>RCNLD</b>
	Base Cost (16.00 x 468)		7,488		7,488	1,498	5,990
	LT	LEAN-TO	0x0x0			288	
	Qual	3	Cond 3	Year		Eff Age	
	<b>Valuation Summary</b>		<b>Modifier Total</b>	<b>RCN</b>	<b>Depr (20% Phys/ % Func)</b>		<b>RCNLD</b>
	Base Cost (2.92 x 288)		841		841	168	673
	STF	STG FAIR	0x0x0			288	
	Qual	2	Cond 3	Year		Eff Age	
	<b>Valuation Summary</b>		<b>Modifier Total</b>	<b>RCN</b>	<b>Depr (20% Phys/ % Func)</b>		<b>RCNLD</b>
	Base Cost (4.68 x 288)		1,348		1,348	270	1,078
	STF	STG FAIR	0x0x0				
	Qual	2	Cond	Year		Eff Age	
	<b>Valuation Summary</b>		<b>Modifier Total</b>	<b>RCN</b>	<b>Depr (0% Phys/ % Func)</b>		<b>RCNLD</b>
	Base Cost (4.68 x )						