



# Rogers

## Assessment Property Record Card for Tax Year 2026

Data provided by LISA DELOZIER County Assessor

Date 04/17/2026  
 Time 03:10:09  
 Page 1

Assessment Data					Primary Image																																																																																																																				
<b>Account</b> 660005579 <b>Parcel ID</b> 000000-00-0-10074-001-0013 <b>Cadastral ID</b> 06-21-16-05020 <b>Property Type</b> REAL - Real Property <b>Property Class</b> URP VI Area 1 <b>Tax Area</b> 17 - CLAREMORE OT <b>Name ID</b> 344561 PATTERSON, LOGAN KEITH & TAYLOR E  2401 CORNERSTONE PL CLAREMORE OK 74017-0000  <b>Parcel Location</b> <b>Situs</b> 02401 CORNERSTONE PL <b>Subdivision</b> CORNERSTONE ESTATES <b>Lot/Block</b> 0013 / 0001 <b>Parcel Size</b> 1 - Lots <b>Sec/Twn/Rng</b> 6 / 21 / 16 / 5 <b>Neighborhood</b> 1181 - R-V01-SW CLAREMORE <b>School District</b> S001 - CLAREMORE SCHOOLS																																																																																																																									
<b>Legal Description</b> Lot/Long: 36.33155645 -95.64119118																																																																																																																									
<b>Legal Description</b> LOT 13 BLOCK 1 CORNERSTONE ESTATES					<b>Building Permits</b> <table border="1"> <thead> <tr> <th>Number</th> <th>Description</th> <th>Opened</th> <th>Closed</th> <th>Amount</th> </tr> </thead> <tbody> <tr> <td> </td> <td> </td> <td> </td> <td> </td> <td> </td> </tr> </tbody> </table>					Number	Description	Opened	Closed	Amount																																																																																																											
Number	Description	Opened	Closed	Amount																																																																																																																					
<b>Exemptions</b> <table border="1"> <thead> <tr> <th>Code</th> <th>Type</th> <th>Active</th> <th>Maximum</th> <th>Exemption</th> </tr> </thead> <tbody> <tr> <td>H</td> <td>Homestead</td> <td>No</td> <td>1,000</td> <td> </td> </tr> </tbody> </table>					Code	Type	Active	Maximum	Exemption	H	Homestead	No	1,000		<b>Sale History</b> <table border="1"> <thead> <tr> <th>Bk/Pg</th> <th>Grantor</th> <th>Date</th> <th>Price</th> <th>Code</th> </tr> </thead> <tbody> <tr> <td>/</td> <td>WEIR, ROBERT Y &amp; CHARLOTTE A</td> <td>06/12/2024</td> <td>235,000</td> <td>7</td> </tr> <tr> <td>885/680</td> <td>CLARK, THOMAS G SR</td> <td>06/30/1992</td> <td>92,000</td> <td>No</td> </tr> </tbody> </table>					Bk/Pg	Grantor	Date	Price	Code	/	WEIR, ROBERT Y & CHARLOTTE A	06/12/2024	235,000	7	885/680	CLARK, THOMAS G SR	06/30/1992	92,000	No																																																																																							
Code	Type	Active	Maximum	Exemption																																																																																																																					
H	Homestead	No	1,000																																																																																																																						
Bk/Pg	Grantor	Date	Price	Code																																																																																																																					
/	WEIR, ROBERT Y & CHARLOTTE A	06/12/2024	235,000	7																																																																																																																					
885/680	CLARK, THOMAS G SR	06/30/1992	92,000	No																																																																																																																					
<b>Parcel Valuation</b> <table border="1"> <thead> <tr> <th>Source</th> <th>REAL</th> <th>Fair Cash</th> <th>Capped</th> <th>Asmnt Level</th> <th>Assessed</th> <th>Levy Rate</th> <th>92.430</th> <th>Current Tax</th> </tr> </thead> <tbody> <tr> <td>Remove Cap</td> <td>2025</td> <td>Land Value 71,211</td> <td>71,211</td> <td>11%</td> <td>7,833</td> <td>Assessed</td> <td>30,158</td> <td>2,787.50</td> </tr> <tr> <td>Year Frozen</td> <td>0</td> <td>Improvements 202,950</td> <td>202,950</td> <td> </td> <td>22,325</td> <td>Penalty</td> <td>0</td> <td> </td> </tr> <tr> <td>Uncapped Value</td> <td>0</td> <td>Mobile Home 0</td> <td>0</td> <td> </td> <td>0</td> <td>Exemption</td> <td>0</td> <td>0.00</td> </tr> <tr> <td>TIF Project ID</td> <td>0</td> <td>Total Value 274,161</td> <td>274,161</td> <td> </td> <td>30,158</td> <td>Total Taxable</td> <td>30,158</td> <td>2,788.00</td> </tr> </tbody> </table>										Source	REAL	Fair Cash	Capped	Asmnt Level	Assessed	Levy Rate	92.430	Current Tax	Remove Cap	2025	Land Value 71,211	71,211	11%	7,833	Assessed	30,158	2,787.50	Year Frozen	0	Improvements 202,950	202,950		22,325	Penalty	0		Uncapped Value	0	Mobile Home 0	0		0	Exemption	0	0.00	TIF Project ID	0	Total Value 274,161	274,161		30,158	Total Taxable	30,158	2,788.00																																																																			
Source	REAL	Fair Cash	Capped	Asmnt Level	Assessed	Levy Rate	92.430	Current Tax																																																																																																																	
Remove Cap	2025	Land Value 71,211	71,211	11%	7,833	Assessed	30,158	2,787.50																																																																																																																	
Year Frozen	0	Improvements 202,950	202,950		22,325	Penalty	0																																																																																																																		
Uncapped Value	0	Mobile Home 0	0		0	Exemption	0	0.00																																																																																																																	
TIF Project ID	0	Total Value 274,161	274,161		30,158	Total Taxable	30,158	2,788.00																																																																																																																	
<b>Assessment History</b> <table border="1"> <thead> <tr> <th>Tax Year</th> <th>Statement Number</th> <th>Billed Owner</th> <th>Tax Area</th> <th>Total Value</th> <th>Exemptions</th> <th>Taxable Value</th> <th>Billed Tax</th> </tr> </thead> <tbody> <tr><td>2025</td><td>2025-660005579</td><td>PATTERSON, LOGAN KEITH &amp;</td><td>17</td><td>270,638</td><td>0</td><td>29,770</td><td>2,752.00</td></tr> <tr><td>2024</td><td>2024-660005579</td><td>PATTERSON, LOGAN KEITH &amp;</td><td>17</td><td>244,604</td><td>1000</td><td>18,867</td><td>1,744.00</td></tr> <tr><td>2023</td><td>2023-660005579</td><td>WEIR, ROBERT Y &amp; CHARLOTTE A</td><td>17</td><td>175,354</td><td>1000</td><td>18,289</td><td>1,675.00</td></tr> <tr><td>2022</td><td>2022-660005579</td><td>WEIR, ROBERT Y &amp; CHARLOTTE A</td><td>17</td><td>178,366</td><td>1000</td><td>18,620</td><td>1,724.00</td></tr> <tr><td>2021</td><td>2021-660005579</td><td>WEIR, ROBERT Y &amp; CHARLOTTE A</td><td>17</td><td>187,115</td><td>1000</td><td>19,583</td><td>1,729.00</td></tr> <tr><td>2020</td><td>2020-660005579</td><td>WEIR, ROBERT Y &amp; CHARLOTTE A</td><td>17</td><td>184,100</td><td>1000</td><td>19,138</td><td>1,752.00</td></tr> <tr><td>2019</td><td>2019-660005579</td><td>WEIR, ROBERT Y &amp; CHARLOTTE A</td><td>17</td><td>177,740</td><td>1000</td><td>18,551</td><td>1,718.00</td></tr> <tr><td>2018</td><td>2018-660005579</td><td>WEIR, ROBERT Y &amp; CHARLOTTE A</td><td>34</td><td>185,505</td><td>1000</td><td>19,279</td><td>2,068.00</td></tr> <tr><td>2017</td><td>2017-660005579</td><td>WEIR, ROBERT Y &amp; CHARLOTTE A</td><td>34</td><td>184,037</td><td>1000</td><td>18,689</td><td>1,974.00</td></tr> <tr><td>2016</td><td>2016-660005579</td><td>WEIR, ROBERT Y &amp; CHARLOTTE A</td><td>34</td><td>179,338</td><td>1000</td><td>18,115</td><td>1,969.00</td></tr> <tr><td>2015</td><td>2015-660005579</td><td>WEIR, ROBERT Y &amp; CHARLOTTE A</td><td>34</td><td>176,159</td><td>1000</td><td>17,559</td><td>1,823.00</td></tr> <tr><td>2014</td><td>2014-660005579</td><td>WEIR, ROBERT Y &amp; CHARLOTTE A</td><td>34</td><td>177,506</td><td>1000</td><td>17,018</td><td>1,790.00</td></tr> <tr><td>2013</td><td>2013-660005579</td><td>WEIR, ROBERT Y &amp; CHARLOTTE A</td><td>34</td><td>168,264</td><td>1000</td><td>16,494</td><td>1,710.00</td></tr> </tbody> </table>										Tax Year	Statement Number	Billed Owner	Tax Area	Total Value	Exemptions	Taxable Value	Billed Tax	2025	2025-660005579	PATTERSON, LOGAN KEITH &	17	270,638	0	29,770	2,752.00	2024	2024-660005579	PATTERSON, LOGAN KEITH &	17	244,604	1000	18,867	1,744.00	2023	2023-660005579	WEIR, ROBERT Y & CHARLOTTE A	17	175,354	1000	18,289	1,675.00	2022	2022-660005579	WEIR, ROBERT Y & CHARLOTTE A	17	178,366	1000	18,620	1,724.00	2021	2021-660005579	WEIR, ROBERT Y & CHARLOTTE A	17	187,115	1000	19,583	1,729.00	2020	2020-660005579	WEIR, ROBERT Y & CHARLOTTE A	17	184,100	1000	19,138	1,752.00	2019	2019-660005579	WEIR, ROBERT Y & CHARLOTTE A	17	177,740	1000	18,551	1,718.00	2018	2018-660005579	WEIR, ROBERT Y & CHARLOTTE A	34	185,505	1000	19,279	2,068.00	2017	2017-660005579	WEIR, ROBERT Y & CHARLOTTE A	34	184,037	1000	18,689	1,974.00	2016	2016-660005579	WEIR, ROBERT Y & CHARLOTTE A	34	179,338	1000	18,115	1,969.00	2015	2015-660005579	WEIR, ROBERT Y & CHARLOTTE A	34	176,159	1000	17,559	1,823.00	2014	2014-660005579	WEIR, ROBERT Y & CHARLOTTE A	34	177,506	1000	17,018	1,790.00	2013	2013-660005579	WEIR, ROBERT Y & CHARLOTTE A	34	168,264	1000	16,494	1,710.00
Tax Year	Statement Number	Billed Owner	Tax Area	Total Value	Exemptions	Taxable Value	Billed Tax																																																																																																																		
2025	2025-660005579	PATTERSON, LOGAN KEITH &	17	270,638	0	29,770	2,752.00																																																																																																																		
2024	2024-660005579	PATTERSON, LOGAN KEITH &	17	244,604	1000	18,867	1,744.00																																																																																																																		
2023	2023-660005579	WEIR, ROBERT Y & CHARLOTTE A	17	175,354	1000	18,289	1,675.00																																																																																																																		
2022	2022-660005579	WEIR, ROBERT Y & CHARLOTTE A	17	178,366	1000	18,620	1,724.00																																																																																																																		
2021	2021-660005579	WEIR, ROBERT Y & CHARLOTTE A	17	187,115	1000	19,583	1,729.00																																																																																																																		
2020	2020-660005579	WEIR, ROBERT Y & CHARLOTTE A	17	184,100	1000	19,138	1,752.00																																																																																																																		
2019	2019-660005579	WEIR, ROBERT Y & CHARLOTTE A	17	177,740	1000	18,551	1,718.00																																																																																																																		
2018	2018-660005579	WEIR, ROBERT Y & CHARLOTTE A	34	185,505	1000	19,279	2,068.00																																																																																																																		
2017	2017-660005579	WEIR, ROBERT Y & CHARLOTTE A	34	184,037	1000	18,689	1,974.00																																																																																																																		
2016	2016-660005579	WEIR, ROBERT Y & CHARLOTTE A	34	179,338	1000	18,115	1,969.00																																																																																																																		
2015	2015-660005579	WEIR, ROBERT Y & CHARLOTTE A	34	176,159	1000	17,559	1,823.00																																																																																																																		
2014	2014-660005579	WEIR, ROBERT Y & CHARLOTTE A	34	177,506	1000	17,018	1,790.00																																																																																																																		
2013	2013-660005579	WEIR, ROBERT Y & CHARLOTTE A	34	168,264	1000	16,494	1,710.00																																																																																																																		



# Rogers

## Assessment Property Record Card for Tax Year 2026

Data provided by LISA DELOZIER County Assessor

Date 04/17/2026  
Time 03:10:09  
Page 2

Lot Data		Square-Foot - NBHD 1181 #1	
Lot Size			
Lot Count			
Units Buildable	1		
Non-Ag Acres	1.2246		
Topography			
Street Access			
Utilities			
Amenities		0	
		0	
Method	Square-Foot		
Base Lot Value	53,345.00 x 1.33 = 71,211		
Factor Value			
Adjustments	1.0000		
Lot Value	71,211		



\\tsclient\T\LOGAN\LOGAN RESIDENTIAL VI\2023-5-2\IMG\_0047. 5/2/2023

Residential Data	
Type	1 Single Family Residence
Condition	3 - Average
Quality	3 - Average
Architecture	R3 Res Nbhd 3
Style	100% One Story
Exterior Wall	80% Veneer, Stone 20% Frame, Siding, Wood
Base/Total Area	2,428 / 2,428
Style	100% One Story
HVAC	100% Warmed & Cooled Air
Roof Cover	1 Composition Shingle
Area on Slab	2,428
Fixture/RghIn	11 /
Bed/F/H Bath	3 / 2.0 /
Basement Area	
Garage Type	638 Attached Garage - Unfinished 2 Stalls
Remodel	
Year/Eff Age	1981 / 34

### GRM Approach

GRM Code	
Gross Rent	0.00
Indicated Value	

### Multiple Regression

MRA Code	1 Test
Adjusted R	0.8445
Indicated Value	263,440 108.50 Per SqFt

### Direct Comparables

Selection Model	A Adam Test
Adjustment Model	1 2022 Residential
Comparables	3
Indicated Value	322,410 Per SqFt

### Value Reconciliation

Selected Approach	Cost Approach
Improvements	202,950
Lot Value	71,211
Indicated Value	274,161 112.92 Per SqFt
Agland Value	
Site Improvements	
Total Value	274,161 112.92 Total Value Per SqFt

### Cost Approach Manual : 01/2025

Base Cost	106.41	Total Misc Impr	+	20,301
Roofing Adj	+ 4.53	Garage Cost	+	19,338
Subfloor Adj	+ -2.18	Total RCN	=	349,913
Heat/Cool Adj	+ 12.64	Depreciation ( 42%)	-	146,963
Plumbing Adj	+ 6.39	Lump Sums	+	0
Basement Adj	+ 0.00	RCNLD	=	202,950
Adj Base Cost	= 127.79	Lot Value	+	71,211
Total Area	x 2,428	Indicated Value	=	274,161
Adjusted Cost	= 310,274	Value Per SqFt		112.92

### Miscellaneous Improvements

Code	Description	Sketch ID	Size	Year	Units	Unit Cost	Depr	Value
FPR1	FIREPLACE - RESIDENTIAL 1 STORY	0		1	1	5,615.40		5,615
PRCH	SLAB PORCH - COVERED	13315	17x7		119	26.55		3,159
CPDT	CARPORT - DETACHED	13316	18x16		288	11.36		3,272
EPKS	ENCLOSED PORCH - KNEEWALL SCREEN	13317	20x10		200	29.08		5,816
PATO	SLAB PORCH - OPEN	13318	18x14		252	9.68		2,439



**Rogers**  
**Assessment Property Record Card for Tax Year 2026**

Data provided by LISA DELOZIER County Assessor

Date 04/17/2026  
 Time 03:10:09  
 Page 3

Sketch Image

660005579

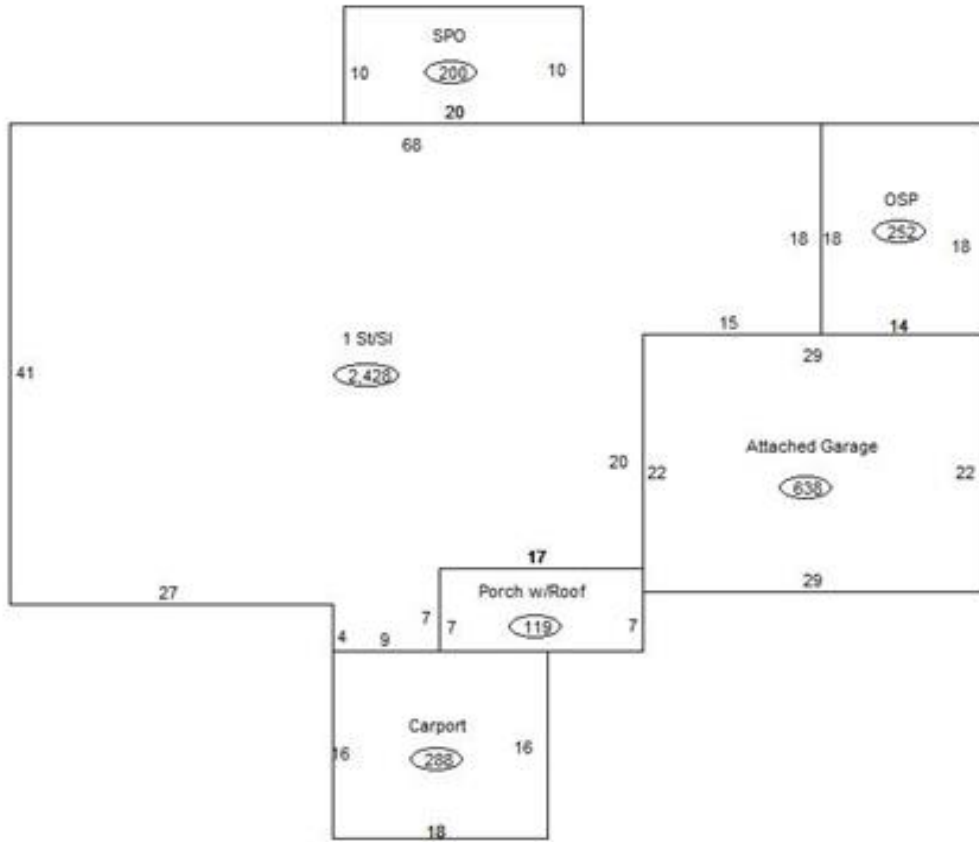

**Sketch Vector Information**

Sequence	Code	Type	Built Over	Scale	Section Label	Base Area	Multiplier	Total Area
1	R	1	Slab	13	1 St/Sl	2,428	1.000	2,428
2	G	1		13	Attached Garage	638	1.000	638
3	M	PRCH		13	SLBC	119	1.000	119
4	M	CPDT		13	Carport	288	1.000	288
5	M	EPKS		13	Screen Porch	200	1.000	200
6	M	PATO		13	Open Slab	252	1.000	252
<b>Total Building Area</b>						2,428		2,428